

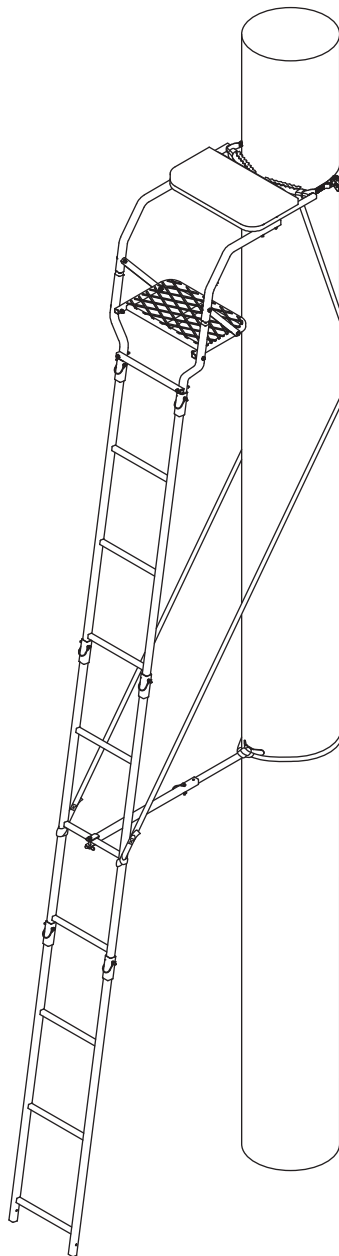

**WE ARE HUNTERS**



Operator's Manual

## **CLASSIC™** Ladder Stand

MODEL RE646

### **Maximum Height**

15' 3" to seat

### **Maximum Field Rating**

300 lbs

### **Tree Diameter Range**

12" to 20"

**Wear Your Harness!**



PRODUCT MEETS  
INDUSTRY STANDARDS  
RECOGNIZED BY



PARTICIPATING MEMBER

Get parts online at  
**[www.HuntRiversEdge.com](http://www.HuntRiversEdge.com)**

© 2017 RETI  
All Rights  
Reserved

P/N: 23744  
REV3: 12/19/17

## INTRODUCTION

Rivers Edge® Treestands are engineered with you the hunter in mind. We appreciate your purchase of one of our world class treestands. Follow these few simple instructions and your stand will provide you many years of trouble-free pleasure. Instructions should be kept in a safe place and reviewed at least annually.

If for any reason you have a problem with your product, **DO NOT return to the retailer**, contact the Rivers Edge® customer service department at 800-450-EDGE (3343) for assistance.

## CONTENTS

Introduction/Warranty .....	2
Warnings.....	2-3
Inspection and Maintenance .....	3
Hardware Identification Chart.....	5
Tools Needed .....	5
Assembly Instructions .....	6-7
Warnings.....	8
Finished Ladder.....	9
Setup and Use Instructions.....	10-11
Illustrated Parts Breakdown.....	12
Parts List.....	13

## WARRANTY

RETI offers a **one-year warranty** for all components of the treestand. These warranties apply to the original owner with a proof of purchase. These warranties begin on the date of purchase by the first retail consumer and continue for the period specified above. These warranties apply to products that are not modified, abused or used in a manner that deviates from the product's intended usage. Minor fading in color is normal and is not covered by warranty. Any corrosion of painted surfaces that occurs as a result of paint being removed or damaged is also not covered by warranty. RETI offers no other warranty expressed or implied. Products for which warranty work has been approved must be sent directly to RETI and performed by RETI. **To obtain warranty service and/or replacement instructions, you must obtain prior approval from RETI before shipping your package to us by calling our customer service department at 800-450-3343 or by writing to: RETI, P.O. Box 755, 1160 Eighth Avenue, Cumberland, WI 54829 for a return material authorization number (RMA#).** All items must be shipped prepaid. RETI will, at no charge, repair or replace, in RETI's sole discretion, any product that satisfies the conditions stated above. RETI retains the right to change models, specifications and price without notice.

This equipment has been manufactured under strict quality and safety guidelines. As with any equipment of this type, full understanding of the instructions and its use is mandatory and imperative for the safety of its user. RETI is not responsible for any damages or injuries sustained due to improper use or modification of any of its products, or resulting from any use which deviates from the product's intended usage. RETI is not responsible for any injuries sustained due to failure to read and adhere to the instructions for use. Any misunderstanding or questions regarding the products of their use should be directed to RETI prior to any use. **All RETI treestands are sold with a full body harness ("Fall Arrest System") that meets standards recognized by the Treestand Manufacturer's Association ("TMA").** It is the owner's sole responsibility to inspect the product regularly for damage, improper installation, or conditions that could jeopardize the ultimate safety of the product. Failure to use or improper use of the provided Fall Arrest System may result in serious injury or death. **ALWAYS wear the provided Fall Arrest System while using this product. Owner is responsible to understand and follow product field weight rating and must never exceed maximum weight rating.** RETI is not responsible for any malfunction or injury resulting from normal wear and tear, damage caused by improper use, improper maintenance, negligence or accidents. This product, if used safely as intended, will provide trouble free service for the useful life of the product. We hope you will enjoy the quality of our products for years to come, and have a safe hunt.

**STOP**

## READ AND UNDERSTAND THE FOLLOWING WARNINGS BEFORE ASSEMBLY

### MODEL RE646

**MAXIMUM USE HEIGHT - 15' 3" TO SEAT**

**MAXIMUM OCCUPANCY - ONE (1) PERSON**

**TOTAL WEIGHT LIMIT - 300 LB**

**TREE DIAMETER RANGE - 12" TO 20"**

### WARNING

- ⚠ This product carries strict height and weight restrictions. **Do Not** use this product if you exceed the total weight limit. Please note that the total weight limit includes the user(s) and their equipment.

### WARNING

- ⚠ **When hunting from a treestand falls can occur any time after leaving the ground causing injury or death.**
- ⚠ **Always** wear a Fall Arrest System (FAS) comprising of a full body harness at all times after leaving the ground. You must stay connected at all times after leaving the ground while using climbing and hang-on treestands. Single safety belts and chest harnesses are no longer allowed and shall never be used. If you are not wearing a full body harness properly attached to the tree that is protecting you from a fall, do not leave the ground.
- ⚠ **Read and understand** all of the manufacturer's Warnings and Instructions and use all safety devices provided by the manufacturer. Contact the manufacturer for any questions. Failure to do so could result in injury or death.
- ⚠ **Never** exceed the total weight limit of the treestand.
- ⚠ **Never** use a treestand during inclement weather such as rain, lightning, windstorms or icy conditions and end your hunt and return to the ground if inclement conditions arise.
- ⚠ **Never** use a treestand while using drugs (even prescription drugs) or alcohol.
- ⚠ **Never** use a treestand while feeling ill, nauseous or dizzy, or if you have a prior medical condition that could cause a problem, that is, heart condition, joints that lock-up, spinal fusions, etc., or if you are not well rested. **Never** sleep in stand.
- ⚠ **Never** use a treestand on a dead, leaning, diseased or loose barked tree, or a utility pole. **Always** avoid electrical power lines.
- ⚠ **Never** rely on a tree branch for support.
- ⚠ **Never** jump or bounce on a treestand to seat it to the tree.

### WARNING

- ⚠ Pull up a bow, backpack, or firearm or other equipment only after being secure in the treestand and a firearm must be pulled up with it unloaded, chamber open, and muzzle down.
- ⚠ **Always** inform someone of the hunting location, where the treestand will be located and the expected duration of the hunt.
- ⚠ A signal device such as a mobile phone, radio, whistle, signal flare or personal locator device (PLD) must be on your person and readily available at all times.
- ⚠ Inspect the treestand and all safety devices each time before use and **Do Not** store a treestand outdoors when not in use.
- ⚠ **Never** modify your treestand in any way by making repairs, replacing parts, or altering it except if explicitly authorized in writing by the manufacturer.
- ⚠ Practice installing, adjusting and using your treestand at ground level prior to using it at elevated positions. Study your new stand to become familiar with all of its features and design. Doing so will confirm that the product is manufactured, assembled and installed correctly.
- ⚠ Instructions (written and video) shall be kept in a safe place and reviewed at least annually. It is the responsibility of the treestand owner to furnish the complete instructions to any person who borrows or purchases the treestand.
- ⚠ Use at least three (3) people to install or take down a ladder treestand.
- ⚠ The criss-cross straps/ropes and stabilization devices must be attached before climbing to the platform.
- ⚠ When installing a ladder stand, always bounce on the first rung to set the ladder into the ground according to manufacturer's instructions before proceeding to climb any higher.
- ⚠ Check every ladder section connection every time you use the stand before you leave the ground. If ladder sections are separating, do not use the stand.
- ⚠ Check the ground under the stand to make sure it is firm and level. Sloping ground or uneven surface (one side on a rock) can cause your ladder to tilt or shift off the tree as you climb.
- ⚠ **Always** maintain three (3) points of contact when climbing a ladder treestand. Proper three-point contact means having either two feet with one hand or one foot with two hands on the step portion of the ladder or climbing aid at all times.



## WARNING

- ▲ **Always** lean forward as you climb and attach your harness to the tree before securing the platform to the tree and stepping onto the platform.
- ▲ **Never** exceed the stated maximum use height.
- ▲ **Do Not** use this product until you have watched the included treestand safety DVD, understand it, and practiced the techniques for safe hunting discussed in this DVD.
- ▲ Read and perform all inspection and maintenance tasks before each and every use. Replace any questionable components immediately with RETI original replacement parts.
- ▲ **Do Not** crush tubing when tightening bolt assemblies! Identify and familiarize yourself with all parts before you start. Bolt identification chart can be found on the following page of the manual.
- ▲ Double check assembly steps to be certain you have correctly assembled this product.
- ▲ **Never** use any product that has not been maintained or inspected properly - Your life depends on it!
- ▲ Replace any and all treestand straps every two years or when any signs of damage or wear exist before.
- ▲ **Always** wear the appropriate footwear when using a ladder treestand. A good non-slip safety boot is important to your personal safety. Be especially careful that boot laces do not get hooked on the stand or any of its components (tuck shoelaces into boots before climbing).



## WARNING

- ▲ **Only** use approved RETI parts. Failure to do so may result in serious injury or death!

## INSPECTION AND MAINTENANCE

### BEFORE EACH USE PERFORM THE FOLLOWING:

- Inspect all webbing, rope, cord, and strap assemblies for wear or damage.
- Inspect cables and/or cable ends for damage or kinking.
- Inspect all hardware and chain components for damage or wear.
- Inspect for any structural damage to product. (If any exists stop use immediately and call RETI Customer Service.)
- Inspect all nut and bolt assemblies to be certain none are loose.
- Inspect for any missing parts.
- Lubricate all pivot and slide together points with powder graphite, petroleum jelly or silicone spray to prevent noise, wear and rust.
- Inspect entire product for any rust, corrosion, cracks, freezing, excessive heat or rotting damage that may effect the safety of your product. Discard any questionable product.
- Inspect entire product for any structural damage - pay close attention to all weld locations. (Discard product if any damage is found.)
- Using correct wrenches inspect all nut & bolt assembly locations and snug up any that may be loose. Be careful not to crush tubing when tightening!
- Inspect and check operation of all cables, cable ends, cord, rope, webbing, and strap or chain assemblies. Replace with RETI original replacement parts any item or assembly that shows signs of wear, damage, kinking, or functions incorrectly.
- Inspect seat for damage or wear. Replace any seat with factory new that shows signs of structural damage or wear.
- Never modify your stand in any way by making repairs, replacing parts, or altering by adding or attaching anything to it except if explicitly authorized in writing by the manufacturer.

## HARDWARE IDENTIFICATION CHART

Bolts shown are for size reference.  
Extra hardware may be included in the parts bag.

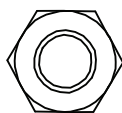
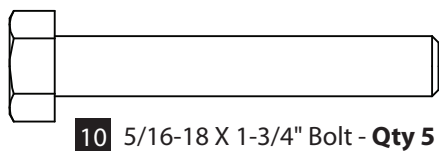

5/16" Nut  
**Qty 12**

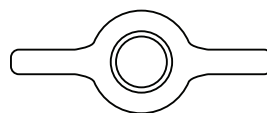

5/16" Wing Nut  
**Qty 1**

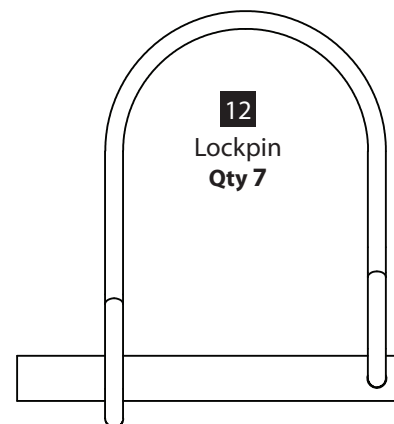
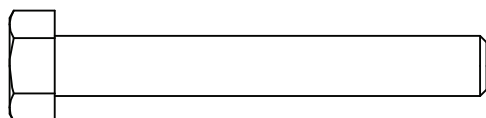

## TOOLS NEEDED

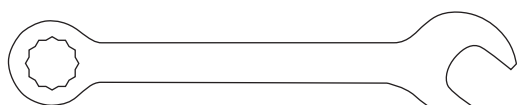

## ASSEMBLY INSTRUCTIONS

### IMPORTANT ASSEMBLY TIP:

Do not tighten any nut and bolt combinations completely until all parts are assembled together! Finger tighten plus one turn of a wrench only! This will temporarily hold the lock nut on the bolt while helping alignment of all parts! After all parts are assembled together, all nut & bolt combinations must be completely tightened.

**All assembly must be done in this order at ground level before uprighting.**

**Do not remove labels/warnings from product, they are there for your safety.**

**Recommended for adult use only.**

1. Attach the two seat side rails (4) to the seat platform (5) using four 5/16-18 X 2-1/4" bolts (11) and four 5/16" nuts (13). **SEE FIGURE 1**
2. Slide the flared platform rails (2) into the already assembled seat side rails (4). Insert two 5/16-18 X 1-3/4" bolts (10). **DO NOT SECURE WITH NUTS UNTIL LATER STEP. SEE FIGURE 2**
3. Attach the two support bars (3) to the rounded end of the foot platform (6) using two 5/16-18 X 1-3/4" bolts (10) and two 5/16" nuts (13). **SEE FIGURE 2**
4. Attach the free ends of the two support bars (3) onto the 5/16-18 X 1-3/4" bolts (10) that connect flared platform rails (2) and seat side rails (4) and secure together with two 5/16" nuts (13). **SEE FIGURE 2**
5. Attach the square ends of the foot platform (6) to the flared platform rails (2) using two 5/16-18 X 2-1/4" bolts (11) and two 5/16" nuts (13). **SEE FIGURE 2**
6. Attach the top ladder rung (7) to the front side of flared rails (2) using two 5/16-18 X 2-1/4" bolts (11) and two 5/16" nuts (13). **SEE FIGURE 2**
7. Slide together the three ladder sections (1) and the assembled top platform section on the ground and secure all sections together using six spring lock pins (12). **SEE FIGURE 3**

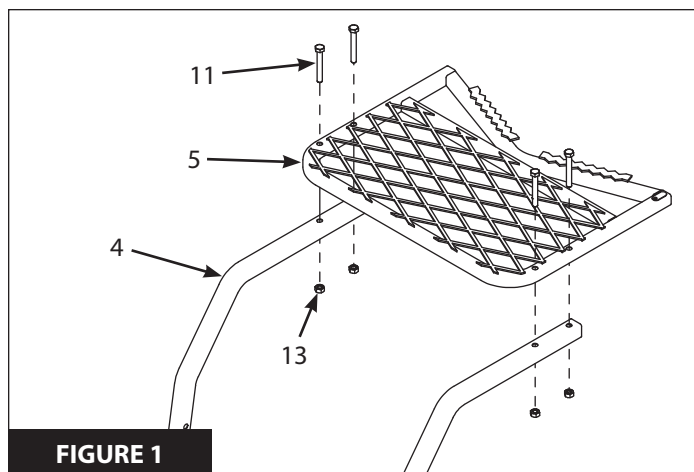

**FIGURE 1**

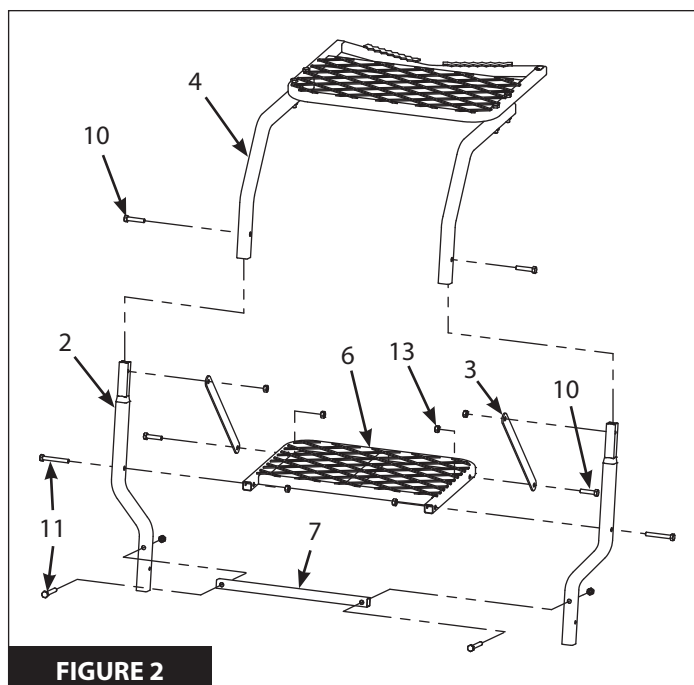

**FIGURE 2**

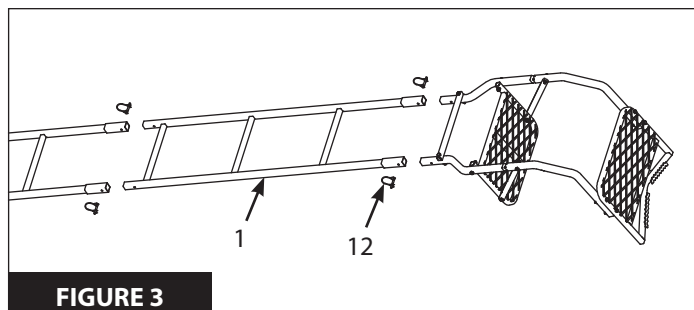

**FIGURE 3**

8. Assemble the horizontal stabilizer bar as follow:

- a. Slide the stabilizer bar (8) into stabilizer bar extension tube (9) and secure together with spring lock pin (12).

**SEE FIGURE 4**

**NOTE: Spring lock pin (12) must go through both the horizontal stabilizer bars at the appropriate hole to achieve the desired distance from the tree. Adjustment in length may be needed when ladder is up righted later in instructions.**

- b. Attach the forward end of the horizontal stabilizer bar assembly to a rung of the ladder using 5/16-18 X 1-3/4" bolt (10) and 5/16" wing nut (14). **SEE FIGURE 4**

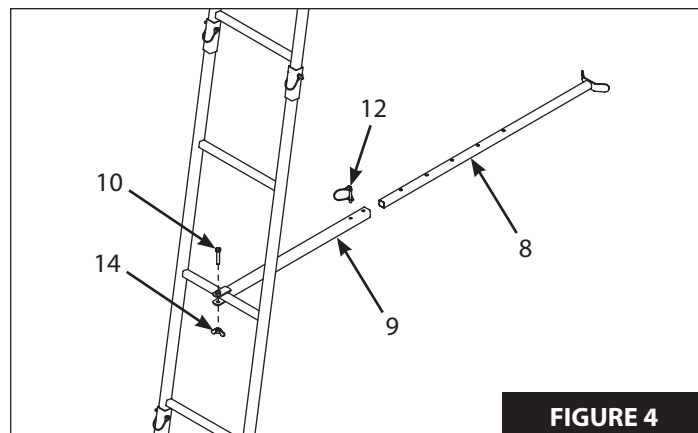

**FIGURE 4**

9. Preassemble 16' stabilizer straps (19) and 6' ratchet strap (18) as follows:

- a. Attach the two long ends of the 16' stabilizer (criss-cross) straps (19) to each side of the rear frame tube on each side of the seat platform tree blade. These long stabilizer straps should be attached by pulling the free end of the strap through the loop end of the strap to create a cinch knot around the frame tube. **SEE FIGURE 5**
- b. To aid in the ease of installation, pre-attach each end of the 6' ratchet strap (18) to each side of the rear frame tube, just inside of the 16' stabilizer straps (19) on both sides of the seat platform tree blade. Use the same method as above. **SEE FIGURE 5**. This way each end of the main ratchet strap is pre-attached before the stand is lifted from the ground. **SEE FIGURE 6** showing all four ends attached.



**FIGURE 5**

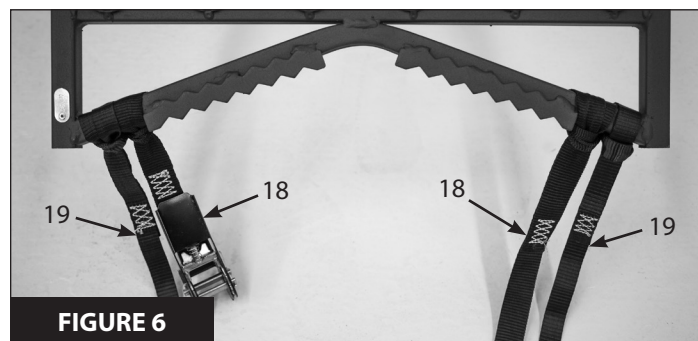

**FIGURE 6**

10. Secure the seat cushion (15) to the seat platform (5) by wrapping straps around metal frame and securely fastening all plastic buckles together. Pull straps tight so seat is not loose.



STOP

## READ AND UNDERSTAND THE FOLLOWING WARNINGS BEFORE SETUP AND USE

### WARNING

- ▲ Double check assembly steps to be certain you have correctly assembled this product.
- ▲ Study your new stand to become familiar with all of its features and design. At ground level, following provided use instructions, practice attaching stand to tree and removing stand from tree. Practice sitting, standing, and using this product before attaching overhead. Save these instructions for future reference. You must always use the provided Fall Arrest System (FAS) while using this product.
- ▲ **Always** use at least three (3) people to install or take down a ladder treestand. **Always** have two people stabilize the ladder before climbing to the platform the first time after every set-up.
- ▲ Be absolutely sure the tree blade(s) on stand and the stabilizer bar are contacting tree before climbing ladder.
- ▲ Stabilizer bar must always be correctly and securely attached to ladder and tree before climbing ladder.
- ▲ Make sure ladder bottom is firmly seated on dry, level ground. Attach your harness tether to the tree before securing the platform to the tree and stepping onto platform. Refer to the Full Body Harness instructions.
- ▲ **Never** ascend or descend ladder without criss-cross straps/ropes securely holding ladder to tree and stabilizer bar securely attached. Failure to correctly perform these steps can cause the ladder to collapse/buckle-over backwards during the initial ascent to attach ratchet strap resulting in serious injury or death.
- ▲ **Always** lean forward as you climb and attach your harness to the tree before securing the platform to the tree and stepping onto the platform.

### WARNING

- ▲ **Always** maintain three (3) points of contact when climbing a ladder treestand. Proper three-point contact means having either two feet with one hand or one foot with two hands on the step portion of the ladder or climbing aid at all times.
- ▲ **Always** wear the appropriate footwear when using a ladder treestand. A good non-slip safety boot is important to your personal safety. Be especially careful that boot laces do not get hooked on the stand or any of its components (tuck shoelaces into boots before climbing).
- ▲ **Never** stand on seat, it is designed for sitting only.
- ▲ **Do Not** allow excessive strap buildup in ratchet as this will prevent the ratchet teeth from engaging causing slippage.
- ▲ **Always** attach ratchet straps securely while using this product!
- ▲ If seat is removable, be certain it is securely attached when in use.
- ▲ Some models include a shooting rail. **Never** lean against, lean over, or sit on shooting rail. It is designed as a shooting rest only. **Always** be aware that the shooting rail can swing to one side or pivot up and down.
- ▲ Some models include a footrest, which is designed as a footrest only. **Never** stand on footrest! **Always** be fully aware of foot placement.
- ▲ Some models include a multi-piece stabilizer bar system. Be sure attachment hardware goes through both the extension tube and the stabilizer bar.

### WARNING

- ▲ **Never** use a treestand on a dead, leaning, diseased or loose barked tree, or a utility pole. **Always** avoid electrical power lines.
- ▲ Bring ratchet strap(s) up with you in a pocket - **Do Not** carry in your hands!



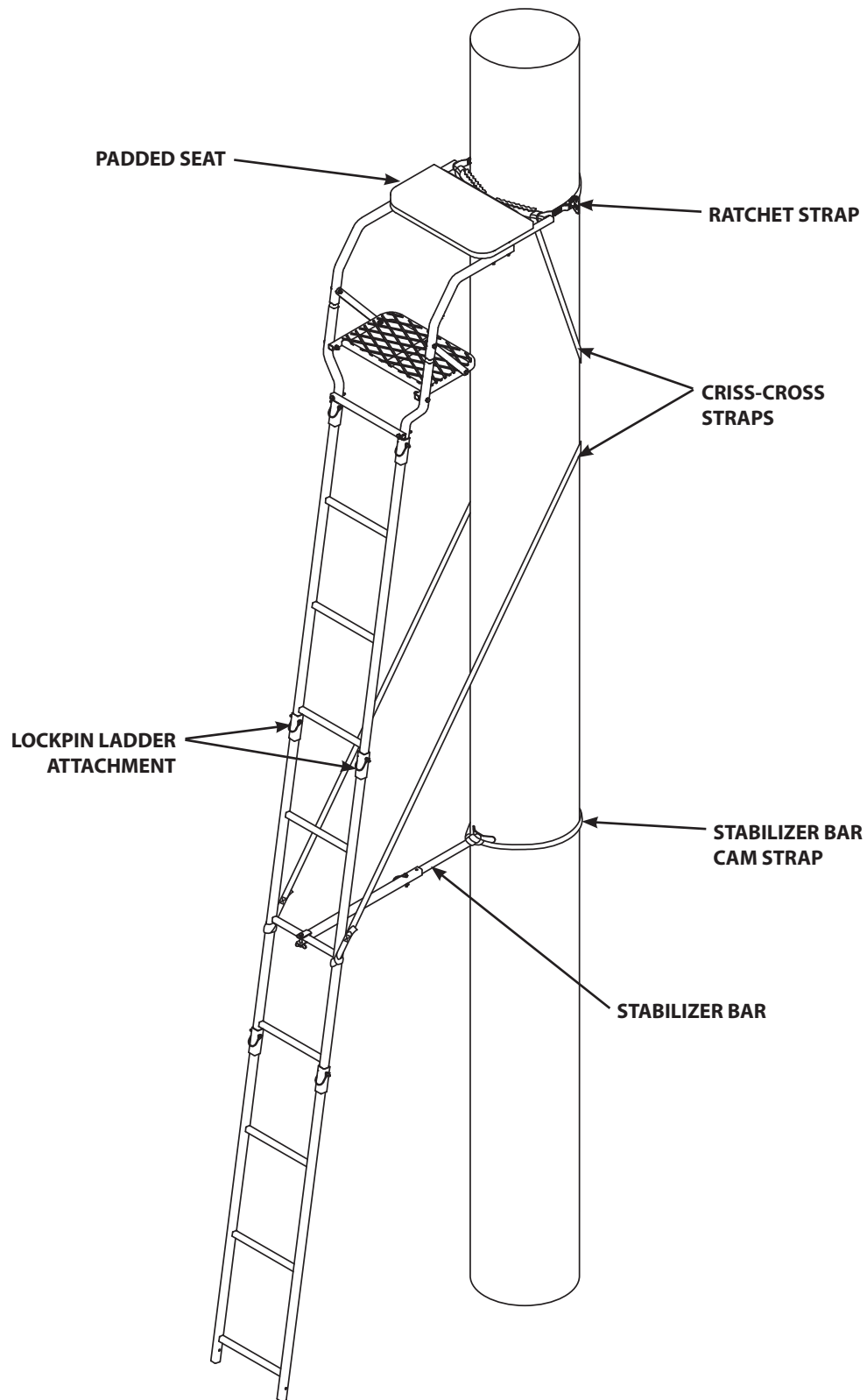

## SETUP AND USE INSTRUCTIONS

*During installation and removal of ladder treestands, you must always and properly use the included Full Body Harness (Fall Arrest System). Refer to the Full Body Harness instructions included with this product for proper use.*

1. Select a straight, healthy tree. Do Not attempt to install on a tree that is not healthy.
2. With assembled product lying on the ground, **position one person at bottom end of ladder lying on the ground.** This person has to prevent the ladder end from tilting up when platform end is lifted and prevent the ladder from skidding across ground.
3.
  - a. Position two people at the platform end of the ladder, lift the platform end and continue uprighting by walking toward bottom end of ladder and moving hands along ladder legs. **Stand ladder up against chosen straight tree on dry, level ground.** Use caution when ladder comes over center against the tree. **SEE FIGURE 7A**
  - b. Step back and look at the ladder top to see that it is level. Adjust as needed to achieve a level platform top. Make sure tree blade is contacting tree. **SEE FIGURE 7B**
  - c. Step down hard on bottom step to push ladder legs into the ground. **SEE FIGURE 7C**
4. While two people hold the stand in place, the third person should connect the horizontal stabilizer bar to the tree. Adjust the length of the stabilizer bar as need so it contacts the tree and is level to the ground. Then secure it to the tree with the 6' cam strap (17) by forming a cinch knot with both ends of the strap and running the long end of the strap through the cam buckle. **SEE FIGURES 8 and 9.**

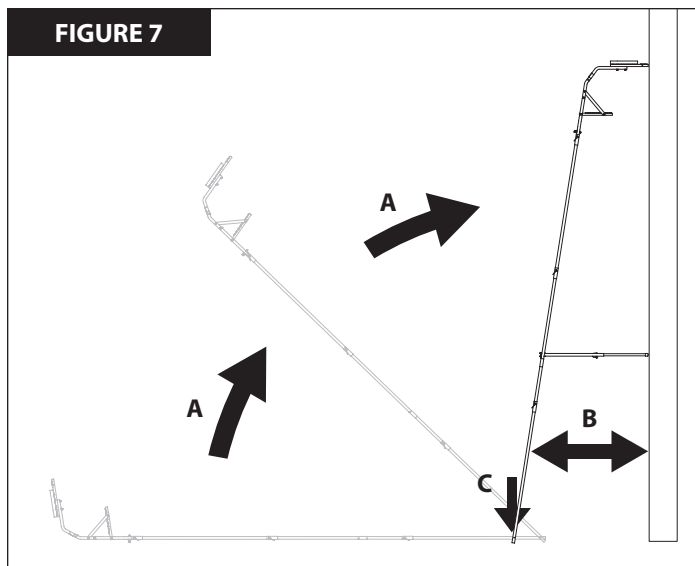
**FIGURE 7**

**FIGURE 8**

**FIGURE 9**

5. a. Loop the d-loop end of the two 16' criss cross straps (19) through the loop end to form a cinch knot around the ladder rail tube. Secure beneath a step rung, at the stabilizer bar height location. **SEE FIGURE 10A.**
- b. With the stand level and being held in place by two people, the third person must cross one of the 16' criss cross straps (19) behind the tree and feed the free end through the opposite d-loop. **SEE FIGURE 10B-E.**
- c. Criss cross the other 16' stabilizer strap (19), forming an "X" pattern on the backside of the tree and feed the free end through the opposite d-loop. **SEE FIGURE 10B-E.**
6. Make sure the criss cross straps and stabilizer bar strap are snug and the tree blade is still contacting the tree.

**NOTE: This ground level ladder-to-tree attachment will prevent the ladder from pulling away from the tree while ascending to the top for final 6' ratchet strap (18) attachment. The same holds tree when the ladder is removed.**

7. With two people securely holding the ladder, the third person must now use the three point contact climbing method to slowly climb the ladder. Make sure to keep a constant hand grip on the ladder at all times. Always lean forward, toward the tree, to keep the platform tree blade against the tree.

**NOTE: Make sure the ladder bottom is firmly seated on dry, level ground. Attach your harness tether to the tree before securing the platform to the tree and stepping onto platform. Refer to the Full Body Harness instructions included with this product.**

8. Standing on ladder step, lean toward tree with previously installed 6' ratchet strap (18) now in hand.
  - a. Wrap the previously installed end of the long strap around the tree and feed through the slot in the ratchet mechanism. **SEE FIGURE 11A.**
  - b. Pull tail of long strap until most of the slack is taken out. Be sure entire strap is even and at the same level all around tree. **SEE FIGURE 11B.**
  - c. Use the ratchet to tighten the strap to tree. The tightened strap will stabilize the stand to tree and prevent movement. **SEE FIGURE 11C.**

**NOTE: Make sure there is at least two full revolutions of strap on the ratchet spool before the strap tightens. Proper tension will ensure the stand is secured to the tree. Do not allow excessive strap to build up in the ratchet as this will prevent the ratchet teeth from engaging and can cause slippage.**

**To release ratchet, simply pull the release lever and open tightening lever wide open (flat). SEE FIGURE 11D.**

9. If necessary, re-check and adjust the 6' ratchet strap (18), 16' criss cross straps (19) and horizontal stabilizer bar assembly to securely attach the treestand to the tree. The tree blade must be touching the tree.

10. You are now ready to use your ladder stand!

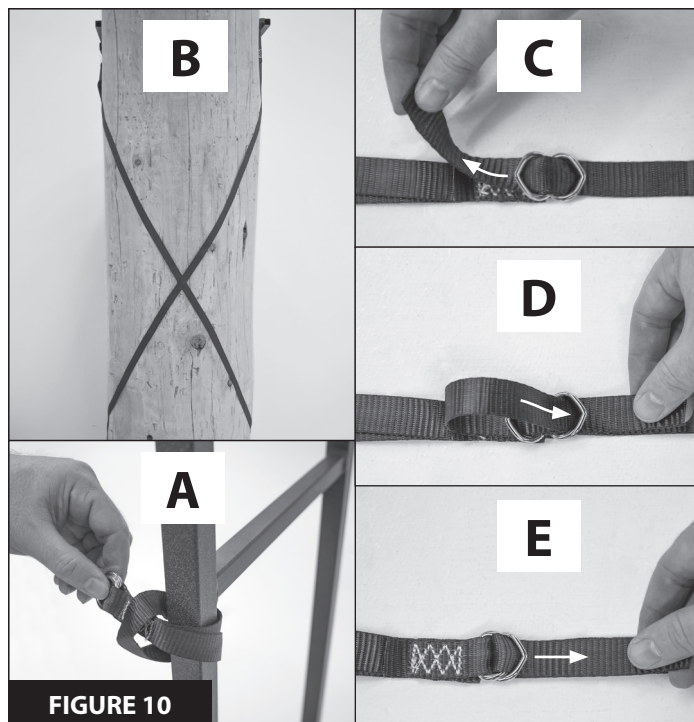

**FIGURE 10**

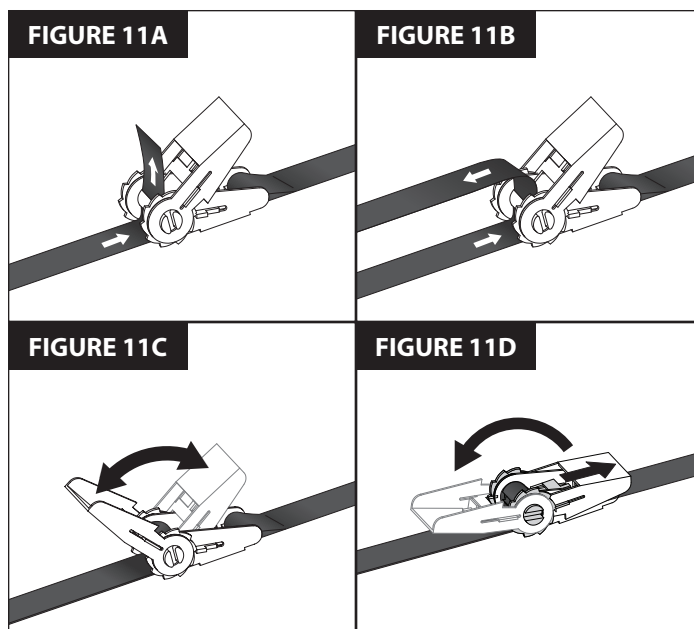

**FIGURE 11A**

**FIGURE 11B**

**FIGURE 11C**

**FIGURE 11D**



## IMPORTANT

- ▲ Reverse the Set-Up and Use Instructions to take the ladder stand down.

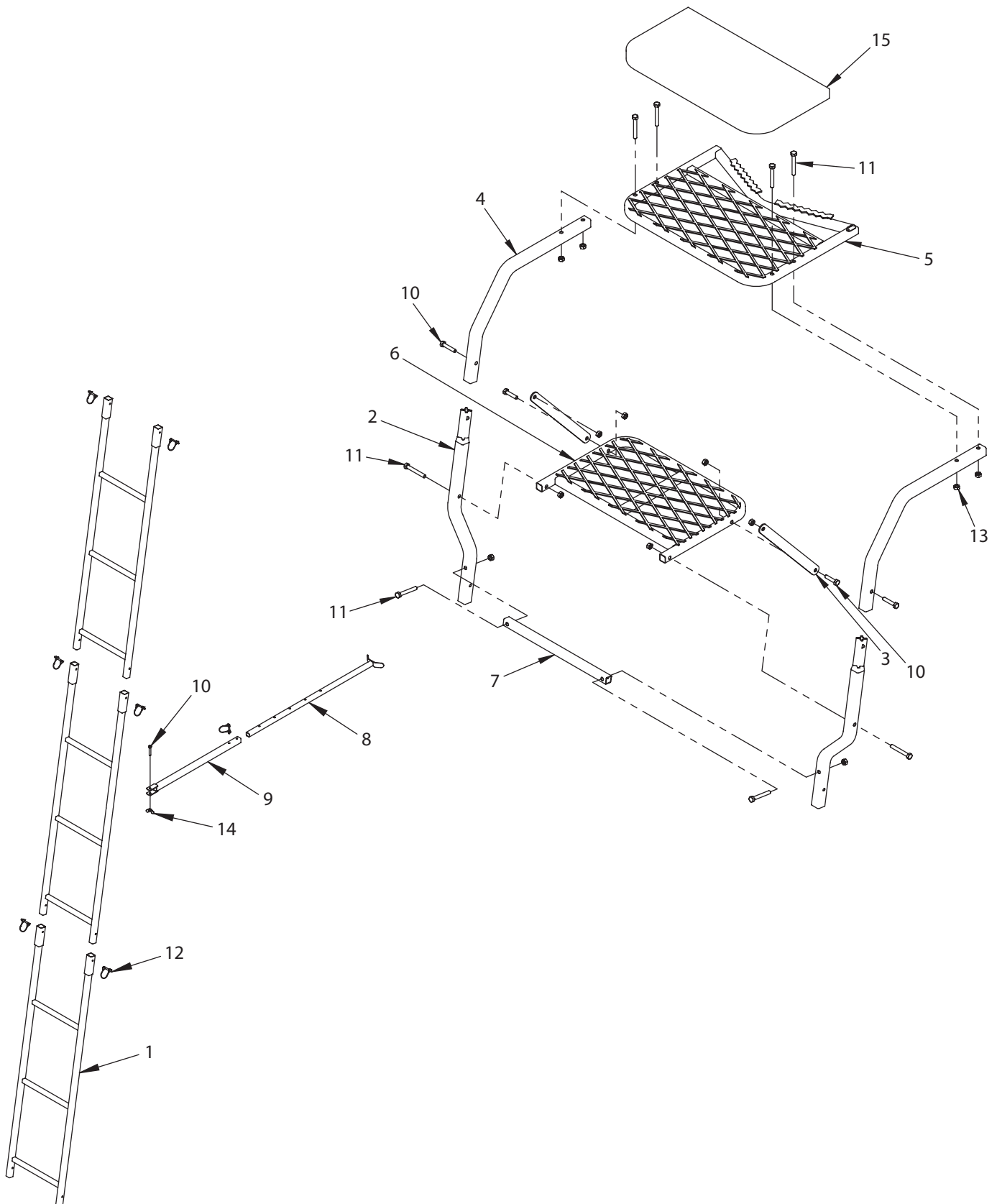

## PARTS LIST

ITEM #	PART #	DESCRIPTION	QTY.
1	23704	LADDER SECTION	3
2	23702	FLARED PLATFORM RAIL	2
3	23701	SUPPORT BAR	2
4	23748	SEAT SIDE RAIL	2
5	23696	SEAT PLATFORM	1
6	23697	FOOT PLATFORM	1
7	23703	TOP LADDER RUNG	1
8	23698	STABILIZER BAR "A"	1
9	23699	STABILIZER BAR EXTENSION "B"	1
10	8655B	5/16-18 X 1-3/4 IN BOLT	5
11	27950	5/16-18 X 2-1/4 IN BOLT	8
12	19847	6MM X 50.8MM ROUND LOCKPIN	7
13	60G5NYB	5/16 IN NUT	12
14	27951	5/16 IN WING NUT	1
15	23750	SEAT CUSHION	1

### ITEMS BELOW ARE NOT SHOWN

16	10531	SAFETY HARNESS / FALL ARREST SYSTEM	1
17	MK021-1401	6' CAM BUCKLE STRAP	1
18	MK011-1601	6' RATCHET STRAP	1
19	MK034-4511	16' STABILIZER STRAP	2
20	48800	TREE STAND SAFETY DVD	1

### Maximum Height - 15' 3" to seat

(Never extend this stand beyond this maximum use height)

### Single User Maximum Field Rating - 300 lb

(This is the maximum combined total weight of the user, their clothing, and gear while on the ladder, platform and/or seat)  
No more than one person should occupy any part of this stand at any time.

### Tree Diameter Range - 12" to 20"

(Select only strong, healthy trees that are straight with no loose bark)

## This image shows a full page of blank, lined paper. It features approximately 20 evenly spaced horizontal grey lines across its entire width, typical of notebook or composition paper. The background is white, and there are no margins, text, or other markings present.

## OTHER GREAT PRODUCTS BY RIVERS EDGE TREESTANDS



**LANDMARK**  
 PERMANENT BLINDS

Portable ground blinds take a beating from the sun, wind, rain and snow. Colors fade, materials rot, poles break and fabric tears. The Landmark Permanent Blind was designed and constructed to resist the elements year after year. The durable steel frame is covered in marine-grade reinforced synthetic tarpaulin, made from the same rugged materials used in pick-up truck tonneau covers. The window configuration allows you to precisely control gap vertically, horizontally or both. If you're looking for an affordable year-round hunting blind with enough room for group hunts and archers, the Landmark Permanent Blind is for you.

## BigFoot™ CLIMBING AIDS



All climbing aids are not created equal. For starters, Bigfoot Climbing Aids feature extra-large rungs that a hunter can place 2 feet on the same level. Next we use a permanent anti-slip coating called Tractionite. Our assortment of climbing aids securely attach to the tree using a cam straps or ratchet straps. We take immense pride and satisfaction in knowing that our designs consistently gain praise from hunters and outfitters who recognize the little differences. A big hunt should never be ruined over a a little climb!

## BigFoot™ HANG-ONS



Nothing attaches to a tree tighter than a Big Foot™ Treestand! Our line of lever-action hang-on stands bite into the tree eliminating the need for a second strap. Other treestands use small ratchet straps that are not as secure once installed. Perfect for sitting on a tree at ground level or higher up when paired with our climbing aids. Feel the stability of a Big Foot™ Treestand for yourself!





---

***WE ARE HUNTERS***

---

**Rivers Edge® Treestands, Inc.**

1160 Eighth Avenue, PO Box 755  
Cumberland, WI 54829

Phone: 800-450-EDGE (3343)

Fax: 715-822-2124

[www.huntriversedge.com](http://www.huntriversedge.com)

\*All weights, specifications and features are approximate and are subject to change without notice. Due to continuous product improvements, product images may not be exact. Warning labels in some product images may have been removed for photography purposes only. Props shown in photos not included. Some assembly may be required.

---