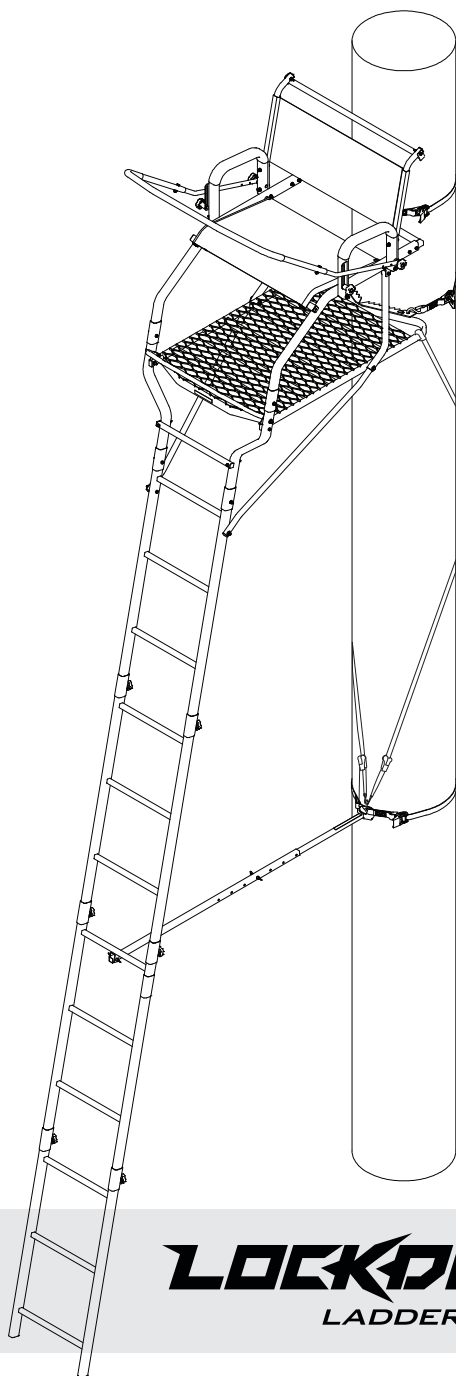




**WE ARE HUNTERS**



**LOCKDOWN™**  
LADDER STANDS

PRODUCT MEETS  
INDUSTRY STANDARDS  
RECOGNIZED BY



PARTICIPATING MEMBER

Operator's Manual

**LOCKDOWN™**  
**WIDE**  
**1-MAN**  
Ladder Stand

MODEL RE655

**Maximum Height**  
18' 6" to shooting rail

**Maximum Field Rating**  
300 lbs

**Tree Diameter Range**  
12" to 20"

**Wear Your Harness!**



Get parts online at  
**[www.HuntRiversEdge.com](http://www.HuntRiversEdge.com)**

© 2018 RETI  
All Rights Reserved

P/N: 29369  
REV2: 2/23/18

## INTRODUCTION

Rivers Edge® Treestands are engineered with you the hunter in mind. We appreciate your purchase of one of our world class treestands. Follow these few simple instructions and your stand will provide you many years of trouble-free pleasure. Instructions should be kept in a safe place and reviewed at least annually.

If for any reason you have a problem with your product or are missing any parts, **DO NOT return to the retailer**, contact Rivers Edge® Customer Service Department at 800-450-EDGE (3343) for assistance.

## CONTENTS

|                                    |       |
|------------------------------------|-------|
| Introduction/Warranty .....        | 2     |
| Warnings.....                      | 3-4   |
| Inspection and Maintenance .....   | 4     |
| Hardware Identification Chart..... | 5     |
| Assembly Instructions .....        | 7-15  |
| Warnings.....                      | 16    |
| Setup and Use Instructions.....    | 16-17 |
| Finished Ladder.....               | 18    |
| Illustrated Parts Breakdown.....   | 19-20 |

## WARRANTY

RETI offers a **one-year warranty** for all components of the treestand. These warranties apply to the original owner with a proof of purchase. These warranties begin on the date of purchase by the first retail consumer and continue for the period specified above. These warranties apply to products that are not modified, abused or used in a manner that deviates from the product's intended usage. Minor fading in color is normal and is not covered by warranty. Any corrosion of painted surfaces that occurs as a result of paint being removed or damaged is also not covered by warranty. RETI offers no other warranty expressed or implied. Products for which warranty work has been approved must be sent directly to RETI and performed by RETI. **To obtain warranty service and/or replacement instructions, you must obtain prior approval from RETI before shipping your package to us by calling our customer service department at 800-450-3343 or by writing to: RETI, P.O. Box 755, 1160 Eighth Avenue, Cumberland, WI 54829 for a return material authorization number (RMA#).** All items must be shipped prepaid. RETI will, at no charge, repair or replace, in RETI's sole discretion, any product that satisfies the conditions stated above. RETI retains the right to change models, specifications and price without notice.

This equipment has been manufactured under strict quality and safety guidelines. As with any equipment of this type, full understanding of the instructions and its use is mandatory and imperative for the safety of its user. RETI is not responsible for any damages or injuries sustained due to improper use or modification of any of its products, or resulting from any use which deviates from the product's intended usage. RETI is not responsible for any injuries sustained due to failure to read and adhere to the instructions for use. Any misunderstanding or questions regarding the products of their use should be directed to RETI prior to any use. **All RETI treestands are sold with a full body harness ("Fall Arrest System") that meets standards recognized by the Treestand Manufacturer's Association ("TMA").** It is the owner's sole responsibility to inspect the product regularly for damage, improper installation, or conditions that could jeopardize the ultimate safety of the product. Failure to use or improper use of the provided Fall Arrest System may result in serious injury or death. **ALWAYS wear the provided Fall Arrest System while using this product. Owner is responsible to understand and follow product field weight rating and must never exceed maximum weight rating.** RETI is not responsible for any malfunction or injury resulting from normal wear and tear, damage caused by improper use, improper maintenance, negligence or accidents. This product, if used safely as intended, will provide trouble free service for the useful life of the product. We hope you will enjoy the quality of our products for years to come, and have a safe hunt.

STOP

## READ AND UNDERSTAND THE FOLLOWING WARNINGS BEFORE ASSEMBLY

### MODEL RE655

**MAXIMUM USE HEIGHT - 18' 6" TO SHOOTING RAIL**

**MAXIMUM OCCUPANCY - ONE (1) PERSON**

**TOTAL WEIGHT LIMIT - 300 LB**

**TREE DIAMETER RANGE - 12" TO 20"**

### WARNING

- ▲ This product carries strict height and weight restrictions. **Do Not** use this product if you exceed the total weight limit. Please note that the total weight limit includes the user(s) and their equipment.

### WARNING

- ▲ **When hunting from a treestand falls can occur any time after leaving the ground causing injury or death.**
- ▲ **Always** wear a Fall Arrest System (FAS) comprising of a full body harness at all times after leaving the ground. You must stay connected at all times after leaving the ground while using climbing and hang-on treestands. Single safety belts and chest harnesses are no longer allowed and shall never be used. If you are not wearing a full body harness properly attached to the tree that is protecting you from a fall, do not leave the ground.
- ▲ **Read and understand** all of the manufacturer's Warnings and Instructions and use all safety devices provided by the manufacturer. Contact the manufacturer for any questions. Failure to do so could result in injury or death.
- ▲ **Never** exceed the total weight limit of the treestand.
- ▲ **Never** use a treestand during inclement weather such as rain, lightning, windstorms or icy conditions and end your hunt and return to the ground if inclement conditions arise.
- ▲ **Never** use a treestand while using drugs (even prescription drugs) or alcohol.
- ▲ **Never** use a treestand while feeling ill, nauseous or dizzy, or if you have a prior medical condition that could cause a problem, that is, heart condition, joints that lock-up, spinal fusions, etc., or if you are not well rested. **Never** sleep in stand.
- ▲ **Never** use a treestand on a dead, leaning, diseased or loose barked tree, or a utility pole. **Always** avoid electrical power lines.
- ▲ **Never** rely on a tree branch for support.
- ▲ **Never** jump or bounce on a treestand to seat it to the tree.

### WARNING

- ▲ Pull up a bow, backpack, or firearm or other equipment only after being secure in the treestand and a firearm must be pulled up with it unloaded, chamber open, and muzzle down.
- ▲ **Always** inform someone of the hunting location, where the treestand will be located and the expected duration of the hunt.
- ▲ A signal device such as a mobile phone, radio, whistle, signal flare or personal locator device (PLD) must be on your person and readily available at all times.
- ▲ Inspect the treestand and all safety devices each time before use and **Do Not** store a treestand outdoors when not in use.
- ▲ **Never** modify your treestand in any way by making repairs, replacing parts, or altering it except if explicitly authorized in writing by the manufacturer.
- ▲ Practice installing, adjusting and using your treestand at ground level prior to using it at elevated positions. Study your new stand to become familiar with all of its features and design. Doing so will confirm that the product is manufactured, assembled and installed correctly.
- ▲ Instructions (written and video) shall be kept in a safe place and reviewed at least annually. It is the responsibility of the treestand owner to furnish the complete instructions to any person who borrows or purchases the treestand.
- ▲ Use at least three (3) people to install or take down a ladder treestand.
- ▲ The criss-cross straps/ropes and stabilization devices must be attached before climbing to the platform.
- ▲ When installing a ladder stand, always bounce on the first rung to set the ladder into the ground according to manufacturer's instructions before proceeding to climb any higher.
- ▲ Check every ladder section connection every time you use the stand before you leave the ground. If ladder sections are separating, do not use the stand.
- ▲ Check the ground under the stand to make sure it is firm and level. Sloping ground or uneven surface (one side on a rock) can cause your ladder to tilt or shift off the tree as you climb.
- ▲ **Always** maintain three (3) points of contact when climbing a ladder treestand. Proper three-point contact means having either two feet with one hand or one foot with two hands on the step portion of the ladder or climbing aid at all times.

## ⚠ WARNING

- ⚠ **Always** lean forward as you climb and attach your harness to the tree before securing the platform to the tree and stepping onto the platform.
- ⚠ **Never** exceed the stated maximum use height.
- ⚠ **Do Not** use this product until you have watched the included treestand safety DVD, understand it, and practiced the techniques for safe hunting discussed in this DVD.
- ⚠ Read and perform all inspection and maintenance tasks before each and every use. Replace any questionable components immediately with RETI original replacement parts.
- ⚠ **Do Not** crush tubing when tightening bolt assemblies! Identify and familiarize yourself with all parts before you start. Bolt identification chart can be found on the following page of the manual.
- ⚠ Double check assembly steps to be certain you have correctly assembled this product.
- ⚠ **Never** use any product that has not been maintained or inspected properly - Your life depends on it!
- ⚠ Replace any and all treestand straps every two years or when any signs of damage or wear exist before.
- ⚠ **Always** wear the appropriate footwear when using a ladder treestand. A good non-slip safety boot is important to your personal safety. Be especially careful that boot laces do not get hooked on the stand or any of its components (tuck shoelaces into boots before climbing).

## ⚠ WARNING

- ⚠ **Only** use approved RETI parts. Failure to do so may result in serious injury or death!

## INSPECTION AND MAINTENANCE

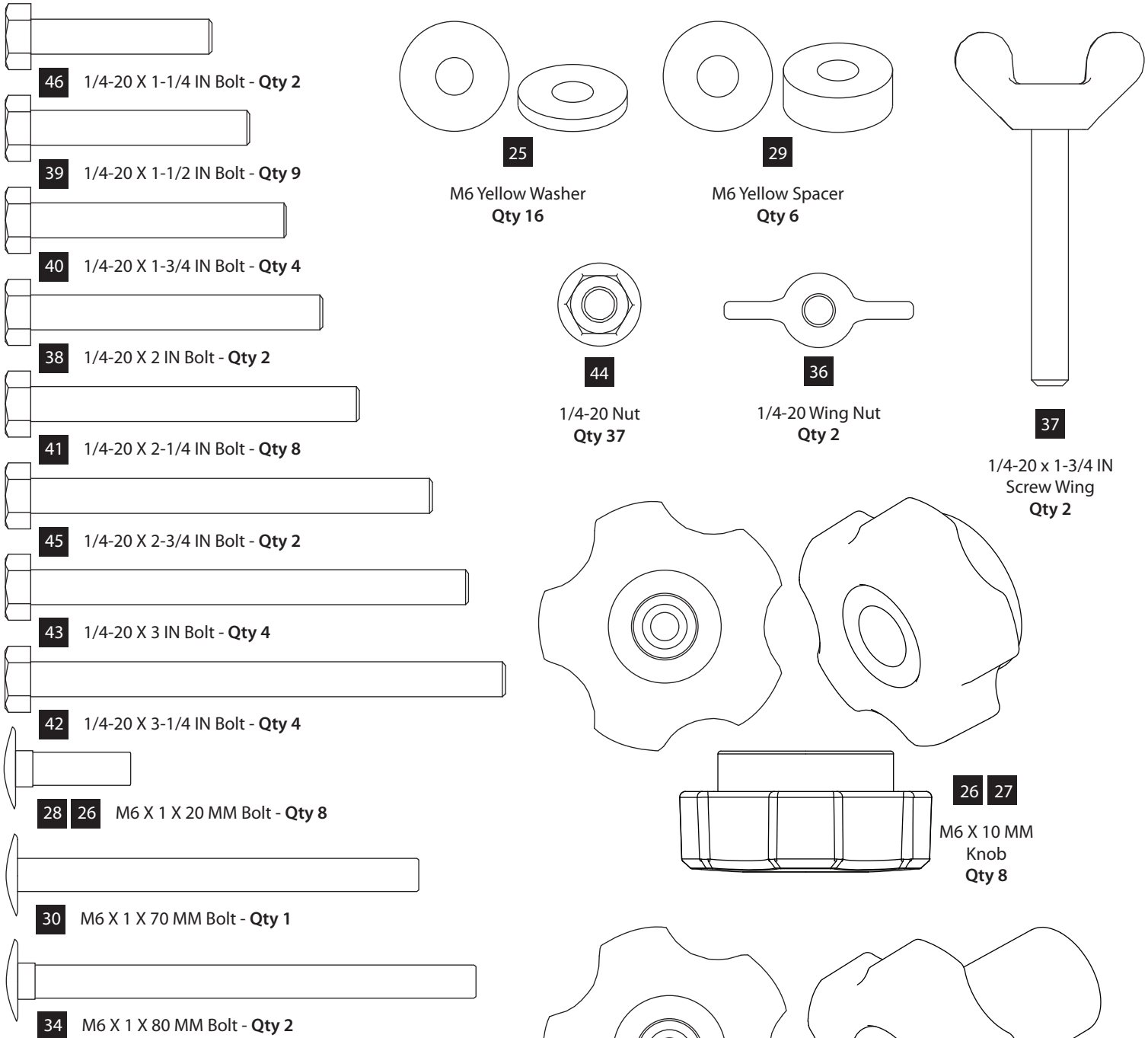
### BEFORE EACH USE PERFORM THE FOLLOWING:

- Inspect all webbing, rope, cord, and strap assemblies for wear or damage.
- Inspect cables and/or cable ends for damage or kinking.
- Inspect all hardware and chain components for damage or wear.
- Inspect for any structural damage to product. (If any exists stop use immediately and call RETI Customer Service.)
- Inspect all nut and bolt assemblies to be certain none are loose.
- Inspect for any missing parts.
- Lubricate all pivot and slide together points with powder graphite, petroleum jelly or silicone spray to prevent noise, wear and rust.
- Inspect entire product for any rust, corrosion, cracks, freezing, excessive heat or rotting damage that may effect the safety of your product. Discard any questionable product.
- Inspect entire product for any structural damage - pay close attention to all weld locations. (Discard product if any damage is found.)
- Using correct wrenches inspect all nut & bolt assembly locations and snug up any that may be loose. Be careful not to crush tubing when tightening!
- Inspect and check operation of all cables, cable ends, cord, rope, webbing, and strap or chain assemblies. Replace with RETI original replacement parts any item or assembly that shows signs of wear, damage, kinking, or functions incorrectly.
- Inspect seat for damage or wear. Replace any seat with factory new that shows signs of structural damage or wear.
- Never modify your stand in any way by making repairs, replacing parts, or altering by adding or attaching anything to it except if explicitly authorized in writing by the manufacturer.

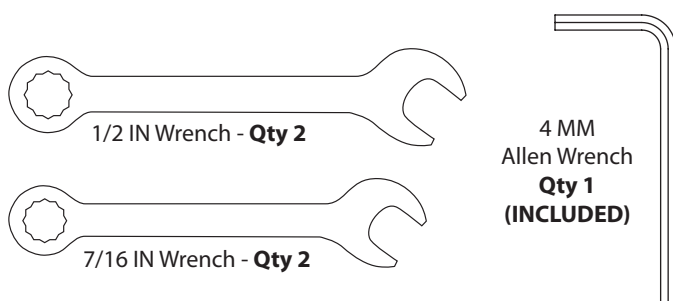
# HARDWARE IDENTIFICATION CHART

Bolts shown are for size reference.  
Extra hardware may be included in the parts bag.

**Quick Tip: Cut page out to use as a reference tool while following assembly instructions**



## TOOLS FOR ASSEMBLY (NOT TO SCALE)





## ASSEMBLY INSTRUCTIONS

### IMPORTANT ASSEMBLY TIP:

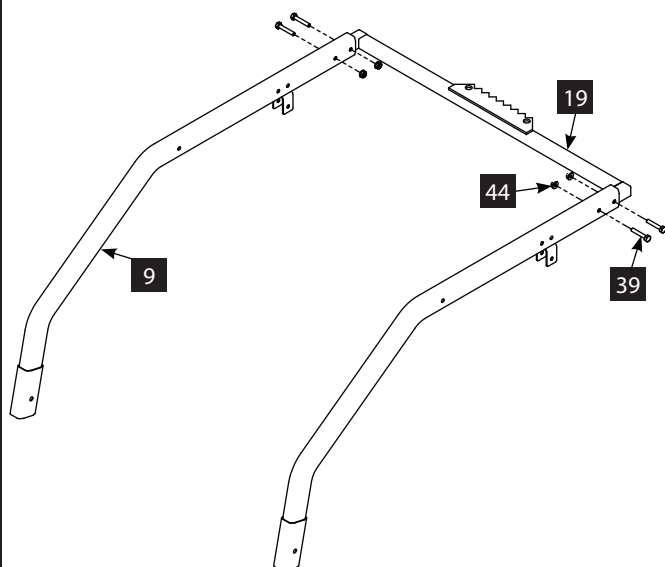
Do not tighten any nut and bolt combinations completely until all parts are assembled together! Finger tighten plus one turn of a wrench only! This will temporarily hold the lock-nut on the bolt while helping alignment of all parts! After all parts are assembled together, all nut and bolt combinations must be completely tightened.

**All assembly must be done in this order at ground level before uprighting.**

**Do not remove labels/warnings from product, they are there for your safety.**

**Recommended for adult use only.**

FIGURE 1



**NOTE: When selecting a tree to install the treestand in, never use a treestand on a dead leaning, diseased or loose barked tree, or a utility pole. Always avoid electrical power lines.**

1. Assemble the top tree blade (19) to the two seat side rails (9) using four 1/4-20 x 1-1/2 IN bolts (39) and four 1/4-20 IN nuts (44). **SEE FIGURE 1**

2. Attach the left armrest (11) and right armrest (12) to the outer edge of the seat rails (9) using two 1/4-20 x 3-1/4 IN bolts (42), two yellow washers (25) and two 1/4-20 IN nuts (44) for each armrest. **SEE FIGURE 2**

**NOTE: To verify that you have the correct armrests attached to the seat rails, the slotted plates on the armrest should be outward facing in orientation.**

**NOTE: It is important to follow the placement of all hardware. Bolts should always be facing outwards (away from the user) when being used in a location where clothing can be easily caught on.**

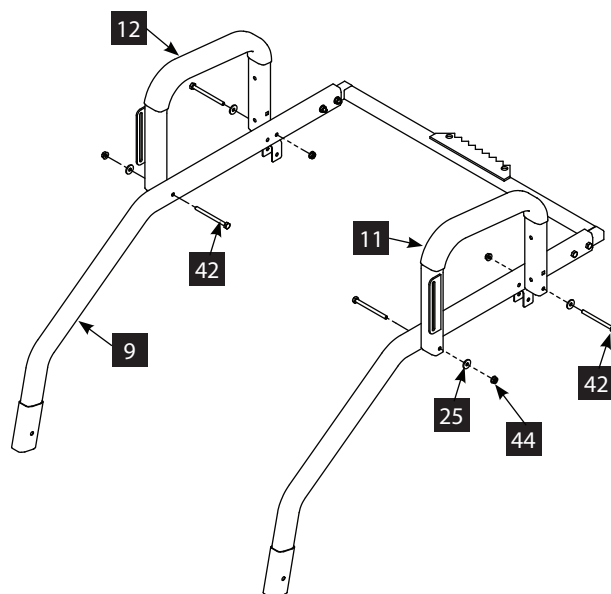
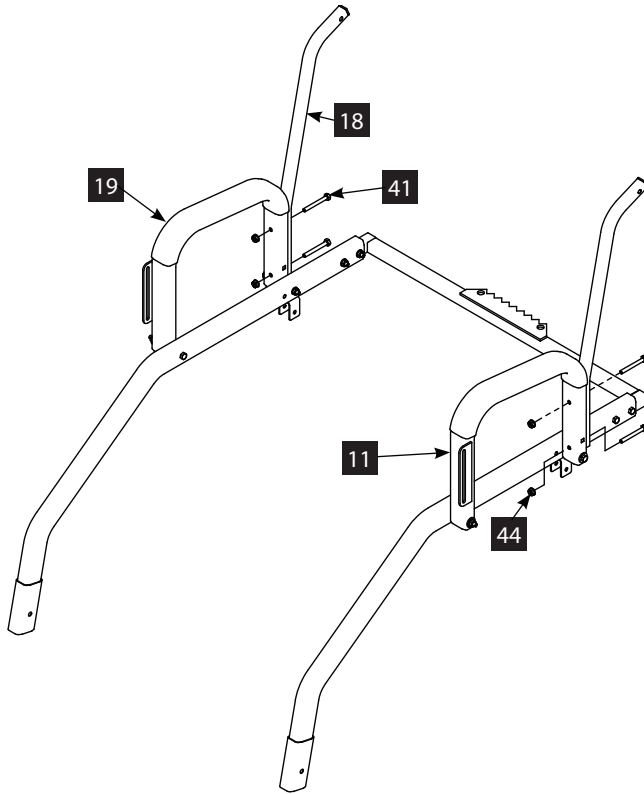


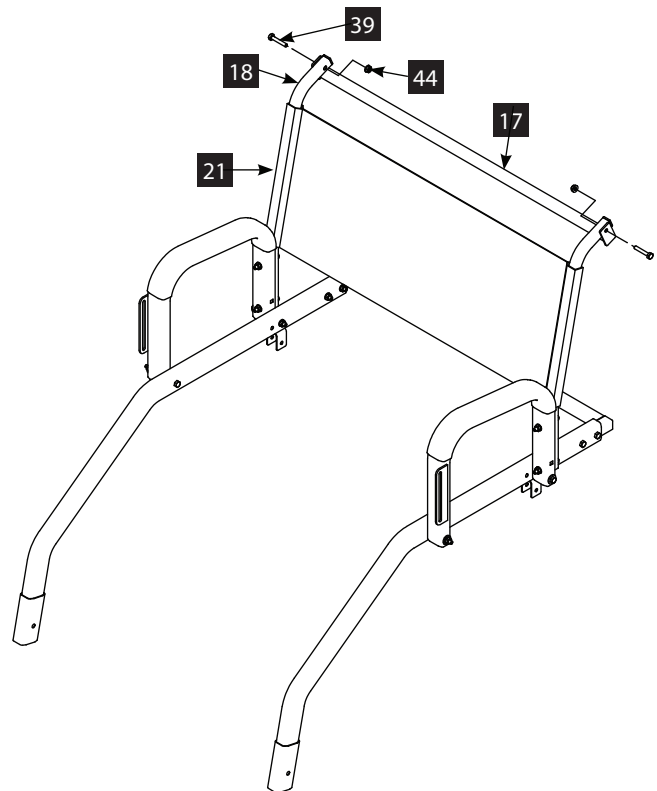
FIGURE 2

**FIGURE 3**



3. Attach one backrest (18) to the back of each armrest (11, 12) using two 1/4-20 x 2-1/4 IN bolts (41) and two 1/4-20 IN nuts (44) for each assembly. **SEE FIGURE 3**

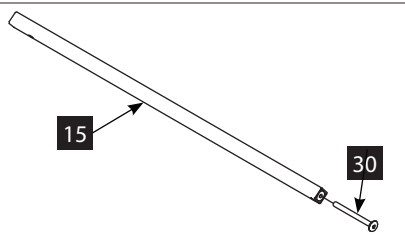
4. Slide the TearTuff backrest (21) over each of the secured backrests (18). After this has been completed, assemble the back rest spreader (17) with one 1/4-20 x 1-1/2 IN bolt (39) and one 1/4-20 IN nut (44) on each end. **SEE FIGURE 4**



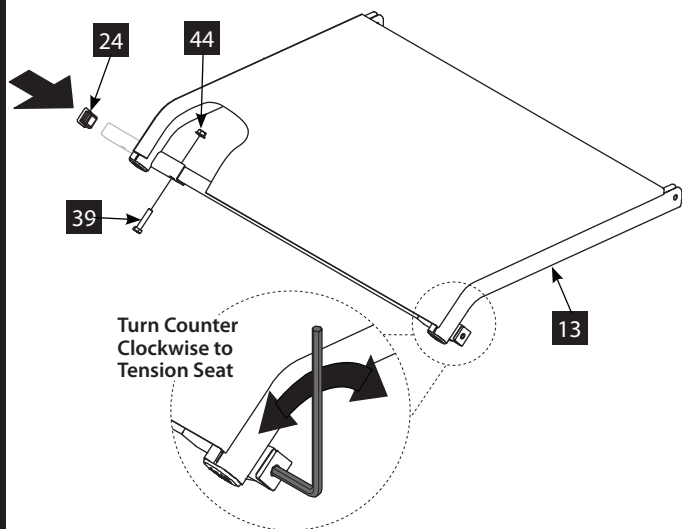
**FIGURE 4**



**FIGURE 5A**



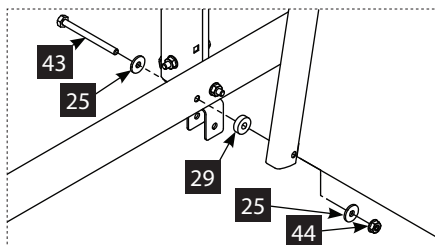
**FIGURE 5**



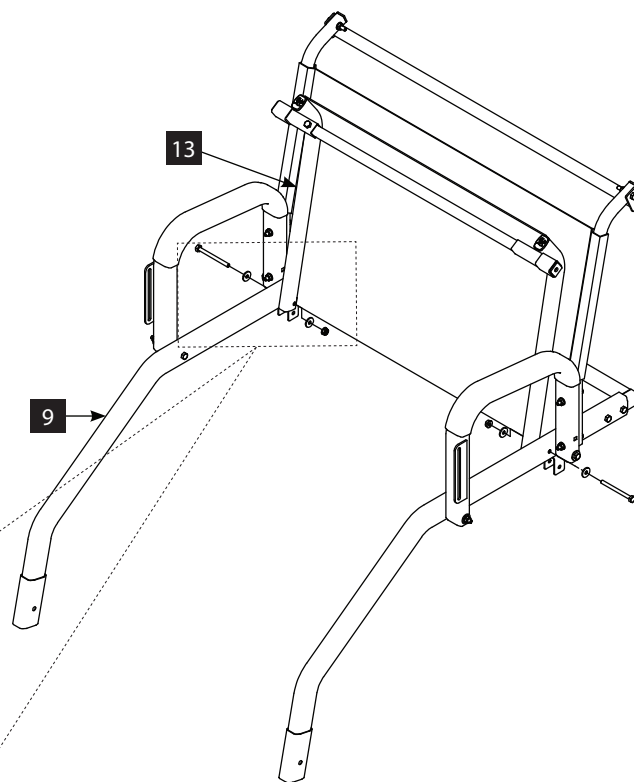
5. Screw the M6 x 70 MM bolt (30) into the opposite end of the front seat tensioner (15) until snug.  
**SEE FIGURE 5A**
6. Slide the front seat tensioner (15) assembly from figure 5A through the open tube mount on the lower front edge of the seat assembly (13) such that the bolt end of the front seat tensioner bumps up against the closed end of the other tube mount. Make sure the bolt holes line up in the open tube mount.  
**SEE FIGURE 5**
7. Secure the front seat tensioner (15) to the open tube mount of the seat assembly (13) using a 1/4-20 x 1-1/2 IN bolt (39) and a 1/4-20 nut (44). Push a 22 MM square end plug (24) into the outside of the open tube mount. **SEE FIGURE 5**
8. Using the provided 4 MM allen wrench, rotate the M6 x 70 MM bolt (30) counter-clockwise, through the cap hole, to create tension in the TearTuff seat (13). Do not over tension the seat because it could cause the seat tensioner (15) to bow and the bolt (30) to strip. **SEE FIGURE 5**

9. With the TearTuff seat assembled, secure the back of the seat assembly (13) to each of the seat side supports (9), using a 1/4-20 x 3 IN (43) bolt, two yellow plastic washers (25), a plastic spacer (29) and one 1/4-20 nut (44). **SEE FIGURE 6 AND FIGURE 6A**

**NOTE:** The order of the hardware is necessary to allow for the seat to properly function.

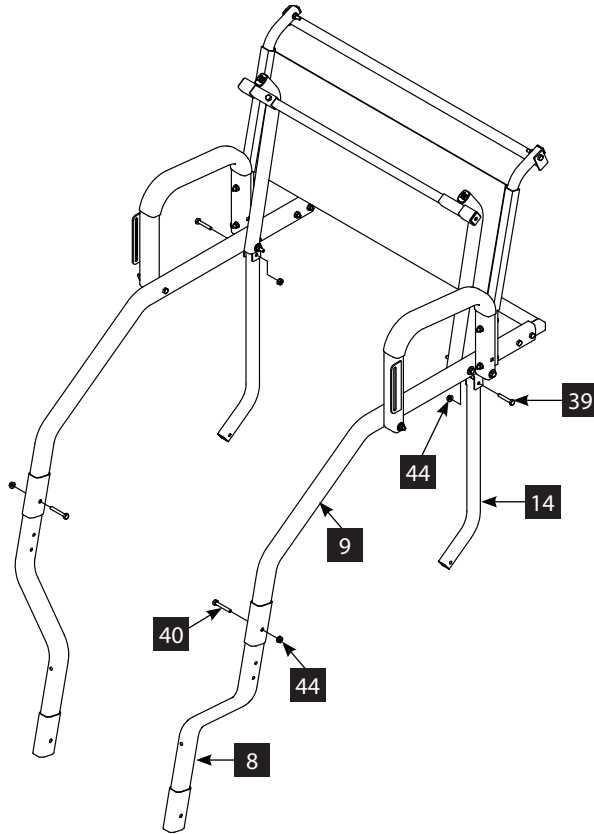


**FIGURE 6A**



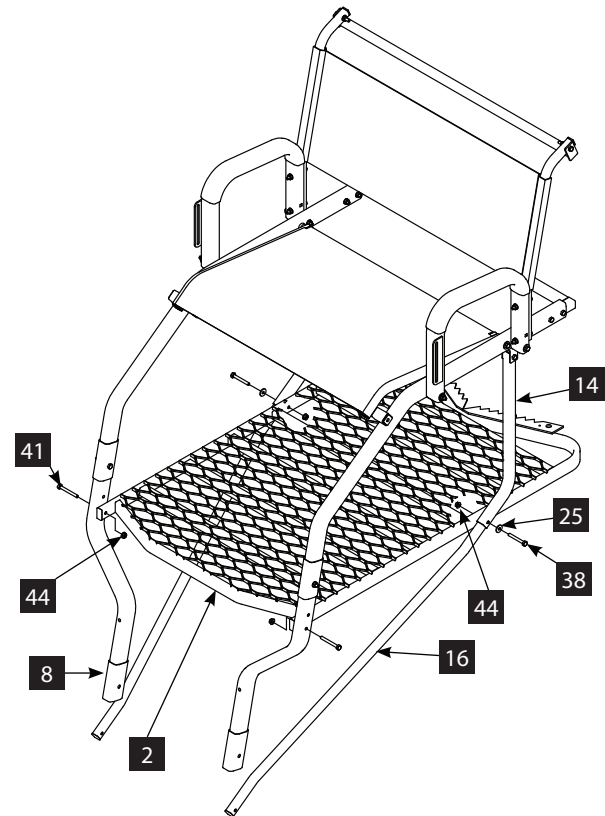
**FIGURE 6**

**FIGURE 7**

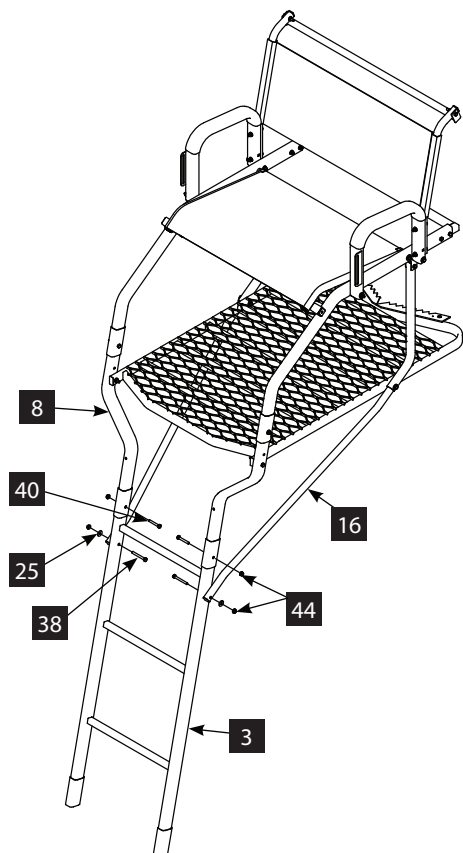


10. Take the rear seat supports (14) and attach them to the correct bracket on each seat side rail (9) using one 1/4-20 x 1-1/2 IN (39) and a 1/4-20 nut (44). **SEE FIGURE 7**
11. Attach the platform rails (8) to the lower end of each seat side rail (9) using a 1/4-20 x 1-3/4 IN bolt (40) and a 1/4-20 nut (44) for each side. **SEE FIGURE 7**

12. Attach the foot platform (2) in the front two corners to the platform rails (8) using a 1/4-20 x 2-1/4 IN bolt (41) and a 1/4-20 nut (44) for each side. **SEE FIGURE 8**
13. Locate the rear seat support (14) and align it with the hole in the end of the platform brace (16) and attach it to the outer edge of the foot platform (2) by aligning the holes in all three items. Secure with a 1/4-20 x 2 IN bolt (38), a yellow washer (25) and a 1/4-20 nut (44). **SEE FIGURE 8**



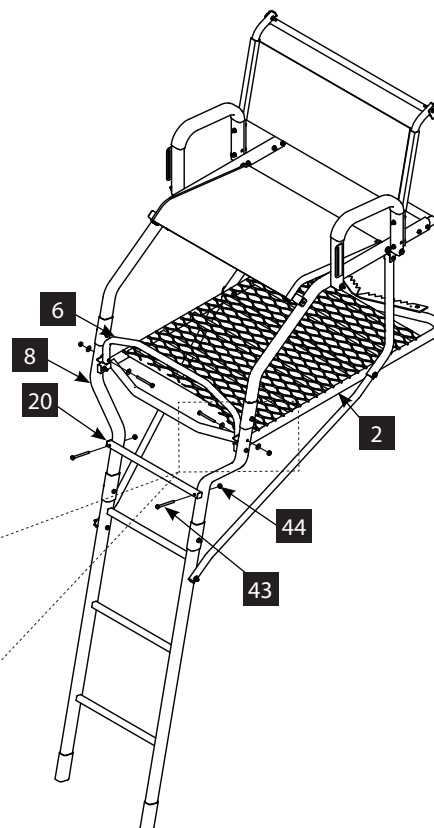
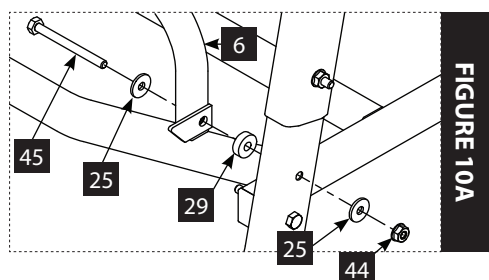
**FIGURE 8**

**FIGURE 9**


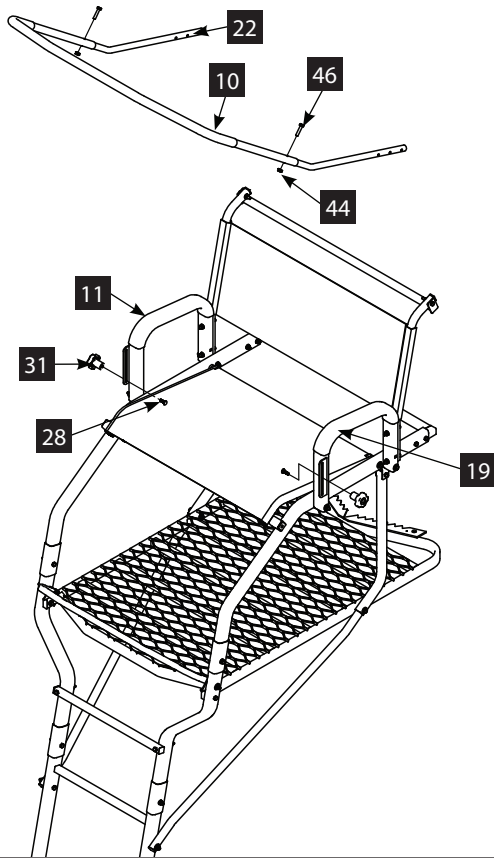
14. Connect the first ladder section (3) to the platform rails (8) with a 1/4-20 x 1-3/4 IN bolt (40) and a 1/4-20 nut (44) on each side of the ladder. Once connected, attach the free end of the platform braces (16) to the outer edge of the ladder section (3) with a 1/4-20 x 2-1/4 IN bolt (38), one yellow washer (25) and a 1/4-20 nut (44) on each side. **SEE FIGURE 9**

15. Attach the top ladder step (20) to the platform rails (8) with two 1/4-20 x 3 IN bolts (43) and two 1/4-20 nuts (44). **SEE FIGURE 10**
16. The footrest (6) is secured to the platform rails (8) using two 1/4-20 x 2-3/4 IN bolts (45), four yellow washers (25), two yellow spacers (29) and two 1/4-20 nuts (44). **SEE FIGURE 10 AND FIGURE 10A**

**NOTE:** The order of the hardware is necessary to allow for the seat to properly function.


**FIGURE 10**

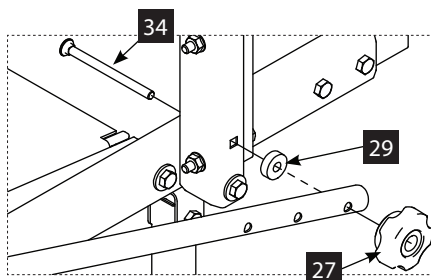
**FIGURE 11**



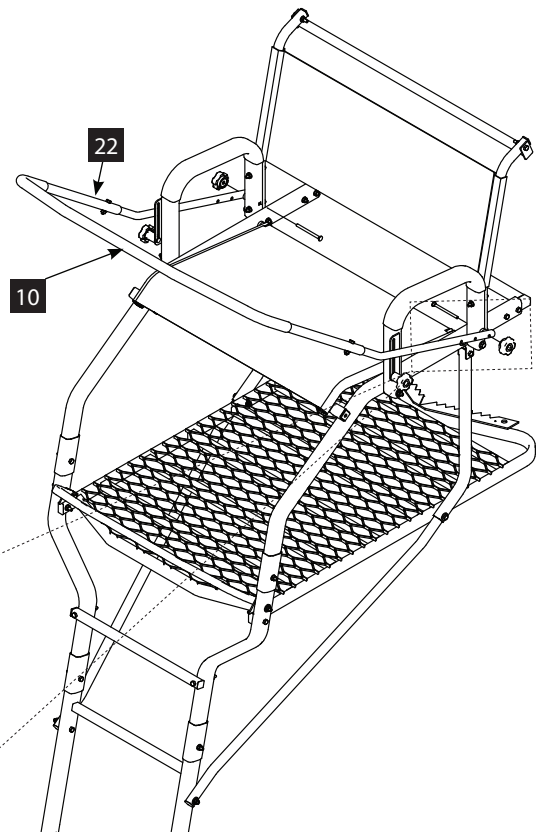
17. Assemble the adjustable shooting rail knobs (31) and bolts (28) to the armrests (11, 12) in the slots provided. To assemble the shooting rest, connect the shooting rail (10) over the ends of both the shooting rail braces (22) and secure using two 1/4-20 x 1-1/4 IN bolts (46) and two 1/4-20 nuts (44). **SEE FIGURE 11**

18. The shooting rail assembly connects to the armrest as shown in Figure 12. Use the two M6 x 80 MM bolts (34), two yellow spacers (29) and two shooting rail knobs (27) to connect the two components together. **SEE FIGURE 12 AND 12A**

**NOTE:** The shooting rail is designed to have multiple configurations. Adjustments can be made to the height by loosening the knob in the slotted-plate on the armrests, and moving it either upwards or downward until desired height is achieved. Once location has been reached re-tighten the knob to create a firm seat of the shooting rail to rest on. To move the shooting rail closer to you or further away, use the three holes drilled into the end of the shooting rail and place the knob location at the desired setting.

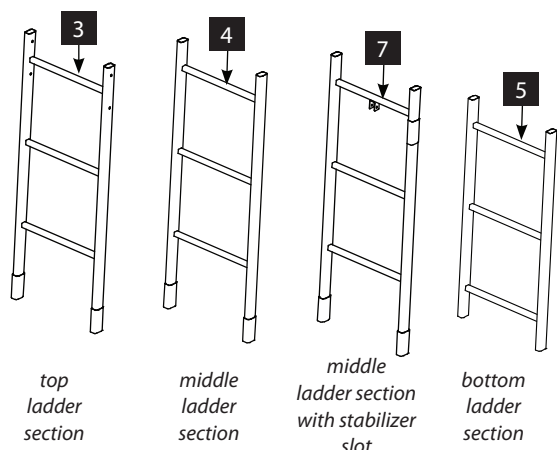


**FIGURE 12A**

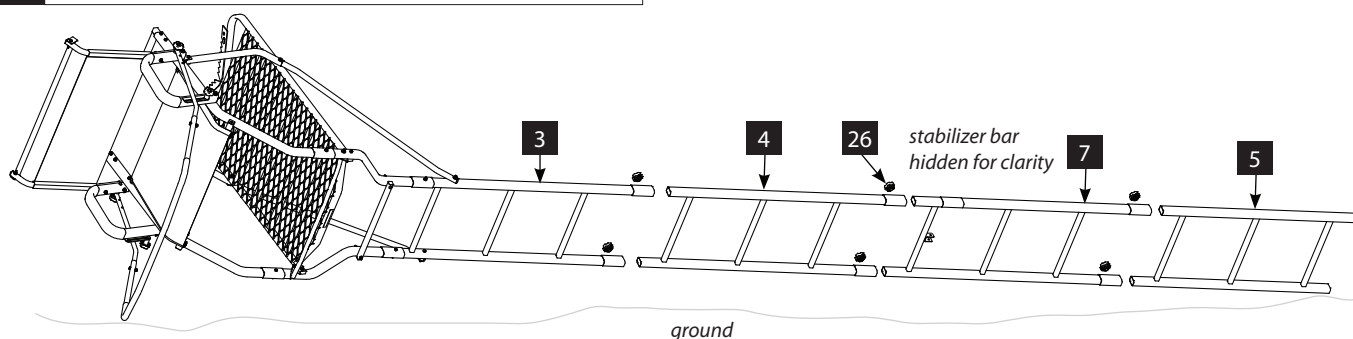


**FIGURE 12**

**FIGURE 13A**



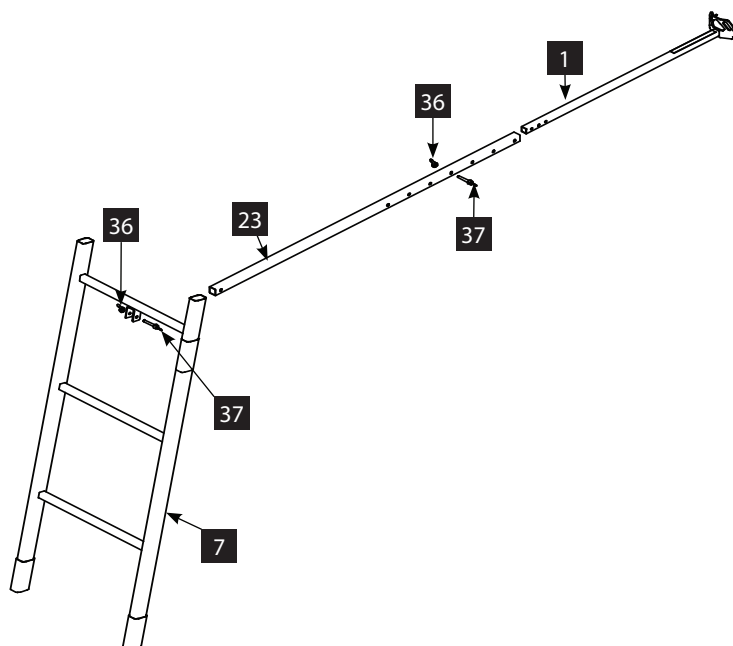
19. Ladder sections are assembled on the ground in the following order: bottom ladder section (5), middle ladder section with stabilizer slot (7), middle ladder section (4), and the top ladder section (3) with the treestand top assembly. Connect all sections together using the six silent knob assemblies (26). **SEE FIGURES 13 AND 13A**



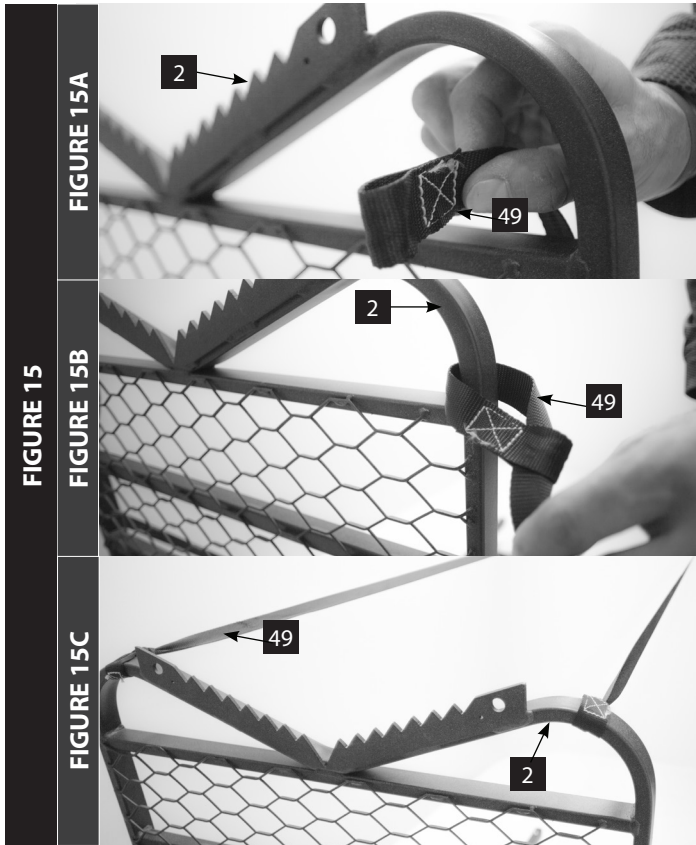
20. Slide the stabilizer bar (1) into the stabilizer support tube (23) and secure using a 1/4-20 x 1-3/4 IN wing screw (37) and a wing nut (36). Make sure the screw passes through the support tube and the stabilizer bar at the appropriate hole to achieve the desired distance from the tree. Adjustment in length may be needed when ladder is uprighted later in the Setup and Use Instructions.

21. Connect the stabilizer bar assembly (1) through the middle ladder section with stabilizer slot (7). These components will be connected using a 1/4-20 x 1-3/4 IN wing screw (37) and one wing nut (36). **SEE FIGURE 14**

**NOTE: Treestand should ALWAYS be fully assembled on the ground prior to mounting it in the tree.**



**FIGURE 14**



#### LONG CRISS-CROSS RATCHET STRAPS (49)

22. Attach the two long straps of the criss-cross ratchet straps (49) to the rear of the foot platform (2) near the lower tree blade.

a. Wrap sewn loop of each strap around each side of the platform and feed the loose end through the sewn loop. **SEE FIGURES 15A AND 15B**

b. Pull tight, forming a cinch knot. This permanently attaches the long straps to the platform. **SEE FIGURES 15B AND 15C**

**NOTE:** The ratchet portion of the long straps will be used later during Setup and Use Instructions.

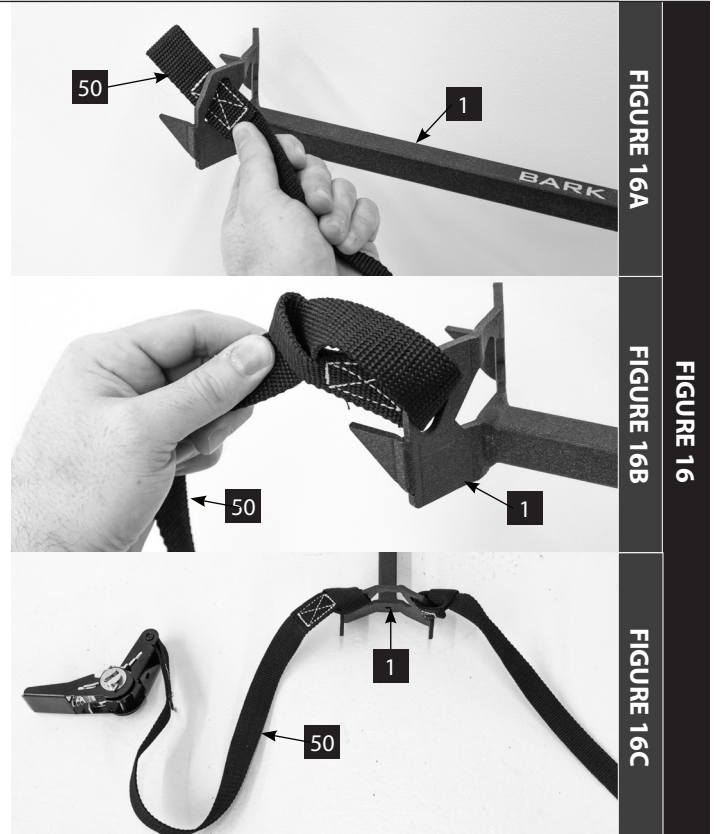
#### STABILIZER BAR RATCHET STRAP (50)

23. Attach the straps of the stabilizer bar ratchet assembly (50) to the stabilizer bar bark biting plate, which is part of the stabilizer bar (1).
- Feed the sewn loop of the long strap through either side slot in the bark biting plate and then feed the loose end through the sewn loop. **SEE FIGURES 16A AND 16B**
  - Pull tight, forming a cinch knot. This permanently attaches the long strap to the stabilizer bar. **SEE FIGURES 16B AND 16C**
  - Feed the sewn loop of the ratchet buckle strap through the opposite side slot in the bark biting plate and then feed the ratchet buckle through the sewn loop.
  - Pull tight, forming a cinch knot. This permanently attaches the ratchet buckle strap to the stabilizer bar. **SEE FIGURE 16C.**

#### LARGE RATCHET STRAPS (48)

The large ratchet straps (48) that secure the platform and tree blades to the tree will be used later during the Setup and Use Instructions, after uprighting the stand.

**NOTE:** Make sure to bring ratchet straps up with you in a pocket. Never carry in your hands!





STOP

## READ AND UNDERSTAND THE FOLLOWING WARNINGS BEFORE SETUP AND USE

### WARNING

- ▲ Double check assembly steps to be certain you have correctly assembled this product.
- ▲ Study your new stand to become familiar with all of its features and design. At ground level, following provided use instructions, practice attaching stand to tree and removing stand from tree. Practice sitting, standing, and using this product before attaching overhead. Save these instructions for future reference. You must always use the provided Fall Arrest System (FAS) while using this product.
- ▲ **Always** use at least three (3) people to install or take down a ladder treestand. **Always** have two people stabilize the ladder before climbing to the platform the first time after every set-up.
- ▲ Be absolutely sure the tree blade(s) on stand and the stabilizer bar are contacting tree before climbing ladder.
- ▲ Stabilizer bar must always be correctly and securely attached to ladder and tree before climbing ladder.
- ▲ Make sure ladder bottom is firmly seated on dry, level ground. Attach your harness tether to the tree before securing the platform to the tree and stepping onto platform. Refer to the Full Body Harness instructions.
- ▲ **Never** ascend or descend ladder without criss-cross straps/ropes securely holding ladder to tree and stabilizer bar securely attached. Failure to correctly perform these steps can cause the ladder to collapse/buckle-over backwards during the initial ascent to attach ratchet strap resulting in serious injury or death.
- ▲ **Always** lean forward as you climb and attach your harness to the tree before securing the platform to the tree and stepping onto the platform.

### WARNING

- ▲ Bring ratchet strap(s) up with you in a pocket - **Do Not** carry in your hands!

### WARNING

- ▲ **Always** maintain three (3) points of contact when climbing a ladder treestand. Proper three-point contact means having either two feet with one hand or one foot with two hands on the step portion of the ladder or climbing aid at all times.
- ▲ **Always** wear the appropriate footwear when using a ladder treestand. A good non-slip safety boot is important to your personal safety. Be especially careful that boot laces do not get hooked on the stand or any of its components (tuck shoelaces into boots before climbing).
- ▲ **Never** stand on seat, it is designed for sitting only.
- ▲ **Do Not** allow excessive strap buildup in ratchet as this will prevent the ratchet teeth from engaging causing slippage.
- ▲ **Always** attach ratchet straps securely while using this product!
- ▲ If seat is removable, be certain it is securely attached when in use.
- ▲ Some models include a shooting rail. **Never** lean against, lean over, or sit on shooting rail. It is designed as a shooting rest only. **Always** be aware that the shooting rail can swing to one side or pivot up and down.
- ▲ Some models include a footrest, which is designed as a footrest only. **Never** stand on footrest! **Always** be fully aware of foot placement.
- ▲ Some models include a multi-piece stabilizer bar system. Be sure attachment hardware goes through both the extension tube and the stabilizer bar.

## SET UP AND USE INSTRUCTIONS

*During installation and removal of ladder treestands, you must always and properly use the included Full Body Harness (Fall Arrest System). Refer to the Full Body Harness instructions included with this product for proper use.*

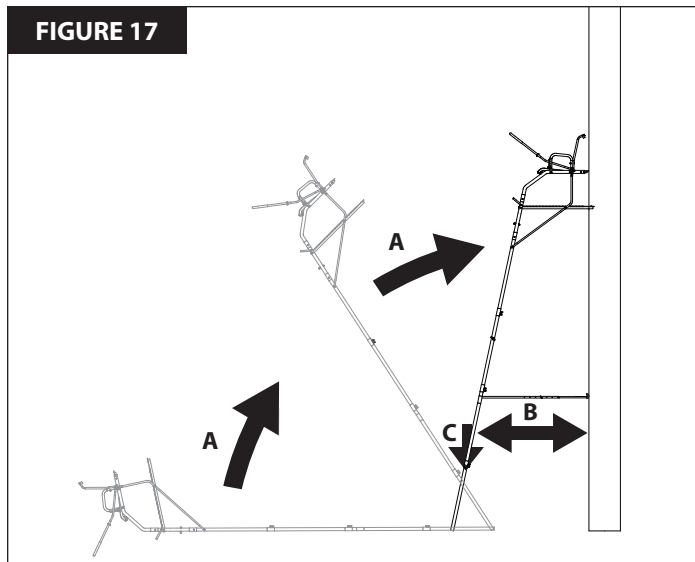
1. Select a straight, healthy tree. Do Not attempt to install on a tree that is not healthy.
2. Place the assembled product lying on the ground in front of the tree with the bottom ladder section approximately five feet away from the base of tree.
3. Position one person at bottom end of ladder. This person has to prevent the ladder end from tilting up and from skidding across the ground when platform end is lifted.
4. Position two people at the platform end of the ladder, lift the platform end and continue uprighting by walking toward bottom end of ladder while moving hands along ladder legs. **Stand ladder up against chosen tree on dry, level ground.** Use caution when ladder comes over center against the tree. **SEE FIGURE 17 (A)**
5. Once elevated completely, carefully slide the base so that the sitting and standing platforms are parallel to the ground. **SEE FIGURE 17 (B)**
6. Step back and look at the ladder top to see that both the lower platform tree blade and upper tree blade are contacting the tree. Adjust as needed so both of the tree blades are contacting tree.
7. Step down hard on bottom step to push ladder legs into the ground. **SEE FIGURE 17 (C)**
8. Adjust length of stabilizer bar assembly so the bark biting teeth of the stabilizer bar contact the tree. Stabilizer bar should be parallel to the ground. Do Not bow ladder in or out to achieve contact with the tree. Maintain tree blade contact.
9. With the stabilizer bar ratchet strap (50) now in hand, wrap the strap around the tree and feed the long strap through the center slot of ratcheting mechanism. Pull tail of long strap until most of the slack is taken out and ratchet tight so the teeth of the stabilizer bar dig into the tree. **SEE FIGURES 18A, 18B, 18C AND 19**

**NOTE: Be sure to feed the long strap correctly so there are no twists in the strap.**

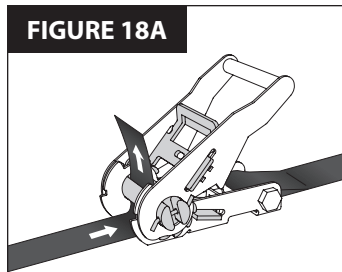
### **WARNING**

- ▲ **Never** use a treestand on a dead, leaning, diseased or loose barked tree, or a utility pole. **Always** avoid electrical power lines.
- ▲ Bring ratchet strap(s) up with you in a pocket - **Do Not** carry in your hands!

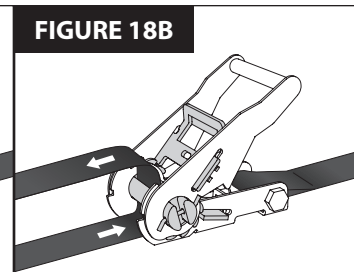
**FIGURE 17**



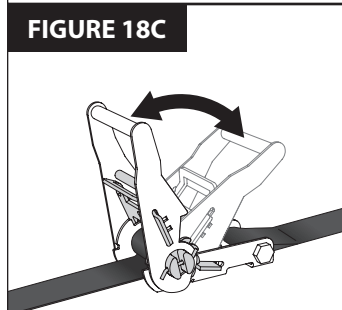
**FIGURE 18A**



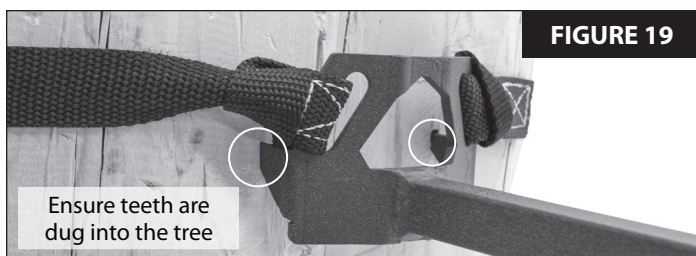
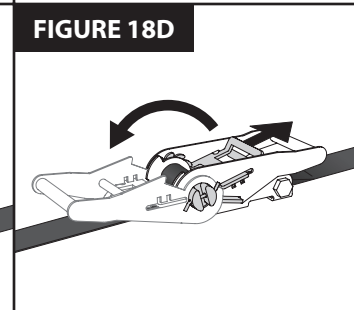
**FIGURE 18B**



**FIGURE 18C**



**FIGURE 18D**



**FIGURE 19**

Ensure teeth are dug into the tree



10. Locate the two ratchet portions with S-hooks for the criss-cross straps (49).
  - a. With one ratchet portion of the criss-cross strap (49) now in hand, feed one long strap hanging down from platform through the center slot of ratcheting mechanism and back around through tightening lever. **SEE FIGURES 18A AND 18B**
  - b. While maintaining contact between long criss-cross strap and the tree surface, wrap entire ratchet strap assembly around back side of tree and hook S-hook to the middle opening of stabilizer bar bark biting plate. **SEE FIGURE 20A**
  - c. Pull the tail of the long strap until most of the slack is taken out. Be sure entire strap is evenly wrapped around tree and ratchet tight to tree. This will securely attach the first of two long ratchet straps to tree. **SEE FIGURES 18B AND 18C**
  - d. Repeat for attachment of the second criss-cross strap. **SEE FIGURES 20B AND 21**

**NOTE: It is extremely critical that the criss-cross ratchet straps are attached to the stabilizer bar bark biting plate in opposite directions of each other forming a "criss-cross" behind the tree. This ground level ladder-to-tree attachment will prevent the ladder from pulling away from the tree while ascending to the top for final ratchet strap attachment. The same holds true when ladder removal is necessary. SEE FIGURE 21**

#### LARGE RATCHET STRAPS (48)

10. With two people securely holding the base of the ladder, use the three point contact climbing method to slowly climb the ladder and carefully keep a constant hand grip on the ladder at all times. Always lean forward, towards the tree, to keep tree blades against the tree. **Be certain ladder bottom is firmly seated on dry, level ground. Attach your harness tether to the tree before securing the platform to the tree and stepping onto platform. Refer to the Full Body Harness instructions included with this product.**

**NOTE: Bring large ratchet straps up with you in a pocket. DO NOT carry in your hands!**

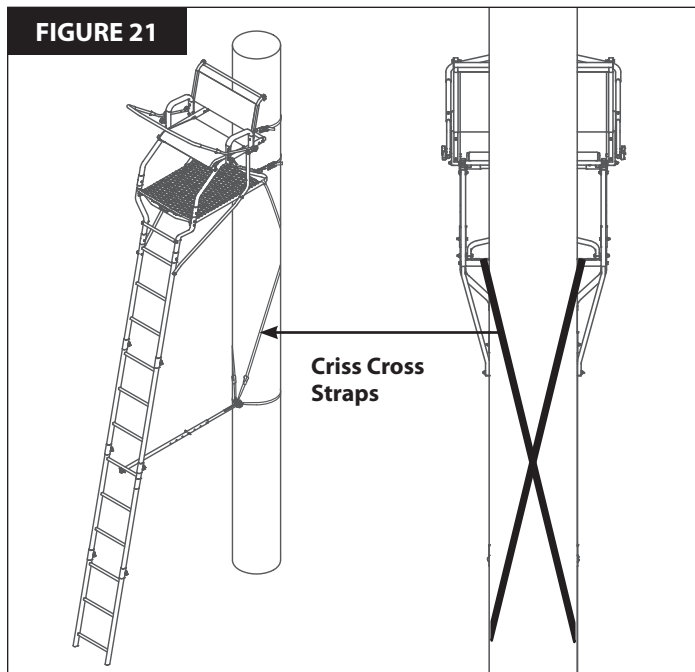
11. Once platform is reached, hook S-hook with long strap through hole provided in upper tree blade frame. Feed the long strap through the center slot of ratcheting mechanism and back around through tightening lever. **SEE FIGURES 18A, 18B AND 22**
12. Wrap the ratchet assembly around the tree and hook other S-hook through opposite tree blade hole. Pull tail of long strap until most of the slack is taken out. Be sure entire strap is even and at the same level all around tree. "Ratchet" tight to tree. This will securely attach only the seat portion to the tree and prevent movement. **SEE FIGURES 18C AND 22**

**NOTE: To release ratchet, simply pull the release lever and open tightening lever wide open (flat). SEE FIGURE 18D**

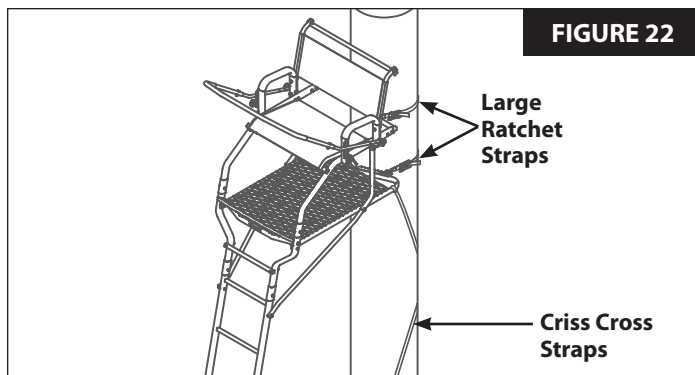
13. Repeat previous two steps for the platform tree blade attachment. Place S-hook through holes provided on bottom tree blade.
14. You are now ready to use your ladder stand!



**FIGURE 21**



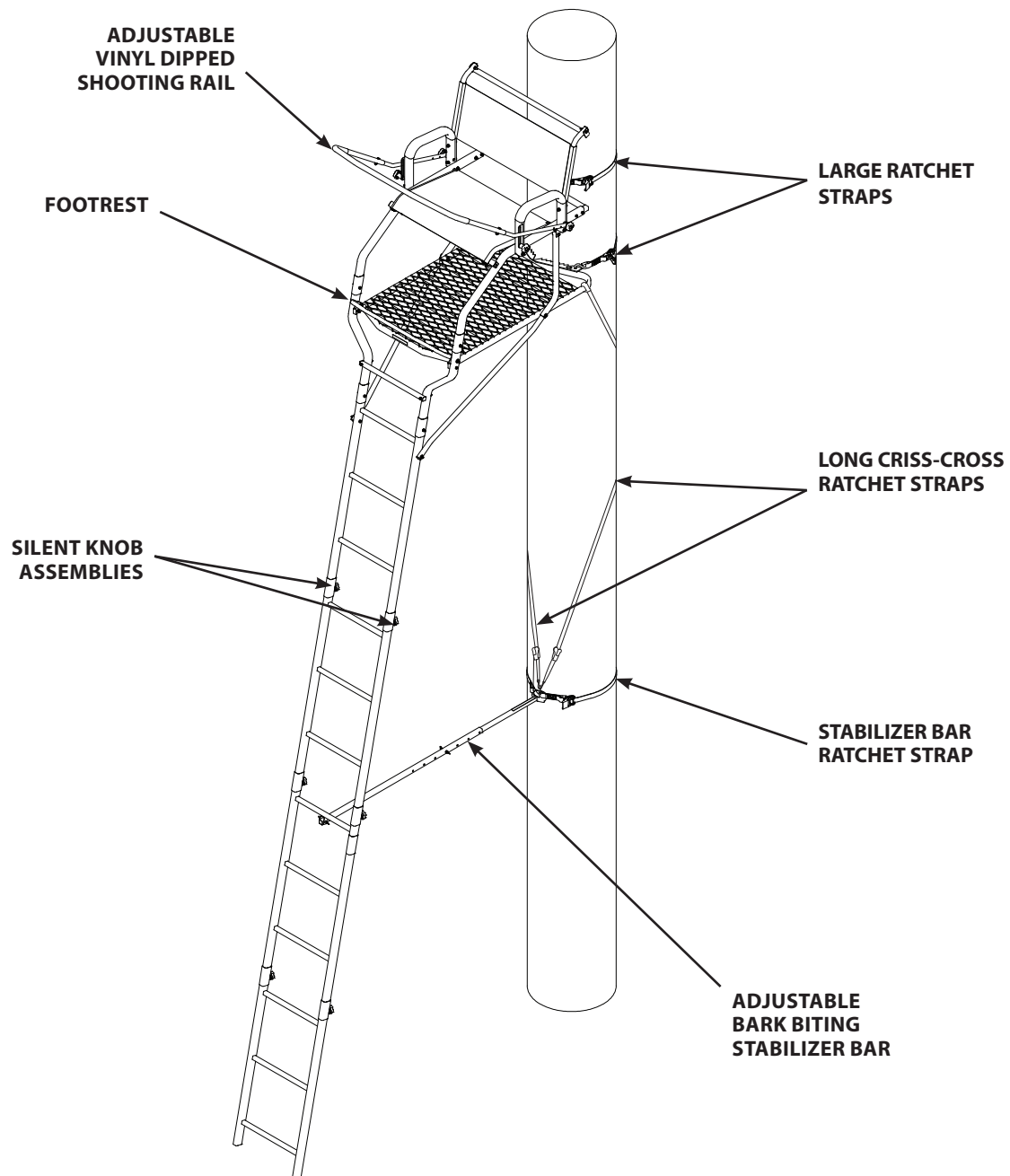
**FIGURE 22**



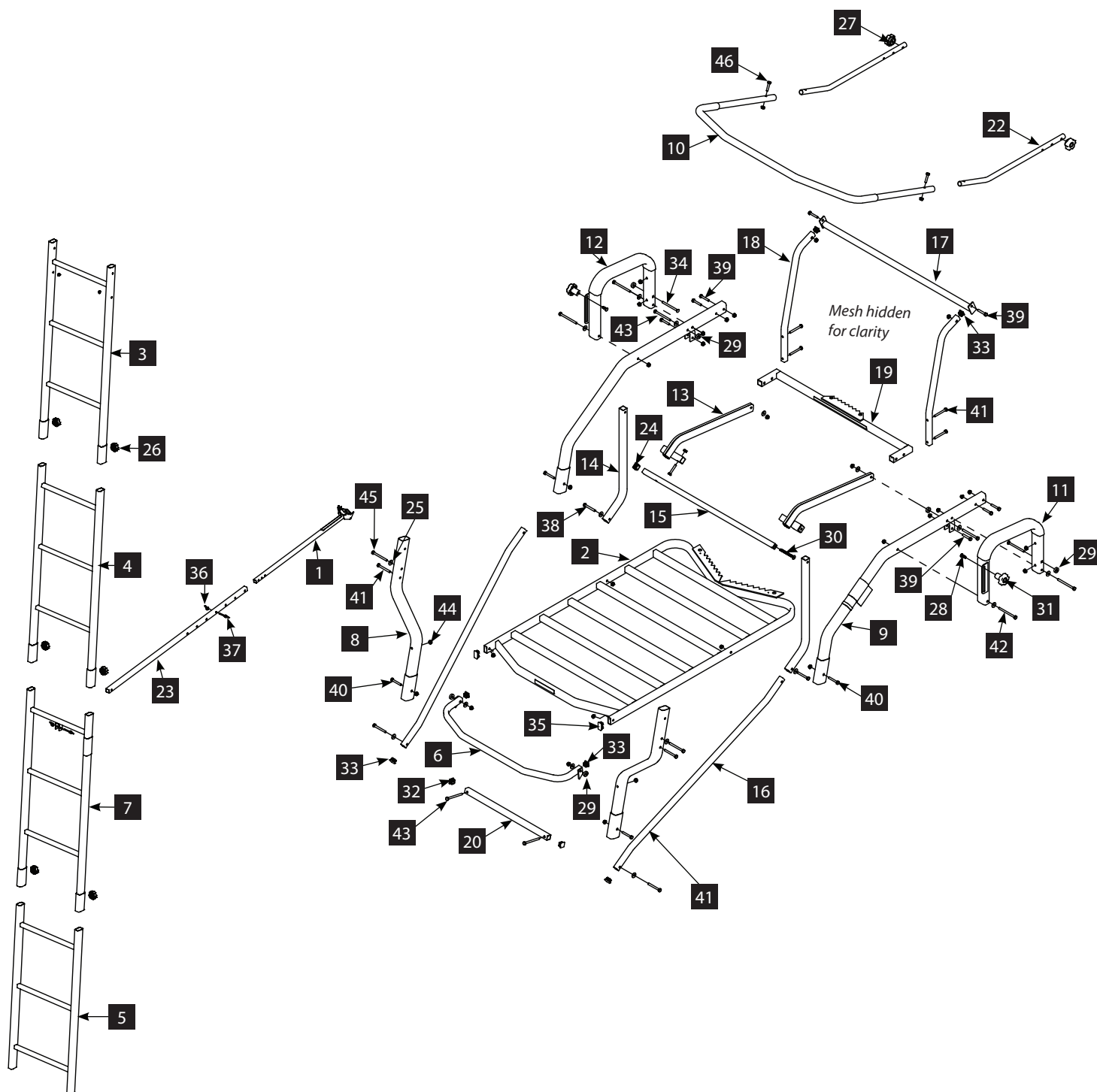
#### IMPORTANT

- ▲ Reverse the Set-Up and Use Instructions to take the ladder stand down.

## FINISHED LADDER



## ILLUSTRATED PARTS BREAKDOWN



## PARTS LIST

| ITEM # | PART # | DESCRIPTION                                | QTY. |
|--------|--------|--|------|
| 1      | 23775  | STABILIZER BAR 27 IN                       | 1    |
| 2      | 29319  | FOOT PLATFORM                              | 1    |
| 3      | 29322  | TOP LADDER SECTION                         | 1    |
| 4      | 29324  | MIDDLE LADDER SECTION                      | 1    |
| 5      | 29326  | BOTTOM LADDER SECTION                      | 1    |
| 6      | 29328  | FOOTREST                                   | 1    |
| 7      | 29348  | MIDDLE LADDER SECTION WITH STABILIZER SLOT | 1    |
| 8      | 29350  | PLATFORM RAIL                              | 2    |
| 9      | 29352  | SEAT SIDE RAIL                             | 2    |
| 10     | 29354  | SHOOTING RAIL                              | 1    |
| 11     | 29355  | ARMREST LEFT                               | 1    |
| 12     | 29356  | ARMREST RIGHT                              | 1    |
| 13     | 29359  | TEAR TUFF SEAT                             | 1    |
| 14     | 29361  | REAR SEAT SUPPORT                          | 2    |
| 15     | 29365  | FRONT SEAT TENSIONER                       | 1    |
| 16     | 29374  | PLATFORM BRACE                             | 2    |
| 17     | 29375  | BACKREST SPREADER                          | 1    |
| 18     | 29378  | BACKREST                                   | 2    |
| 19     | 29379  | TOP TREE BLADE                             | 1    |
| 20     | 29582  | TOP LADDER STEP                            | 1    |
| 21     | 29648  | TEAR TUFF BACKREST                         | 1    |
| 22     | 30307  | SHOOTING RAIL BRACE                        | 2    |
| 23     | 48053  | STABILIZER SUPPORT BAR                     | 1    |
| 24     | 23439  | PLUG SQ END 22 MM                          | 1    |
| 25     | 23572  | YELLOW WASHER M6                           | 16   |
| 26     | 23603  | KNOB SILENT LADDER                         | 6    |
| 27     | 23604  | KNOB M6 X 10 MM                            | 2    |
| 28     | 26813  | BOLT M6 X 1 X 20 MM                        | 2    |
| 29     | 26913  | YELLOW SPACER M6                           | 6    |

**NO EXTENSIONS AVAILABLE FOR THIS MODEL.  
NEVER MODIFY OR EXCEED ORIGINAL STATED USE HEIGHT!**

| ITEM #                           | PART # | DESCRIPTION                         | QTY. |
|----------------------------------|--------|-------------------------------------|------|
| 30                               | 26959  | BOLT M6 X 1 X 70 MM                 | 1    |
| 31                               | 28839  | KNOB M6 X 29 MM                     | 2    |
| 32                               | 29713  | PLUG SQ END 19 MM                   | 2    |
| 33                               | 29714  | PLUG SQ END 18MM                    | 6    |
| 34                               | 29728  | BOLT M6 X 1 X 80 MM                 | 2    |
| 35                               | 29738  | PLUG SQ END 30 MM                   | 2    |
| 36                               | 48042B | WING NUT 1/4-20                     | 2    |
| 37                               | 48044B | SCREW WING 1/4-20 X 1-3/4 IN        | 2    |
| 38                               | 48153B | BOLT 1/4-20 X 2 IN                  | 2    |
| 39                               | 48240B | BOLT 1/4-20 X 1-1/2 IN              | 9    |
| 40                               | 48250B | BOLT 1/4-20 X 1-3/4 IN              | 4    |
| 41                               | 48271B | BOLT 1/4-20 X 2-1/4 IN              | 8    |
| 42                               | 48273B | BOLT 1/4-20 X 3-1/4 IN              | 4    |
| 43                               | 48280B | BOLT 1/4-20 X 3 IN                  | 4    |
| 44                               | 48752B | NUT 1/4-20                          | 37   |
| 45                               | 67540B | BOLT 1/4-20 X 2-3/4 IN              | 2    |
| 46                               | 8909B  | BOLT 1/4-20 X 1-1/4 IN              | 2    |
| <b>ITEMS BELOW ARE NOT SHOWN</b> |        |                                     |      |
| 47                               | 10531  | SAFETY HARNESS / FALL ARREST SYSTEM | 1    |
| 48                               | 23610  | STRAP 1-1/2 IN W/ RATCHET & S HOOKS | 2    |
| 49                               | 15034  | STRAP RATCHET CRISS CROSS           | 2    |
| 50                               | 11058  | STRAP RATCHET STABILIZER BAR        | 1    |
| 51                               | 48800  | TREE STAND SAFETY DVD               | 1    |
| 52                               | 29742  | HARDWARE BAG - BOLTS                | 1    |
| 53                               | 29743  | HARDWARE BAG - NUTS AND WASHERS     | 1    |
| 54                               | 23622  | HARDWARE BAG - SILENT POCKETS       | 1    |
| 55                               | 27477  | ALLEN WRENCH 4 MM                   | 1    |

**NOTES:**

This image shows a single sheet of white paper with horizontal ruling lines. The lines are evenly spaced and run across the width of the page. There are no margins, text, or other markings on the paper.

**NOTES:**

This image shows a full page of blank, lined paper. It features approximately 20 evenly spaced horizontal grey lines across its entire width, providing a guide for handwriting or typing. The paper itself is a clean, off-white color.

## OTHER GREAT PRODUCTS BY RIVERS EDGE TREESTANDS



**LANDMARK**  
 PERMANENT BLINDS

Portable ground blinds take a beating from the sun, wind, rain and snow. Colors fade, materials rot, poles break and fabric tears. The Landmark Permanent Blind was designed and constructed to resist the elements year after year. The durable steel frame is covered in marine-grade reinforced synthetic tarpaulin, made from the same rugged materials used in pick-up truck tonneau covers. The window configuration allows you to precisely control gap vertically, horizontally or both. If you're looking for an affordable year-round hunting blind with enough room for group hunts and archers, the Landmark Permanent Blind is for you.

## BigFoot™ CLIMBING AIDS



## BigFoot™ HANG-ONS



All climbing aids are not created equal. For starters, Bigfoot Climbing Aids feature extra-large rungs that a hunter can place 2 feet on the same level. Next we use a permanent anti-slip coating called Tractionite. Our assortment of climbing aids securely attach to the tree using a cam straps or ratchet straps. We take immense pride and satisfaction in knowing that our designs consistently gain praise from hunters and outfitters who recognize the little differences. A big hunt should never be ruined over a little climb!

Nothing attaches to a tree tighter than a Big Foot™ Treestand! Our line of lever-action hang-on stands bite into the tree eliminating the need for a second strap. Other treestands use small ratchet straps that are not as secure once installed. Perfect for sitting on a tree at ground level or higher up when paired with our climbing aids. Feel the stability of a Big Foot™ Treestand for yourself!

# LOCKDOWN™

## LADDER STANDS

by



**WE ARE HUNTERS**

**Rivers Edge® Treestands, Inc.**

1160 Eighth Avenue, PO Box 755  
Cumberland, WI 54829

Phone: 800-450-EDGE (3343)

Fax: 715-822-2124

[www.HuntRiversEdge.com](http://www.HuntRiversEdge.com)

\*All weights, specifications and features are approximate and are subject to change without notice. Due to continuous product improvements, product images may not be exact. Warning labels in some product images may have been removed for photography purposes only. Props shown in photos not included. Some assembly may be required.