

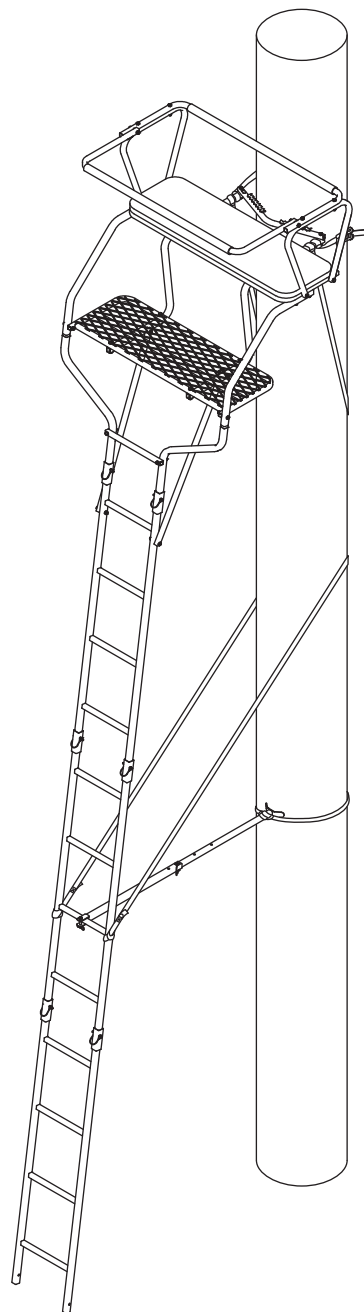

WE ARE HUNTERS



Operator's Manual

18' 2-Man Ladder Stand

MODEL RE649

Maximum Height

18' to shooting rail

Maximum Field Rating

500 lbs; no more than
300 lbs per person.

Tree Diameter Range

12" to 20"

Wear Your Harness!



PRODUCT MEETS
INDUSTRY STANDARDS
RECOGNIZED BY



PARTICIPATING MEMBER

Get parts online at
www.HuntRiversEdge.com

© 2017 RETI
All Rights Reserved

P/N: 25774
REV1: 03/09/17

INTRODUCTION

Rivers Edge® Treestands are engineered with you the hunter in mind. We appreciate your purchase of one of our world class treestands. Follow these few simple instructions and your stand will provide you many years of trouble-free pleasure. Instructions should be kept in a safe place and reviewed at least annually.

If for any reason you have a problem with your product, **DO NOT return to the retailer**, contact the Rivers Edge® customer service department at 800-450-EDGE (3343) for assistance.

CONTENTS

Introduction/Warranty	2
Warnings.....	3-4
Inspection and Maintenance	4
Hardware Identification Chart.....	5
Tools Needed	5
Assembly Instructions	6-11
Warnings.....	12
Setup and Use Instructions.....	13-14
Finished Ladder.....	15
Illustrated Parts Breakdown.....	16-17
Notes Pages.....	18-19

WARRANTY

RETI offers a one year warranty for all components of the treestand. These warranties apply to the original owner with a proof of purchase. These warranties begin on the date of purchase by the first retail consumer and continue for the period specified above. These warranties apply to products that are not modified, abused or used in a manner that deviates from the product's intended usage. Minor fading in color is normal and is not covered by warranty. Any corrosion of painted surfaces that occurs as a result of paint being removed or damaged is also not covered by warranty. RETI offers no other warranty expressed or implied. Products for which warranty work has been approved must be sent directly to RETI and performed by RETI. **To obtain warranty service and/or replacement instructions, you must obtain prior approval from RETI before shipping your package to us by calling our customer service department at 800-450-3343 or by writing to: RETI, P.O. Box 755, 1160 Eighth Avenue, Cumberland, WI 54829 for a return material authorization number (RMA#).** All items must be shipped prepaid. RETI will, at no charge, repair or replace, in RETI's sole discretion, any product that satisfies the conditions stated above. RETI retains the right to change models, specifications and price without notice.

This equipment has been manufactured under strict quality and safety guidelines. As with any equipment of this type, full understanding of the instructions and its use is mandatory and imperative for the safety of its user. RETI is not responsible for any damages or injuries sustained due to improper use or modification of any of its products, or resulting from any use which deviates from the product's intended usage. RETI is not responsible for any injuries sustained due to failure to read and adhere to the instructions for use. Any misunderstanding or questions regarding the products of their use should be directed to RETI prior to any use. **All RETI treestands are sold with a full body harness ("Fall Arrest System") that meets standards set by the Treestand Manufacturer's Association ("TMA").** It is the owner's sole responsibility to inspect the product regularly for damage, improper installation, or conditions that could jeopardize the ultimate safety of the product. Failure to use or improper use of the provided Fall Arrest System may result in serious injury or death. **ALWAYS wear the provided Fall Arrest System while using this product. Owner is responsible to understand and follow product field weight rating and must never exceed maximum weight rating.** RETI is not responsible for any malfunction or injury resulting from normal wear and tear, damage caused by improper use, improper maintenance, negligence or accidents. This product, if used safely as intended, will provide trouble free service for the useful life of the product. We hope you will enjoy the quality of our products for years to come, and have a safe hunt.

STOP

READ AND UNDERSTAND THE FOLLOWING WARNINGS BEFORE ASSEMBLY

MODEL RE649

MAXIMUM USE HEIGHT - 18' TO SHOOTING RAIL

MAXIMUM OCCUPANCY - TWO (2)

TOTAL WEIGHT LIMIT - 500 LB (300 lb Per Person Max)

TREE DIAMETER RANGE - 12" TO 20"

WARNING

- ⚠ This product carries strict height and weight restrictions. **Do Not** use this product if you exceed the total weight limit. Please note that the total weight limit includes the user(s) and their equipment.

WARNING

- ⚠ **When hunting from a treestand falls can occur any time after leaving the ground causing injury or death.**
- ⚠ **Always** wear a Fall Arrest System (FAS) comprising a full body harness at all times after leaving the ground. You must stay connected at all times after leaving the ground while using climbing and hang-on treestands. Single safety belts and chest harnesses are no longer allowed and shall never be used. If you are not wearing a full body harness properly attached to the tree that is protecting you from a fall, do not leave the ground.
- ⚠ **Read and understand** all of the manufacturer's Warnings and Instructions and use all safety devices provided by the manufacturer. Contact the manufacturer for any questions. Failure to do so could result in injury or death.
- ⚠ **Never** exceed the total weight limit of the treestand.
- ⚠ **Never** use a treestand during inclement weather such as rain, lightning, windstorms or icy conditions and end your hunt and return to the ground if inclement conditions arise.
- ⚠ **Never** use a treestand while using drugs (even prescription drugs) or alcohol.
- ⚠ **Never** use a treestand while feeling ill, nauseous or dizzy, or if you have a prior medical condition that could cause a problem, that is, heart condition, joints that lock-up, spinal fusions, etc., or if you are not well rested. **Never** sleep in stand.
- ⚠ **Never** use a treestand on a dead, leaning, diseased or loose barked tree, or a utility pole. **Always** avoid electrical power lines.
- ⚠ **Never** rely on a tree branch for support.

WARNING

- ⚠ **Never** jump or bounce on a treestand to seat it to the tree.
- ⚠ Pull up a bow, backpack, or firearm or other equipment only after being secure in the treestand and a firearm must be pulled up with it unloaded, chamber open, and muzzle down.
- ⚠ **Always** inform someone of the hunting location, where the treestand will be located and the expected duration of the hunt.
- ⚠ A signal device such as a mobile phone, radio, whistle, signal flare or personal locator device (PLD) must be on your person and readily available at all times.
- ⚠ Inspect the treestand and all safety devices each time before use and **Do Not** store a treestand outdoors when not in use.
- ⚠ **Never** modify your treestand in any way by making repairs, replacing parts, or altering it except if explicitly authorized in writing by the manufacturer.
- ⚠ Practice installing, adjusting and using your treestand at ground level prior to using it at elevated positions. Study your new stand to become familiar with all of its features and design. Doing so will confirm that the product is manufactured, assembled and installed correctly.
- ⚠ Instructions (written and video) shall be kept in a safe place and reviewed at least annually. It is the responsibility of the treestand owner to furnish the complete instructions to any person who borrows or purchases the treestand.
- ⚠ Use at least three (3) people to install or take down a ladder treestand.
- ⚠ The criss-cross straps/ropes and stabilization devices must be attached before climbing to the platform.
- ⚠ When installing a ladder stand, always bounce on the first rung to set the ladder into the ground according to manufacturer's instructions before proceeding to climb any higher.
- ⚠ Check every ladder section connection every time you use the stand before you leave the ground. If ladder sections are separating, do not use the stand.
- ⚠ Check the ground under the stand to make sure it is firm and level. Sloping ground or uneven surface (one side on a rock) can cause your ladder to tilt or shift off the tree as you climb.
- ⚠ **Always** maintain three (3) points of contact when climbing a ladder treestand. Proper three-point contact means having either two feet with one hand or one foot with two hands on the step portion of the ladder or climbing aid at all times.

WARNING

- ▲ **Always** lean forward as you climb and attach your harness to the tree before securing the platform to the tree and stepping onto the platform.
- ▲ **Never** exceed the stated maximum use height.
- ▲ **Do Not** use this product until you have watched the included treestand safety DVD, understand it, and practiced the techniques for safe hunting discussed in this DVD.
- ▲ Read and perform all inspection and maintenance tasks before each and every use. Replace any questionable components immediately with RETI original replacement parts.
- ▲ **Do Not** crush tubing when tightening bolt assemblies! Identify and familiarize yourself with all parts before you start. Bolt identification chart can be found in the back.
- ▲ Double check assembly steps to be certain you have correctly assembled this product.
- ▲ **Never** use any product that has not been maintained or inspected properly - Your life depends on it!
- ▲ Replace any and all treestand straps every two years or when any signs of damage or wear exist before.
- ▲ **Always** wear the appropriate footwear when using a ladder treestand. A good non-slip safety boot is important to your personal safety. Be especially careful that boot laces do not get hooked on the stand or any of its components (tuck shoelaces into boots before climbing).

WARNING

- ▲ **Only** use approved RETI parts. Failure to do so may result in serious injury or death!

INSPECTION AND MAINTENANCE

BEFORE EACH USE PERFORM THE FOLLOWING:

- Inspect all webbing, rope, cord, and strap assemblies for wear or damage.
- Inspect cables and/or cable ends for damage or kinking.
- Inspect all hardware and chain components for damage.
- Inspect for any structural damage to product. (If any exists call RETI customer service.)
- Inspect all nut and bolt assemblies to be certain none are loose.
- Inspect for any missing parts.
- Lubricate all pivot and slide together points with powder graphite, petroleum jelly or silicone spray to prevent noise, wear and rust.
- Inspect entire product for any rust, corrosion, cracks, freezing, excessive heat or rotting damage that may effect the safety of your product. Discard any questionable product.
- Inspect entire product for any structural damage - pay close attention to all weld locations. (Return to factory for repair or discard product if any damage is found.)
- Using correct wrenches inspect all nut & bolt assembly locations and snug up any that may be loose. Be careful not to crush tubing when tightening!
- Inspect and check operation of all cables, cable ends, cord, rope, webbing, and strap or chain assemblies. Replace with factory new any item or assembly that shows signs of wear, damage, kinking, or functions incorrectly.
- Inspect seat. Replace any seat with factory new that shows signs of structural damage or wear.
- Inspect all hardware for wear or damage, also be sure you have no missing parts.
- Never modify your stand in any way by making repairs, replacing parts, or altering adding or attaching anything to it except if explicitly authorized in writing by the manufacturer.

HARDWARE IDENTIFICATION CHART

Bolts shown are for size reference.
Extra hardware may be included in the parts bag.

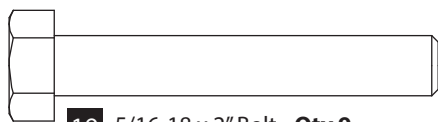

19 5/16-18 x 2" Bolt - **Qty 9**

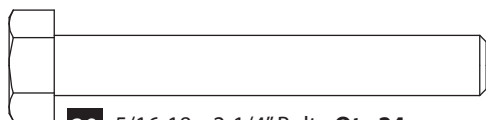

20 5/16-18 x 2-1/4" Bolt - **Qty 24**

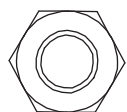

21 5/16-18 Locknut
Qty 32

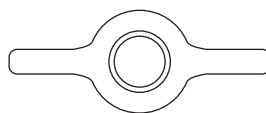

22

5/16-18
Wing Locknut
Qty 1

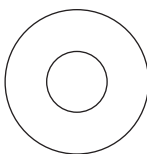

23 Yellow Washer
Qty 2

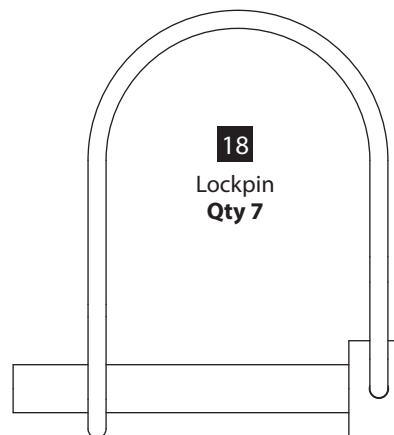

18

Lockpin
Qty 7

TOOLS NEEDED



1/2" Wrenches - **Qty 2**

ASSEMBLY INSTRUCTIONS

IMPORTANT ASSEMBLY TIP:

Do not tighten any nut and bolt combinations completely until all parts are assembled together! Finger tighten plus one turn of a wrench only! This will temporarily hold the lock nut on the bolt while helping alignment of all parts! After all parts are assembled together, all nut & bolt combinations must be completely tightened.

All assembly must be done in this order at ground level before uprighting.

Do not remove labels/warnings from product, they are there for your safety.

Recommended for adult use only.

FIGURE 1

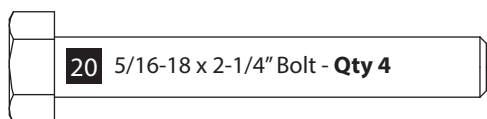

21 5/16-18 Nut
Qty 4

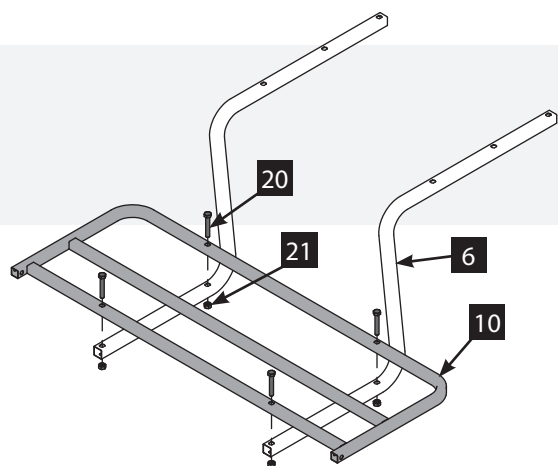

1. Attach the foot platform (10) to the lower portion of the two platform frame tubes (6) using four 5/16-18 x 2-1/4" bolts (20) and locknuts (21). **SEE FIGURE 1.**

NOTE: Rounded corners of foot platform must be oriented back, towards the platform frame tubes.

FIGURE 2

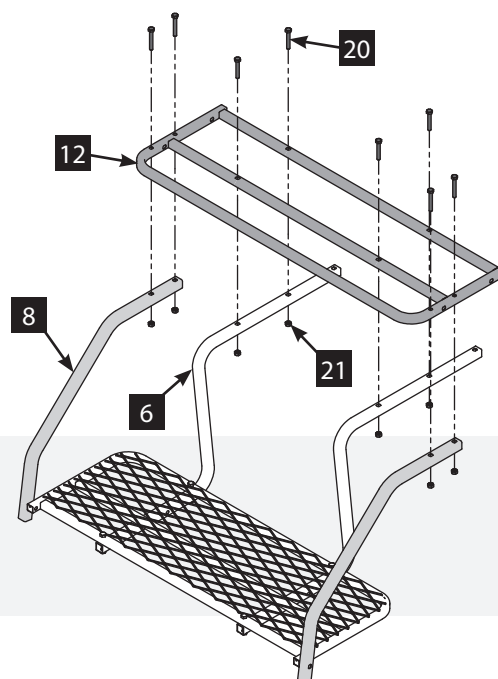

2. Attach the seat platform (12) to the upper portion of the two platform frame tubes (6) using four 5/16-18 x 2-1/4" bolts (20) and locknuts (21). **SEE FIGURE 2.**

NOTE: Rounded corners of seat platform must be oriented forward, towards the foot platform.

3. Attach the two side frame tubes (8) to the underside of the seat platform (12) using four 5/16-18 x 2-1/4" bolts (20) and locknuts (21). **SEE FIGURE 2.**



20 5/16-18 x 2-1/4" Bolt - Qty 8

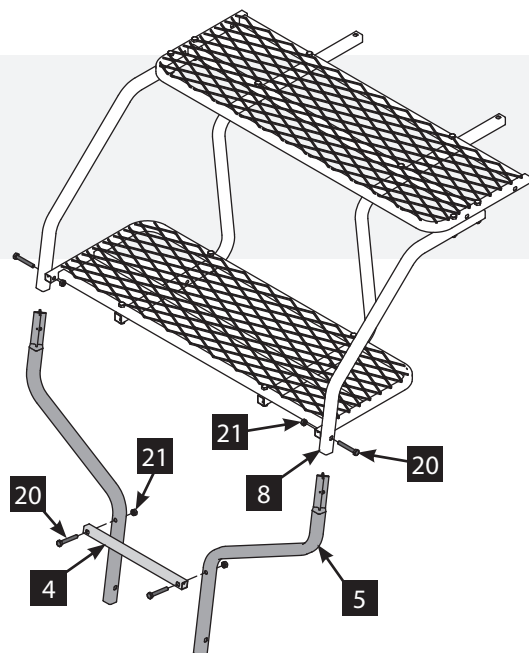
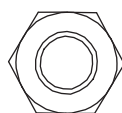
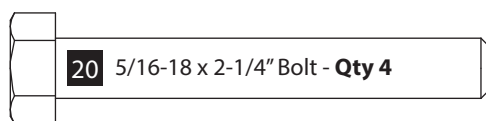

21 5/16-18 Nut
Qty 8

FIGURE 3

- Insert the crimped end of the offset ladder tubes (5) into the bottom of the two side frame tubes (8) on either side of the foot platform and secure using two 5/16-18 x 2-1/4" bolts (20) and locknuts (21). **SEE FIGURE 3.**

NOTE: Make sure bolts pass through both the offset ladder tubes and the side frame tubes.

- Attach the ladder step tube (4) to the offset ladder tubes (5) using two 5/16-18 x 2-1/4" bolts (20) and locknuts (21). **SEE FIGURE 3.**

- Attach the tree blade (14) to the platform frame tubes (6) using two 5/16-18 x 2-1/4" bolts (20) and locknuts (21). **SEE FIGURE 4.**
- Attach both armrests (3) to the outside edges of the seat platform (12) using four 5/16-18 x 2" bolts (19) and locknuts (21). **SEE FIGURE 4.**
- Attach the backrest (15) to the top of the two armrests (3) using four 5/16-18 x 2" bolts (19) and locknuts (21). **SEE FIGURE 4.**

NOTE: The tabs on both ends of the backrest need to be orientated on the lower side of the backrest when attached.

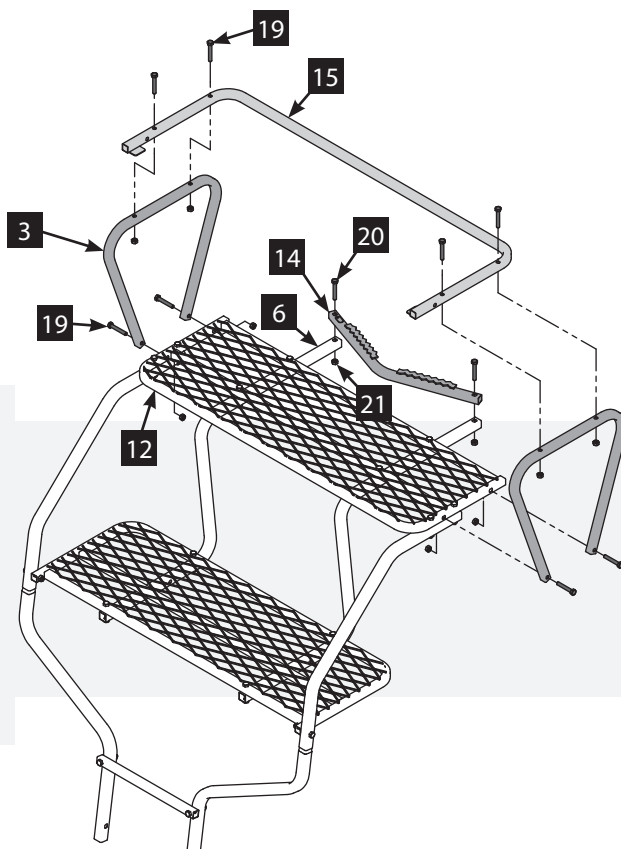
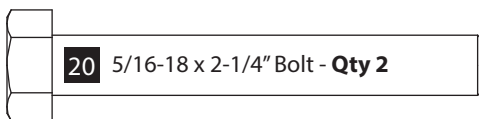
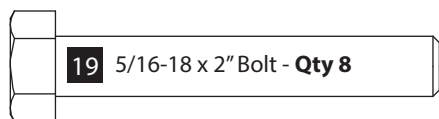
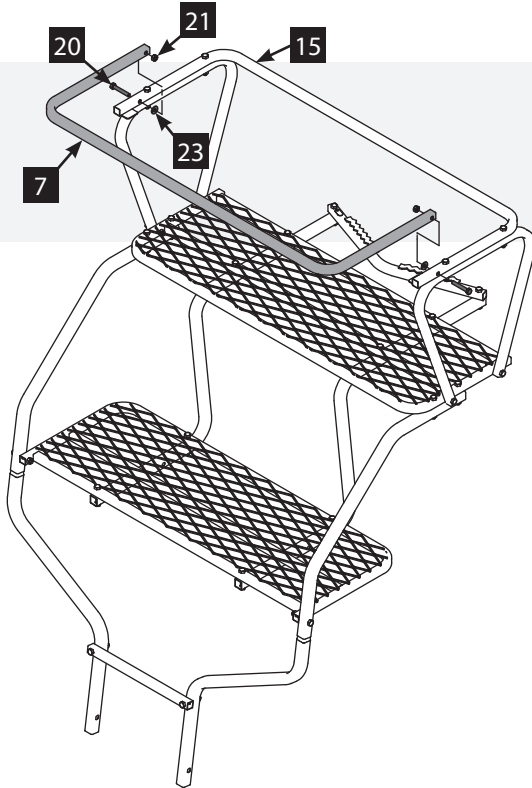
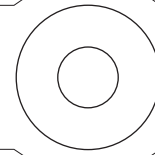
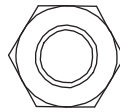
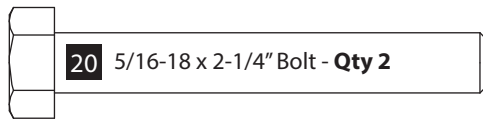

FIGURE 4

FIGURE 5



9. Attach the shooting rail (7) to the inside edge of the backrest tube (15) using two 5/16-18 x 2-1/4" bolts (20), yellow washers (23) and locknuts (21). **SEE FIGURE 5.**

NOTE: The yellow washers should be placed between the shooting rail and the backrest.

FIGURE 6

10. Attach the two support braces (9) to the inside edge of the platform frame tubes (6) using two 5/16-18 x 2-1/4" bolts (20) and locknuts (21). **SEE FIGURE 6.**

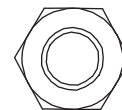
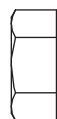
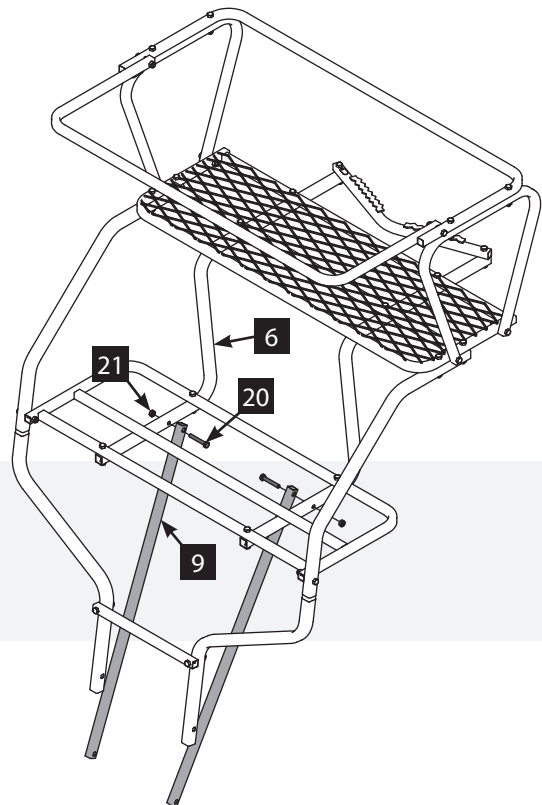
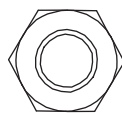
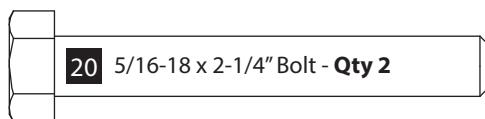
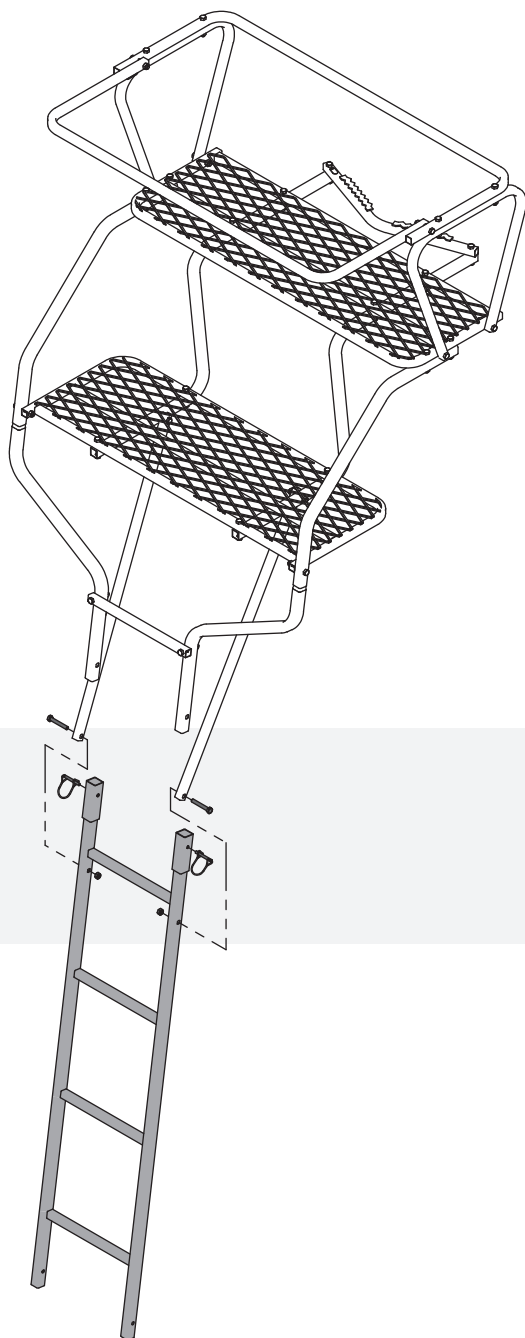

FIGURE 7



21 5/16-18 Nut
Qty 2



11. Slide the ends of the offset ladder tubes (5) into the top ladder section (11) and secure with two lockpins (18). **SEE FIGURES 7.**

NOTE: The top ladder section has bolt holes on the outside below the top ladder rung.

12. Attach the two support braces (9) to the outside edge of the top ladder sections (11) using two 5/16-18 x 2-1/4" bolts (20) and locknuts (21). **SEE FIGURE 7.**

FIGURE 8

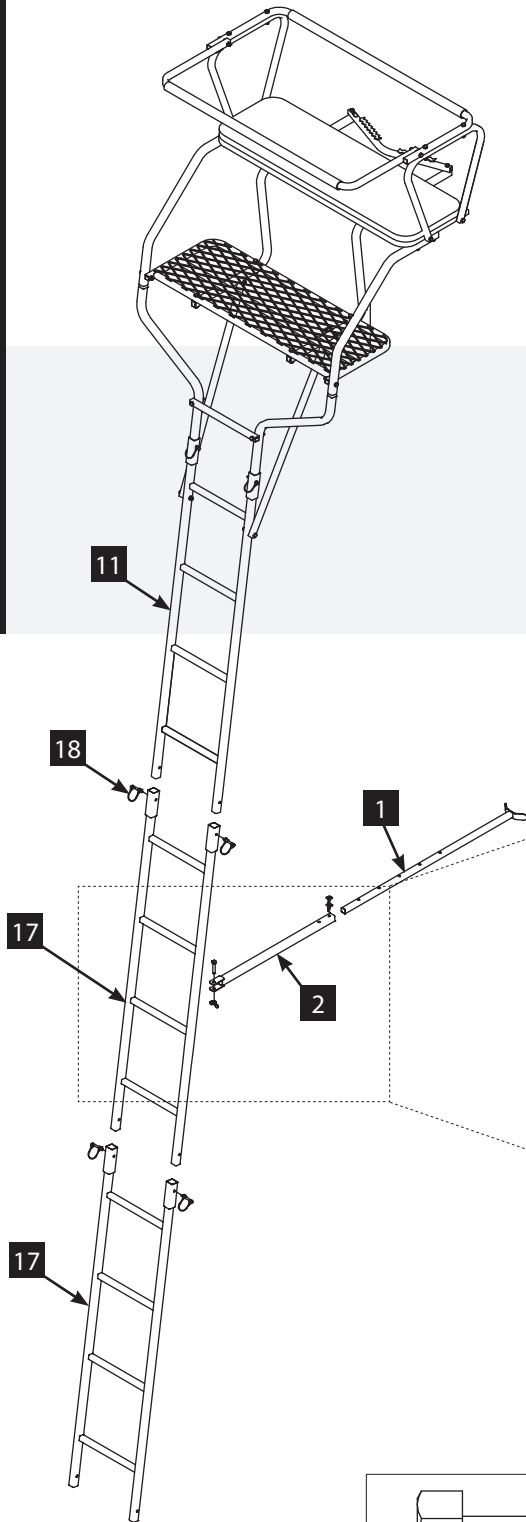

13. Assemble the two remaining ladder section (17) to the top ladder section (11) and assembled platform, with the stand laying on the ground, using four lockpins (18) at the points where the ladder sections slide together. **SEE FIGURE 8.**

NOTE: Make sure the lockpins pass through both ladder sections tubes.

14. Attach stabilizer support tube (2) to one of the middle ladder rungs of the middle ladder section using 5/16-18 x 2" bolts (19) and wing nut (22). **SEE FIGURES 8 & 9.**

15. Slide the stabilizer bar (1) into the stabilizer support tube (2) and secure using a lockpin (18). Make sure lockpin passes through support tube and stabilizer bar at appropriate hole to achieve desired distance from tree. Adjustment in length may be needed when ladder is uprighted later in the Setup and Use instructions. **SEE FIGURES 8 & 9.**

NOTE: Uprighting of the stand may be easier with the stabilizer bar not attached to the ladder. If removed, refer back during setup.

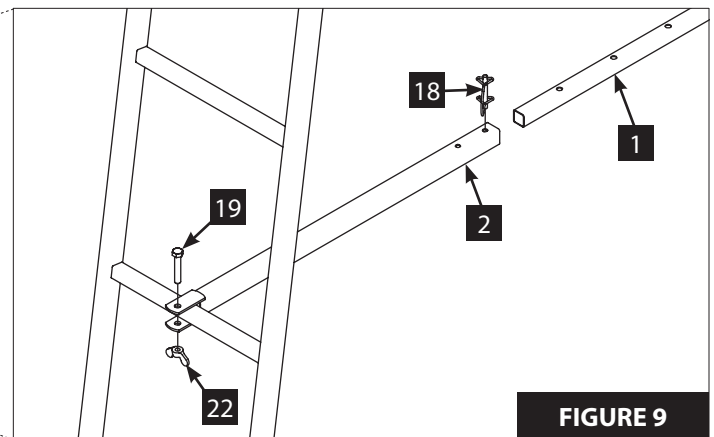
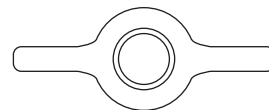
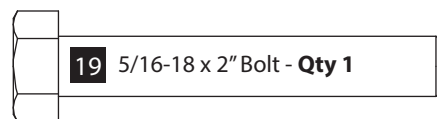

FIGURE 9



22 5/16-18 Wing Nut Qty 1

16. Attach the two long ends of the 16' criss-cross straps (27) to the platform frame tubes (6) near the tree blade. These long stabilizer straps should be attached by pulling the free end of the strap through the loop end of the strap to create a cinch knot around the frame tube. **SEE FIGURE 10.**
17. To aid in the ease of installation, pre-attach each end of the 6' ratchet strap (26) to each side of the platform frame tubes (6) between the 16' criss cross straps (27) and the tree blade. Use the same method as above. **SEE FIGURES 10, 11 & 12.** This way each end of the main ratchet strap is pre-attached before the stand is lifted from the ground.
18. Attach removable seat pad (13) to the metal seat frame by wrapping buckle straps around seat frame and secure together. Pull straps tight so seat is not loose.
19. Attach removable backrest and shooting rail pads (16) to the backrest tube (15) and the shooting rail tube (7) with hook and loop attachment strips on the pads.

FIGURE 10

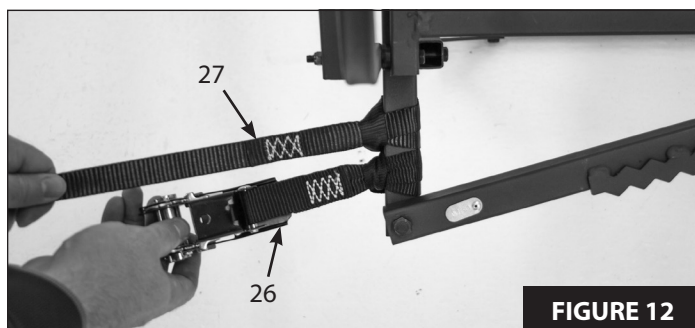
FIGURE 11

FIGURE 12

STOP

READ AND UNDERSTAND THE FOLLOWING WARNINGS BEFORE SETUP AND USE

WARNING

- ▲ Double check assembly steps to be certain you have correctly assembled this product.
- ▲ Study your new stand to become familiar with all of its features and design. At ground level, following provided use instructions, practice attaching stand to tree and removing stand from tree. Practice sitting, standing, and using this product before attaching overhead. Save these instructions for future reference. You must always use the provided Fall Arrest System (FAS) while using this product.
- ▲ **Always** use at least three (3) people to install or take down a ladder treestand. **Always** have two people stabilize the ladder before climbing to the platform the first time after every set-up.
- ▲ Be absolutely sure the tree blade(s) on stand and the stabilizer bar are contacting tree before climbing ladder.
- ▲ Stabilizer bar must always be correctly and securely attached to ladder and tree before climbing ladder.
- ▲ Make sure ladder bottom is firmly seated on dry, level ground. Attach your harness tether to the tree before securing the platform to the tree and stepping onto platform. Refer to the Full Body Harness instructions.
- ▲ **Never** ascend or descend ladder without criss-cross straps/ropes securely holding ladder to tree and stabilizer bar securely attached. Failure to correctly perform these steps can cause the ladder to collapse/buckle-over backwards during the initial ascent to attach ratchet strap resulting in serious injury or death.
- ▲ **Always** lean forward as you climb and attach your harness to the tree before securing the platform to the tree and stepping onto the platform.

WARNING

- ▲ Be sure only one person ascends or descends ladder at a time. Be certain first person is seated safely, and attached to tree with provided Fall Arrest System (FAS) correctly before second person ascends or descends ladder.
- ▲ **Never** have two people on one side of the platform. Keep weight evenly distributed on platform.
- ▲ **Always** be aware of the other person's position. Use extreme caution when weapons are used to prevent personal injury.

WARNING

- ▲ **Always** maintain three (3) points of contact when climbing a ladder treestand. Proper three-point contact means having either two feet with one hand or one foot with two hands on the step portion of the ladder or climbing aid at all times.
- ▲ **Always** wear the appropriate footwear when using a ladder treestand. A good non-slip safety boot is important to your personal safety. Be especially careful that boot laces do not get hooked on the stand or any of its components (tuck shoelaces into boots before climbing).
- ▲ **Never** stand on seat, it is designed for sitting only.
- ▲ **Do Not** allow excessive strap buildup in ratchet as this will prevent the ratchet teeth from engaging causing slippage.
- ▲ **Always** attach ratchet straps securely while using this product!
- ▲ If seat is removable, be certain it is securely attached when in use.
- ▲ Some models include a shooting rail. **Never** lean against, lean over, or sit on shooting rail. It is designed as a shooting rest only. **Always** be aware that the shooting rail can swing to one side or pivot up and down.
- ▲ Some models include a footrest, which is designed as a footrest only. **Never** stand on footrest! **Always** be fully aware of foot placement.
- ▲ Some models include a multi-piece stabilizer bar system. Be sure attachment hardware goes through both the extension tube and the stabilizer bar.

SETUP AND USE INSTRUCTIONS

WARNING

⚠ **Never** use a treestand on a dead, leaning, diseased or loose barked tree, or a utility pole. **Always** avoid electrical power lines.

During installation and removal of ladder treestands, you must always and properly use the included Full Body Harness (Fall Arrest System). Refer to the Full Body Harness instructions included with this product for proper use.

1. With assembled product lying on the ground, **position one person at bottom end of ladder lying on the ground**. This person has to prevent the ladder end from tilting up when platform end is lifted and prevent the ladder from skidding across ground.
2.
 - a. Position two people at the platform end of the ladder, lift the platform end and continue uprighting by walking toward bottom end of ladder and moving hands along ladder legs. **Stand ladder up against chosen straight tree on dry, level ground**. Use caution when ladder comes over center against the tree.
 - b. Step back and look at the ladder top to see that it is level. Adjust as needed to achieve a level platform top. Make sure both tree blade is contacting the tree.
 - c. Step down hard on bottom step to push ladder legs into the ground.
3. While two people hold the stand in place, the third person should connect the horizontal stabilizer bar to the tree. Adjust the length of the stabilizer bar as need so it contacts the tree and is level to the ground. Then secure it to the tree with the 6' cam strap (25) by forming a cinch knot with both ends of strap and running the long end of strap through the cam buckle. **SEE FIGURES 13 & 14.**
4.
 - a. Loop the d-loop end of the two 16' criss cross straps (27) through the loop end to form a cinch knot around the ladder rail tube. Secure beneath a step rung, at the stabilizer bar height location. **SEE FIGURE 15A.**
 - b. With the stand level and being held in place by two people, the third person must cross one of the 16' criss cross straps (27) behind the tree and feed the free end through the opposite d-loop. **SEE FIGURE 15B-E.**
 - c. Criss cross the other 16' strap (27), forming an "X" pattern on the of the tree and feed the free end through the opposite d-loop. **SEE FIGURE 15B-E.**
5. Make sure the criss cross straps and stabilizer bar strap are snug and the tree blades are still both contacting the tree.

NOTE: This ground level ladder-to-tree attachment will prevent the ladder from pulling away from the tree while ascending to the top for final 6' ratchet strap (26) attachment. The same holds true when the ladder is removed.

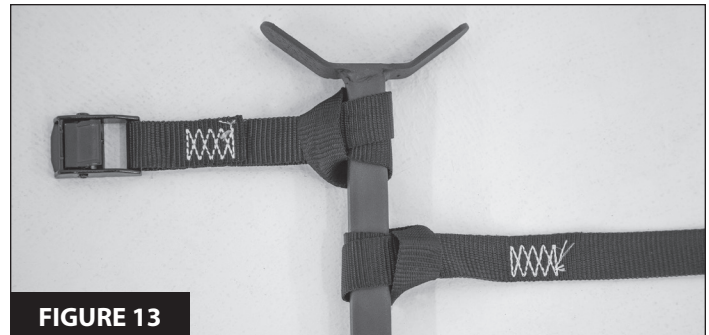

FIGURE 13



FIGURE 14

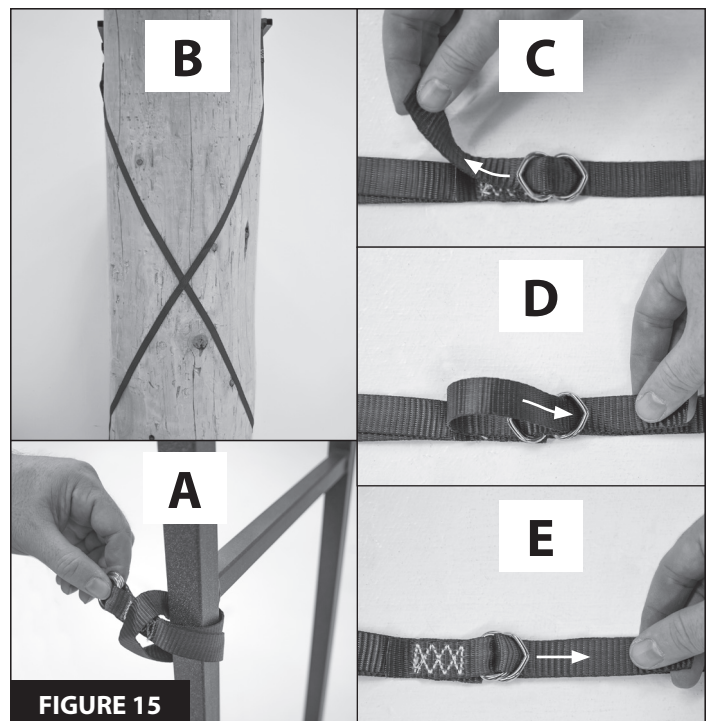

FIGURE 15

6. With two people securely holding the ladder, the third person must now use the three point contact climbing method to slowly climb the ladder. Make sure to keep a constant hand grip on the ladder at all times. Always lean forward, toward the tree, to keep the platform tree blade against the tree.

NOTE: Make sure the ladder bottom is firmly seated on dry, level ground. Attach your harness tether to the tree before securing the platform to the tree and stepping onto platform. Refer to the Full Body Harness instructions included with this product.

7. Standing on ladder step, lean toward tree with previously installed 6' ratchet strap (26) now in hand.
 - a. Wrap the previously installed end of the long strap around the tree and feed through the slot in the ratchet mechanism. **SEE FIGURE 16A.**

NOTE: Be sure to feed the long strap correctly so there are no twists in the strap.
 - b. Pull tail of long strap until most of the slack is taken out. Be sure entire strap is even and at the same level all around tree. **SEE FIGURE 16B.**
 - c. Use the ratchet to tighten the strap to tree. The tightened strap will stabilize the stand to tree and prevent movement. **SEE FIGURE 16C.**

NOTE: Make sure there is at least two full revolutions of strap on the ratchet spool before the strap tightens. Proper tension will ensure the stand is secured to the tree. Do not allow excessive strap to build up in the ratchet as this will prevent the ratchet teeth from engaging and can cause slippage.

To release ratchet, simply pull the release lever and open tightening lever wide open (flat).
8. If necessary, re-check and adjust the 6' ratchet strap (26), 16' criss cross straps (27) and horizontal stabilizer bar assembly to securely attach the treestand to the tree. The tree blade must be touching the tree.
9. Reverse setup and use instructions to take ladder down.

FIGURE 16A

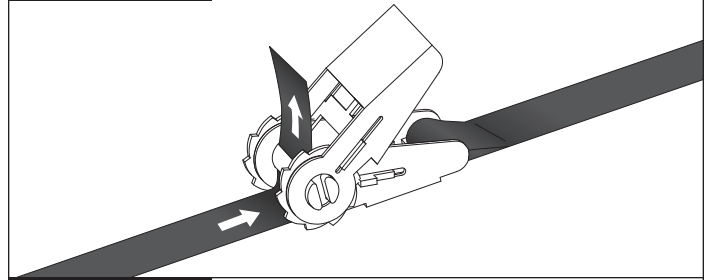

FIGURE 16B

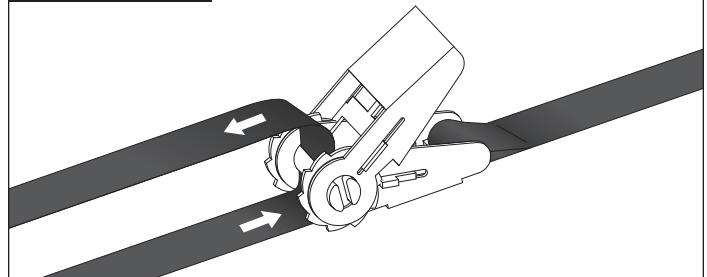
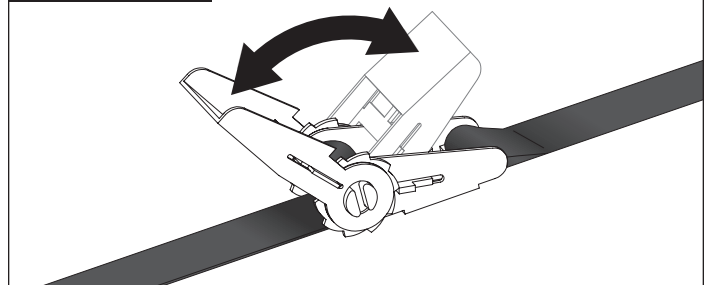
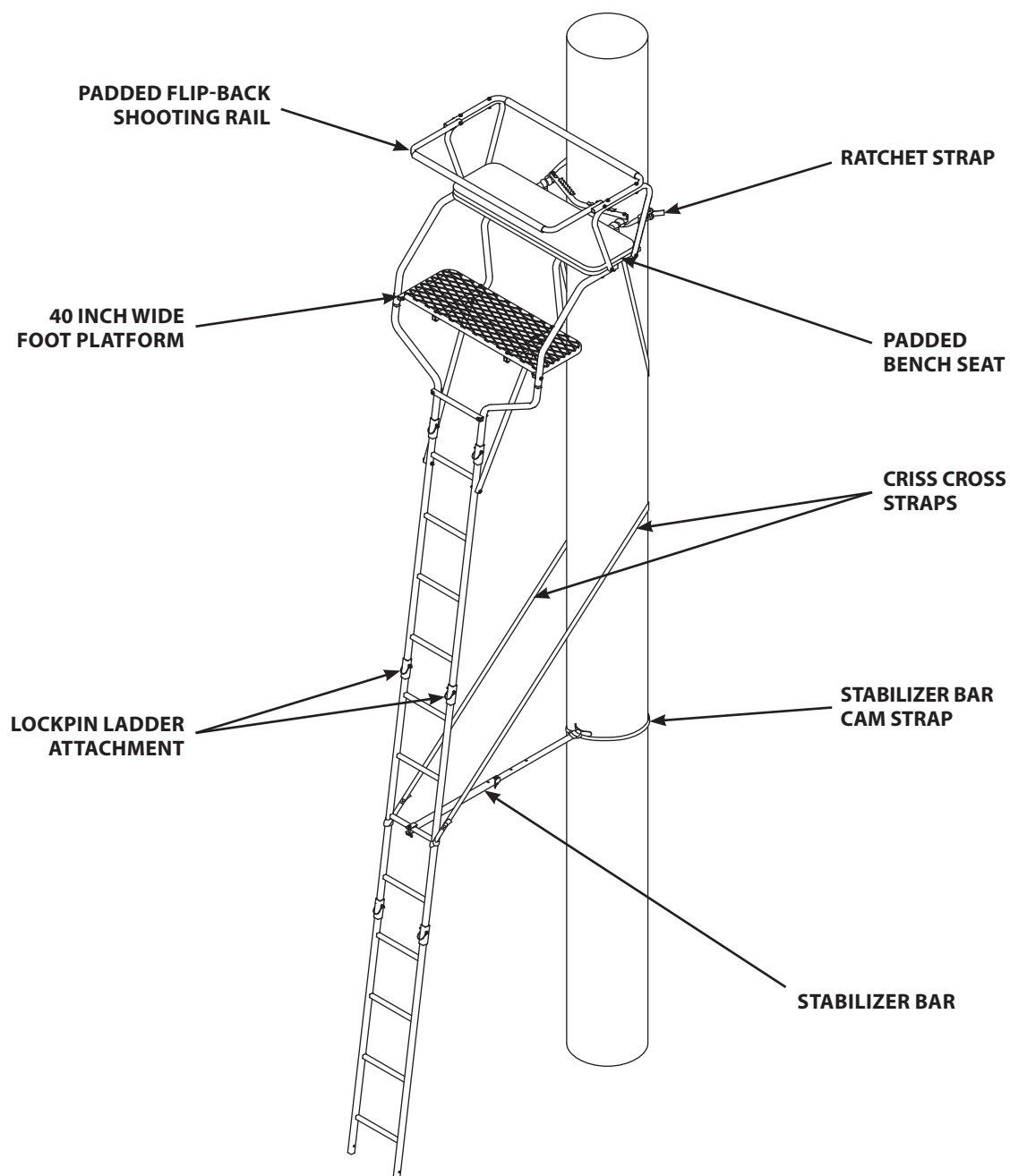

FIGURE 16C



FINISHED LADDER



ILLUSTRATED PARTS BREAKDOWN

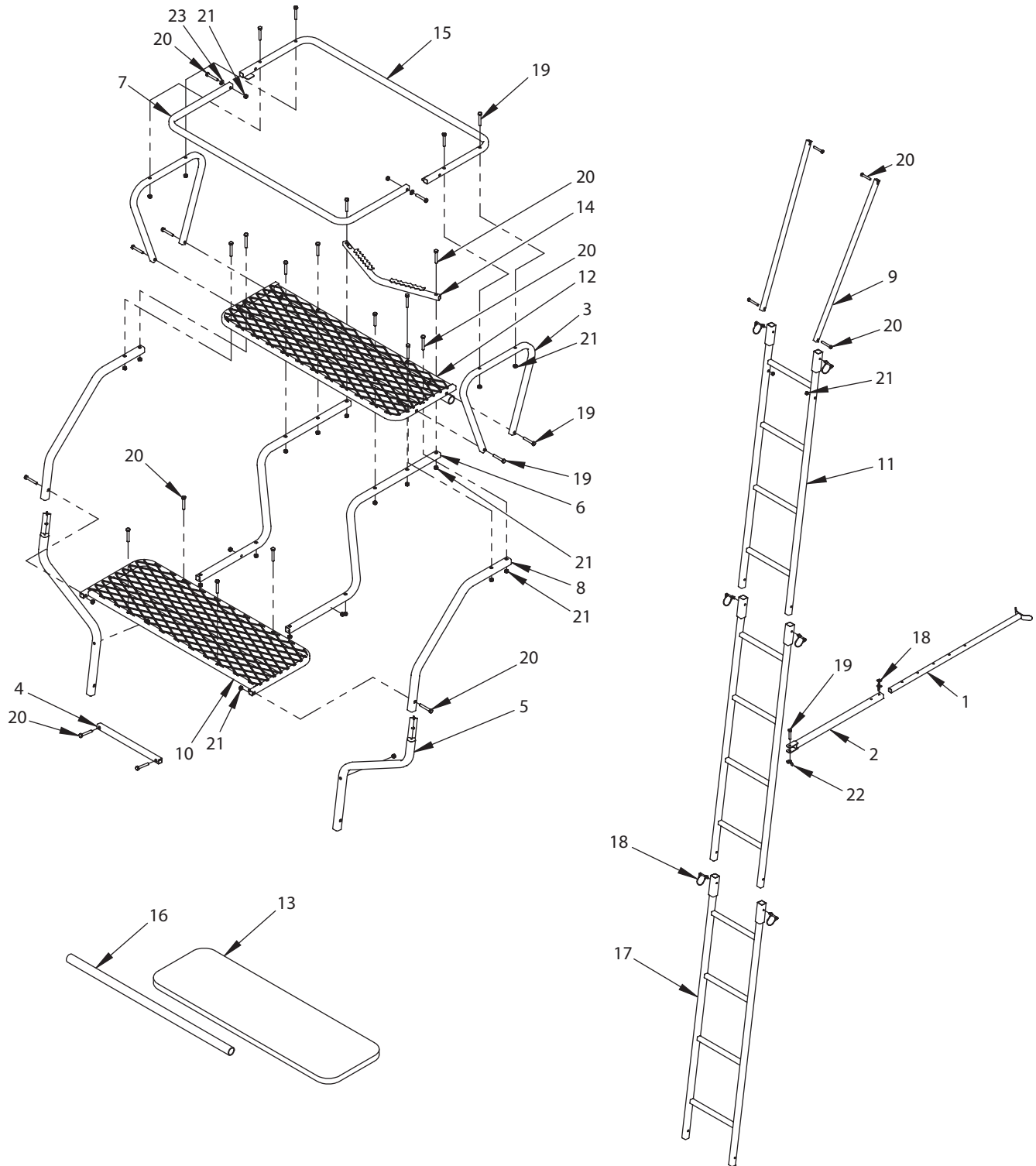

PARTS LIST

ITEM #	PART #	DESCRIPTION	QTY.
1	23698	STABILIZER BAR	1
2	23699	STABILIZER SUPPORT TUBE	1
3	25570	ARMREST	2
4	25576	OFFSET LADDER STEP	1
5	25573	LADDER OFFSET EXTENSION	2
6	25578	PLATFORM FRAME	2
7	25579	SHOOTING RAIL	1
8	25581	PLATFORM SIDE FRAME	2
9	25582	SUPPORT BRACE 32 IN	2
10	25584	FOOT PLATFORM	1
11	25585	TOP LADDER SECTION	1
12	25587	SEAT PLATFORM	1
13	25588	SEAT CUSHION 38 IN X 12 IN X 1 IN THK	1
14	25589	TREE BLADE	1
15	25592	BACKREST	1
16	25707	SHOOTING RAIL BACKREST COVER 34 IN	2
17	25724	LADDER SECTION	2
18	19847	LOCKPIN 6MM X 50.8MM BLACK ROUND HANDLE	7
19	1423B	BOLT 5/16-18 X 2 IN	9
20	27950	BOLT 5/16-18 X 2-1/4 IN	24
21	60G5NYB	NUT 5/16-18	32
22	27951	WING NUT 5/16-18	1
23	23523	WASHER YELLOW PLASTIC 8.1MM X 19.0MM X 2.0MM	2

ITEMS BELOW ARE NOT SHOWN

24	10531	SAFETY HARNESS / FALL ARREST SYSTEM	2
25	MK021-1401	6' CAM BUCKLE STRAP	1
26	MK011-1601	6' RATCHET STRAP	1
27	MK034-4511	16' CRISS CROSS STRAP	2
28	48800	TREE STAND SAFETY DVD	1

**NO EXTENSIONS AVAILABLE FOR THIS MODEL.
NEVER MODIFY OR EXCEED ORIGINAL STATED USE HEIGHT!**

This image shows a single sheet of white paper with horizontal ruling lines. The lines are evenly spaced and run across the width of the page. There are no margins, text, or other markings on the paper.

This image shows a single sheet of white paper with horizontal ruling lines. The lines are evenly spaced and run across the width of the page. There are no margins, text, or other markings on the paper.



WE ARE HUNTERS

Rivers Edge® Treestands, Inc.

1160 Eighth Avenue, PO Box 755
Cumberland, WI 54829

Phone: 800-450-EDGE (3343)

Fax: 715-822-2124

Email: info@huntriversedge.com

*All weights, specifications and features are approximate and are subject to change without notice. Due to continuous product improvements, product images may not be exact. Warning labels in some product images may have been removed for photography purposes only. Props shown in photos not included. Some assembly may be required.
