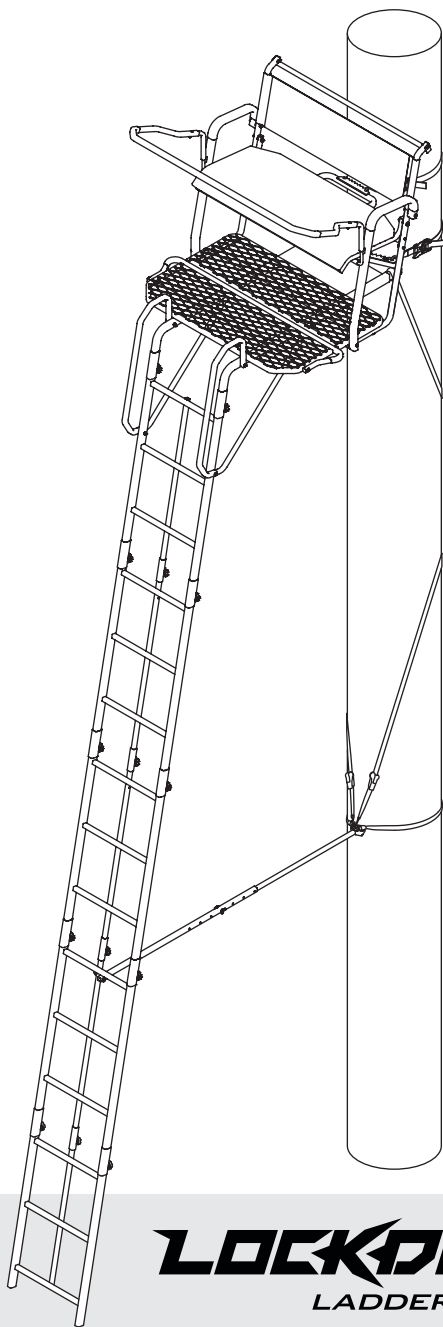




**WE ARE HUNTERS**



**LOCKDOWN™**  
LADDER STANDS

PRODUCT MEETS  
INDUSTRY STANDARDS  
RECOGNIZED BY



PARTICIPATING MEMBER

Operator's Manual

## **LOCKDOWN™ 21** **2-MAN** Ladder Stand

MODEL RE650

**Maximum Height**  
21' to shooting rail

**Maximum Field Rating**  
500 lbs; no more than  
300 lbs per person.

**Tree Diameter Range**  
12" to 20"

**Wear Your Harness!**



Get parts online at  
**[www.HuntRiversEdge.com](http://www.HuntRiversEdge.com)**

© 2017 RETI  
All Rights Reserved

P/N: 26504  
REV3: 05/11/17

## INTRODUCTION

Rivers Edge® Treestands are engineered with you the hunter in mind. We appreciate your purchase of one of our world class treestands. Follow these few simple instructions and your stand will provide you many years of trouble-free pleasure. Instructions should be kept in a safe place and reviewed at least annually.

If for any reason you have a problem with your product, **DO NOT return to the retailer**, contact the Rivers Edge® customer service department at 800-450-EDGE (3343) for assistance.

## CONTENTS

Introduction/Warranty .....	2
Warnings.....	3-4
Inspection and Maintenance .....	4
Hardware Identification Chart.....	5
Tools Needed .....	5
Assembly Instructions .....	6-12
Warnings.....	13
Setup and Use Instructions.....	14-15
Finished Ladder.....	16
Notes Page.....	17
Illustrated Parts Breakdown.....	18-19

## WARRANTY

RETI offers a one year warranty for all components of the treestand. These warranties apply to the original owner with a proof of purchase. These warranties begin on the date of purchase by the first retail consumer and continue for the period specified above. These warranties apply to products that are not modified, abused or used in a manner that deviates from the product's intended usage. Minor fading in color is normal and is not covered by warranty. Any corrosion of painted surfaces that occurs as a result of paint being removed or damaged is also not covered by warranty. RETI offers no other warranty expressed or implied. Products for which warranty work has been approved must be sent directly to RETI and performed by RETI. **To obtain warranty service and/or replacement instructions, you must obtain prior approval from RETI before shipping your package to us by calling our customer service department at 800-450-3343 or by writing to: RETI, P.O. Box 755, 1160 Eighth Avenue, Cumberland, WI 54829 for a return material authorization number (RMA#).** All items must be shipped prepaid. RETI will, at no charge, repair or replace, in RETI's sole discretion, any product that satisfies the conditions stated above. RETI retains the right to change models, specifications and price without notice.

This equipment has been manufactured under strict quality and safety guidelines. As with any equipment of this type, full understanding of the instructions and its use is mandatory and imperative for the safety of its user. RETI is not responsible for any damages or injuries sustained due to improper use or modification of any of its products, or resulting from any use which deviates from the product's intended usage. RETI is not responsible for any injuries sustained due to failure to read and adhere to the instructions for use. Any misunderstanding or questions regarding the products of their use should be directed to RETI prior to any use. **All RETI treestands are sold with a full body harness ("Fall Arrest System") that meets standards recognized by the Treestand Manufacturer's Association ("TMA").** It is the owner's sole responsibility to inspect the product regularly for damage, improper installation, or conditions that could jeopardize the ultimate safety of the product. Failure to use or improper use of the provided Fall Arrest System may result in serious injury or death. **ALWAYS wear the provided Fall Arrest System while using this product. Owner is responsible to understand and follow product field weight rating and must never exceed maximum weight rating.** RETI is not responsible for any malfunction or injury resulting from normal wear and tear, damage caused by improper use, improper maintenance, negligence or accidents. This product, if used safely as intended, will provide trouble free service for the useful life of the product. We hope you will enjoy the quality of our products for years to come, and have a safe hunt.

STOP

## READ AND UNDERSTAND THE FOLLOWING WARNINGS BEFORE ASSEMBLY

### MODEL RE650

**MAXIMUM USE HEIGHT - 21' TO SHOOTING RAIL**

**MAXIMUM OCCUPANCY - TWO (2)**

**TOTAL WEIGHT LIMIT - 500 LB (300 lb Per Person Max)**

**TREE DIAMETER RANGE - 12" TO 20"**

### WARNING

- ⚠ This product carries strict height and weight restrictions. **Do Not** use this product if you exceed the total weight limit. Please note that the total weight limit includes the user(s) and their equipment.

### WARNING

- ⚠ **When hunting from a treestand falls can occur any time after leaving the ground causing injury or death.**
- ⚠ **Always** wear a Fall Arrest System (FAS) comprising a full body harness at all times after leaving the ground. You must stay connected at all times after leaving the ground while using climbing and hang-on treestands. Single safety belts and chest harnesses are no longer allowed and shall never be used. If you are not wearing a full body harness properly attached to the tree that is protecting you from a fall, do not leave the ground.
- ⚠ **Read and understand** all of the manufacturer's Warnings and Instructions and use all safety devices provided by the manufacturer. Contact the manufacturer for any questions. Failure to do so could result in injury or death.
- ⚠ **Never** exceed the total weight limit of the treestand.
- ⚠ **Never** use a treestand during inclement weather such as rain, lightning, windstorms or icy conditions and end your hunt and return to the ground if inclement conditions arise.
- ⚠ **Never** use a treestand while using drugs (even prescription drugs) or alcohol.
- ⚠ **Never** use a treestand while feeling ill, nauseous or dizzy, or if you have a prior medical condition that could cause a problem, that is, heart condition, joints that lock-up, spinal fusions, etc., or if you are not well rested. **Never** sleep in stand.
- ⚠ **Never** use a treestand on a dead, leaning, diseased or loose barked tree, or a utility pole. **Always** avoid electrical power lines.
- ⚠ **Never** rely on a tree branch for support.

### WARNING

- ⚠ **Never** jump or bounce on a treestand to seat it to the tree.
- ⚠ Pull up a bow, backpack, or firearm or other equipment only after being secure in the treestand and a firearm must be pulled up with it unloaded, chamber open, and muzzle down.
- ⚠ **Always** inform someone of the hunting location, where the treestand will be located and the expected duration of the hunt.
- ⚠ A signal device such as a mobile phone, radio, whistle, signal flare or personal locator device (PLD) must be on your person and readily available at all times.
- ⚠ Inspect the treestand and all safety devices each time before use and **Do Not** store a treestand outdoors when not in use.
- ⚠ **Never** modify your treestand in any way by making repairs, replacing parts, or altering it except if explicitly authorized in writing by the manufacturer.
- ⚠ Practice installing, adjusting and using your treestand at ground level prior to using it at elevated positions. Study your new stand to become familiar with all of its features and design. Doing so will confirm that the product is manufactured, assembled and installed correctly.
- ⚠ Instructions (written and video) shall be kept in a safe place and reviewed at least annually. It is the responsibility of the treestand owner to furnish the complete instructions to any person who borrows or purchases the treestand.
- ⚠ Use at least three (3) people to install or take down a ladder treestand.
- ⚠ The criss-cross straps/ropes and stabilization devices must be attached before climbing to the platform.
- ⚠ When installing a ladder stand, always bounce on the first rung to set the ladder into the ground according to manufacturer's instructions before proceeding to climb any higher.
- ⚠ Check every ladder section connection every time you use the stand before you leave the ground. If ladder sections are separating, do not use the stand.
- ⚠ Check the ground under the stand to make sure it is firm and level. Sloping ground or uneven surface (one side on a rock) can cause your ladder to tilt or shift off the tree as you climb.
- ⚠ **Always** maintain three (3) points of contact when climbing a ladder treestand. Proper three-point contact means having either two feet with one hand or one foot with two hands on the step portion of the ladder or climbing aid at all times.

## WARNING

- ▲ **Always** lean forward as you climb and attach your harness to the tree before securing the platform to the tree and stepping onto the platform.
- ▲ **Never** exceed the stated maximum use height.
- ▲ **Do Not** use this product until you have watched the included treestand safety DVD, understand it, and practiced the techniques for safe hunting discussed in this DVD.
- ▲ Read and perform all inspection and maintenance tasks before each and every use. Replace any questionable components immediately with RETI original replacement parts.
- ▲ **Do Not** crush tubing when tightening bolt assemblies! Identify and familiarize yourself with all parts before you start. Bolt identification chart can be found in the back.
- ▲ Double check assembly steps to be certain you have correctly assembled this product.
- ▲ **Never** use any product that has not been maintained or inspected properly - Your life depends on it!
- ▲ Replace any and all treestand straps every two years or when any signs of damage or wear exist before.
- ▲ **Always** wear the appropriate footwear when using a ladder treestand. A good non-slip safety boot is important to your personal safety. Be especially careful that boot laces do not get hooked on the stand or any of its components (tuck shoelaces into boots before climbing).

## WARNING

- ▲ **Only** use approved RETI parts. Failure to do so may result in serious injury or death!

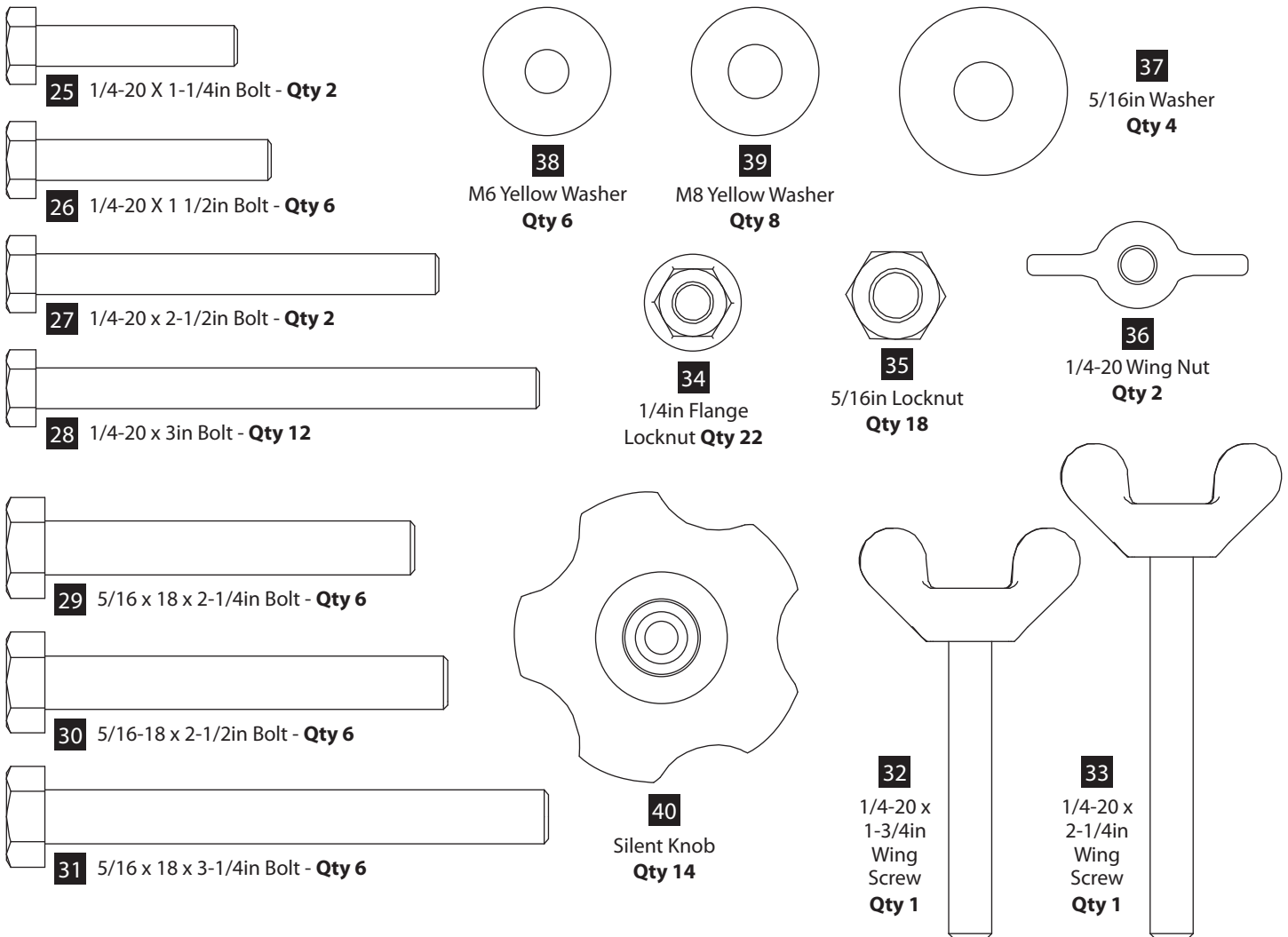
## INSPECTION AND MAINTENANCE

### BEFORE EACH USE PERFORM THE FOLLOWING:

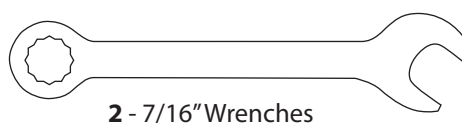
- Inspect all webbing, rope, cord, and strap assemblies for wear or damage.
- Inspect cables and/or cable ends for damage or kinking.
- Inspect all hardware and chain components for damage.
- Inspect for any structural damage to product. (If any exists call RETI customer service.)
- Inspect all nut and bolt assemblies to be certain none are loose.
- Inspect for any missing parts.
- Lubricate all pivot and slide together points with powder graphite, petroleum jelly or silicone spray to prevent noise, wear and rust.
- Inspect entire product for any rust, corrosion, cracks, freezing, excessive heat or rotting damage that may effect the safety of your product. Discard any questionable product.
- Inspect entire product for any structural damage - pay close attention to all weld locations. (Return to factory for repair or discard product if any damage is found.)
- Using correct wrenches inspect all nut & bolt assembly locations and snug up any that may be loose. Be careful not to crush tubing when tightening!
- Inspect and check operation of all cables, cable ends, cord, rope, webbing, and strap or chain assemblies. Replace with factory new any item or assembly that shows signs of wear, damage, kinking, or functions incorrectly.
- Inspect seat. Replace any seat with factory new that shows signs of structural damage or wear.
- Inspect all hardware for wear or damage, also be sure you have no missing parts.
- Never modify your stand in any way by making repairs, replacing parts, or altering adding or attaching anything to it except if explicitly authorized in writing by the manufacturer.

## HARDWARE IDENTIFICATION CHART

Bolts shown are for size reference.  
 Extra hardware may be included in the parts bag.



## TOOLS NEEDED



## ASSEMBLY INSTRUCTIONS

### IMPORTANT ASSEMBLY TIP:

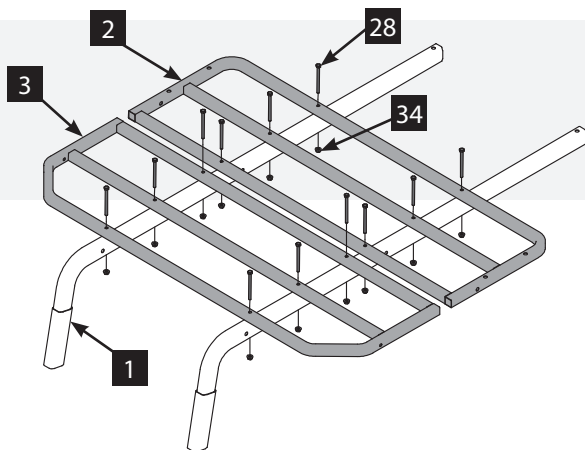
Do not tighten any nut and bolt combinations completely until all parts are assembled together! Finger tighten plus one turn of a wrench only! This will temporarily hold the lock nut on the bolt while helping alignment of all parts! After all parts are assembled together, all nut & bolt combinations must be completely tightened.

**All assembly must be done in this order at ground level before uprighting.**

**Do not remove labels/warnings from product, they are there for your safety.**

**Recommended for adult use only.**

FIGURE 1



1. Attach the front platform (3) and rear platform (2) to the two J-tubes (1) using twelve 1/4-20 x 3in bolts (28) and 1/4in flange locknuts (34). **SEE FIGURE 1.**

**NOTE:** Angled corners of front platform (3) must be oriented towards the bent ends of the J-tubes (1). The bolt holes on the outside edge of the rear platform (2) must be oriented towards the front platform (3).

2. Slide the TearTuff™ mesh shelf (24) onto the straight ends of the J-tubes (1). Attach the lower tree blade (4) to the J-tubes with two 5/16 x 18 x 3-1/4in bolts (31) and 5/16in locknuts (35). **SEE FIGURE 2.**

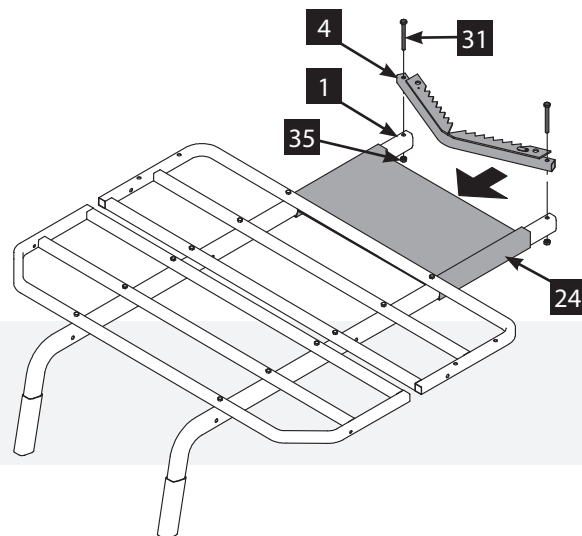
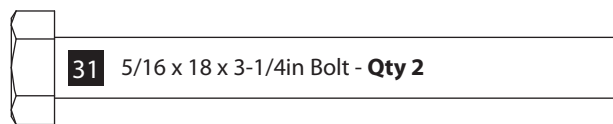
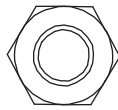
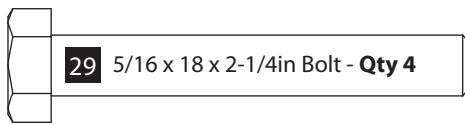
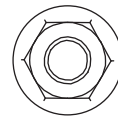
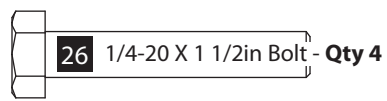


FIGURE 2

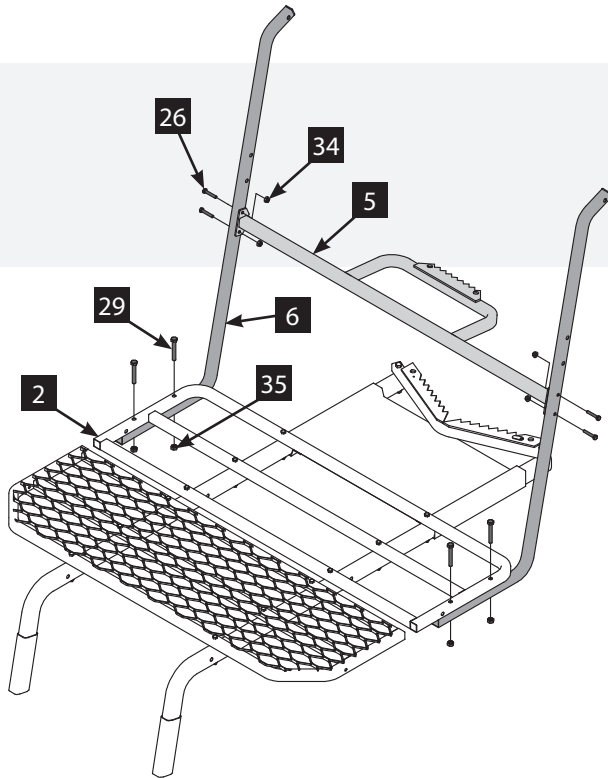


**FIGURE 3**


**35** 5/16in  
Nut  
Qty 4



**34** 1/4in  
Nut  
Qty 4



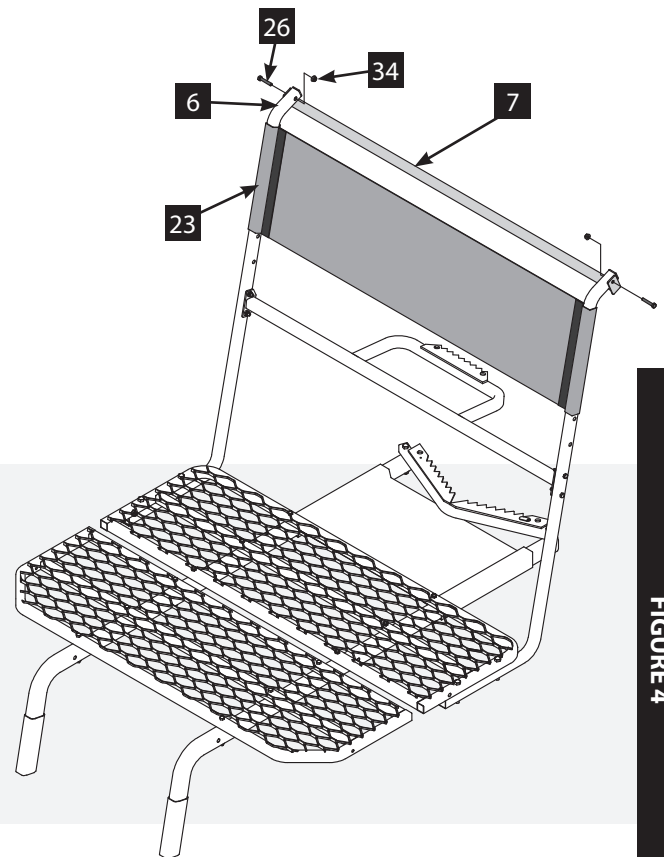
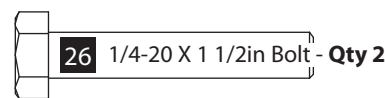
3. Attach the two rear seat supports (6) to the underside of the rear platform (2) using four 5/16 x 18 x 2-1/4in bolts (29) and 5/16in locknuts (35). **SEE FIGURE 3.**
4. Attach the upper tree blade (5) to the lower set of bolt holes on the rear seat supports (6) using four 1/4-20 X 1 1/2in bolts (26) and 1/4in flange locknuts (34). **SEE FIGURE 3.**

5. Slide the TearTuff™ mesh backrest (23) onto the rear seat supports (6) and keep towards the top. **SEE FIGURE 4.**

**NOTE: The hook and loop attachment strips on the top and bottom of the mesh should face backwards and the strips on the left and right sides will face forwards.**

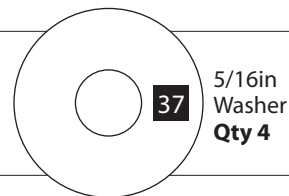
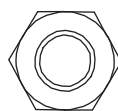
6. Attach the backrest spreader (7) to the top most part of the rear seat supports (6) using two 1/4-20 X 1 1/2in bolts (26) and 1/4in flange locknuts (34). **SEE FIGURE 4.**

**NOTE: Backrest spreader (7) must be orientated to the underside of the rear seat supports (6), with mounting brackets on the outside.**


**FIGURE 4**


**34** 1/4in Nut  
Qty 2

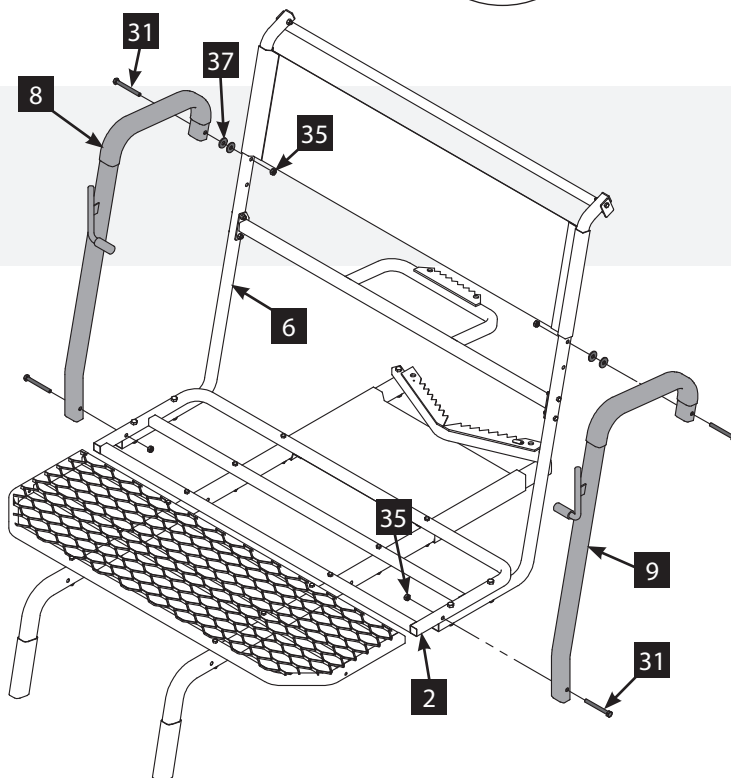
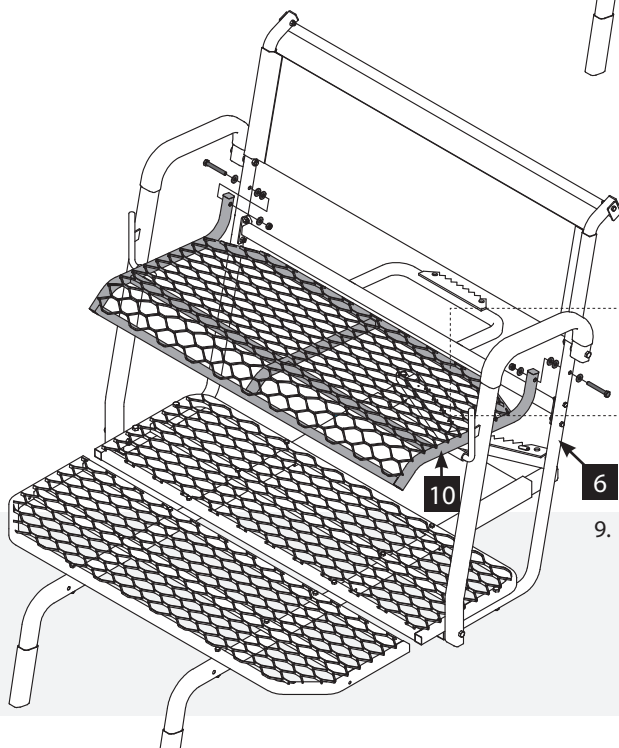
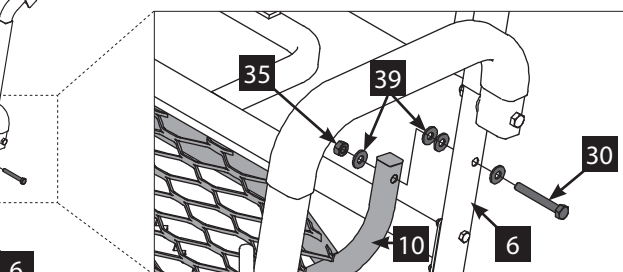




7. Attach the top of the right armrest (8) and the top of the left armrest (9) to the rear seat supports (6) using two 5/16 x 18 x 3-1/4in bolts (31), 5/16in washers (37) and 5/16in locknuts (35). Make sure that the seat posts are pointing inwards. **SEE FIGURE 5.**

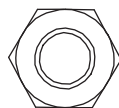
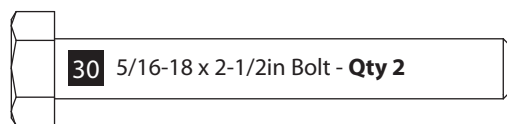
**NOTE:** Make sure that the armrests are attached to the second holes above the upper tree blade frame. If the TearTuff™ backrest has slid over the holes, you may need to loosen the hardware of the backrest spreader to slide the backrest upwards. The washer between the armrest and the seat support should not rest on the mesh, slide mesh up until washer contacts only metal.

8. Attach the bottom of the right armrest (8) and the bottom of the left armrest (9) to the rear platform (2) using two 5/16 x 18 x 3-1/4in bolts (31) and 5/16in locknuts (35). **SEE FIGURE 5.**

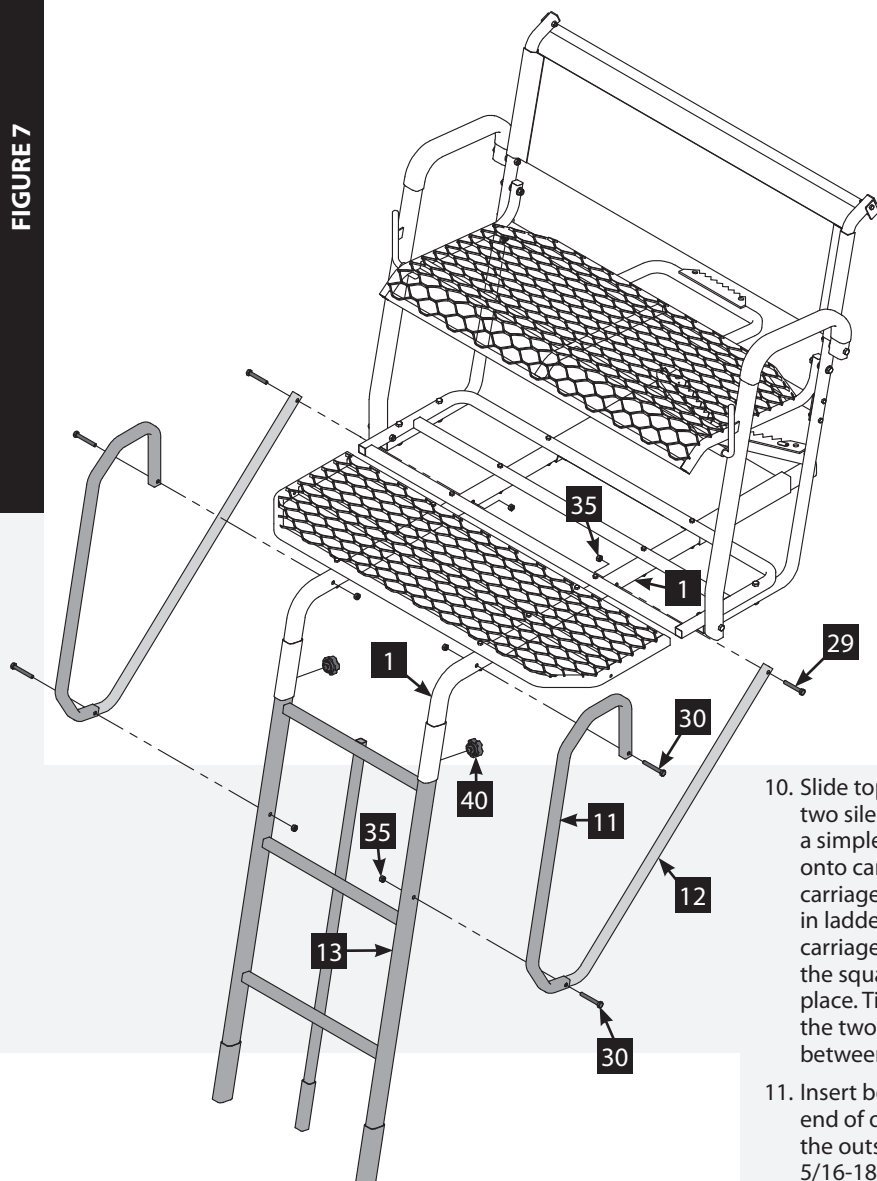
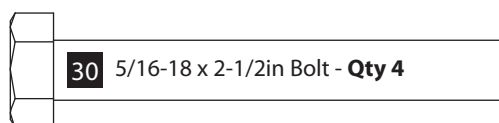
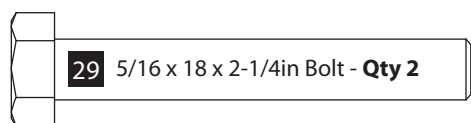
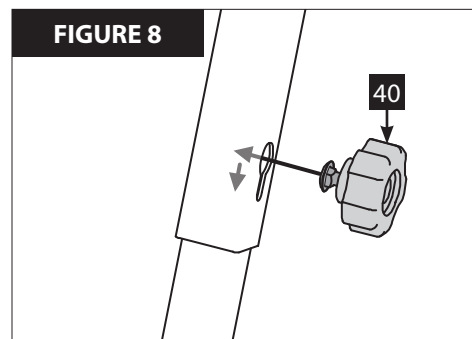

**FIGURE 5**

**FIGURE 6**


9. Attach the seat (10) to the rear seat supports (6) between the armrests and upper tree blade using two 5/16-18 x 2-1/2in bolts (30), eight yellow M8 plastic washers (39) and two 5/16in locknuts (35). **SEE FIGURE 6.**

**NOTE:** Hardware should be arranged from the outside to the inside as follows: 5/16-18 x 2-1/2in bolt (30), yellow washer (39), rear seat support (6), two yellow washers (39), seat (10), yellow washer (39), 5/16in locknut (35).





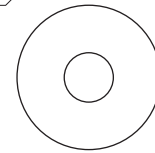
**FIGURE 7**

**FIGURE 8**


10. Slide top ladder section (13) into J-tubes (1) and secure with two silent knobs (40). These silent knob assemblies consist of a simple threaded knob with carriage bolt. Thread the knob onto carriage bolt, only about 2 turns. Insert the head of carriage bolt into the large end of the key hole type opening in ladder pocket and slide the square "block" portion of carriage bolt head down into the slot. Doing this will capture the square "block" portion of carriage bolt and hold it in place. Tighten the knob by hand until tight which will draw the two ladder sections together and eliminate any slop between the ladder sections. **SEE FIGURES 7 AND 8.**
11. Insert bent end of one platform brace (12) into the lower end of one ladder hand rail (11). Attach connection point to the outside edge of the top ladder section (13) using one 5/16-18 x 2-1/2in bolt (30) and 5/16in locknut (35). Make sure bolt passes through ladder hand rail, platform brace and top ladder section. **SEE FIGURE 7.**
12. Repeat previous step for opposite platform brace (12) and ladder hand rail (11). **SEE FIGURE 7.**
13. Attach the free end of both ladder hand rails (11) to the J-tubes (1) just in front of the front platform using two 5/16-18 x 2-1/2in bolts (30) and 5/16in locknuts (35). **SEE FIGURE 7.**
14. Attach the free end of both platform braces (12) to the J-tubes (1) below the rear platform using two 5/16 x 18 x 2-1/4in bolts (29) and 5/16in locknuts (35). **SEE FIGURE 7.**

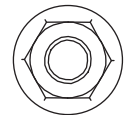
**FIGURE 9**

**25** 1/4-20 X 1-1/4in Bolt - Qty 2

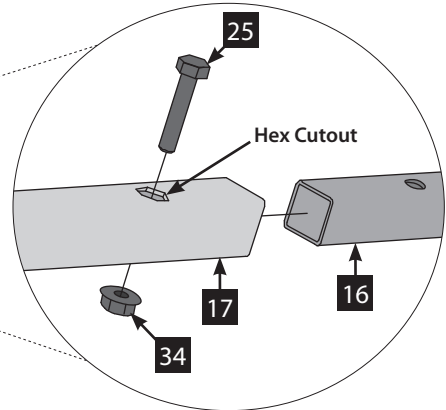
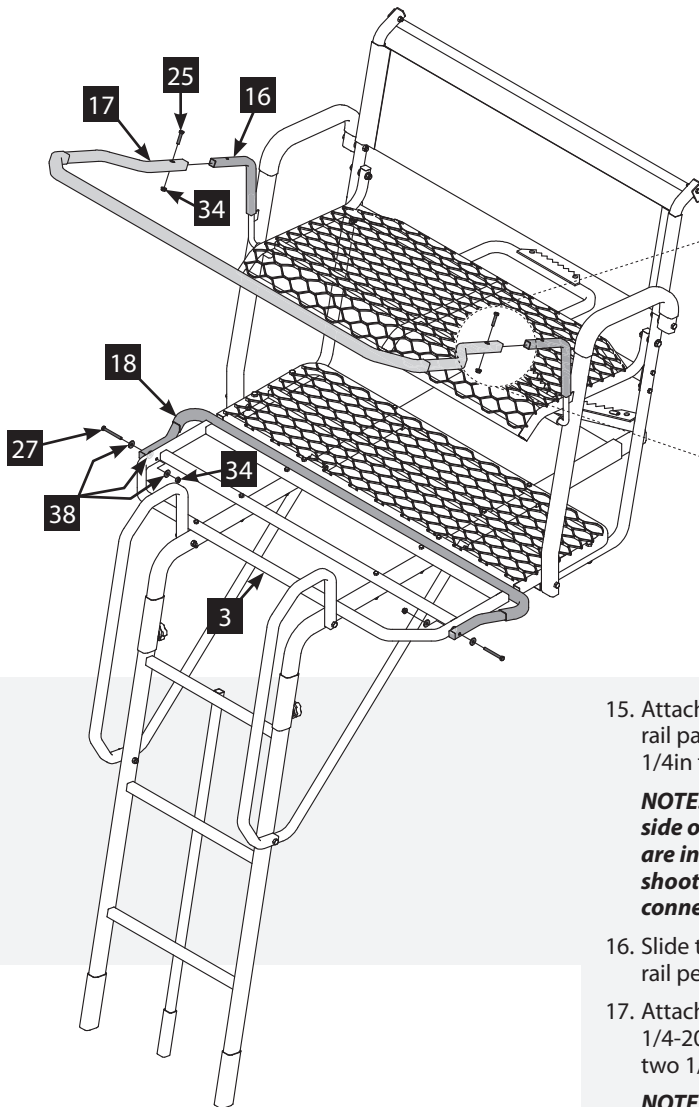
**27** 1/4-20 x 2-1/2in Bolt - Qty 2



M6 Yellow  
Washer  
Qty 6



**34**  
1/4in Nut  
Qty 4



15. Attach one shooting rail part A (16) to each end of shooting rail part B (17) using two 1/4-20 X 1-1/4in bolts (25) and 1/4in flange locknuts (34). **SEE FIGURE 9.**

**NOTE: The hex cutouts need to be orientated on the top side of shooting rail part B (17) so when the hex head bolts are inserted down through the cutouts they engage each shooting rail part A (16) and remove the slop from the connection points.**

16. Slide the ends of the shooting rail (16,17) onto the shooting rail pegs on the right and left armrests. **SEE FIGURE 9.**

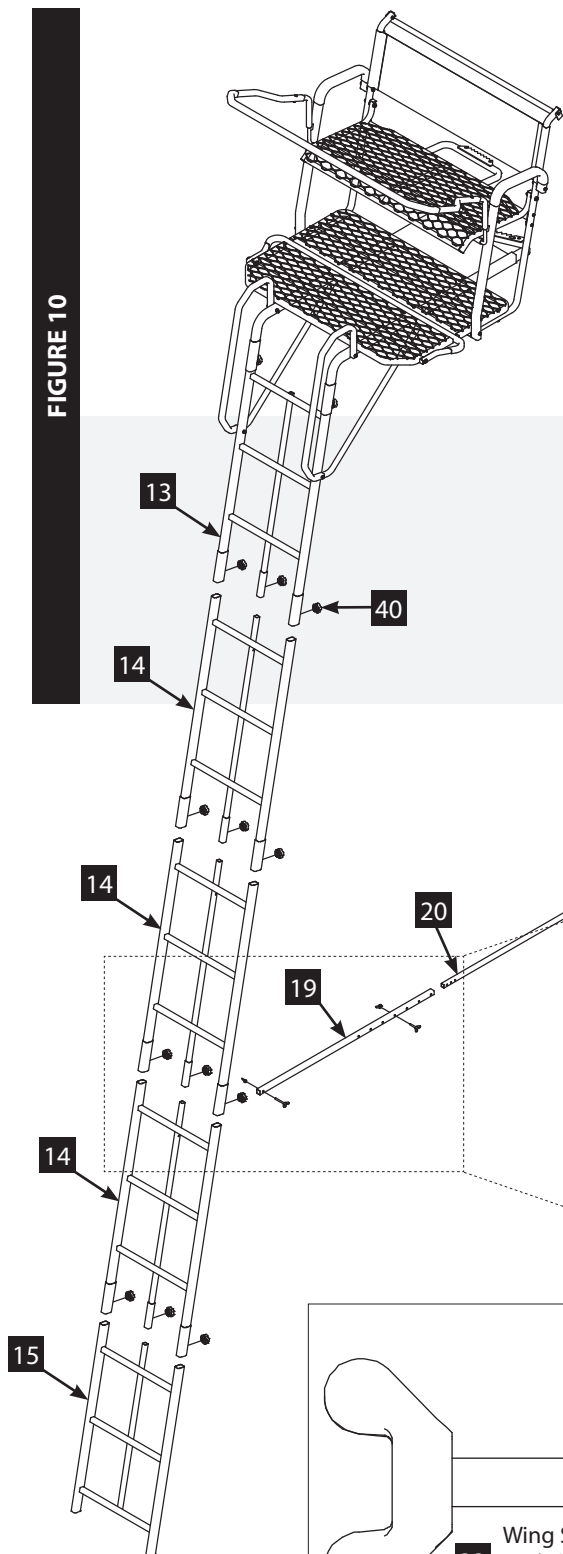
17. Attach the footrest (18) to the front platform (3) using two 1/4-20 x 2-1/2in (27), six yellow M6 plastic washers (38) and two 1/4in flange locknuts (34).

**NOTE: Hardware should be arranged from the outside to the inside as follows: 1/4-20 x 2-1/2in bolt (27), yellow washer (38), footrest (18), yellow washer (38), front platform (3), yellow washer (38), 1/4in locknut (34).**

**NOTE: Footrest is intended to be able to pivot from the hidden position between the front and rear platforms and the use position leaning against the ladder hand rails.**

18. Tighten all nut and bolt combinations completely at this time. Be sure not to over tighten or crush tubing when tightening.

**FIGURE 10**



19. Ladder sections are assembled on the ground in the following order: bottom ladder section (15); three middle ladder sections (14); top ladder section (13) and the treestand top. **SEE FIGURE 10.**

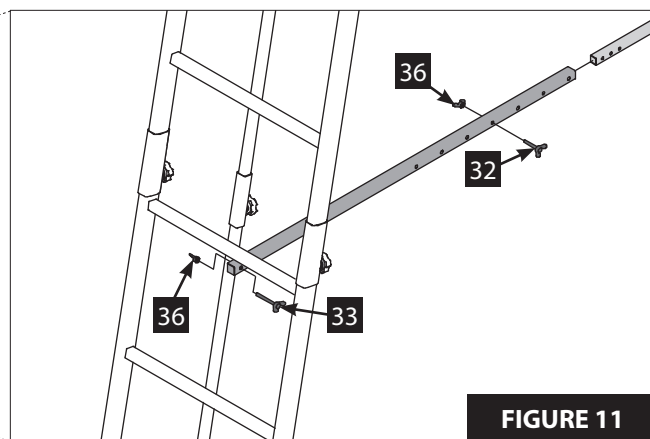
20. With all sections assembled together on ground, secure all sections together using twelve silent knobs (40).

21. Attach stabilizer support tube (19) to the lowest middle ladder section (14) using 1/4-20 x 2 1/4in wing screw (33) and wing nut (36). **SEE FIGURES 10 & 11.**

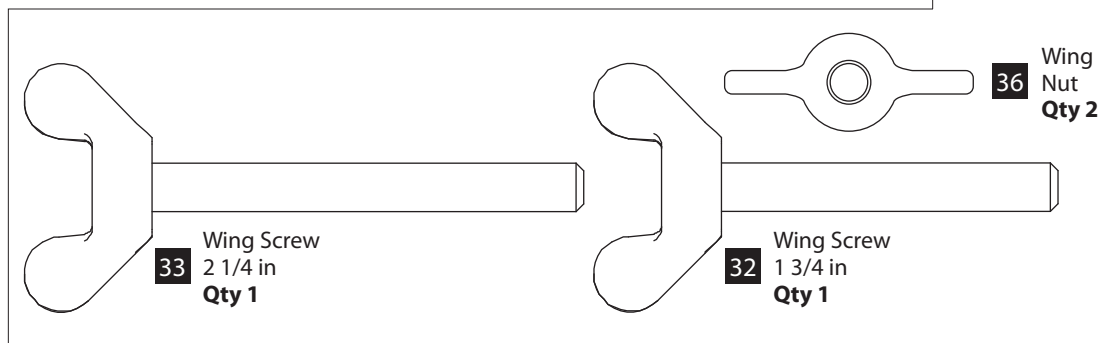
**NOTE: Mounting hole is located just below top ladder rung on the middle ladder section.**

22. Slide the bark biting stabilizer bar (20) into the stabilizer support tube (19) and secure using 1/4-20 x 1 3/4in wing screw (32) and wing nut (36). Make sure screw passes through support tube and stabilizer bar at appropriate hole to achieve desired distance from tree. Adjustment in length may be needed when ladder is uprighted later in the Setup and Use instructions. **SEE FIGURES 10 & 11.**

**NOTE: Uprighting of the stand may be easier with the stabilizer bar not attached to the ladder. If removed, refer back during setup.**



**FIGURE 11**



### LONG CRISS CROSS RATCHET STRAPS (46)

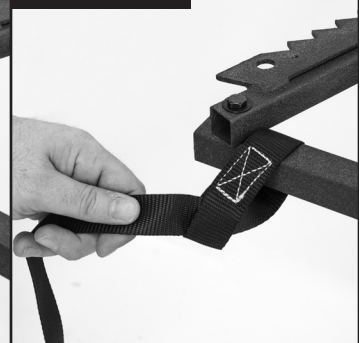
23. Attach the two long straps of the criss cross ratchet straps (46) to the rear of the J-tubes near the lower tree blade.
- Wrap sewn loop of each strap around the J-tubes on each side of the platform and feed the loose end through the sewn loop. **SEE FIGURES 12A & 12B.**
  - Pull tight, forming a cinch knot. This permanently attaches the long straps to the platform. **SEE FIGURES 12B & 12C.**

**NOTE:** The ratchet portion of the long straps will be used later during the Setup and Use instructions.

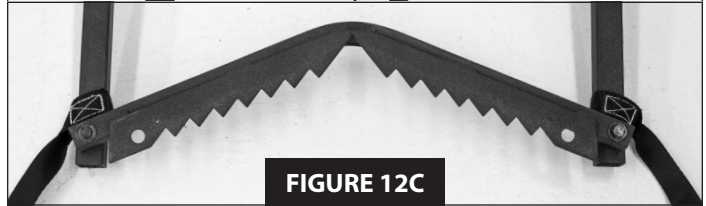
**FIGURE 12A**



**FIGURE 12B**



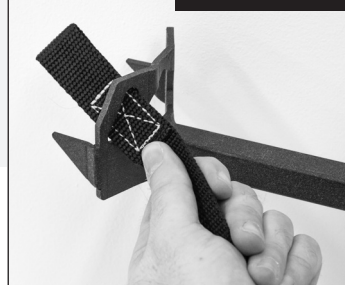
**FIGURE 12C**



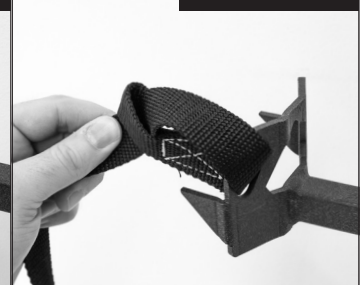
### STABILIZER BAR RATCHET STRAP (47)

24. Attach the straps of the stabilizer bar ratchet assembly (47) to the stabilizer bar bark biting plate.
- Feed the sewn loop of the long strap through either side slot in the bark biting plate and then feed the loose end through the sewn loop. **SEE FIGURES 13A & 13B.**
  - Pull tight, forming a cinch knot. This permanently attaches the long strap to the stabilizer bar. **SEE FIGURES 13B & 13C.**
  - Feed the sewn loop of the ratchet buckle strap through the opposite side slot in the bark biting plate and then feed the ratchet buckle through the sewn loop.
  - Pull tight, forming a cinch knot. This permanently attaches the ratchet buckle strap to the stabilizer bar. **SEE FIGURE 13C.**

**FIGURE 13A**



**FIGURE 13B**



**FIGURE 13C**



### SEAT PAD (21)

25. Attach removable seat pad (21) to the metal seat frame by sliding seat frame into pocket. Wrap buckle straps around seat frame and secure together. Pull straps tight so seat is not loose.

### BACKREST PAD (22)

26. Attach removable backrest pad (22) to the TearTuff™ mesh backrest with hook and loop attachment strips on the top and bottom of the back of mesh and the left and right sides of the front of the mesh.

### LARGE RATCHET STRAPS (45)

The large ratchet straps (45) that secure the platform and tree blades to the tree will be used later during the Setup and Use instructions, after uprighting the stand.

**NOTE:** Make sure to bring ratchet straps up with you in a pocket. Never carry in your hands!

**STOP**

**READ AND UNDERSTAND THE FOLLOWING WARNINGS BEFORE SETUP AND USE**

### **WARNING**

- ▲ Double check assembly steps to be certain you have correctly assembled this product.
- ▲ Study your new stand to become familiar with all of its features and design. At ground level, following provided use instructions, practice attaching stand to tree and removing stand from tree. Practice sitting, standing, and using this product before attaching overhead. Save these instructions for future reference. You must always use the provided Fall Arrest System (FAS) while using this product.
- ▲ **Always** use at least three (3) people to install or take down a ladder treestand. **Always** have two people stabilize the ladder before climbing to the platform the first time after every set-up.
- ▲ Be absolutely sure the tree blade(s) on stand and the stabilizer bar are contacting tree before climbing ladder.
- ▲ Stabilizer bar must always be correctly and securely attached to ladder and tree before climbing ladder.
- ▲ Make sure ladder bottom is firmly seated on dry, level ground. Attach your harness tether to the tree before securing the platform to the tree and stepping onto platform. Refer to the Full Body Harness instructions.
- ▲ **Never** ascend or descend ladder without criss-cross straps/ropes securely holding ladder to tree and stabilizer bar securely attached. Failure to correctly perform these steps can cause the ladder to collapse/buckle-over backwards during the initial ascent to attach ratchet strap resulting in serious injury or death.
- ▲ **Always** lean forward as you climb and attach your harness to the tree before securing the platform to the tree and stepping onto the platform.

### **WARNING**

- ▲ Be sure only one person ascends or descends ladder at a time. Be certain first person is seated safely, and attached to tree with provided Fall Arrest System (FAS) correctly before second person ascends or descends ladder.
- ▲ **Never** have two people on one side of the platform. Keep weight evenly distributed on platform.
- ▲ **Always** be aware of the other person's position. Use extreme caution when weapons are used to prevent personal injury.

### **WARNING**

- ▲ Bring ratchet strap(s) up with you in a pocket - **Do Not** carry in your hands!

### **WARNING**

- ▲ **Always** maintain three (3) points of contact when climbing a ladder treestand. Proper three-point contact means having either two feet with one hand or one foot with two hands on the step portion of the ladder or climbing aid at all times.
- ▲ **Always** wear the appropriate footwear when using a ladder treestand. A good non-slip safety boot is important to your personal safety. Be especially careful that boot laces do not get hooked on the stand or any of its components (tuck shoelaces into boots before climbing).
- ▲ **Never** stand on seat, it is designed for sitting only.
- ▲ **Do Not** allow excessive strap buildup in ratchet as this will prevent the ratchet teeth from engaging causing slippage.
- ▲ **Always** attach ratchet straps securely while using this product!
- ▲ If seat is removable, be certain it is securely attached when in use.
- ▲ Some models include a shooting rail. **Never** lean against, lean over, or sit on shooting rail. It is designed as a shooting rest only. **Always** be aware that the shooting rail can swing to one side or pivot up and down.
- ▲ Some models include a footrest, which is designed as a footrest only. **Never** stand on footrest! **Always** be fully aware of foot placement.
- ▲ Some models include a multi-piece stabilizer bar system. Be sure attachment hardware goes through both the extension tube and the stabilizer bar.



## SETUP AND USE INSTRUCTIONS

*During installation and removal of ladder treestands, you must always and properly use the included Full Body Harness (Fall Arrest System). Refer to the Full Body Harness instructions included with this product for proper use.*

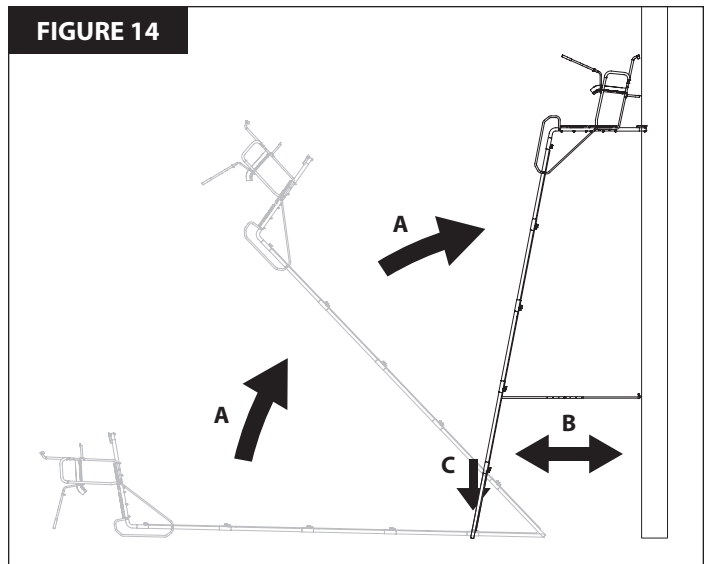
1. Select a straight, healthy tree. Do Not attempt to install on a tree that is not healthy.
2. Place the assembled product lying on the ground in front of the tree with the bottom ladder section approximately five feet away from the base of tree.
3. Position one person at bottom end of ladder. This person has to prevent the ladder end from tilting up and from skidding across the ground when platform end is lifted.
4. Position two people at the platform end of the ladder, lift the platform end and continue uprighting by walking toward bottom end of ladder while moving hands along ladder legs. **Stand ladder up against chosen tree on dry, level ground. Use caution when ladder comes over center against the tree. SEE FIGURE 14 (A).**
5. Once elevated completely, carefully slide the base so that the sitting and standing platforms are parallel to the ground. **SEE FIGURE 14 (B).**
6. Step back and look at the ladder top to see that both the lower platform tree blade and upper tree blade are contacting the tree. Adjust as needed so both of the tree blades are contacting tree.
7. Step down hard on bottom step to push ladder legs into the ground. **SEE FIGURE 14 (C).**
8. Adjust length of stabilizer bar assembly so the bark biting teeth of the stabilizer bar contact the tree. Stabilizer bar should be parallel to the ground. Do Not bow ladder in or out to achieve contact with the tree. Maintain tree blade contact.
9. With the stabilizer bar ratchet strap (47) now in hand, wrap the strap around the tree and feed the long strap through the center slot of ratcheting mechanism. Pull tail of long strap until most of the slack is taken out and ratchet tight so the teeth of the stabilizer bar dig into the tree. **SEE FIGURES 15A, 15B, 15C & 16.**

**NOTE: Be sure to feed the long strap correctly so there are no twists in the strap.**

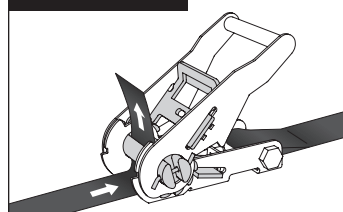
### **WARNING**

- ▲ **Never** use a treestand on a dead, leaning, diseased or loose barked tree, or a utility pole. **Always** avoid electrical power lines.
- ▲ Bring ratchet strap(s) up with you in a pocket - **Do Not** carry in your hands!

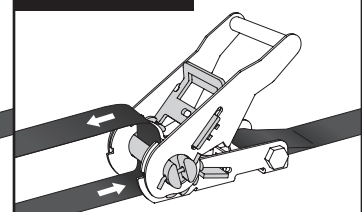
**FIGURE 14**



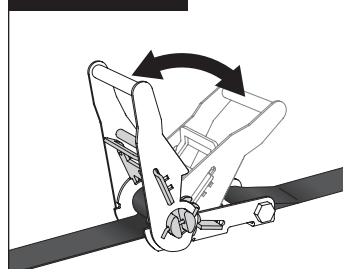
**FIGURE 15A**



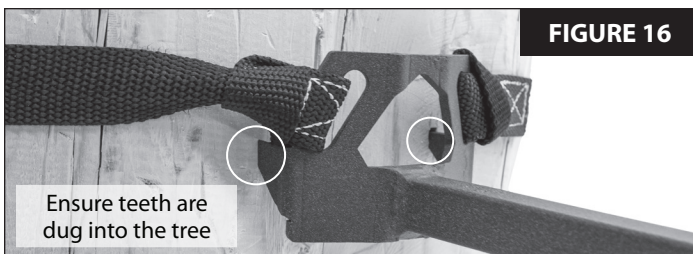
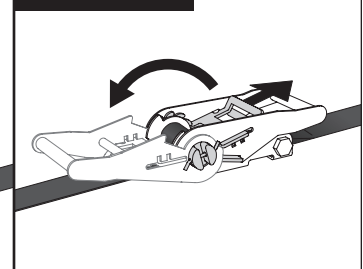
**FIGURE 15B**



**FIGURE 15C**



**FIGURE 15D**



**FIGURE 16**

Ensure teeth are  
dug into the tree



10. Locate the two ratchet portions with S-hooks for the criss cross straps (46).
  - a. With one ratchet portion of the criss cross strap (46) now in hand, feed one long strap hanging down from platform through the center slot of ratcheting mechanism and back around through tightening lever. **SEE FIGURES 15A & 15B.**
  - b. While maintaining contact between long criss cross strap and the tree surface, wrap entire ratchet strap assembly around back side of tree and hook S-hook to the middle opening of stabilizer bar bark biting plate. **SEE FIGURE 17A.**
  - c. Pull the tail of the long strap until most of the slack is taken out. Be sure entire strap is evenly wrapped around tree and ratchet tight to tree. This will securely attach the first of two long ratchet straps to tree. **SEE FIGURES 15B & 15C.**
  - d. Repeat for attachment of the second criss cross strap. **SEE FIGURES 17B & 18.**

**NOTE: It is extremely critical that the criss cross ratchet straps are attached to the stabilizer bar bark biting plate in opposite directions of each other forming a "criss cross" behind the tree. This ground level ladder-to-tree attachment will prevent the ladder from pulling away from the tree while ascending to the top for final ratchet strap attachment. The same holds true when ladder removal is necessary. SEE FIGURE 18.**

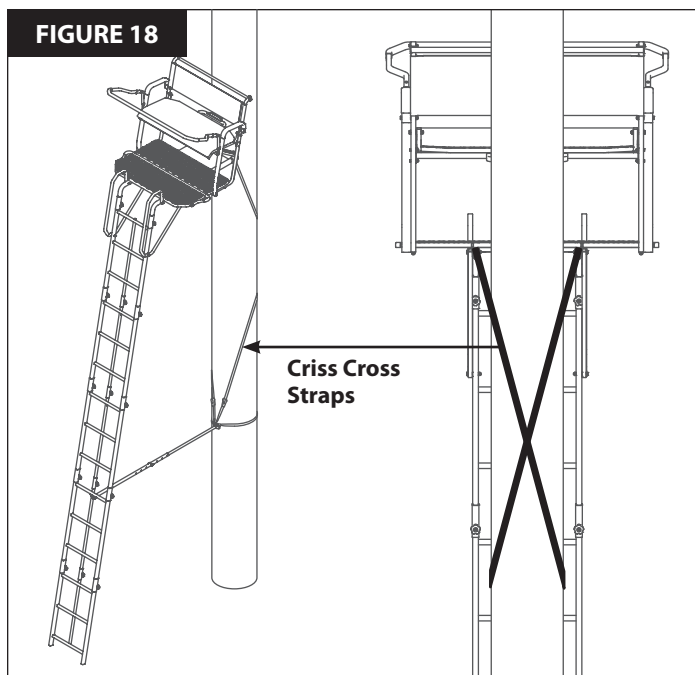
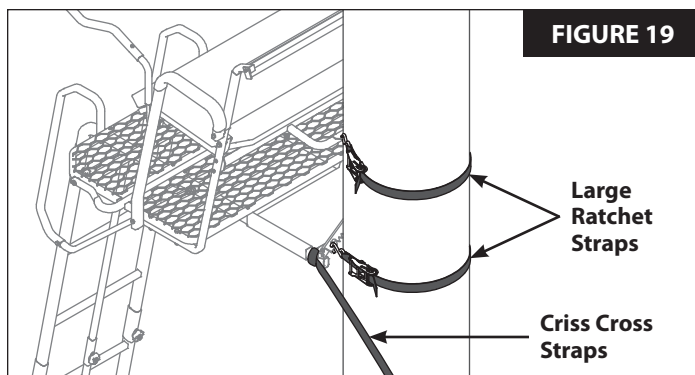
#### LARGE RATCHET STRAPS (45)

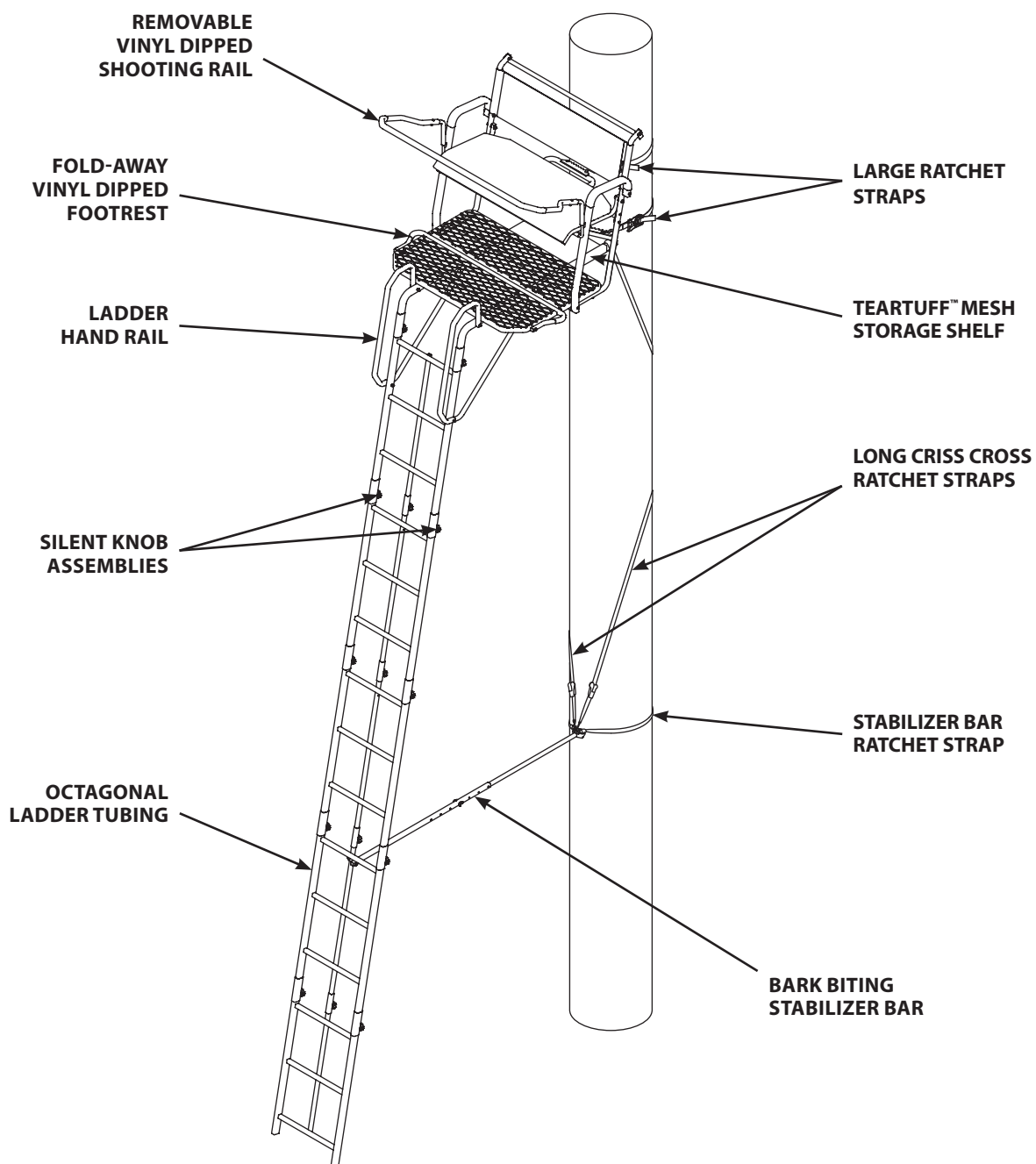
10. With two people securely holding the base of the ladder, use the three point contact climbing method to slowly climb the ladder and carefully keep a constant hand grip on the ladder at all times. Always lean forward, towards the tree, to keep tree blades against the tree. **Be certain ladder bottom is firmly seated on dry, level ground. Attach your harness tether to the tree before securing the platform to the tree and stepping onto platform. Refer to the Full Body Harness instructions included with this product.**

**NOTE: Bring large ratchet straps up with you in a pocket. DO NOT carry in your hands!**

11. Once platform is reached, hook S-hook with long strap through hole provided in upper tree blade frame. Feed the long strap through the center slot of ratcheting mechanism and back around through tightening lever. **SEE FIGURES 15A, 15B & 19.**
12. Wrap the ratchet assembly around the tree and hook other S-hook through opposite tree blade hole. Pull tail of long strap until most of the slack is taken out. Be sure entire strap is even and at the same level all around tree. "Ratchet" tight to tree. This will securely attach only the seat portion to the tree and prevent movement. **SEE FIGURES 15C & 19.**

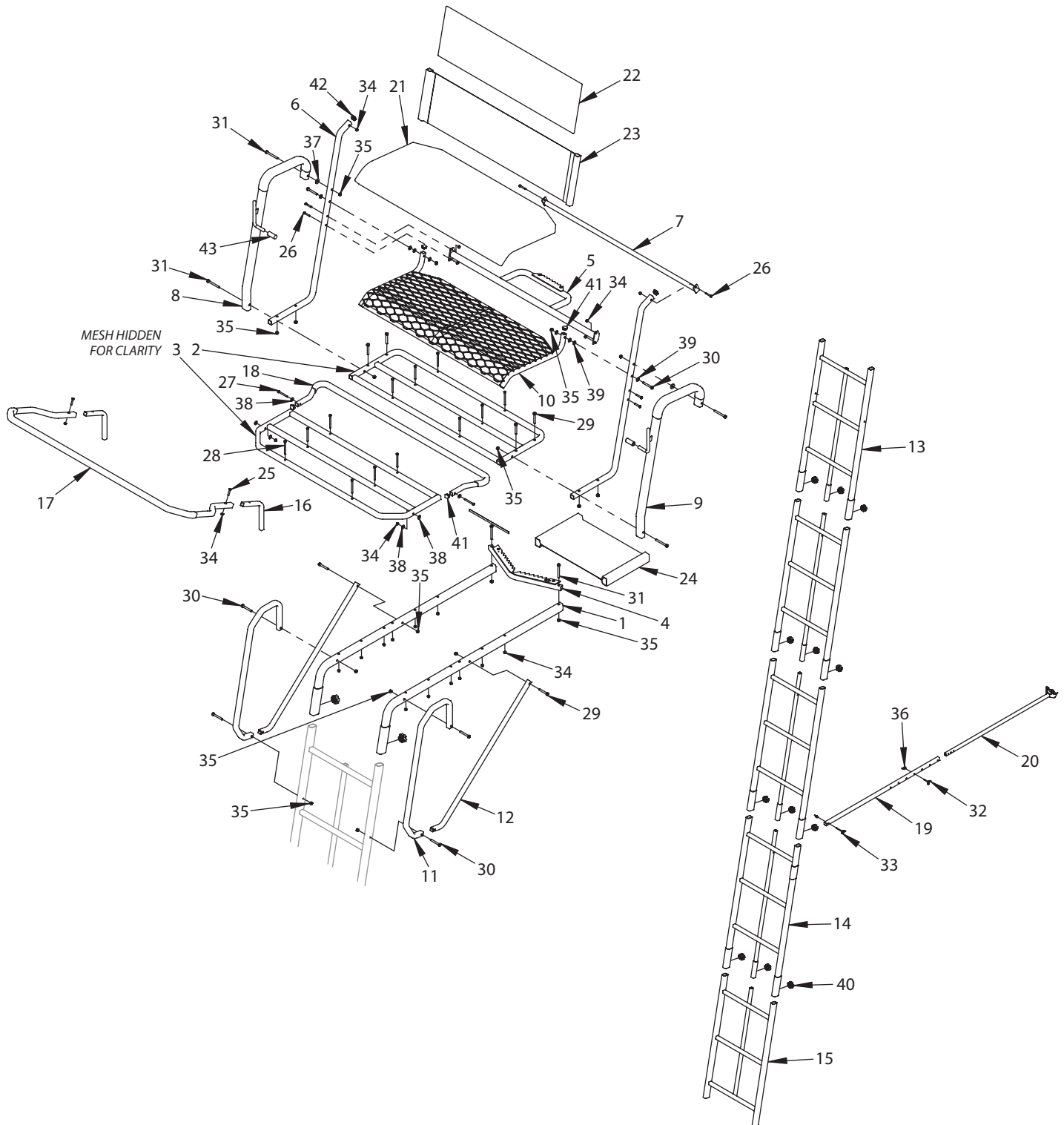
**NOTE: To release ratchet, simply pull the release lever and open tightening lever wide open (flat). SEE FIGURE 15D.**
13. Repeat previous two steps for the platform tree blade attachment. Place S-hook through holes provided on bottom tree blade.
14. Reverse setup and use instructions to take ladder down.


**FIGURE 17A**
**FIGURE 17B**

**FIGURE 18**

**FIGURE 19**

**FINISHED LADDER**

[illegible]

## ILLUSTRATED PARTS BREAKDOWN



## PARTS LIST

ITEM #	PART #	DESCRIPTION	QTY.
1	26376	J TUBES	2
2	26381	PLATFORM REAR	1
3	26382	PLATFORM FRONT	1
4	26490	TREE BLADE LOWER	1
5	26399	TREE BLADE UPPER	1
6	26394	SEAT SUPPORT REAR	2
7	26397	BACKREST SPREADER	1
8	26385	ARMREST RIGHT W/ VINYL DIP	1
9	26386	ARMREST LEFT W/ VINYL DIP	1
10	26391	SEAT	1
11	26374	LADDER HAND RAIL	2
12	26375	PLATFORM BRACE	2
13	26372	TOP LADDER SECTION	1
14	26370	MIDDLE LADDER SECTION	3
15	26368	BOTTOM LADDER SECTION	1
16	26393	SHOOTING RAIL A	2
17	26532	SHOOTING RAIL B W/ VINYL DIP	1
18	26531	FOOTREST W/ VINYL DIP	1
19	48053	TUBE STABILIZER SUPPORT 43.25 IN	1
20	23600	STABILIZER BAR 39 IN	1
21	26401	SEWN SEAT PAD 2 IN	1
22	26403	SEWN BACKREST PAD	1
23	26402	SEWN BACKREST TEARTUFF	1
24	26404	SEWN TEARTUFF SHELF	1

**NO EXTENSIONS AVAILABLE FOR THIS MODEL.  
NEVER MODIFY OR EXCEED ORIGINAL STATED USE HEIGHT!**

ITEM #	PART #	DESCRIPTION	QTY.
25	8909B	BOLT 1/4-20 X 1-1/4IN	2
26	48240B	BOLT 1/4-20 X 1-1/2IN	6
27	48270B	BOLT 1/4-20 X 2-1/2IN	2
28	48280B	BOLT 1/4-20 X 3IN	12
29	27950	BOLT 5/16 X 18 X 2-1/4IN	6
30	53730B	BOLT 5/16-18 X 2-1/2IN	6
31	27966	BOLT 5/16 X 18 X 3-1/4IN	6
32	48044B	SCREW WING 1/4-20 X 1-3/4IN	1
33	48057B	SCREW WING 1/4-20 X 2-1/4IN	1
34	48752B	FLANGE LOCKNUT 1/4IN -20	22
35	60G5NYB	LOCKNUT 5/16IN-18	18
36	48042B	NUT WING 1/4-20	2
37	WF516B	WASHER 5/16 X 7/8 X 5/64IN	4
38	23572	WASHER M6 YELLOW PLASTIC	6
39	23523	WASHER M8 YELLOW PLASTIC	8
40	23603	KNOB SILENT LADDER	14
41	19175	PLUG SQ END 19MM	4
42	23439	PLUG SQ END 22MM	2
43	26512	SEAT STOP RUBBER CAP	2
<b>ITEMS BELOW ARE NOT SHOWN</b>			
44	10531	SAFETY HARNESS / FALL ARREST SYSTEM	2
45	23610	STRAP 1-1/2 IN W/ RATCHET & S HOOKS	2
46	15034	STRAP RATCHET CRISS CROSS	2
47	11058	STRAP RATCHET STABILIZER BAR	1
48	48800	TREE STAND SAFETY DVD	1

# LOCKDOWN™

## LADDER STANDS

by



**WE ARE HUNTERS**

**Rivers Edge® Treestands, Inc.**

1160 Eighth Avenue, PO Box 755  
Cumberland, WI 54829

Phone: 800-450-EDGE (3343)

Fax: 715-822-2124

Email: [info@huntriversedge.com](mailto:info@huntriversedge.com)

\*All weights, specifications and features are approximate and are subject to change without notice. Due to continuous product improvements, product images may not be exact. Warning labels in some product images may have been removed for photography purposes only. Props shown in photos not included. Some assembly may be required.