

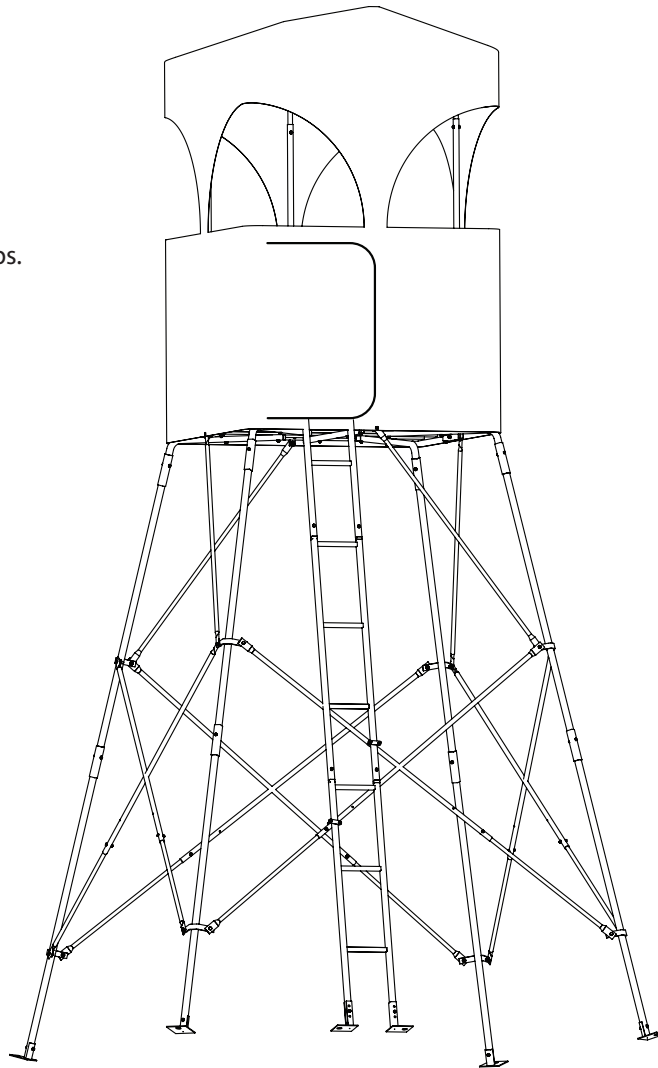

Operator's Manual

# RE703 Outpost™ Tower

Maximum Field Rating - 500 lbs.



PRODUCT MEETS  
INDUSTRY STANDARDS  
RECOGNIZED BY



PARTICIPATING MEMBER

Get parts online at  
[www.HuntRiversEdge.com](http://www.HuntRiversEdge.com)



P/N: 27306  
REV1: 03/23/17  
© 2017 RETI  
All Rights Reserved

## INTRODUCTION

Rivers Edge® Treestands are engineered with you, the hunter, in mind. We appreciate your purchase of one of our world class treestands. Follow these few simple instructions and your stand will provide you many years of trouble-free pleasure. Instructions should be kept in a safe place and reviewed at least annually. If for any reason you have a problem with your product, **DO NOT return to the retailer**, contact the Rivers Edge® customer service department at 800-450-EDGE (3343) for assistance.

## CONTENTS

|  |       |
|--|-------|
| Introduction/Warranty .....              | 2     |
| Warnings.....                            | 3-4   |
| Inspection and Maintenance Schedule..... | 4     |
| Assembly and Use Instructions .....      | 5-13  |
| Uprighting and Use Instructions .....    | 14    |
| Illustrated Parts Breakdown.....         | 15-17 |
| Bolt Identification Chart.....           | 18    |
| Notes Page.....                          | 19    |

### WARRANTY

RETI offers a one year warranty for all components of the treestand. These warranties apply to the original owner with a proof of purchase. These warranties begin on the date of purchase by the first retail consumer and continue for the period specified above. These warranties apply to products that are not modified, abused or used in a manner that deviates from the product's intended usage. Minor fading in color is normal and is not covered by warranty. Any corrosion of painted surfaces that occurs as a result of paint being removed or damaged is also not covered by warranty. RETI offers no other warranty expressed or implied. Products for which warranty work has been approved must be sent directly to RETI and performed by RETI. **To obtain warranty service and/or replacement instructions, you must obtain prior approval from RETI before shipping your package to us by calling our customer service department at 800-450-3343 or by writing to: RETI, P.O. Box 755, 1160 Eighth Avenue, Cumberland, WI 54829 for a return material authorization number (RMA#).** All items must be shipped prepaid. RETI will, at no charge, repair or replace, in RETI's sole discretion, any product that satisfies the conditions stated above. RETI retains the right to change models, specifications and price without notice.

This equipment has been manufactured under strict quality and safety guidelines. As with any equipment of this type, full understanding of the instructions and its use is mandatory and imperative for the safety of its user. RETI is not responsible for any damages or injuries sustained due to improper use or modification of any of its products, or resulting from any use which deviates from the product's intended usage. RETI is not responsible for any injuries sustained due to failure to read and adhere to the instructions for use. Any misunderstanding or questions regarding the products of their use should be directed to RETI prior to any use. It is the owner's sole responsibility to inspect the product regularly for damage, improper installation, or conditions that could jeopardize the ultimate safety of the product. **Owner is responsible to understand and follow product field weight rating and must never exceed maximum weight rating.** RETI is not responsible for any malfunction or injury resulting from normal wear and tear, damage caused by improper use, improper maintenance, negligence or accidents. This product, if used safely as intended, will provide trouble free service for the useful life of the product. We hope you will enjoy the quality of our products for years to come, and have a safe hunt.

## MODEL RE703

**MAXIMUM USE HEIGHT - 12' 8" TO SHOOTING RAIL**

**MAXIMUM OCCUPANCY - TWO (2)**

**TOTAL WEIGHT LIMIT - 500 LB (300 lb Per Person Max)**

### WARNING

- ▲ This product carries strict height and weight restrictions. **Do Not** use this product if you exceed the total weight limit. Please note that the total weight limit includes the user(s) and their equipment.

### WARNING

- ▲ **When hunting from a treestand or free standing platform stand falls can occur any time after leaving the ground causing injury or death.**
- ▲ **Read and understand** all of the manufacturer's Warnings and Instructions and use all safety devices provided by the manufacturer. Contact the manufacturer for any questions. Failure to do so could result in injury or death.
- ▲ **Never** exceed the total weight limit of the treestand or free standing platform stand.
- ▲ **Never** use a treestand or free standing platform stand during inclement weather such as rain, lightning, windstorms or icy conditions and end your hunt and return to the ground if inclement conditions arise.
- ▲ **Never** use a treestand or free standing platform stand while using drugs (even prescription drugs) or alcohol.
- ▲ **Never** use a treestand or free standing platform stand while feeling ill, nauseous or dizzy, or if you have a prior medical condition that could cause a problem, that is, heart condition, joints that lock-up, spinal fusions, etc., or if you are not well rested. **Never** sleep in stand.
- ▲ **Always** avoid electrical power lines.
- ▲ **Never** rely on a tree branch for support.
- ▲ **Never** jump or bounce on a treestand or free standing platform stand to seat it to the tree or ground.
- ▲ Pull up a bow, backpack, or firearm or other equipment only after being secure in the treestand or free standing platform stand and a firearm must be pulled up with it unloaded, chamber open, and muzzle down.
- ▲ **Always** inform someone of the hunting location, where the treestand or free standing platform stand will be located and the expected duration of the hunt.

### WARNING

- ▲ A signal device such as a mobile phone, radio, whistle, signal flare or personal locator device (PLD) must be on your person and readily available at all times.
- ▲ Inspect the treestand or free standing platform stand and all safety devices each time before use and **Do Not** store a treestand or free standing platform stand outdoors when not in use.
- ▲ **Never** modify your treestand or free standing platform stand in any way by making repairs, replacing parts, or altering it except if explicitly authorized in writing by the manufacturer.
- ▲ Practice installing, adjusting and using your treestand or free standing platform stand at ground level prior to using it at elevated positions. Study your new stand to become familiar with all of its features and design. Doing so will confirm that the product is manufactured, assembled and installed correctly.
- ▲ Instructions (written and video) shall be kept in a safe place and reviewed at least annually. It is the responsibility of the treestand or free standing platform stand owner to furnish the complete instructions to any person who borrows or purchases the treestand or free standing platform stand.
- ▲ **Always** use at least four (4) people to install or take down a free standing platform stand.
- ▲ Stabilization devices must be attached before climbing to the platform.
- ▲ When installing a ladder stand or free standing platform stand, always bounce on the first rung to set the ladder into the ground according to manufacturer's instructions before proceeding to climb any higher.
- ▲ Check every ladder/leg section connection every time you use the stand before you leave the ground. If ladder/leg sections are separating, do not use the stand.
- ▲ Check the ground under the stand to make sure it is firm and level. Sloping ground or uneven surface (one side on a rock) can cause your ladder or free standing platform stand to tilt or shift off as you climb.
- ▲ **Always** maintain three (3) points of contact when climbing a ladder treestand or free standing platform stand. Proper three-point contact means having either two feet with one hand or one foot with two hands on the step portion of the ladder or climbing aid at all times.
- ▲ **Always** lean forward as you climb ladder or climbing aid.
- ▲ **Never** exceed the stated maximum use height.

## WARNING

- ▲ **Do Not** use this product until you have watched the included treestand safety DVD, understand it, and practiced the techniques for safe hunting discussed in this DVD.
- ▲ Read and perform all inspection and maintenance tasks before each and every use. Replace any questionable components immediately with RETI original replacement parts.
- ▲ **Do Not** crush tubing when tightening bolt assemblies! Identify and familiarize yourself with all parts before you start. Bolt identification chart can be found in the back.
- ▲ Double check assembly steps to be certain you have correctly assembled this product.
- ▲ **Never** use any product that has not been maintained or inspected properly - Your life depends on it!
- ▲ **Always** wear the appropriate footwear when using a free standing platform stand. A good non-slip safety boot is important to your personal safety. Be especially careful that boot laces do not get hooked on the stand or any of its components (tuck shoelaces into boots before climbing).
- ▲ Do not position this product on a slope, unlevel, or wet ground. It may tip over and serious injury or death may occur.
- ▲ Ground should be such that ground stakes (not included) can be driven into the ground through holes provided in foot pads. This will help prevent pod from tipping over in strong winds. You will need to make or purchase (4) ground stakes. Stakes should be 3/8 inch rod x 24 inches long.

## INSPECTION AND MAINTENANCE SCHEDULE

### BEFORE EACH USE PERFORM THE FOLLOWING:

- Inspect all webbing, rope, cord, and strap assemblies for wear or damage.
- Inspect cables and/or cable ends for damage or kinking.
- Inspect all hardware and chain components for damage.
- Inspect for any structural damage to product. (If any exists call RETI customer service.)
- Inspect all nut and bolt assemblies to be certain none are loose.
- Inspect for any missing parts.
- Lubricate all pivot and slide together points with powder graphite, petroleum jelly or silicone spray to prevent noise, wear and rust.
- Inspect entire product for any rust, corrosion, cracks, freezing, excessive heat or rotting damage that may effect the safety of your product. Discard any questionable product.
- Inspect entire product for any structural damage - pay close attention to all weld locations. (Return to factory for repair or discard product if any damage is found.)
- Using correct wrenches inspect all nut & bolt assembly locations and snug up any that may be loose. Be careful not to crush tubing when tightening!
- Inspect and check operation of all cables, cable ends, cord, rope, webbing, and strap or chain assemblies. Replace with factory new any item or assembly that shows signs of wear, damage, kinking, or functions incorrectly.
- Inspect seat. Replace any seat with factory new that shows signs of structural damage or wear.
- Inspect all hardware for wear or damage, also be sure you have no missing parts.
- Never modify your stand in any way by making repairs, replacing parts, or altering adding or attaching anything to it except if explicitly authorized in writing by the manufacturer.

## ASSEMBLY AND USE INSTRUCTIONS:

### SELECTING A GOOD LOCATION

Assemble this product only in areas that meet the following criteria! No overhead power lines near area; open, flat, level, dry ground of sufficient size to allow for assembly, uprighting and climbing. Approximate area needed for this is 14' X 24'.

### ASSEMBLY INSTRUCTIONS

Tools needed – two 10 mm wrenches, two 13 mm wrenches and a tape measure to measure level ground area needed & cross brace length.

**NOTE: It is highly recommended that as much assembly as possible be done in a garage setting because of hardware amount and time involved! Allow between two and four hours for assembly.**

### IMPORTANT ASSEMBLY NOTE:

**Do not tighten any nut and bolt combinations completely until all parts are assembled together! Finger tighten plus one turn of a wrench only! This will temporarily hold the lock nut on the bolt while helping alignment of all parts! After all parts are assembled together, all nut & bolt combinations must be completely tightened.**

1. Attach the (2) platforms (TWR15) together using (2) provided M8 x 1.25 x 65 mm bolts and locknuts. **SEE FIGURE 1. DO NOT tighten all nut & bolt assemblies completely!**
2. Attach the center platform joiner tube (TWR32) to the bottom of assembled platforms using (4) provided M8 x 1.25 x 65 mm bolts and locknuts. **SEE FIGURE 1.**
3. Attach (2) outside platform joiner tubes (TWR31) to the bottom of assembled platforms using (4) provided M8 x 1.25 x 65 mm bolts and locknuts. **SEE FIGURE 1.**
4. Attach (4) leg receivers (TWR25) to the bottom four corners of platform using (8) provided M8 x 1.25 x 65 mm bolts and locknuts. **SEE FIGURE 2.**

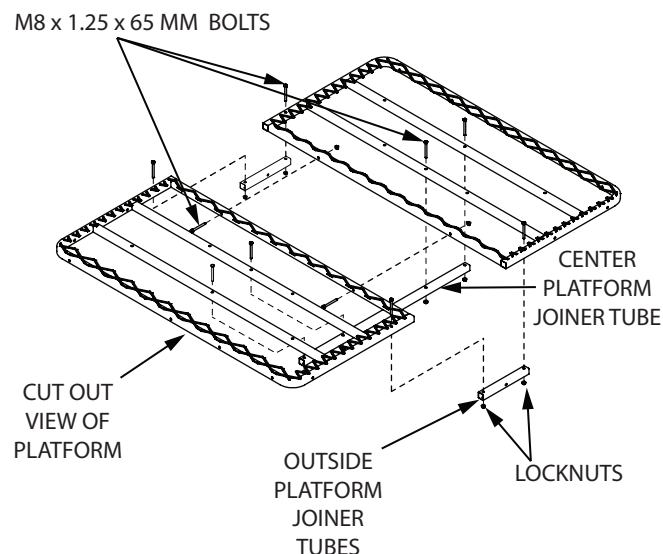

FIGURE 1

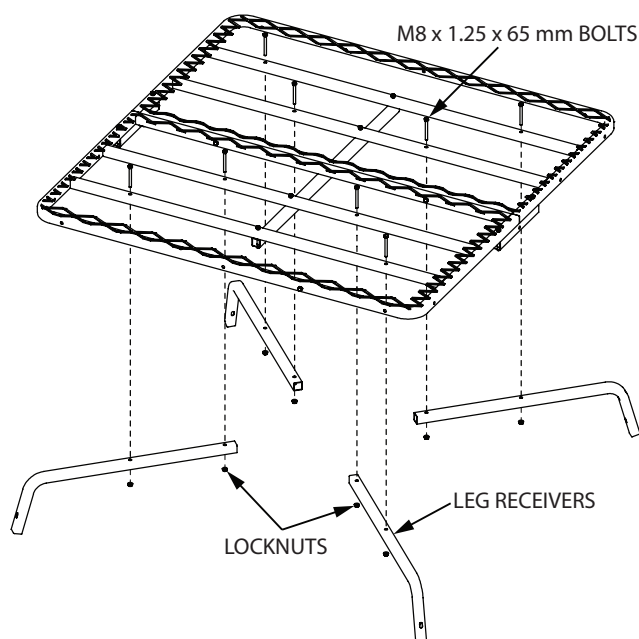

FIGURE 2

5. Attach (2) blind uprights (TWR18) to the long sides of both platforms using (2) provided M8 x 1.25 x 65 mm bolts and locknuts. **SEE FIGURE 3**

6. Attach remaining (2) blind uprights (TWR18) to the outside platform joiners using (2) provided M8 x 1.25 x 65 mm bolts and locknuts. **SEE FIGURE 4**

7. Attach (4) upright support flat bars (SL8) to the blind uprights and platform using (8) provided M6 x 1.0 x 40 mm bolt, locknuts and (4) washers. **SEE FIGURE 3 & 4**

**NOTE: Bolt heads should be inserted as shown in figures. This will help prevent unnecessary wear or interference to the fabric blind.**

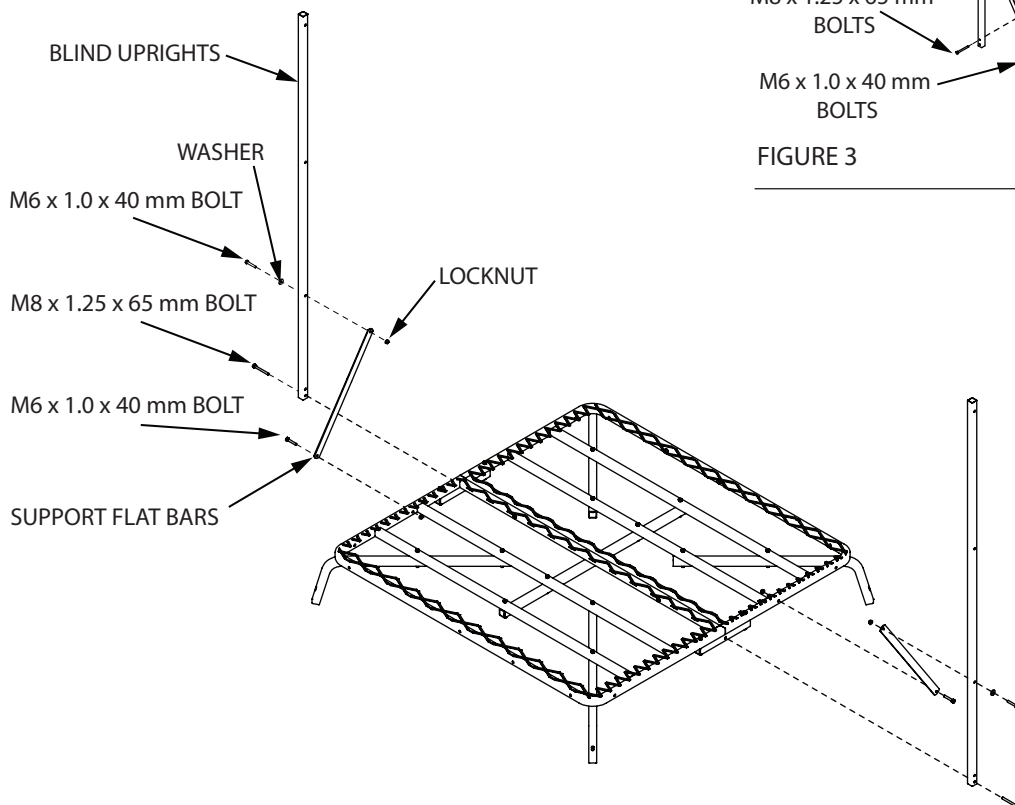

FIGURE 4

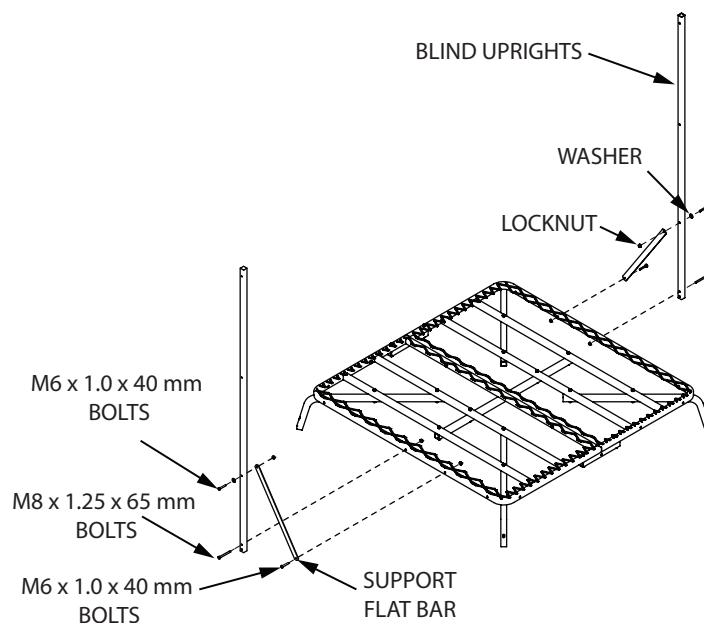

FIGURE 3

8. Assemble Blind Rim Rail As follows:

a. Insert (2) blind rim rails (TWR19) into (2) rail spanner tubes (TWR26) forming a square. Align the four holes and insert (4) provided M6 x 1.0 x 35 mm bolts, locknuts and washers. **SEE FIGURE 5**

b. Assemble this square to the inside the four blind uprights by attaching (2) rail spanner tubes to the two blind uprights that are attached to the outside platform joiner using (2) provided M6 x 1.0 x 55 mm bolts, locknuts and washers. **SEE FIGURE 6**

c. Attach the two blind rim rails to the two blind uprights that are attached to the long side of both platforms using (2) provided M6 x 1.0 x 55 mm bolts, locknuts and washers. **SEE FIGURE 6**

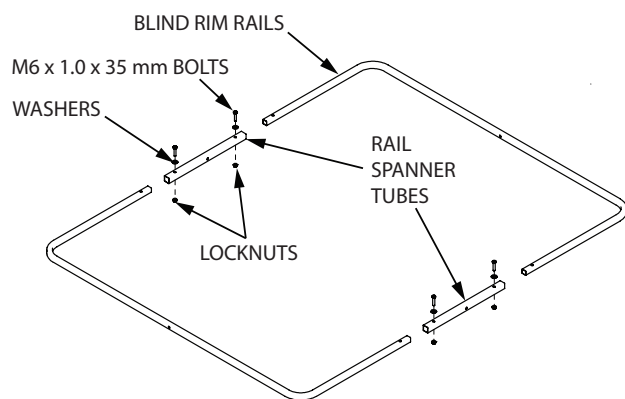

FIGURE 5

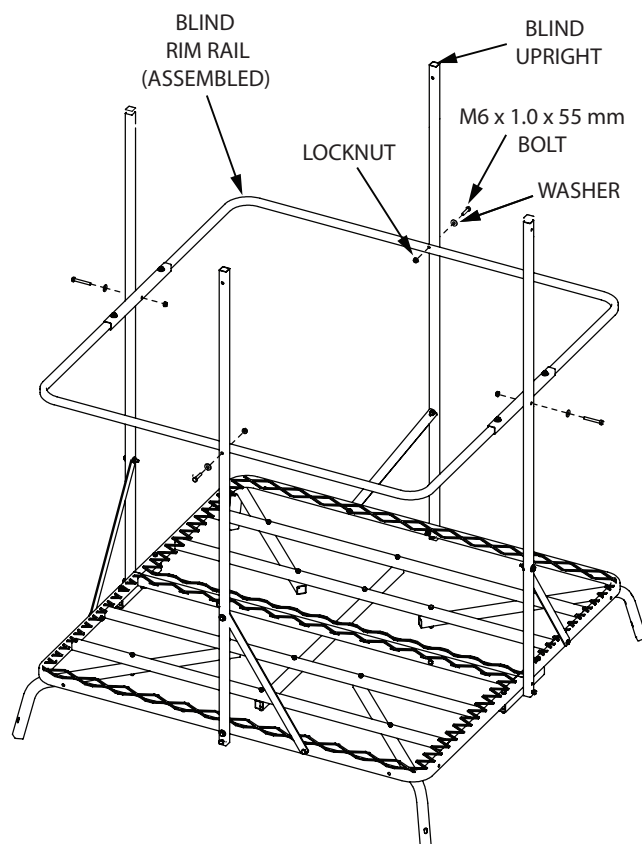

FIGURE 6



9. Insert (2) rail extension tubes (TWR27) into the two blind uprights that are attached to the outside platform joiner using (2) provided M6 x 1.0 x 35 mm bolts, locknuts and washers. **SEE FIGURE 7**
10. Insert blind roof rail (TWR28) into the two blind uprights that are attached to the long side of both platforms using (2) provided M6 x 1.0 x 35 mm bolts, locknuts and washers. **SEE FIGURE 7**
11. Assemble Blind Sections as follows:
  - a. Insert (2) blind rim rails (TWR19) into (2) rail spanner tubes (TWR26) forming a square. Align the four holes and insert (4) provided M6 x 1.0 x 35 mm bolts, locknuts and washers. **SEE FIGURE 7**
  - b. Assemble this square to the inside the rail extension tubes and blind roof rail by attaching (2) rail spanner tubes to the blind roof rail using (2) provided M6 x 1.0 x 55 mm bolts, locknuts and washers. **SEE FIGURE 7**
  - c. Attach the two blind rim rails to the two rail extension tubes using (2) provided M6 x 1.0 x 55 mm bolts, locknuts and washers. **SEE FIGURE 7. You must now tighten all nut & bolt assemblies. Be sure not to over tighten or crush tubing when tightening!**

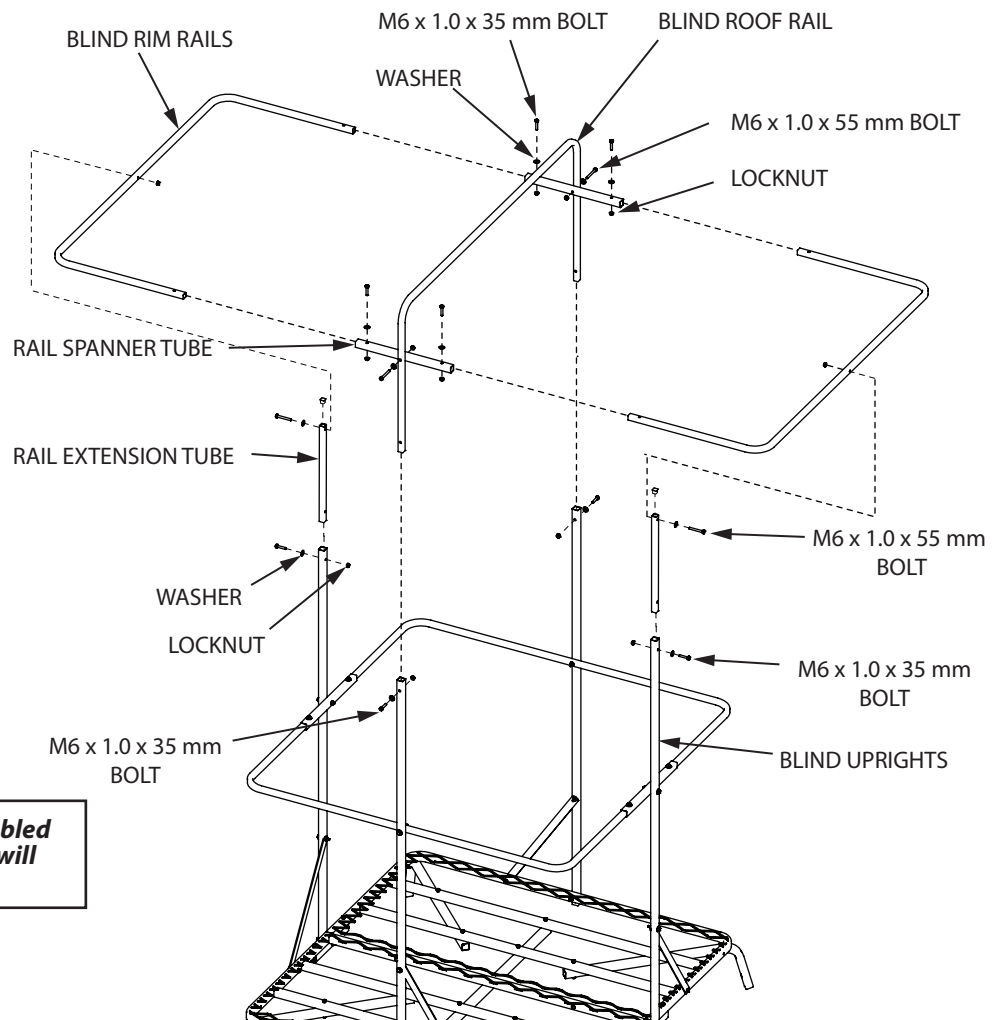

FIGURE 7



12. Attach foot pads (TP113) to four of the eight leg sections (TWR20) using (4) provided M8 x 1.25 x 40 mm bolts and locknuts. **SEE FIGURE 8.** This step now makes these four legs, the bottom section legs.

**NOTE: Be sure foot pads are oriented correctly in relation to the welded on bracket of leg section. Channel on foot pads should cradle on three sides of the leg sections. SEE FIGURE 8**

13. Insert each of the four remaining (top) leg sections into the bottom leg sections by inserting into pocketed end of bottom leg section. Attach each section together using (4) M8 x 1.25 x 40 mm bolt and locknut. **SEE FIGURE 8**

**NOTE: Be sure the welded on brackets on each leg section are oriented correctly in relation to each other. SEE FIGURE 8**

14. With assembled platform section laying on its side, insert all four assembled leg sections onto each leg receiver J-pipe using (4) provided M8 x 1.25 x 40 mm bolts and locknuts. **SEE FIGURE 8**

**NOTE: Be sure the foot pads are oriented outward from the platform. SEE FIGURE 8**

**! WARNING**

**▲ Only** use approved RETI parts. Failure to do so may result in serious injury or death!

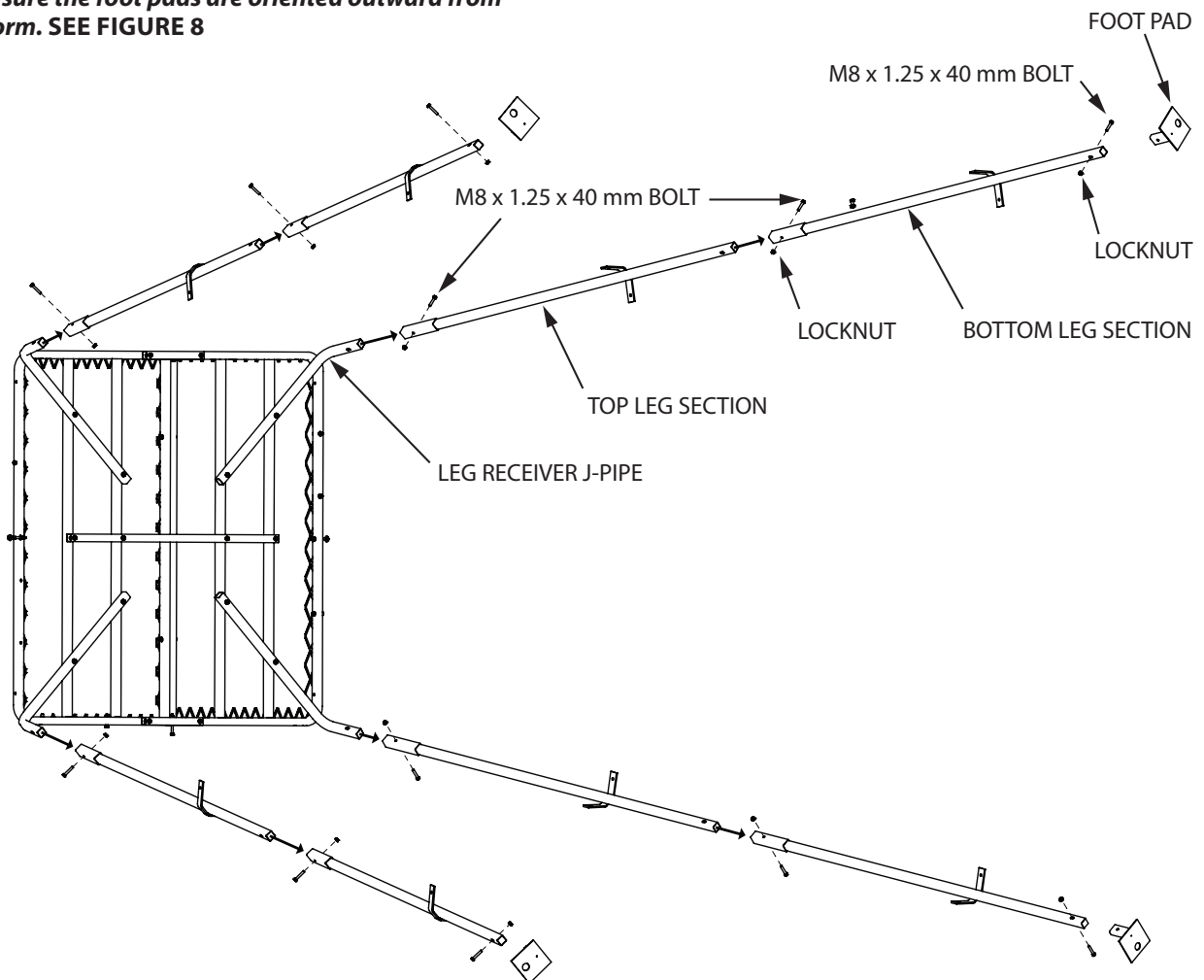

FIGURE 8

15. Assemble Cross Braces as follows:

- Locate the (8) male cross braces (TP132) and the (8) female cross braces (TP131). Insert the male cross braces into the female cross braces.
- Using (8) provided M6 x 1.0 x 30 mm bolts and locknuts, secure the cross braces in the hole location listed in **FIGURE 9**. When assembled together, all eight cross brace assemblies should measure approximately 88-3/4" from end to end.

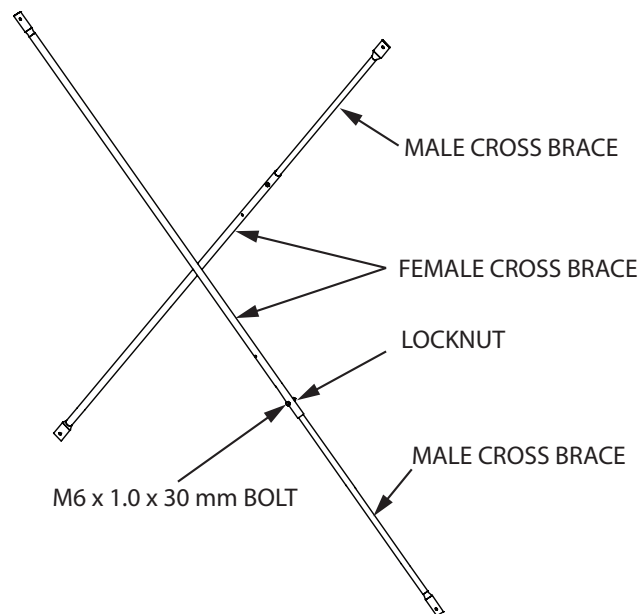

FIGURE 9

16. Assemble Double Flat Braces as follows:

- Attach (2) double flat braces (TP135) to the bottom hole of each blind upright (TWR18) that is already attached to the long side of each platform using (2) provided M8 x 1.25 x 40 mm bolts and locknuts. **SEE FIGURE 10**
- Attach remaining (2) double flat braces to blind uprights/platform joiner tubes using (2) provided M8 x 1.25 x 65 mm bolts and locknuts. **SEE FIGURE 10**

**NOTE:** You will use the same M8 x 1.25 x 65 mm bolt and locknut that is already holding the blind uprights to the platform joiner tubes.

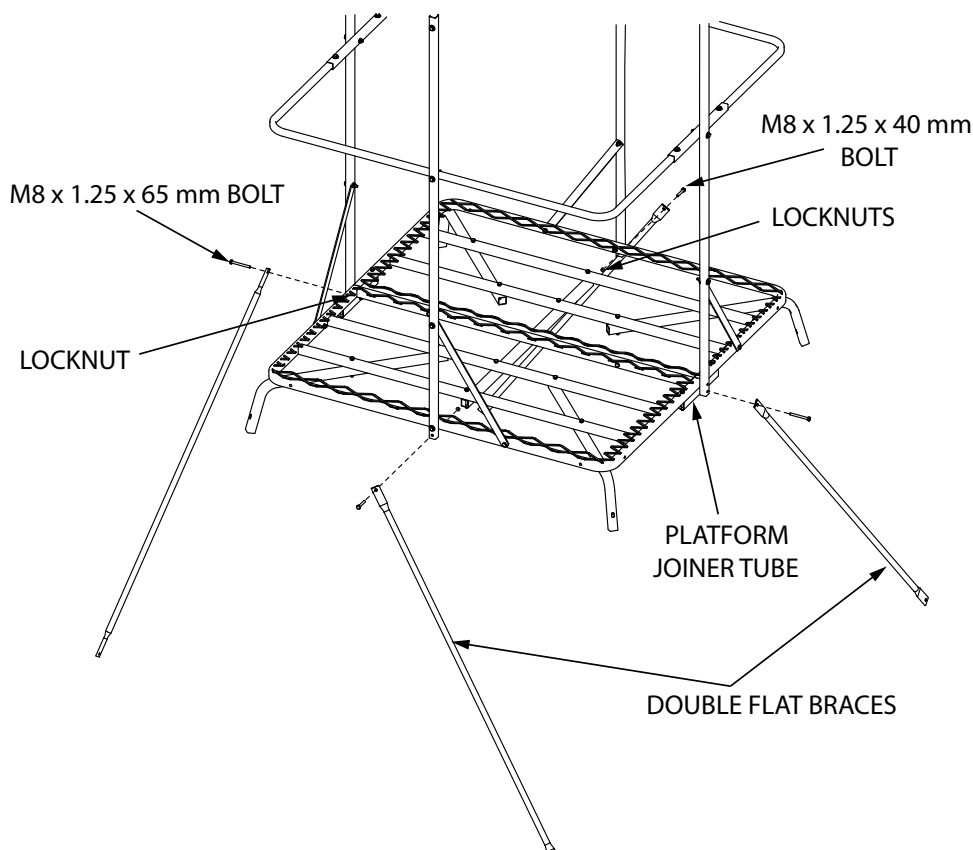

FIGURE 10

17. Install Cross Braces as follows:

- a. Attach the opposite end of all four double flat braces to the wing bracket of each top leg section using (4) provided M8 x 1.25 x 25 mm bolts and locknuts. **SEE FIGURE 11**

**IMPORTANT ASSEMBLY NOTE:**

**Be sure to use M8 x 1.25 x 25 mm bolts at any location where multiple cross brace poles are attached!**

- b. Attach (2) cross brace assemblies to wing brackets of leg sections, on each side of the tower (8 total cross brace assemblies), using (16) M8 x 1.25 x 25 mm bolts and locknuts. **SEE FIGURE 11**

**NOTE: You will use the M8 x 1.25 x 25 mm bolts and nuts that are already holding the double flat braces.**

18. Once all cross braces are attached to tower legs, **you must now tighten all nut & bolt assemblies. Be sure not to over tighten or crush tubing when tightening! Double and triple check all nut and bolts to make sure all are securely fastened.**

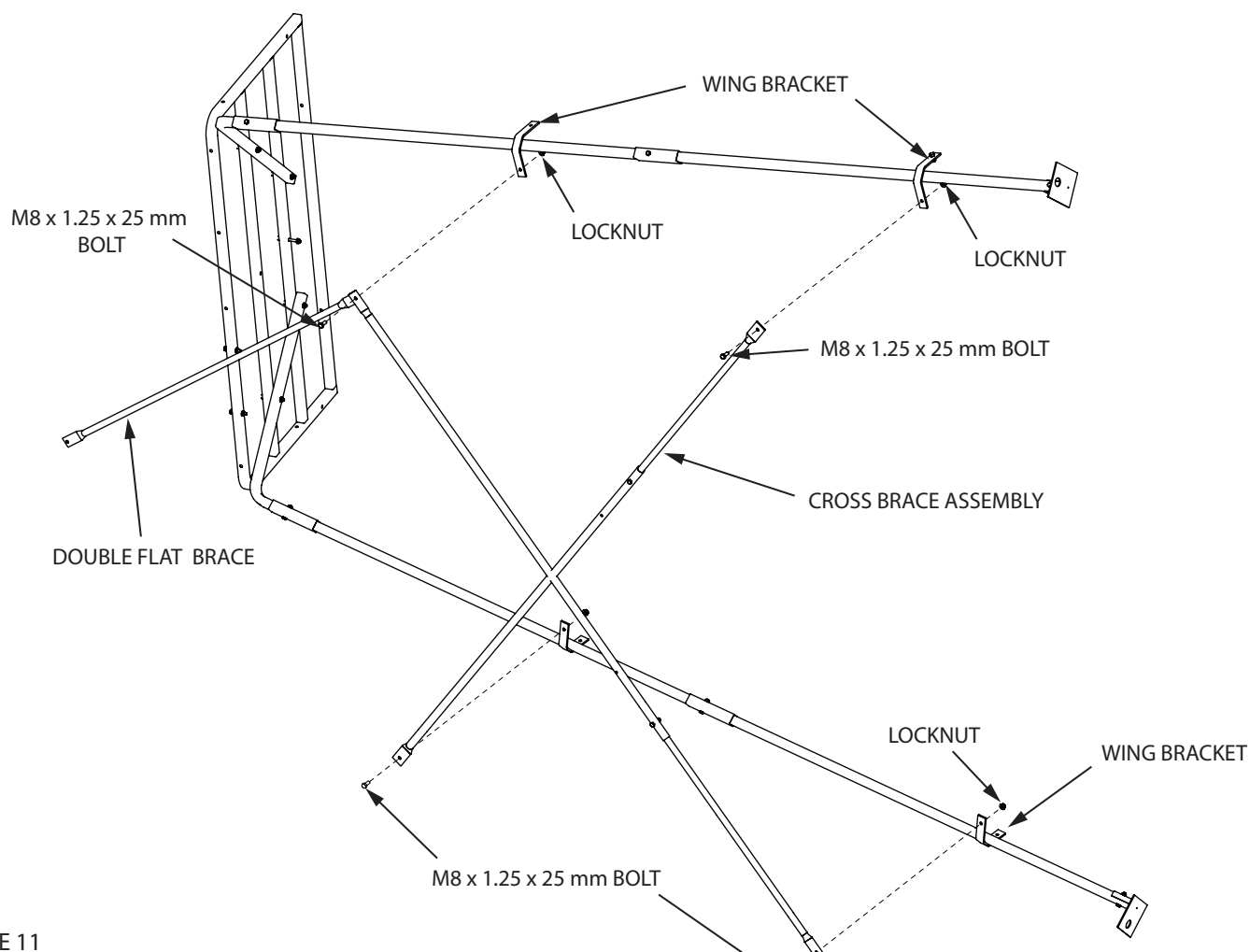

FIGURE 11

19. Assemble the (3) ladder sections on the ground in the following order: bottom section (AL1 ladder); second section (AL3 ladder); top section (TWR21 ladder).

**SEE FIGURE 12**

20. With all ladder sections assembled together on ground, secure all sections together using (4) provided M6 x 1.0 x 35 mm bolts and locknuts. **SEE FIGURE 12**

21. Attach the (2) height adjuster feet (TWR41) to the bottom ladder section using (2) provided M6 x 1.0 x 40 mm bolts and lock nuts. **SEE FIGURE 12**

**NOTE: Adjustment in height may be needed when tower is uprighted later in instructions. Channel on adjuster feet should cradle on three sides of the ladder leg sections.**

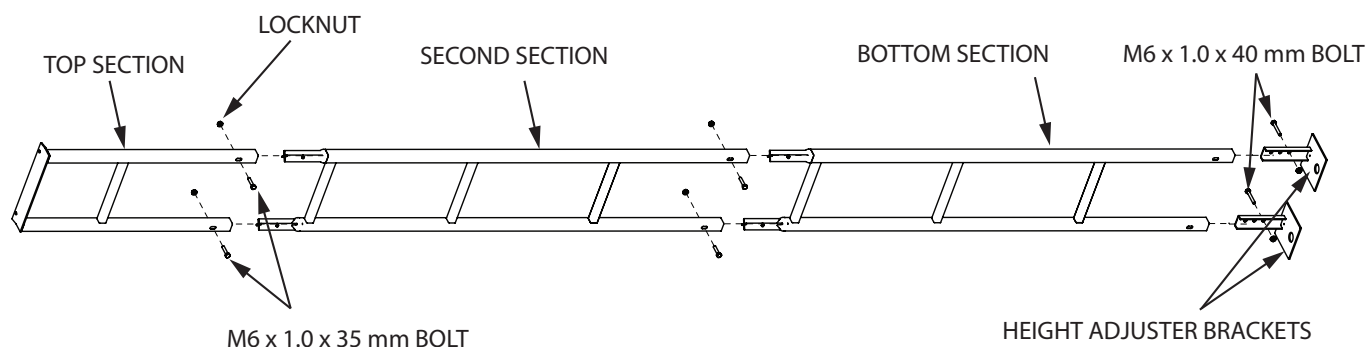

FIGURE 12

22. Attach assembled ladder to the platform using (2) provided M8 x 1.25 x 40 mm bolts and locknuts. See figure 13. Plate of top ladder section should be mounted on top side of platform.

**NOTE: Ladder can be bolted to long side of either platform, they are the same.**

23. Attach the ladder assembly to the cross braces using the (2) provided U-bolts/backup plates/nyloc nuts and tighten securely. This will hold the ladder securely to the cross braces. See figure 13.
24. Go over every detailed step of assembly to be sure all assembly is done correctly and all bolt locations are secured and snug. Be sure not to over tighten or crush tubing when tightening!
25. The camo blind cover (48028) can now be positioned over the upper frame work.

**NOTE: Supporting platform end of tower slightly off ground will be needed to slide blind over frame work.**

- Locate the door opening and align it with the top of the ladder.
- Stretch sewn in bungee cord on bottom edge of blind around platform corners/edges to get a snug fit.
- The webbing straps in each corner can be fed around the platform J-pipes and back through platform mesh. Feed long strap through tri-slide. Pull strap tight so blind will be attached to platform. Repeat for all 4 corners of blind.
- The Velcro straps located on each side can be fed around the platform frame and back through platform mesh and secured.



## WARNING

▲ **Only** use approved RETI parts. Failure to do so may result in serious injury or death!

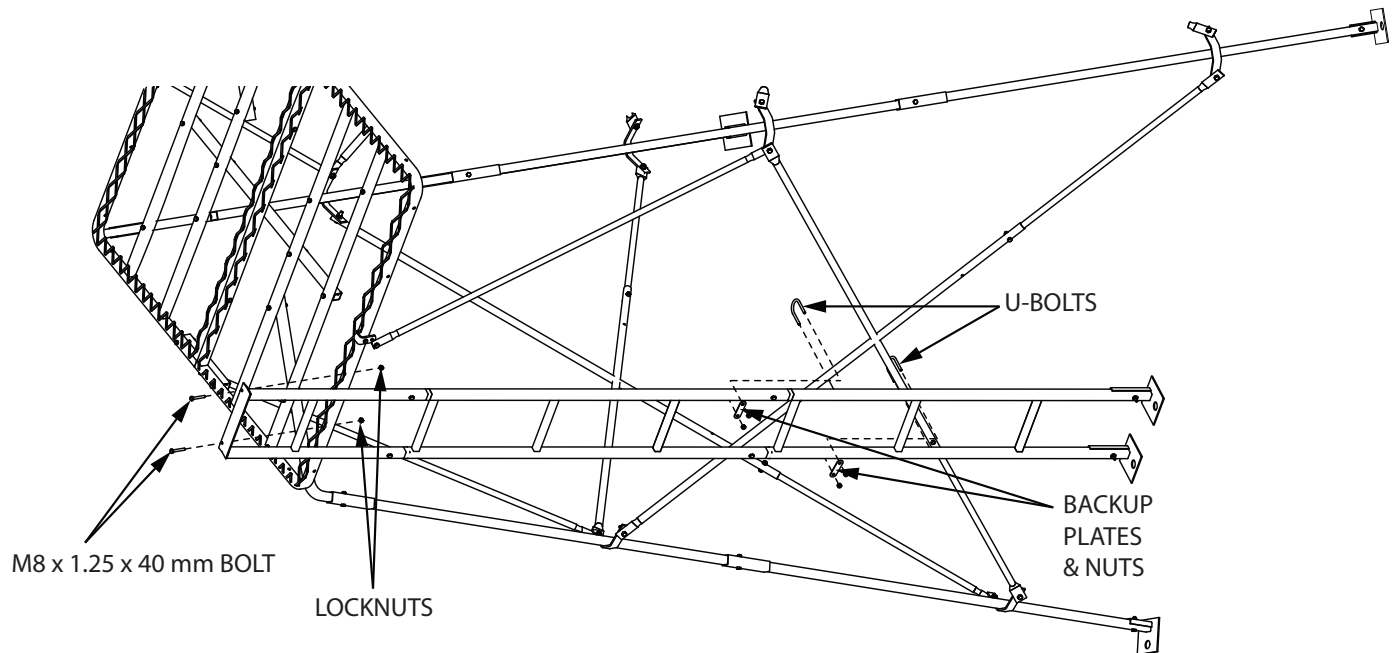

FIGURE 13

## UPRIGHTING AND USE INSTRUCTIONS

1. With assembled product lying on ground, position two people at feet end of tower laying on ground. These people have to prevent the bottom end from tilting up when platform end is lifted and prevent feet from skidding across the ground.
2. Position two people at platform end, lift platform end of tower and continue uprighting by walking toward feet end and moving hands along leg sections. As tower goes over-center, slowly allow the tower to land on the opposite legs section. Be sure all people are clear to prevent injury.
3. Tower may need to be positioned to allow for a level stand and all legs touching ground. Avoid rocks or anything that may hinder this from happening. Only move tower with four people, one on each leg. Each person should lift equally and only enough to shift tower to a level ground location. **DO NOT lift tower by round cross braces as you could bend or damage them.** The ladder height adjuster brackets may need to be repositioned so they contact the ground firmly.
4. Drive (4) ground stakes (not included) through the holes in the (4) feet. Stakes should be approximately 24" in length with 18" in ground and should be driven in at an angle. **SEE FIGURE 14**
5. Climb ladder slowly and carefully keeping a constant hand grip on ladder at all times. Lean forward, towards ladder as you climb. Be sure hands are free for climbing. Continue up onto the platform.
6. Unzip access door for entry. Door may be zipped closed once inside blind. Windows can be configured in multiple positions for versatility.
7. **REVERSE UPRIGHTING AND USE INSTRUCTIONS TO TAKE TOWER DOWN.**

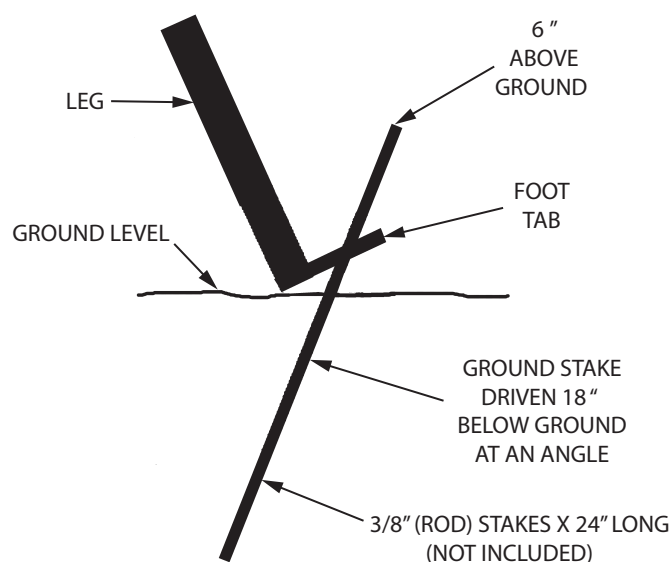
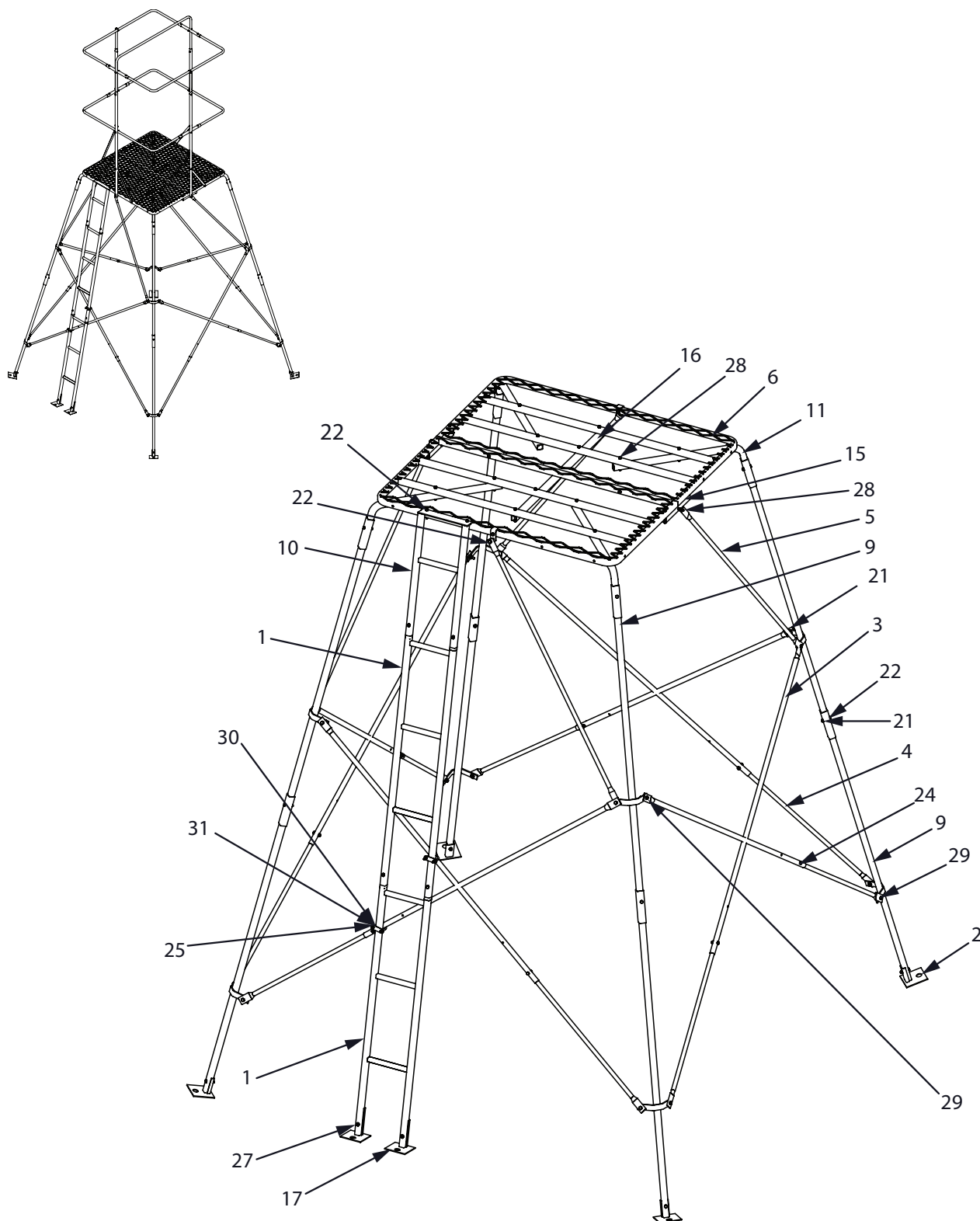

FIGURE 14

### **! WARNING**

- ▲ Double check assembly steps to be certain you have correctly assembled this product.
- ▲ Study your new stand to become familiar with all of its features and design. Save these instructions for future reference.
- ▲ **Be Sure** uprighting area is open, flat, level, and dry with no power lines near!
- ▲ **Always** use at least four (4) people to install or take down a free standing platform.
- ▲ **Do Not** use any type of motorized vehicle to upright this free standing platform stand. You could cause unnecessary damage to this product. Upright by hand only using four people, two people at feet end of free standing platform stand and two people at platform end. Be aware it is top heavy. Use great care and caution during this process to prevent an off balance fall to prevent injury.
- ▲ As free standing platform stand goes over-center, be sure to slowly allow the stand to land on the opposite leg sections. **Be Sure** all people are clear to prevent injury.
- ▲ **Never** stand on seat, it is designed for sitting only.
- ▲ If seat is removable, be certain it is securely attached when in use.
- ▲ **Always** lean forward as you climb ladder or climbing aid.
- ▲ **Always** maintain three (3) points of contact when climbing a ladder treestand or free standing platform stand. Proper three-point contact means having either two feet with one hand or one foot with two hands on the step portion of the ladder or climbing aid at all times.
- ▲ **Always** wear the appropriate footwear when using a free standing platform stand. A good non-slip safety boot is important to your personal safety. Be especially careful that boot laces do not get hooked on the stand or any of its components (tuck shoelaces into boots before climbing).
- ▲ Some models include a shooting rail. **Never** lean against, lean over, or sit on shooting rail. It is designed as a shooting rest only. On models that have a non-fixed shooting rail, be sure shooting rail is flipped back or swung to the side when ascending or descending ladder.
- ▲ Some models include a footrest, which is designed as a footrest only. **Never** stand on footrest! **Always** be fully aware of foot placement.

## ILLUSTRATED PARTS BREAKDOWN





## ILLUSTRATED PARTS BREAKDOWN

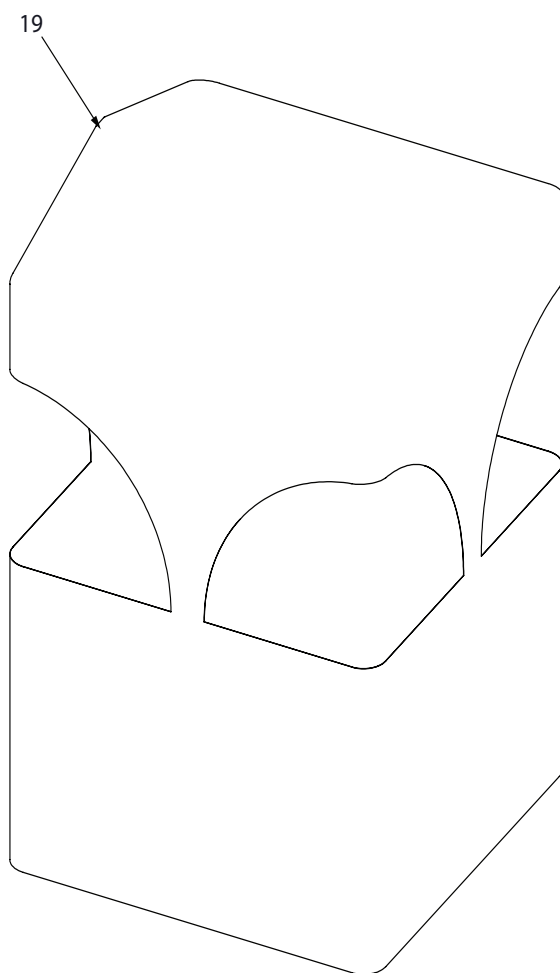
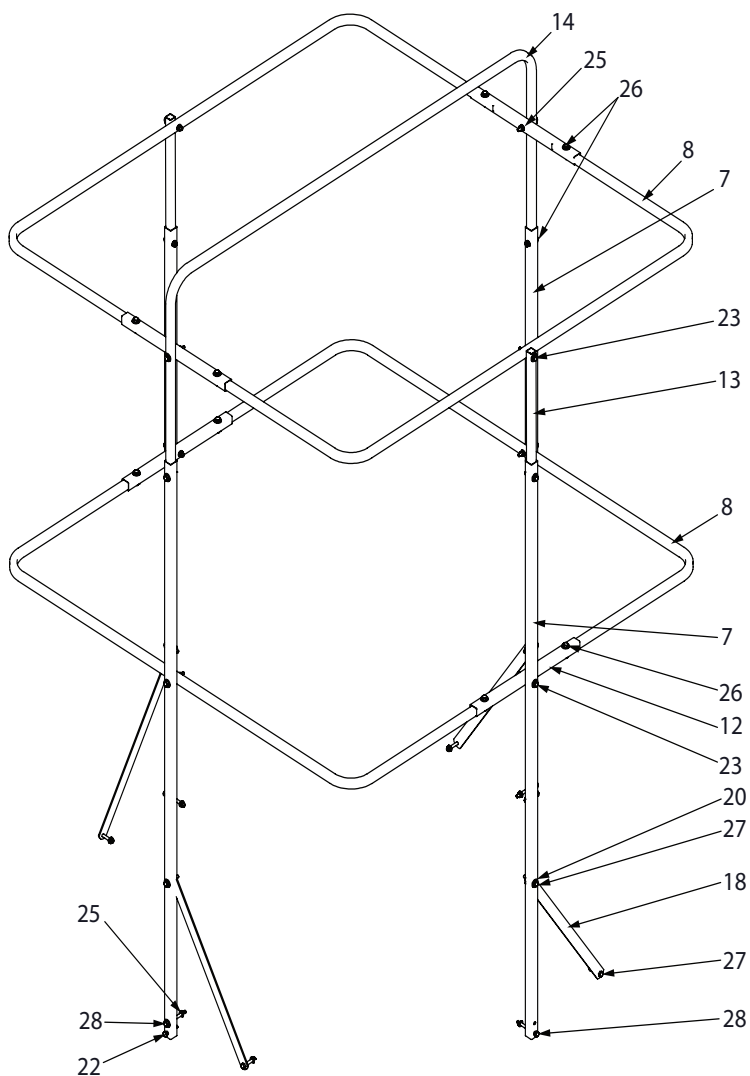

## ILLUSTRATED PARTS BREAKDOWN

| ITEM # | PART # | DESCRIPTION                             | QTY. |
|--------|--------|---|------|
| 1      | AL3    | WELDMENT AP LADDER 3 STEP PIN STYLE     | 2    |
| 2      | TP113  | WELDMENT FOOT PAD LADDER POD            | 4    |
| 3      | TP131  | BRACE FEMALE CROSS 60 IN                | 8    |
| 4      | TP132  | BRACE MALE CROSS 36 IN                  | 8    |
| 5      | TP135  | BRACE DOUBLE FLAT TOWER                 | 4    |
| 6      | TWR15  | WELDMENT PLATFORM TOWER                 | 2    |
| 7      | TWR18  | RIM UPRIGHT BLIND TOWER                 | 4    |
| 8      | TWR19  | RAIL RIM BLIND TOWER                    | 4    |
| 9      | TWR20  | WELDMENT LEG TOWER                      | 8    |
| 10     | TWR21  | WELDMENT LADDER TOP TOWER               | 1    |
| 11     | TWR25  | RECEIVER LEG TOWER                      | 4    |
| 12     | TWR26  | TUBE RAIL SPANNER TOWER                 | 4    |
| 13     | TWR27  | TUBE EXTENSION RAIL TOWER               | 2    |
| 14     | TWR28  | RAIL ROOF BLIND TOWER                   | 1    |
| 15     | TWR31  | TUBE PLATFORM JOINER OUTSIDE            | 2    |
| 16     | TWR32  | TUBE PLATFORM JOINER CENTER             | 1    |
| 17     | TWR41  | WELDMENT HEIGHT ADJUSTER FEET           | 2    |
| 18     | SL8    | BRACE FLAT BAR LADDER PLATFORM          | 4    |
| 19     | 48028  | BLIND SEWN COMPLETE 10 FT OUTPOST TOWER | 1    |
| 20     | 11498  | WASHER M6 X 13 X 1.75 MM                | 24   |
| 21     | 22339  | LOCKNUT M8 X 1.25                       | 54   |
| 22     | 22546  | BOLT M8 X 1.25 X 40 MM                  | 16   |
| 23     | 22587  | BOLT M6 X 1.0 X 55 MM                   | 8    |
| 24     | 22588  | BOLT M6 X 1.0 X 30 MM                   | 8    |
| 25     | 22946  | FLANGED LOCKNUT M6 X 1.0                | 46   |
| 26     | 23060  | BOLT M6 X 1.0 X 35 MM                   | 16   |
| 27     | 23061  | BOLT M6 X 1.0 X 40 MM                   | 10   |
| 28     | 23564  | BOLT M8 X 1.25 X 65 MM                  | 22   |
| 29     | 27365  | BOLT M8 X 1.25 X 25 MM                  | 16   |
| 30     | 27385  | U-BOLT M6 X 1.0 X 70 X 40 MM            | 2    |
| 31     | 27390  | PLATE U-BOLT M6 X 40 MM                 | 2    |

## BOLT IDENTIFICATION CHART

Not all bolt sizes shown are included with all treestands. Bolts shown are for size reference only. Extra hardware may be included in the parts bag.

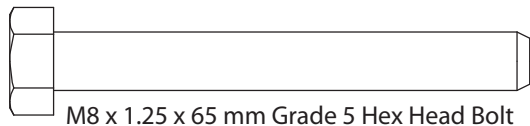
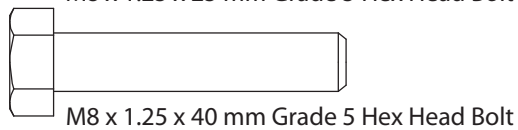
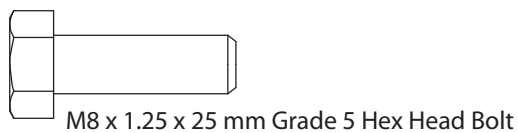
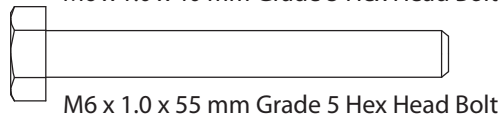
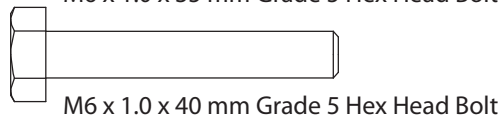
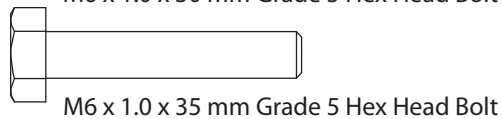
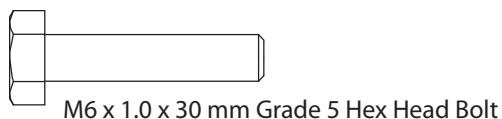

[illegible]



Rivers Edge® Treestands, Inc.  
1160 Eighth Avenue, PO Box 755  
Cumberland, WI 54829  
800-450-EDGE (3343) | Fax 715-822-2124  
Email: [info@huntriversedge.com](mailto:info@huntriversedge.com)