

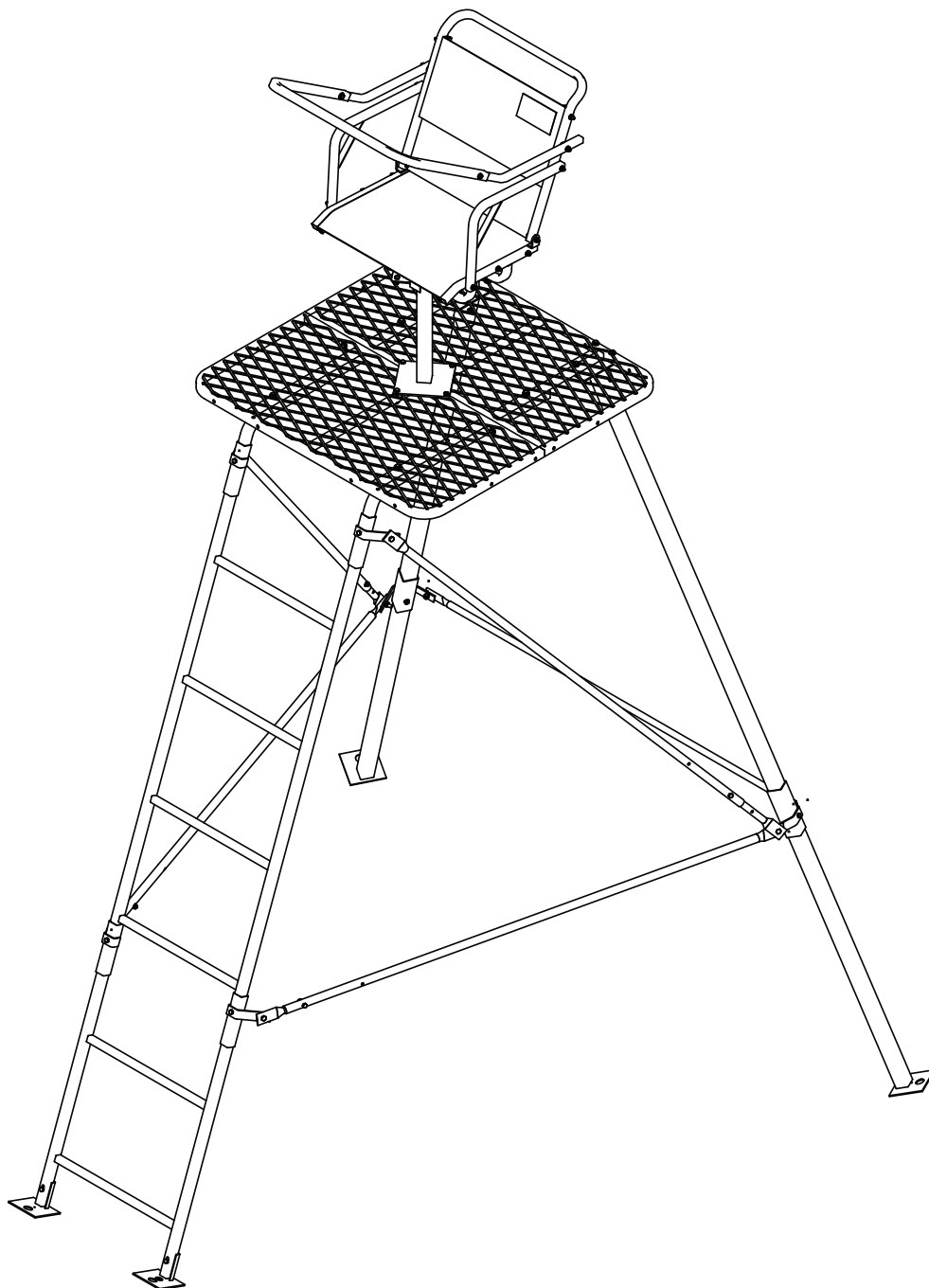

Operator's Manual
**RE740 Perimeter™
Ladder Pod**



PRODUCT MEETS
INDUSTRY STANDARDS
RECOGNIZED BY



PARTICIPATING MEMBER

Get parts online at
www.HuntRiversEdge.com



P/N: 17753
REV2: 03/29/16
© 2016 RETI
All Rights Reserved

INTRODUCTION

Rivers Edge® Treestands are engineered with you, the hunter, in mind. We appreciate your purchase of one of our world class treestands. Follow these few simple instructions and your stand will provide you many years of trouble-free pleasure. Instructions should be kept in a safe place and reviewed at least annually. If for any reason you have a problem with your product, **DO NOT return to the retailer**, contact the Rivers Edge® customer service department at 800-450-EDGE (3343) for assistance.

CONTENTS

Introduction/Warranty	2
Warnings.....	3-4
Inspection and Maintenance Schedule.....	4
Assembly and Use Instructions	5-10
Uprighting and Use Instructions	11
Notes Page.....	12
Ladder Pod Illustrated Parts Breakdown.....	13-15
Bolt Identification Chart.....	15

WARRANTY

RETI offers a one year warranty for all components of the treestand. These warranties apply to the original owner with a proof of purchase. These warranties begin on the date of purchase by the first retail consumer and continue for the period specified above. These warranties apply to products that are not modified, abused or used in a manner that deviates from the product's intended usage. Minor fading in color is normal and is not covered by warranty. Any corrosion of painted surfaces that occurs as a result of paint being removed or damaged is also not covered by warranty. RETI offers no other warranty expressed or implied. Products for which warranty work has been approved must be sent directly to RETI and performed by RETI. **To obtain warranty service and/or replacement instructions, you must obtain prior approval from RETI before shipping your package to us by calling our customer service department at 800-450-3343 or by writing to: RETI, P.O. Box 755, 1160 Eighth Avenue, Cumberland, WI 54829 for a return material authorization number (RMA#).** All items must be shipped prepaid. RETI will, at no charge, repair or replace, in RETI's sole discretion, any product that satisfies the conditions stated above. RETI retains the right to change models, specifications and price without notice.

This equipment has been manufactured under strict quality and safety guidelines. As with any equipment of this type, full understanding of the instructions and its use is mandatory and imperative for the safety of its user. RETI is not responsible for any damages or injuries sustained due to improper use or modification of any of its products, or resulting from any use which deviates from the product's intended usage. RETI is not responsible for any injuries sustained due to failure to read and adhere to the instructions for use. Any misunderstanding or questions regarding the products of their use should be directed to RETI prior to any use. It is the owner's sole responsibility to inspect the product regularly for damage, improper installation, or conditions that could jeopardize the ultimate safety of the product. **Owner is responsible to understand and follow product field weight rating and must never exceed maximum weight rating.** RETI is not responsible for any malfunction or injury resulting from normal wear and tear, damage caused by improper use, improper maintenance, negligence or accidents. This product, if used safely as intended, will provide trouble free service for the useful life of the product. We hope you will enjoy the quality of our products for years to come, and have a safe hunt.

MODEL RE740

MAXIMUM USE HEIGHT - 10' 6" TO SHOOTING RAIL

MAXIMUM OCCUPANCY - ONE (1)

TOTAL WEIGHT LIMIT - 300 LB

WARNING

- ▲ This product carries strict height and weight restrictions. **Do Not** use this product if you exceed the total weight limit. Please note that the total weight limit includes the user(s) and their equipment.

WARNING

- ▲ **When hunting from a treestand or free standing platform stand falls can occur any time after leaving the ground causing injury or death.**
- ▲ **Read and understand** all of the manufacturer's Warnings and Instructions and use all safety devices provided by the manufacturer. Contact the manufacturer for any questions. Failure to do so could result in injury or death.
- ▲ **Never** exceed the total weight limit of the treestand or free standing platform stand.
- ▲ **Never** use a treestand or free standing platform stand during inclement weather such as rain, lightning, windstorms or icy conditions and end your hunt and return to the ground if inclement conditions arise.
- ▲ **Never** use a treestand or free standing platform stand while using drugs (even prescription drugs) or alcohol.
- ▲ **Never** use a treestand or free standing platform stand while feeling ill, nauseous or dizzy, or if you have a prior medical condition that could cause a problem, that is, heart condition, joints that lock-up, spinal fusions, etc., or if you are not well rested. **Never** sleep in stand.
- ▲ **Always** avoid electrical power lines.
- ▲ **Never** rely on a tree branch for support.
- ▲ **Never** jump or bounce on a treestand or free standing platform stand to seat it to the tree or ground.
- ▲ Pull up a bow, backpack, or firearm or other equipment only after being secure in the treestand or free standing platform stand and a firearm must be pulled up with it unloaded, chamber open, and muzzle down.
- ▲ **Always** inform someone of the hunting location, where the treestand or free standing platform stand will be located and the expected duration of the hunt.

WARNING

- ▲ A signal device such as a mobile phone, radio, whistle, signal flare or personal locator device (PLD) must be on your person and readily available at all times.
- ▲ Inspect the treestand or free standing platform stand and all safety devices each time before use and **Do Not** store a treestand or free standing platform stand outdoors when not in use.
- ▲ **Never** modify your treestand or free standing platform stand in any way by making repairs, replacing parts, or altering it except if explicitly authorized in writing by the manufacturer.
- ▲ Practice installing, adjusting and using your treestand or free standing platform stand at ground level prior to using it at elevated positions. Study your new stand to become familiar with all of its features and design. Doing so will confirm that the product is manufactured, assembled and installed correctly.
- ▲ Instructions (written and video) shall be kept in a safe place and reviewed at least annually. It is the responsibility of the treestand or free standing platform stand owner to furnish the complete instructions to any person who borrows or purchases the treestand or free standing platform stand.
- ▲ **Always** use at least four (4) people to install or take down a free standing platform stand.
- ▲ Stabilization devices must be attached before climbing to the platform.
- ▲ When installing a ladder stand or free standing platform stand, always bounce on the first rung to set the ladder into the ground according to manufacturer's instructions before proceeding to climb any higher.
- ▲ Check every ladder/leg section connection every time you use the stand before you leave the ground. If ladder/leg sections are separating, do not use the stand.
- ▲ Check the ground under the stand to make sure it is firm and level. Sloping ground or uneven surface (one side on a rock) can cause your ladder or free standing platform stand to tilt or shift off as you climb.
- ▲ **Always** maintain three (3) points of contact when climbing a ladder treestand or free standing platform stand. Proper three-point contact means having either two feet with one hand or one foot with two hands on the step portion of the ladder or climbing aid at all times.
- ▲ **Always** lean forward as you climb ladder or climbing aid.
- ▲ **Never** exceed the stated maximum use height.

WARNING

- ▲ **Do Not** use this product until you have watched the included treestand safety DVD, understand it, and practiced the techniques for safe hunting discussed in this DVD.
- ▲ Read and perform all inspection and maintenance tasks before each and every use. Replace any questionable components immediately with RETI original replacement parts.
- ▲ **Do Not** crush tubing when tightening bolt assemblies! Identify and familiarize yourself with all parts before you start. Bolt identification chart can be found in the back.
- ▲ Double check assembly steps to be certain you have correctly assembled this product.
- ▲ **Never** use any product that has not been maintained or inspected properly - Your life depends on it!
- ▲ **Always** wear the appropriate footwear when using a free standing platform stand. A good non-slip safety boot is important to your personal safety. Be especially careful that boot laces do not get hooked on the stand or any of its components (tuck shoelaces into boots before climbing).
- ▲ Do not position this product on a slope, unlevel, or wet ground. It may tip over and serious injury or death may occur.
- ▲ Ground should be such that ground stakes (not included) can be driven into the ground through holes provided in foot pads. This will help prevent pod from tipping over in strong winds. You will need to make or purchase (4) ground stakes. Stakes should be 3/8 inch rod x 24 inches long.

INSPECTION AND MAINTENANCE SCHEDULE

BEFORE EACH USE PERFORM THE FOLLOWING:

- Inspect all webbing, rope, cord, and strap assemblies for wear or damage.
- Inspect cables and/or cable ends for damage or kinking.
- Inspect all hardware and chain components for damage.
- Inspect for any structural damage to product. (If any exists call RETI customer service.)
- Inspect all nut and bolt assemblies to be certain none are loose.
- Inspect for any missing parts.
- Lubricate all pivot and slide together points with powder graphite, petroleum jelly or silicone spray to prevent noise, wear and rust.
- Inspect entire product for any rust, corrosion, cracks, freezing, excessive heat or rotting damage that may effect the safety of your product. Discard any questionable product.
- Inspect entire product for any structural damage - pay close attention to all weld locations. (Return to factory for repair or discard product if any damage is found.)
- Using correct wrenches inspect all nut & bolt assembly locations and snug up any that may be loose. Be careful not to crush tubing when tightening!
- Inspect and check operation of all cables, cable ends, cord, rope, webbing, and strap or chain assemblies. Replace with factory new any item or assembly that shows signs of wear, damage, kinking, or functions incorrectly.
- Inspect seat. Replace any seat with factory new that shows signs of structural damage or wear.
- Inspect all hardware for wear or damage, also be sure you have no missing parts.
- Never modify your stand in any way by making repairs, replacing parts, or altering adding or attaching anything to it except if explicitly authorized in writing by the manufacturer.

ASSEMBLY AND USE INSTRUCTIONS:

Assemble this product only in areas that meet the following criteria! No overhead power lines near area; open, flat, level, dry ground of sufficient size to allow for assembly, up righting and climbing. Approximate area needed for this is 14' X 24'.

ASSEMBLY INSTRUCTIONS

Tools needed: Two 7/16" wrenches, two 1/2" wrenches, and a tape measure to measure level ground area needed & cross brace length.

NOTE: It is highly recommended that as much assembly as possible be done in a garage setting because of hardware amount and time involved! Allow between two and four hours for assembly.

IMPORTANT ASSEMBLY TIP:

Do not tighten any nut and bolt combinations completely until all parts are assembled together! Finger tighten plus one turn of a wrench only! This will temporarily hold the lock nut on the bolt while helping alignment of all parts! After all parts are assembled together, all nut & bolt combinations must be completely tightened.

1. Attach (2) platforms (TP100) together using (2) provided 1/4-20 x 2-1/4" bolts, locknuts and steel washers. **SEE FIGURE 1. DO NOT tighten all nut & bolt assemblies completely!**
2. Attach the assembled platforms to the (2) provided J-receiver tubes (TP109) using (4) provided 1/4-20 x 2-1/2" bolts, locknuts and steel washers. **SEE FIGURE 2**
3. Attach the two rear leg pockets w/ plates (TP151 & TP152) to the bottom of assembled platform using (6) provided 1/4-20 x 1-1/2" bolts, locknuts and steel washers. **SEE FIGURE 3**

NOTE: Make sure the pockets are orientated outward, away from each other.

4. Attach the seat post (TP11) to the assembled platforms using (4) provided 1/4-20 x 1-1/2" bolts and locknuts. **SEE FIGURE 4**

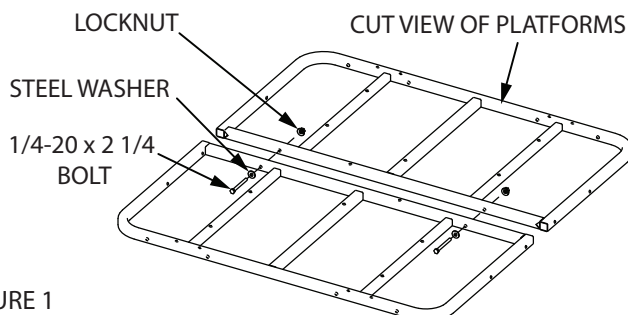

FIGURE 1

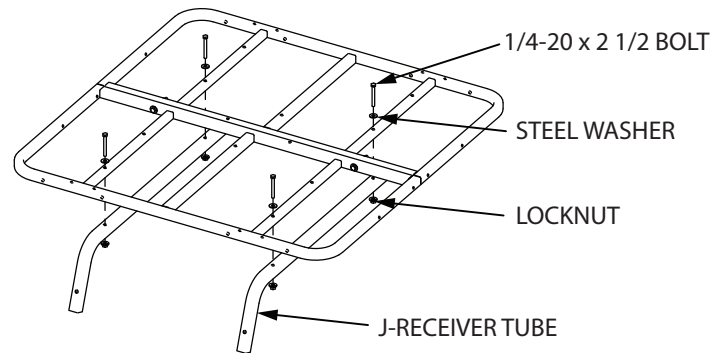

FIGURE 2

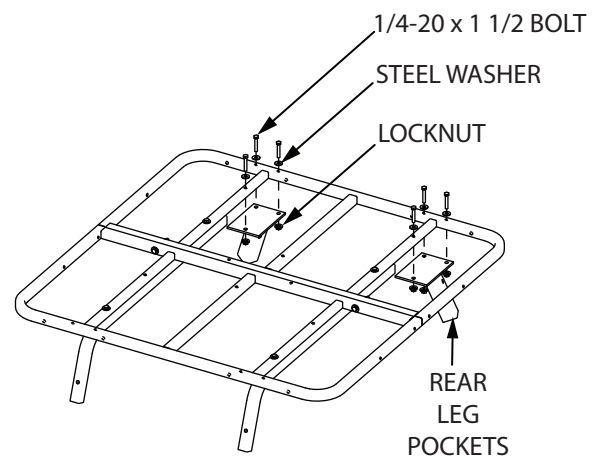

FIGURE 3

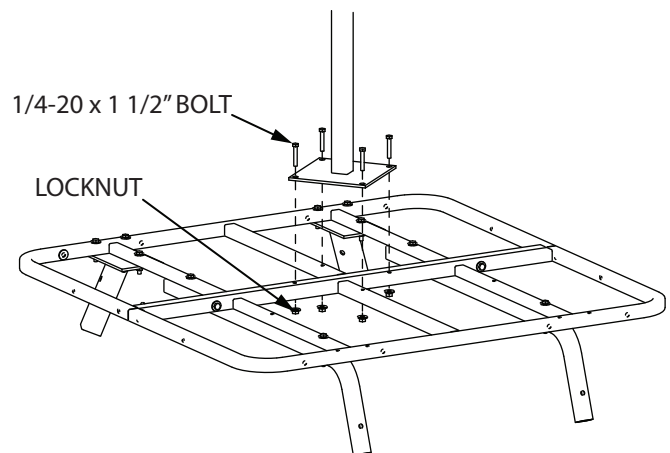

FIGURE 4

5. Attach swivel (48662) to top of seat post (TP11) using (4) provided 1/4-20 x 3/4" bolts and locknuts. **SEE FIGURE 5**
NOTE: Make sure head of bolts are on swivel side and nut on bottom of seat post plate to prevent any obstruction when swivel is pivoted during use.
6. Attach factory assembled seat (16857) to the swivel using (4) provided 1/4-20 x 1-1/4" bolts and locknuts. **SEE FIGURE 5**
NOTE: Make sure head of bolts are on swivel side and nut on top of seat frame to prevent any obstruction when swivel is pivoted during use.
7. Attach factory assembled backrest (17630) to tabs of seat frame using (2) provided 1/4-20 x 1-1/2" bolts and locknuts. **SEE FIGURE 6**
8. For assembly of the armrests and shooting rest, you must first remove the "front" (2) bolts/nuts from factory assembled seat frame and the "bottom" (4) bolts/nuts from factory assembled backrest frame. Discard this hardware. **SEE FIGURE 7**

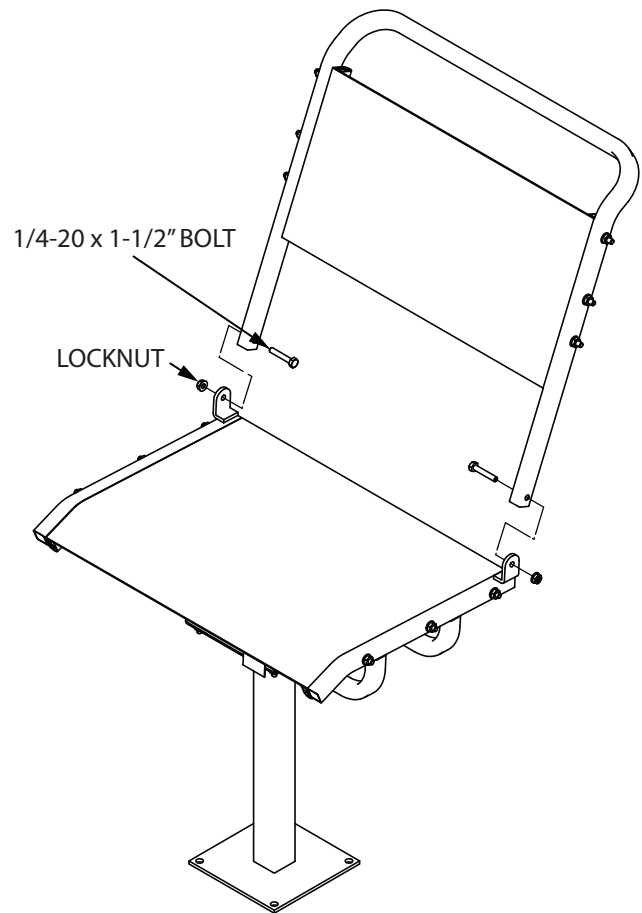

FIGURE 6

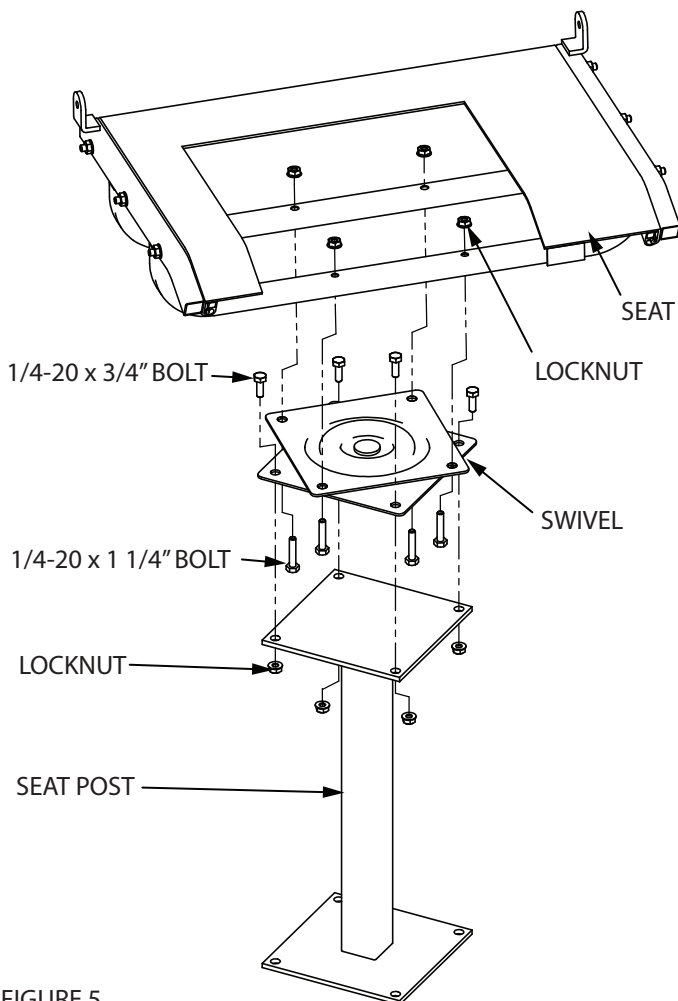

FIGURE 5

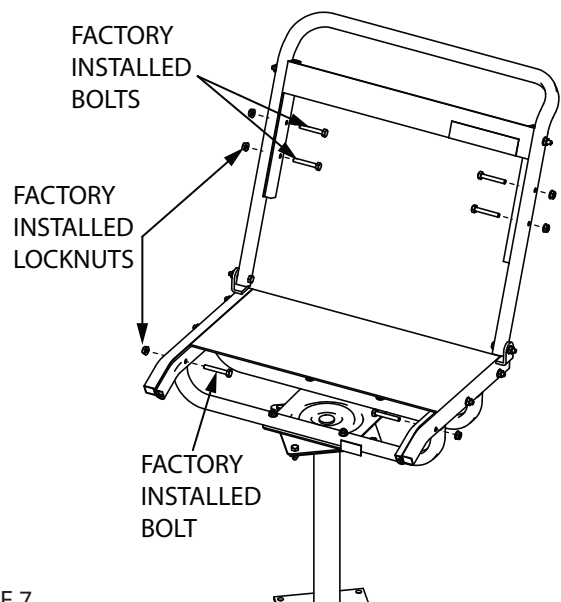

FIGURE 7

9. Attach the (2) armrests (17635) to the seat frame and backrest frame using (4) provided 1/4-20 x 2-1/2" bolts and locknuts. **SEE FIGURE 8**

NOTE: The armrests are more than 3" longer on one side. Bolt the longer side to the backrest frame and the shorter side to the seat frame to achieve proper backrest angle.

10. Using the longer end, attach the (2) shooting rail side rails (TP142) to the backrest frame using (2) provided 1/4-20 x 2-1/2" bolts, locknuts and plastic washers. **SEE FIGURE 8**
11. Attach the shooting rail front rail to the shooting rail side rails using (2) provided 1/4-20 x 1-1/4" bolts, lock nuts and steel washers. Side rails should be inserted into the front rail and bolts should go through both rails. **You must now tighten all nut and bolt combinations securely; DO NOT CRUSH TUBING WHEN TIGHTENING! SEE FIGURE 8**
12. Attach the 66" shooting rail pad to shooting rail by wrapping around metal tubing and attaching Velcro together. The pad will act as a noise dampener between shooting rail and armrests.
13. Attach the ladder foot pads (TP113) to the bottom (short) ladder (TP159) using (2) provided 1/4-20 x 1-1/2" bolts and locknuts. This step now makes this the bottom ladder section. **SEE FIGURE 9**

NOTE: Channel on foot pads should cradle on three sides of the ladder legs.

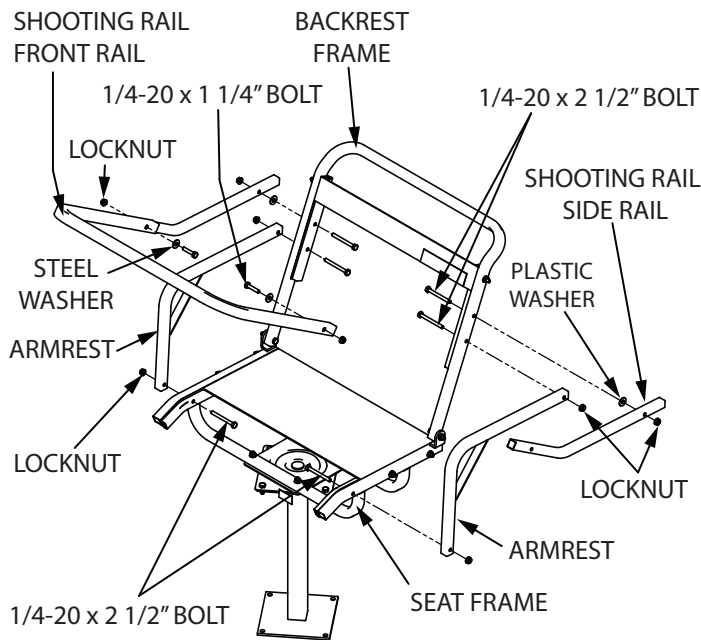

FIGURE 8

14. Insert the platform J-pipes into top ladder (SL51) and the top ladder into bottom ladder assembly. Attach (4) single mount support brace tabs (TP115) to each joint location of ladder assembly. Secure those locations using (4) 1/4-20 x 1-3/4" bolts and locknuts. **SEE FIGURE 9**

NOTE: Make sure foot pads are orientated out, away from platform

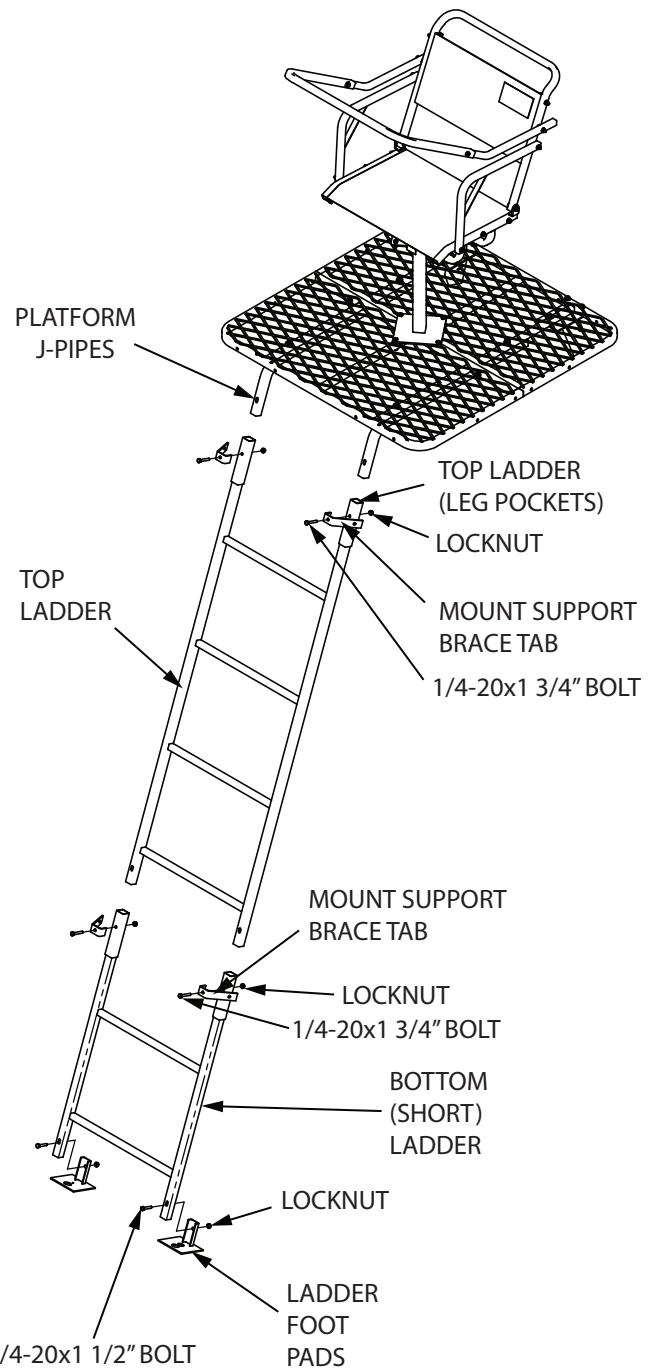

FIGURE 9

15. Insert the (2) top legs (TP145) into the leg pockets already mounted to platform and secure using (2) provided 1/4-20 x 2-1/4" bolts and locknuts. **SEE FIGURE 10**

16. Insert the bottom legs with feet (TP147) into the top legs. Attach (2) dual mount support brace tabs to each joint location of the leg assemblies and secure those locations using (2) provided 1/4-20 x 2-1/4" bolts and locknuts. **SEE FIGURE 10**

NOTE: Make sure foot pads are orientated out, away from platform.

17. Build crossbrace assemblies as follows:

a. Locate the (4) 12" male cross braces (TP149) and the (4) 60" female cross braces (TP131). Insert the male cross braces into the female cross braces.

b. Assemble two cross braces in the hole location listed for Pole length **A** and two cross braces in the hole location listed for pole length **B**. Secure with (4) provided 1/4-20 x 1-1/4" bolts and locknuts. **SEE FIGURE 11**

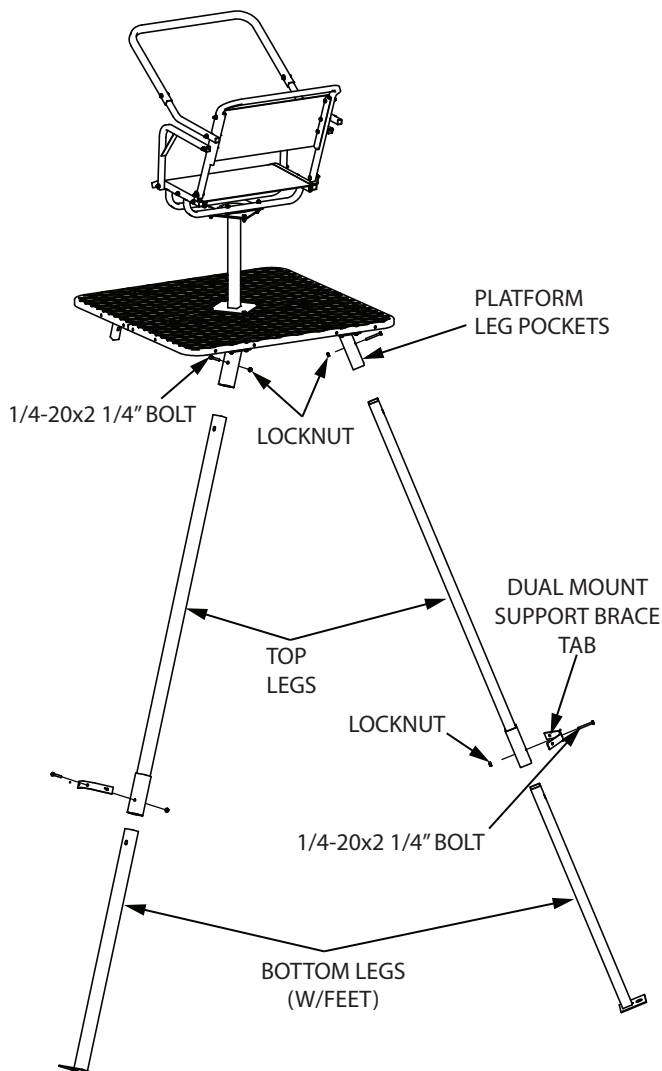

FIGURE 10

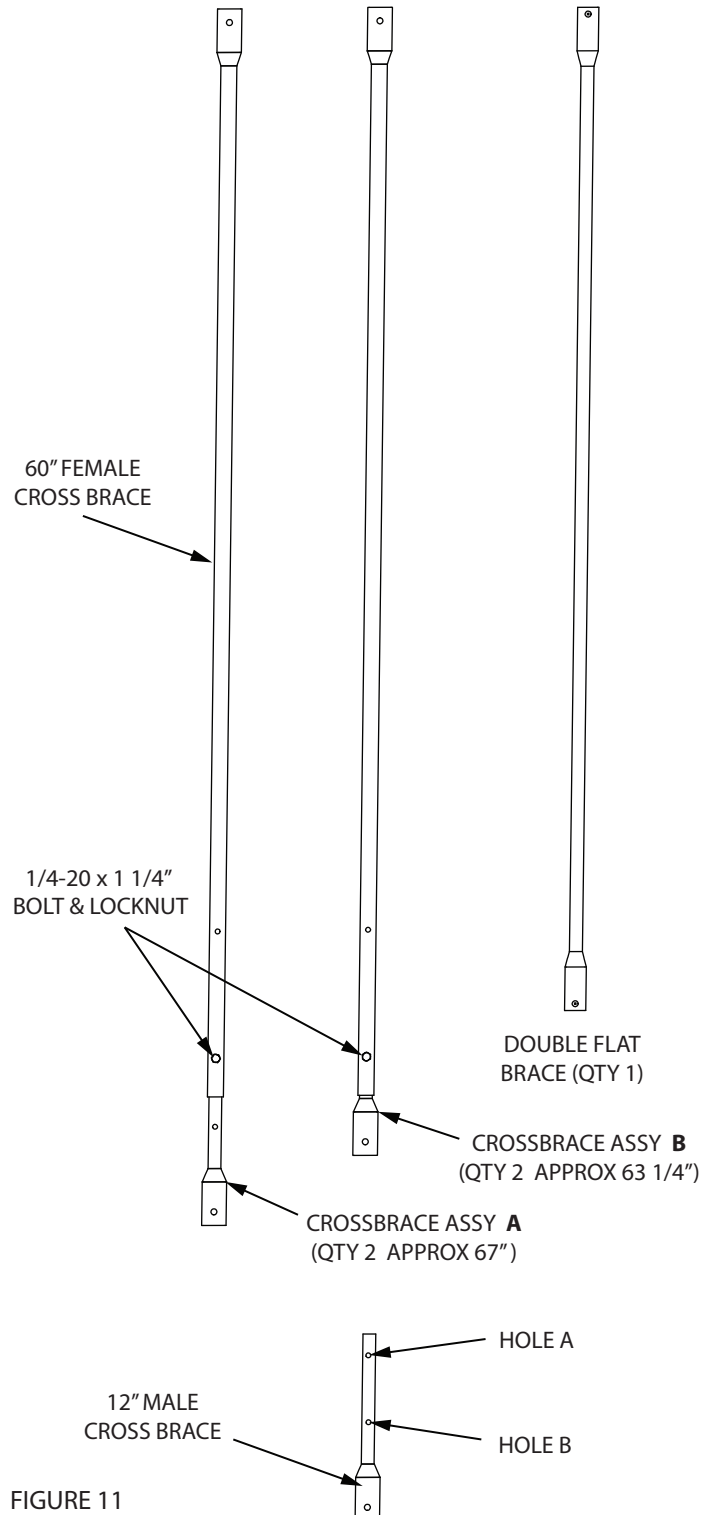

FIGURE 11

18. Install cross brace assemblies as follows::

a. **The two cross brace assemblies that run diagonally from the top ladder section to the top/bottom leg joint are the longest.** Using cross brace assembly length A (approximately 67"), attach to the support brace tabs on top ladder section using (2) provided 5/16-18 x 3/4" bolts and locknuts. Attach other end of cross brace assemblies to the support brace tabs of leg joints. Finger tighten with (2) provided 5/16-18 x 1-1/4" bolts and locknuts to temporarily hold these cross braces in place. **SEE FIGURE 12**

NOTE: Be sure to use 1-1/4" bolts at any location where multiple cross brace poles are attached.

b. The two cross brace poles that run horizontally from the top/bottom leg joint to the top/bottom ladder joint are the shortest. Using pole length B (approximately 63-1/4", attach to the support brace tabs of leg joint using (2) previously finger tightened 5/16-18 x 1-1/4" bolts and locknuts. Attach other end of cross brace assemblies to the support brace tabs of ladder joints using (2) provided 5/16-18 x 3/4" bolts and locknuts. **SEE FIGURE 12**

NOTE: You will use the 1-1/4" bolts and nuts to attach cross braces at the leg joint that are already holding the diagonal braces.

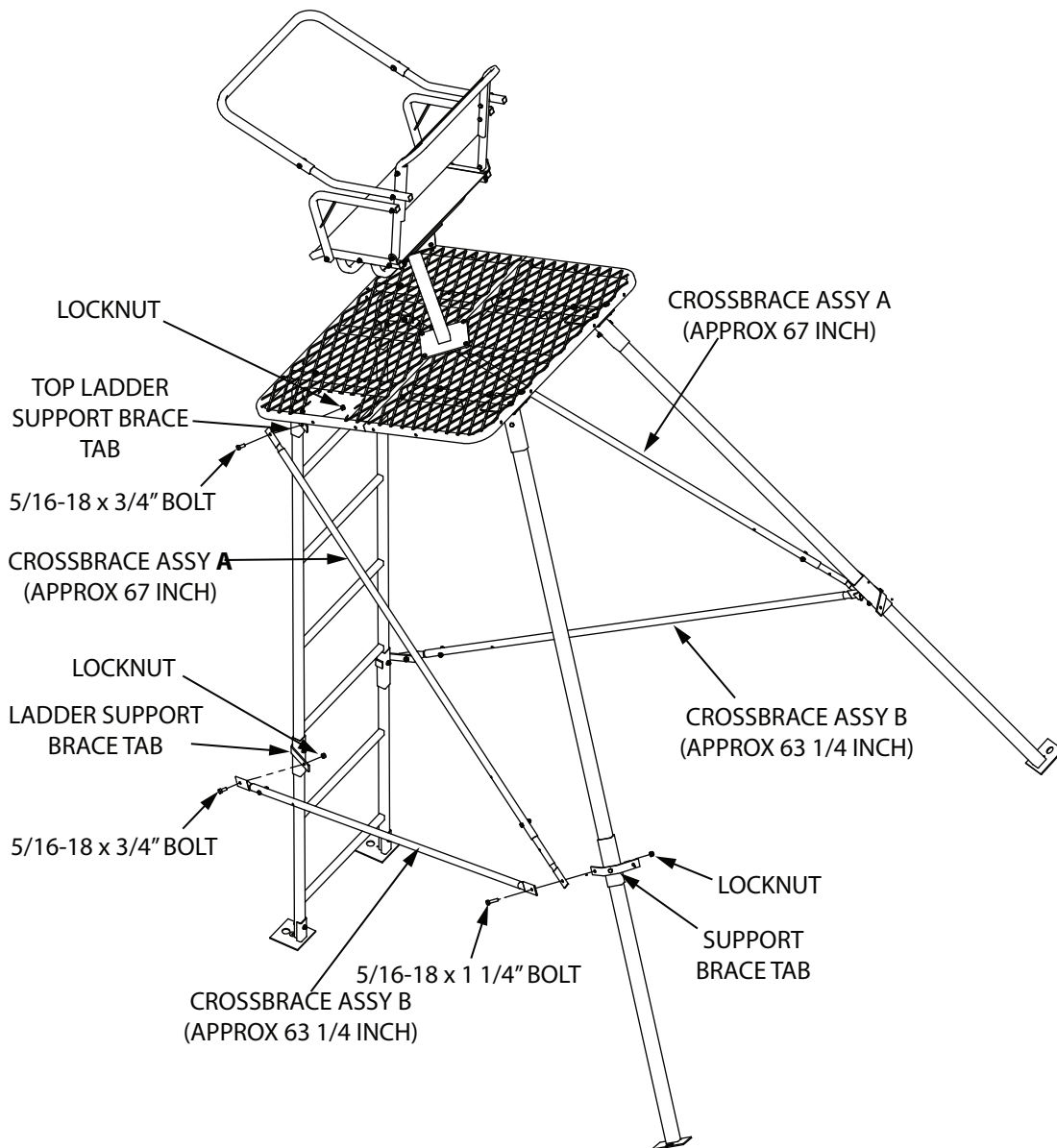
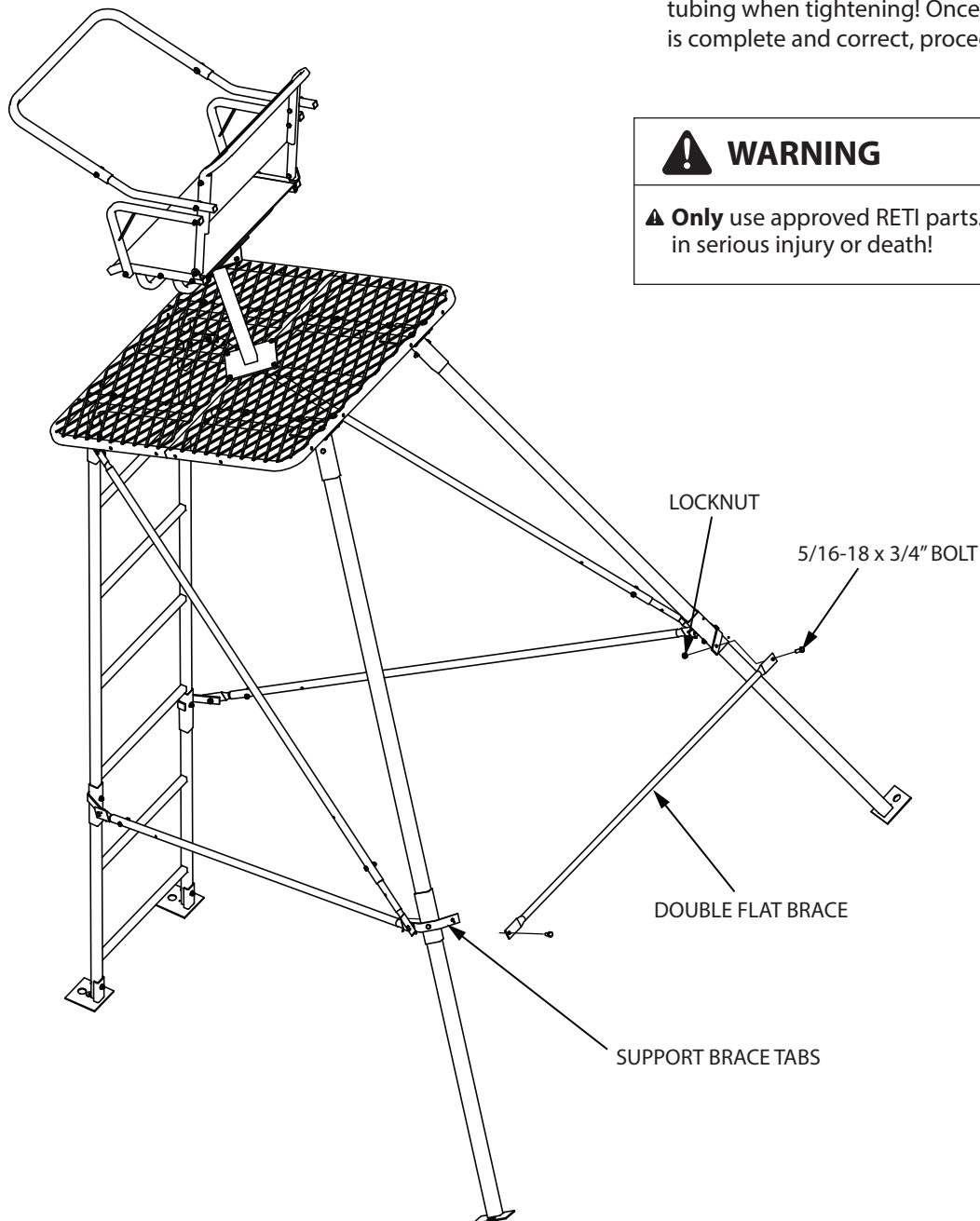

FIGURE 12

c. Attach the double flat brace horizontally to the support brace tabs of the two leg joints (between two rear legs). Secure with (2) provided 5/16-18 x 3/4" bolts and locknuts.
SEE FIGURE 13

19. Once all cross braces are attached to pod, you must now tighten all nut & bolt assemblies. Be sure not to over tighten or crush tubing when tightening! Double and triple check all nuts and bolts to make sure all are securely fastened.
20. Go over every detailed step of assembly to be sure all assembly is done correctly and all bolt locations are secured and snug. Be sure not to over tighten or crush tubing when tightening! Once you are certain all assembly is complete and correct, proceed to uprighting instructions.



WARNING

⚠ **Only** use approved RETI parts. Failure to do so may result in serious injury or death!

FIGURE 13

UPRIGHTING AND USE INSTRUCTIONS

1. With assembled product lying on ground flat between one leg and ladder section, position one person at feet end of legs. This person has to prevent the bottom end from tilting up when platform end is lifted and prevent feet from skidding across the ground.
 2. Position two people at platform end, lift platform end of pod and continue up righting by walking toward feet end and moving hands along ladder and leg sections. As pod goes over-center, slowly allow the pod to land on the opposite leg section. Be sure all people are clear to prevent injury.
 3. Pod may need to be positioned to allow for a level stand and all ladder/legs touching ground. Avoid rocks or anything that may hinder this from happening. Only move pod with three people; one person on each leg section and one person on ladder section. Each person should lift equally and only enough to shift pod to a level ground location. **DO NOT lift pod by round cross braces as you could bend or damage them.**
 4. Drive (4) ground stakes (not included) through the holes in the (4) feet stakes should be approximately 24" in length with 18" in ground and should be driven in at an angle. **SEE FIGURE 14**
 5. Climb ladder slowly and carefully always having three points of contact on ladder at all times. Lean forward, towards ladder as you climb. Be sure hands are free for climbing.
 6. Upon reaching foot platform, with shooting rail flipped back out of the way, carefully turn around and sit on seat.
- NOTE: To exit your ladder pod, reverse the climbing procedure. Take great care to be sure of hand and foot placement as you proceed back down pod ladder.**
7. Reverse up righting and use instructions to take ladder pod down.

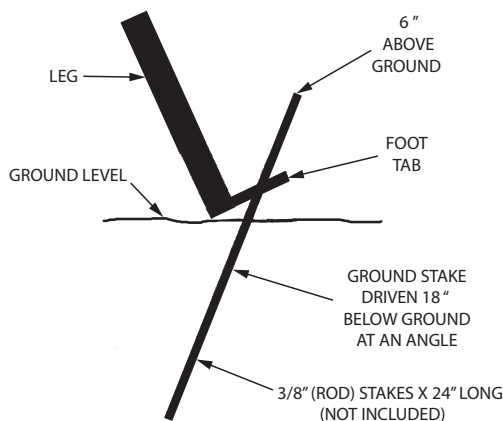

! WARNING

- ▲ Double check assembly steps to be certain you have correctly assembled this product.
- ▲ Study your new stand to become familiar with all of its features and design. Save these instructions for future reference.
- ▲ **Be Sure** uprighting area is open, flat, level, and dry with no power lines near!
- ▲ **Always** use at least four (4) people to install or take down a free standing platform.
- ▲ **Do Not** use any type of motorized vehicle to upright this free standing platform stand. You could cause unnecessary damage to this product. Upright by hand only using four people, two people at feet end of free standing platform stand and two people at platform end. Be aware it is top heavy. Use great care and caution during this process to prevent an off balance fall to prevent injury.
- ▲ As free standing platform stand goes over-center, be sure to slowly allow the stand to land on the opposite leg sections. **Be Sure** all people are clear to prevent injury.
- ▲ **Never** stand on seat, it is designed for sitting only.
- ▲ If seat is removable, be certain it is securely attached when in use.
- ▲ **Always** lean forward as you climb ladder or climbing aid.
- ▲ **Always** maintain three (3) points of contact when climbing a ladder treestand or free standing platform stand. Proper three-point contact means having either two feet with one hand or one foot with two hands on the step portion of the ladder or climbing aid at all times.
- ▲ **Always** wear the appropriate footwear when using a free standing platform stand. A good non-slip safety boot is important to your personal safety. Be especially careful that boot laces do not get hooked on the stand or any of its components (tuck shoelaces into boots before climbing).
- ▲ Some models include a shooting rail. **Never** lean against, lean over, or sit on shooting rail. It is designed as a shooting rest only. On models that have a non-fixed shooting rail, be sure shooting rail is flipped back or swung to the side when ascending or descending ladder.
- ▲ Some models include a footrest, which is designed as a footrest only. **Never** stand on footrest! **Always** be fully aware of foot placement.

FIGURE 14

This image shows a single sheet of white paper with horizontal ruling lines. The lines are evenly spaced and run across the width of the page. There are no margins, text, or other markings on the paper.

ILLUSTRATED PARTS BREAKDOWN

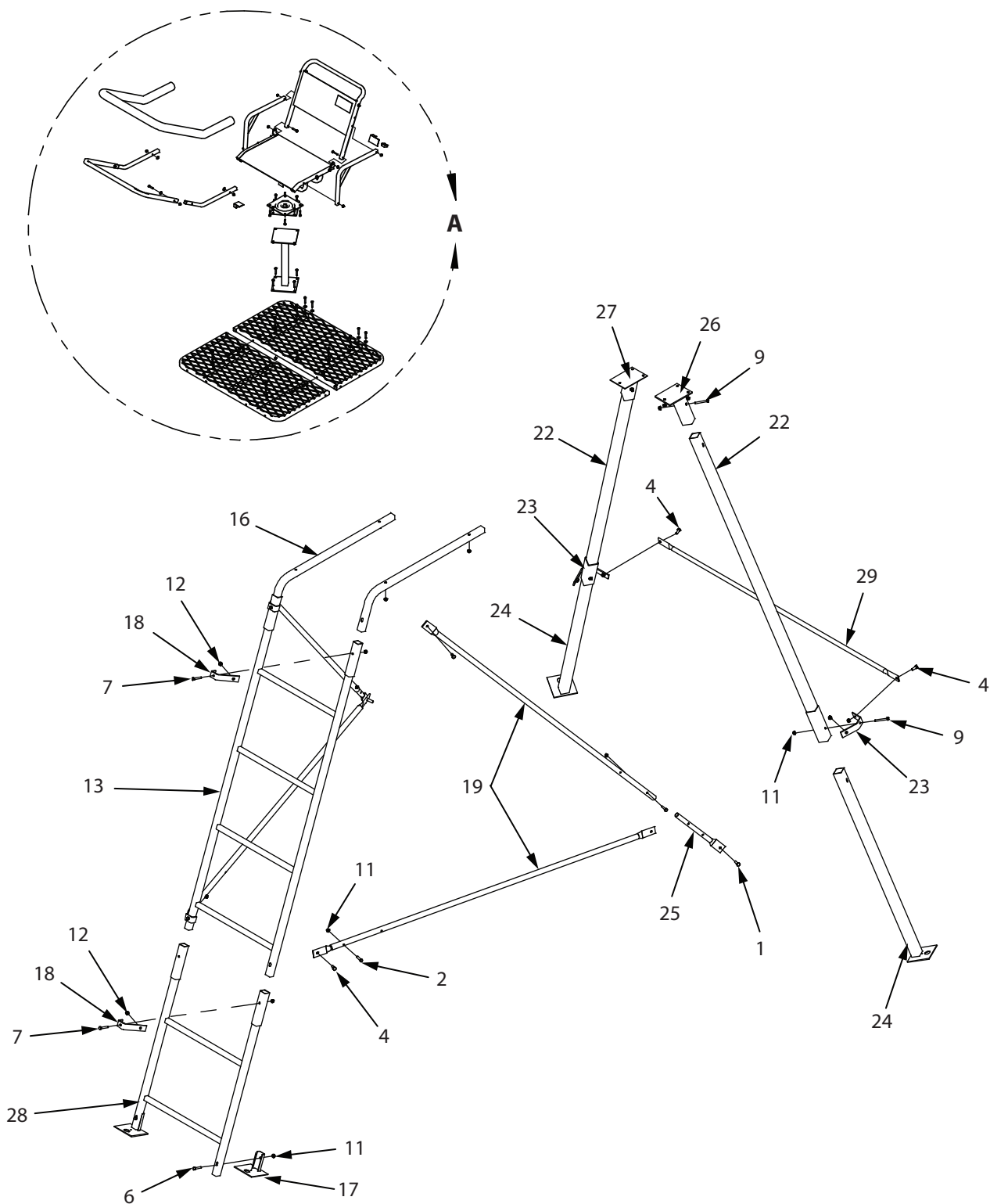

ILLUSTRATED PARTS BREAKDOWN

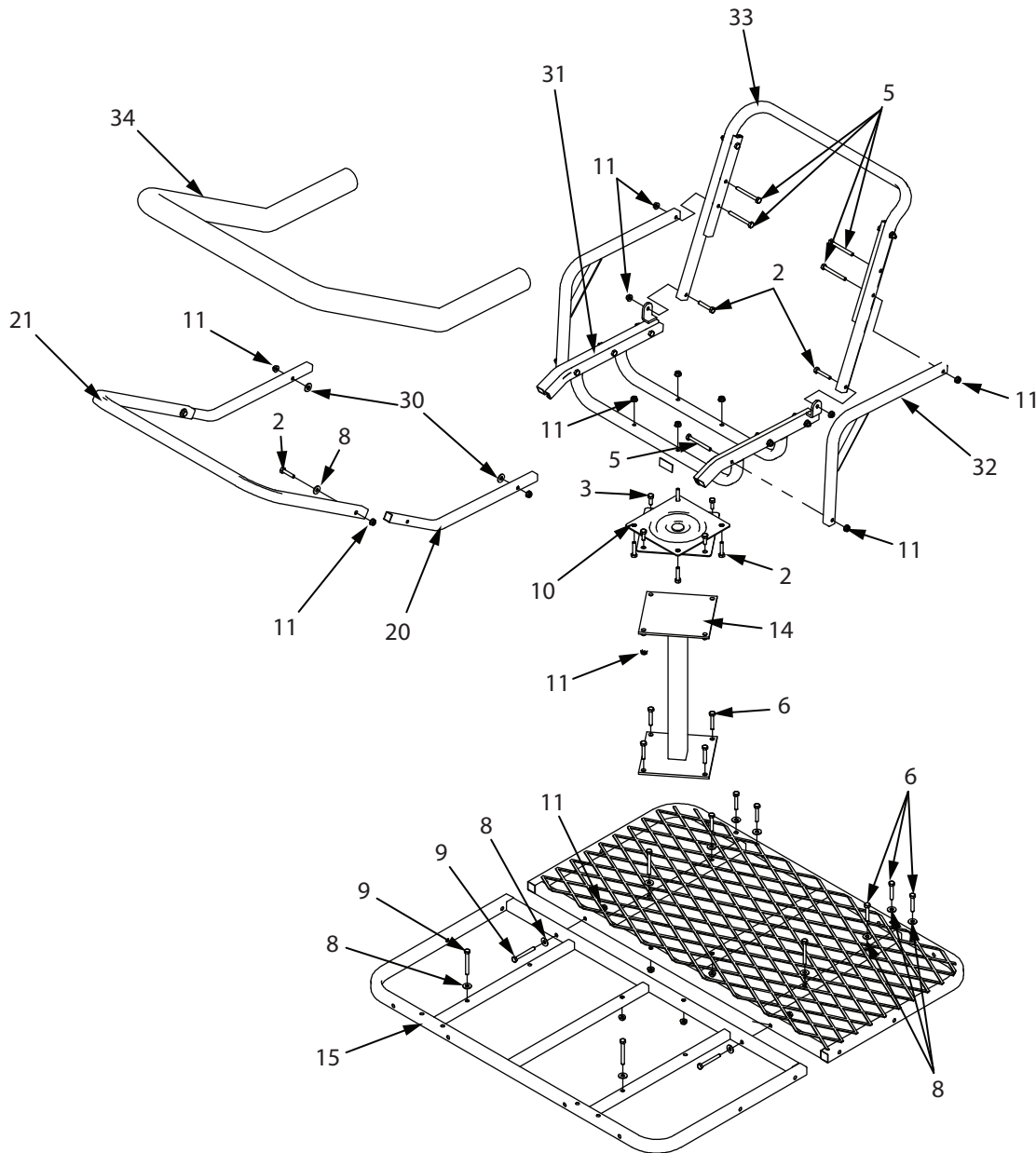

DETAIL A

ILLUSTRATED PARTS BREAKDOWN

ITEM #	PART #	DESCRIPTION	QTY.
1	1401B	BOLT 5/16-18 X 1-1/4 HHCS GR5 BLK ZN	2
2	8909B	BOLT 1/4-20 X 1-1/4 HHCS GR5 BLK ZN	10
3	8930B	BOLT 1/4-20 X 3/4 HH GR5 BLK ZN	4
4	48151	BOLT 5/16-18 X 3/4 HHCS GR5 BLK ZN	6
5	48270B	BOLT 1/4-20 X 2-1/2 HHCS BLK ZN	10
6	48240B	BOLT 1/4-20 X 1-1/2 HHCS GR5 BLK ZN	14
7	48250B	BOLT 1/4-20 X 1-3/4 HHCS GR5 BLK ZN	4
8	48261B	WASHER, FLAT BLK 1/4	14
9	48271B	BOLT 1/4-20 X 2-1/4 HH GR5 BLK ZN	6
10	48662	SWIVEL ONLY (LADDER POD SEAT)	1
11	48752B	NUT, 1/4-20 HFNYLK BLK ZN	48
12	60G5NYB	NUT 5/16-18 HNYLK BLK ZN	8
13	SL51	LADDER WELDMENT, (4-STEP, POCKET/ PIN STYLE)	1
14	TP11	POST, SEAT WELDMENT, LADDER POD	1
15	TP100	PLATFORM, WELDMENT	2
16	TP109	RECEIVER, LADDER POD	2
17	TP113	FOOT PAD	2
18	TP115	BRACKET, SUPPORT BAR	4
19	TP131	BRACE, FEMALE CROSS 60"	4
20	TP142	RAIL, SIDE SHOOTING	2
21	TP143	RAIL, FRONT SHOOTING	1
22	TP145	LEG WELDMENTS, PERIMETER POD	2
23	TP146	TAB, DUAL SUPPORT BRACE	2
24	TP147	BOTTOM LEG, W/FOOT, PERIMETER POD	2
25	TP149	BRACE, MALE CROSS 12"	4
26	TP151	LEG, RECEIVER, LEFT, PERIMETER POD	1
27	TP152	LEG, RECEIVER, RIGHT, PERIMETER POD	1
28	TP159	LADDER, BOTTOM, PERIMETER POD	1
29	TP160	CROSS BRACE, DOUBLE FLAT 54 9/16"	1
30	WN516	WASHER, PLASTIC BLK	2
31	16857	SEAT ASSEMBLY, TEARTUFF	1
32	17635	ARMREST, WELDMENT, TEARTUFF	2
33	17630	BACKREST ASSEMBLY, TEARTUFF	1
34	48874	SLEEVE, BLACK WITH FOAM 66 INCH	1

BOLT IDENTIFICATION CHART

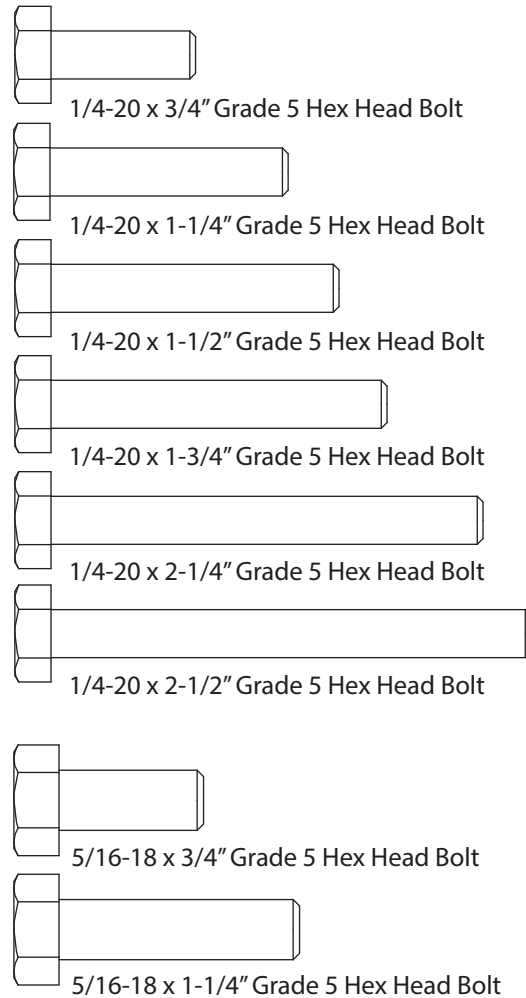



Rivers Edge® Treestands, Inc.

1160 Eighth Avenue, PO Box 755

Cumberland, WI 54829

800-450-EDGE (3343) | Fax 715-822-2124

Email: info@huntriversedge.com