

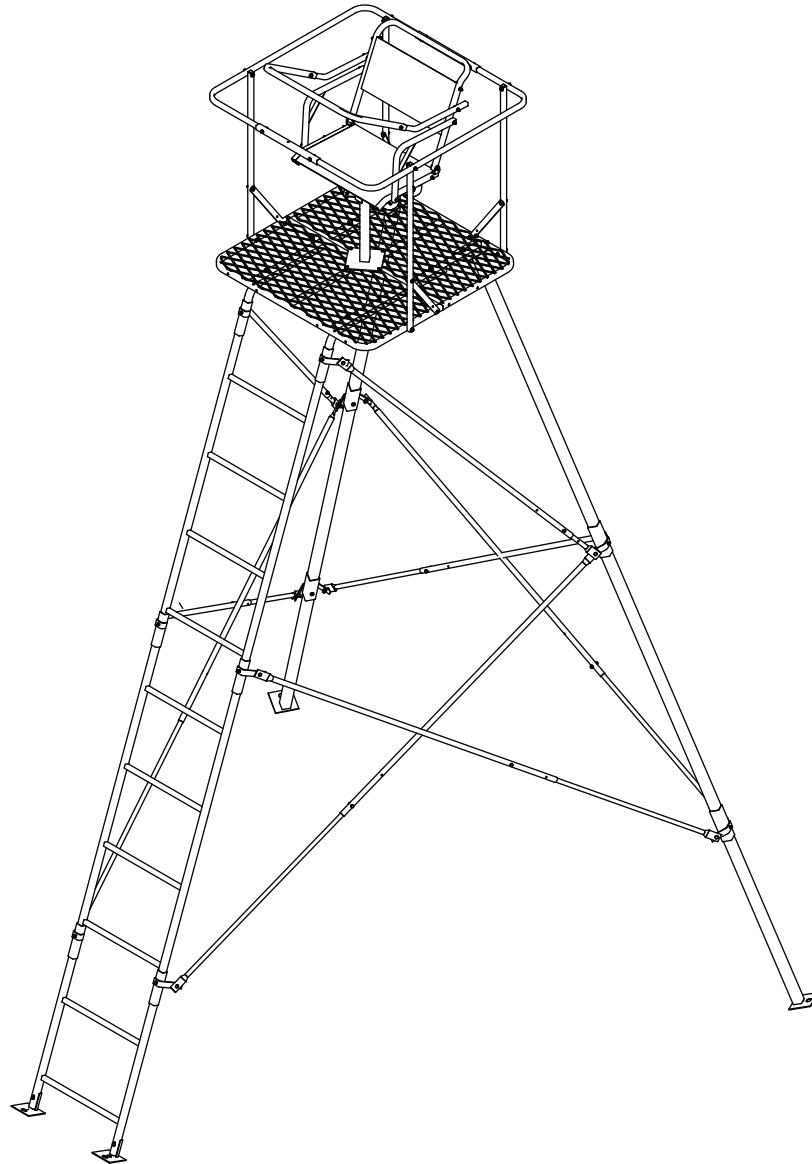

Operator's Manual
**RE741 Perimeter™
Ladder Pod**



PRODUCT MEETS
INDUSTRY STANDARDS
RECOGNIZED BY



PARTICIPATING MEMBER

Get parts online at
www.HuntRiversEdge.com



P/N: 17781
REV3: 03/29/16
© 2016 RETI
All Rights Reserved

INTRODUCTION

Rivers Edge® Treestands are engineered with you, the hunter, in mind. We appreciate your purchase of one of our world class treestands. Follow these few simple instructions and your stand will provide you many years of trouble-free pleasure. Instructions should be kept in a safe place and reviewed at least annually. If for any reason you have a problem with your product, **DO NOT return to the retailer**, contact the Rivers Edge® customer service department at 800-450-EDGE (3343) for assistance.

CONTENTS

Introduction/Warranty	2
Warnings.....	3-4
Inspection and Maintenance Schedule.....	4
Assembly and Use Instructions	5-13
Uprighting and Use Instructions	13
Pod Curtain Assembly Instructions.....	14
Uprighting and Use Instructions	15
Ladder Pod Illustrated Parts Breakdown.....	16-18
Bolt Identification Chart.....	19

WARRANTY

RETI offers a one year warranty for all components of the treestand. These warranties apply to the original owner with a proof of purchase. These warranties begin on the date of purchase by the first retail consumer and continue for the period specified above. These warranties apply to products that are not modified, abused or used in a manner that deviates from the product's intended usage. Minor fading in color is normal and is not covered by warranty. Any corrosion of painted surfaces that occurs as a result of paint being removed or damaged is also not covered by warranty. RETI offers no other warranty expressed or implied. Products for which warranty work has been approved must be sent directly to RETI and performed by RETI. **To obtain warranty service and/or replacement instructions, you must obtain prior approval from RETI before shipping your package to us by calling our customer service department at 800-450-3343 or by writing to: RETI, P.O. Box 755, 1160 Eighth Avenue, Cumberland, WI 54829 for a return material authorization number (RMA#).** All items must be shipped prepaid. RETI will, at no charge, repair or replace, in RETI's sole discretion, any product that satisfies the conditions stated above. RETI retains the right to change models, specifications and price without notice.

This equipment has been manufactured under strict quality and safety guidelines. As with any equipment of this type, full understanding of the instructions and its use is mandatory and imperative for the safety of its user. RETI is not responsible for any damages or injuries sustained due to improper use or modification of any of its products, or resulting from any use which deviates from the product's intended usage. RETI is not responsible for any injuries sustained due to failure to read and adhere to the instructions for use. Any misunderstanding or questions regarding the products of their use should be directed to RETI prior to any use. It is the owner's sole responsibility to inspect the product regularly for damage, improper installation, or conditions that could jeopardize the ultimate safety of the product. **Owner is responsible to understand and follow product field weight rating and must never exceed maximum weight rating.** RETI is not responsible for any malfunction or injury resulting from normal wear and tear, damage caused by improper use, improper maintenance, negligence or accidents. This product, if used safely as intended, will provide trouble free service for the useful life of the product. We hope you will enjoy the quality of our products for years to come, and have a safe hunt.

MODEL RE741

MAXIMUM USE HEIGHT - 15' 9" TO SHOOTING RAIL

MAXIMUM OCCUPANCY - ONE (1)

TOTAL WEIGHT LIMIT - 300 LB

WARNING

- ▲ This product carries strict height and weight restrictions. **Do Not** use this product if you exceed the total weight limit. Please note that the total weight limit includes the user(s) and their equipment.

WARNING

- ▲ **When hunting from a treestand or free standing platform stand falls can occur any time after leaving the ground causing injury or death.**
- ▲ **Read and understand** all of the manufacturer's Warnings and Instructions and use all safety devices provided by the manufacturer. Contact the manufacturer for any questions. Failure to do so could result in injury or death.
- ▲ **Never** exceed the total weight limit of the treestand or free standing platform stand.
- ▲ **Never** use a treestand or free standing platform stand during inclement weather such as rain, lightning, windstorms or icy conditions and end your hunt and return to the ground if inclement conditions arise.
- ▲ **Never** use a treestand or free standing platform stand while using drugs (even prescription drugs) or alcohol.
- ▲ **Never** use a treestand or free standing platform stand while feeling ill, nauseous or dizzy, or if you have a prior medical condition that could cause a problem, that is, heart condition, joints that lock-up, spinal fusions, etc., or if you are not well rested. **Never** sleep in stand.
- ▲ **Always** avoid electrical power lines.
- ▲ **Never** rely on a tree branch for support.
- ▲ **Never** jump or bounce on a treestand or free standing platform stand to seat it to the tree or ground.
- ▲ Pull up a bow, backpack, or firearm or other equipment only after being secure in the treestand or free standing platform stand and a firearm must be pulled up with it unloaded, chamber open, and muzzle down.
- ▲ **Always** inform someone of the hunting location, where the treestand or free standing platform stand will be located and the expected duration of the hunt.

WARNING

- ▲ A signal device such as a mobile phone, radio, whistle, signal flare or personal locator device (PLD) must be on your person and readily available at all times.
- ▲ Inspect the treestand or free standing platform stand and all safety devices each time before use and **Do Not** store a treestand or free standing platform stand outdoors when not in use.
- ▲ **Never** modify your treestand or free standing platform stand in any way by making repairs, replacing parts, or altering it except if explicitly authorized in writing by the manufacturer.
- ▲ Practice installing, adjusting and using your treestand or free standing platform stand at ground level prior to using it at elevated positions. Study your new stand to become familiar with all of its features and design. Doing so will confirm that the product is manufactured, assembled and installed correctly.
- ▲ Instructions (written and video) shall be kept in a safe place and reviewed at least annually. It is the responsibility of the treestand or free standing platform stand owner to furnish the complete instructions to any person who borrows or purchases the treestand or free standing platform stand.
- ▲ **Always** use at least four (4) people to install or take down a free standing platform stand.
- ▲ Stabilization devices must be attached before climbing to the platform.
- ▲ When installing a ladder stand or free standing platform stand, always bounce on the first rung to set the ladder into the ground according to manufacturer's instructions before proceeding to climb any higher.
- ▲ Check every ladder/leg section connection every time you use the stand before you leave the ground. If ladder/leg sections are separating, do not use the stand.
- ▲ Check the ground under the stand to make sure it is firm and level. Sloping ground or uneven surface (one side on a rock) can cause your ladder or free standing platform stand to tilt or shift off as you climb.
- ▲ **Always** maintain three (3) points of contact when climbing a ladder treestand or free standing platform stand. Proper three-point contact means having either two feet with one hand or one foot with two hands on the step portion of the ladder or climbing aid at all times.
- ▲ **Always** lean forward as you climb ladder or climbing aid.
- ▲ **Never** exceed the stated maximum use height.

WARNING

- ▲ **Do Not** use this product until you have watched the included treestand safety DVD, understand it, and practiced the techniques for safe hunting discussed in this DVD.
- ▲ Read and perform all inspection and maintenance tasks before each and every use. Replace any questionable components immediately with RETI original replacement parts.
- ▲ **Do Not** crush tubing when tightening bolt assemblies! Identify and familiarize yourself with all parts before you start. Bolt identification chart can be found in the back.
- ▲ Double check assembly steps to be certain you have correctly assembled this product.
- ▲ **Never** use any product that has not been maintained or inspected properly - Your life depends on it!
- ▲ **Always** wear the appropriate footwear when using a free standing platform stand. A good non-slip safety boot is important to your personal safety. Be especially careful that boot laces do not get hooked on the stand or any of its components (tuck shoelaces into boots before climbing).
- ▲ Do not position this product on a slope, unlevel, or wet ground. It may tip over and serious injury or death may occur.
- ▲ Ground should be such that ground stakes (not included) can be driven into the ground through holes provided in foot pads. This will help prevent pod from tipping over in strong winds. You will need to make or purchase (4) ground stakes. Stakes should be 3/8 inch rod x 24 inches long.

INSPECTION AND MAINTENANCE SCHEDULE

BEFORE EACH USE PERFORM THE FOLLOWING:

- Inspect all webbing, rope, cord, and strap assemblies for wear or damage.
- Inspect cables and/or cable ends for damage or kinking.
- Inspect all hardware and chain components for damage.
- Inspect for any structural damage to product. (If any exists call RETI customer service.)
- Inspect all nut and bolt assemblies to be certain none are loose.
- Inspect for any missing parts.
- Lubricate all pivot and slide together points with powder graphite, petroleum jelly or silicone spray to prevent noise, wear and rust.
- Inspect entire product for any rust, corrosion, cracks, freezing, excessive heat or rotting damage that may effect the safety of your product. Discard any questionable product.
- Inspect entire product for any structural damage - pay close attention to all weld locations. (Return to factory for repair or discard product if any damage is found.)
- Using correct wrenches inspect all nut & bolt assembly locations and snug up any that may be loose. Be careful not to crush tubing when tightening!
- Inspect and check operation of all cables, cable ends, cord, rope, webbing, and strap or chain assemblies. Replace with factory new any item or assembly that shows signs of wear, damage, kinking, or functions incorrectly.
- Inspect seat. Replace any seat with factory new that shows signs of structural damage or wear.
- Inspect all hardware for wear or damage, also be sure you have no missing parts.
- Never modify your stand in any way by making repairs, replacing parts, or altering adding or attaching anything to it except if explicitly authorized in writing by the manufacturer.

ASSEMBLY AND USE INSTRUCTIONS

SELECTING A GOOD LOCATION

Assemble this product only in areas that meet the following criteria! No overhead power lines near area; open, flat, level, dry ground of sufficient size to allow for assembly, up righting and climbing. Approximate area needed for assembly is 14' X 24'.

POD LADDER ASSEMBLY INSTRUCTIONS

Tools needed: Two 7/16" wrenches, two 1/2" wrenches, and a tape measure to measure level ground area needed & cross brace length.

NOTE: It is highly recommended that as much assembly as possible be done in a garage setting because of hardware amount and time involved! Allow between two and four hours for assembly.

IMPORTANT ASSEMBLY STEP:

Do not tighten any nut and bolt combinations completely until all parts are assembled together! Finger tighten plus one turn of a wrench only! This will temporarily hold the lock nut on the bolt while helping alignment of all parts! After all parts are assembled together, all nut & bolt combinations must be completely tightened.

1. Attach (2) platforms (TP100) together using (2) provided 1/4-20 x 2-1/4" bolts, locknuts and steel washers. **SEE FIGURE 1. DO NOT tighten all nut & bolt assemblies completely!**
2. Attach the assembled platforms to the (2) provided J-receiver tubes (TP109) using (4) provided 1/4-20 x 2-1/2" bolts, locknuts and steel washers. **SEE FIGURE 2**
3. Attach the two rear leg pockets w/ plates (TP151 & TP152) to the bottom of assembled platform using (6) provided 1/4-20 x 1-1/2" bolts, locknuts and steel washers. **SEE FIGURE 3**

NOTE: Make sure the pockets are orientated outward, away from each other.

4. Attach the seat post (TP11) to the assembled platforms using (4) provided 1/4-20 x 1-1/2" bolts and locknuts. **SEE FIGURE 4**

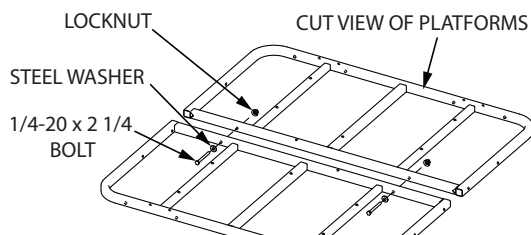

FIGURE 1

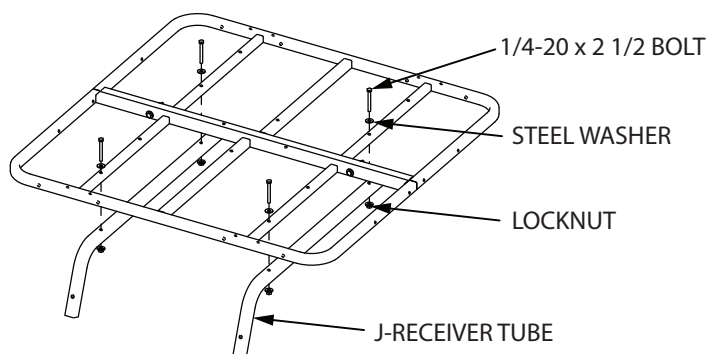

FIGURE 2

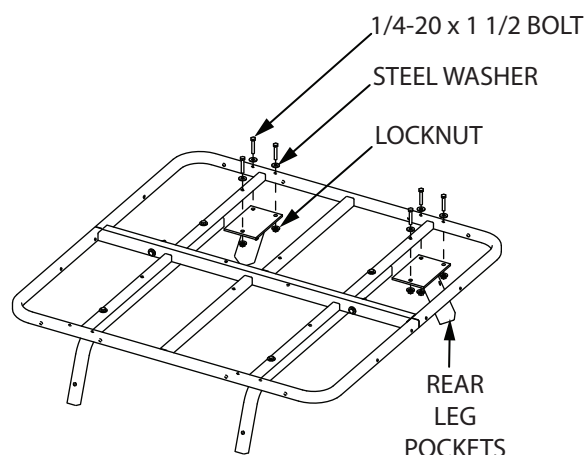

FIGURE 3

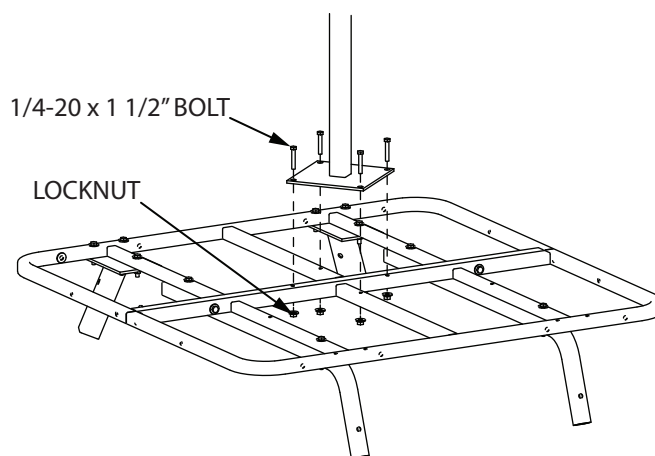

FIGURE 4

5. Attach swivel (48662) to top of seat post (TP11) using (4) provided 1/4-20 x 3/4" bolts and locknuts. **SEE FIGURE 5**

NOTE: Make sure head of bolts are on swivel side and nut on bottom of seat post plate to prevent any obstruction when swivel is pivoted during use.

6. Attach factory assembled seat (16857) to the swivel using (4) provided 1/4-20 x 1-1/4" bolts and locknuts. **SEE FIGURE 5**

NOTE: Make sure head of bolts are on swivel side and nut on top of seat frame to prevent any obstruction when swivel is pivoted during use.

7. Attach factory assembled backrest (17630) to tabs of seat frame using (2) provided 1/4-20 x 1-1/2" bolts and locknuts. **SEE FIGURE 6**

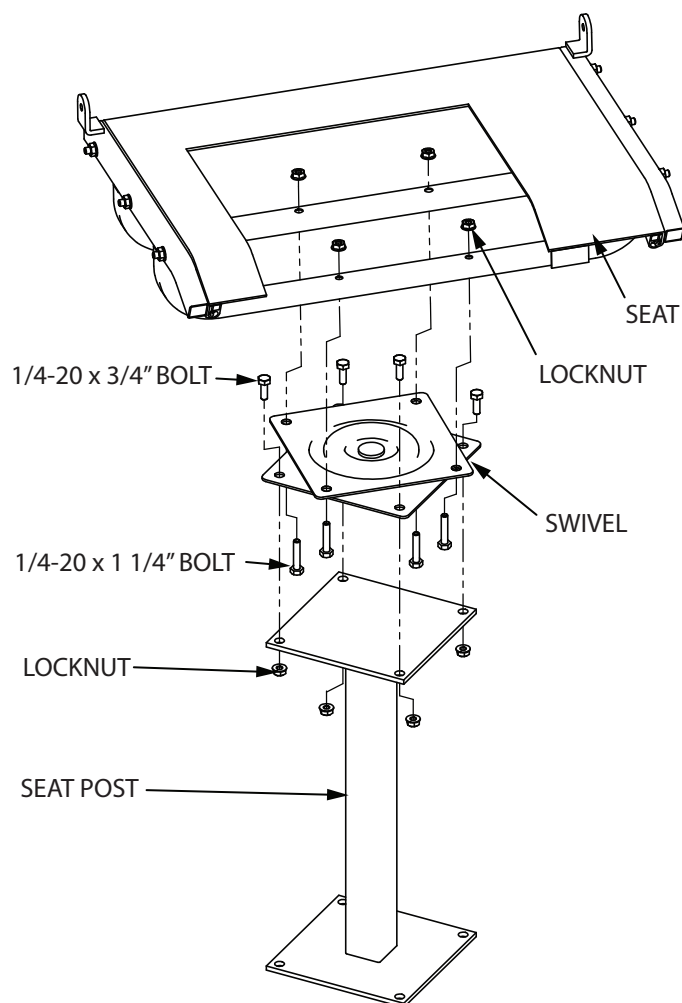

FIGURE 5

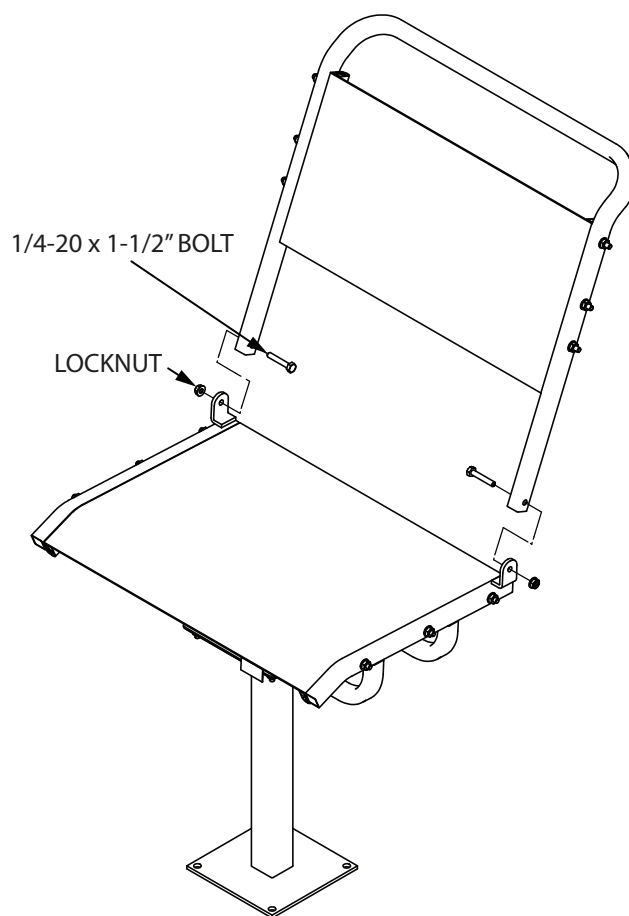

FIGURE 6

8. For assembly of the armrests and shooting rail, you must first remove the “front” (2) bolts/nuts from factory assembled seat frame and the “bottom” (4) bolts/nuts from factory assembled backrest frame. Discard this hardware.

SEE FIGURE 7

9. Attach the (2) armrests (17635) to the seat frame and backrest frame using (4) provided 1/4-20 x 2-1/2” bolts and locknuts. **SEE FIGURE 8**

NOTE: The armrests are more than 3” longer on one side. Bolt the longer side to the backrest frame and the shorter side to the seat frame to achieve proper backrest angle.

10. Using the longer end, attach the (2) shooting rail side rails (TP142) to the backrest frame using (2) provided 1/4-20 x 2-1/2” bolts, locknuts and plastic washers. **SEE FIGURE 8**

11. Attach the shooting rail front rail to the shooting rail side rails using (2) provided 1/4-20 x 1-1/4” bolts, lock nuts and steel washers. Side rails should be inserted into the front rail and bolts should go through both rails. **You must now tighten all nut and bolt combinations securely; DO NOT CRUSH TUBING WHEN TIGHTENING! SEE FIGURE 8**

12. Attach the 66” shooting rail pad to shooting rail by wrapping around metal tubing and attaching Velcro together. The pad will act as a noise dampener between shooting rail and armrests.

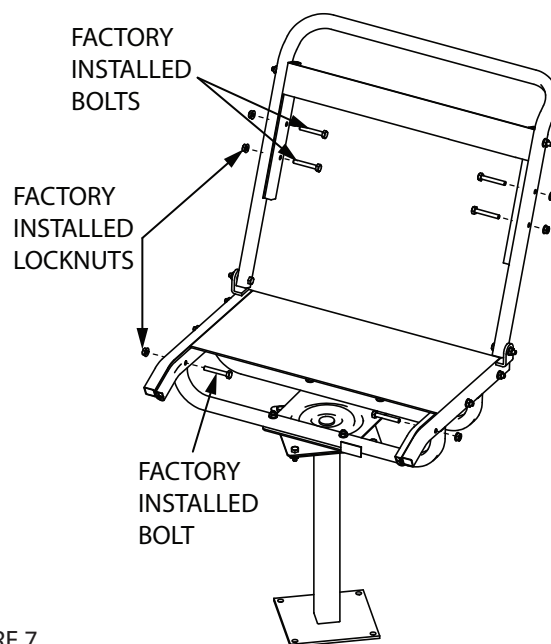

FIGURE 7

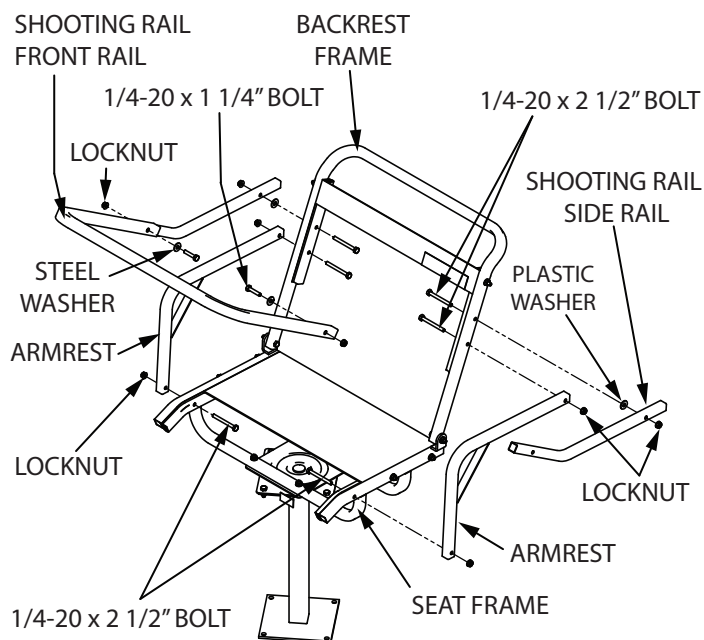

FIGURE 8

13. Attach the ladder foot pads (TP113) to the bottom (short) ladder (TP159) using (2) provided 1/4-20 x 1-1/2" bolts and locknuts. This step now makes this the bottom ladder section. **SEE FIGURE 9**

NOTE: Channel on foot pads should touch on three sides of the ladder legs.

14. Assemble all ladder sections together and attach them to the assembled platform in the following order: attach top ladder (SL51 ladder) onto the J-receiver tubes; attach middle ladder (SL51 ladder) onto the top ladder; attach bottom ladder (TP159 ladder with feet) onto the middle ladder.

NOTE: Make sure foot pads are orientated out, away from platform.

15. Attach single support brace tabs (TP115) to each joint location of ladder assembly (6 total locations) and secure those locations using (6) provided 1/4-20 x 1-3/4" bolts and locknuts. **SEE FIGURE 9**

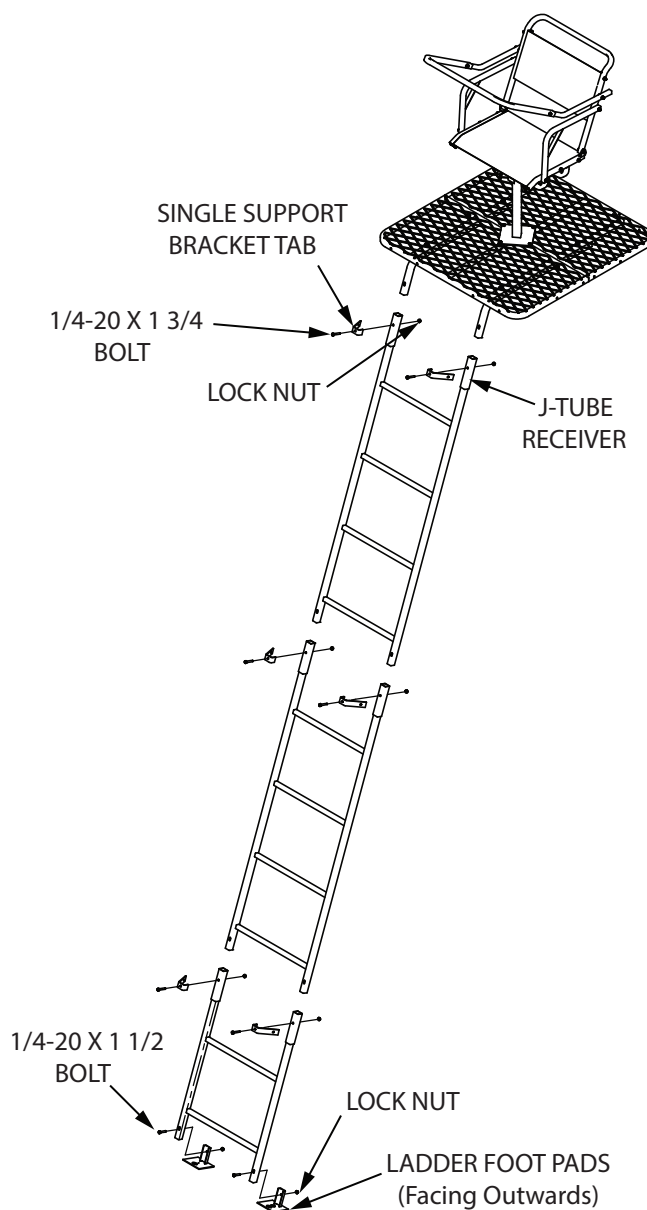

FIGURE 9

16. Assemble all leg sections together and attach them to the assembled platform in the following order:

- Insert top legs (TP145) into the leg pockets attached to the platform.
- Insert middle legs (TP145) into the top leg pockets.
- Insert bottom legs with feet (TP147) into the middle leg pockets.

NOTE: Make sure foot pads are orientated out, away from platform.

17. Secure top legs to the leg pockets attached to platform using (2) provided 1/4-20 x 2-1/4" bolts and locknuts.

SEE FIGURE 10

18. Attach (4) dual support brace tabs (TP146) to each remaining joint locations of the leg assemblies (4 total locations) and secure those locations using (4) provided 1/4-20 x 2-1/4" bolts and locknuts. **SEE FIGURE 10**

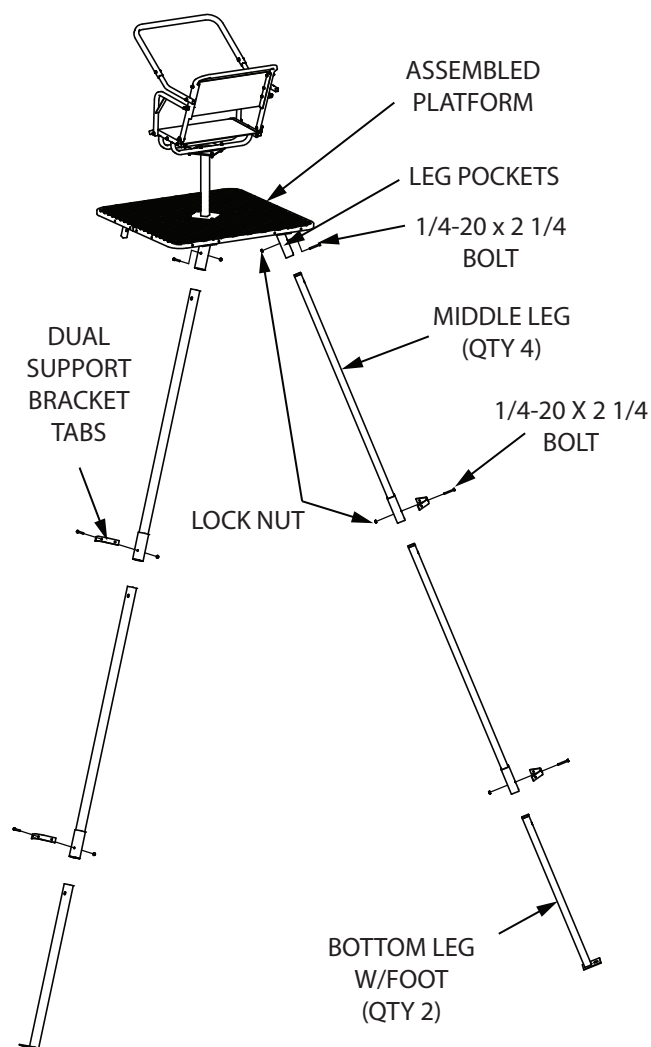

FIGURE 10

19. Assemble Cross Braces as follows:

- a. Locate the (2) 12" male cross braces (TP149) and (2) 60" female cross braces (TP131). Insert the male cross braces into the female cross braces. Use (2) provided 1/4-20 x 1-1/4" bolts and locknuts to secure these cross braces in the hole location to achieve length A. **SEE FIGURE 11**
- b. Locate the (2) 36" male cross braces (TP132) and (2) 60" female cross braces (TP131). Insert the male cross braces into the female cross braces. Use (2) provided 1/4-20 x 1-1/4" bolts and locknuts to secure these cross braces in the hole location to achieve length C. **SEE FIGURE 11**
- c. Locate the (4) 48" male cross braces (TP150) and (4) 60" female cross braces (TP131). Insert the male cross braces into the female cross braces. Use (4) provided 1/4-20 x 1-1/4" bolts and locknuts to secure these cross braces in the hole location to achieve lengths D & E (two each). **SEE FIGURE 11**

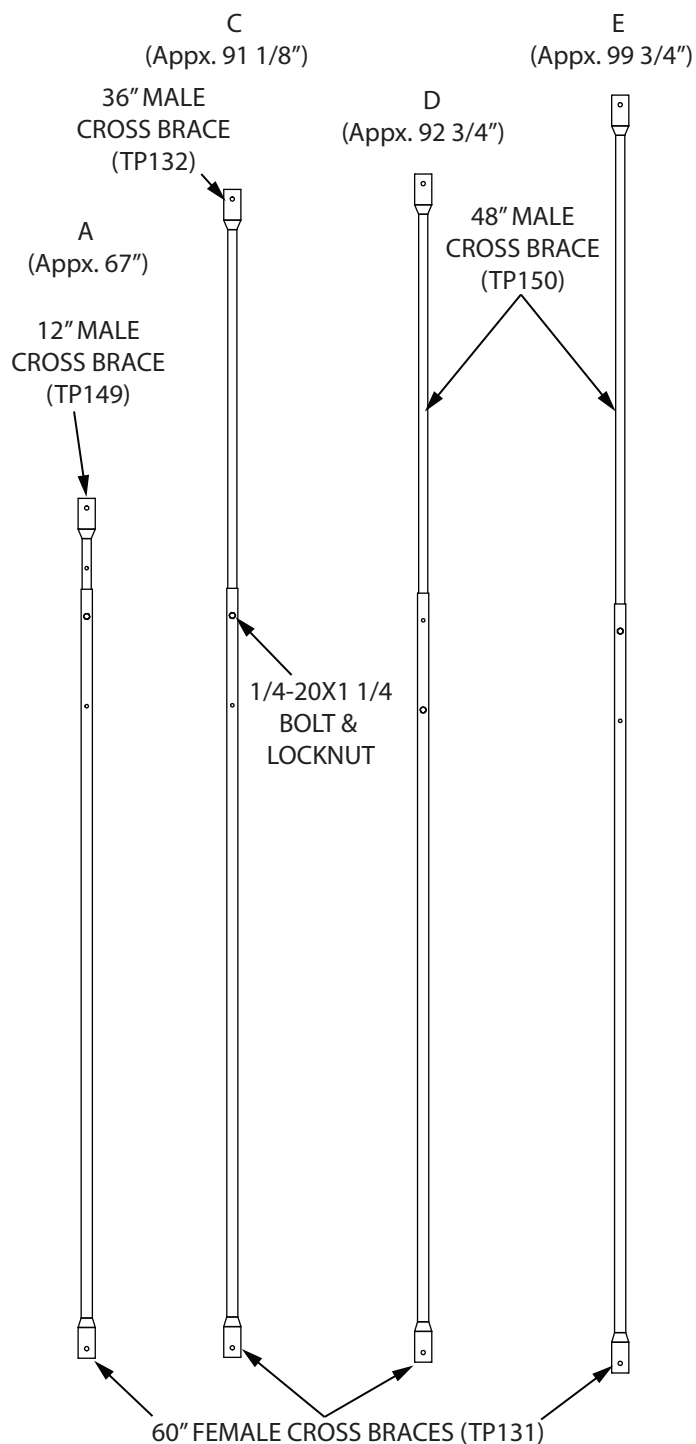

FIGURE 11

20. Install Cross Braces as follows:

a. The two cross braces that run diagonally from the top ladder section to the top/middle leg joint are the shortest. Using pole length A (approximately 67"), attach to the support brace tabs on top ladder section with (2) provided 5/16-18 x 3/4" bolts and locknuts. Attach other end of cross brace assemblies to the support brace tabs of top/middle leg joints. Finger tighten with (2) provided 5/16-18 x 1-1/4" bolts and locknuts to temporarily hold these cross braces in place. **SEE FIGURE 11, 12, and 13**

IMPORTANT NOTE: Be sure to use 1-1/4" bolts at any location where multiple cross brace poles are attached.

b. The two cross brace poles that run diagonally from the top/middle leg joint to the middle/bottom ladder joint are longest. Using pole length E (approximately 99-3/4") attach to the lower support brace tabs of leg joints using (2) provided 5/16-18 x 3/4" bolts and locknuts. Attach opposite end of pole length E to middle support brace tabs of ladder joints using (2) previously finger tightened 5/16-18 x 1-1/4" bolts and locknuts. **SEE FIGURE 11 and 12**

NOTE: Make sure to use the 1-1/4" bolts and nuts to attach cross braces at the leg joint that is already holding the diagonal braces or at any location where multiple cross brace poles are attached.

c. The two cross brace poles that run from the top/middle ladder joint to the middle/bottom leg joint are pole length D (approximately 92-3/4"). Using pole length D attach to the support brace tabs of leg joints and ladder joints using (4) provided 5/16-18 x 3/4" bolts and (4) locknuts.

SEE FIGURE 11 and 12

d. The two cross braces that run diagonally between both rear legs are both the same length. Using pole length C (approximately 91-1/8"), attach to the support brace tabs on leg joints using (4) provided 5/16-18 x 3/4" bolts and locknuts. **SEE FIGURE 11 and 13**

21. Once all cross braces are attached to pod, **you must now tighten all nut & bolt assemblies. Be sure not to over tighten or crush tubing when tightening!** Double and triple check all nuts and bolts to make sure all are securely fastened.

22. Go over every detailed step of assembly to be sure all assembly is done correctly and all bolt locations are secured and snug. Be sure not to over tighten or crush tubing when tightening! Once you are certain all assembly is complete and correct, proceed to curtain assembly instructions.

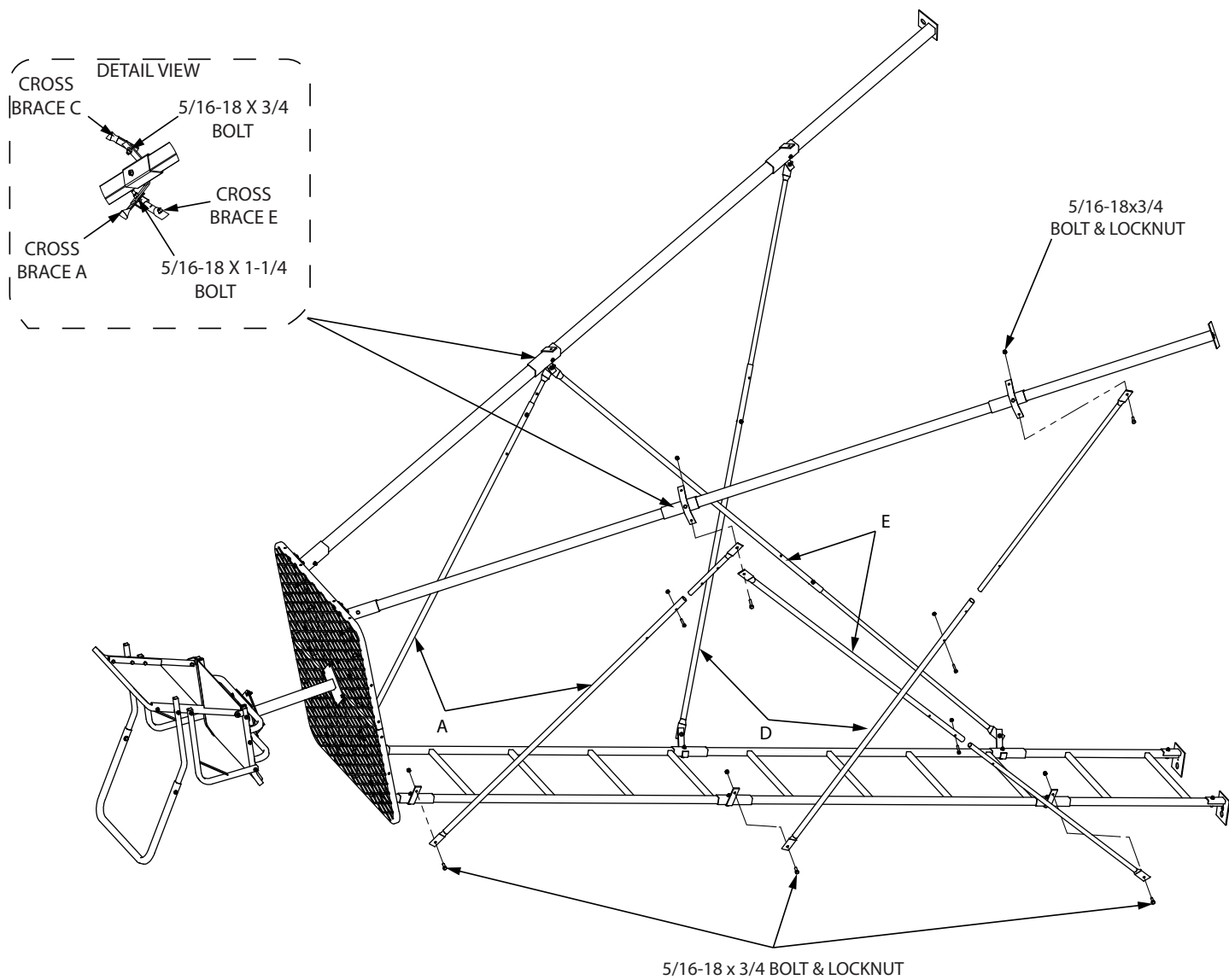

FIGURE 12

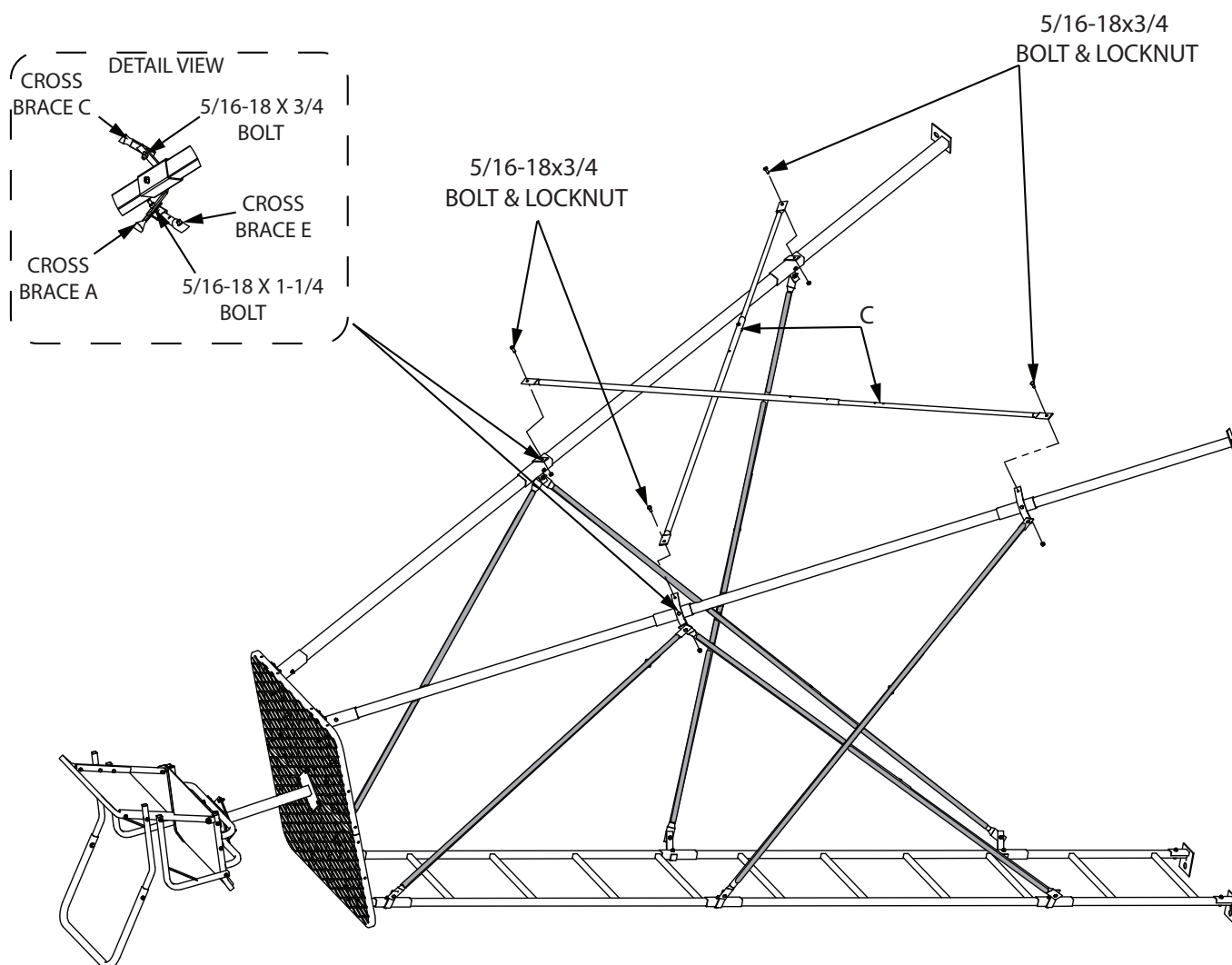

FIGURE 13

POD CURTAIN ASSEMBLY INSTRUCTIONS

23. Assembly Pod Curtain as follows:

- a. Attach the (4) uprights (TP162) to the platform using (4) provided 1/4-20 x 2" bolts, locknuts and washers.

SEE FIGURE 14

NOTE: DO NOT tighten all nuts and bolts completely!

- b. Attach the (4) flat bar supports (AL7) to the inside of uprights using (4) provided 1/4-20 x 1-1/4" bolts and locknuts.

- c. Attach the opposite end of flat bars supports to the platform using (4) provided 1/4-20 x 1-1/2" bolts and locknuts.

- d. Insert the (2) curtain rails (TP161) into the (2) spanner tubes (TWR26) forming a square. Using (4) provided 1/4-20 x 1-1/4" bolts, locknuts and washers, secure the curtain rails and spanner tubes together.

- e. Attach the assembled rail square to the outside of uprights using (4) provided 1/4-20 x 2" bolts, locknuts and washers. **You must now tighten all nut & bolt assemblies securely. DO NOT crush tubing when tightening!**

- f. The side of curtain with numerous Velcro loops is the top side of curtain. Attach the top side of curtain to the curtain frame by wrapping all Velcro attachment points around metal tubing and securing together. Curtain should be positioned with zippered door on the front/center of your ladder for entry and exit purposes.

- g. Once top of curtain is secured properly, pull the bottom edges of curtain down around the foot platform. The sewn-in elastic bungee will securely grab the lower corners of your platform. Attach remaining Velcro loops on bottom/back seam of curtain securely. Once you are certain all assembly is complete and correct, proceed to Uprighting and Use Instructions.

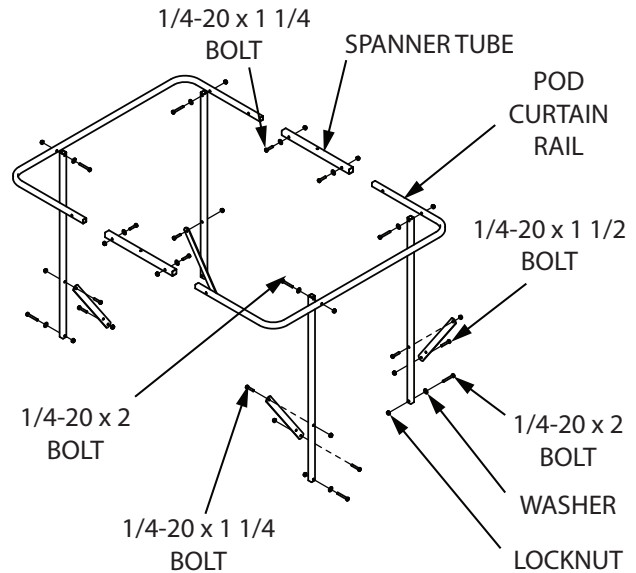

FIGURE 14



WARNING

▲ **Only** use approved RETI parts. Failure to do so may result in serious injury or death!

UPRIGHTING AND USE INSTRUCTIONS

1. With assembled product lying on ground flat between one leg and ladder section, position one person at feet end of legs. This person has to prevent the bottom end from tilting up when platform end is lifted and prevent feet from skidding across the ground.
 2. Position two people at platform end, lift platform end of pod and continue uprighting by walking toward feet end and moving hands along ladder and leg sections. As pod goes over-center, slowly allow the pod to land on the opposite leg section. Be sure all people are clear to prevent injury.
 3. Pod may need to be positioned to allow for a level stand and all ladder/legs touching ground. Avoid rocks or anything that may hinder this from happening. Only move pod with three people; one person on each leg section and one person on ladder section. Each person should lift equally and only enough to shift pod to a level ground location. **DO NOT lift pod by round cross braces as you could bend or damage them.**
 4. Drive (4) ground stakes (not included) through the holes in the (4) feet. Stakes should be approximately 24" in length with 18" in ground and should be driven in at an angle. **SEE FIGURE 15**
 5. Climb ladder slowly and carefully always having three points of contact on ladder at all times. Lean forward, towards ladder as you climb. Be sure hands are free for climbing.
 6. Upon reaching foot platform, with shooting rail flipped back out of the way, carefully turn around and sit on seat.
- NOTE: To exit your ladder pod, reverse the climbing procedure. Take great care to be sure of hand and foot placement as you proceed back down pod ladder.**
7. Reverse uprighting and use instructions to take ladder pod down.

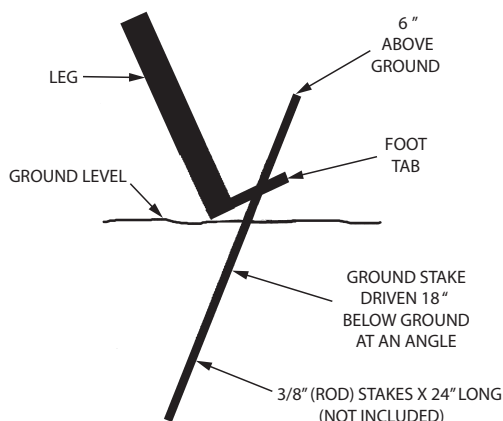
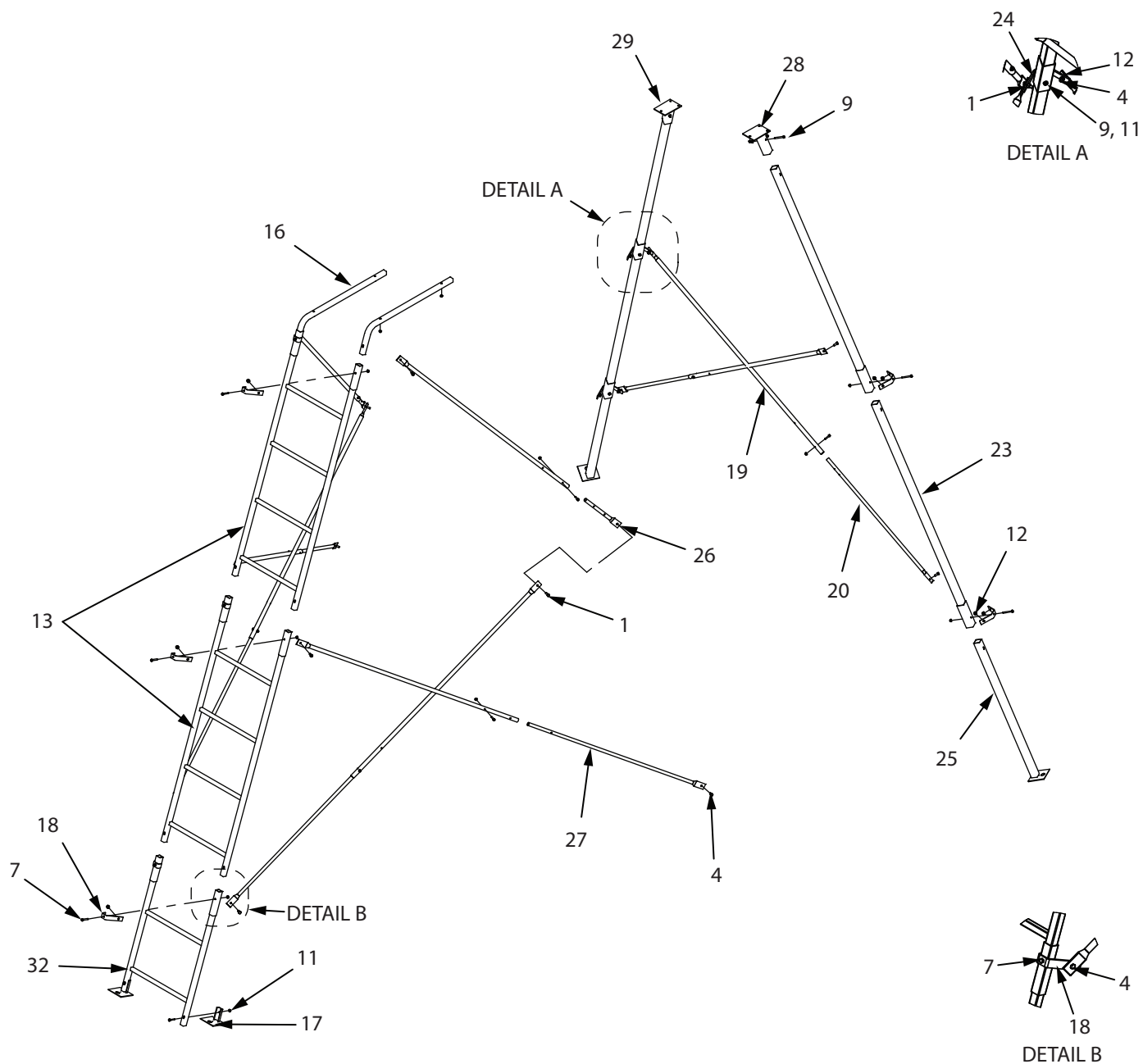

FIGURE 15

WARNING

- ▲ Double check assembly steps to be certain you have correctly assembled this product.
- ▲ Study your new stand to become familiar with all of its features and design. Save these instructions for future reference.
- ▲ **Be Sure** uprighting area is open, flat, level, and dry with no power lines near!
- ▲ **Always** use at least four (4) people to install or take down a free standing platform.
- ▲ **Do Not** use any type of motorized vehicle to upright this free standing platform stand. You could cause unnecessary damage to this product. Upright by hand only using four people, two people at feet end of free standing platform stand and two people at platform end. Be aware it is top heavy. Use great care and caution during this process to prevent an off balance fall to prevent injury.
- ▲ As free standing platform stand goes over-center, be sure to slowly allow the stand to land on the opposite leg sections. **Be Sure** all people are clear to prevent injury.
- ▲ **Never** stand on seat, it is designed for sitting only.
- ▲ If seat is removable, be certain it is securely attached when in use.
- ▲ **Always** lean forward as you climb ladder or climbing aid.
- ▲ **Always** maintain three (3) points of contact when climbing a ladder treestand or free standing platform stand. Proper three-point contact means having either two feet with one hand or one foot with two hands on the step portion of the ladder or climbing aid at all times.
- ▲ **Always** wear the appropriate footwear when using a free standing platform stand. A good non-slip safety boot is important to your personal safety. Be especially careful that boot laces do not get hooked on the stand or any of its components (tuck shoelaces into boots before climbing).
- ▲ Some models include a shooting rail. **Never** lean against, lean over, or sit on shooting rail. It is designed as a shooting rest only. On models that have a non-fixed shooting rail, be sure shooting rail is flipped back or swung to the side when ascending or descending ladder.
- ▲ Some models include a footrest, which is designed as a footrest only. **Never** stand on footrest! **Always** be fully aware of foot placement.

ILLUSTRATED PARTS BREAKDOWN



ILLUSTRATED PARTS BREAKDOWN

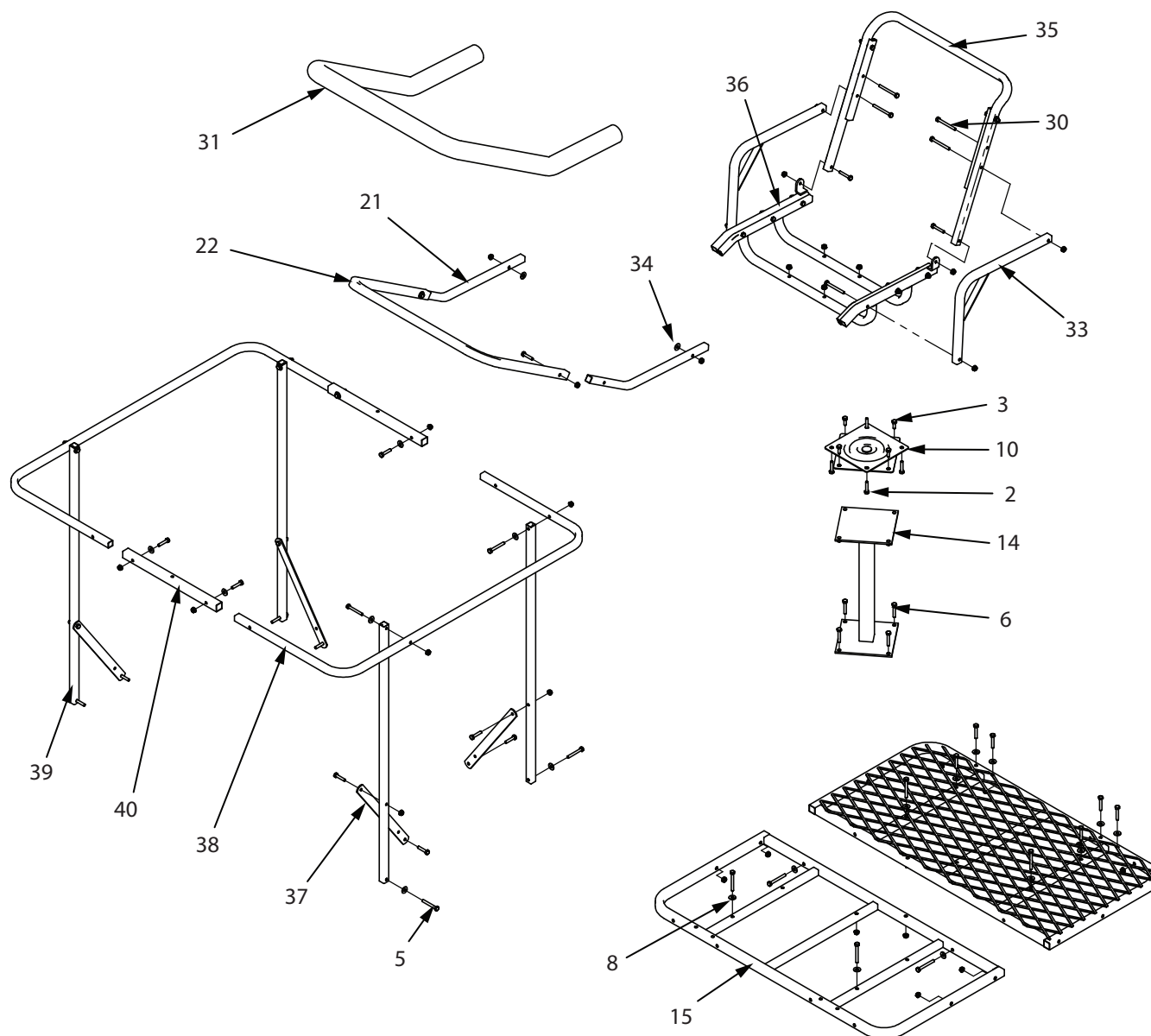

ILLUSTRATED PARTS BREAKDOWN

ITEM #	PART #	DESCRIPTION	QTY
1	1401B	BOLT 5/16-18 X 1-1/4 HHCS GR5 BLK	2
2	8909B	BOLT 1/4-20 X 1-1/4 HHCS GR5 BLK	22
3	8930B	BOLT 1/4-20 X 3/4 HH GR5 BLK	4
4	48151	BOLT 5/16-20 X 3/4 HHCS GR5 BLK	12
5	48153B	BOLT 1/4-20 X 2 HHCS BLK P-T	8
6	48240B	BOLT 1/4-20 X 1-1/2 HHCS GR5 BLK	18
7	48250B	BOLT 1/4-20 X 1-3/4 HHCS GR5 BLK	6
8	48261B	WASHER, FLAT BLK 1/4	26
9	48271B	BOLT 1/4-20 X 2-1/4 HH GR5 BLK	8
10	48662	SWIVEL	1
11	48752B	NUT, TOP LOCK FLANGED 1/4-20	76
12	60G5NYB	NUT 5/16-18 HNYLK BLK	14
13	SL51	LADDER, 4-STEP	2
14	TP11	SEAT POST	1
15	TP100	PLATFORM	2
16	TP109	RECEIVER	2
17	TP113	FOOT PAD	2
18	TP115	BRACKET, SUPPORT BAR	6
19	TP131	BRACE, FEMALE CROSS 60"	8
20	TP132	BRACE, MALE CROSS 36"	2
21	TP142	SIDE SHOOTING RAIL	2
22	TP143	FRONT SHOOTING RAIL	1
23	TP145	LEG, FTS	4
24	TP146	TAB, DUAL SUPPORT BRACE	4
25	TP147	BOTTOM LEG, W/FOOT	2
26	TP149	BRACE, MALE CROSS 12"	2
27	TP150	BRACE, MALE CROSS 48"	4
28	TP151	LEFT, LEG RECEIVER	1
29	TP152	RIGHT, LEG RECEIVER	1

ITEM #	PART #	DESCRIPTION	QTY
30	48270B	BOLT, (1/4-20 x 2 1/2 HHCS GR5 BLK ZN)	10
31	48874	SLEEVE, (BLACK FOAM 66")	1
32	TP159	BOTTOM LADDER	1
33	17635	ARM REST, WELDMENT TEARTUFF	2
34	WN516	WASHER, NYLON BLK 5/16	2
35	17630	BACKREST ASSEMBLY, TEARTUFF	1
36	16857	SEAT ASSEMBLY, TEARTUFF	1
37	AL7	SUPPORT , FOOT PLATFORM, SIDE SUPPORT	4
38	TP161	RAIL, POD CURTAIN	2
39	TP162	UPRIGHT, SHOOTING RAIL 33-1/4"	4
40	TWR26	TUBE, RAIL SPANNER	2
41*	48069	CURTAIN, SEWN COMPLETE PERIMETER POD	1
* Item Not Illustrated			

BOLT IDENTIFICATION CHART

Not all bolt sizes shown are included with all treestands.
Bolts shown are for size reference only. Extra hardware may
be included in the parts bag.

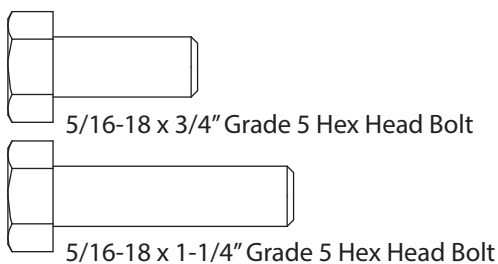
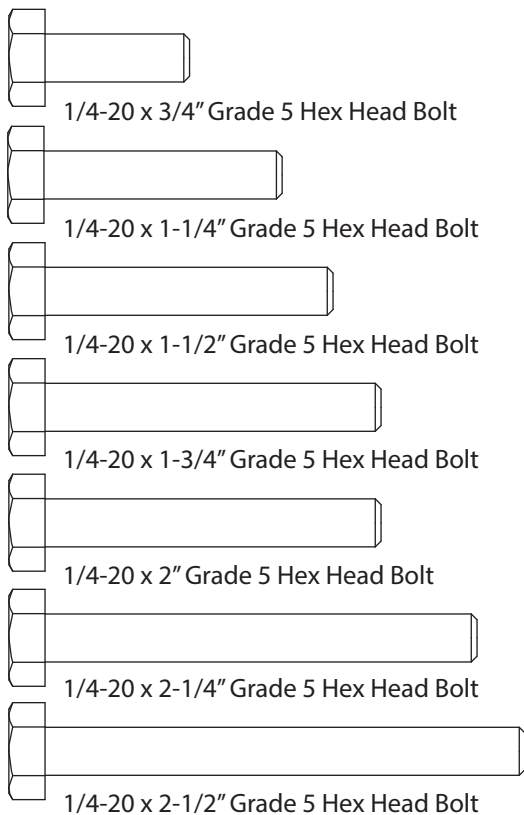



Rivers Edge® Treestands, Inc.

1160 Eighth Avenue, PO Box 755

Cumberland, WI 54829

800-450-EDGE (3343) | Fax 715-822-2124

Email: info@huntriversedge.com