

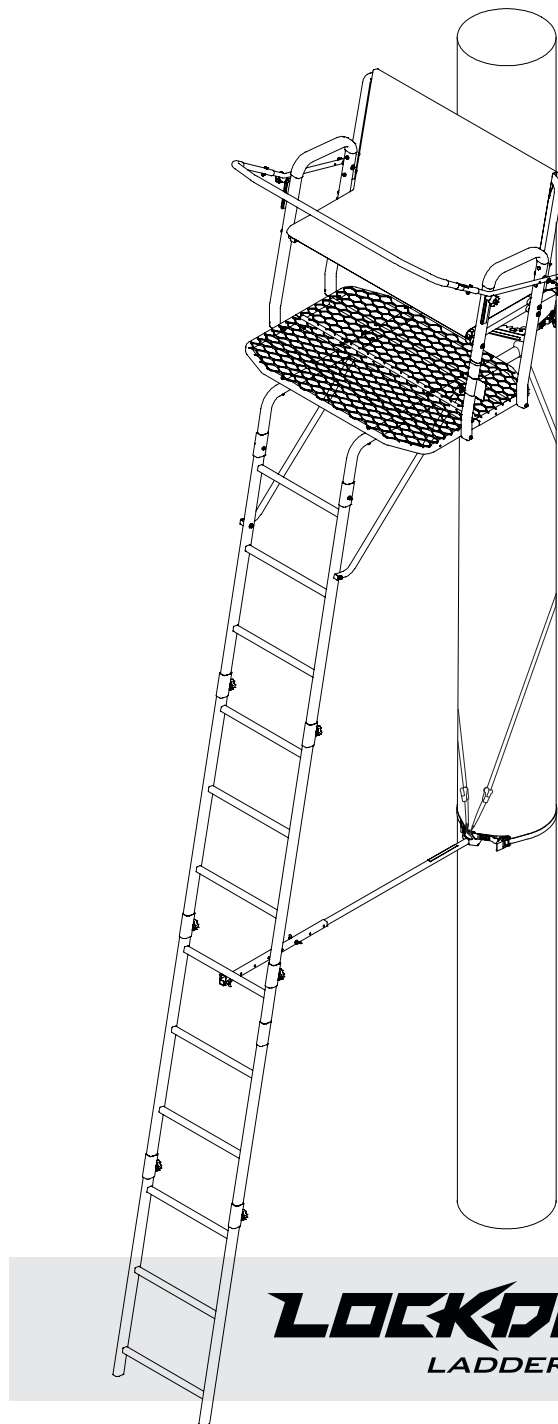

WE ARE HUNTERS



LOCKDOWN™
LADDER STANDS

PRODUCT MEETS
INDUSTRY STANDARDS
RECOGNIZED BY



PARTICIPATING MEMBER

Operator's Manual

LOCKDOWN™ **2-MAN** Ladder Stand

MODEL RE654

Maximum Height

17' 5" to shooting rail

Maximum Field Rating

500 lbs; no more than
300 lbs per person.

Tree Diameter Range

12" to 20"

Wear Your Harness!



Watch video before using.



standsafety.com/r3
LADDER STAND SAFETY



Get parts online at
www.HuntRiversEdge.com

© 2018 RETI
All Rights Reserved

P/N: 29500
REV3: 12/11/18

INTRODUCTION

Rivers Edge® Treestands are engineered with you the hunter in mind. We appreciate your purchase of one of our world class treestands. Follow these few simple instructions and your stand will provide you many years of trouble-free pleasure. Instructions should be kept in a safe place and reviewed at least annually.

If for any reason you have a problem with your product, **DO NOT return to the retailer**, contact the Rivers Edge® customer service department at 800-450-EDGE (3343) for assistance.

CONTENTS

Introduction/Warranty	2
Warnings.....	3-4
Inspection and Maintenance	4
Hardware Identification Chart.....	5
Tools Needed	5
Assembly Instructions	7-13
Warnings.....	14
Setup and Use Instructions.....	15-16
Finished Ladder.....	17
Illustrated Parts Breakdown.....	18-19

WARRANTY

RETI offers a **one year warranty** for all components of the treestand. These warranties apply to the original owner with a proof of purchase. These warranties begin on the date of purchase by the first retail consumer and continue for the period specified above. These warranties apply to products that are not modified, abused or used in a manner that deviates from the product's intended usage. Minor fading in color is normal and is not covered by warranty. Any corrosion of painted surfaces that occurs as a result of paint being removed or damaged is also not covered by warranty. RETI offers no other warranty expressed or implied. Products for which warranty work has been approved must be sent directly to RETI and performed by RETI. **To obtain warranty service and/or replacement instructions, you must obtain prior approval from RETI before shipping your package to us by calling our customer service department at 800-450-3343 or by writing to: RETI, P.O. Box 755, 1160 Eighth Avenue, Cumberland, WI 54829 for a return material authorization number (RMA#).** All items must be shipped prepaid. RETI will, at no charge, repair or replace, in RETI's sole discretion, any product that satisfies the conditions stated above. RETI retains the right to change models, specifications and price without notice.

This equipment has been manufactured under strict quality and safety guidelines. As with any equipment of this type, full understanding of the instructions and its use is mandatory and imperative for the safety of its user. RETI is not responsible for any damages or injuries sustained due to improper use or modification of any of its products, or resulting from any use which deviates from the product's intended usage. RETI is not responsible for any injuries sustained due to failure to read and adhere to the instructions for use. Any misunderstanding or questions regarding the products of their use should be directed to RETI prior to any use. **All RETI treestands are sold with a full body harness ("Fall Arrest System") that meets standards set by the Treestand Manufacturer's Association ("TMA").** It is the owner's sole responsibility to inspect the product regularly for damage, improper installation, or conditions that could jeopardize the ultimate safety of the product. Failure to use or improper use of the provided Fall Arrest System may result in serious injury or death. **ALWAYS wear the provided Fall Arrest System while using this product. Owner is responsible to understand and follow product field weight rating and must never exceed maximum weight rating.** RETI is not responsible for any malfunction or injury resulting from normal wear and tear, damage caused by improper use, improper maintenance, negligence or accidents. This product, if used safely as intended, will provide trouble free service for the useful life of the product. We hope you will enjoy the quality of our products for years to come, and have a safe hunt.

STOP

READ AND UNDERSTAND THE FOLLOWING WARNINGS BEFORE ASSEMBLY

MODEL RE654

MAXIMUM USE HEIGHT - 17' 5" TO SHOOTING RAIL

MAXIMUM OCCUPANCY - TWO (2) PEOPLE

TOTAL WEIGHT LIMIT - 500 LB (300 lb Per Person Max)

TREE DIAMETER RANGE - 12" TO 20"

WARNING

- ⚠ This product carries strict height and weight restrictions. **Do Not** use this product if you exceed the total weight limit. Please note that the total weight limit includes the user(s) and their equipment.

WARNING

- ⚠ **When hunting from a treestand falls can occur any time after leaving the ground causing injury or death.**
- ⚠ **Always** wear a Fall Arrest System (FAS) comprising a full body harness at all times after leaving the ground. You must stay connected at all times after leaving the ground while using climbing and hang-on treestands. Single safety belts and chest harnesses are no longer allowed and shall never be used. If you are not wearing a full body harness properly attached to the tree that is protecting you from a fall, do not leave the ground.
- ⚠ **Read and understand** all of the manufacturer's Warnings and Instructions and use all safety devices provided by the manufacturer. Contact the manufacturer for any questions. Failure to do so could result in injury or death.
- ⚠ **Never** exceed the total weight limit of the treestand.
- ⚠ **Never** use a treestand during inclement weather such as rain, lightning, windstorms or icy conditions and end your hunt and return to the ground if inclement conditions arise.
- ⚠ **Never** use a treestand while using drugs (even prescription drugs) or alcohol.
- ⚠ **Never** use a treestand while feeling ill, nauseous or dizzy, or if you have a prior medical condition that could cause a problem, that is, heart condition, joints that lock-up, spinal fusions, etc., or if you are not well rested. **Never** sleep in stand.
- ⚠ **Never** use a treestand on a dead, leaning, diseased or loose barked tree, or a utility pole. **Always** avoid electrical power lines.
- ⚠ **Never** rely on a tree branch for support.

WARNING

- ⚠ **Never** jump or bounce on a treestand to seat it to the tree.
- ⚠ Pull up a bow, backpack, or firearm or other equipment only after being secure in the treestand and a firearm must be pulled up with it unloaded, chamber open, and muzzle down.
- ⚠ **Always** inform someone of the hunting location, where the treestand will be located and the expected duration of the hunt.
- ⚠ A signal device such as a mobile phone, radio, whistle, signal flare or personal locator device (PLD) must be on your person and readily available at all times.
- ⚠ Inspect the treestand and all safety devices each time before use and **Do Not** store a treestand outdoors when not in use.
- ⚠ **Never** modify your treestand in any way by making repairs, replacing parts, or altering it except if explicitly authorized in writing by the manufacturer.
- ⚠ Practice installing, adjusting and using your treestand at ground level prior to using it at elevated positions. Study your new stand to become familiar with all of its features and design. Doing so will confirm that the product is manufactured, assembled and installed correctly.
- ⚠ Instructions (written and video) shall be kept in a safe place and reviewed at least annually. It is the responsibility of the treestand owner to furnish the complete instructions to any person who borrows or purchases the treestand.
- ⚠ Use at least three (3) people to install or take down a ladder treestand.
- ⚠ The criss-cross straps/ropes and stabilization devices must be attached before climbing to the platform.
- ⚠ When installing a ladder stand, always bounce on the first rung to set the ladder into the ground according to manufacturer's instructions before proceeding to climb any higher.
- ⚠ Check every ladder section connection every time you use the stand before you leave the ground. If ladder sections are separating, do not use the stand.
- ⚠ Check the ground under the stand to make sure it is firm and level. Sloping ground or uneven surface (one side on a rock) can cause your ladder to tilt or shift off the tree as you climb.
- ⚠ **Always** maintain three (3) points of contact when climbing a ladder treestand. Proper three-point contact means having either two feet with one hand or one foot with two hands on the step portion of the ladder or climbing aid at all times.

⚠ WARNING

- ⚠ **Always** lean forward as you climb and attach your harness to the tree before securing the platform to the tree and stepping onto the platform.
- ⚠ **Never** exceed the stated maximum use height.
- ⚠ **Do Not** use this product until you have watched the online safety video, understand it, and practiced the techniques for safe hunting discussed in this video. Video can be found with the QR code and/or URL shown on front cover of this manual.
- ⚠ Read and perform all inspection and maintenance tasks before each and every use. Replace any questionable components immediately with RETI original replacement parts.
- ⚠ **Do Not** crush tubing when tightening bolt assemblies! Identify and familiarize yourself with all parts before you start. Bolt identification chart can be found on the following page of the manual.
- ⚠ Double check assembly steps to be certain you have correctly assembled this product.
- ⚠ **Never** use any product that has not been maintained or inspected properly - Your life depends on it!
- ⚠ Replace any and all treestand straps every two years or when any signs of damage or wear exist before.
- ⚠ **Always** wear the appropriate footwear when using a ladder treestand. A good non-slip safety boot is important to your personal safety. Be especially careful that boot laces do not get hooked on the stand or any of its components (tuck shoelaces into boots before climbing).

⚠ WARNING

- ⚠ **Only** use approved RETI parts. Failure to do so may result in serious injury or death!

INSPECTION AND MAINTENANCE

BEFORE EACH USE PERFORM THE FOLLOWING:

- Inspect all webbing, rope, cord, and strap assemblies for wear or damage.
- Inspect cables and/or cable ends for damage or kinking.
- Inspect all hardware and chain components for damage or wear.
- Inspect for any structural damage to product. (If any exists stop use immediately and call RETI Customer Service.)
- Inspect all nut and bolt assemblies to be certain none are loose.
- Inspect for any missing parts.
- Lubricate all pivot and slide together points with powder graphite, petroleum jelly or silicone spray to prevent noise, wear and rust.
- Inspect entire product for any rust, corrosion, cracks, freezing, excessive heat or rotting damage that may effect the safety of your product. Discard any questionable product.
- Inspect entire product for any structural damage - pay close attention to all weld locations. (Discard product if any damage is found.)
- Using correct wrenches inspect all nut & bolt assembly locations and snug up any that may be loose. Be careful not to crush tubing when tightening!
- Inspect and check operation of all cables, cable ends, cord, rope, webbing, and strap or chain assemblies. Replace with RETI original replacement parts any item or assembly that shows signs of wear, damage, kinking, or functions incorrectly.
- Inspect seat for damage or wear. Replace any seat with factory new that shows signs of structural damage or wear.
- Never modify your stand in any way by making repairs, replacing parts, or altering by adding or attaching anything to it except if explicitly authorized in writing by the manufacturer.

HARDWARE IDENTIFICATION CHART

Bolts shown are for size reference.
Extra hardware may be included in the parts bag.

Quick Tip: Cut page out to use as a reference tool while following assembly instructions

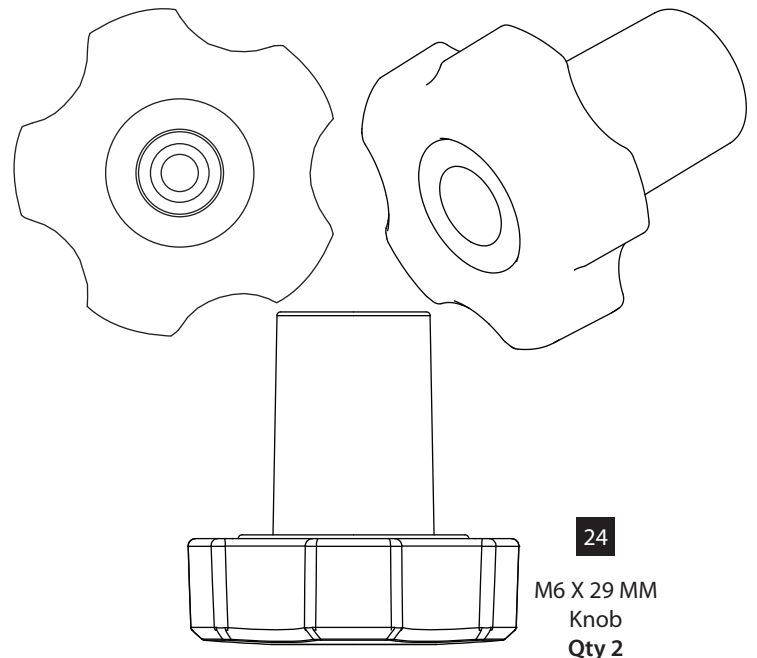
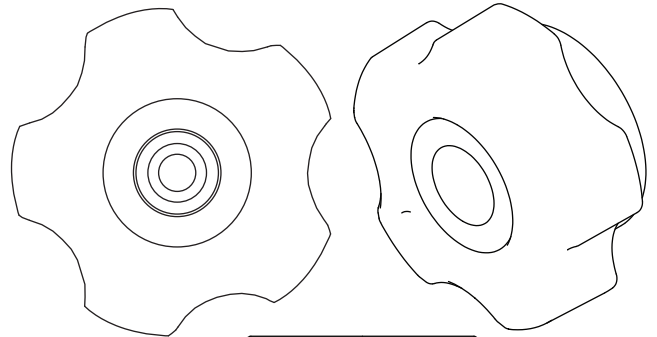
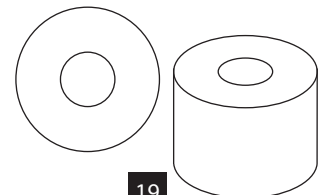
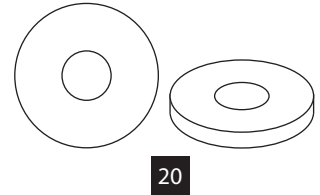
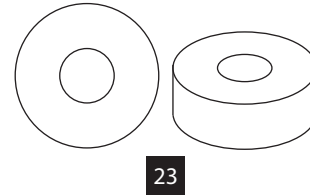
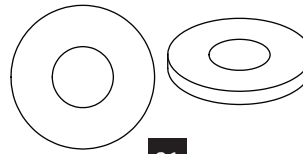
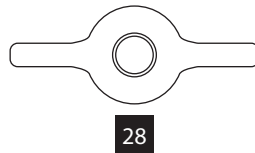
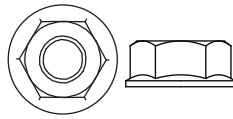
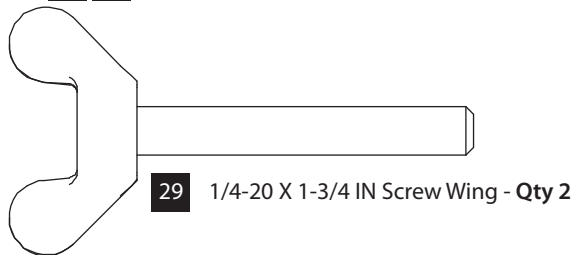
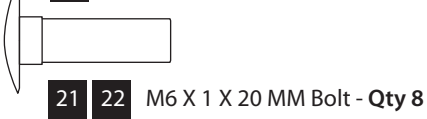
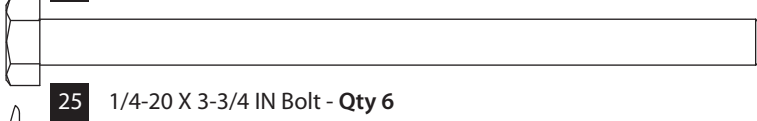
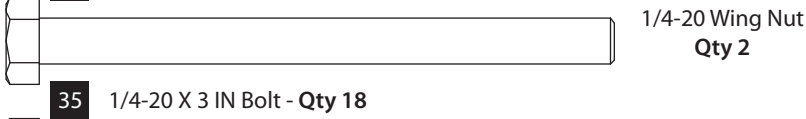
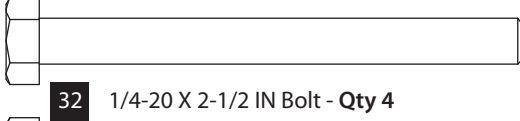
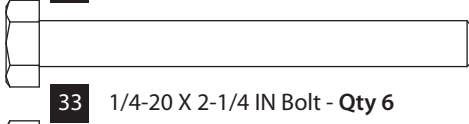
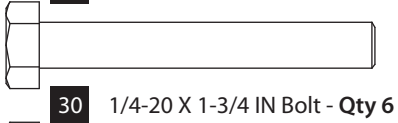
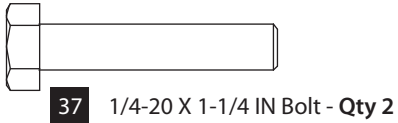

TOOLS FOR ASSEMBLY (NOT TO SCALE)

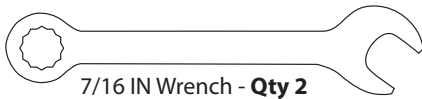

ASSEMBLY INSTRUCTIONS

IMPORTANT ASSEMBLY TIP:

Do not tighten any nut and bolt combinations completely until all parts are assembled together! Finger tighten plus one turn of a wrench only! This will temporarily hold the lock-nut on the bolt while helping alignment of all parts! After all parts are assembled together, all nut and bolt combinations must be completely tightened.

All assembly must be done in this order at ground level before uprighting.

Do not remove labels/warnings from product, they are there for your safety.

Recommended for adult use only.

FIGURE 1

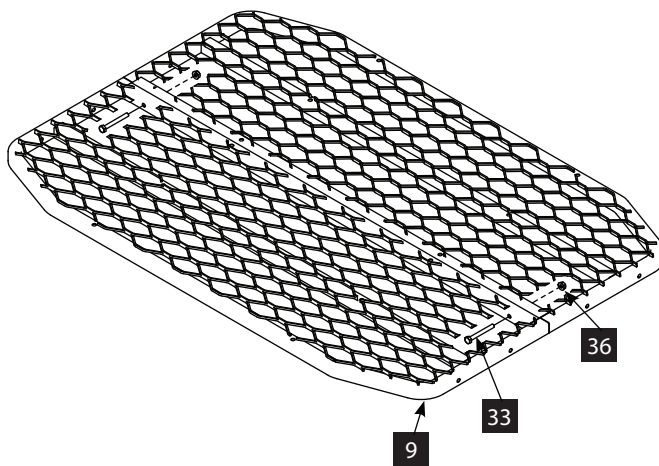

NOTE: When selecting a tree to install the treestand in, never use a treestand on a dead leaning, diseased or loose barked tree, or a utility pole. Always avoid electrical power lines.

1. Join the two platform halves (9) using two 1/4 -20 X 2-1/4 IN bolts (33) and two 1/4-20 nuts (36) by aligning the holes in the edges of the platform, using the fasteners as shown in **FIGURE 1**.

2. With the platform (26) assembled, attach the j-tubes (5) and lower tree blade (18) with fourteen 1/4 -20 X 3 IN bolts (35) and fourteen 1/4-20 nuts (36). **SEE FIGURE 2.**

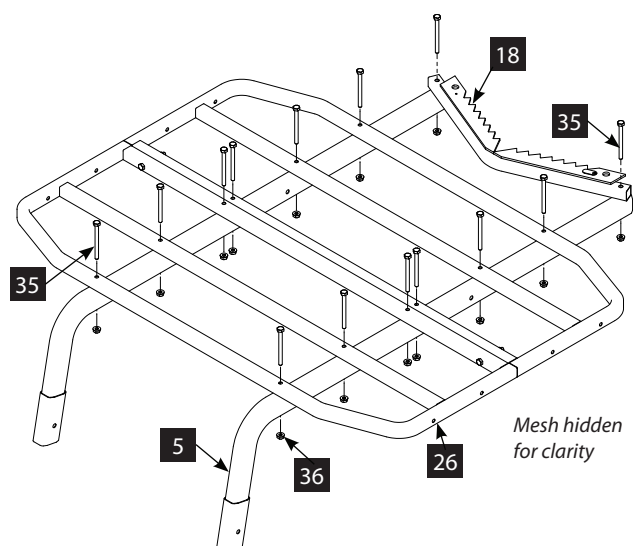
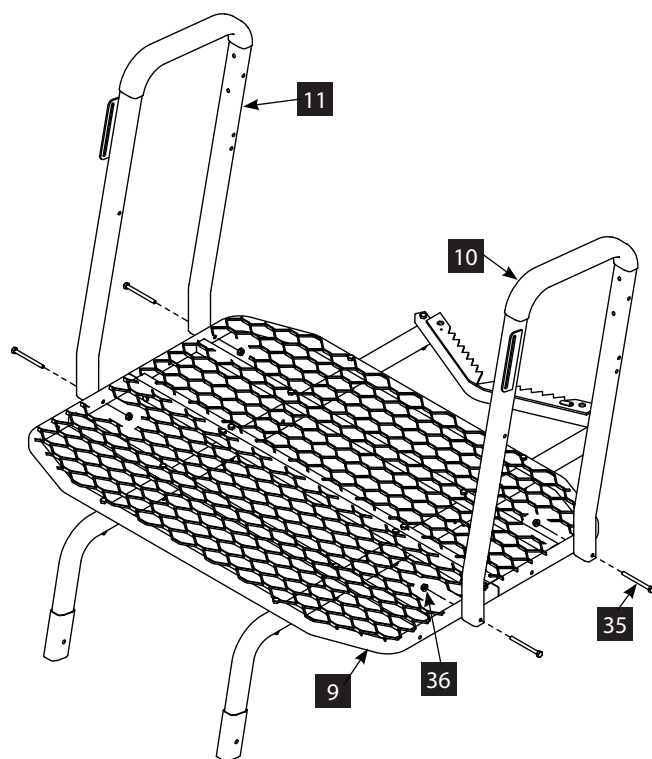

FIGURE 2

FIGURE 3



3. Continuing the assembly, attach the left armrest (10) and right armrest (11) to the outer edge of the platform (9), using two 1/4 -20 X 3 IN bolts (35) and two 1/4-20 nuts (11) per armrest. **SEE FIGURE 3** to be sure the armrest orientation is correct.

4. Next assemble the seat support (13) to the armrests (10 & 11) as shown in **FIGURE 4**. The order of the hardware: 1/4 -20 X 3-3/4 IN bolts (25), yellow plastic washers (20), plastic spacers (19) and 1/4-20 nuts (36) is imperative for proper assembly and function, **SEE FIGURE 4A**.

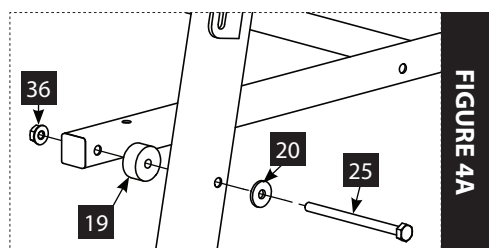

FIGURE 4A

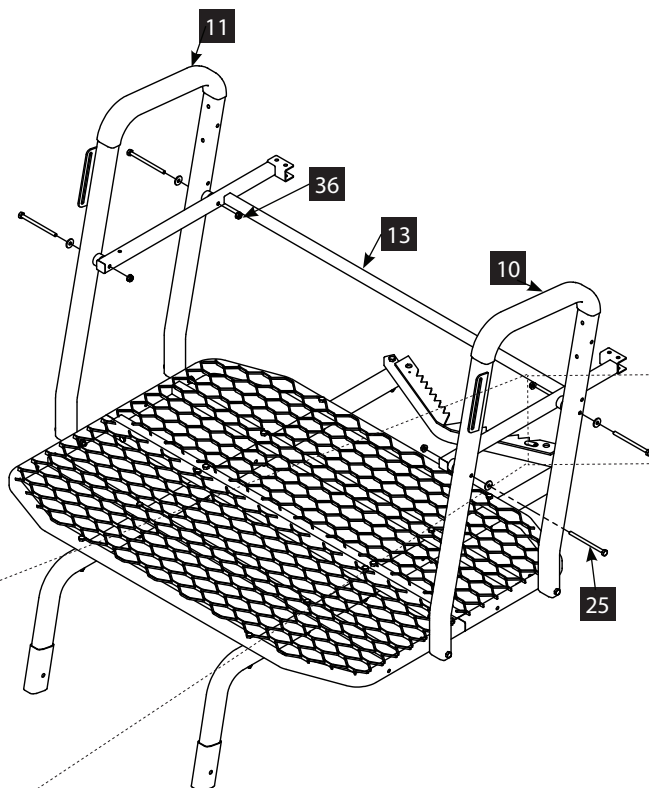
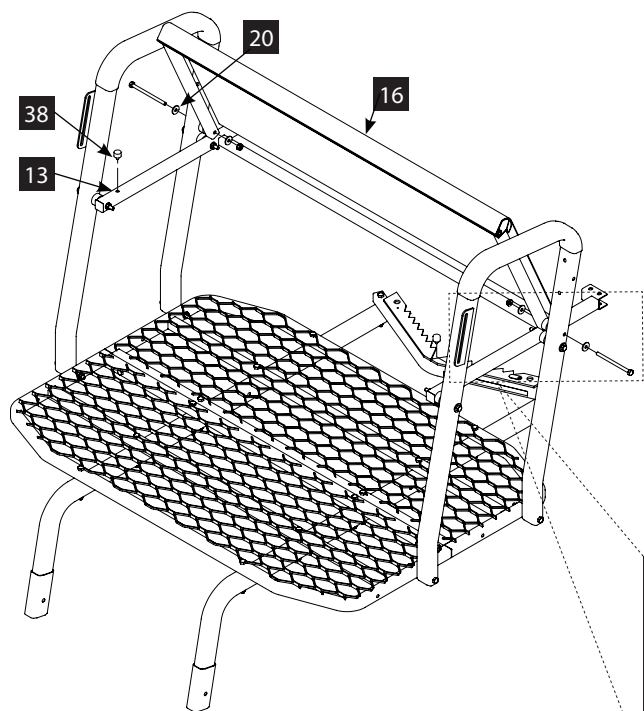

FIGURE 4

FIGURE 5



5. Once the seat support (13) is properly assembled, take the seat assembly (16), using the hardware: 1/4 -20 X 3-3/4 IN bolts (25), yellow plastic washers (20), plastic spacers (19) and 1/4-20 nuts (36) assemble as shown in **FIGURES 5 AND 5A**. The hardware order in this step is imperative for proper assembly and function. Press the two rubber bumper stops (38) into the top-side holes of the seat support frame (13). **SEE FIGURE 5.**

FIGURE 5A

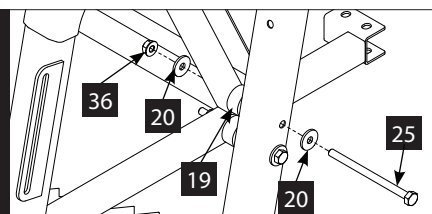

6. Now with seat assembly secured, take the backrest support (15) and feed it through sleeve in seat as shown in **FIGURE 6**. After back support (15) has been fed through seat assembly (16), attach to rear of armrests (10 & 11) with four 1/4-20 X 2-1/2 IN bolts (32) and 1/4-20 nuts (36) as shown in **FIGURE 6**. This will require the seat bottom to be flipped up to relieve tension on seat assembly.

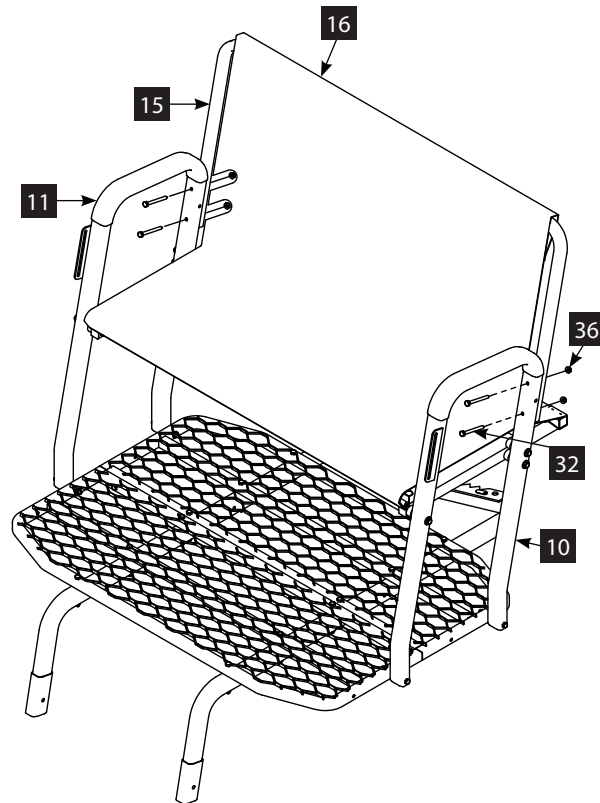
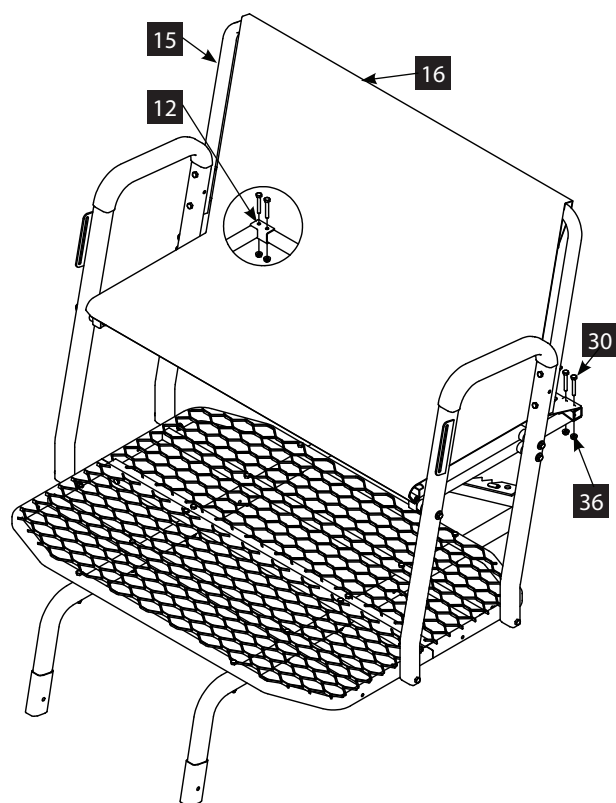

FIGURE 6

FIGURE 7



7. Once the backrest support (15) has been secured, take top tree blade (12) and slide through remaining sleeve on seat assembly (16), using four of the 1-3/4 IN bolts (30) and four 1/4-20 nuts (36) assemble top tree blade (12) to stand as shown in **FIGURE 7**.

8. Assemble the adjustable shooting rail knobs (24) and bolts (22) to the armrests (10 & 11) in the slots provided. **SEE FIGURE 8.**
9. To assemble the shooting rest, connect the shooting rail (14) over the ends of both the shooting rail braces (4) and secure using two 1/4-20 x 1-1/4 IN bolts (37) and two 1/4-20 nuts (36). **SEE FIGURE 8.**

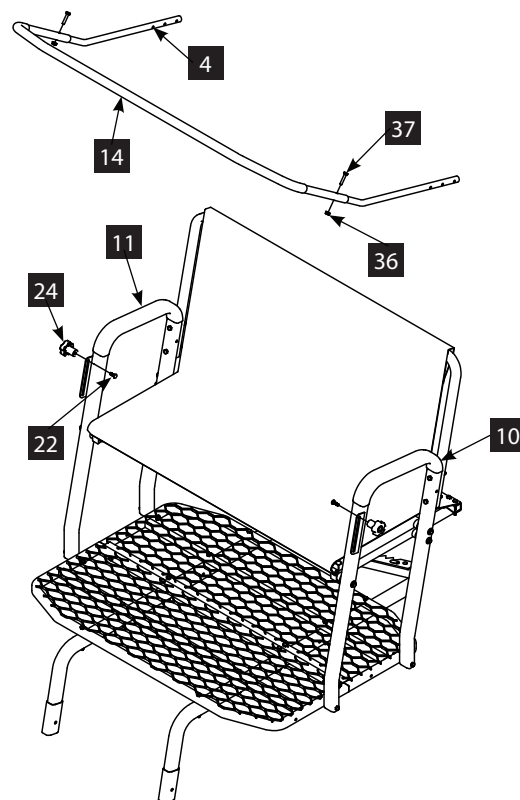
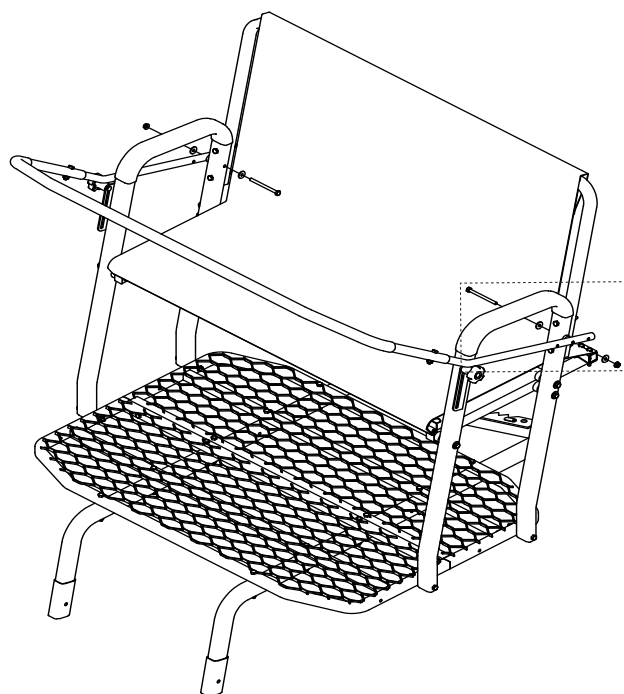

FIGURE 8

FIGURE 9



10. The shooting rail assembly connects to the armrest as shown in **FIGURE 9**. Use the following hardware: two 1/4-20 X 3-1/4 IN bolts, four yellow plastic washers (20), two yellow spacers (23) and two 1/4-20 nuts (36).

NOTE: The shooting rail is designed to have multiple configurations. Adjustments can be made to the height by loosening the knob in the slotted-plate on the armrests, and moving it either upwards or downward until desired height is achieved. Once location has been reached re-tighten the knob to create a firm seat for the shooting rail to rest on. To move the shooting rail closer to you or further away, use the three holes drilled into the end of the shooting rail to place it in the desired location.

FIGURE 9A

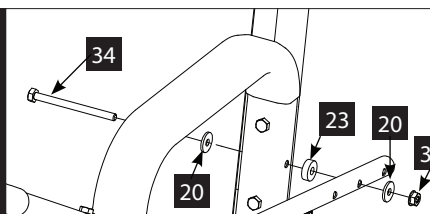

11. Take top ladder section (6) and attach to j-tubes (5) with two 1/4-20 X 1-3/4 IN bolts (30) and two 1/4-20 nuts (36) as shown in **FIGURE 10**.
12. After top ladder section (6) has been assembled and secured, take platform braces (3) and attach to outer edge of j tubes (5) with two 1/4-20 X 2-1/4 IN bolts (33), two yellow plastic washers (20) and two 1/4-20 nuts (36). **SEE FIGURE 10.**
13. Take other end of platform braces (3) and attach to outer edge of top ladder section (6) with two 1/4-20 X 2-1/4 IN bolts (33), two yellow plastic washers (20) and two 1/4-20 nuts (36). **SEE FIGURE 10.**

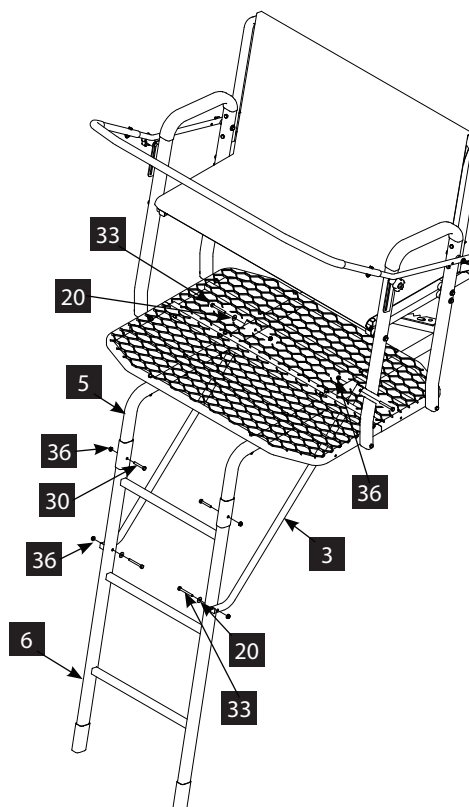
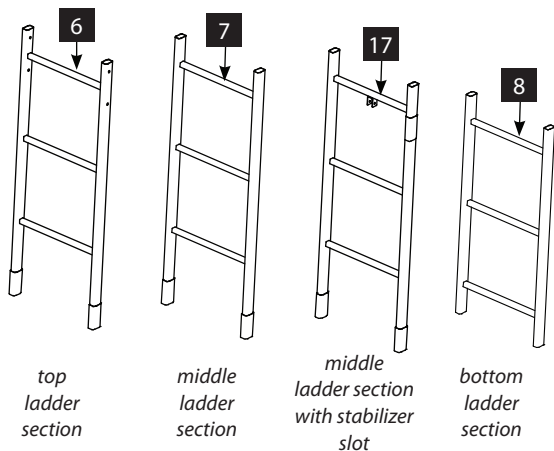
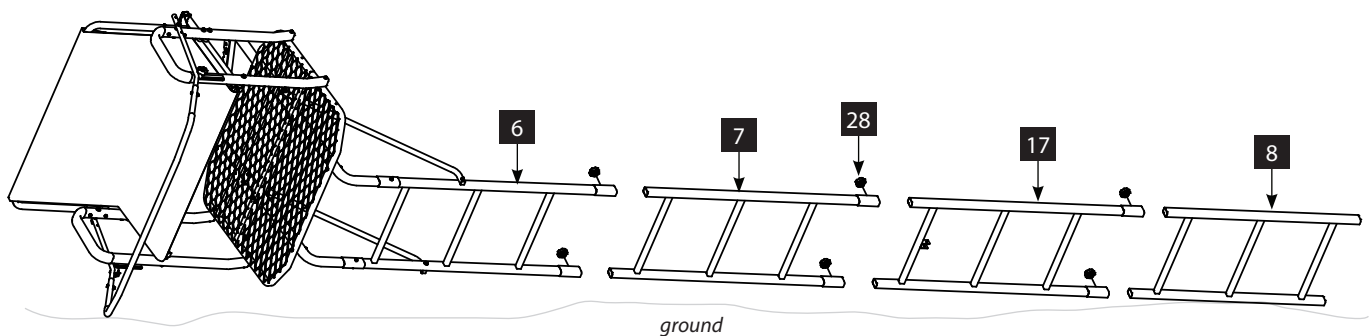

FIGURE 10

FIGURE 11A



14. Ladder sections are assembled on the ground in the following order: bottom ladder section (8), middle ladder section with stabilizer slot (17), middle ladder section (7), and the top ladder section (6) with the treestand top assembly. Connect all sections together using the six silent knob assemblies (21). **SEE FIGURES 11 AND 11A.**



15. Slide the stabilizer bar (1) into the stabilizer support tube (2) and secure using a 1/4-20 x 1-3/4 IN wing screw (29) and a wing nut (28). Make sure the screw passes through the support tube and the stabilizer bar at the appropriate hole to achieve the desired distance from the tree. Adjustment in length may be needed when ladder is uprighted later in the Setup and Use Instructions. **SEE FIGURE 12.**
16. Connect the stabilizer bar assembly (1) through the middle ladder section with stabilizer slot (17). These components will be connected using a 1/4-20 x 1-3/4 IN wing screw (29) and one wing nut (28). **SEE FIGURE 12.**

NOTE: Treestand should **ALWAYS** be fully assembled on the ground prior to mounting it in the tree.

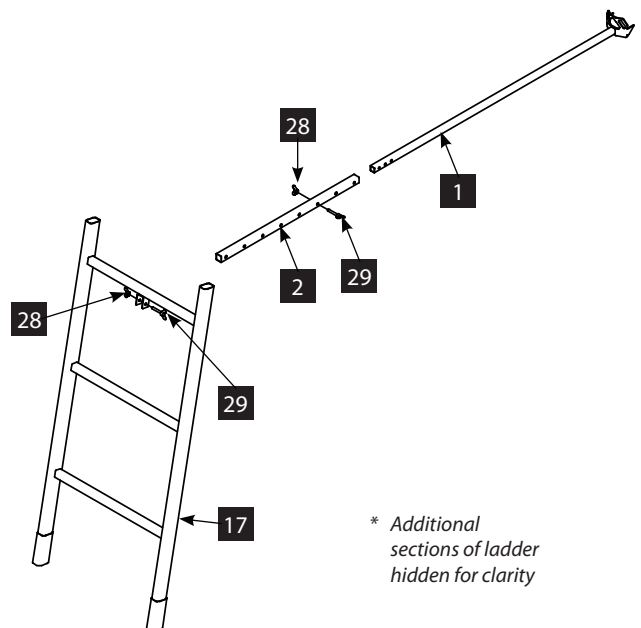
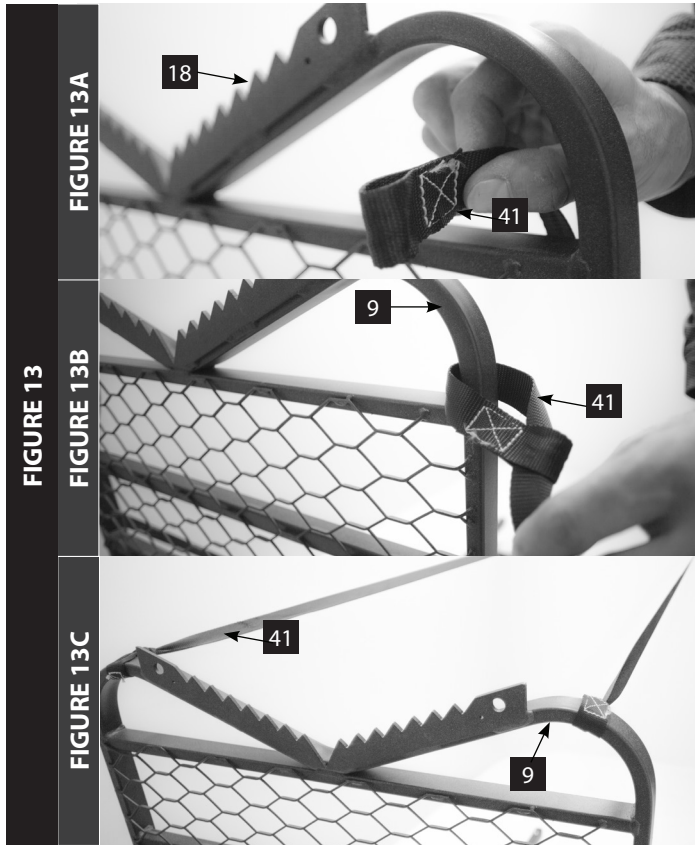

FIGURE 12



LONG CRISS-CROSS RATCHET STRAPS (41)

17. Attach the two long straps of the criss-cross ratchet straps (41) to the rear of the foot platform (9) near the lower tree blade.

a. Wrap sewn loop of each strap around each side of the platform and feed the loose end through the sewn loop. **SEE FIGURES 13A AND 13B.**

b. Pull tight, forming a cinch knot. This permanently attaches the long straps to the platform. **SEE FIGURES 13B AND 13C.**

NOTE: The ratchet portion of the long straps will be used later during Setup and Use Instructions.

STABILIZER BAR RATCHET STRAP (42)

18. Attach the straps of the stabilizer bar ratchet assembly (42) to the stabilizer bar bark biting plate, which is part of the stabilizer bar (1).

a. Feed the sewn loop of the long strap through either side slot in the bark biting plate and then feed the loose end through the sewn loop. **SEE FIGURES 14A AND 14B.**

b. Pull tight, forming a cinch knot. This permanently attaches the long strap to the stabilizer bar. **SEE FIGURES 14B AND 14C.**

c. Feed the sewn loop of the ratchet buckle strap through the opposite side slot in the bark biting plate and then feed the ratchet buckle through the sewn loop.

d. Pull tight, forming a cinch knot. This permanently attaches the ratchet buckle strap to the stabilizer bar. **SEE FIGURE 14C.**

LARGE RATCHET STRAPS (40)

The large ratchet straps (40) that secure the platform and tree blades to the tree will be used later during the Setup and Use Instructions, after uprighting the stand.

NOTE: Make sure to bring ratchet straps up with you in a pocket. Never carry in your hands!

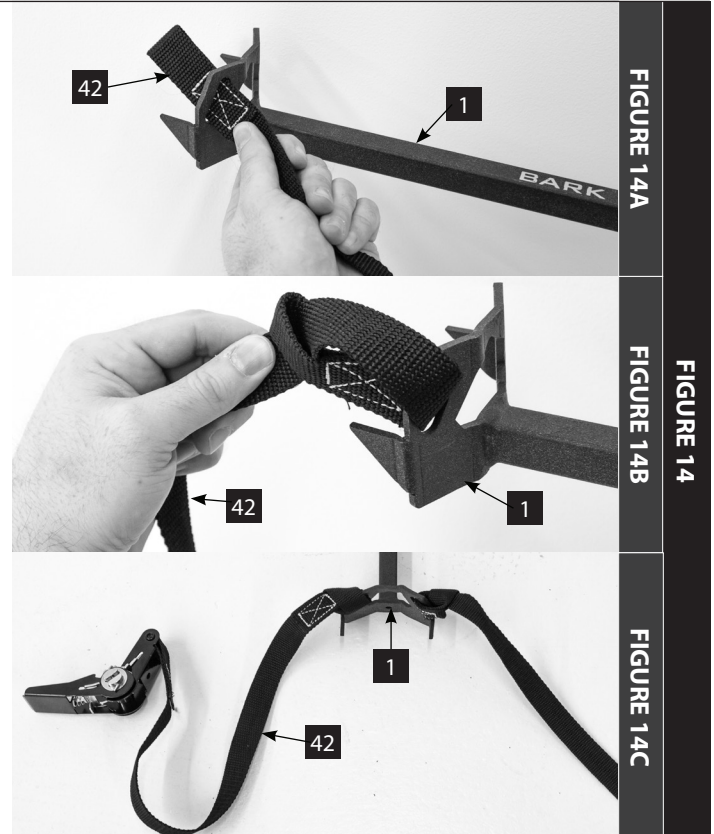

STOP

READ AND UNDERSTAND THE FOLLOWING WARNINGS BEFORE SETUP AND USE

WARNING

- ▲ Double check assembly steps to be certain you have correctly assembled this product.
- ▲ Study your new stand to become familiar with all of its features and design. At ground level, following provided use instructions, practice attaching stand to tree and removing stand from tree. Practice sitting, standing, and using this product before attaching overhead. Save these instructions for future reference. You must always use the provided Fall Arrest System (FAS) while using this product.
- ▲ **Always** use at least three (3) people to install or take down a ladder treestand. **Always** have two people stabilize the ladder before climbing to the platform the first time after every set-up.
- ▲ Be absolutely sure the tree blade(s) on stand and the stabilizer bar are contacting tree before climbing ladder.
- ▲ Stabilizer bar must always be correctly and securely attached to ladder and tree before climbing ladder.
- ▲ Make sure ladder bottom is firmly seated on dry, level ground. Attach your harness tether to the tree before securing the platform to the tree and stepping onto platform. Refer to the Full Body Harness instructions.
- ▲ **Never** ascend or descend ladder without criss-cross straps/ropes securely holding ladder to tree and stabilizer bar securely attached. Failure to correctly perform these steps can cause the ladder to collapse/buckle-over backwards during the initial ascent to attach ratchet strap resulting in serious injury or death.
- ▲ **Always** lean forward as you climb and attach your harness to the tree before securing the platform to the tree and stepping onto the platform.

WARNING

- ▲ **Always** maintain three (3) points of contact when climbing a ladder treestand. Proper three-point contact means having either two feet with one hand or one foot with two hands on the step portion of the ladder or climbing aid at all times.
- ▲ **Always** wear the appropriate footwear when using a ladder treestand. A good non-slip safety boot is important to your personal safety. Be especially careful that boot laces do not get hooked on the stand or any of its components (tuck shoelaces into boots before climbing).
- ▲ **Never** stand on seat, it is designed for sitting only.
- ▲ **Do Not** allow excessive strap buildup in ratchet as this will prevent the ratchet teeth from engaging causing slippage.
- ▲ **Always** attach ratchet straps securely while using this product!
- ▲ If seat is removable, be certain it is securely attached when in use.
- ▲ Some models include a shooting rail. **Never** lean against, lean over, or sit on shooting rail. It is designed as a shooting rest only. **Always** be aware that the shooting rail can swing to one side or pivot up and down.
- ▲ Some models include a footrest, which is designed as a footrest only. **Never** stand on footrest! **Always** be fully aware of foot placement.
- ▲ Some models include a multi-piece stabilizer bar system. Be sure attachment hardware goes through both the extension tube and the stabilizer bar.

WARNING

- ▲ Bring ratchet strap(s) up with you in a pocket - **Do Not** carry in your hands!
- ▲ Be sure only one person ascends or descends ladder at a time. Be certain first person is seated safely, and attached to tree with provided Fall Arrest System (FAS) correctly before second person ascends or descends ladder.
- ▲ **Never** have two people on one side of the platform. Keep weight evenly distributed on platform.
- ▲ **Always** be aware of the other person's position. Use extreme caution when weapons are used to prevent personal injury.

SET UP AND USE INSTRUCTIONS

During installation and removal of ladder treestands, you must always and properly use the included Full Body Harness (Fall Arrest System). Refer to the Full Body Harness instructions included with this product for proper use.

1. Select a straight, healthy tree. Do Not attempt to install on a tree that is not healthy.
2. Place the assembled product lying on the ground in front of the tree with the bottom ladder section approximately five feet away from the base of tree.
3. Position one person at bottom end of ladder. This person has to prevent the ladder end from tilting up and from skidding across the ground when platform end is lifted.
4. Position two people at the platform end of the ladder, lift the platform end and continue uprighting by walking toward bottom end of ladder while moving hands along ladder legs. **Stand ladder up against chosen tree on dry, level ground.** Use caution when ladder comes over center against the tree. **SEE FIGURE 15 (A).**
5. Once elevated completely, carefully slide the base so that the sitting and standing platforms are parallel to the ground. **SEE FIGURE 15 (B).**
6. Step back and look at the ladder top to see that both the lower platform tree blade and upper tree blade are contacting the tree. Adjust as needed so both of the tree blades are contacting tree.
7. Step down hard on bottom step to push ladder legs into the ground. **SEE FIGURE 15 (C).**
8. Adjust length of stabilizer bar assembly so the bark biting teeth of the stabilizer bar contact the tree. Stabilizer bar should be parallel to the ground. Do Not bow ladder in or out to achieve contact with the tree. Maintain tree blade contact.
9. With the stabilizer bar ratchet strap (42) now in hand, wrap the strap around the tree and feed the long strap through the center slot of ratcheting mechanism. Pull tail of long strap until most of the slack is taken out and ratchet tight so the teeth of the stabilizer bar dig into the tree. **SEE FIGURES 16A, 16B, 16C AND 17.**

NOTE: Be sure to feed the long strap correctly so there are no twists in the strap.

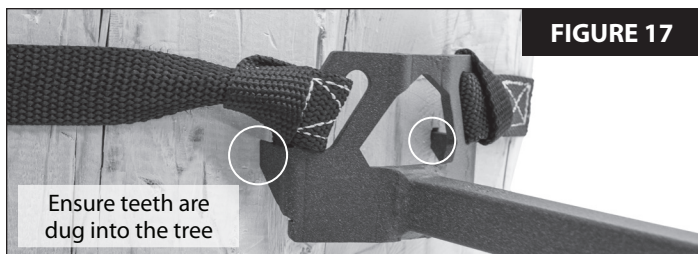

! WARNING

- ⚠ **Never** use a treestand on a dead, leaning, diseased or loose barked tree, or a utility pole. **Always** avoid electrical power lines.
- ⚠ Bring ratchet strap(s) up with you in a pocket - **Do Not** carry in your hands!

FIGURE 15

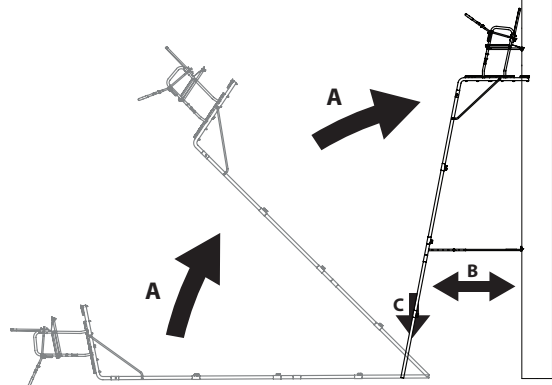

FIGURE 16A

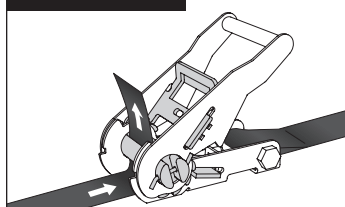

FIGURE 16B

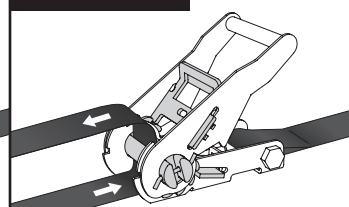

FIGURE 16C

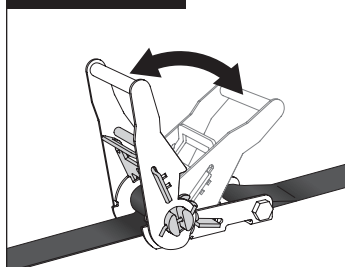
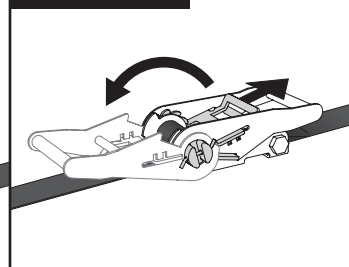

FIGURE 16D



10. Locate the two ratchet portions with S-hooks for the criss-cross straps (41).

- a. With one ratchet portion of the criss-cross strap (41) now in hand, feed one long strap hanging down from platform through the center slot of ratcheting mechanism and back around through tightening lever. **SEE FIGURES 16A AND 16B.**
- b. While maintaining contact between long criss-cross strap and the tree surface, wrap entire ratchet strap assembly around back side of tree and hook S-hook to the middle opening of stabilizer bar bark biting plate. **SEE FIGURE 18A.**
- c. Pull the tail of the long strap until most of the slack is taken out. Be sure entire strap is evenly wrapped around tree and ratchet tight to tree. This will securely attach the first of two long ratchet straps to tree. **SEE FIGURES 16B AND 16C.**
- d. Repeat for attachment of the second criss-cross strap. **SEE FIGURES 18B AND 19.**

NOTE: It is extremely critical that the criss-cross ratchet straps are attached to the stabilizer bar bark biting plate in opposite directions of each other forming a "criss-cross" behind the tree. This ground level ladder-to-tree attachment will prevent the ladder from pulling away from the tree while ascending to the top for final ratchet strap attachment. The same holds true when ladder removal is necessary. SEE FIGURE 19.

LARGE RATCHET STRAPS (40)

11. With two people securely holding the base of the ladder, use the three point contact climbing method to slowly climb the ladder and carefully keep a constant hand grip on the ladder at all times. Always lean forward, towards the tree, to keep tree blades against the tree. **Be certain ladder bottom is firmly seated on dry, level ground. Attach your harness tether to the tree before securing the platform to the tree and stepping onto platform. Refer to the Full Body Harness instructions included with this product.**

NOTE: Bring large ratchet straps up with you in a pocket. DO NOT carry in your hands!

12. Once platform is reached, hook S-hook with long strap through hole provided in upper tree blade frame. Feed the long strap through the center slot of ratcheting mechanism and back around through tightening lever. **SEE FIGURES 16A, 16B AND 20.**
 13. Wrap the ratchet assembly around the tree and hook other S-hook through opposite tree blade hole. Pull tail of long strap until most of the slack is taken out. Be sure entire strap is even and at the same level all around tree. "Ratchet" tight to tree. This will securely attach only the seat portion to the tree and prevent movement. **SEE FIGURES 16C AND 20.**
- NOTE: To release ratchet, simply pull the release lever and open tightening lever wide open (flat). SEE FIGURE 16D.**
14. Repeat previous two steps for the platform tree blade attachment. Place S-hook through holes provided on bottom tree blade.
 15. You are now ready to use your ladder stand!



FIGURE 18A

FIGURE 18B

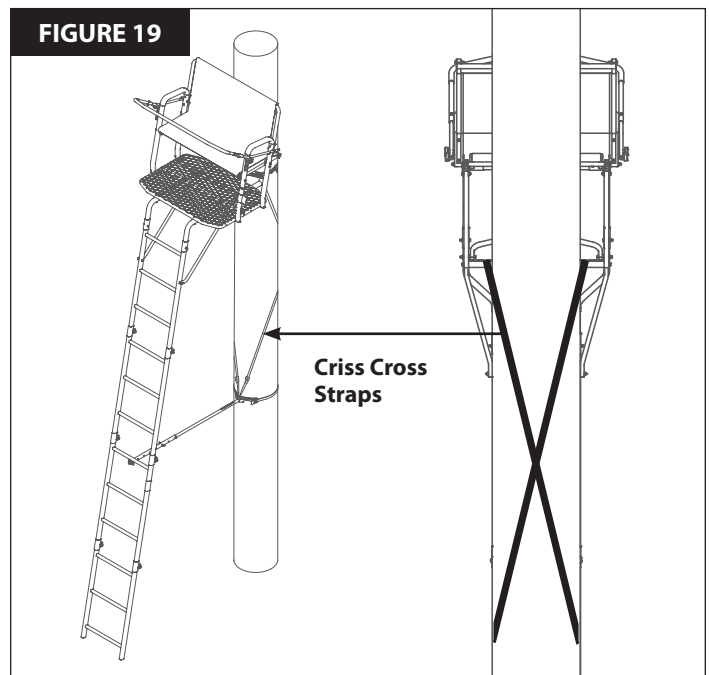

FIGURE 19

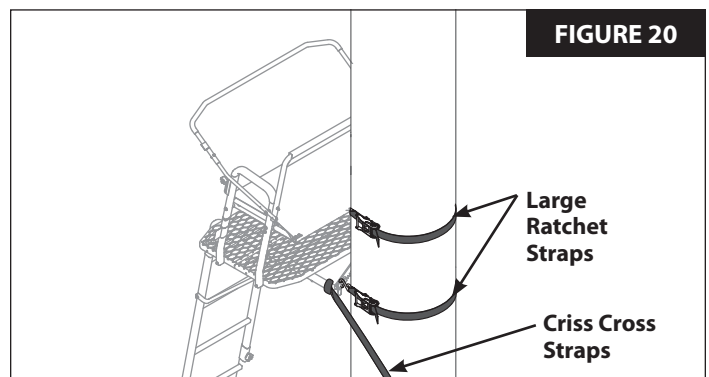

FIGURE 20



IMPORTANT

- ⚠ Reverse the Set-Up and Use Instructions to take the ladder stand down.

FINISHED LADDER

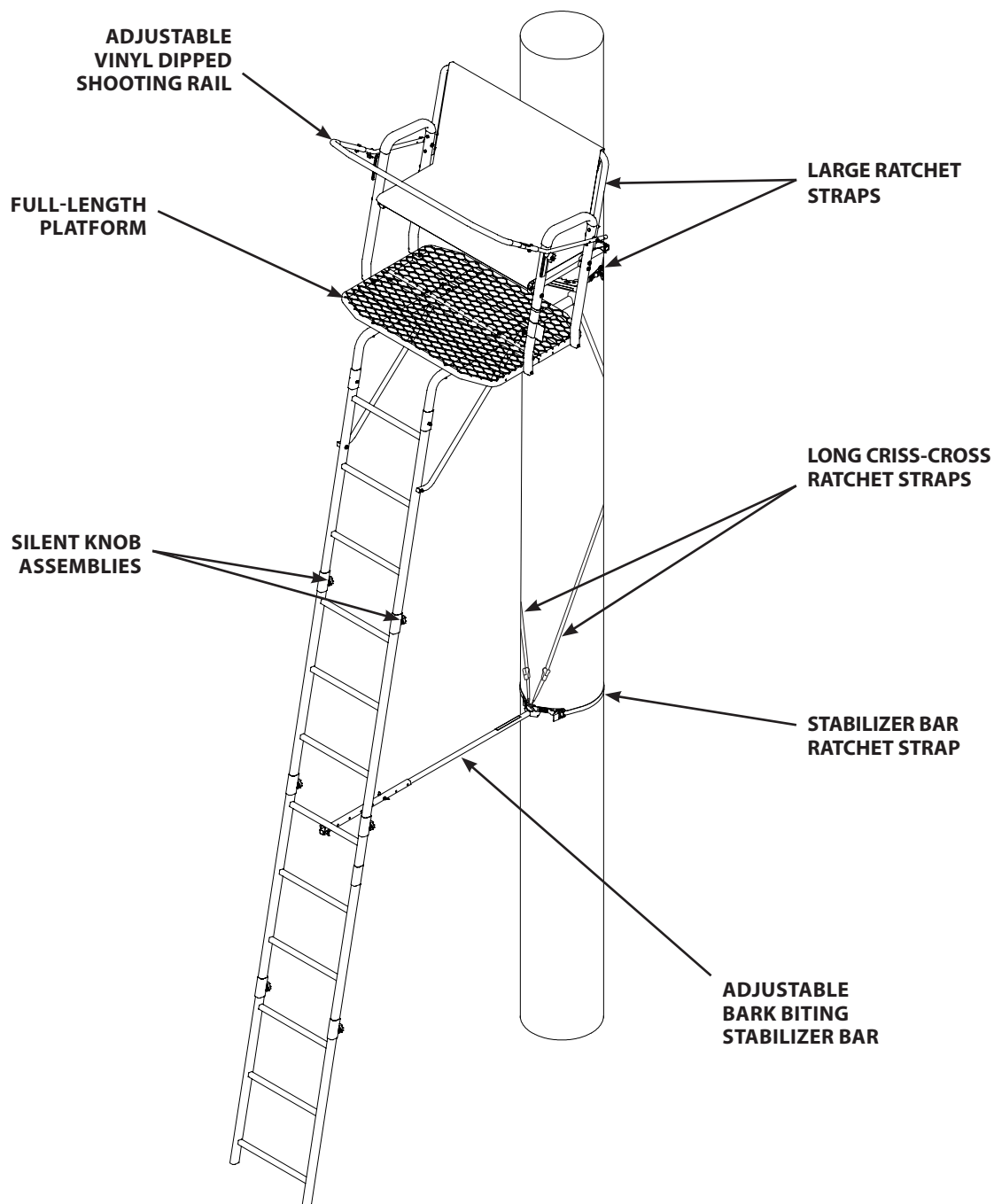

ILLUSTRATED PARTS BREAKDOWN

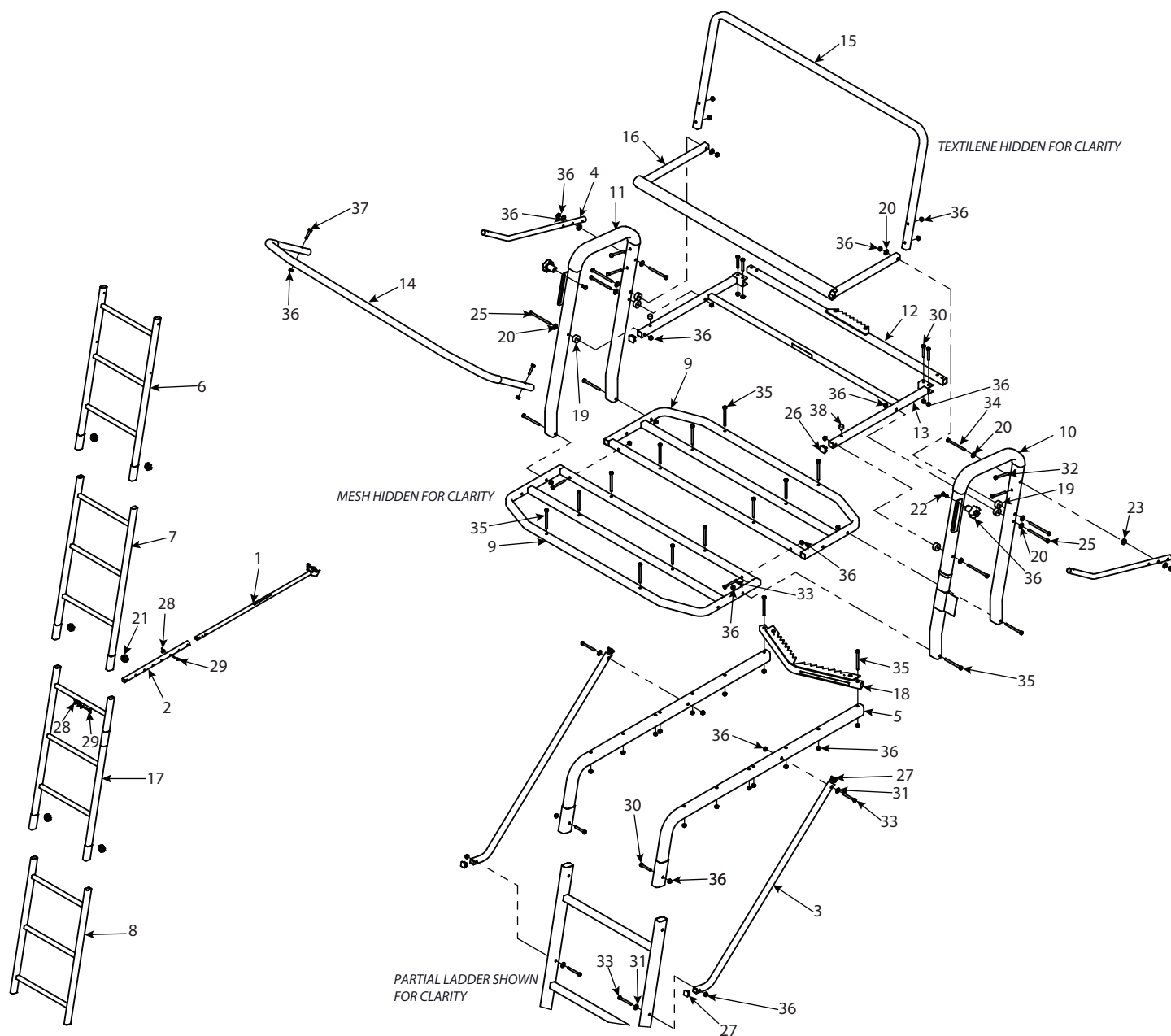

PARTS LIST

ITEM #	PART #	DESCRIPTION	QTY.
1	23600	STABILIZER BAR 27 IN	1
2	1ML23	STABILIZER EXTENSION BAR	1
3	26375	PLATFORM BRACE	2
4	30307	SHOOTING RAIL BRACE	2
5	29529	J TUBES	2
6	29531	TOP LADDER SECTION	1
7	29539	MIDDLE LADDER SECTION	1
8	29542	BOTTOM LADDER SECTION	1
9	29544	FOOT PLATFORM	2
10	29551	ARMREST LEFT	1
11	29555	ARMREST RIGHT	1
12	29556	TOP TREE BLADE	1
13	29559	SEAT SUPPORT	1
14	29563	SHOOTING RAIL	1
15	29566	BACKREST	1
16	29685	TEARTUFF 2-MAN SEAT	1
17	29695	MIDDLE LADDER SECTION WITH STABILIZER SLOT	1
18	2ML130	BOTTOM TREE BLADE	1
19	10347	SPACER 12 MM TK	6
20	23572	YELLOW WASHER M6	12
21	23603	KNOB SILENT LADDER	6
22	26813	BOLT M6 X 1 X 20 MM	2
23	26913	YELLOW SPACER M6	2
24	28839	KNOB M6 X 29 MM	2
25	29676	BOLT 1/4-20 X 3-3/4 IN	6
26	29712	PLUG SQ END 22 MM	2
27	29714	PLUG SQ END 18 MM	4
28	48042B	WING NUT 1/4-20	2
29	48044B	SCREW WING 1/4-20 X 1-3/4 IN	2

ITEM #	PART #	DESCRIPTION	QTY.
30	48250B	BOLT 1/4-20 X 1-3/4 IN	6
31	48261B	WASHER 1/4 IN	4
32	48270B	BOLT 1/4-20 X 2-1/2 IN	4
33	48271B	BOLT 1/4-20 X 2-1/4 IN	6
34	48273B	BOLT 1/4-20 X 3-1/4 IN	2
35	48280B	BOLT 1/4-20 X 3 IN	18
36	48752B	NUT 1/4-20	44
37	8909B	BOLT 1/4-20 X 1-1/4 IN	2
38	48679	RUBBER BUMPER STOP	2
ITEMS BELOW ARE NOT SHOWN			
39	10531	SAFETY HARNESS / FALL ARREST SYSTEM	2
40	23610	STRAP 1-1/2 IN W/ RATCHET & S HOOKS	2
41	15034	STRAP RATCHET CRISS CROSS	2
42	11058	STRAP RATCHET STABILIZER BAR	1
43	29507	HARDWARE BAG - BOLTS	1
44	29741	HARDWARE BAG - NUTS AND WASHERS	1

**NO EXTENSIONS AVAILABLE FOR THIS MODEL.
NEVER MODIFY OR EXCEED ORIGINAL STATED USE HEIGHT!**

LOCKDOWN™

LADDER STANDS

by



WE ARE HUNTERS

Rivers Edge® Treestands, Inc.

1160 Eighth Avenue, PO Box 755
Cumberland, WI 54829

Phone: 800-450-EDGE (3343)

Fax: 715-822-2124

www.HuntRiversEdge.com

*All weights, specifications and features are approximate and are subject to change without notice. Due to continuous product improvements, product images may not be exact. Warning labels in some product images may have been removed for photography purposes only. Props shown in photos not included. Some assembly may be required.