

# Big Foot™

LEVER-ACTION HANG-ONS

## Operator's Manual Hang-On Stands

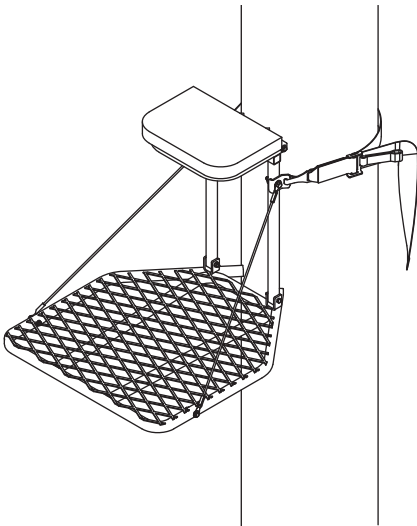

**BIG FOOT™  
Model RE550**

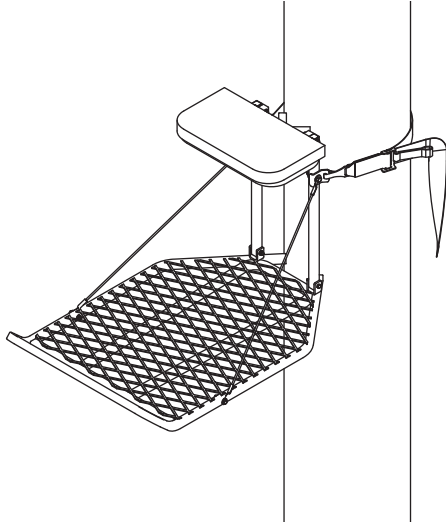

**CLASSIC BIG FOOT™ XL with Footrest  
Model RE514**

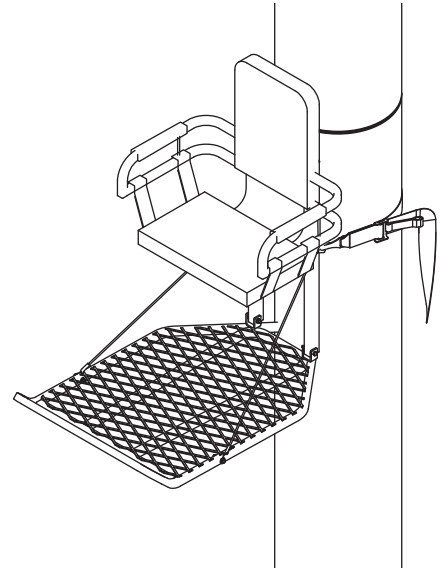

**BIG FOOT™ XL LOUNGER  
Model RE552**

### **INCLUDES MODEL #'s:**

RE550, Big Foot™  
RE514, Classic Big Foot™ XL with Footrest  
RE513, Big Foot™ Traveler  
RE552, Big Foot™ XL Lounger



Certified to TMA  
Standards by an  
Independent  
Testing Laboratory

**Wear Your  
Harness!**



Get parts online at  
[www.HuntRiversEdge.com](http://www.HuntRiversEdge.com)



P/N: 18051  
REV2: 03/08/14  
© 2014 RETI  
All Rights Reserved.

## INTRODUCTION

Rivers Edge® Treestands are engineered with you the hunter in mind. We appreciate your purchase of one of our world class treestands. Follow these few simple instructions and your stand will provide you many years of trouble-free pleasure. Instructions should be kept in a safe place and reviewed at least annually.

If for any reason you have a problem with your product, **DO NOT return to the retailer**, contact the Rivers Edge® customer service department at 800-450-EDGE (3343) for assistance.

## CONTENTS

Introduction/Warranty .....	2
Warnings.....	3-4
Inspection and Maintenance .....	5
Assembly Instructions (RE550, RE513, RE514) .....	6
Assembly Instructions (RE552) .....	7
Set Up and Use Instructions .....	8
Threading the Float Buckle.....	9
Parts Explosion/Parts List (RE550, RE513, RE514) .....	10-11
Parts Explosion/Parts List (RE552) .....	12
Bolt Identification Chart.....	13

## WARRANTY

Rivers Edge Tree Stands, Inc. ("RETI") offers a one year warranty for all components of the treestand. These warranties apply to the original owner with a proof of purchase. These warranties begin on the date of purchase by the first retail consumer and continue for the period specified above. These warranties apply to products that are not modified, abused or used in a manner that deviates from the product's intended usage. Minor fading in color is normal and is not covered by warranty. Any corrosion of painted surfaces that occurs as a result of paint being removed or damaged is also not covered by warranty. RETI offers no other warranty expressed or implied. Products for which warranty work has been approved must be sent directly to RETI and performed by RETI. **To obtain warranty service and/or replacement instructions, you must obtain prior approval from Rivers Edge® Treestands before shipping your package to us by calling our customer service department at 800-450-EDGE (3343) or by writing to: Rivers Edge Tree Stands, Inc., P.O. Box 755, 1160 Eighth Avenue, Cumberland, WI 54829 for a return material authorization number (RMA#).** All items must be shipped prepaid. RETI will, at no charge, repair or replace, in RETI's sole discretion, any product that satisfies the conditions stated above. RETI retains the right to change models, specifications and price without notice.

This equipment has been manufactured under strict quality and safety guidelines. As with any equipment of this type, full understanding of the instructions and its use is mandatory and imperative for the safety of its user. RETI is not responsible for any damages or injuries sustained due to improper use or modification of any of its products, or resulting from any use which deviates from the product's intended usage. RETI is not responsible for any injuries sustained due to failure to read and adhere to the instructions for use. Any misunderstanding or questions regarding the products of their use should be directed to RETI prior to any use. **All RETI treestands are sold with a full body harness ("Fall Arrest System") that meets standards set by the Treestand Manufacturer's Association ("TMA").** It is the owner's sole responsibility to inspect the product regularly for damage, improper installation, or conditions that could jeopardize the ultimate safety of the product. Failure to use or improper use of the provided Fall Arrest System may result in serious injury or death. **ALWAYS wear the provided Fall Arrest System while using this product. Owner is responsible to understand and follow product field weight rating and must never exceed maximum weight rating.** RETI is not responsible for any malfunction or injury resulting from normal wear and tear, damage caused by improper use, improper maintenance, negligence or accidents. This product, if used safely as intended, will provide trouble free service for the useful life of the product. We hope you will enjoy the quality of our products for years to come, and have a safe hunt.

**For replacement parts, phone 800-450-EDGE (3343) or go online to [www.HuntRiversEdge.com](http://www.HuntRiversEdge.com).**

## WARNINGS

### WARNING

DO NOT USE THIS PRODUCT UNTIL YOU HAVE WATCHED THE INCLUDED TREESTAND SAFETY DVD, UNDERSTAND IT, AND PRACTICED THE TECHNIQUES FOR SAFE HUNTING DISCUSSED IN THIS DVD.

YOU MUST ALWAYS USE THE PROVIDED FULL BODY HARNESS (FALL ARREST SYSTEM) THAT MEETS TMA STANDARDS WHILE USING THIS PRODUCT. SINGLE SAFETY BELTS AND CHEST HARNESES ARE NO LONGER ALLOWED AND SHOULD NEVER BE USED.

IF YOU ARE NOT WEARING A FULL BODY HARNESS PROPERLY ATTACHED TO THE TREE THAT IS PROTECTING YOU FROM A FALL, DO NOT LEAVE THE GROUND.

FAILURE TO USE OR IMPROPER USE OF THE PROVIDED FULL BODY HARNESS (FALL ARREST SYSTEM) THAT MEETS TMA STANDARDS MAY RESULT IN SERIOUS INJURY OR DEATH! READ & UNDERSTAND INSTRUCTIONS ON INSPECTION AND MAINTENANCE SHEET. IF ANY INSTRUCTIONS ARE NOT UNDERSTOOD OR IF YOU HAVE A PARTS ISSUE CALL 800-450-EDGE (3343) BEFORE USING.

READ, UNDERSTAND AND FOLLOW ALL ASSEMBLY, INSPECTION, MAINTENANCE, FULL BODY HARNESS (FALL ARREST SYSTEM) & USE INSTRUCTIONS PROVIDED BEFORE EACH USE. FAILURE TO FOLLOW ALL WARNINGS AND INSTRUCTIONS COULD RESULT IN SERIOUS INJURY OR DEATH.

READ AND PERFORM ALL INSPECTION AND MAINTENANCE TASKS BEFORE EACH AND EVERY USE. (REPLACE ANY QUESTIONABLE COMPONENTS IMMEDIATELY WITH RIVERS EDGE® ORIGINAL REPLACEMENT PARTS.) DO NOT LEAVE YOUR STAND OUTDOORS - REMOVE AFTER EACH USE AND STORE INDOORS!

INSTRUCTIONS/DVD SHOULD BE KEPT IN A SAFE PLACE AND REVIEWED AT LEAST ANNUALLY. IT IS THE RESPONSIBILITY OF THE TREESTAND OWNER TO FURNISH THE COMPLETE INSTRUCTIONS TO ANY PERSON THAT WHO BORROWS OR PURCHASES THE TREESTAND.

DOUBLE CHECK ASSEMBLY STEPS TO BE CERTAIN YOU HAVE CORRECTLY ASSEMBLED THIS PRODUCT.

DO NOT CRUSH TUBING WHEN TIGHTENING BOLT ASSEMBLIES! IDENTIFY AND FAMILIARIZE YOURSELF WITH ALL PARTS BEFORE YOU START. A BOLT IDENTIFICATION CHART CAN BE FOUND IN THE BACK.

DO NOT EXCEED THE TOTAL FIELD RATING - 300 LBS.

NEVER USE ANY PRODUCT THAT HAS NOT BEEN MAINTAINED OR INSPECTED PROPERLY - YOUR LIFE DEPENDS ON IT!

### WARNING

WHEN HUNTING FROM A TREESTAND, FALLS CAN OCCUR ANY TIME AFTER LEAVING THE GROUND CAUSING INJURY OR DEATH.

NEVER ATTACH TO A DEAD, ODD-SHAPED, LEANING, DISEASED, LOOSE-BARKED TREE OR UTILITY POLES.

REPLACE ANY AND ALL TREESTAND STRAPS EVERY TWO YEARS OR WHEN ANY SIGNS OF DAMAGE OR WEAR EXIST BEFORE.

SOME MODELS INCLUDE A FOOTREST, WHICH IS DESIGNED AS A FOOTREST ONLY. NEVER STAND ON FOOTREST!

BE SURE TO RAISE AND LOWER YOUR WEAPON WITH A HAUL LINE. GUN BARREL END OR ARROW TIPS MUST BE POINTED DOWN-AWAY FROM YOU.

BE SURE SEAT PAD AND/OR BUCKLES ARE SECURELY AND CORRECTLY ATTACHED TO PREVENT ACCIDENTAL REMOVAL. STUDY YOUR NEW STAND TO BECOME FAMILIAR WITH ALL OF ITS FEATURES AND DESIGN. AT GROUND LEVEL, BEFORE ATTACHING OVERHEAD AND WHILE FOLLOWING PROVIDED USE INSTRUCTIONS, PRACTICE ATTACHING STAND TO TREE, REMOVING STAND FROM TREE, SITTING, AND STANDING.

INSTALLING AND USING THE TREESTAND AT GROUND LEVEL BEFORE ATTEMPTING AT ALTITUDE WILL CONFIRM THAT THE PRODUCT IS MANUFACTURED, ASSEMBLED, AND INSTALLED CORRECTLY. FAILURE TO INSTALL AND TEST AT GROUND LEVEL FIRST PUTS USERS AT RISK FOR SERIOUS INJURY OR DEATH.

DO NOT USE ANY TYPE OF AFTER MARKET HANGING ASSISTS, BRACKET MOUNT SYSTEMS OR ANY OTHER TYPE OF MECHANISM TO ATTACH YOUR BIGFOOT HANG-ON TREESTAND TO A TREE. THESE TYPES OF DEVICES CAN NEGATIVELY AFFECT THE STABILITY OF THE TREESTAND IN THE TREE AND REDUCE OR PREVENT PROPER TIGHTENING, TREE ADHESION AND PERFORMANCE OF THE TREESTAND TO THE TREE WHICH CAN LEAD TO SERIOUS INJURY OR DEATH.

## WARNING

**THE USE OF A LINEMAN'S/CLIMBING BELT IS REQUIRED WHILE ASCENDING, DESCENDING AND INSTALLING A HANG-ON TREESTAND TO STABILIZE THE USER WITH THE TREE.**

**CLIMBING AIDS (STICK LADDERS, SECTIONAL LADDERS, STEPS, ETC.) MUST EXTEND ABOVE THE PLATFORM TO ALLOW THE USER TO STEP DOWN ONTO THE PLATFORM. NEVER STEP UP TO YOUR STAND FROM A CLIMBING AID.**

**CORRECT TIGHTENING AND ADJUSTMENTS OF CHAINS, CABLES, STRAPS, ETC. ARE CRITICAL TO STABLE HANG-ON TREESTAND INSTALLATION. ALL TREESTAND CONTACT POINTS MUST BE IN CONTACT WITH THE TREE BEFORE YOU STEP ONTO YOUR STAND.**

**PLATFORM MUST BE FOLDED UP TO REMOVE STAND! THIS ALLOWS SLACK IN STRAP FOR REMOVAL.**

## WARNING

**ALWAYS CLIMB TREE ON THE ATTACHMENT SIDE OF THIS TREESTAND. VISUALLY INSPECT YOUR CONNECTION TO BE ASSURED YOU HAVE CORRECTLY ATTACHED STAND TO TREE AS PER INSTRUCTIONS AND DIAGRAMS.**

**NEVER PULL YOURSELF UP ONTO PLATFORM - ALWAYS STEP DOWN FROM ABOVE.**

**NEVER TOUCH OR MOVE BUCKLE WHILE STAND IS IN USE.**

**USE A HAUL LINE TO RAISE OR LOWER THE TREESTAND. NEVER CLIMB WITH ANYTHING ON YOUR BACK.**

**NEVER LEAVE A TREESTAND IN A TREE WHEN NOT IN USE SINCE WEATHER OR ANIMALS COULD CAUSE DAMAGE. TREE GROWTH CAN ALSO STRESS AND DAMAGE STRAPS AND BUCKLES.**

### ALWAYS...

- Be physically fit, mentally alert, and well rested before using this product
- Read, understand and follow all warnings and instructions before use, save for future reference
- Use the provided Full Body Harness (Fall Arrest System) that meets TMA standards at all times including ascending to and descending from a tree stand
- Be fully aware of foot placement
- Recommended for adult use only
- Inspect for missing parts, all hardware condition, and damage before every application, replace if necessary
- Pull up a bow, backpack, firearm or other equipment only after being secure in the treestand and a firearm must be pulled up with it unloaded, chamber open and muzzle down.
- Remove after every use, store product indoors.
- Use only Rivers Edge® original replacement parts.
- Lubricate all slide together points with powder graphite to prevent binding, wear, rust and noise.
- Avoid all electrical power lines.
- Inform someone of the hunting location, where the treestand will be located and the expected duration of the hunt.
- Carry a signal device such as a mobile phone, radio, whistle, signal flare or personal locator device (PLD) and it must be readily available at all times.
- Inspect the treestand and all safety devices each time before use and do not store a treestand outdoors when not in use.

### NEVER...

- Sleep in a treestand
- Exceed the total field rating of 300 lbs.
- Attach to a dead, odd-shaped, leaning, diseased, loose barked trees or utility poles.
- Exceed maximum recommended use height of 10' while using a 15' climbing aid (climbing stick)
- Exceed maximum recommended use height of 15' while using a 20' climbing aid (climbing stick)
- Use on trees with a diameter smaller than 8 inches or larger than 20 inches.
- Use a treestand during inclement weather such as rain, lightning, windstorms or icy conditions and end your hunt and return to the ground if inclement conditions arise.
- Carry gun or bow when ascending or descending
- Alter the original design of your stand.
- Jump on or use in a careless manner.
- Lean out over edge of device.
- Use when intoxicated or using over-the-counter medication or prescription drugs.
- Use a damaged product, replace with new.
- Loan your stand to someone else.
- Stand on the seat, it is designed for sitting only.
- Use a treestand when feeling ill, nauseous or dizzy., or if you have a prior medical condition that could cause a problem (i.e. heart condition, joints that lock up, spinal fusions, etc.) or if you are not well rested.
- Rely on a tree branch for support.
- Jump or bounce on a treestand to seat it to the tree.

## **INSPECTION AND MAINTENANCE SCHEDULE**

### **FOR ALL RIVERS EDGE® PRODUCTS**

- Inspect all webbing, rope, cord, and strap assemblies for wear or damage.
- Inspect cables and cable ends for damage or kinking.
- Inspect all hardware and chain components for damage.
- Inspect for any structural damage to product. (Return to factory for repair or discard product if any damage is found.)
- Inspect all nut and bolt assemblies to be certain none are loose.
- Inspect for any missing parts.
- Lubricate all pivot and slide together points with powder graphite to prevent noise, wear, and rust.
- Inspect entire product for any rust, corrosion, cracks, freezing, excessive heat or rotting damage that may effect the safety of your product. Discard any questionable product.
- Inspect entire product for any structural damage - pay close attention to all weld locations. (Return to factory for repair or discard product if any damage is found.)
- Using correct wrenches inspect all nut & bolt assembly locations and snug up any that may be loose. Be careful not to crush tubing when tightening!
- Inspect and check operation of all cables, cable ends, cord, rope, webbing, and strap or chain assemblies. Replace with factory new any item or assembly that shows signs of wear, damage, kinking, or functions incorrectly.
- Inspect seat. Replace any seat with factory new that shows signs of structural damage or wear.
- Inspect all hardware for wear or damage, also be sure you have no missing parts.
- Never modify your stand in any way by making repairs, replacing parts, or altering adding or attaching anything to it except if explicitly authorized in writing by the manufacturer.

## ASSEMBLY INSTRUCTIONS (RE550, RE513, RE514)

Tools needed – two 7/16" wrenches

**IMPORTANT ASSEMBLY TIP:** Do not tighten any nut and bolt combinations completely until all parts are assembled together! Finger tighten plus one turn of a wrench only! This will temporarily hold the lock nut on the bolt while helping alignment of all parts! After all parts are assembled together, all nut & bolt combinations must be completely tightened.

1. Bolt the metal seat frame (C30) or (C33) onto the seat post using the (2) provided 1/4-20 x 2-1/4" bolts, locknuts and (6) nylon washers. **SEE FIGURES 1A OR 1B. DO NOT tighten all nut & bolt assemblies completely!**
2. Attach removable seat cushion to metal seat frame by sliding seat frame into pocket. Wrap the Velcro seat straps or buckle straps around seat frame and secure together. Snap the side release buckle together for buckle style seats. Pull straps tight so seat is not loose.
3. Bolt cables onto platform using the (2) provided 1/4 x 1-1/2" bolts, locknuts and steel washers. **SEE FIGURE 2. You must now tighten all nut & bolt assemblies. Be sure not to over tighten or crush tubing when tightening!**

**NOTE:** Using powder graphite lubricant during assembly of moving parts will help eliminate noise during use!

4. If included, attach backpacking straps (48067) at desired location on platform. Fold strap in half. Feed folded strap through platform mesh. Feed the two loose ends of strap through folded loop and pull tight forming a cinch knot. **SEE FIGURES 3A AND 3B.** Feed straps through platform mesh and secure with provided tri-slide buckles. **SEE FIGURES 3C**

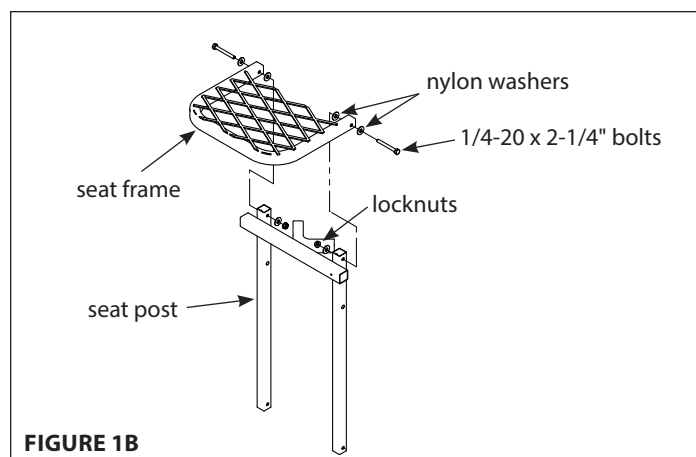

FIGURE 1B

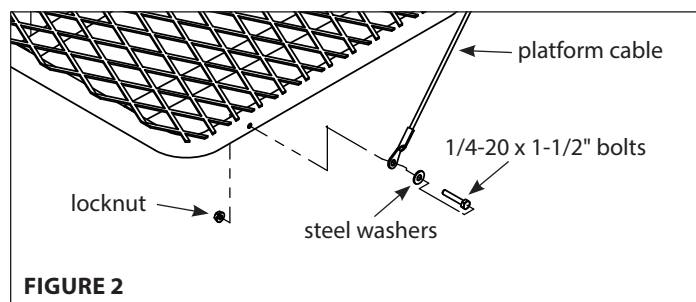

FIGURE 2

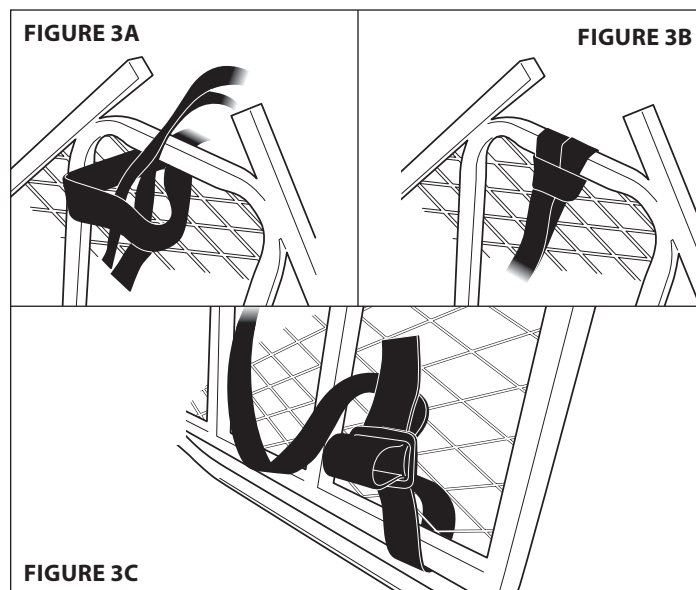

FIGURE 3C

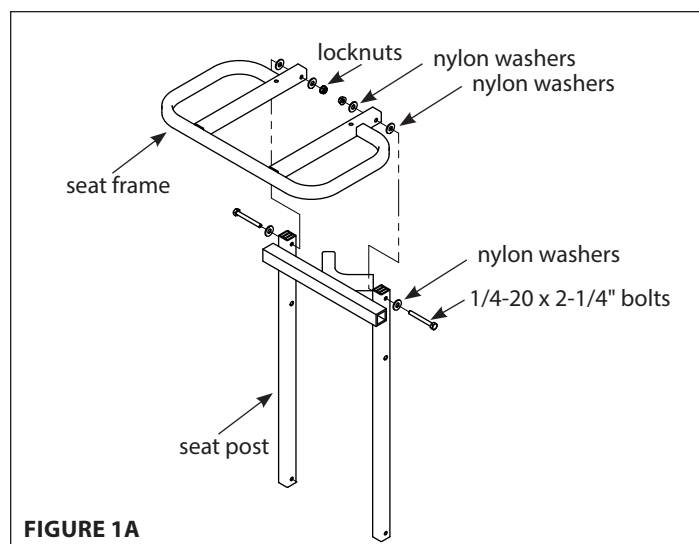

FIGURE 1A



## ASSEMBLY INSTRUCTIONS (RE552)

Tools needed – two 7/16" wrenches

**IMPORTANT ASSEMBLY TIP:** Do not tighten any nut and bolt combinations completely until all parts are assembled together! Finger tighten plus one turn of a wrench only! This will temporarily hold the lock nut on the bolt while helping alignment of all parts! After all parts are assembled together, all nut and bolt combinations must be completely tightened.

1. Attach the seat frame weldment (CXR15) to the seat post (CXR14) using (2) provided 1/4-20 x 2-1/2" bolts, locknuts and (6 to 8) nylon washers. **SEE FIGURE 4. DO NOT tighten all nuts and bolts completely!**

**NOTE:** You may need to place 2 nylon washers between seat post upright and seat frame to take up necessary gap.

2. Attach cable (48212) ends to the platform (CXR12) using (2) provided 1/4-20 x 1-1/2" bolts, locknuts and steel washers. **SEE FIGURE 5. You must now tighten all nut & bolt assemblies securely. Be sure not to over tighten or crush tubing when tightening!**

**NOTE:** Using powder graphite lubricant during assembly of moving parts will help eliminate noise during use!

3. If included, attach backpacking straps (48067) at desired location on platform. Fold strap in half. Feed folded strap through platform mesh. Feed the two loose ends of strap through folded loop and pull tight forming a cinch knot. **SEE FIGURES 6A AND 6B.** Feed straps through platform mesh and secure with provided tri-slide buckles. **SEE FIGURES 6C**

4. Attach padded seat (48103) by feeding straps around the lower portion of seat frame. Feed the long strap through both metal tri-slides that are sewn to opposite side of strap. Wrap the long strap back around one tri-slide and through the second tri-slide and pull tight. **SEE FIGURE 7.** Repeat the same operation for the other seat strap. Adjust as needed to achieve desirable seat height. Excess strap can be tucked away using provided Velcro tabs under the seat.

5. Attach (2) provided 9" camo arm pads (48736) to upper portion of seat frame weldment by wrapping around tubing and attaching Velcro together.

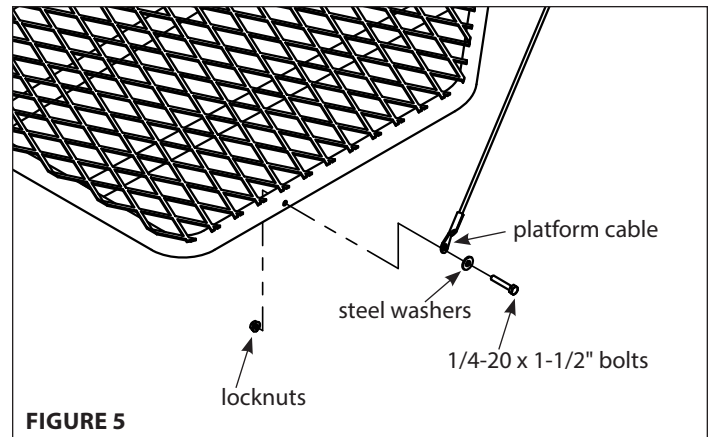

FIGURE 5

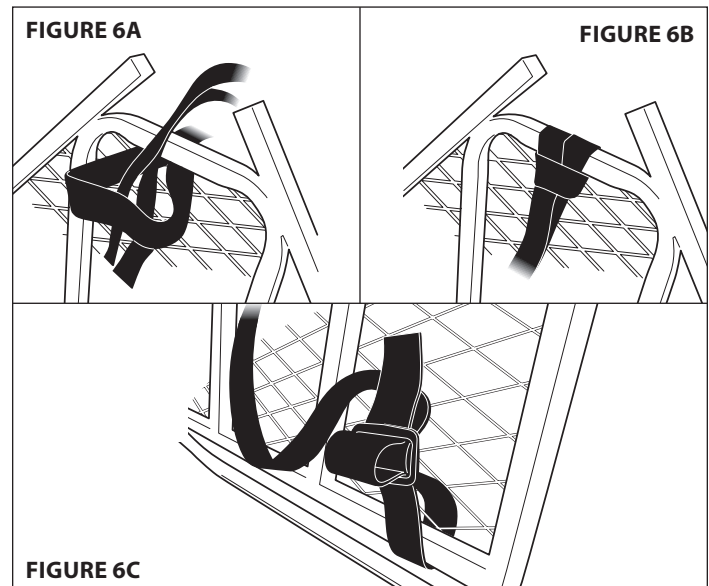

FIGURE 6C

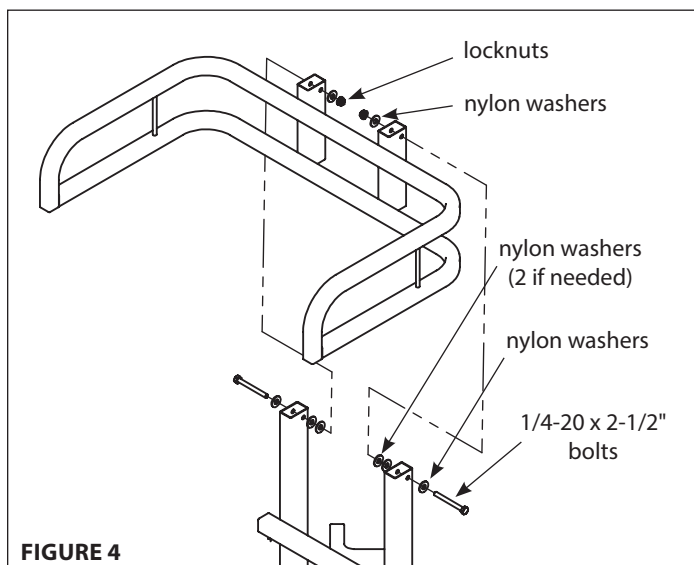

FIGURE 4

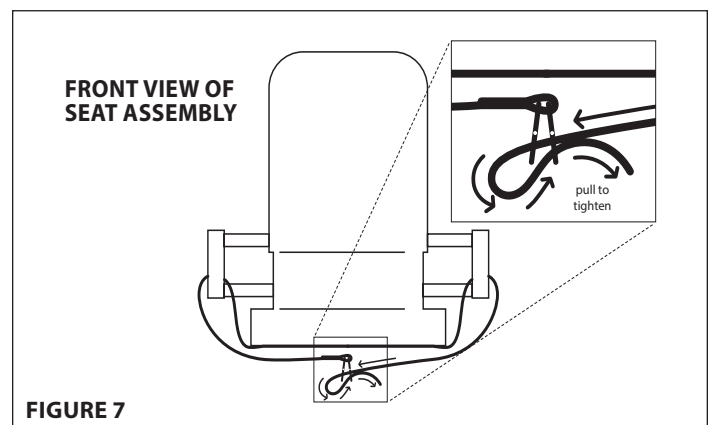

FIGURE 7

## SETUP AND USE INSTRUCTIONS (RE550, RE513, RE514, RE552)

During installation and removal of a hang-on treestand, you must always and properly use the included Full Body Harness (Fall Arrest System) with climbing belt. Refer to the Full Body Harness and climbing belt instructions included with this product for proper use. You must always use the Full Body Harness while using this product.

1. At desired height, attach by following instructions - a,b,c,d,e,f.

**NOTE: Stand should be attached to tree with platform folded in an upright position!**

a. Lengthen strap by pulling buckle away from strap - this will allow strap to slide around buckle roller bar.

b. Take snap hook/buckle end and wrap around tree. Be sure the strap is even and at the same level all the way around the tree. Also, be sure there are no twists in the strap. Connect hook to opposite side of stand by inserting through slot provided. Be absolutely sure snap hook engages through slot of bracket and can not come off. **SEE FIGURE 8**

c. Pull on excess end of strap firmly - snugging up stand to tree. **SEE FIGURE 9**

**NOTE: Platform must be folded up while doing this.**

d. While platform is still folded up, push treestand in a downward direction to further tighten strap. **SEE FIGURE 10**

e. Once securely attached, pivot the platform down. This lever-action will snug stand up tight to tree to prevent any shifting. Redo as necessary to accomplish a snug stand-to-tree fit. All four contact bars must be touching tree! **SEE FIGURE 11**

f. The tension on strap will not allow any slippage due to roller bar tension of buckle. Proper installation should be checked prior to stepping onto platform to ensure safety.

2. Before stepping down onto center of stand platform, be sure it is secured properly and is tight against tree with all (4) contact bars touching tree!
3. Carefully step onto stand platform to be sure you have a solid feel against tree and platform is level. Seat folds down for sitting and tips back for standing.
4. **RE552 ONLY.** Attach backrest portion of seat to tree by wrapping the long strap with buckle end around tree and snapping together with opposite end. Adjust as needed.

**NOTE: To remove stand, fold platform back up and pull on buckle hand strap to release tension on roller bar.**

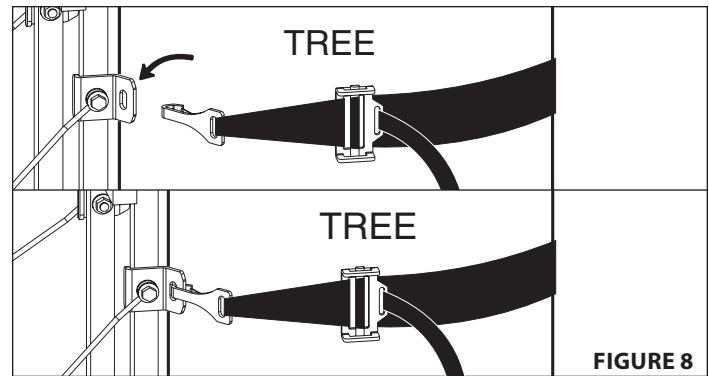

FIGURE 8

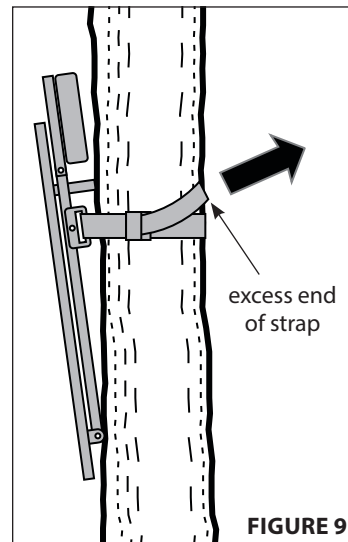

FIGURE 9

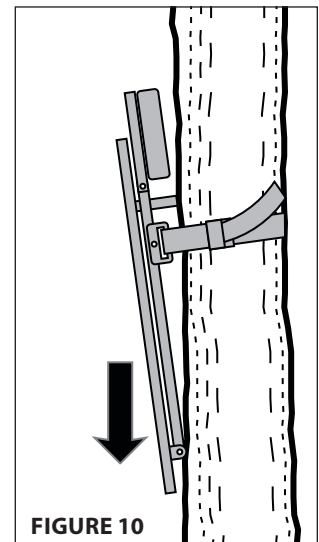

FIGURE 10

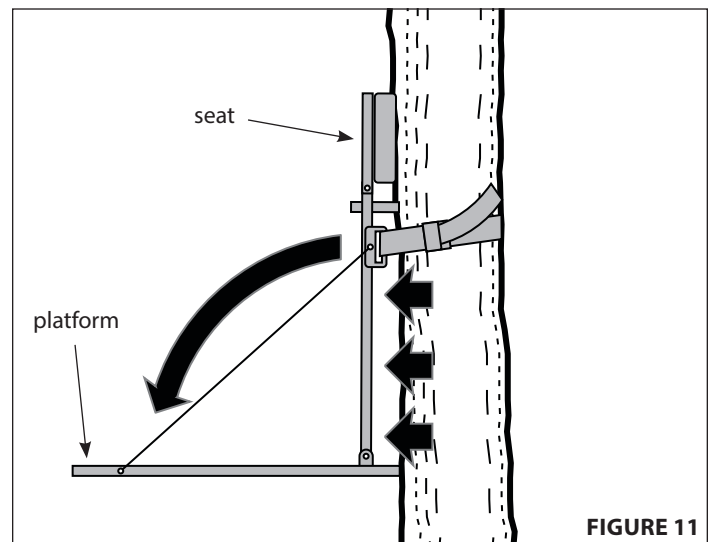

FIGURE 11



### Important:

Use only approved RETI parts.



## THREADING THE FLOAT BUCKLE

Always check the condition of your Big Foot strap before use. If strap becomes twisted or if you need to replace a worn or damaged strap, make sure to follow these instruction to ensure proper assembly.

1. Hold float buckle so warning tag faces upward. **SEE FIGURE 12**
2. Feed end tail of strap up through the bottom of the float buckle on the snap-hook side of the roller bar. **SEE FIGURE 13**

**NOTE: Smooth side of end tail must face snap-hook.**

3. Feed end tail over roller bar and down through float buckle. **SEE FIGURE 14**
4. Pull end tail away from float buckle. **SEE FIGURE 14**

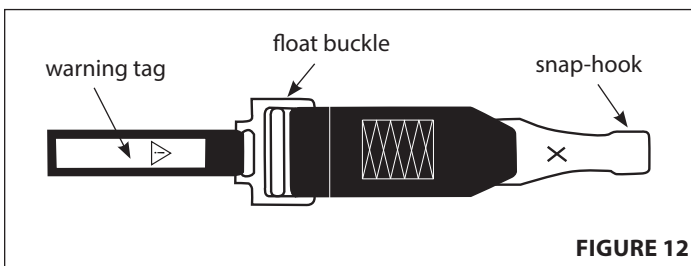

FIGURE 12

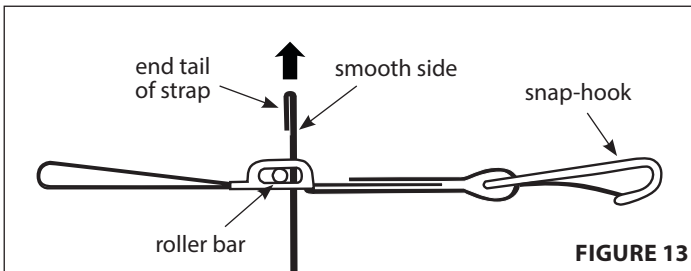

FIGURE 13

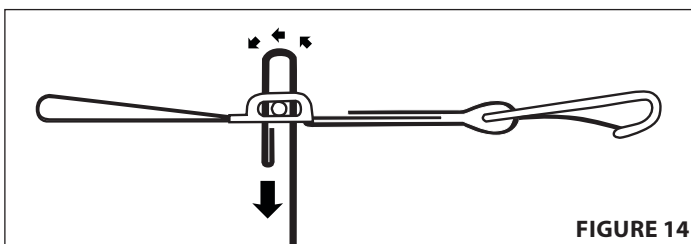

FIGURE 14

## ⚠ WARNING

**DO NOT TWIST STRAP WHEN ATTACHING. SEE SETUP AND USE INSTRUCTIONS FOR CORRECT ATTACHMENT.**

**DOUBLE CHECK ASSEMBLY STEPS TO BE CERTAIN YOU HAVE CORRECTLY ASSEMBLED THIS PRODUCT.**

**STUDY YOUR NEW STAND TO BECOME FAMILIAR WITH ALL OF ITS FEATURES AND DESIGN. AT GROUND LEVEL, BEFORE ATTACHING OVERHEAD AND WHILE FOLLOWING PROVIDED USE INSTRUCTIONS, PRACTICE ATTACHING STAND TO TREE, REMOVING STAND FROM TREE, SITTING, AND STANDING.**

**INSTALLING AND USING THE TREESTAND AT GROUND LEVEL BEFORE ATTEMPTING AT ALTITUDE WILL CONFIRM THAT THE PRODUCT IS MANUFACTURED, ASSEMBLED, AND INSTALLED CORRECTLY. FAILURE TO INSTALL AND TEST AT GROUND LEVEL FIRST PUTS USERS AT RISK FOR SERIOUS INJURY OR DEATH**

**ALWAYS CLIMB TREE ON THE ATTACHMENT SIDE OF THIS TREESTAND. VISUALLY INSPECT YOUR CONNECTION TO BE ASSURED YOU HAVE CORRECTLY ATTACHED STAND TO TREE AS PER INSTRUCTIONS AND DIAGRAMS.**

**THE USE OF A LINEMAN'S/CLIMBING BELT IS REQUIRED WHILE ASCENDING, DESCENDING AND INSTALLING A HANG-ON TREESTAND TO STABILIZE THE USER WITH THE TREE.**

**CORRECT TIGHTENING AND ADJUSTMENTS OF CHAINS, CABLES, STRAPS, ETC. ARE CRITICAL TO STABLE HANG-ON TREESTAND INSTALLATION. ALL TREESTAND CONTACT POINTS MUST BE IN CONTACT WITH THE TREE BEFORE YOU STEP ONTO YOUR STAND.**

**PLATFORM MUST BE FOLDED UP TO REMOVE STAND! THIS ALLOWS SLACK IN STRAP FOR REMOVAL.**

**NEVER PULL YOURSELF UP ONTO PLATFORM - ALWAYS STEP DOWN FROM ABOVE.**

**NEVER TOUCH OR MOVE BUCKLE WHILE STAND IS IN USE.**

## HANG-ON PARTS EXPLOSION (RE550, RE513, RE14)

### BIG FOOT (RE550)

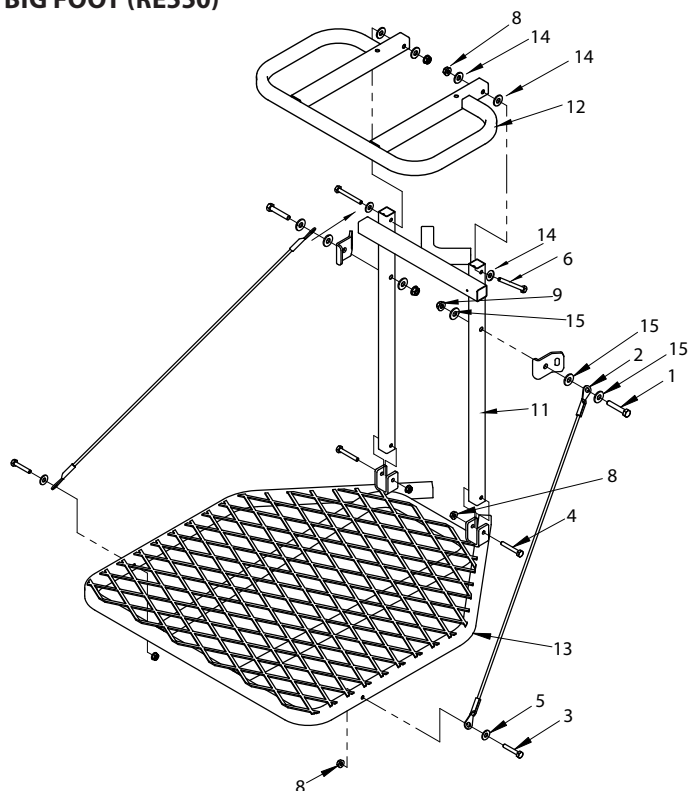

### BIG FOOT TRAVELER (RE513)

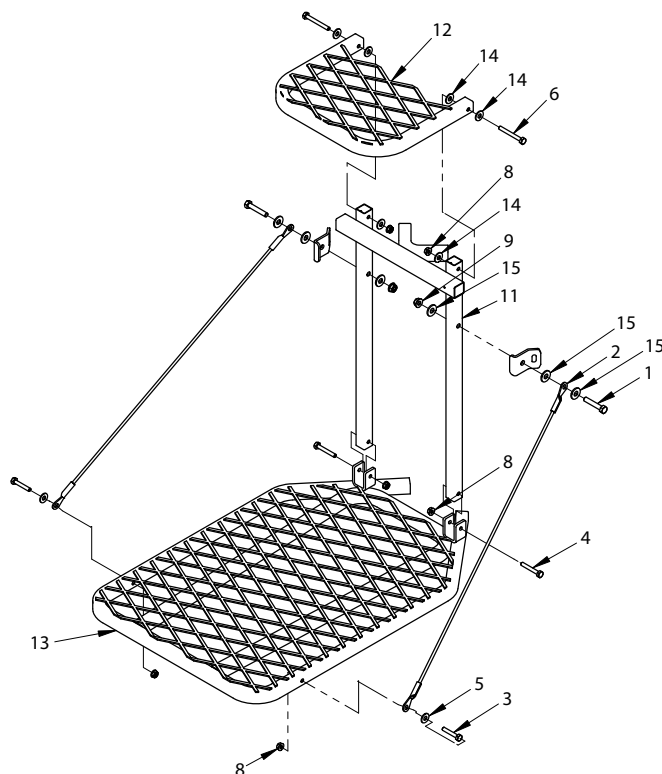

### CLASSIC BIG FOOT XL WITH FOOTREST (RE514)

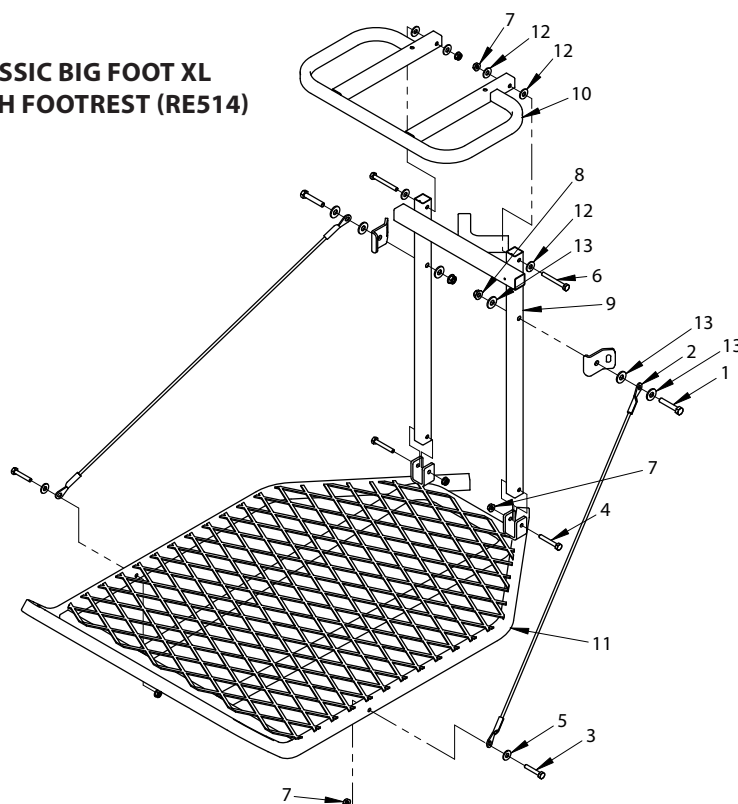

## HANG-ON PARTS LIST (RE550, RE513, RE514)

KEY #	DESCRIPTION	RE550 PART #	QTY.	RE513 PART #	QTY.	RE514 PART #	QTY
1	BOLT 5/16-18 X 1-3/4" HH BLK ZN	8655B	2	8655B	2	8655B	2
2	CABLE 26" BLACK VINYL W/BLACK ENDS	48210	2	48210	2	48212	2
3	BOLT 1/4-20 X 1-1/2" HH BLK ZN	48240B	2	48240B	2	48240B	2
4	BOLT 1/4-20 X 1-3/4" HH BLK ZN	48250B	2	48250B	2	48250B	2
5	WASHER 1/4" FLAT BLK ZN	48261B	2	48261B	2	48261B	2
6	BOLT 1/4-20 X 2-1/4" HH BLK ZN	48271B	2	48271B	2	48271B	2
8	NUT 1/4-20 FLANGE NYLOCK BLK ZN	48752B	6	48752B	6	48752B	6
9	NUT 5/16-18 FLANGE NYLOCK BLK ZN	60G5NYB	2	60G5NYB	2	60G5NYB	2
11	SEAT POST	C19	1	C19	1	C19	1
12	SEAT FRAME	C30	1	C33	1	C30	1
13	PLATFORM	C18	1	CB18	1	CXR18	1
14	WASHER 5/16" NYLON, BLK	WN516	6	WN516	6	WN516	6
15	WASHER 5/16" FLAT BLK ZN	WF516B	6	WF516B	6	WF516B	6
<b>ITEMS BELOW NOT SHOWN</b>							
--	TREE STRAP ASSEMBLY	RE760	1	RE760	1	RE760	1
--	FULL BODY HARNESS (FAS)	10531	1	10531	1	10531	1
--	CLIMBING BELT	15599	1	15599	1	15599	1
--	BACKPACK STRAPS / TRI-SLIDE KIT	48067	1	--	--	48067	1
--	SEAT COVER, SEWN COMPLETE W/FOAM	486103	1	48101	1	486103	1
--	DVD TREESTAND SAFETY	48800	1	48800	1	48800	1

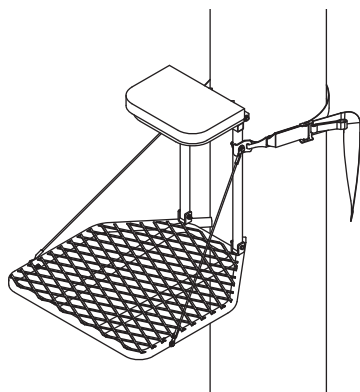

**BIG FOOT™**  
**Model RE550**

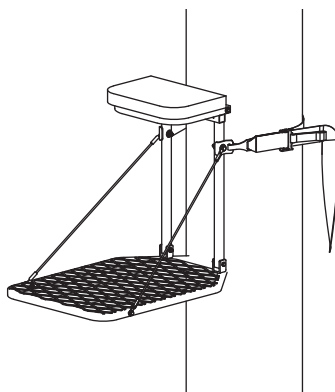

**BIG FOOT™ TRAVELER**  
**Model RE513**

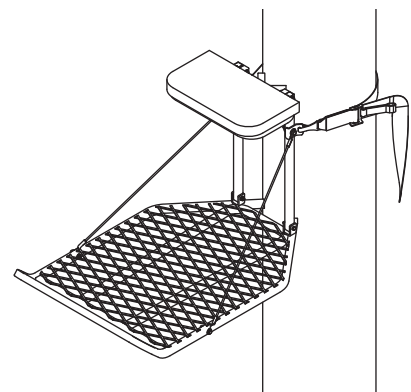

**CLASSIC BIG FOOT™ XL**  
**with Footrest**  
**Model RE514**

## HANG-ON PARTS LIST (RE552)

KEY #	PART #	DESCRIPTION	QTY.
1	1423B	BOLT 5/16-18 X 2 HHCS GR5 BLK ZN	2
2	48153B	BOLT 1/4-20 X 2 HHCS GR5 BLK ZN	2
3	48212	CABLE- 28" BROWN VINYL	2
4	48240B	BOLT 1/4-20 X 1-1/2 HHCS GR5 BLK ZN	2
5	48261B	WASHER FLAT 1/4" BLACK	2
6	48270B	BOLT 1/4-20 X 2-1/2 HHCS GR5 BLK ZN	2
7	48752B	NUT, FLANGED, NYLOCK, 1/4-20	6
8	60G5NYB	NUT 5/16-18 NYLOCK BLACK	2
9	CXR12	WELDMENT, PLATFORM, LOUNGER	1
10	CXR14	WELDMENT, FTS, SEAT POST LOUNGER	1
11	CXR15	WELDMENT, SEAT FRAME, LOUNGER	1
12	WF516B	WASHER FLAT 5/16" STANDARD BLACK ZN	6
13	WN516	WASHER, 5/16", BLACK NYLON	10
<b>ITEMS BELOW NOT SHOWN</b>			
--	RE760	TREE STRAP ASSEMBLY	1
--	10531	FULL BODY HARNESS (FAS)	1
--	15599	CLIMBING BELT	1
--	48103	SEAT W/ BACKREST, LOUNGER HANG-ON	1
--	48736	CAMO ARMREST PAD, 9"	2
--	48067	KIT, BACKPACK STRAPS	1
--	48800	DVD TREESTAND SAFETY	1

## HANG-ON PARTS EXPLOSION (RE552)

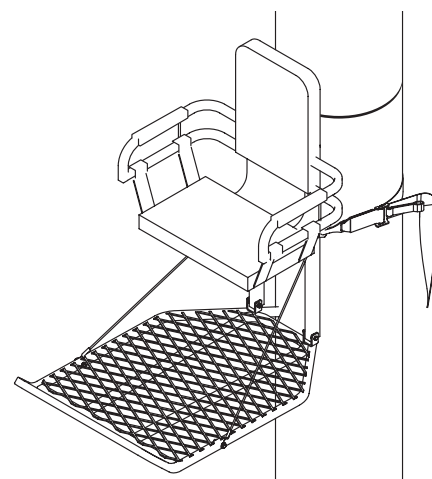
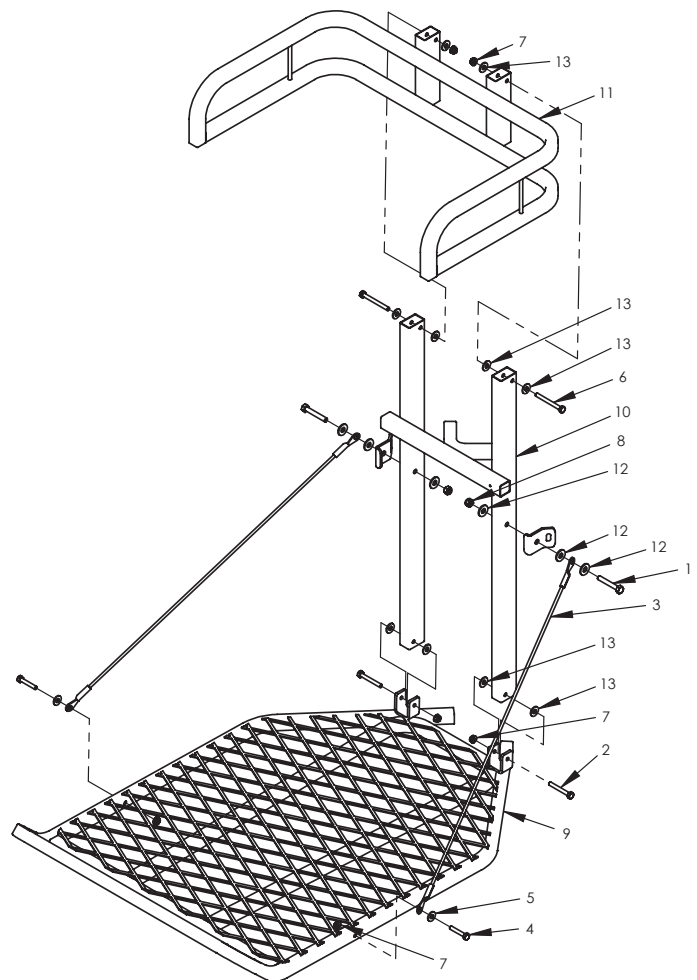

**BIG FOOT™ XL LOUNGER  
MODEL RE552**

## BOLT IDENTIFICATION CHART

Bolts shown are for size reference only. Extra hardware may be included in the parts bag.

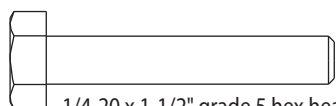

1/4-20 x 1-1/2" grade 5 hex head bolt



1/4-20 x 1-3/4" grade 5 hex head bolt

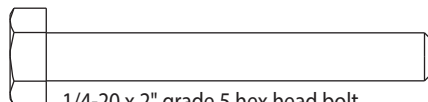

1/4-20 x 2" grade 5 hex head bolt



1/4-20 x 2-1/4" grade 5 hex head bolt

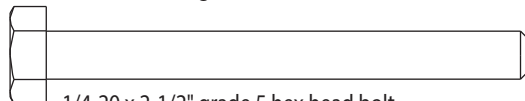

1/4-20 x 2-1/2" grade 5 hex head bolt

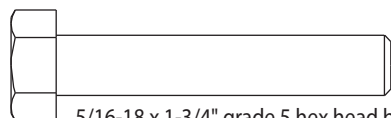

5/16-18 x 1-3/4" grade 5 hex head bolt

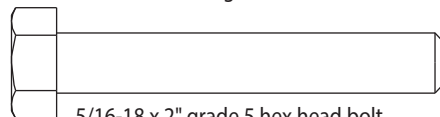

5/16-18 x 2" grade 5 hex head bolt

[illegible]



[illegible]



Rivers Edge® Treestands, Inc.  
1160 Eighth Avenue, PO Box 755  
Cumberland, WI 54829  
800-450-EDGE (3343) | Fax 715-822-2124  
Email: [info@huntriversedge.com](mailto:info@huntriversedge.com)