

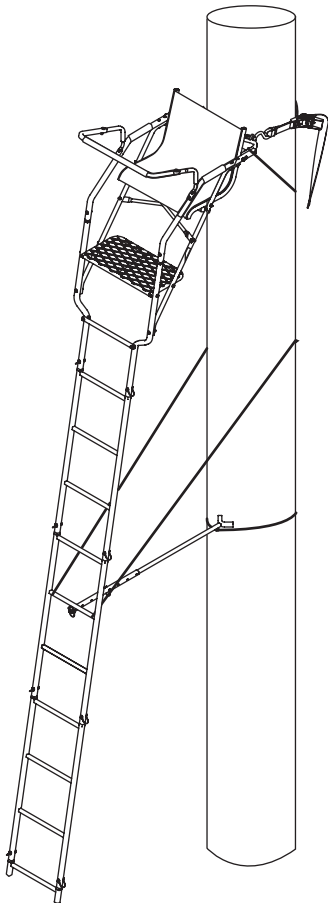

Operator's Manual
**One-Man
Ladder Stands**

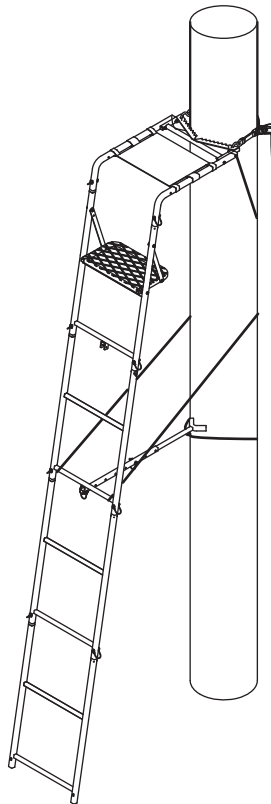

**RELAX™ WIDE
Model RE631**



**PACK-N-STACK™
Model RE622**

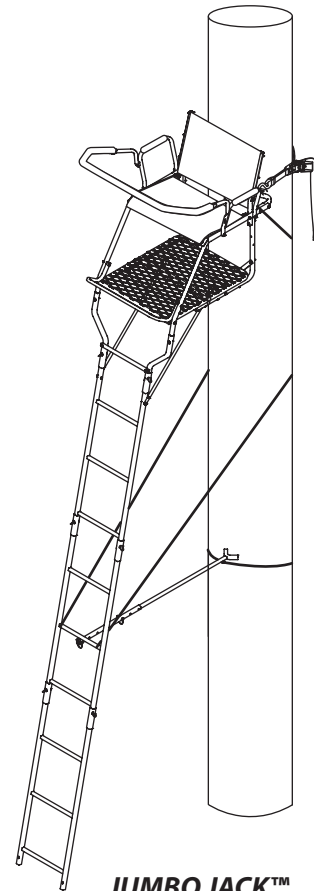

**JUMBO JACK™
Model RE628**



INCLUDES MODEL #'s:

RE622, Pack-N-Stack™
RE627, Oasis™
RE628, Jumbo Jack™
RE631, Relax™ Wide

**Wear Your
Harness!**



Get parts online at
www.HuntRiversEdge.com



P/N: OMRELD001
REV3: 02/17/15
© 2015 RETI
All Rights Reserved.

INTRODUCTION

Rivers Edge® Treestands are engineered with you the hunter in mind. We appreciate your purchase of one of our world class treestands. Follow these few simple instructions and your stand will provide you many years of trouble-free pleasure. Instructions should be kept in a safe place and reviewed at least annually.

If for any reason you have a problem with your product, **DO NOT return to the retailer**, contact the Rivers Edge® customer service department at 800-450-EDGE (3343) for assistance.

CONTENTS

Introduction/Warranty	2
Warnings.....	3
Inspection and Maintenance	4
Assembly/Parts Explosion/Parts List (RE622)	5-9
Assembly/Parts Explosion/Parts List (RE627)	10-19
Assembly/Parts Explosion/Parts List (RE628)	20-29
Assembly/Parts Explosion/Parts List (RE631)	30-35
Set-Up and Use Instructions (All ladders in this manual).....	36-37
Bolt Guide	38

WARRANTY

Rivers Edge Tree Stands, Inc. ("RETI") offers a one year warranty for all components of the treestand. These warranties apply to the original owner with a proof of purchase. These warranties begin on the date of purchase by the first retail consumer and continue for the period specified above. These warranties apply to products that are not modified, abused or used in a manner that deviates from the product's intended usage. Minor fading in color is normal and is not covered by warranty. Any corrosion of painted surfaces that occurs as a result of paint being removed or damaged is also not covered by warranty. RETI offers no other warranty expressed or implied. Products for which warranty work has been approved must be sent directly to RETI and performed by RETI. **To obtain warranty service and/or replacement instructions, you must obtain prior approval from Rivers Edge® Treestands before shipping your package to us by calling our customer service department at 800-450-EDGE (3343) or by writing to: Rivers Edge Tree Stands, Inc., P.O. Box 755, 1160 Eighth Avenue, Cumberland, WI 54829 for a return material authorization number (RMA#).** All items must be shipped prepaid. RETI will, at no charge, repair or replace, in RETI's sole discretion, any product that satisfies the conditions stated above. RETI retains the right to change models, specifications and price without notice.

This equipment has been manufactured under strict quality and safety guidelines. As with any equipment of this type, full understanding of the instructions and its use is mandatory and imperative for the safety of its user. RETI is not responsible for any damages or injuries sustained due to improper use or modification of any of its products, or resulting from any use which deviates from the product's intended usage. RETI is not responsible for any injuries sustained due to failure to read and adhere to the instructions for use. Any misunderstanding or questions regarding the products of their use should be directed to RETI prior to any use. **All RETI treestands are sold with a full body harness ("Fall Arrest System") that meets standards set by the Treestand Manufacturer's Association ("TMA").** It is the owner's sole responsibility to inspect the product regularly for damage, improper installation, or conditions that could jeopardize the ultimate safety of the product. Failure to use or improper use of the provided Fall Arrest System may result in serious injury or death. **ALWAYS wear the provided Fall Arrest System while using this product. Owner is responsible to understand and follow product field weight rating and must never exceed maximum weight rating.** RETI is not responsible for any malfunction or injury resulting from normal wear and tear, damage caused by improper use, improper maintenance, negligence or accidents. This product, if used safely as intended, will provide trouble free service for the useful life of the product. We hope you will enjoy the quality of our products for years to come, and have a safe hunt.

For replacement parts, phone 800-450-EDGE (3343) or go online to www.HuntRiversEdge.com.

WARNINGS

WARNING

DO NOT USE THIS PRODUCT UNTIL YOU HAVE WATCHED THE INCLUDED TREESTAND SAFETY DVD, UNDERSTAND IT AND PRACTICED THE TECHNIQUES FOR SAFE HUNTING DISCUSSED IN THIS DVD.

YOU MUST ALWAYS USE THE PROVIDED FULL BODY HARNESS (FALL ARREST SYSTEM) THAT MEETS TMA STANDARDS WHILE USING THIS PRODUCT. SINGLE SAFETY BELTS AND CHEST HARNESSES ARE NO LONGER ALLOWED AND SHOULD NEVER BE USED.

IF YOU ARE NOT WEARING A FULL BODY HARNESS THAT IS PROTECTING YOU FROM A FALL, DO NOT LEAVE THE GROUND.

FAILURE TO USE OR IMPROPER USE OF THE PROVIDED FULL BODY HARNESS (FALL ARREST SYSTEM) THAT MEETS TMA STANDARDS MAY RESULT IN SERIOUS INJURY OR DEATH! READ, UNDERSTAND AND FOLLOW ALL INSTRUCTIONS. IF ANY INSTRUCTIONS ARE NOT UNDERSTOOD OR IF YOU HAVE A PARTS ISSUE CALL 800-450-EDGE (3343) BEFORE USING.

READ, UNDERSTAND AND FOLLOW ALL ASSEMBLY, INSPECTION, MAINTENANCE, FULL BODY HARNESS (FALL ARREST SYSTEM) & USE INSTRUCTIONS PROVIDED BEFORE EACH USE. FAILURE TO FOLLOW ALL WARNINGS AND INSTRUCTIONS COULD RESULT IN SERIOUS INJURY OR DEATH.

READ AND PERFORM ALL INSPECTION AND MAINTENANCE TASKS BEFORE EACH AND EVERY USE (REPLACE ANY QUESTIONABLE COMPONENTS IMMEDIATELY WITH RIVERS EDGE® ORIGINAL REPLACEMENT PARTS). DO NOT LEAVE YOUR STAND OUTDOORS - REMOVE AFTER EACH USE AND STORE INDOORS!

INSTRUCTIONS SHOULD BE KEPT IN A SAFE PLACE AND REVIEWED AT LEAST ANNUALLY. IT IS THE RESPONSIBILITY OF THE TREESTAND OWNER TO FURNISH THE COMPLETE INSTRUCTIONS TO ANY PERSON THAT WHO BORROWS OR PURCHASES THE TREESTAND.

DOUBLE CHECK ASSEMBLY STEPS TO BE CERTAIN YOU HAVE CORRECTLY ASSEMBLED THIS PRODUCT.

DO NOT CRUSH TUBING WHEN TIGHTENING BOLT ASSEMBLIES! IDENTIFY AND FAMILIARIZE YOURSELF WITH ALL PARTS BEFORE YOU START. A BOLT IDENTIFICATION CHART CAN BE FOUND IN THE BACK.

DO NOT EXCEED THE TOTAL FIELD RATING- 300 LBS.

NEVER USE ANY PRODUCT THAT HAS NOT BEEN MAINTAINED OR INSPECTED PROPERLY - YOUR LIFE DEPENDS ON IT!

WHEN HUNTING FROM A TREESTAND, FALLS CAN OCCUR ANY TIME AFTER LEAVING THE GROUND CAUSING INJURY OR DEATH.

NEVER ATTACH TO A DEAD, ODD-SHAPED, LEANING, DISEASED, LOOSE-BARKED TREE OR UTILITY POLES.

WARNING

REPLACE ANY AND ALL TREESTAND STRAPS EVERY TWO YEARS OR WHEN ANY SIGNS OF DAMAGE OR WEAR EXIST BEFORE.

SOME MODELS INCLUDE A FOOTREST, WHICH IS DESIGNED AS A FOOTREST ONLY. NEVER STAND ON THE FOOTREST.

BE SURE TO RAISE AND LOWER YOUR WEAPON AND GEAR WITH A HAUL LINE. GUN BARREL END AND ARROW TIPS MUST BE POINTED DOWN- AWAY FROM YOU.

BE SURE SEAT PAD AND/OR BUCKLES ARE SECURELY AND CORRECTLY ATTACHED TO PREVENT ACCIDENTAL REMOVAL.

WARNING

ALL ASSEMBLY MUST BE DONE BY THREE PEOPLE IN THIS ORDER AT GROUND LEVEL BEFORE UPRIGHTING.

NEVER EXCEED THE MAXIMUM STATED USE HEIGHT.

CHECK THE GROUND UNDER STAND TO MAKE SURE IT IS FIRM AND LEVEL. SLOPED GROUND OR UNEVEN SURFACE (ONE SIDE ON A ROCK) CAN CAUSE YOUR LADDER TO TILT OR SHIFT OFF THE TREE AS YOU CLIMB.

CHECK EVERY LADDER SECTION CONNECTION EVERY TIME YOU USE THE STAND BEFORE YOU LEAVE THE GROUND. IF LADDER SECTIONS ARE SEPARATING, DO NOT USE THE STAND.

LUBRICATION IS HIGHLY RECOMMENDED AT SLIDE TOGETHER POINTS OF EACH SECTION TO PREVENT BINDING. SECTIONS ARE STACKED TOGETHER BY SLIDING SECTIONS TOGETHER, INSIDE OF EACH OTHER. SECTIONS ARE THEN SECURED WITH SPRING LOCK PINS.

BE SURE ALL LADDER SECTIONS ARE SEATED COMPLETELY TOGETHER ON SWEDGED OR POCKETED ENDS OF PIPE.

STABILIZER BAR MUST ALWAYS BE CORRECTLY AND SECURELY ATTACHED TO LADDER AND TREE BEFORE CLIMBING LADDER.

SOME MODELS INCLUDE A MULTI-PIECE STABILIZER BAR SYSTEM. BE SURE SPRING LOCK PIN GOES THROUGH BOTH THE EXTENSION TUBE AND THE STABILIZER BAR.

BE CERTAIN SPRING LOCK PINS ARE LATCHED SECURELY TO PREVENT ACCIDENTAL REMOVAL.

BE SURE YOUR DOUBLE KNOTS ARE ALL SECURE ON ALL ROPE CONNECTIONS.

NEVER ASCEND OR DESCEND LADDER WITHOUT TIE-OFF ROPES SECURELY HOLDING LADDER TO TREE AND STABILIZER BAR SECURELY ATTACHED.

ALWAYS...

- Be physically fit, mentally alert, and well rested before using this product.
- Read, understand and follow all warnings and instructions before use and save for future reference.
- Use the provided Full Body Harness (Fall Arrest System) that meets TMA standards immediately upon reaching foot platform.
- Be fully aware of foot placement.
- Recommended for adult use only.
- Inspect ladder for missing parts, all hardware condition, and damage before every application, replace if necessary.
- Pull up a bow, backpack, firearm or other equipment only after being secure in the treestand and a fire arm must be pulled up with it unloaded, chamber open and muzzle down.
- Remove ladder after every use, store product indoors.
- Use only Rivers Edge® original replacement parts.
- Lean forward, towards tree, when ascending and descending ladder.
- Place ladder on dry, level ground.
- Lubricate all slide together points to prevent binding, wear, rust and noise.
- Avoid all electrical power lines.
- Always inform someone of the hunting location, where the treestand will be located and the expected duration of the hunt.
- Carry a signal device such as a mobile phone, radio, whistle, signal flare or personal locator device (PLD) and it must be readily available at all times.
- Inspect the treestand and all safety devices each time before use and do not store a treestand outdoors when not in use.

NEVER...

- Sleep in a treestand
- Use on wet, soft, or unstable ground.
- Exceed the total field rating of 300 lb.
- Attach to a dead, odd-shaped, leaning, diseased, loose barked trees or utility poles.
- Use on trees with a diameter smaller than 12 inches or no larger than 20 inches.
- Use a treestand during inclement weather such as rain, lightning, windstorms or icy conditions and end your hunt and return to the ground if inclement conditions arise.
- Alter the original design of your stand.
- Jump on or use in a careless manner.
- Lean out over edge of device.
- Use when intoxicated or using over-the-counter medication or prescription drugs.
- Use a damaged product, replace with new.
- Loan your stand to someone else.
- Use without stabilizer bar, spring lock pins & tie-off ropes securely attached.
- Stand on the seat, it is designed for sitting only.
- Use a treestand when feeling ill, nauseous or dizzy, or if you have a prior medical condition that could cause a problem i.e., heart condition, joints that lock-up, spinal fusion, etc. or if you are not well rested.
- Rely on a tree branch for support.
- Jump or bounce on a treestand to seat it to the tree

INSPECTION AND MAINTENANCE SCHEDULE**FOR ALL RIVERS EDGE® PRODUCTS**

- Inspect all webbing, rope, cord, and strap assemblies for wear or damage.
- Inspect cables and cable ends for damage or kinking.
- Inspect all hardware and chain components for damage.
- Inspect for any structural damage to product. (Return to factory for repair or discard product if any damage is found.)
- Inspect all nut and bolt assemblies to be certain none are loose.
- Inspect for any missing parts.
- Lubricate all pivot and slide together points with powder graphite to prevent noise, wear, and rust.
- Inspect entire product for any rust, corrosion, cracks, freezing, excessive heat, or rotting damage that may effect the safety of your product. Discard any questionable product.
- Inspect entire product for any structural damage - pay close attention to all weld locations. (Return to factory for repair or discard product if any damage is found.)
- Using correct wrenches inspect all nut & bolt assembly locations and snug up any that may be loose. Be careful not to crush tubing when tightening!
- Inspect and check operation of all cables, cable ends, cord, rope, webbing, and strap or chain assemblies. Replace with factory new any item or assembly that shows signs of wear, damage, kinking, or functions incorrectly.
- Inspect seat. Replace any seat with factory new that shows signs of structural damage or wear.
- Inspect all hardware for wear or damage, also be sure you have no missing parts.
- Never modify your stand in any way by making repairs, replacing parts, or altering adding or attaching anything to it except if explicitly authorized in writing by the manufacturer.

ASSEMBLY INSTRUCTIONS (RE622)

Tools needed – two 7/16" wrenches

IMPORTANT ASSEMBLY TIP: DO NOT TIGHTEN NUT & BOLT COMBINATIONS COMPLETELY UNTIL ALL PARTS ARE ASSEMBLED TOGETHER! FINGER TIGHTEN PLUS ONE TURN OF A WRENCH ONLY! THIS WILL TEMPORARILY HOLD THE LOCK NUT ON THE BOLT WHILE HELPING ALIGNMENT OF ALL PARTS! AFTER ALL PARTS ARE ASSEMBLED TOGETHER, ALL NUT AND BOLT COMBINATIONS MUST BE COMPLETELY TIGHTENED.

1. Attach the foot platform (1ML61), mesh side up, to the 2-step ladder section w/ stabilizer bar mount (SL64) using (2) provided 1/4-20 x 2-1/4" bolts and locknuts. **SEE FIGURE 1. DO NOT tighten all nut & bolt assemblies completely!**

NOTE: Mesh surface should be on top with squared ends of platform closest to ladder.

2. Attach the foot platform flat bars (AL7) to the foot platform and to the inside of top ladder section side rails using (4) provided 1/4-20 x 1-1/2" bolts and locknuts. **SEE FIGURE 1.**
3. Attach sling seat (48066) to assembled top sitting section by sliding each side rail through webbing loops of seat (3 on each side of seat). Seat should be orientated with seat straps on bottom side of seat for comfort.

NOTE: Always have all three seat loops on each side of seat attached to the side rails of assembled top sitting section.

4. Attach the tree blade frame (SL67) to the side rails (SL69) using (4) provided 1/4-20 x 2-1/4" bolts, locknuts and steel washers. **SEE FIGURE 2. You must now tighten all nut & bolt assemblies. Be sure not to over tighten or crush tubing when tightening!**
5. Sections are assembled on the ground in the following order: bottom section (SL62 ladder); second section (SL62 ladder); third section (SL63 ladder with stabilizer bar mount); fourth section (assembled SL64 ladder with foot platform); top section (assembled top sitting section). **SEE FINISHED 13' PACK-N-STACK LADDER LINE ART.**

WARNING

FOOT PLATFORM AND SITTING SECTION MUST ALWAYS FACE THE SAME DIRECTION, TOWARDS THE TREE.

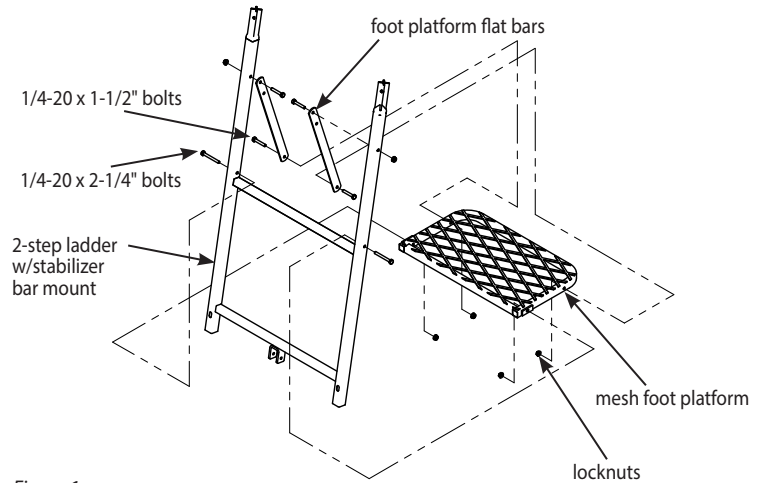

Figure 1

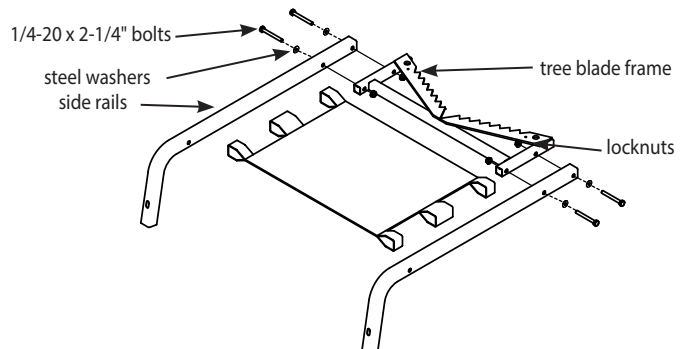

Figure 2

6. With all sections assembled together on ground, secure all sections together using (8) provided spring lock pins. Handle of spring lock pin must be put to the outside of ladder side rails. **SEE FIGURE 3.**
7. a. Attach the stabilizer bar extension tube (1ML23) to the third ladder section mounting bracket using (1) provided spring lock pin. **SEE FIGURE 4.**
b. Slide the stabilizer bar (L29) into the extension tube and attach the two pieces together using (1) provided spring lock pin. Spring lock pin must go through both the extension tube and the stabilizer bar at appropriate hole to achieve desired distance from tree. Adjustment in length may be needed when ladder is uprighted later in instructions. **SEE FIGURE 4.**
8. a. Tie one end of the provided 9' rope to the link welded onto the stabilizer bar, just in front of the tree hugger. **Be sure your double knot is secure. SEE FIGURE 5.**
b. Tie one end of each of the provided 15' ropes to the square tube side rails and tree blade frame, just in front of the welded on tree blade. **Be sure your double knots are secure. SEE FIGURE 5.**

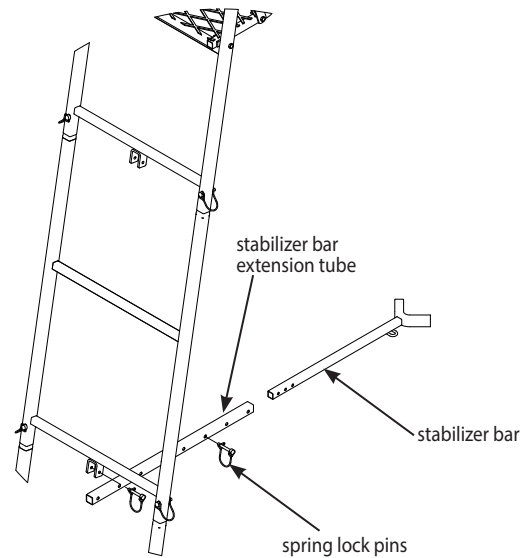

Figure 4

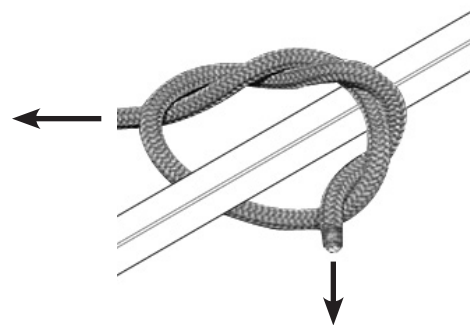

Figure 5

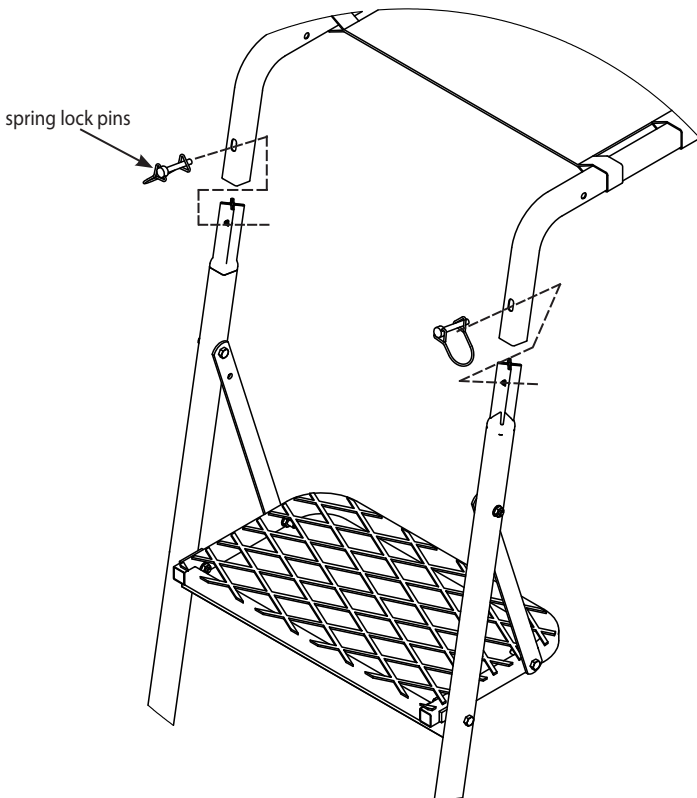

Figure 3

RE622 BACKPACKING STRAP ATTACHMENT INSTRUCTIONS

1. Stack metal components of the ladder **AS SHOWN IN FIGURE 1A AND 1B.**
2. Lay stabilizer with extension tube along side of stacked ladder. Wrap the provided ladder ratchet strap around the stacked frame. Hook the two "S"-hooks together and ratchet tight. This will securely hold all ladder components together.
3. Attach backpacking straps (48067) on packed ladder. Fold strap in half. Feed folded strap through foot platform mesh and around platform frame OR around the ladder rung located directly underneath the foot platform. Feed the two loose ends of strap through folded loop and pull tight forming a cinch knot. **SEE FIGURES 2A AND 2B.** Feed the two loose ends of straps around bottom group of ladder rungs and secure with provided tri-slide buckles. **SEE FIGURE 2C.**
4. Secure all ladder sections and stabilizer bar together with your ratchet strap.

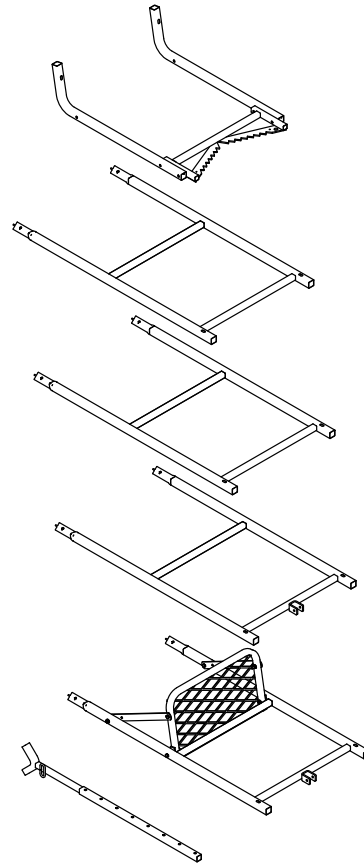

Figure 1B: Unstacked View

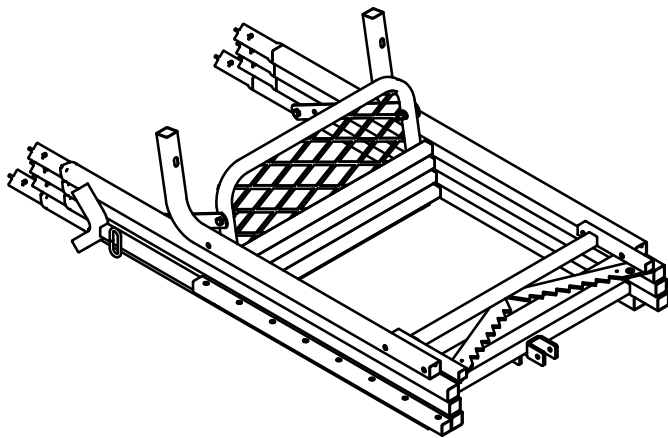

Figure 1A: Stacked View



Figure 2A: Attaching the straps

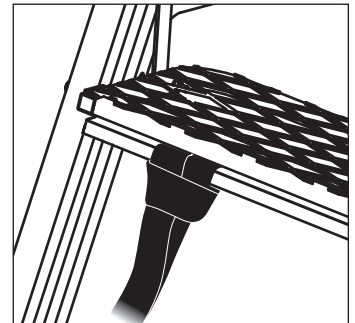

Figure 2B: Pulling the straps tight

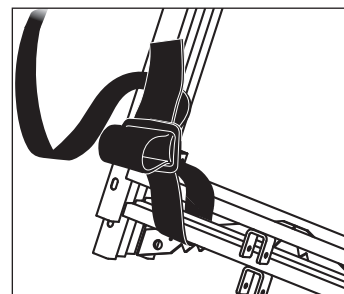
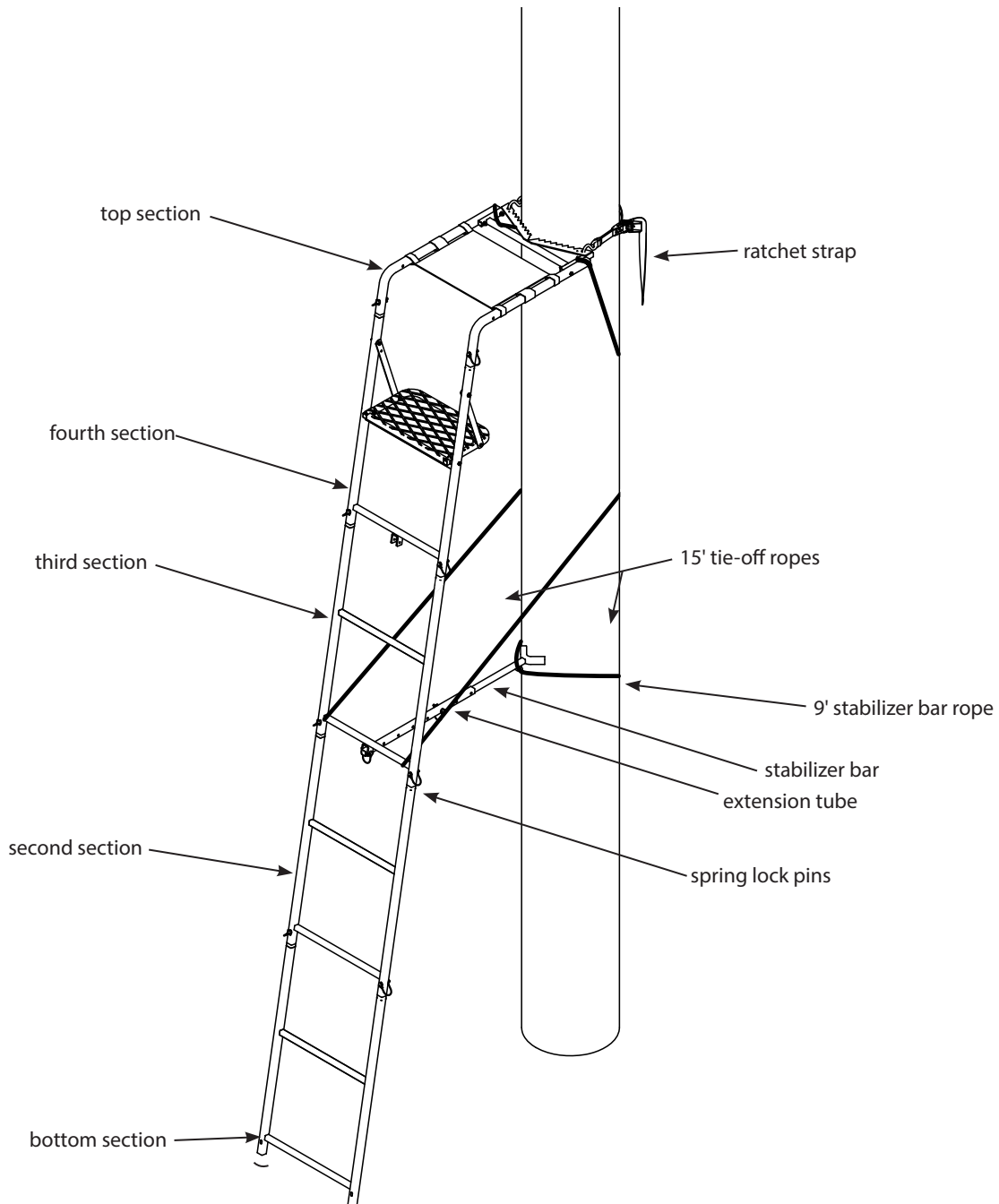
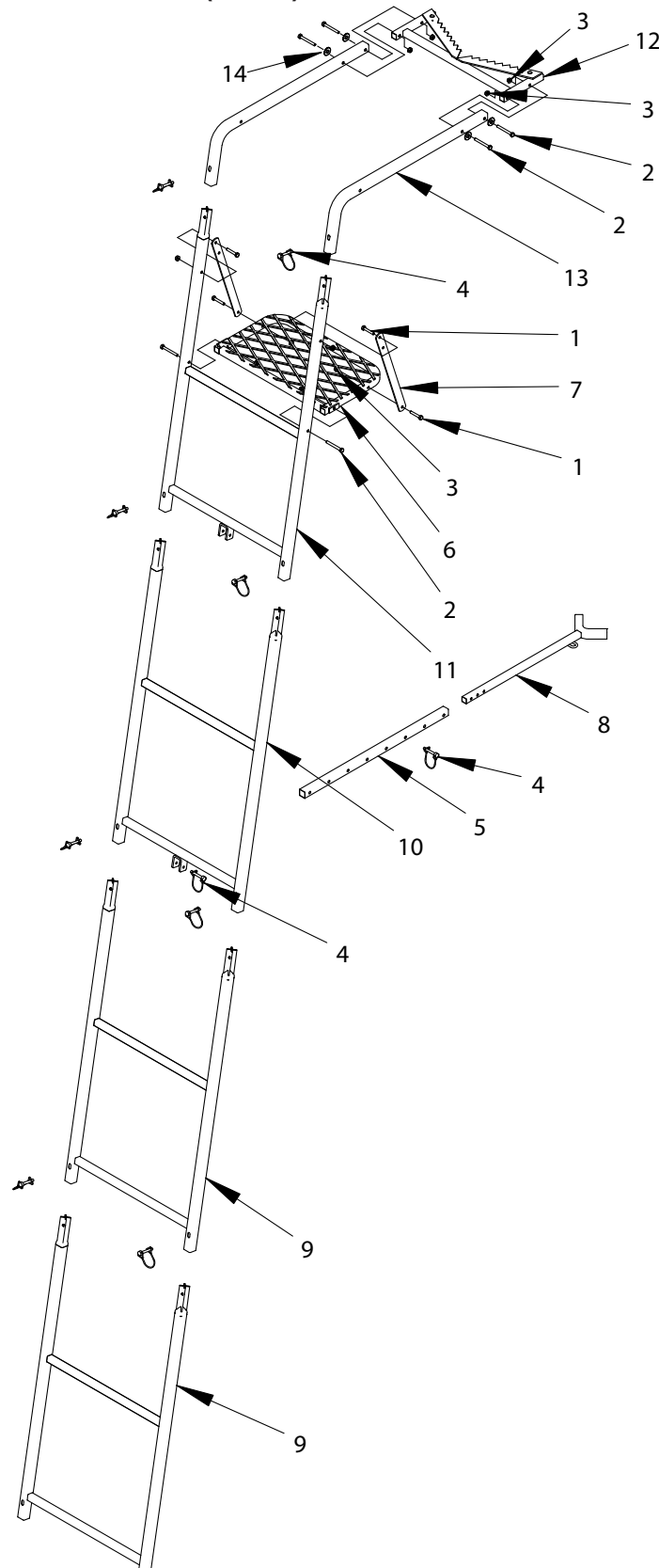

Figure 2C: Attaching straps to bottom

FINISHED PACK-N-STACK™ LADDER



LADDER PARTS (RE622)



**NO EXTENSIONS AVAILABLE FOR THIS MODEL.
NEVER MODIFY OR EXCEED ORIGINAL STATED USE HEIGHT!**

LADDER PARTS LIST (RE622)

KEY #	PART #	DESCRIPTION	QTY.
1	48240B	BOLT, HHCS GR5 BLK 1/4-20 X 1-1/2"	4
2	48271B	BOLT, HHCS GR5 BLK 1/4-20 X 2-1/4"	6
3	48752B	NUT, FLANGED NYLOCK 1/4-20	10
4	63281	SNAP PIN, 1/4 X 1-3/4, ROUNDED RETAINER	10
5	1ML23	SUPPORT TUBE, STABILIZER	1
6	1ML61	FOOT PLATFORM	1
7	AL7	SIDE SUPPORT, FOOT PLATFORM	2
8	L29	STABILIZER BAR, 18"	1
9	SL62	SWEDGED LADDER, 38"	2
10	SL63	SWEDGED LADDER W/VAM, 38"	1
11	SL64	SWEDGED LADDER W/VAM, 38"	1
12	SL67	TREE BLADE, LADDER	1
13	SL69	SIDE RAIL	2
14	48261B	WASHER BLK 1/4"	4

ITEMS BELOW NOT SHOWN

--	48415	RATCHET STRAP	1
--	10531	FULL BODY HARNESS (FAS)	1
--	48691	TIE-OFF ROPE KIT (INCLUDES TWO 15' ROPES AND ONE 9' ROPE)	2
--	48066	SEAT, W/STIFFENER, SLING	1
--	48800	DVD TREESTAND SAFETY	1

Maximum Height - 12' 3" to seat

Maximum Field Rating - 300 lbs.

Tree Diameter Range - 12" to 20"

ASSEMBLY INSTRUCTIONS (RE627)

Tools needed – two 7/16" wrenches, one 9/16" wrench

IMPORTANT ASSEMBLY TIP: Do not tighten any nut and bolt combinations completely until all parts are assembled together! Finger tighten plus one turn of a wrench only! This will temporarily hold the lock nut on the bolt while helping alignment of all parts! After all parts are assembled together, all nut & bolt combinations must be completely tightened.

1. Attach the front platform (410050) and the rear platform (410058) together using (2) provided 1/4-20 x 2" bolts, locknuts and steel washers. **SEE FIGURE 1. DO NOT tighten all nut and bolt assemblies completely!**

NOTE: Mesh surface of foot platforms should be on top.

2. Attach the platform support rails (410055) to the bottom of assembled foot platforms using (8) provided 1/4-20 x 2-1/4" bolts, locknuts and steel washers. **SEE FIGURE 2.**
3. Attach the platform flat support braces (1ML40) to the rear platform and platform support rails using (4) provided 1/4-20 x 1-1/2" bolts and locknuts. **SEE FIGURE 2.**

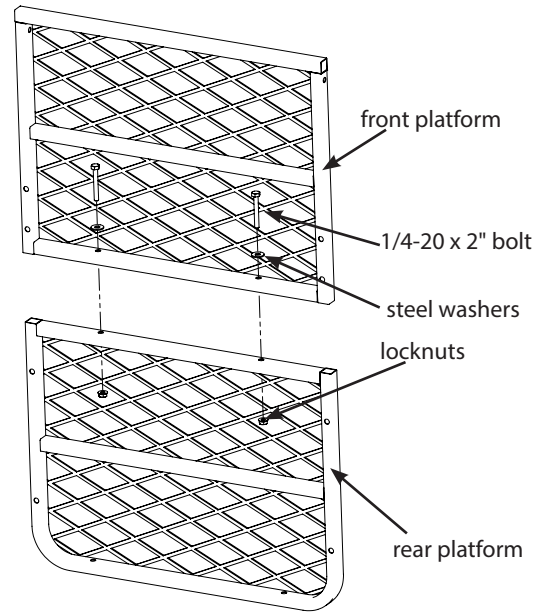

Figure 1

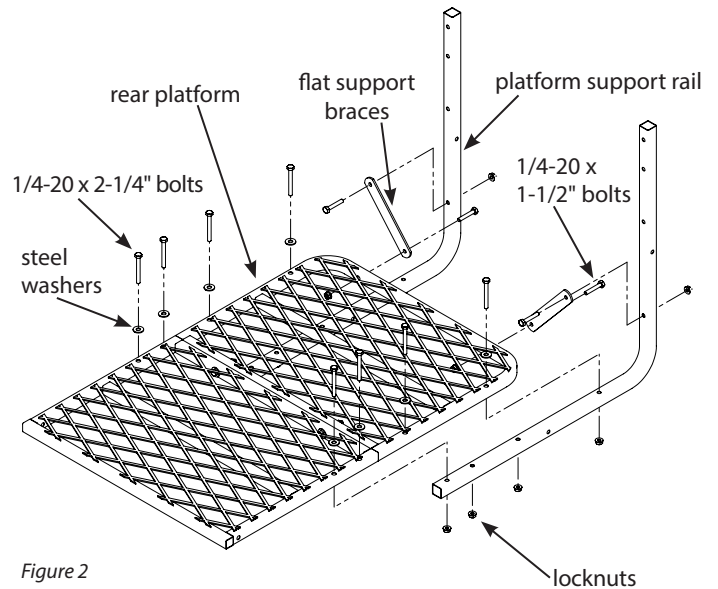

Figure 2

4. Attach the front of the ladder side rails (410053) to the front platform using (2) provided 1/4-20 x 2" bolts (2), locknuts (4) and steel washers. **SEE FIGURE 3.**
5. Attach the left armrest (410062L), right armrest (410062R) and (2) backrest mounts (410082) to the previously assembled ladder side rails and platform support rails using (2) provided 1/4-20 x 2" bolts, (4) 1/4-20 x 2-1/4" bolts, (2) 1/4-20 x 3" bolts, (8) locknuts and (8) steel washers. **SEE FIGURE 3.**
6. Attach the tree blade (410056) to the ladder side rails using (4) provided 1/4-20 x 2-1/4" bolts, locknuts and steel washers. **SEE FIGURE 4.**
7. Attach footrest (410061) to ladder side rails using (2) provided 1/4-20 x 2-3/4" bolts, locknuts, steel washers and nylon spacers. **SEE FIGURE 5.**

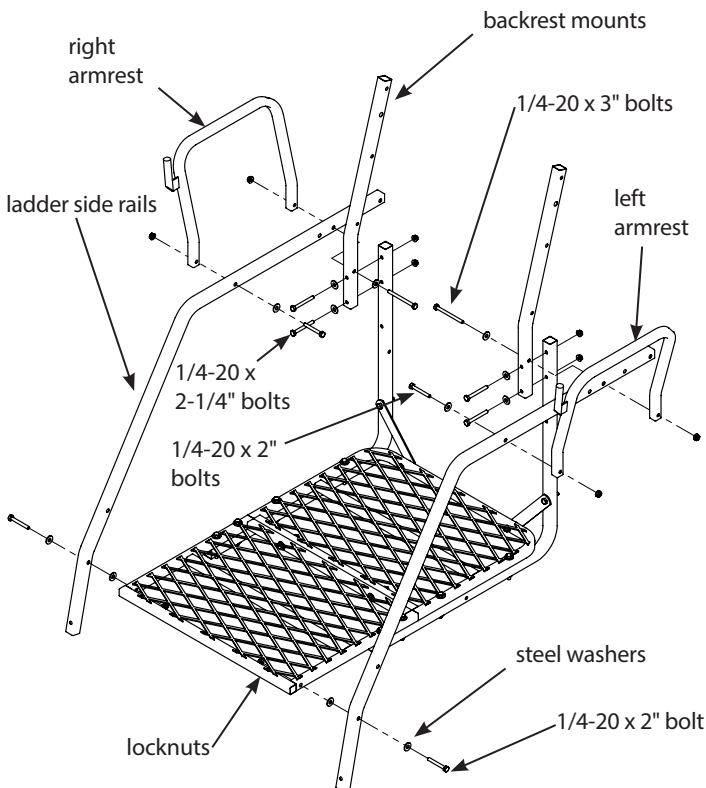

Figure 3

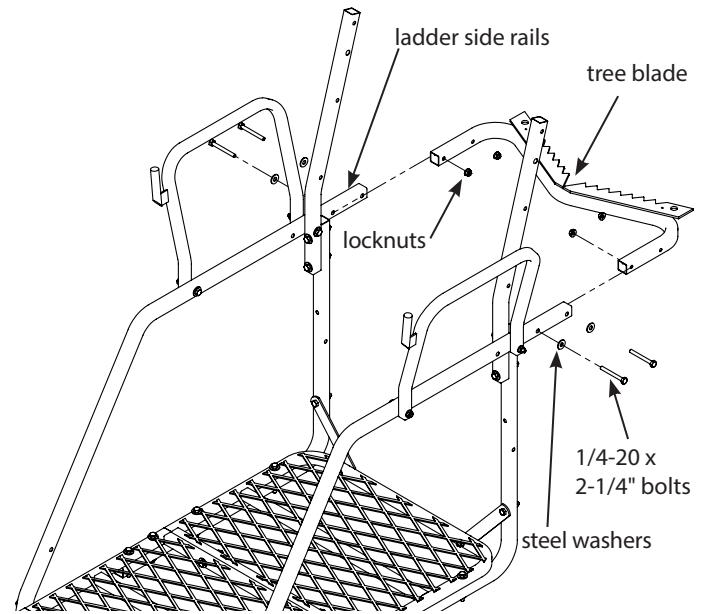

Figure 4

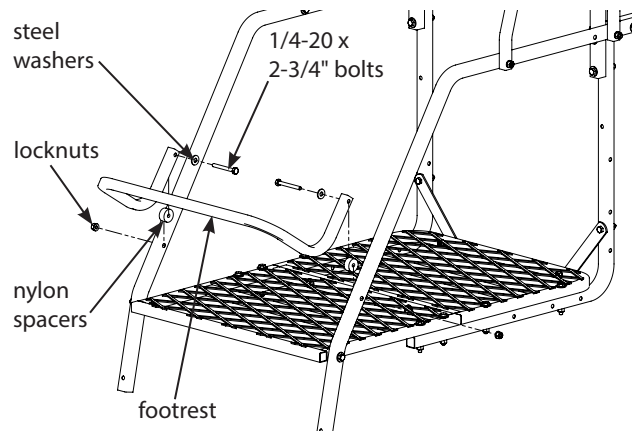

Figure 5

SEAT ASSEMBLY

8. a. Position the factory assembled mesh seat (360018) upside down on a sturdy, hard surface. **SEE FIGURE 6.**

b. Insert (1) 1/4-20 x 2-3/4" bolt through the rear fixed brace (410122) and side rail of mesh seat. Finger tighten locknut (rear fixed brace locknuts will need to be removed in order to attach finished seat to treestand later in assembly instructions). **SEE FIGURE 7.**

NOTE: The rear fixed brace is meant to be wider than the seat. The TearTuff material is extremely durable and is meant to stretch. SEE FIGURE 7.

c. Angle the other side rail so it is outside of the rear fixed brace to align the bolt holes. **SEE FIGURE 8a.** Insert (1) 1/4-20 x 2-3/4" bolt through the rear fixed brace and side rail (bolt will enter at an angle). **SEE FIGURE 8b.** Finger tighten locknut to aid in further assembly. **SEE FIGURE 8c.**

d. Rotate the rear fixed brace towards the seat to lock the brace in position. **SEE FIGURE 9a and 9b.**



FIGURE 8b - Insert 1/4-20 x 2-3/4" bolt



FIGURE 8c - Finger tighten locknut



FIGURE 6 - Factory assembled mesh seat



FIGURE 7 - Insert 1/4-20 x 2-3/4" bolt



FIGURE 9a - Rear fixed brace in vertical position



FIGURE 8a - Angle side rail outside of rear fixed brace

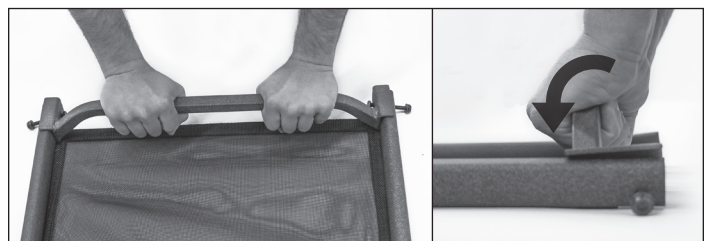

FIGURE 9b - Rear fixed brace rotated into locked position

SEAT ASSEMBLY CONTINUED

e. Remove the factory installed "locking" bolt and locknut from the front hinged brace (410112), and set aside. Hinge the brace slightly to aid in assembly. **SEE FIGURE 10.**

f. Insert (2) 1/4-20 x 1-1/4" bolts through the front hinged brace and each side rail, and finger tighten locknuts. **SEE FIGURE 11.** Brace should remain hinged.

g. Rotate the front hinged brace towards the seat to lock the brace in position. **SEE FIGURES 12a and 12b.**

h. Push down on the front hinged brace and install the previously removed bolt and locknut. **SEE FIGURE 13.**

i. Tighten all (4) bolts and locknuts on the front hinged brace at this time. **SEE FIGURE 14.** This will tighten up the side rails of the seat to the braces and square up the entire seat.

NOTE: The rear fixed brace locknuts will need to be removed in order to attach finished seat and should not be tightened at this time.

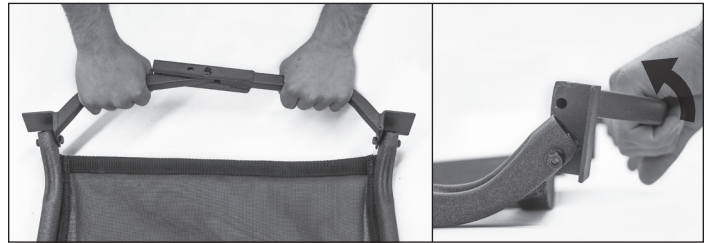

FIGURE 12a - Front hinged brace in vertical position

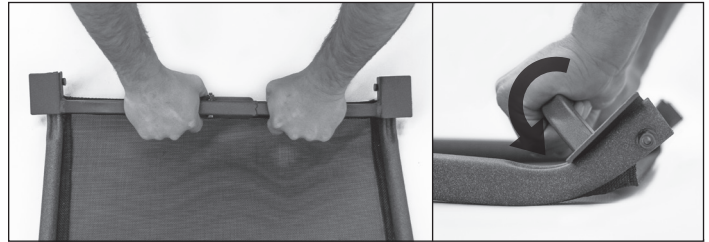

FIGURE 12b - Front hinged brace rotated into locked position

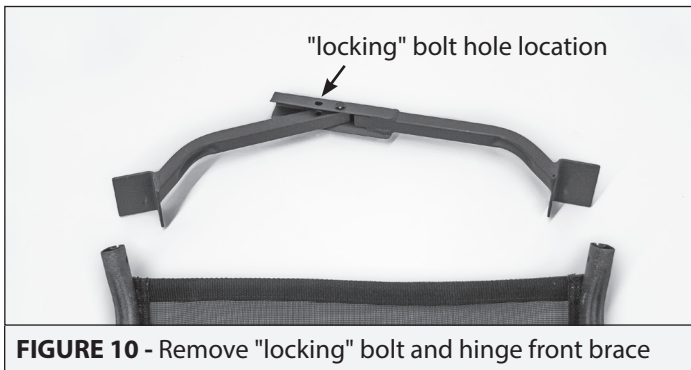

FIGURE 10 - Remove "locking" bolt and hinge front brace

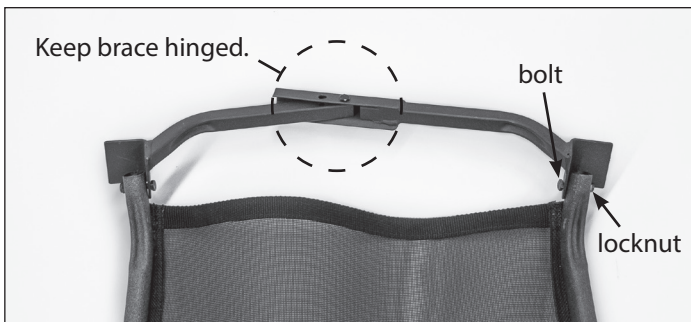

FIGURE 11 - Insert (2) 1/4-20 x 1-1/4" bolts

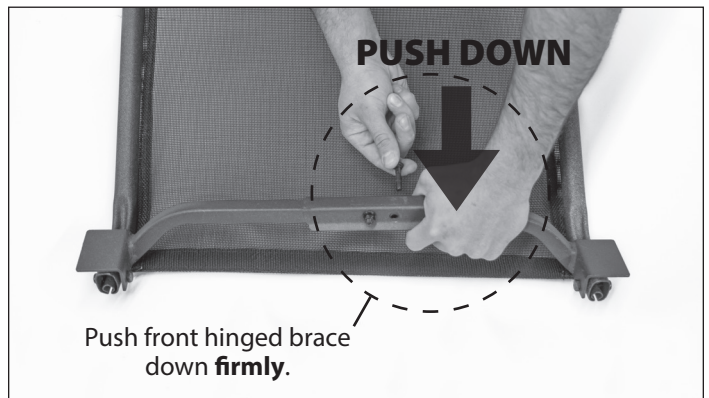

FIGURE 13 - Install previously removed bolt and locknut

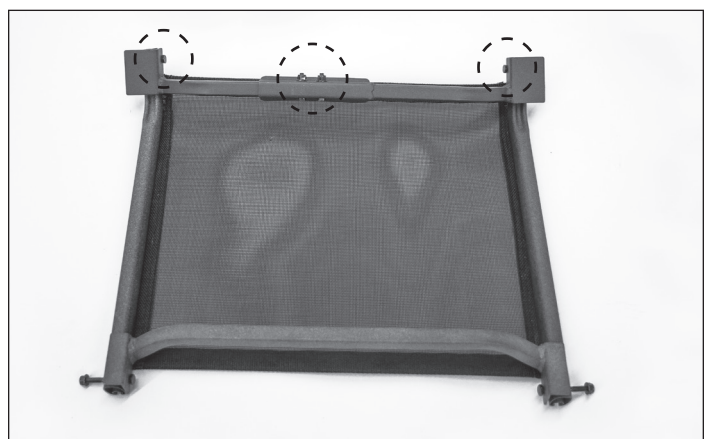

FIGURE 14 - Tighten front brace bolts and locknuts (4)

9. Remove the locknuts from the (2) 1/4-20 x 2-1/4" bolts that were previously attached to the rear of the seat assembly. Continue by attaching the seat assembly to the ladder side rails using (2) provided 1/4-20 x 2-1/4" bolts, locknuts and nylon washers. **SEE FIGURE 15. Make sure all (4) angle brackets are fully cradling fabric rails.**

NOTE: Mesh seat is not depicted in drawing so hardware can be visible.

10. Insert the shooting rail J-pipes (410113) into the shooting rail front (410065) and secure together using (2) provided 1/4-20 x 1-1/4" bolts and locknuts. **SEE FIGURE 16.**

11. Insert the two side rails into the flared rails (410054). Secure using (2) provided 1/4-20 x 1-1/2" bolts, locknuts and steel washers. **SEE FIGURE 17.**

12. Attach the bolt-on ladder step (410034) to the front side of flared rails using (2) provided 1/4-20 x 2-1/4" bolts, locknuts and steel washers. **SEE FIGURE 17.**

13. Attach the mesh backrest assembly (360021) and the (2) retaining bars (410081) to the backrest mounts using (6) provided 1/4-20 x 1-1/2" bolts and locknuts. **SEE FIGURE 18.** The mesh backrest must wrap around the front side of backrest mounts and the plastic stiffening rod located in the sewn sleeve on each side of the backrest **MUST** be positioned behind the backrest retainer bars to act as a stop and prevent the backrest from pulling out during use. All bolts **MUST** go through the backrest retainer bars, the holes provided in the backrest and the backrest mounts. **SEE FIGURE 18.** Temporary removal of the backrest mount tube from the rest of the assembled ladder top may be necessary to attach the mesh backrest. If this is needed, re-attach backrest mount tubes with mesh backrest to the ladder top assembly.

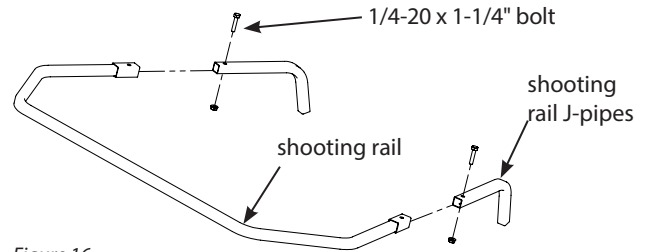

Figure 16

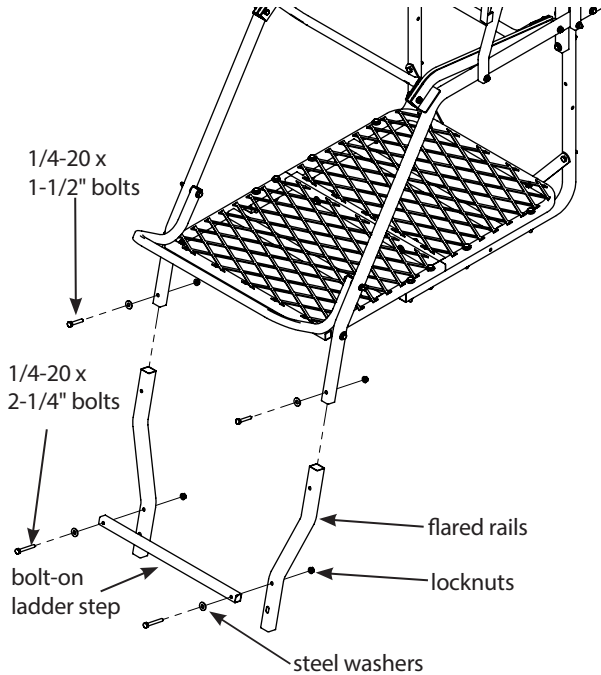

Figure 17

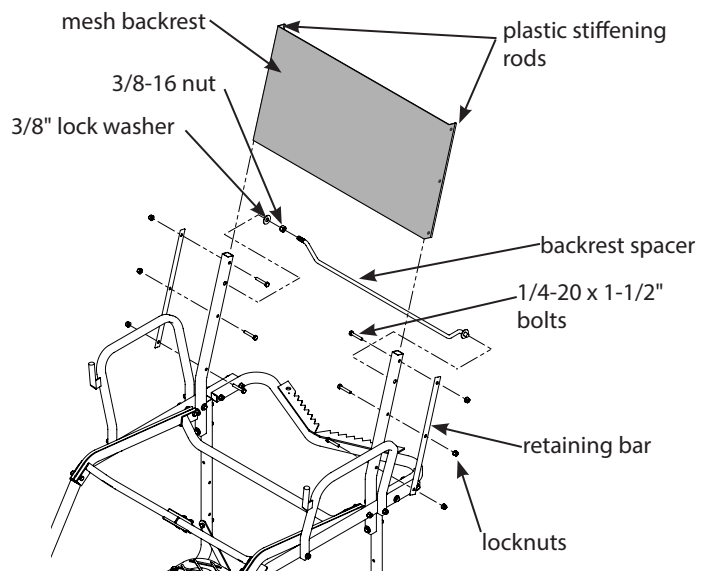

Figure 18

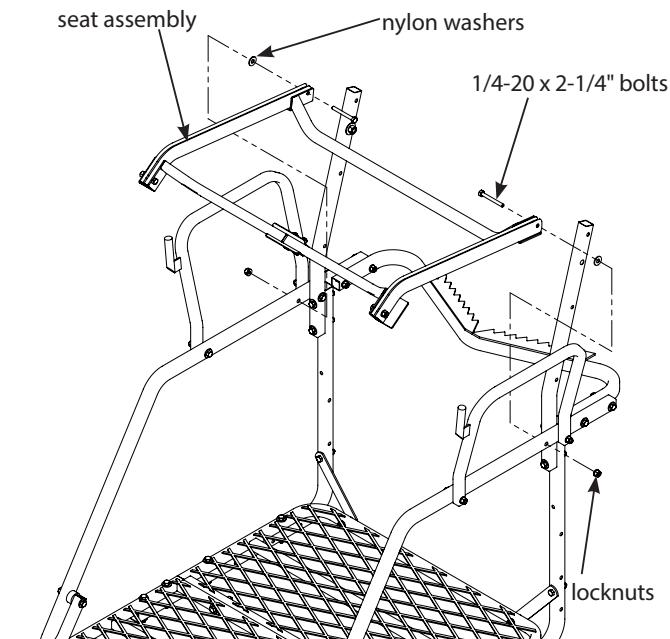

Figure 15

14. Thread the non-locking 3/8-16 nut onto the threaded end of spacer rod all the way to the bottom of threads and slide 3/8" lock washer on. Insert the threaded end of spacer rod through either backrest mount tube far enough to be able to insert the opposite end of spacer rod (end with welded-on washer) into opposite backrest mount tube. Thread 3/8-16 nut back against mount tube. Using a 9/16" wrench, tighten nut until mesh backrest becomes taut. **SEE FIGURE 18. You must now tighten all nut and bolt assemblies. Be sure not to over tighten or crush tubing when tightening!**

15. Sections are assembled on the ground in the following order; bottom section (410066 3-step ladder); second section (410068 3-step ladder with stabilizer bar mount); third section (410069 3-step ladder w/ mounting holes); top section (assembled top platform section). **SEE FINISHED 17' OASIS LADDER.**

16. With all sections assembled together on ground, secure all sections together using (6) provided spring lock pins. Handle of spring lock pin must be put to the outside of ladder side rails. **SEE FIGURE 19.**

17. Attach the (2) support braces (410024) to the inside of platform support rails and outside of top ladder section w/ mounting holes using (4) provided 1/4-20 x 1-1/2" bolts and locknuts. **SEE FIGURE 20. Tighten securely. Be sure not to over tighten or crush tubing when tightening!**

18. a. Attach the removable shooting rail by setting rail down over studs provided on armrests. **SEE FIGURE 21. Lubrication is recommended to prevent binding and noise.**

b. Attach the (2) provided 9" and (1) provided 47" camo foam pads to the armrests and shooting rail by wrapping around tubing and attaching Velcro together.

c. Attach foam padded seat bumpers (48102) to bottom side of front seat spacer assembly. Surface must be clean and at room temperature to assure proper adhesion.

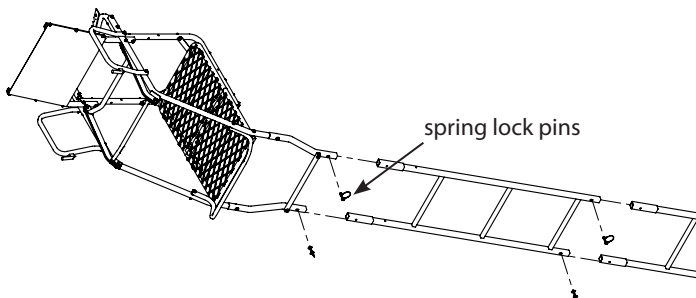

Figure 19

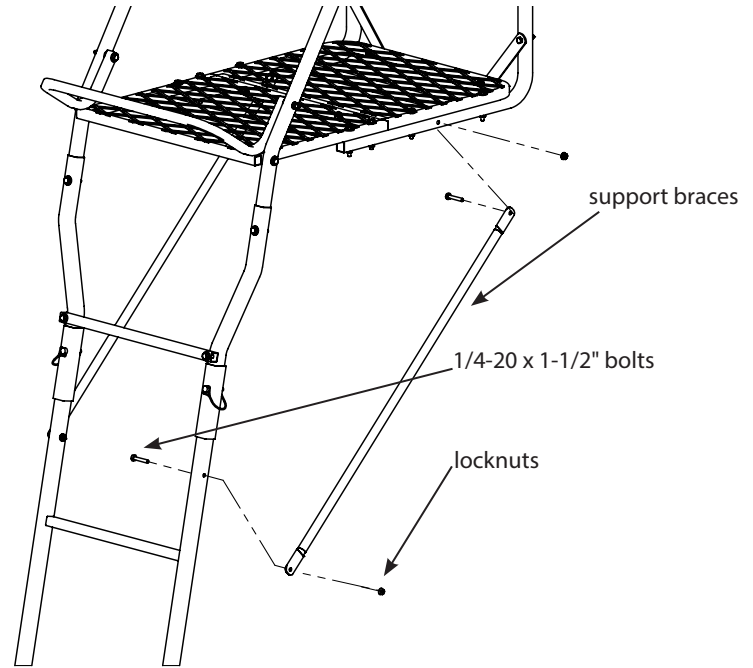

Figure 20

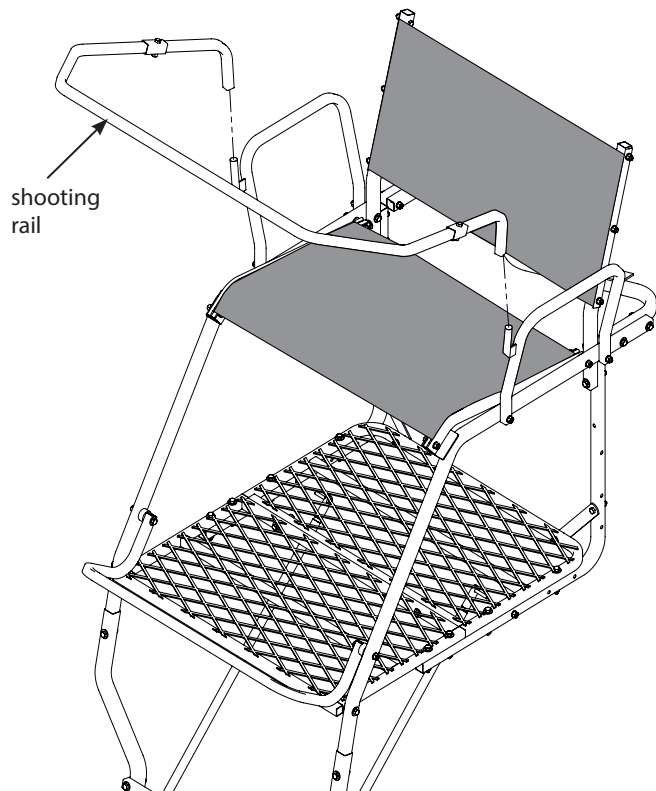

Figure 21

19. a. Attach the stabilizer bar extension tube (1ML23) to the second ladder section mounting bracket using (1) provided spring lock pin. **SEE FIGURE 22.**

b. Slide the stabilizer bar (L17) into the extension tube and attach the two pieces together using (1) provided spring lock pin. Spring lock pin must go through both the extension tube and stabilizer bar at appropriate hole to achieve desired distance from tree. Adjustment in length may be needed when ladder is uprighted later in instructions. **SEE FIGURE 22.**

20. a. Tie one end of the provided 9' rope to the link welded onto the stabilizer bar, just in front of the tree hugger. **Be sure your double knot is secure. SEE FIGURE 23.**

b. Tie one end of each of the provided 15' ropes to the square tube of tree blade frame, just in front of the tree blades. **Be sure your double knots are secure. SEE FIGURE 23.**

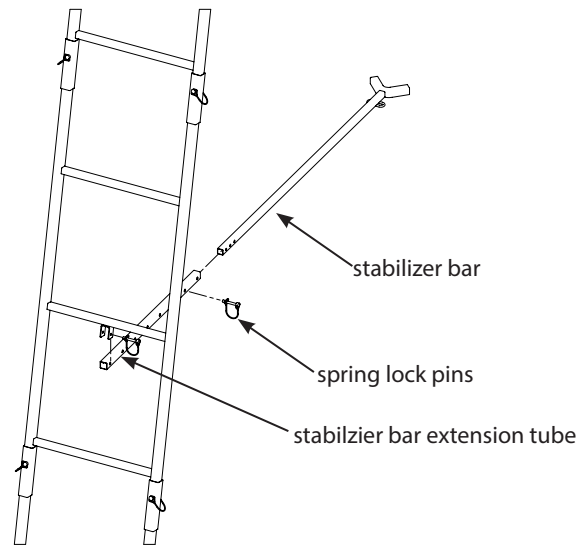

Figure 22

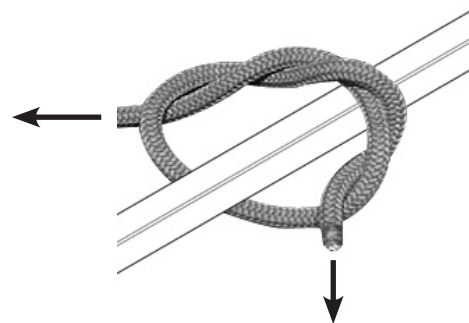
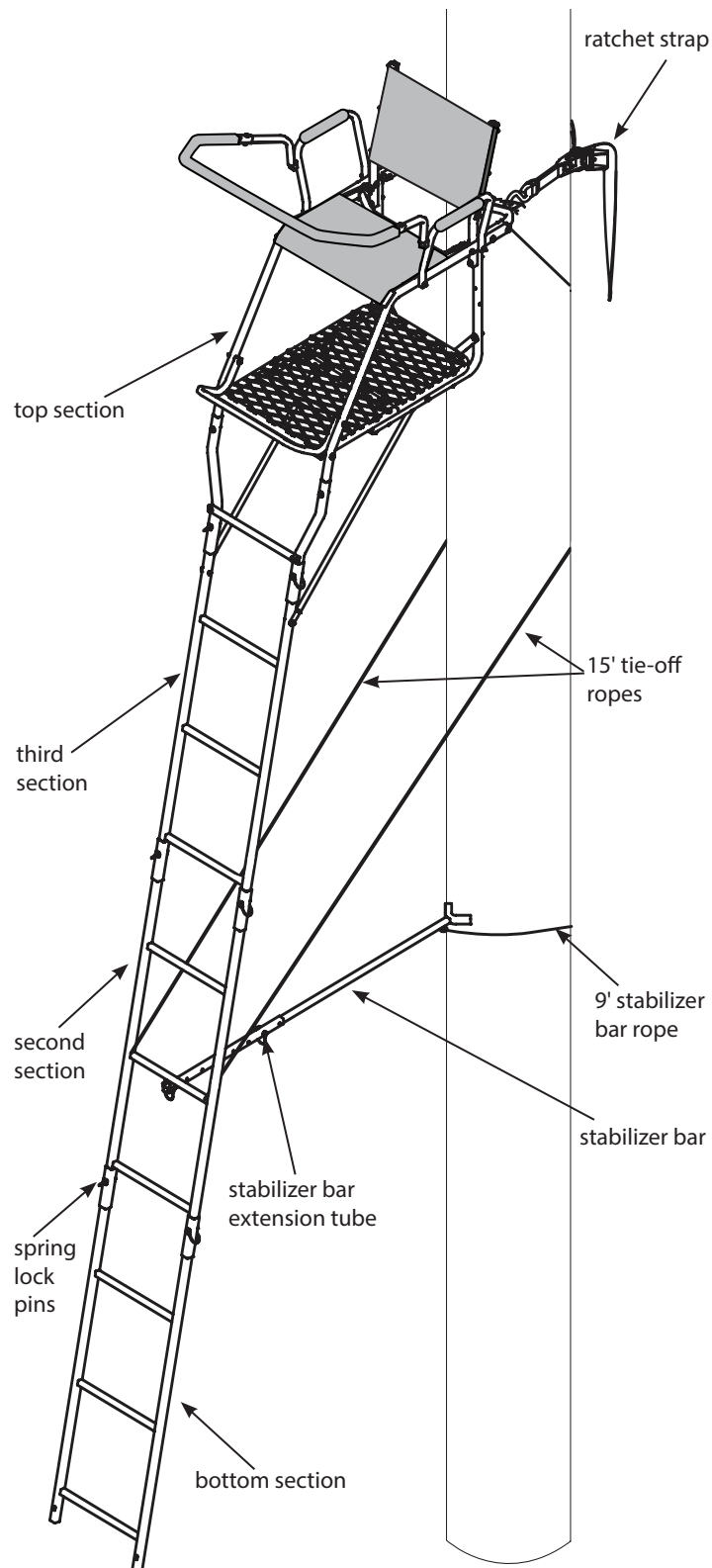
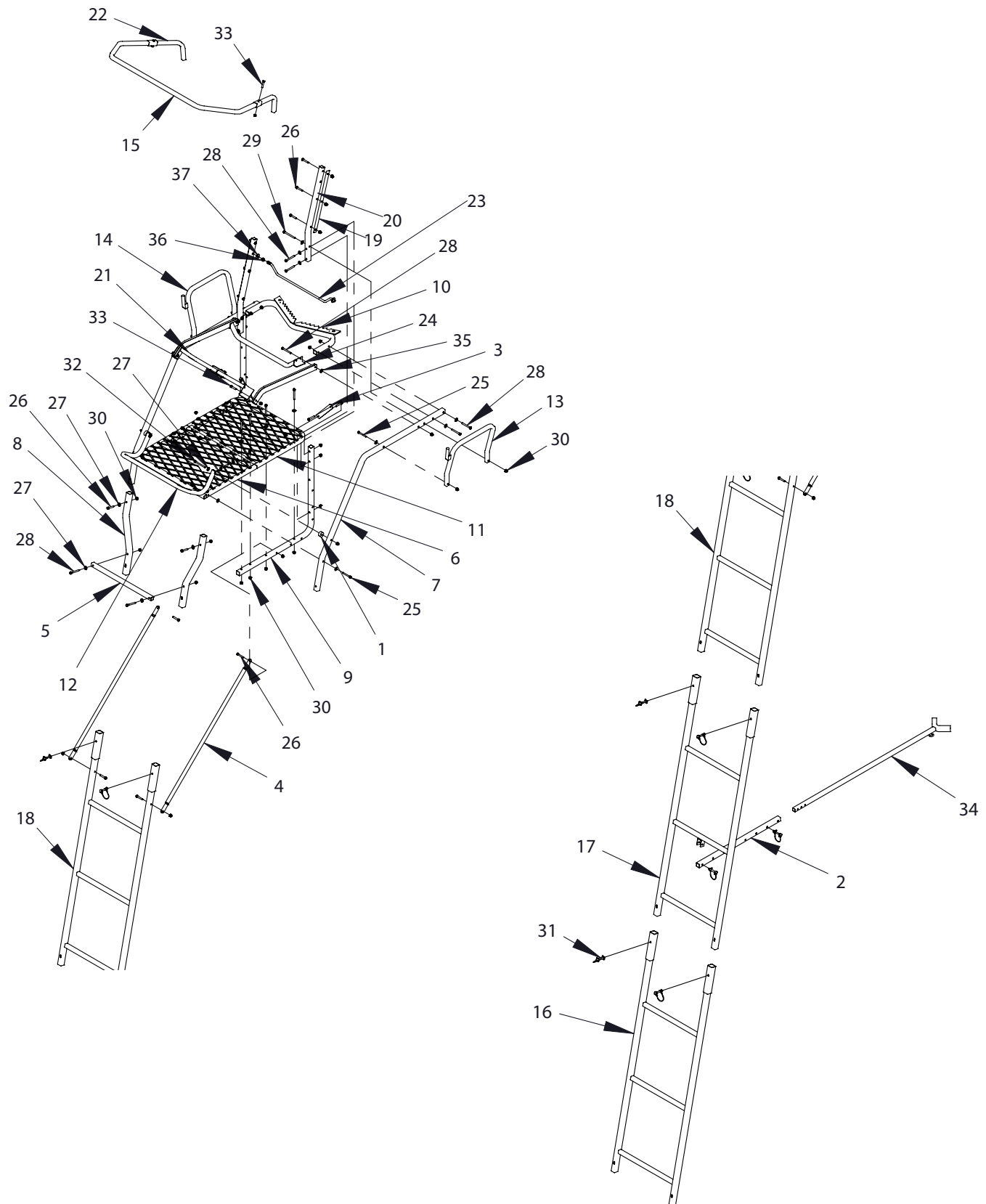

Figure 23

Finished Oasis™ Ladder



RE627 PARTS EXPLOSION



RE627 PARTS LIST

**NO EXTENSIONS AVAILABLE FOR THIS MODEL.
NEVER MODIFY OR EXCEED ORIGINAL STATED USE HEIGHT!**

KEY #	PART #	DESCRIPTION	6Q
1	10347	SPACER NYLON 1/4 X 1 X 1/2	2
2	1ML23	TUBE, STABILIZER, SUPPORT	1
3	1ML40	BRACE, SUPPORT FLAT, TIMBER LADDERS	2
4	410024	BRACE SUPPORT 35.69"	2
5	410034	STEP LADDER 17"	1
6	410050	WELDMENT PLATFORM FRONT 20" X 15"	1
7	410053	RAIL SIDE LADDER	2
8	410054	RAIL SIDE FLARED LADDER	2
9	410055	RAIL PLATFORM SUPPORT	2
10	410056	WELDMENT, TREE BLADE LADDER	1
11	410058	WELDMENT PLATFORM REAR 20" X 15"	1
12	410061	FTS FOOTREST LADDER	1
13	410062L	WELDMENT ARMREST LEFT	1
14	410062R	WELDMENT ARMREST RIGHT	1
15	410065	WELDMENT FTS SHOOTING RAIL	1
16	410066	WELDMENT LADDER 3 STEP	1
17	410068	WELDMENT LADDER W/MOUNT 3 STEP	1
18	410069	WELDMENT LADDER W/HOLES 3 STEP	1
19	410081	STRIP FABRIC MOUNT	2
20	410082	FTS MOUNT BACKREST	2
21	410112	ASSEMBLY SEAT SPACER FRONT	1
22	410113	FTS J PIPE SHOOTING RAIL	2
23	410118	WELDMENT SPACER BACKREST	1
24	410122	WELDMENT SEAT SPACER REAR	1

KEY #	PART #	DESCRIPTION	QTY.
25	48153B	BOLT 1/4-20 X 2 HHCS GR5 BLK ZN	6
26	48240B	BOLT 1/4-20 X 1-1/2 HHCS GR5 BLK ZN	16
27	48261B	WASHER FLAT 1/4" BLACK	32
28	48271B	BOLT 1/4-20 X 2-1/4 HHCS GR5 BLK ZN	20
29	48280B	BOLT 1/4-20 X 3 HHCS GR5 BLK ZN	2
30	48752B	NUT 1/4-20 HFNYLK BLK ZN	50
31	63281	SNAP PIN, 1/4 X 1-3/4, ROUNDED RETAINER	8
32	67540B	BOLT 1/4-20 X 2-3/4 HHCS GR5 BLK ZN	2
33	8909B	BOLT 1/4-20 X 1-1/4 HHCS GR5 BLK ZN	4
34	L17	WELDMENT, STABILIZER BAR	1
35	WN516	WASHER, 5/16", BLACK NYLON	2
36	10755	NUT 3/8-16 HEX BLK ZINC	1
37	719	WASHER 3/8" SPRING LOCK ZINC	1
ITEMS NOT SHOWN			
--	360018	ASSEMBLY SEAT OASIS	1
--	360021	ASSEMBLY BACKREST OASIS	1
--	48415	RATCHET STRAP	1
--	10531	FULL BODY HARNESS (FAS)	1
--	48736	CAMO SLEEVE W/FOAM 9"	2
--	48912	CAMO SLEEVE W/FOAM 47"	1
--	48691	TIE-OFF ROPE KIT (INCLUDES TWO 15' ROPES AND ONE 9' ROPE)	1
--	48102	PAD, BUMPER SEAT	2
--	48800	DVD TREESTAND SAFETY	1

Maximum Height - 17' 2" to shooting rail

Maximum Field Rating - 300 lbs.

Tree Diameter Range - 12" to 20"

ASSEMBLY INSTRUCTIONS (RE628)

Tools needed – two 7/16" wrenches, one 9/16" wrench

IMPORTANT ASSEMBLY TIP: Do not tighten any nut and bolt combinations completely until all parts are assembled together! Finger tighten plus one turn of a wrench only! This will temporarily hold the lock nut on the bolt while helping alignment of all parts! After all parts are assembled together, all nut & bolt combinations must be completely tightened.

1. Attach the front platform (410083) and the rear platform (410086) together using (2) provided 1/4-20 x 2" bolts, locknuts and steel washers. **SEE FIGURE 1. DO NOT tighten all nut and bolt assemblies completely!**

NOTE: Mesh surface of foot platforms should be on top.

2. Attach the platform support rails (410055) to the bottom of assembled foot platforms using (8) provided 1/4-20 x 2-1/4" bolts, locknuts and steel washers. **SEE FIGURE 2.**
3. Attach the platform flat bars (1ML40) to the rear platform and platform support rails using (4) provided 1/4-20 x 1-1/2" bolts and locknuts. **SEE FIGURE 2.**

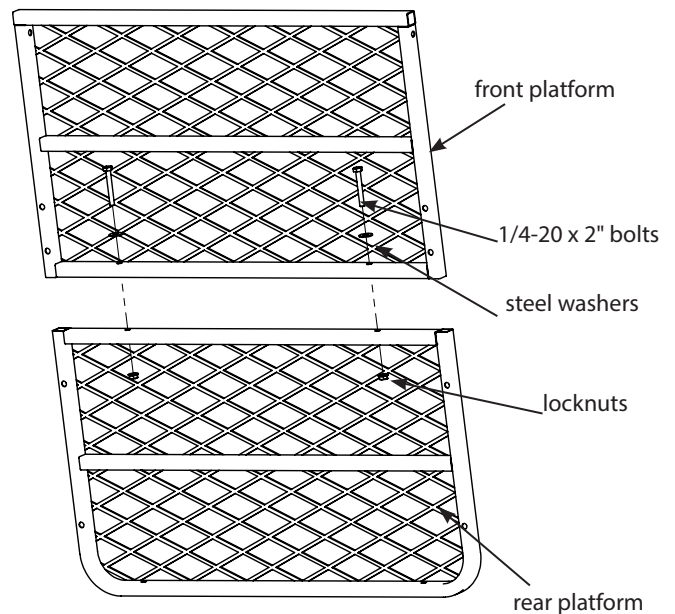

Figure 1

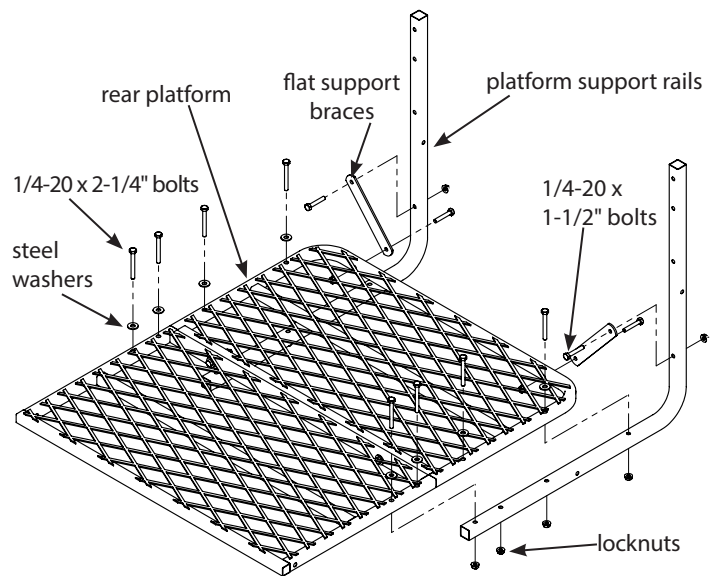

Figure 2

4. Attach the front of the ladder side rails (410053) to the front platform using (2) provided 1/4-20 x 2" bolts (2), locknuts (4) and steel washers. **SEE FIGURE 3.**
5. Attach the left armrest (410062L), right armrest (410062R) and (2) backrest mounts (410082) to the previously assembled ladder side rails and platform support rails using (2) provided 1/4-20 x 2" bolts, (4) 1/4-20 x 2-1/4" bolts, (2) 1/4-20 x 3" bolts, (8) locknuts and (8) steel washers. **SEE FIGURE 3.**
6. Attach the tree blade (410090) to the ladder side rails using (4) provided 1/4-20 x 2-1/4" bolts, locknuts and steel washers. **SEE FIGURE 4.**
7. Attach footrest (410092) to ladder side rails using (2) provided 1/4-20 x 2-3/4" bolts, locknuts, steel washers and nylon spacers. **SEE FIGURE 5.**

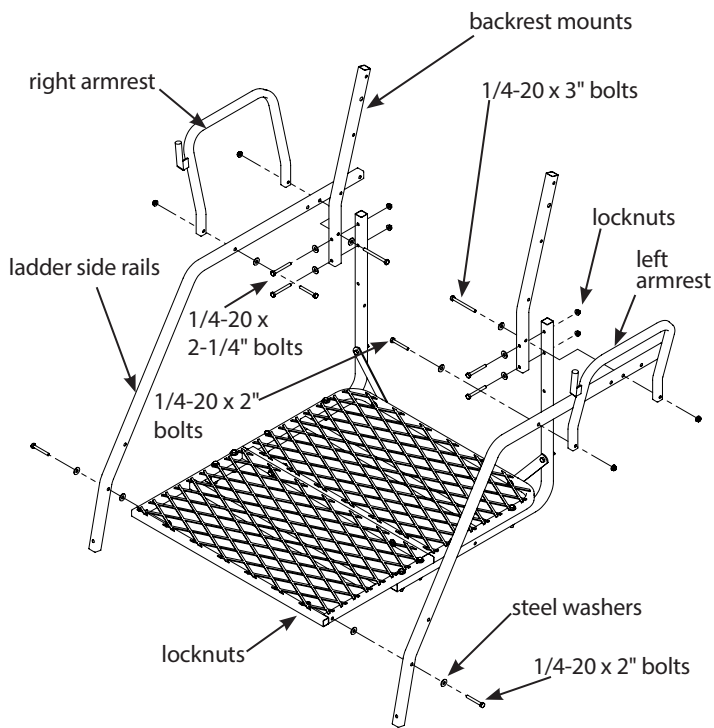

Figure 3

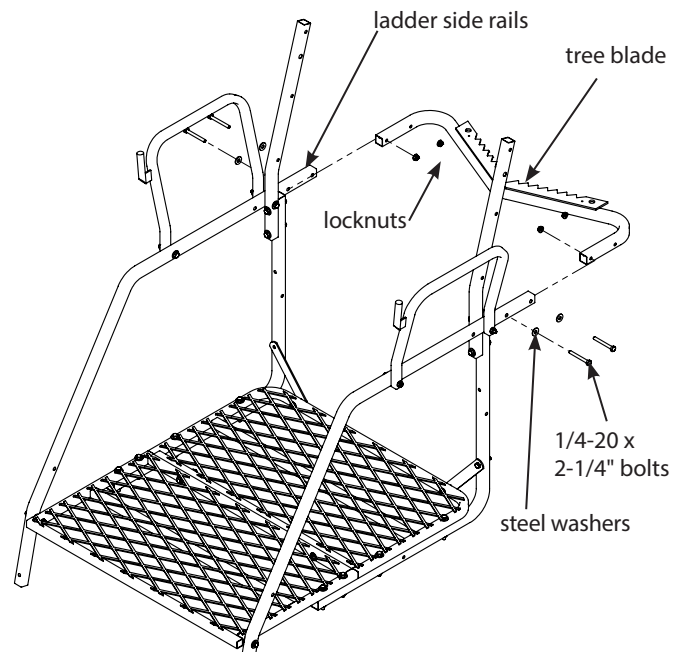

Figure 4

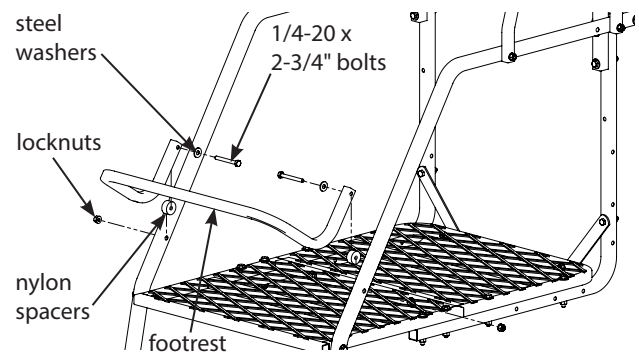

Figure 5

SEAT ASSEMBLY

8. a. Position the factory assembled mesh seat (360019) upside down on a sturdy, hard surface. **SEE FIGURE 6.**

b. Insert (1) 1/4-20 x 2-3/4" bolt through the rear fixed brace (410127) and side rail of mesh seat. Finger tighten locknut (rear fixed brace locknuts will need to be removed in order to attach finished seat to treestand later in assembly instructions). **SEE FIGURE 7.**

NOTE: The rear fixed brace is meant to be wider than the seat. The TearTuff material is extremely durable and is meant to stretch. SEE FIGURE 7.

c. Angle the other side rail so it is outside of the rear fixed brace to align the bolt holes. **SEE FIGURE 8a.** Insert (1) 1/4-20 x 2-3/4" bolt through the rear fixed brace and side rail (bolt will enter at an angle). **SEE FIGURE 8b.** Finger tighten locknut to aid in further assembly. **SEE FIGURE 8c.**

d. Rotate the rear fixed brace towards the seat to lock the brace in position. **SEE FIGURE 9a and 9b.**



FIGURE 8b - Insert 1/4-20 x 2-3/4" bolt



FIGURE 8c - Finger tighten locknut



FIGURE 6 - Factory assembled mesh seat

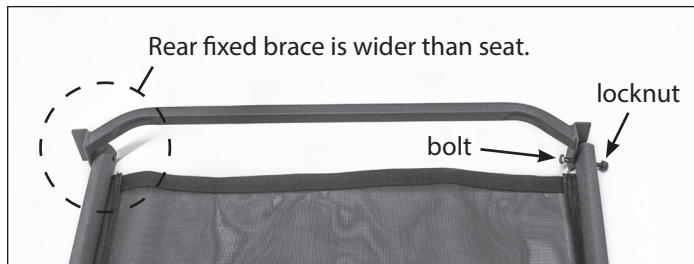

FIGURE 7 - Insert 1/4-20 x 2-3/4" bolt



FIGURE 9a - Rear fixed brace in vertical position



FIGURE 8a - Angle side rail outside of rear fixed brace



FIGURE 9b - Rear fixed brace rotated into locked position

SEAT ASSEMBLY CONTINUED

e. Remove the factory installed "locking" bolt and locknut from the front hinged brace (410115), and set aside. Hinge the brace slightly to aid in assembly. **SEE FIGURE 10.**

f. Insert (2) 1/4-20 x 1-1/4" bolts through the front hinged brace and each side rail, and finger tighten locknuts. **SEE FIGURE 11.** Brace should remain hinged.

g. Rotate the front hinged brace towards the seat to lock the brace in position. **SEE FIGURES 12a and 12b.**

h. Push down on the front hinged brace and install the previously removed bolt and locknut. **SEE FIGURE 13.**

i. Tighten all (4) bolts and locknuts on the front hinged brace at this time. **SEE FIGURE 14.** This will tighten up the side rails of the seat to the braces and square up the entire seat.

NOTE: The rear fixed brace locknuts will need to be removed in order to attach finished seat and should not be tightened at this time.



FIGURE 12a - Front hinged brace in vertical position

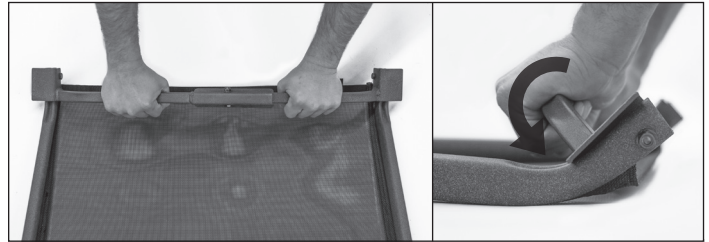

FIGURE 12b - Front hinged brace rotated into locked position

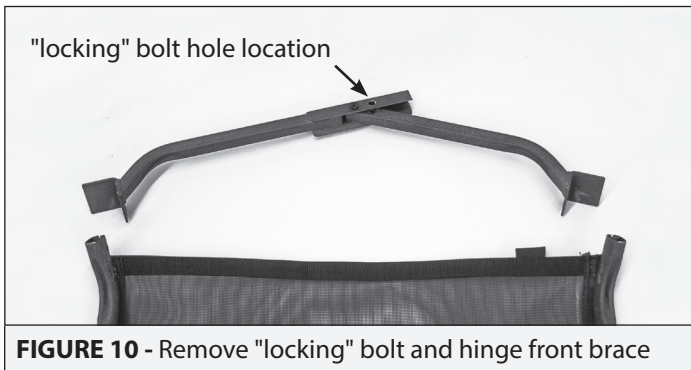

FIGURE 10 - Remove "locking" bolt and hinge front brace

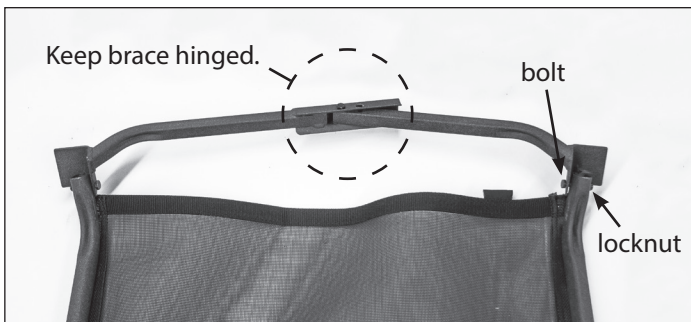

FIGURE 11 - Insert (2) 1/4-20 x 1-1/4" bolts

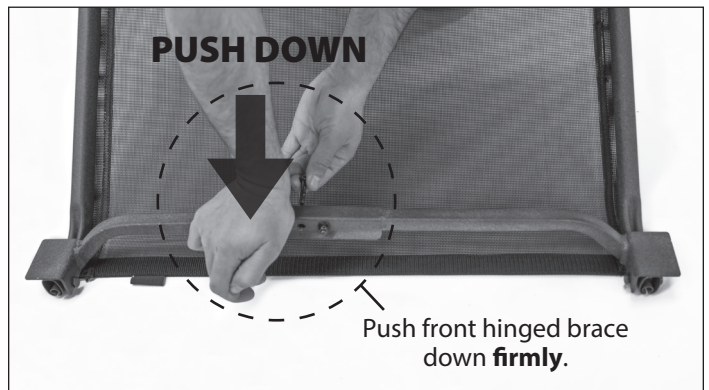

FIGURE 13 - Install previously removed bolt and locknut



FIGURE 14 - Tighten front brace bolts and locknuts (4)

9. Remove the locknuts from the (2) 1/4-20 x 2-1/4" bolts that were previously attached to the rear of the seat assembly. Continue by attaching the seat assembly to the ladder side rails using (2) provided 1/4-20 x 2-1/4" bolts, locknuts and nylon washers. **SEE FIGURE 15. Make sure all (4) angle brackets are fully cradling fabric rails.**
10. Insert the shooting rail J-pipes (410113) into the shooting rail front (410093) and secure together using (2) provided 1/4-20 x 1-1/4" bolts and locknuts. **SEE FIGURE 16.**
11. Insert the two side rails into the flared rails (410089). Secure using (2) provided 1/4-20 x 1-1/2" bolts, locknuts and steel washers. **SEE FIGURE 17.**
12. Attach the bolt-on ladder step (410034) to the front side of flared rails using (2) provided 1/4-20 x 2-1/4" bolts, locknuts and steel washers. **SEE FIGURE 17.**
13. Attach the mesh backrest (360022) and the (2) retaining bars (410081) to the backrest mounts using (6) provided 1/4-20 x 1-1/2" bolts and locknuts. **SEE FIGURE 18.** The mesh backrest must wrap around the front side of backrest mounts and the plastic stiffening rod located in the sewn sleeve on each side of the backrest **MUST** be positioned behind the backrest retainer bars to act as a stop and prevent the backrest from pulling out during use. All bolts **MUST** go through the backrest retainer bars, the holes provided in the backrest and the backrest mounts. **SEE FIGURE 18.** Temporary removal of the backrest mount tube from the rest of the assembled ladder top may be necessary to attach the mesh backrest. If this is needed, re-attach backrest mount tubes with mesh backrest to the ladder top assembly.
14. Thread the non-locking 3/8-16 nut onto the threaded end of spacer rod all the way to the bottom of threads and slide 3/8" lock washer on. Insert the threaded end of spacer rod through either backrest mount tube far enough to be able to insert the opposite end of spacer rod (end with welded-on washer) into opposite backrest mount tube. Thread 3/8-16 nut back against mount tube. Using a 9/16" wrench, tighten nut until mesh backrest becomes taut. **SEE FIGURE 18. You must now tighten all nut and bolt assemblies. Be sure not to over tighten or crush tubing when tightening!**

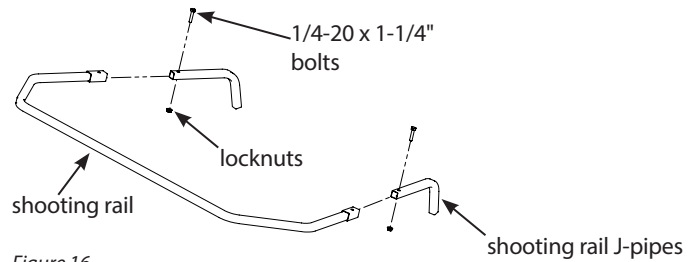
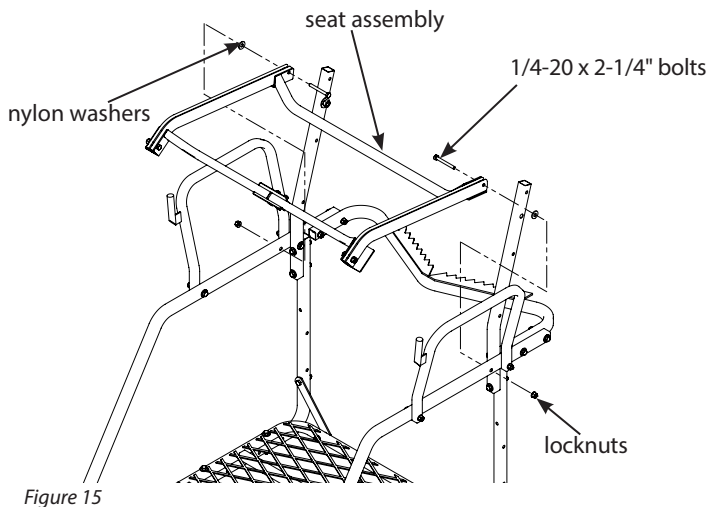

Figure 16

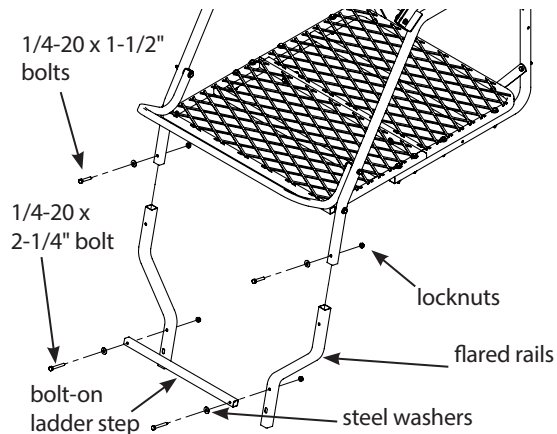

Figure 17

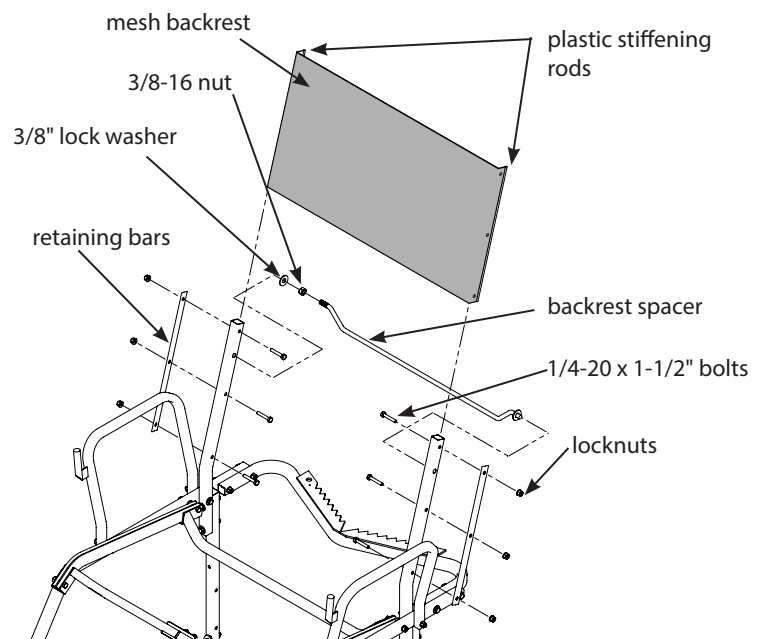

Figure 18

15. Sections are assembled on the ground in the following order; bottom section (410066 3-step ladder); second section (410068 3-step ladder with stabilizer bar mount); third section (410069 3-step ladder w/ mounting holes); top section (assembled top platform section). **SEE FINISHED 17' JUMBO JACK LADDER.**

16. With all sections assembled together on ground, secure all sections together using (6) provided spring lock pins. Handle of spring lock pin must be put to the outside of ladder side rails. **SEE FIGURE 19.**

17. Attach the (2) support braces (410024) to the inside of platform support rails and outside of top ladder section w/ mounting holes using (4) provided 1/4-20 x 1-1/2" bolts and locknuts. **SEE FIGURE 20. Tighten securely. Be sure not to over tighten or crush tubing when tightening!**

18.a. Attach the removable shooting rail by setting rail down over studs provided on armrests **SEE FIGURE 21. Lubrication is recommended to prevent binding and noise.**

b. Attach the (2) provided 9" and (1) provided 54" camo foam pads to the armrests and shooting rail by wrapping around tubing and attaching Velcro together.

c. Attach foam-padded seat bumpers (48102) to bottom side of front seat spacer assembly. Surface must be clean and at room temperature for proper adhesion.

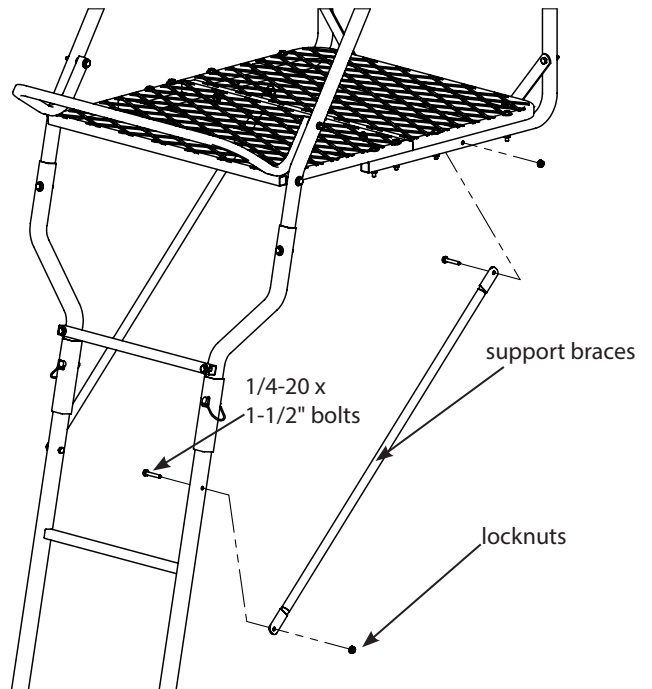

Figure 20

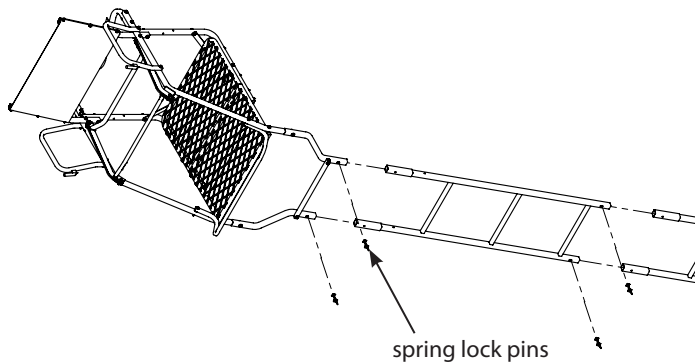

Figure 19

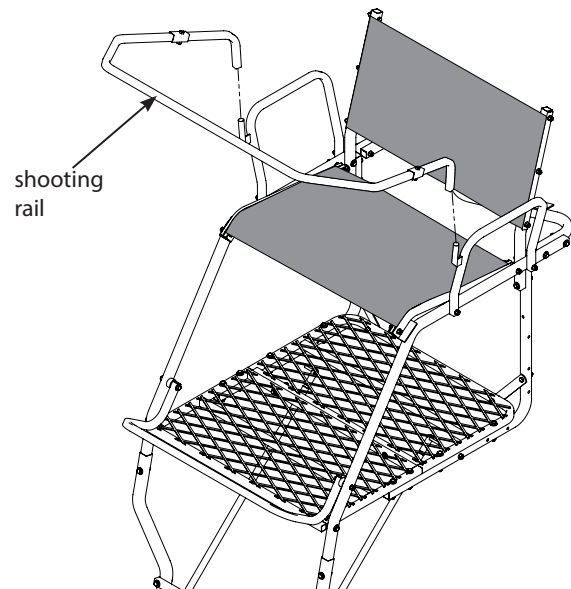

Figure 21

19.a. Attach the stabilizer bar extension tube (1ML23) to the second ladder section mounting bracket using (1) provided spring lock pin. **SEE FIGURE 22.**

b. Slide the stabilizer bar (L17) into the extension tube and attach the two pieces together using (1) provided spring lock pin. Spring lock pin must go through both the extension tube and stabilizer bar at appropriate hole to achieve desired distance from tree. Adjustment in length may be needed when ladder is uprighted later in instructions. **SEE FIGURE 22.**

20.a. Tie one end of the provided 9' rope to the link welded onto the stabilizer bar, just in front of the tree hugger. **Be sure your double knot is secure. SEE FIGURE 23.**

b. Tie one end of each of the provided 15' ropes to the square tube of tree blade frame, just in front of the tree blades. **Be sure your double knots are secure. SEE FIGURE 23.**

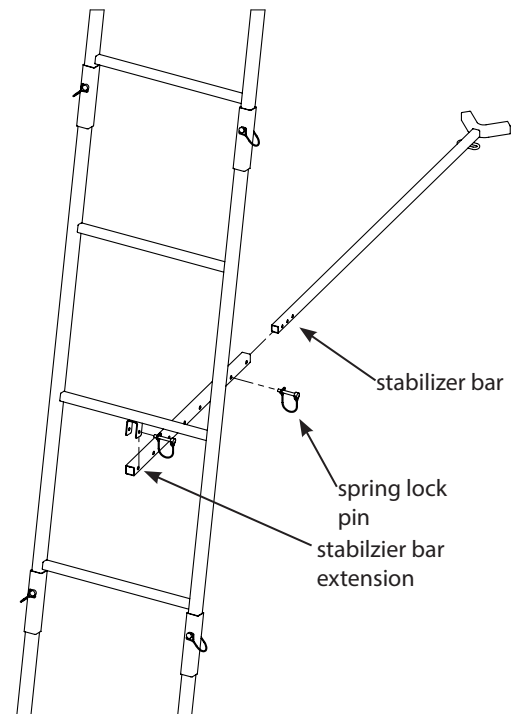

Figure 22

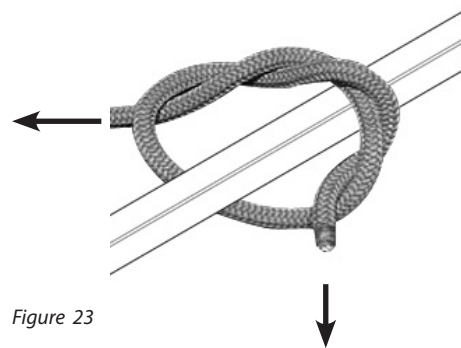
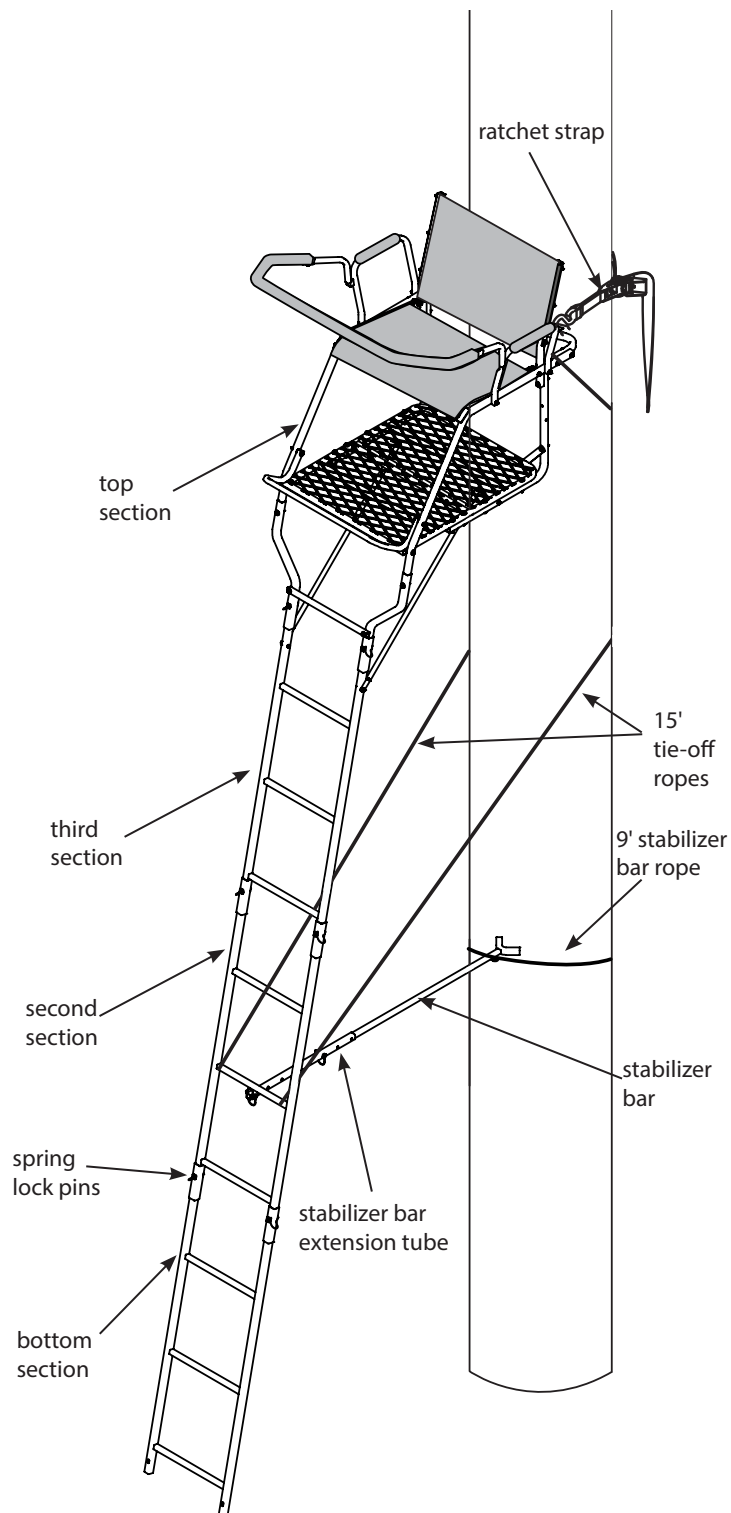
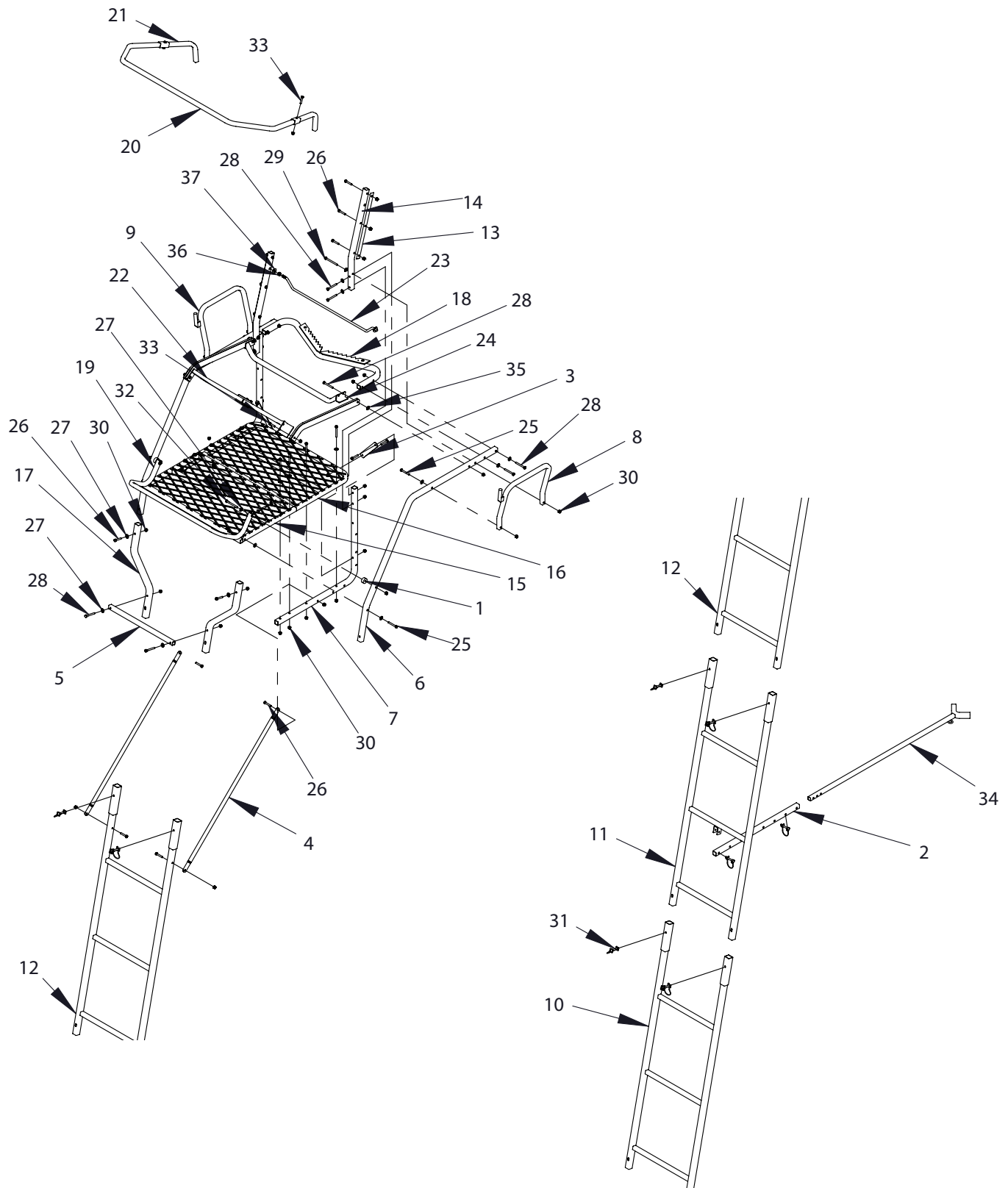

Figure 23

Finished Jumbo Jack™ Ladder



RE628 PARTS EXPLOSION



RE628 PARTS LIST

**NO EXTENSIONS AVAILABLE FOR THIS MODEL.
NEVER MODIFY OR EXCEED ORIGINAL STATED USE HEIGHT!**

KEY #	PART #	DESCRIPTION	QTY.
1	10347	SPACER NYLON 1/4 X 1 X 1/2	2
2	1ML23	TUBE, STABILIZER, SUPPORT	1
3	1ML40	BRACE, SUPPORT FLAT, TIMBER LADDERS	2
4	410024	BRACE SUPPORT 35.69"	2
5	410034	STEP LADDER 17"	1
6	410053	RAIL SIDE LADDER	2
7	410055	RAIL PLATFORM SUPPORT	2
8	410062L	WELDMENT ARMREST LEFT	1
9	410062R	WELDMENT ARMREST RIGHT	1
10	410066	WELDMENT LADDER 3 STEP	1
11	410068	WELDMENT LADDER W/MOUNT 3 STEP	1
12	410069	WELDMENT LADDER W/HOLES 3 STEP	1
13	410081	STRIP FABRIC MOUNT	2
14	410082	FTS MOUNT BACKREST	2
15	410083	WELDMENT PLATFORM FRONT 26" X 15"	1
16	410086	WELDMENT PLATFORM REAR 26" X 15"	1
17	410089	RAIL SIDE FLARED LADDER	2
18	410090	WELDMENT, TREE BLADE LADDER	1
19	410092	FTS FOOTREST LADDER	1
20	410093	WELDMENT FTS SHOOTING RAIL	1
21	410113	FTS J PIPE SHOOTING RAIL	2
22	410115	ASSEMBLY SEAT SPACER FRONT	1
23	410119	WELDMENT SPACER BACKREST	1
24	410127	WELDMENT SEAT SPACER REAR	1

KEY #	PART #	DESCRIPTION	QTY.
25	48153B	BOLT 1/4-20 X 2 HHCS GR5 BLK ZN	6
26	48240B	BOLT 1/4-20 X 1-1/2 HHCS GR5 BLK ZN	16
27	48261B	WASHER FLAT 1/4" BLACK	32
28	48271B	BOLT 1/4-20 X 2-1/4 HHCS GR5 BLK ZN	20
29	48280B	BOLT 1/4-20 X 3 HHCS GR5 BLK ZN	2
30	48752B	NUT 1/4-20 HFNYLK BLK ZN	50
31	63281	SNAP PIN, 1/4 X 1-3/4, ROUNDED RETAINER	8
32	67540B	BOLT 1/4-20 X 2-3/4 HHCS GR5 BLK ZN	2
33	8909B	BOLT 1/4-20 X 1-1/4 HHCS GR5 BLK ZN	4
34	L17	WELDMENT, STABILIZER BAR	1
35	WN516	WASHER, 5/16", BLACK NYLON	2
36	10755	NUT 3/8-16 HEX BLK ZINC	1
37	719	WASHER 3/8" SPRING LOCK ZINC	1
ITEMS NOT SHOWN			
--	360019	ASSEMBLY SEAT JUMBO JACK	1
--	360022	ASSEMBLY BACKREST JUMBO JACK	1
--	48415	RATCHET STRAP	1
--	10531	FULL BODY HARNESS (FAS)	1
--	48736	CAMO SLEEVE W/FOAM 9"	2
--	48913	CAMO SLEEVE W/FOAM 54"	1
--	48691	TIE-OFF ROPE KIT (INCLUDES TWO 15' ROPES AND ONE 9' ROPE)	1
--	48102	PAD, BUMPER SEAT	2
--	48800	DVD TREESTAND SAFETY	1

Maximum Height - 17' 2" to shooting rail

Maximum Field Rating - 300 lbs.

Tree Diameter Range - 12" to 20"

ASSEMBLY INSTRUCTIONS (RE631)

Tools needed – two 7/16" wrenches, Phillips screw driver

IMPORTANT ASSEMBLY TIP: Do not tighten any nut and bolt combinations completely until all parts are assembled together! Finger tighten plus one turn of a wrench only! This will temporarily hold the lock nut on the bolt while helping alignment of all parts! After all parts are assembled together, all nut and bolt combinations must be completely tightened.

1. Attach the tree blade (10373) to the main ladder side rails (10346) using (4) provided 1/4-20 x 2-1/4" bolts, locknuts and steel washers. **SEE FIGURE 1. DO NOT tighten all nut and bolt assemblies completely!**
2. Insert the crimped end of two flared rails (10375) into the main side rails. Secure using (2) provided 1/4-20 x 1-1/2" bolts, locknuts and steel washers. **SEE FIGURE 2.** Pay special attention to orientation of flared rails.

3. Attach the foot platform (10370) to the inside of flared rails using (2) provided 1/4-20 x 2-1/4" bolts, locknuts and steel washers. **SEE FIGURE 2.**

NOTE: Mesh surface of foot platforms should be on top with square ends of platform near flared rails.

- 4 a. Attach the 2-hole (slot) end of upper ladder support tubes (10336) to the bottom side of main side rails using (4) provided 1/4-20 x 2-1/4" Phillips head bolts and locknuts. **SEE FIGURE 3.**
- b. Attach the 1-hole (slot) end of upper ladder support tubes to the backside of flared rails using (2) provided 1/4-20 x 2-1/4" bolts, washers and locknuts. **SEE FIGURE 3.**
- c. Attach the foot platform to the upper ladder support tubes using (2) provided 1/4-20 x 2" bolts, locknuts and steel washers. **SEE FIGURE 3.**

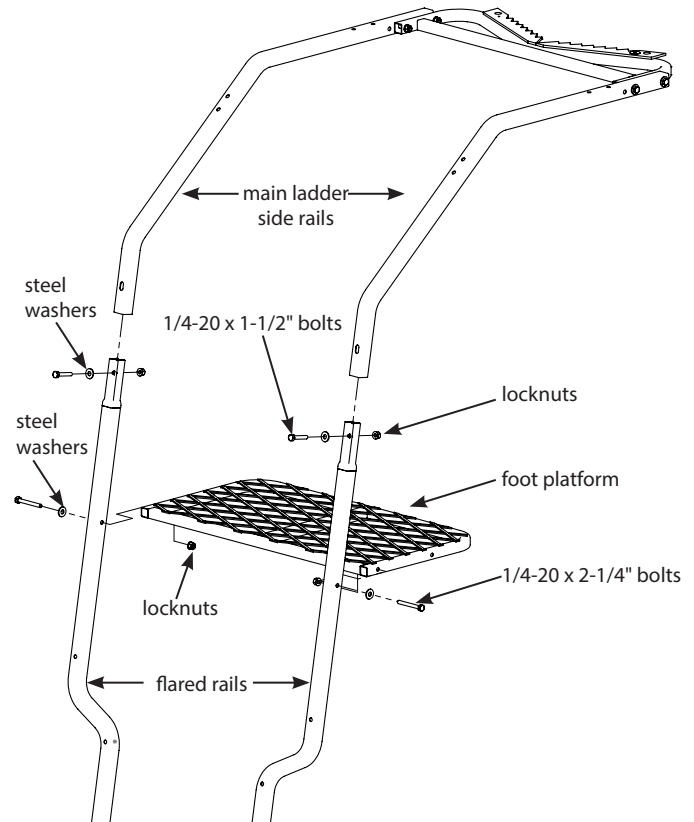

Figure 2

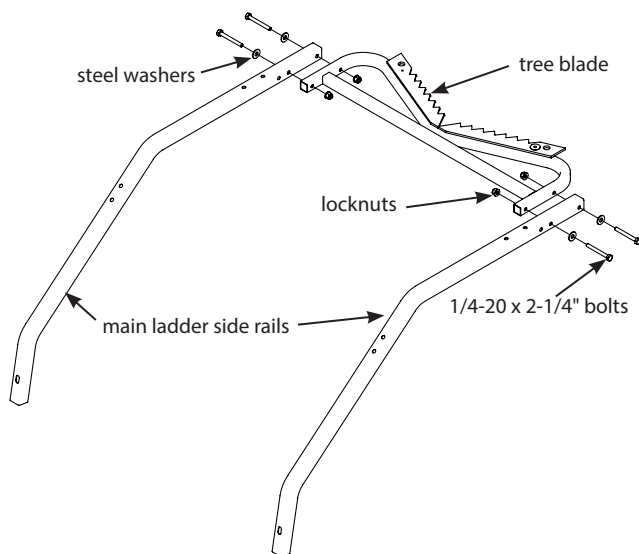

Figure 1

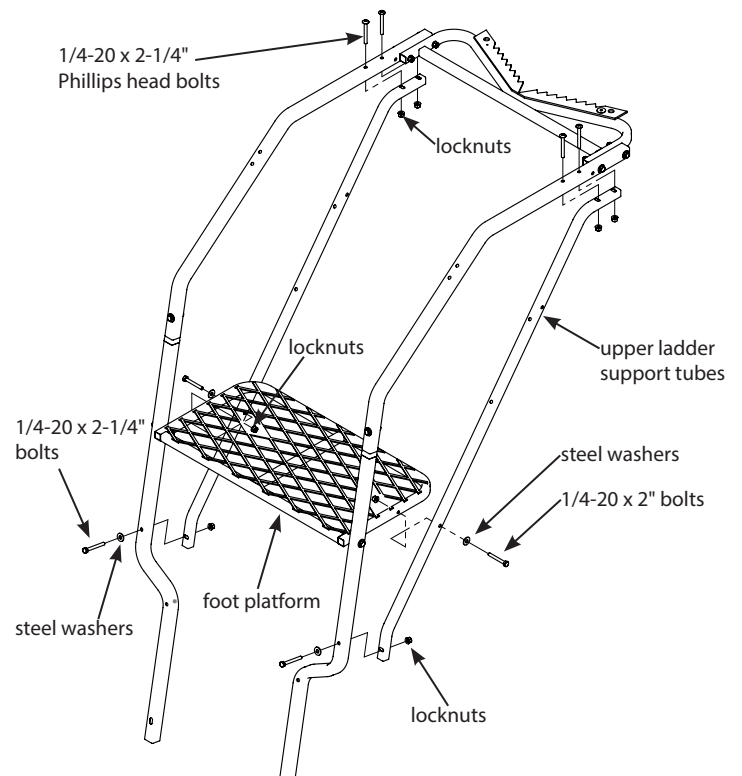

Figure 3

5. Attach the round tube, double flat braces (10377) to the upper ladder support tubes using (4) provided 1/4-20 x 1-1/2" bolts and locknuts. **SEE FIGURE 4.** One double flat brace should be positioned on each side of the upper ladder support tubes for clearance purposes.
6. Attach the bolt-on step (410034) to the front side of flared rails using (2) provided 1/4-20 x 2-1/4" bolts, locknuts and steel washers. **SEE FIGURE 4.**
7. Attach the shooting rail posts (10393) to the main side rails using (4) provided 1/4-20 x 1-3/4" bolts and locknuts. **SEE FIGURE 5.**
8. Insert the shooting rail J-pipes (410113) into the shooting rail rim (10394). Secure together using (2) provided 1/4-20 x 1-1/2" bolts, locknuts and steel washers. **SEE FIGURE 6.** You must now tighten all nut and bolt assemblies. **Be sure not to over tighten or crush tubing when tightening!**
9. Attach the factory assembled mesh seat with seat rails (10549) to the previously assembled upper ladder stand assembly.
 - a. Using (2) provided 1/4-20 x 2-1/2" bolts, locknuts and steel washers, attach the upper portion of each seat rail to the main side rails. **SEE FIGURE 7.** It is important to have the bolt head on the seat rail side and the locknut on the main side rail side for ease of assembly. **FINGER TIGHTEN THESE TWO BOLTS ONLY AT THIS TIME.**
 - b. Using (2) provided 1/4-20 x 2-1/4" bolts, locknuts and steel washers, attach the lower portion of each seat rail to the upper ladder support tubes. **SEE FIGURE 7.** It is important to have the bolt head on the seat rail side and the locknut on the upper ladder support tube side for ease of assembly.
 - c. Alternately tighten all four nut/bolt assemblies from steps 9a and 9b. The spanned mesh seat will become tighter as you tighten each nut/bolt assembly. Tighten until all steel tubular components are tight to each other, locking feature of nuts are fully engaged by bolt threads and spanned mesh seat is taut. **Be sure not to over tighten or crush tubing when tightening!**

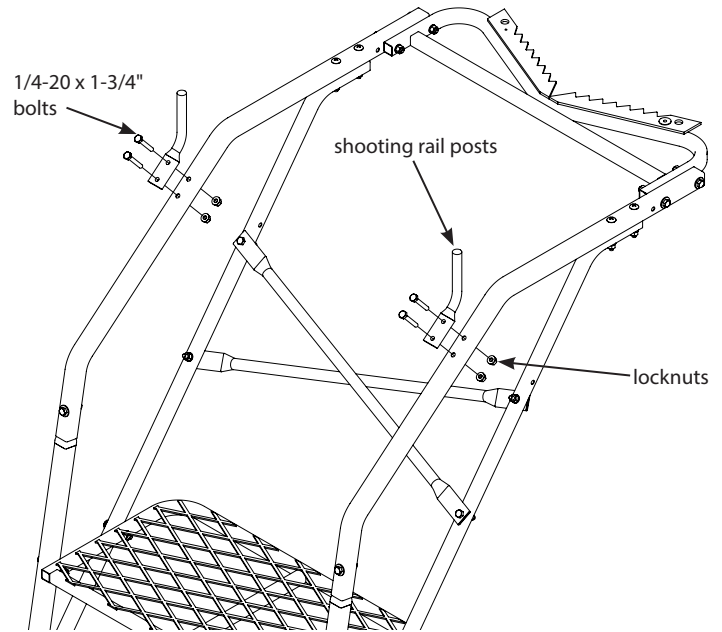

Figure 5

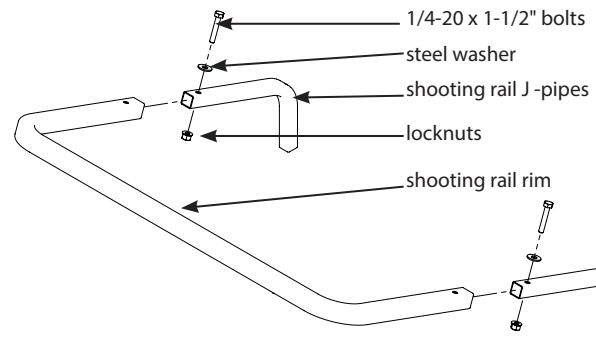

Figure 6

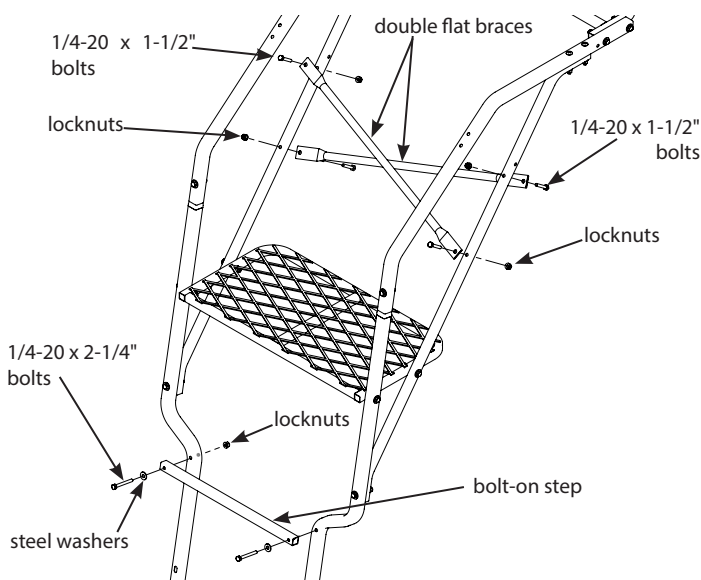

Figure 4

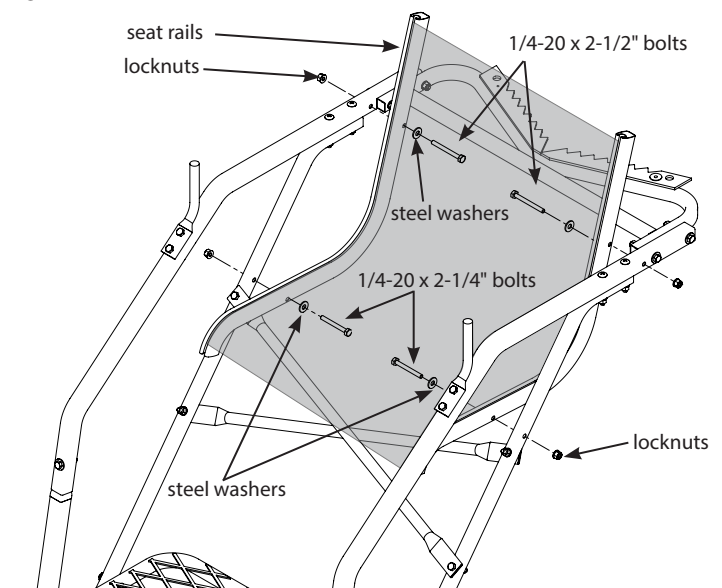

Figure 7

10. Sections are assembled on the ground in the following order; bottom section (410044 base extension); second section (10468 3-step ladder); third section (10470 3-step ladder w/ stabilizer bar mount); fourth section (10468 3-step ladder); top section (assembled top platform section). **SEE FINISHED RELAX WIDE LADDER.**

11. With all sections assembled together on ground, secure all sections together using (8) provided spring lock pins. Handle of spring lock pin must be put to the outside of ladder side rails. **SEE FIGURE 8.**

12. a. Attach the removable shooting rail by setting rail down over the bolt-on posts. **SEE FIGURE 9.** Lubrication is recommended to prevent binding and noise.

b. Attach the (2) provided 9" and (1) provided 18" camo foam pads to the main side rails (armrests) and shooting rail by wrapping around tubing and attaching Velcro together.

13. a. Attach the stabilizer bar extension tube (1ML23) to the second ladder section mounting bracket using (1) provided spring lock pin. **SEE FIGURE 10.**

b. Slide the stabilizer bar (L17) into the extension tube and attach the two pieces together using (1) provided spring lock pin. Spring lock pin must go through both the extension tube and stabilizer bar at appropriate hole to achieve desired distance from tree. Adjustment in length may be needed when ladder is uprighted later in instructions. **SEE FIGURE 10.**

14. a. Tie one end of the provided 9' rope to the link welded onto the stabilizer bar, just in front of the tree hugger. Be sure your double knots are secure. **SEE FIGURE 11.**

b. Tie one end of each of the provided 15' ropes to the square tube of tree blade frame, just in front of the tree blades. Be sure your double knots are secure. **SEE FIGURE 11.**

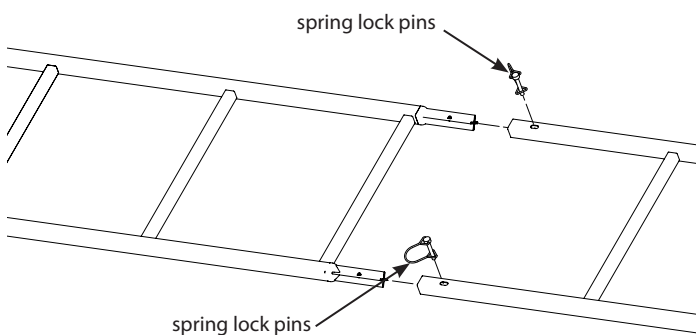

Figure 8

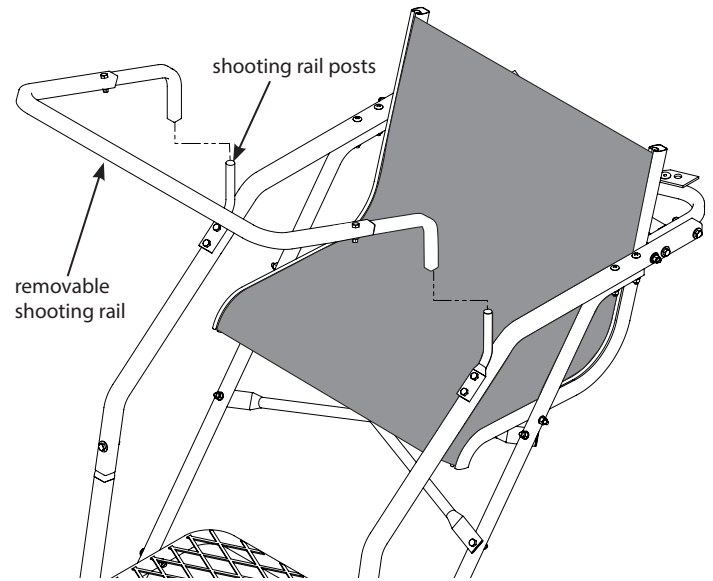

Figure 9

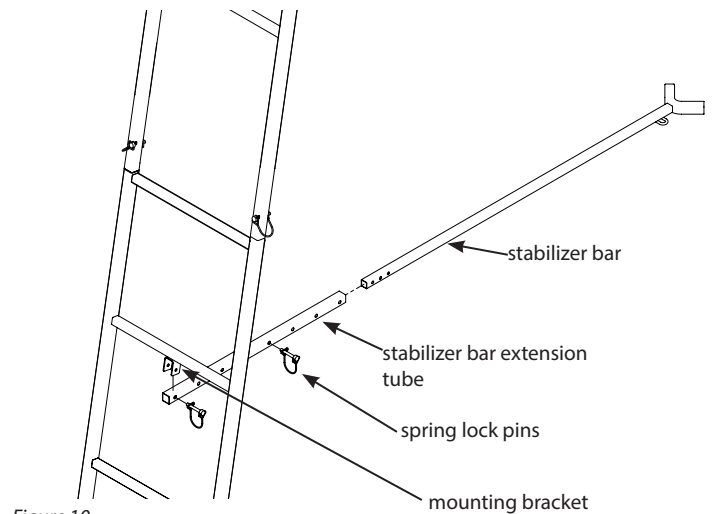

Figure 10

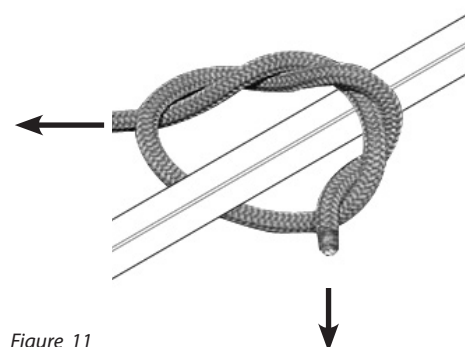
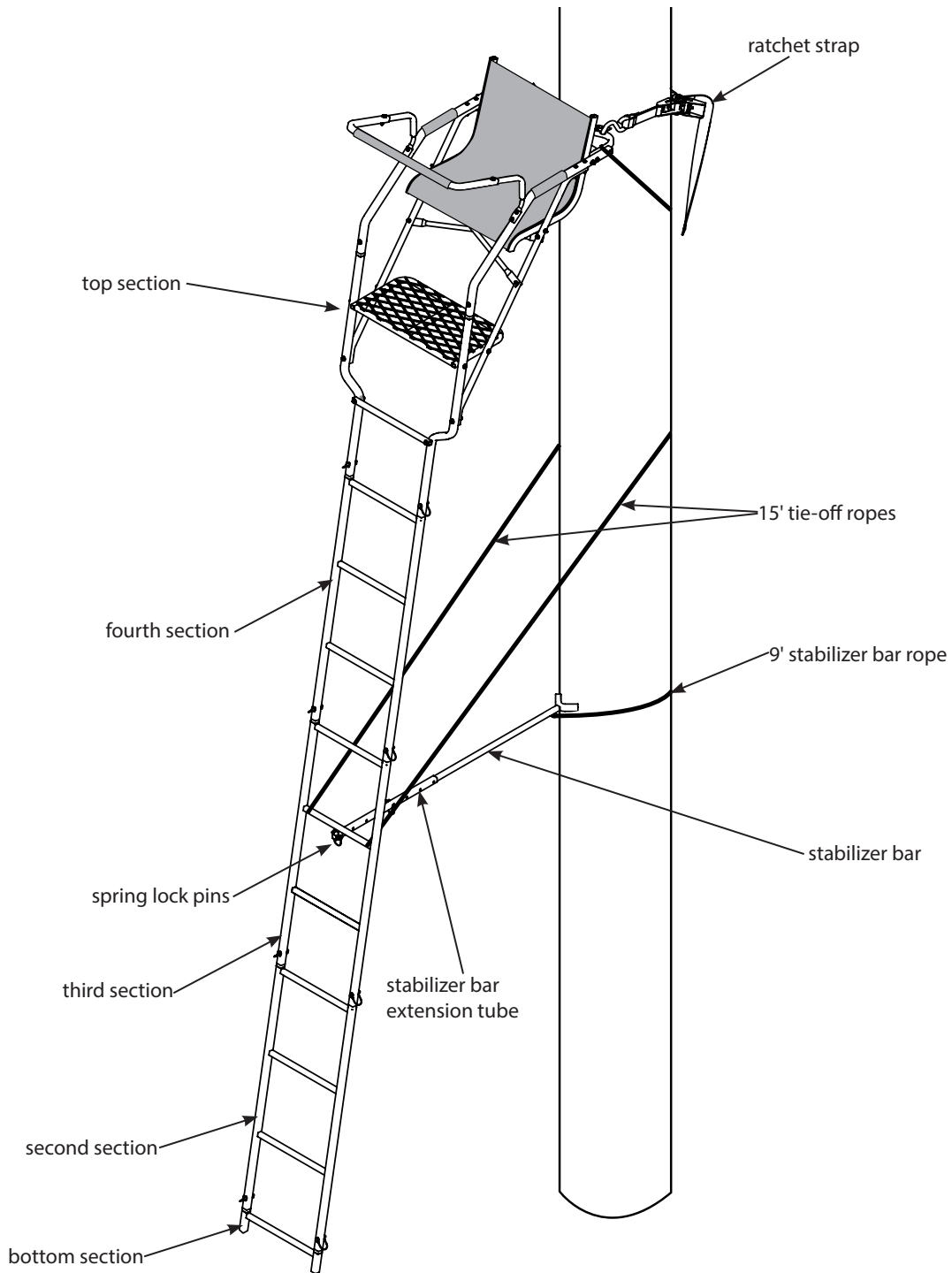
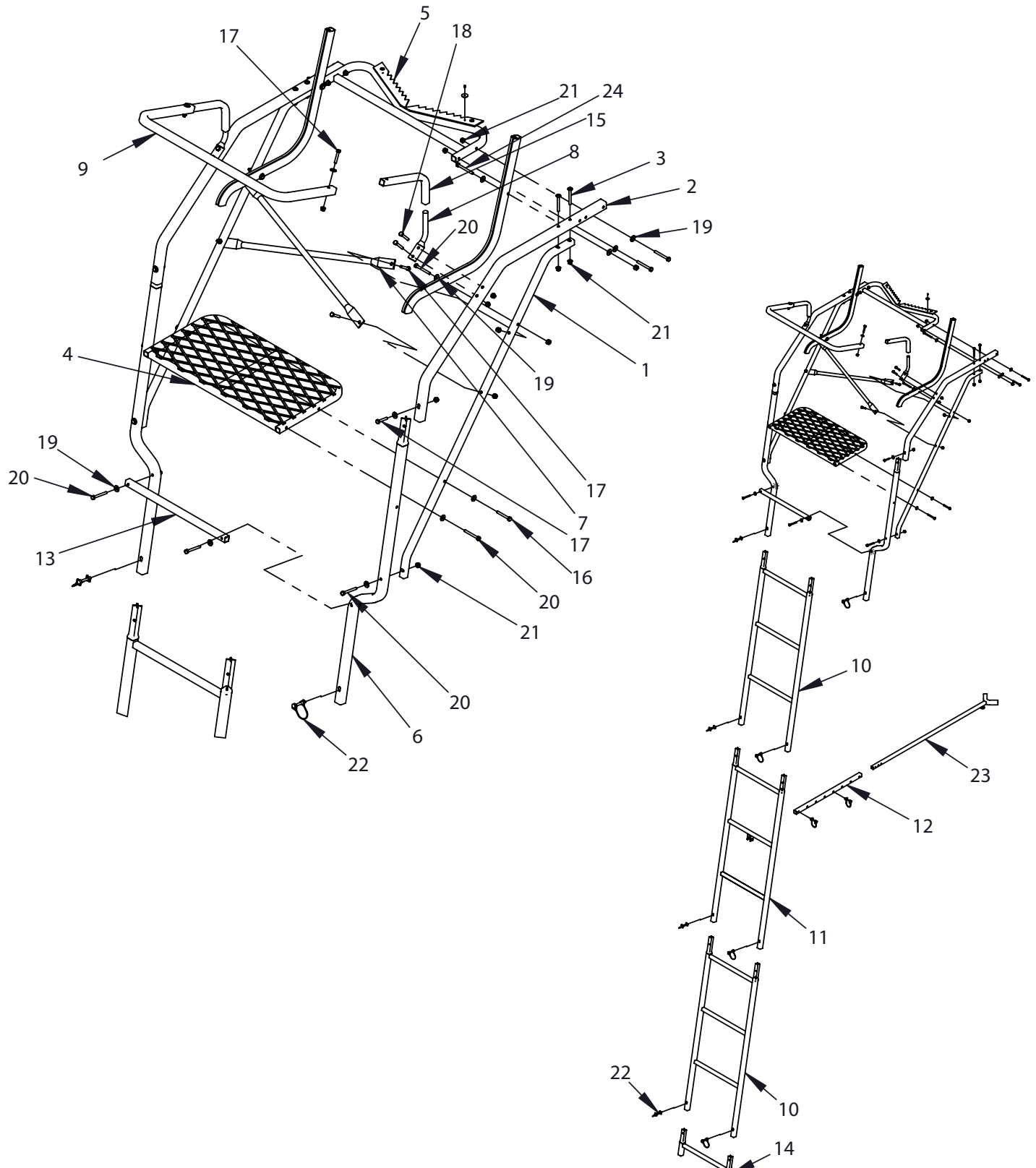

Figure 11

Finished Relax™ Wide Ladder



RE631 PARTS EXPLOSION



RE631 PARTS LIST

**NO EXTENSIONS AVAILABLE FOR THIS MODEL.
NEVER MODIFY OR EXCEED ORIGINAL STATED USE HEIGHT!**

KEY #	PART #	DESCRIPTION	QTY.
1	10336	TUBE BRACE UPPER LADDER SUPPORT	2
2	10346	TUBE RAIL SIDE LADDER	2
3	10368	BOLT 1/4-20 X 2-1/4" PTH GR 5 BLACK ZINC	4
4	10370	WELDMENT PLATFORM 23 1/4 IN X 12 IN	1
5	10373	WELDMENT TREE BLADE LADDER	1
6	10375	RAIL SIDE FLARED LADDER 41.15 IN	2
7	10377	BRACE DOUBLE FLAT 26.04 IN	2
8	10393	POST SHOOTING RAIL	2
9	10394	RIM SHOOTING RAIL	1
10	10468	WELDMENT LADDER 3 STEP PIN STYLE	2
11	10470	WELDMENT LADDER 3 STEP PIN STYLE W/VAM	1
12	1ML23	TUBE, STABILIZER, SUPPORT	1
13	410034	STEP LADDER 17"	1
14	410044	WELDMENT BASE EXTENSION	1
15	410113	FTS J PIPE SHOOTING RAIL	2
16	48153B	BOLT 1/4-20 X 2 HHCS GR5 BLK ZN	2
17	48240B	BOLT 1/4-20 X 1-1/2 HHCS GR5 BLK ZN	8
18	48250B	BOLT 1/4-20 X 1-3/4 HHCS GR5 BLK ZN	4
19	48261B	WASHER FLAT 1/4" BLACK	22
20	48271B	BOLT 1/4-20 X 2-1/4 HHCS GR5 BLK ZN	12
21	48752B	NUT 1/4-20 HFNYLK BLK ZN	32
22	63281	SNAP PIN, 1/4 X 1-3/4, ROUNDED RETAINER	10
23	L17	WELDMENT, STABILIZER BAR	1
24	48270B	BOLT 1/4-20 X 2-1/2 HHCS GR5 BLK ZN	2

ITEMS NOT SHOWN			
--	48415	RATCHET STRAP	1
--	10531	FULL BODY HARNESS (FAS)	1
--	48736	CAMO SLEEVE W/FOAM 9"	2
--	48737	CAMO SLEEVE W/FOAM 18"	1
--	48691	TIE-OFF ROPE KIT (INCLUDES TWO 15' ROPES AND ONE 9' ROPE)	1
--	48800	DVD TREESTAND SAFETY	1
--	10549	ASSEMBLY SEAT RELAX WIDE	1

Maximum Height - 16' 8" to shooting rail

Maximum Field Rating - 300 lbs.

Tree Diameter Range - 12" to 20"

SETUP AND USE INSTRUCTIONS

(FOR ALL LADDERS INCLUDED IN THIS MANUAL)

During installation and removal of ladder treestands, you must always and properly use the included Full Body Harness (Fall Arrest System). Refer to the Full Body Harness instructions included with this product for proper use.

1. With assembled product lying on the ground in assembled position, **position one person at bottom end of ladder lying on the ground.** This person has to prevent the ladder end from tilting up when platform end is lifted and prevent the ladder from skidding across ground.
2.
 - a. Position (2) people at the platform end of the ladder, lift the platform end, and continue uprighting by walking toward bottom end of ladder and moving hands along ladder legs. **Stand ladder up against chosen straight tree on dry, level ground.** Use caution when ladder comes over center against tree.
 - b. Step back and look at the ladder top to see that it is level. Adjust as needed to achieve a level platform at top.
 - c. Step down hard on bottom step to push ladder legs into the ground.
 - d. Wrap the 9' rope attached to the stabilizer bar around tree and tie the free end to the link welded on stabilizer bar at the stabilizer bar height location. Secure the ladder tight so that the stabilizer bar is at a right angle to the tree. Adjust stabilizer bar length as necessary so it contacts tree. Be absolutely sure the tree blades on platform and the stabilizer bar are contacting tree.
 - e. Wrap the previously attached 15' tie-off ropes hanging down from platform, around the back side of tree in opposite directions of each other. Pull the ropes snug and tie them to the ladder at the stabilizer bar height location. This ground level ladder-to-tree attachment will prevent the ladder from pulling away from the tree while ascending to top for final ratchet strap attachment. The same holds true when ladder removal is necessary. **SEE FIGURE 1.**

WARNING

NEVER ASCEND OR DESCEND LADDER WITHOUT TIE-OFF ROPES SECURELY HOLDING LADDER TO TREE AND STABILIZER BAR SECURELY ATTACHED. FAILURE TO CORRECTLY PERFORM THESE STEPS CAN CAUSE THE LADDER TO COLLAPSE/BUCKLE-OVER BACKWARDS DURING THE INITIAL ASCENT TO ATTACH RATCHET STRAP RESULTING IN SERIOUS INJURY OR DEATH.

WARNING

DOUBLE CHECK ASSEMBLY STEPS TO BE CERTAIN YOU HAVE CORRECTLY ASSEMBLED THIS PRODUCT.

STUDY YOUR NEW STAND TO BECOME FAMILIAR WITH ALL OF ITS FEATURES AND DESIGN. AT GROUND LEVEL, FOLLOWING PROVIDED USE INSTRUCTIONS, PRACTICE ATTACHING STAND TO TREE AND REMOVING STAND FROM TREE. PRACTICE SITTING, STANDING, AND USING THIS PRODUCT BEFORE ATTACHING OVERHEAD. SAVE THESE INSTRUCTIONS FOR FUTURE REFERENCE. YOU MUST ALWAYS USE THE PROVIDED FULL BODY HARNESS (FALL ARREST SYSTEM) THAT MEETS TMA STANDARDS WHILE USING THIS PRODUCT.

ALWAYS USE THREE PEOPLE FOR SET-UP AND TAKE-DOWN. BE ABSOLUTELY SURE THE TREE BLADES ON PLATFORM AND THE STABILIZER BAR ARE BOTH CONTACTING TREE BEFORE CLIMBING LADDER.

STABILIZER BAR MUST ALWAYS BE CORRECTLY AND SECURELY ATTACHED TO LADDER AND TREE BEFORE CLIMBING LADDER.

SOME MODELS INCLUDE A MULTI-PIECE STABILIZER BAR SYSTEM. BE SURE SPRING LOCK PIN GOES THROUGH BOTH THE EXTENSION TUBE AND THE STABILIZER BAR.

BE CERTAIN SPRING LOCK PINS ARE LATCHED SECURELY TO PREVENT ACCIDENTAL REMOVAL.

BE SURE YOUR DOUBLE KNOTS ARE ALL SECURE ON ALL ROPE CONNECTIONS.

NEVER ASCEND OR DESCEND LADDER WITHOUT TIE-OFF ROPES SECURELY HOLDING LADDER TO TREE AND STABILIZER BAR SECURELY ATTACHED. FAILURE TO CORRECTLY PERFORM THESE STEPS CAN CAUSE THE LADDER TO COLLAPSE/BUCKLE-OVER BACKWARDS DURING THE INITIAL ASCENT TO ATTACH RATCHET STRAP RESULTING IN SERIOUS INJURY OR DEATH.

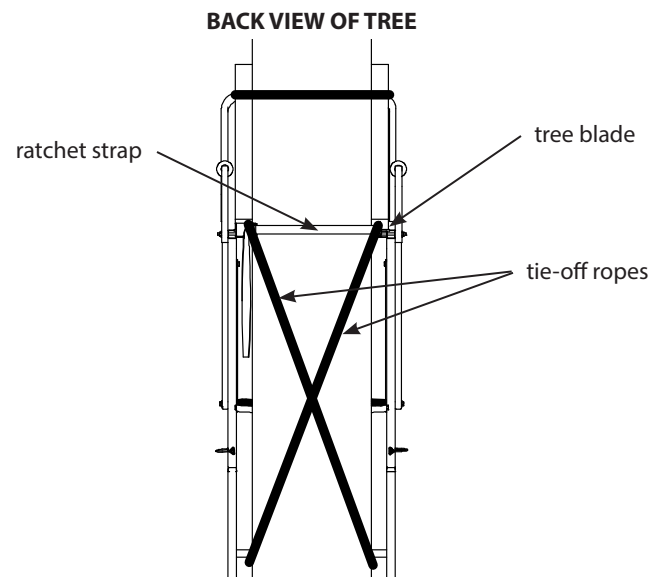

Figure 1

3. **With two people securely holding the ladder,** use the three point contact climbing method to slowly climb the ladder and carefully keep a constant hand grip on the ladder at all times. Always lean forward, toward tree, to keep top section tree blades against the tree. **Be certain ladder bottom is firmly seated on dry, level ground. Attach your harness tether to the tree before securing the platform to the tree and stepping onto platform. Refer to the Full Body Harness instructions included with this product.**
4. Standing on ladder step, lean toward tree with ratchet strap now in hand, hook "S" hook with long strap through hole provided on tree blade. Feed the long strap through the center (slot) of ratcheting mechanism and back around through tightening lever. **SEE FIGURES 2 and 3.**

NOTE: Be sure you feed the long strap correctly so there are no twists in the strap.

Wrap entire ratchet assembly around tree and hook other "S" hook through opposite tree blade hole. Pull tail of long strap until most of the slack is taken out. Be sure entire strap is even and at the same level all around tree. "Ratchet" tight to tree, this will securely attach ladder to tree and prevent movement. **SEE FIGURES 2 and 4.**

NOTE: To release ratchet, simply pull the release lever and open tightening lever wide open (flat).
5. If applicable, attach backrest portion of seat to tree by wrapping the long strap with buckle end around tree and snapping together with opposite end. Adjust as needed.
6. If applicable, once seated the shooting rail can now be seated down over studs of armrest mounts. **SEE FINISHED LADDER IMAGES.**
7. Reverse setup and use instructions to take ladder down.

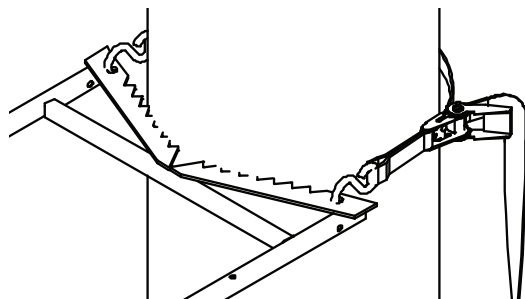

Figure 2

! WARNING

BE CERTAIN TO ALWAYS LEAN FORWARD, TOWARD THE TREE WHEN ASCENDING OR DESCENDING LADDER. ATTACH YOUR HARNESS TETHER TO THE TREE BEFORE SECURING THE PLATFORM TO THE TREE AND STEPPING ONTO THE PLATFORM.

ALWAYS HAVE THREE POINTS OF CONTACT WHILE CLIMBING LADDER.

BRING RATCHET STRAP(S) UP WITH YOU IN A POCKET- DO NOT CARRY IN YOUR HANDS!

DO NOT ALLOW EXCESSIVE STRAP BUILDUP IN RATCHET AS THIS WILL PREVENT THE RATCHET TEETH FROM ENGAGING CAUSING SLIPPAGE.

ALWAYS ATTACH RATCHET STRAPS SECURELY WHILE USING THIS PRODUCT!

NEVER STAND ON LADDER SEAT, IT IS DESIGNED FOR SITTING ONLY.

SEAT IS REMOVABLE. BE CERTAIN IT IS SECURELY ATTACHED WHEN IN USE.

BE SURE SHOOTING RAIL IS SEATED ALL THE WAY DOWN ON STUDS DURING USE.

NEVER LEAN AGAINST, LEAN OVER, OR SIT ON SHOOTING RAIL. IT IS DESIGNED AS A SHOOTING REST ONLY. ALWAYS BE AWARE THAT THE SHOOTING RAIL CAN SWING TO ONE SIDE OR THE OTHER.

BE SURE SHOOTING RAIL IS SET OFF TO THE SIDE (ON ONE STUD) WHEN ASCENDING OR DESCENDING LADDER.

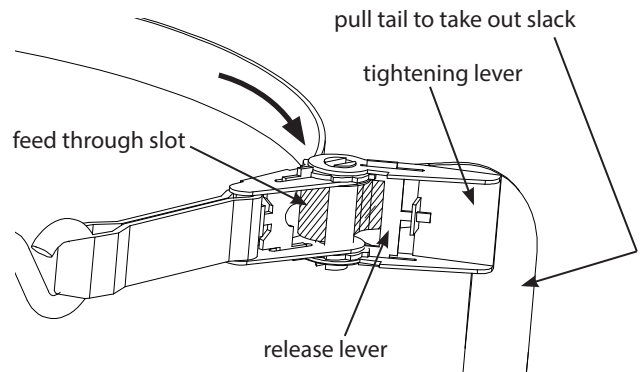

Figure 3

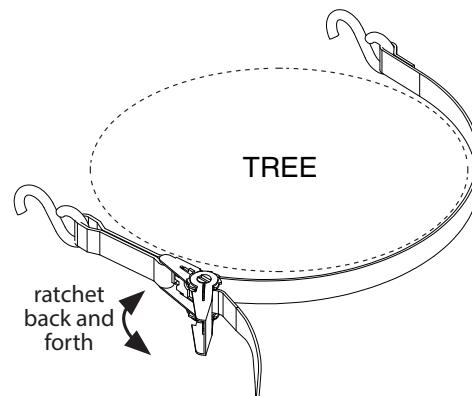
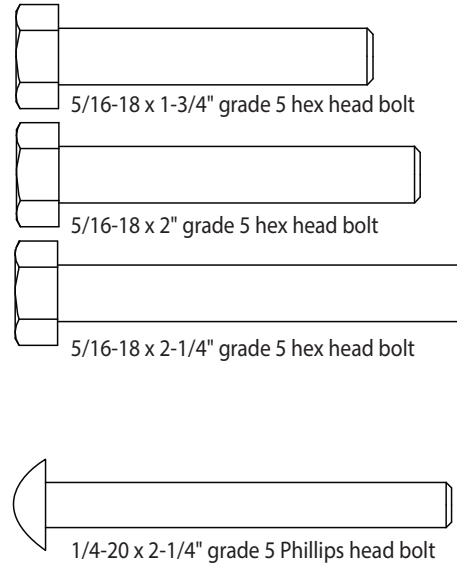
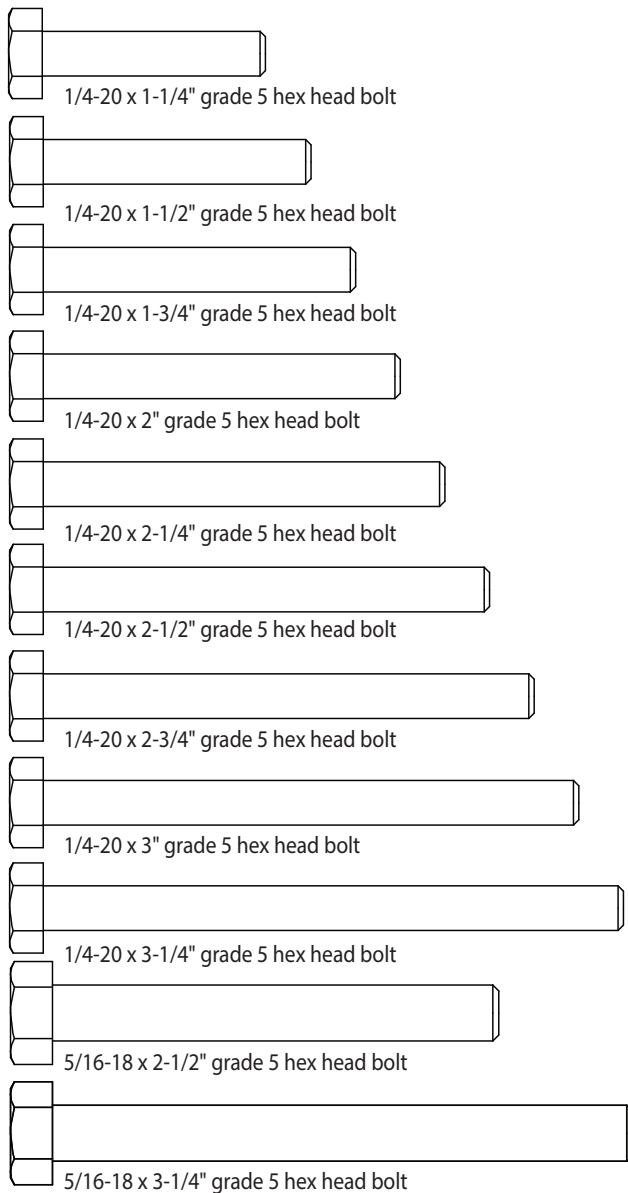

Figure 4

BOLT IDENTIFICATION CHART

Not all bolt sizes shown are included with all treestands. Bolts shown are for size reference only. Extra hardware may be included in the parts bag.





This image shows a single sheet of white paper with horizontal ruling lines. The lines are evenly spaced and run across the width of the page. There are no margins, text, or other markings on the paper.



Rivers Edge® Treestands, Inc.
1160 Eighth Avenue, PO Box 755
Cumberland, WI 54829
800-450-EDGE (3343) | Fax 715-822-2124
Email: info@huntriversedge.com