

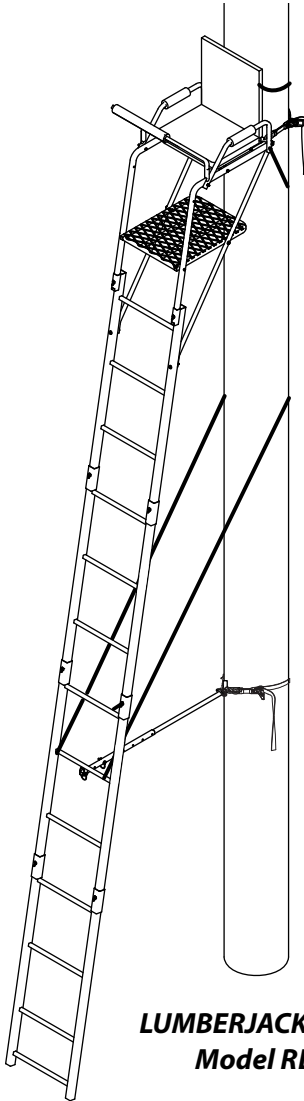

Operator's Manual

One-Man Ladder Stands



LUMBERJACK EXTRME
Model RE619

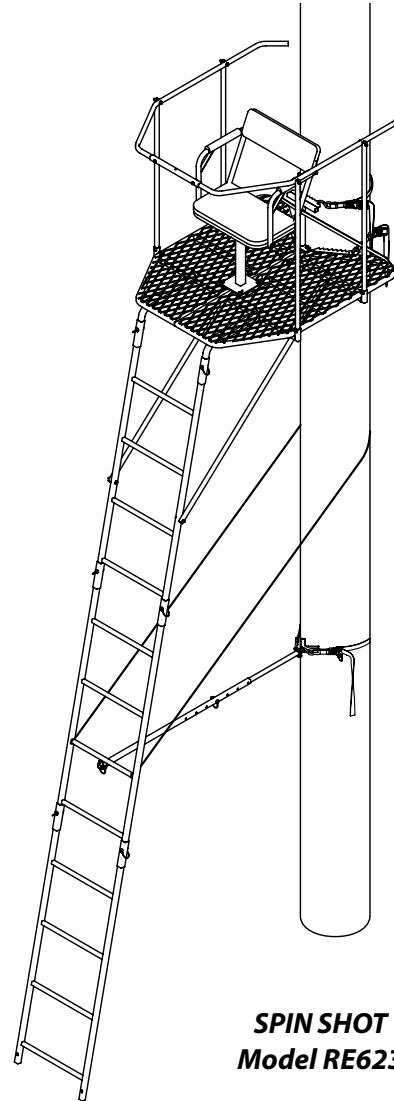

SPIN SHOT
Model RE623

INCLUDES MODEL #'s:



Certified to TMA
Standards by an
Independent
Testing Laboratory

- ☐ RE619, 20' Lumberjack Extreme Ladder
- ☐ RE607, 22' Timbershot Extreme Ladder
- ☐ RE623, 17' Spin Shot Ladder
- ☐ RE624, 15' Opening Day Ladder

Get parts online at
www.HuntRiversEdge.com

OMRELD004
Revised 02/25/11
© 2011 RETI
All Rights Reserved.



Rivers Edge Treestands are engineered with you the hunter in mind. We appreciate your purchase of one of our world class treestands. Follow these few simple instructions and your stand will provide you many years of trouble-free pleasure. Instructions should be kept in a safe place and reviewed at least annually.

If for any reason you have a problem with your product, **DO NOT return to the retailer**, contact the Rivers Edge customer service department at 800-450-EDGE (3343) for assistance.

CONTENTS

Introduction/Warranty	2
Warnings.....	3
Full Body Harness (Fall Arrest System)	4-9
Inspection and Maintenance	10
Assembly/Parts Explosion/Parts List (RE619)	11-15
Assembly/Parts Explosion/Parts List (RE607)	16-21
Assembly/Parts Explosion/Parts List (RE623)	22-27
Assembly/Parts Explosion/Parts List (RE624)	28-36
Set-Up and Use Instructions.....	37-40
Bolt Guide	41

WARRANTY

Rivers Edge Treestands, Inc., offers a lifetime warranty to be free from defects in materials and workmanship. This warranty applies to the original owner with a proof of purchase. All items attached to our stands (seat, strap, rope, wood, etc.) that are degradable are warranted for a period of one year. There is no warranty on paint. This warranty applies to products that are not modified, abused or misused in a manner that deviates from the products intended usage. Rivers Edge Treestands offers no other warranty expressed or implied nor is to be held liable for any damage that may result from any defect in a treestand manufactured by them. Warranty work must be sent directly to Rivers Edge Treestands and performed by them. **To obtain warranty service and/or replacement instructions, you must have prior approval from Rivers Edge Treestands before shipping your package to us by calling our customer service department at 800-450-EDGE (3343) or by writing to: Rivers Edge Treestands, Inc., P.O. Box 755, 1690 Elm Street, Cumberland, WI 54829 for a return material authorization number (RMA#).** All items must be shipped prepaid. Rivers Edge Treestands will at no charge, repair or replace, at their discretion, any defective stand which falls under the conditions stated above. Rivers Edge Treestands retains the right to change models, specifications and price without notice.

NOTE: You must always use the provided full body harness (fall arrest system) that meets TMA standards while using this product!

This equipment has been manufactured under strict quality guidelines. As with any equipment of this type, full understanding of the instructions and its use is mandatory for the safety of its user. Rivers Edge Treestands, Inc., is not responsible for any damages or injuries sustained due to improper use or modification of any of its products, or due to any use which deviates from the products intended usage. The manufacturer also is not responsible for any injuries sustained due to failure to adhere to the instructions for use. Any misunderstanding of its operation should be directed to manufacturer prior to its use.

ALL RIVERS EDGE TREESTANDS COME WITH A FULL BODY HARNESS (FALL ARREST SYSTEM) THAT MEETS TMA STANDARDS. It is the owner's responsibility to inspect the product regularly for damage that could inhibit the ultimate safety of the product. Failure to use or improper use of the provided Full Body Harness (Fall Arrest System) that meets TMA standards may result in serious injury or death. ALWAYS wear the provided Full Body Harness (Fall Arrest System) that meets TMA standards while using this product.

Owner is responsible to check product field rating and must never exceed maximum weight rating stated. Rivers Edge Treestands, Inc., is not responsible for any malfunction due to normal wear and tear and/or damage caused by improper use, improper maintenance or accidents. This product if used safely as intended, will give you years of trouble free service. We hope you will enjoy the quality of our products for years to come, and have a safe hunt.

For replacement parts, phone 800-450-EDGE (3343) or go online to www.HuntRiversEdge.com.

WARNINGS

WARNING

DO NOT USE THIS PRODUCT UNTIL YOU HAVE WATCHED THE INCLUDED TREESTAND SAFETY DVD, UNDERSTAND IT AND PRACTICED THE TECHNIQUES FOR SAFE HUNTING DISCUSSED IN THIS DVD.

YOU MUST ALWAYS USE THE PROVIDED FULL BODY HARNESS (FALL ARREST SYSTEM) THAT MEETS TMA STANDARDS WHILE USING THIS PRODUCT. SINGLE SAFETY BELTS AND CHEST HARNESES ARE NO LONGER ALLOWED AND SHOULD NEVER BE USED.

IF YOU ARE NOT WEARING A FULL BODY HARNESS THAT IS PROTECTING YOU FROM A FALL, DO NOT LEAVE THE GROUND.

FAILURE TO USE OR IMPROPER USE OF THE PROVIDED FULL BODY HARNESS (FALL ARREST SYSTEM) THAT MEETS TMA STANDARDS MAY RESULT IN SERIOUS INJURY OR DEATH! READ, UNDERSTAND AND FOLLOW ALL INSTRUCTIONS. IF ANY INSTRUCTIONS ARE NOT UNDERSTOOD OR IF YOU HAVE A PARTS ISSUE CALL 800-450-EDGE (3343) BEFORE USING.

READ, UNDERSTAND AND FOLLOW ALL ASSEMBLY, INSPECTION, MAINTENANCE, FULL BODY HARNESS (FALL ARREST SYSTEM) & USE INSTRUCTIONS PROVIDED BEFORE EACH USE. FAILURE TO FOLLOW ALL WARNINGS AND INSTRUCTIONS COULD RESULT IN SERIOUS INJURY OR DEATH.

READ AND PERFORM ALL INSPECTION AND MAINTENANCE TASKS BEFORE EACH AND EVERY USE (REPLACE ANY QUESTIONABLE COMPONENTS IMMEDIATELY WITH RIVERS EDGE ORIGINAL REPLACEMENT PARTS). DO NOT LEAVE YOUR STAND OUTDOORS – REMOVE AFTER EACH USE AND STORE INDOORS!

INSTRUCTIONS SHOULD BE KEPT IN A SAFE PLACE AND REVIEWED AT LEAST ANNUALLY.

DOUBLE CHECK ASSEMBLY STEPS TO BE CERTAIN YOU HAVE CORRECTLY ASSEMBLED THIS PRODUCT.

DO NOT CRUSH TUBING WHEN TIGHTENING BOLT ASSEMBLIES! IDENTIFY AND FAMILIARIZE YOURSELF WITH ALL PARTS BEFORE YOU START. A BOLT IDENTIFICATION CHART CAN BE FOUND IN THE BACK.

DO NOT EXCEED THE TOTAL FIELD RATING- 300 LBS.

NEVER USE ANY PRODUCT THAT HAS NOT BEEN MAINTAINED OR INSPECTED PROPERLY – YOUR LIFE DEPENDS ON IT!

WHEN HUNTING FROM A TREESTAND, FALLS CAN OCCUR ANY TIME AFTER LEAVING THE GROUND CAUSING INJURY OR DEATH.

NEVER ATTACH TO A DEAD, ODD-SHAPED, LEANING, DISEASED, LOOSE-BARKED TREE OR UTILITY POLES.

WARNING

REPLACE ANY AND ALL TREESTAND STRAPS EVERY TWO YEARS OR WHEN ANY SIGNS OF DAMAGE OR WEAR EXIST BEFORE.

SOME MODELS INCLUDE A FOOTREST, WHICH IS DESIGNED AS A FOOTREST ONLY. NEVER STAND ON THE FOOTREST.

BE SURE TO RAISE AND LOWER YOUR WEAPON AND GEAR WITH A HAUL LINE. GUN BARREL END AND ARROW TIPS MUST BE POINTED DOWN- AWAY FROM YOU.

BE SURE SEAT PAD AND/OR BUCKLES ARE SECURELY AND CORRECTLY ATTACHED TO PREVENT ACCIDENTAL REMOVAL.

WARNING

ALL ASSEMBLY MUST BE DONE BY THREE PEOPLE IN THIS ORDER AT GROUND LEVEL BEFORE UPRIGHTING.

NEVER EXCEED THE MAXIMUM STATED USE HEIGHT.

CHECK THE GROUND UNDER STAND TO MAKE SURE IT IS FIRM AND LEVEL. SLOPED GROUND OR UNEVEN SURFACE (ONE SIDE ON A ROCK) CAN CAUSE YOUR LADDER TO TILT OR SHIFT OFF THE TREE AS YOU CLIMB.

CHECK EVERY LADDER SECTION CONNECTION EVERY TIME YOU USE THE STAND BEFORE YOU LEAVE THE GROUND. IF LADDER SECTIONS ARE SEPARATING, DO NOT USE THE STAND.

LUBRICATION IS HIGHLY RECOMMENDED AT SLIDE TOGETHER POINTS OF EACH SECTION TO PREVENT BINDING. SECTIONS ARE STACKED TOGETHER BY SLIDING SECTIONS TOGETHER, INSIDE OF EACH OTHER. SECTIONS ARE THEN SECURED WITH SPRING LOCK PINS OR WING NUTS/WING BOLTS. BE SURE ALL LADDER SECTIONS ARE SEATED COMPLETELY TOGETHER ON SWEDGED OR POCKETED ENDS OF PIPE.

STABILIZER BAR MUST ALWAYS BE CORRECTLY AND SECURELY ATTACHED TO LADDER AND TREE BEFORE CLIMBING LADDER.

SOME MODELS INCLUDE A MULTI-PIECE STABILIZER BAR SYSTEM. BE SURE SPRING LOCK PIN GOES THROUGH BOTH THE EXTENSION TUBE AND THE STABILIZER BAR.

BE CERTAIN SPRING LOCK PINS ARE LATCHED SECURELY TO PREVENT ACCIDENTAL REMOVAL.

BE SURE YOUR DOUBLE KNOTS ARE ALL SECURE ON ALL ROPE CONNECTIONS.

NEVER ASCEND OR DESCEND LADDER WITHOUT TIE-OFF ROPES SECURELY HOLDING LADDER TO TREE AND STABILIZER BAR SECURELY ATTACHED.

FULL BODY HARNESS (FALL ARREST SYSTEM)

NOTE: Model RE623 17' Spin Shot Ladder comes with a special Full Body Harness (FAS) with an extended tether, part number 48164. Refer to the harness instructions provided with that harness for proper use. You must read, understand and follow all instructions provided and warnings listed at all times.

ALL LADDER STYLE TREESTANDS INCLUDE A TREE BELT THAT MUST BE USED IN ACCORDANCE WITH THE FULL BODY HARNESS (FAS) SUPPLIED.

For safety reasons, take time to read each section of these instructions for proper attachment, use and maintenance of this Full Body Harness (FAS).

To ensure your personal safety, you must read these instructions before using this product. Failure to do so could result in serious personal injury or death. This product is certified to TMA Standards by an Independent Testing Laboratory. It is the responsibility of the user to follow all instructions provided, warnings listed, installation, set up, and use of this product.

If you have any questions or do not understand any instructions or warnings listed please call 800-450-EDGE (3343) before attempting to use.

WARNING

YOU MUST READ, UNDERSTAND, AND FOLLOW ALL INSTRUCTIONS PROVIDED, AND WARNINGS LISTED AT ALL TIMES. FAILURE TO DO SO COULD RESULT IN SERIOUS INJURY OR DEATH.

THE PROVIDED FULL BODY HARNESS (FAS) IS DESIGNED TO STOP YOUR FALL, BUT DOES NOT REMOVE THE RISK OF SERIOUS PERSONAL INJURY OR DEATH. IF YOU DO NOT UNDERSTAND ANY INSTRUCTIONS OR WARNINGS PROVIDED IN THIS BOOK, YOU MUST CALL RIVERS EDGE TREESTANDS, INC., AT 800-450-EDGE (3343) BEFORE USING.

ALWAYS WEAR THIS FULL BODY HARNESS (FAS) WHILE USING THE RIVERS EDGE TREESTAND THAT IT WAS PURCHASED WITH. FAILURE TO DO SO COULD RESULT IN SERIOUS INJURY OR DEATH

INSPECT THIS PRODUCT BEFORE EACH USE FOR SIGNS OF WEAR AND/OR DAMAGE. NEVER USE A DAMAGED PRODUCT.

THIS PRODUCT IS DESIGNED FOR ADULT USE ONLY. ADULTS MUST BE BETWEEN 120 LBS (MINIMUM) AND 300 LBS (MAXIMUM) TO USE THIS PRODUCT.

BEFORE ATTEMPTING TO USE THIS HARNESS, PRACTICE INSTALLING, SET UP, AND USE AT GROUND LEVEL. ONCE YOU BECOME COMFORTABLE WITH ITS SET UP AND USE, YOU MAY PROCEED AND USE IT AT HEIGHTS ABOVE GROUND.

DO NOT USE THIS PRODUCT OR ANY RIVERS EDGE PRODUCT ON UTILITY POLES, TELEPHONE POLES, OR ANY OTHER MAN MADE STRUCTURES. USE ON STRONG, STRAIGHT, LIVE TREES ONLY. NEVER USE IN A COMMERCIAL OR INDUSTRIAL SETTING. USE ONLY AS A FULL BODY HARNESS (FAS) WHILE HUNTING.

FAILURE TO DISCARD AND REMOVE THIS FULL BODY HARNESS (FAS) DEVICE FROM SERVICE AFTER FIVE (5) YEARS FROM MANUFACTURE DATE, WHEN ANY SIGNS OF DAMAGE OR WEAR EXIST, OR AFTER ARRESTING A FALL, COULD RESULT IN SERIOUS INJURY OR DEATH.

WARNING

DO NOT USE THIS OR ANY OTHER RIVERS EDGE PRODUCT IF YOU HAVE A HISTORY OF HEALTH PROBLEMS SUCH AS HEART PROBLEMS, BACK PROBLEMS, VISION PROBLEMS, HIGH BLOOD PRESSURE, OR ANY OTHER PHYSICAL OR MENTAL IMPAIRMENT. DO NOT USE IF YOU ARE ON ANY TYPE OF MEDICATION OR ANY OTHER SUBSTANCE SUCH AS ALCOHOL THAT MAY ALTER YOUR ABILITY TO USE THIS PRODUCT PROPERLY AND SAFELY.

DO NOT USE IN SLIPPERY OR STORMY CONDITIONS. SNOW, ICE, FREEZING RAIN, WIND, AND LIGHTNING POSE VERY DANGEROUS THREATS TO YOUR SAFETY. END YOUR HUNT AND RETURN TO THE GROUND IF INCLEMENT CONDITIONS ARISE.

DO NOT ATTEMPT TO REMOVE, MODIFY, AND/OR EXCLUDE ANY PORTION OF THIS PRODUCT. MODIFICATION, MISUSE, AND/OR PART SUBSTITUTION COULD RESULT IN SERIOUS INJURY OR DEATH. IF YOU SUSPECT PARTS ARE MISSING OR DAMAGED, IMMEDIATELY CONTACT RIVERS EDGE TREESTANDS, INC., AT 800-450-EDGE (3343) BEFORE USING.

THIS RIVERS EDGE FULL BODY HARNESS (FAS) WAS DESIGNED AS A FALL-ARREST ONLY! DO NOT UNDER ANY CIRCUMSTANCES USE IT TO LEAN OUT OF YOUR TREESTAND. USING THIS PRODUCT IN SUCH A MANNER COULD RESULT IN SERIOUS INJURY OR DEATH!

PRACTICE THE USE OF A FULL BODY HARNESS AT GROUND LEVEL IN THE PRESENCE OF A RESPONSIBLE ADULT TO EXPERIENCE THE FEELING OF WEARING THIS HARNESS BEFORE USING IN A HUNTING ENVIRONMENT.

USING YOUR FULL BODY HARNESS (FALL ARREST SYSTEM)

PUTTING ON YOUR FULL BODY HARNESS

1. With the Full Body Harness (FAS) lying on the ground, familiarize yourself with all of its design and features. **SEE FIGURE 1.**
2. Loosen both leg straps to the maximum position and unthread the waist belt completely. Doing both of these actions will allow you to put the Full Body Harness (FAS) on easier.
3. Now holding the harness, locate the (2) shoulder straps labeled "LEFT SHOULDER" and "RIGHT SHOULDER", and spread them apart to make sure there are no twists or tangles in the harness. **SEE FIGURE 2.**
4. Position yourself in front of the harness and proceed to step through each leg loop as if you were putting on a pair of pants. **SEE FIGURE 3.**
5. Pull harness up your body to chest height where you will slide your left arm through the "LEFT SHOULDER" strap and your right arm through the "RIGHT SHOULDER" strap as if you were putting on a jacket. **SEE FIGURE 4.**

NOTE: Be sure there are no twists in leg or shoulder straps. The "LEFT SHOULDER" and "RIGHT SHOULDER" printing should be away from your body so you can read the words while wearing the Full Body Harness (FAS). If not, the harness is on inside out and must be switched.

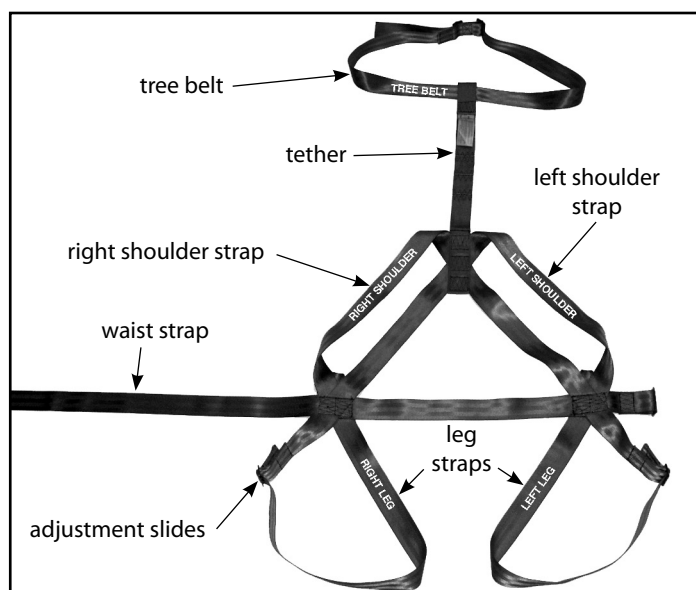

Figure 1

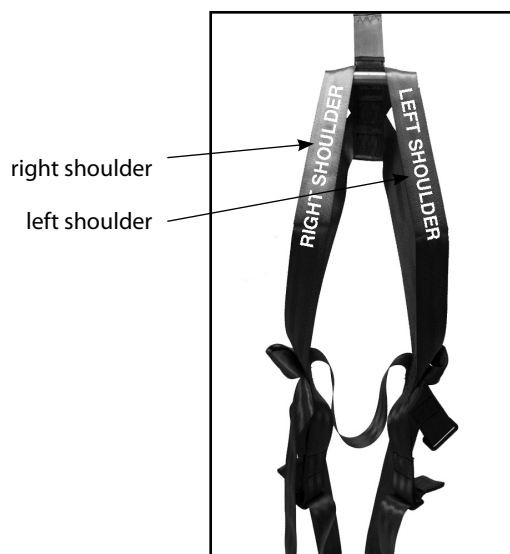

Figure 2

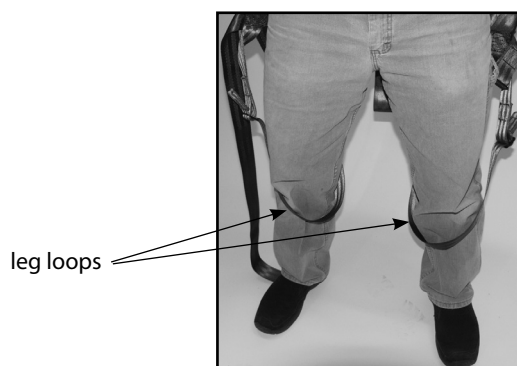

Figure 3



Figure 4

6. Tighten and adjust each leg strap so they are tight to your legs, but not uncomfortably tight. **SEE FIGURE 5.**
7. Feed waist strap through waist strap adjustment slide. Tighten and adjust the waist strap so it is tight fit to your body, but not uncomfortably tight. **SEE FIGURE 6.**
8. You should now have the Full Body Harness (FAS) configured with the waist strap on your front side, shoulder straps over the proper shoulders and the tether strap positioned on your back side. **SEE FIGURES 7 & 8.** The entire Full Body Harness (FAS) should have a snug, tight fit to your body.

NOTE: Tether strap should not be tangled, twisted or looped around any portion of the harness. Excess leg and waist strap can be tucked away.

⚠ WARNING

BE SURE THAT YOU ARE WEARING YOUR FULL BODY HARNESS (FAS) CORRECTLY.



Figure 7



Figure 8

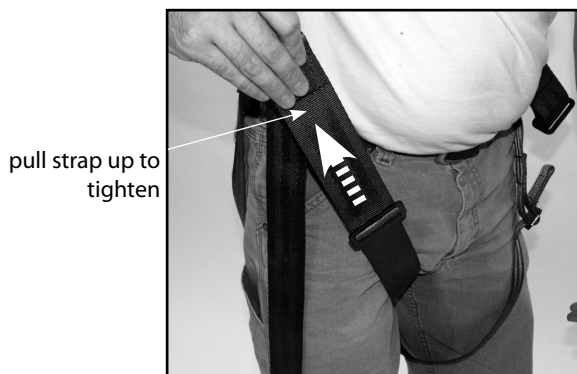

Figure 5



Figure 6

FULL BODY HARNESS (FAS) USED WITH TREE BELT SUPPLIED WITH ALL LADDER STYLE TREESTANDS

This is the primary attachment method when using a Full Body Harness (FAS). This method must be used while in your final hunting position with any type of treestand. This method must be done immediately upon reaching the foot platform of your ladder stand.

1. While wearing your Full Body Harness (FAS) correctly, wrap the tree belt through the loop end of the tether and around tree. Take the tail end of the tree belt and feed it through the (2) adjustment slides on tree belt. **SEE FIGURE 9.** Pull the tail of tree belt tight.

NOTE: Be sure the (2) adjustment slides are facing away from tree, preventing any obstruction. Do not position tether on or between the (2) tree belt adjustment slides. SEE FIGURE 9.

Once you have reached your desired hunting height, you must slide the tree belt up the tree as high as possible. Tighten the tree belt to the tree by pulling the tree belt tail tight. The tether strap accommodates your freedom of movement, however, the distance should be as short as possible to reduce the dynamic load on your body in case of a fall. There should be no slack in tether strap while in a sitting position.

2. Reverse these procedures to descend from your treestand.

WARNING

NEVER POSITION YOURSELF IN A WAY THAT ALLOWS THE TETHER TO BE UNDER YOUR CHIN OR AROUND YOUR NECK. TETHER STRAP SHOULD NOT BE TANGLED, TWISTED OR LOOPED AROUND ANY PORTION OF THE HARNESS. EXCESS LEG AND WAIST STRAP CAN BE TUCKED AWAY.

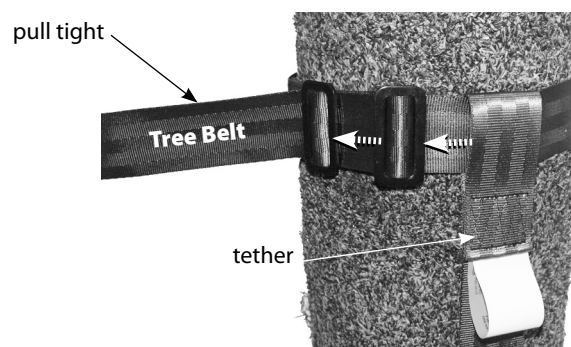

Figure 9

⚠ WARNING

IN CASE OF A FALL...

DO NOT PANIC! This Full Body Harness (Fall Arrest System) is designed to prevent a fall to the ground. It will suspend you until you are able to return to your treestand or until help arrives. Using the included Suspension Relief Device (SRD) will help to maintain circulation in the legs and help mitigate the effects of hanging suspended with your weight resting on the leg straps of the Full Body Harness. The effects of prolonged suspension without using the Suspension Relief Device may result in unconsciousness and death may occur.

⚠ WARNING

THE SUSPENSION RELIEF DEVICE (SRD) STRAP MUST BE ON YOUR PERSON AND ALWAYS BE READILY ACCESSIBLE TO YOU WHILE WEARING THE FULL BODY HARNESS (FALL ARREST SYSTEM)! EVEN IF YOU HAVE ENCOUNTERED A FALL AND ARE SUSPENDED BY YOUR HARNESS TETHER, YOU MUST HAVE ACCESS TO THE SUSPENSION RELIEF DEVICE. ALWAYS HAVE THE SRD STRAP STORED IN THE STORAGE POUCH SO YOU HAVE ACCESS TO IT!

1. Retrieve the Suspension Relief Device (SRD) strap from the storage pouch on harness.
2. Insert the looped end of SRD strap through either of the climbing belt loops sewn on harness, near the waist belt. Take the opposite end of SRD strap and feed it through the looped end and pull tight, forming a cinch knot. **SEE FIGURES 1A & 1B.**
3. Take the opposite end of SRD strap and feed it through the other climbing belt loop located on other side of harness. Once SRD strap is fed through climbing belt loop, feed the SRD strap back through the adjustment slide. **SEE FIGURES 2A & 2B.**
4. Adjust SRD strap length so it forms a large loop that is slightly shorter than the length of your legs.
5. Put both feet in the loop and stand up to relieve the pressure from the harness leg straps. **SEE FIGURES 3 & 4.** If pressure is still felt on the leg straps while standing on the Suspension Relief Device (SRD) strap, you must readjust the length of the SRD strap to relieve pressure off the leg straps.
6. You can also adjust the SRD strap to a shorter length and place your knees on the SRD strap to relieve the pressure from the harness leg straps. **SEE FIGURE 5.** Alternating between the standing method on feet and the kneeling method on knees, comfort and better blood circulation are maintained.



Figure 1A

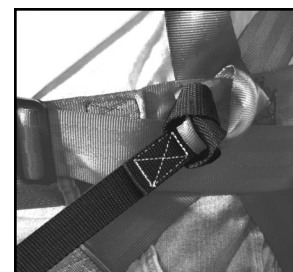

Figure 1B



Figure 2A



Figure 2B



Figure 3



Figure 4



Figure 5

ALWAYS...

- Be physically fit, mentally alert, and well rested before using this product.
- Read and understand all instructions provided and warnings listed before each use and save for future reference.
- Practice using at ground level first before using above ground.
- For adult use only, Weight Range: Min-120 lbs. Max-300 lbs.
- Inspect before each use for signs of wear and/or damage- never use a damaged product. Replace with new.
- Store in a cool, dry place. Never put away damp to avoid mildew.

NEVER...

- Sleep while using this product.
- Use in slippery or stormy conditions.
- Exceed the Weight Range: Minimum-120 lbs. Maximum-300 lbs.
- Alter the original design of your Full Body Harness (FAS).
- Use to lean out from stand.
- Use if history of health problems persist.
- Use while intoxicated or using medication.
- Loan your Full Body Harness (FAS) to someone else.
- Use a damaged product, replace with new.
- Use in a commercial or industrial setting.
- Leave product outdoors.

WARNING

INFORM SOMEONE OF THE HUNTING LOCATION, WHERE THE TREESTAND WILL BE LOCATED AND THE EXPECTED DURATION OF THE HUNT.

CARRY A SIGNAL DEVICE SUCH AS A MOBILE PHONE, RADIO, WHISTLE, SIGNAL FLARE OR PERSONAL LOCATOR DEVICE (PLD) AND IT MUST BE READILY AVAILABLE AT ALL TIMES.

FAILURE TO FOLLOW HARNESS INSTRUCTIONS COULD RESULT IN NOT BEING ABLE TO RETURN TO THE STAND AND BEING SUSPENDED IN A HARNESS AFTER A FALL.

IF THE HUNTING LOCATION IS UNKNOWN BY ANYONE AND COMMUNICATION EFFORTS ARE UNSUCCESSFUL, YOU MUST HAVE A PERSONAL PLAN FOR RECOVERY/ESCAPE BECAUSE PROLONGED SUSPENSION IN A HARNESS WITHOUT THE USE OF THE SUSPENSION RELIEF DEVICE (SRD) CAN BE FATAL. IT IS IMPORTANT TO EXERCISE THE LEGS BY PUSHING AGAINST THE TREE OR DOING OTHER FORMS OF CONTINUOUS LEG EXERCISES TO MITIGATE SUSPENSION TRAUMA (BLOOD POOLING) WHILE BEING SUSPENDED.

SEVERAL OPTIONAL PRODUCTS/SYSTEMS ARE AVAILABLE THAT OFFER SELF-RECOVERY OR SELF-EXTRACTION FROM A FALL WHEN SUSPENDED IN A HARNESS. SOME SYSTEMS AUTOMATICALLY DESCEND THE USER WHILE OTHERS ALLOW USER CONTROL. ONE OF THESE PRODUCTS/SYSTEMS CAN BE CONSIDERED FOR USE AS AN ADDITIONAL SAFETY PRECAUTION AGAINST PROLONGED SUSPENSION AND SUSPENSION TRAUMA. BE SURE TO FOLLOW THE MANUFACTURERS' DIRECTIONS ON THE SAFE USE OF THESE PRODUCTS/SYSTEMS.

WARNING

EXTREME WARNING! IF FALL OCCURS WHILE USING THIS FULL BODY HARNESS (FALL ARREST SYSTEM) YOU MUST ALWAYS REMEMBER TO REMAIN CALM. REGAIN YOUR THOUGHTS AND COMPOSURE AND TRY TO RECOVER AS QUICKLY AS POSSIBLE. SOME OPTIONS YOU MAY HAVE, BUT NOT ALL VARIABLES INCLUDE USING YOUR CLIMBING STICKS, TREE STEPS, ETC. AS FOOTING TO RAISE YOURSELF TO RELIEVE PRESSURE OFF THE LEG & WAIST STRAPS OR TO RECOVER, CLIMB BACK ONTO YOUR STAND PLATFORM AND STAY PUT UNTIL YOUR THOUGHTS AND JUDGEMENT ARE CLEAR. IF RAISING YOURSELF IS NOT AN OPTION, CARRY A SIGNAL DEVICE SUCH AS A MOBILE PHONE, RADIO, WHISTLE, SIGNAL FLARE OR PERSONAL LOCATOR DEVICE (PLD) TO CALL OR ALERT SOMEONE TO HELP RESCUE YOU.

WHILE YOU ARE DOING ONE OR MORE OF THESE OPTIONS, YOU MUST KEEP MOVING ALL OF YOUR LIMBS INCLUDING BENDING YOUR KNEES AND LIFTING YOUR LEGS UP TO PROMOTE CIRCULATION THROUGHOUT YOUR BODY.

THE SUSPENSION RELIEF DEVICE (SRD) STRAP MUST BE ON YOUR PERSON AND ALWAYS BE READILY ACCESSIBLE TO YOU WHILE WEARING THE FULL BODY HARNESS (FALL ARREST SYSTEM)! EVEN IF YOU HAVE ENCOUNTERED A FALL AND ARE SUSPENDED BY YOUR HARNESS TETHER, YOU MUST HAVE ACCESS TO THE SUSPENSION RELIEF DEVICE. ALWAYS HAVE THE SRD STRAP STORED IN THE STORAGE POUCH SO YOU HAVE ACCESS TO IT!

THE SUSPENSION RELIEF DEVICE IS DESIGNED FOR PROVIDING IMMEDIATE RELIEF FROM PROLONGED SUSPENSION TRAUMA. IF YOU ARE NOT PHYSICALLY ABLE TO PERFORM THE STEPS INVOLVED IN THE CORRECT USE OF THIS SUSPENSION RELIEF DEVICE (SRD) STRAP, YOU SHOULD HUNT FROM GROUND LEVEL ONLY.

HUNTERS WITH VARYING DEGREES OF PHYSICAL FITNESS MAY REQUIRE DIFFERENT PLANS TO RECOVER/ESCAPE THE EFFECTS OF PROLONGED SUSPENSION. IF YOU DO NOT RECOVER QUICKLY, OR KEEP MOVING TO PROMOTE BLOOD CIRCULATION, UNCONSCIOUSNESS AND DEATH MAY OCCUR. HAVE A PERSONAL PLAN AND PRACTICE IT IN THE PRESENCE OF A RESPONSIBLE ADULT BEFORE LEAVING THE GROUND. NO ONE ESCAPE/RESCUE PLAN WILL WORK FOR EVERY HUNTER ON EVERY TREE IN EVERY CIRCUMSTANCE. ONLY YOU CAN DETERMINE THE BEST RECOVERY/ESCAPE PLAN FOR YOUR HUNTING SITUATION BEFORE LEAVING THE GROUND. HUNT FROM THE GROUND WHEN SELF-RECOVERY/ESCAPE ABILITY IS ABSENT. THERE IS TIME TO MAKE A CORRECT DECISION ON WHAT ACTION TO TAKE IF A FALL OCCURS WHILE WEARING A FULL BODY HARNESS. IT IS IMPORTANT TO REMEMBER, "DO NOT PANIC." REMAIN CALM AND IMPLEMENT YOUR PRACTICED RESCUE, RELIEF AND RECOVERY PLAN.

ALWAYS...

- Be physically fit, mentally alert, and well rested before using this product.
- Read, understand and follow all warnings and instructions before use and save for future reference.
- Use the provided Full Body Harness (Fall Arrest System) that meets TMA standards immediately upon reaching foot platform.
- Be fully aware of foot placement.
- Recommended for adult use only.
- Inspect ladder for missing parts, all hardware condition, and damage before every application, replace if necessary.
- Pull up a bow, backpack, firearm or other equipment only after being secure in the treestand and a fire arm must be pulled up with it unloaded, chamber open and muzzle down.
- Remove ladder after every use, store product indoors.
- Use only Rivers Edge original replacement parts.
- Lean forward, towards tree, when ascending and descending ladder.
- Place ladder on dry, level ground.
- Lubricate all slide together points to prevent binding, wear, rust & noise.
- Avoid all electrical power lines.
- Always inform someone of the hunting location, where the treestand will be located and the expected duration of the hunt.
- Carry a signal device such as a mobile phone, radio, whistle, signal flare or personal locator device (PLD) and it must be readily available at all times.
- Inspect the treestand and all safety devices each time before use and do not store a treestand outdoors when not in use.

NEVER...

- Sleep in a treestand
- Use on wet, soft, or unstable ground.
- Exceed the total field rating of 300 lbs.
- Attach to a dead, odd-shaped, leaning, diseased, loose barked trees or utility poles.
- Use on trees with a diameter smaller than 12 inches or no larger than 20 inches.
- Use a treestand during inclement weather such as rain, lightning, windstorms or icy conditions and end your hunt and return to the ground if inclement conditions arise.
- Alter the original design of your stand.
- Jump on or use in a careless manner.
- Lean out over edge of device.
- Use when intoxicated or using over-the-counter medication or prescription drugs.
- Use a damaged product, replace with new.
- Loan your stand to someone else.
- Use without stabilizer bar, spring lock pins & tie-off ropes securely attached.
- Stand on the seat, it is designed for sitting only.
- Use a treestand when feeling ill, nauseous or dizzy, or if you have a prior medical condition that could cause a problem i.e., heart condition, joints that lock-up, spinal fusion, etc. or if you are not well rested.
- Rely on a tree branch for support.
- Jump or bounce on a treestand to seat it to the tree

INSPECTION AND MAINTENANCE SCHEDULE

FOR ALL RIVERS EDGE PRODUCTS

- Inspect all webbing, rope, cord, and strap assemblies for wear or damage.
- Inspect cables and cable ends for damage or kinking.
- Inspect all hardware and chain components for damage.
- Inspect for any structural damage to product. (Return to factory for repair or discard product if any damage is found.)
- Inspect all nut and bolt assemblies to be certain none are loose.
- Inspect for any missing parts.
- Lubricate all pivot and slide together points with powder graphite to prevent noise, wear, and rust.
- Inspect entire product for any rust, corrosion, cracks, freezing, excessive heat, or rotting damage that may effect the safety of your product. Discard any questionable product.
- Inspect entire product for any structural damage - pay close attention to all weld locations. (Return to factory for repair or discard product if any damage is found.)
- Using correct wrenches inspect all nut & bolt assembly locations and snug up any that may be loose. Be careful not to crush tubing when tightening!
- Inspect and check operation of all cables, cable ends, cord, rope, webbing, and strap or chain assemblies. Replace with factory new any item or assembly that shows signs of wear, damage, kinking, or functions incorrectly.
- Inspect seat. Replace any seat with factory new that shows signs of structural damage or wear.
- Inspect all hardware for wear or damage, also be sure you have no missing parts.
- Never modify your stand in any way by making repairs, replacing parts, or altering adding or attaching anything to it except if explicitly authorized in writing by the manufacturer.

ASSEMBLY INSTRUCTIONS (RE619)

Tools needed – two 7/16" wrenches, rubber mallet

IMPORTANT ASSEMBLY TIP: Do not tighten any nut and bolt combinations completely until all parts are assembled together! Finger tighten plus one turn of a wrench only! This will temporarily hold the lock nut on the bolt while helping alignment of all parts! After all parts are assembled together, all nut & bolt combinations must be completely tightened.

1. Attach the foot platform (1ML37) to the inside of side rails (SL61) using (2) provided 1/4-20 x 2-1/4" bolts and locknuts. **SEE FIGURE 1. DO NOT tighten all nut & bolt assemblies completely!**

NOTE: Mesh surface should be on top with squared ends of platform closest to side rails.

2. Attach the rear (blade end) of tree blade frame (1ML34) to the inside of side rails, and the (2) armrests (AR12) to the outside of side rails using (2) provided 1/4-20 x 3-1/4" bolts, locknuts and steel washers. **SEE FIGURE 2.**
3. Attach the front end of tree blade frame to the side rails and the front end of armrests to the side rails using (4) provided 1/4-20 x 2-1/4" bolts, locknuts and (2) steel washers. **SEE FIGURE 2.**
4. Attach the seat frame (1ML15) to the tabs on the tree blade frame using (2) provided 1/4-20 x 1-1/2" bolts, locknuts, steel washers and nylon washers. **SEE FIGURE 3.** Attach the (2) provided rubber bumper stops to the top side of tree blade frame by pressing into provided holes. **SEE FIGURE 3.**

NOTE: Mesh surface of seat frame should be on top.

NOTE: Nylon washers should be placed between the tabs and seat frame to prevent noise.

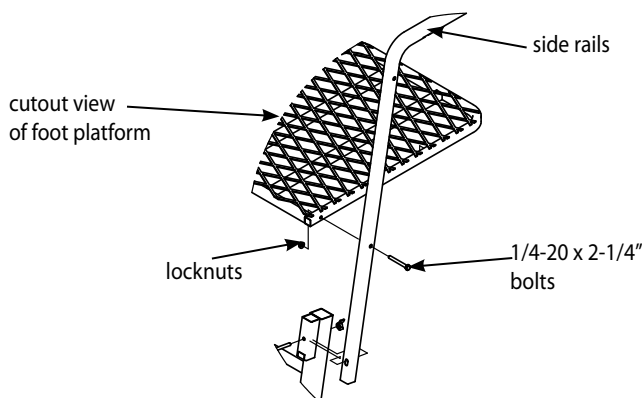

Figure 1

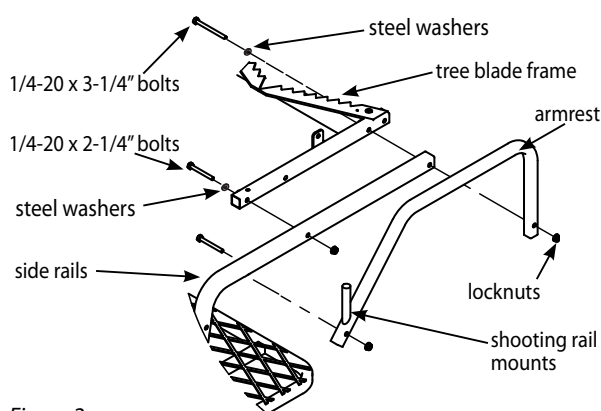

Figure 2

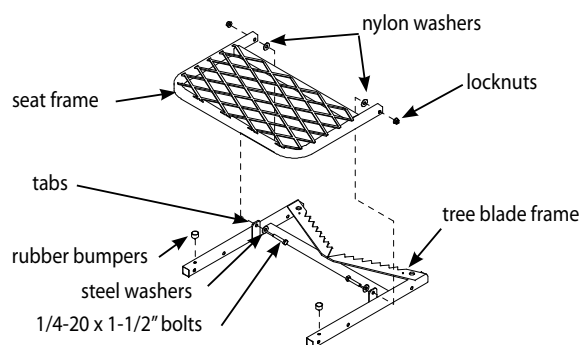

Figure 3

5. Attach the (2) brace supports (48055) to the rear holes of tree blade frame and foot platform using (4) provided 1/4-20 x 2" bolts, locknuts and steel washers. **SEE FIGURE 4.**
6. Insert the assembled top platform section into the pockets of top ladder section with mounting holes (SL74). Attach the (2) support braces to the back side of top ladder section using (2) provided 1/4-20 x 2-3/4" bolts, locknuts and steel washers. **SEE FIGURE 4. You must now tighten all nut & bolt assemblies. Be sure not to over tighten or crush tubing when tightening!**
7. Attach the removable seat cushion (48819) to the top of seat frame. Wrap the Velcro straps or buckle straps around seat frame and secure together. Snap the side release buckles together for buckle style seats. Pull straps tight so seat is not loose.
8.
 - a. Attach the shooting rail (SR10) by setting rail down over studs on armrests. **SEE FIGURE 4.** Lubrication is recommended to prevent binding and noise.
 - b. Attach the (2) provided 9" camo sleeves to the armrests and the (1) 18" camo sleeve to the shooting rail by wrapping around metal tubing and attaching Velcro together.
 - c. Tap the (2) provided plastic end caps into top end of top ladder section using a rubber mallet.
9. The remaining (3) ladder sections are assembled to the top ladder assembly on the ground in the following order: bottom section (SL71 ladder); second section (SL72 ladder); third section (SL73 ladder); top section (assembled top, platform section). **SEE FINISHED 20' LUMBERJACK EXTREME LADDER.**

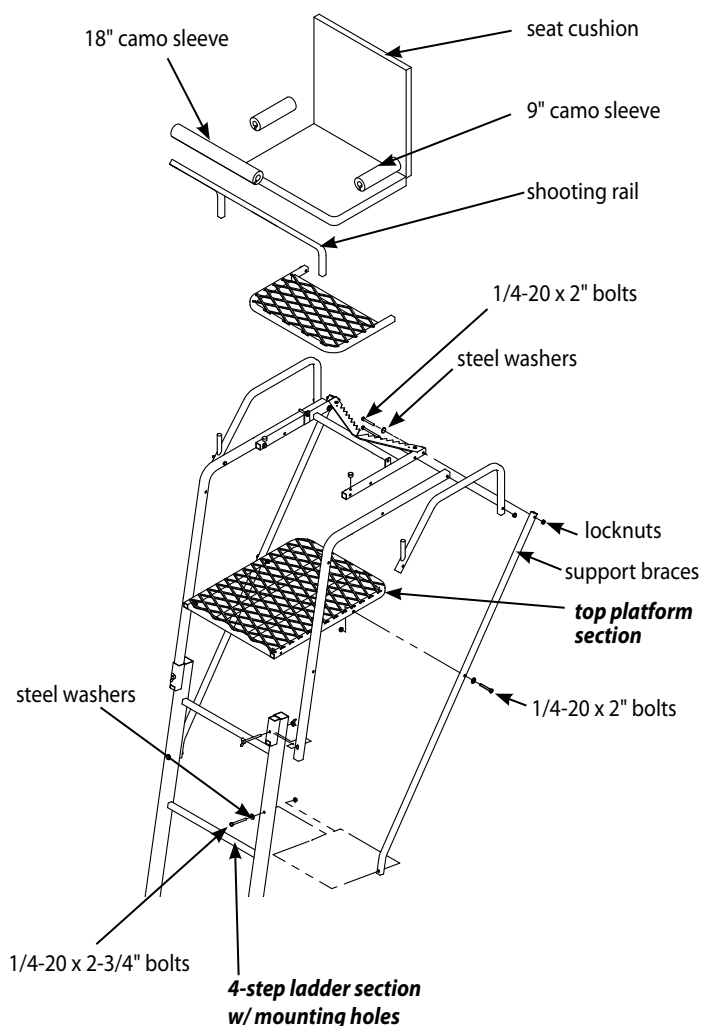

Figure 4

10. With all sections assembled together on ground, secure all sections together using (6) provided 1/4-20 x 2-1/4" wing bolts with wing nuts and (2) provided 1/4-20 x 3-1/4" hex bolts with locknuts. The longer 3-1/4" hex bolts must be used to connect the top ladder section and the assembled top platform section. **SEE FIGURE 5.**
11. a. Attach the stabilizer bar extension tube (1ML23) to the second ladder section mounting bracket using (1) provided spring lock pin. **SEE FIGURE 6.**
 b. Slide the stabilizer bar (L17) into the extension tube and attach the two pieces together using (1) provided spring lock pin. Spring lock pin must go through both the extension tube and stabilizer bar at appropriate hole to achieve desired distance from tree. Adjustment in length may be needed when ladder is uprighted later in instructions. **SEE FIGURE 6.**
12. Tie one end of each of the provided 22' ropes to the square tube side rails, just in front of the welded tree blade. Be sure your double knots are secure. **SEE FIGURE 7.**

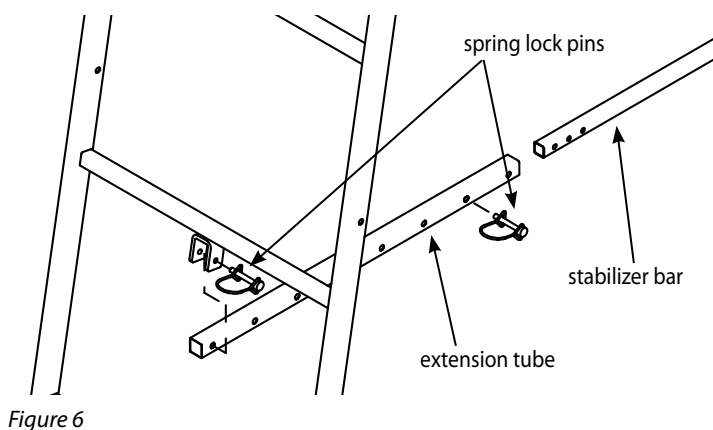

Figure 6

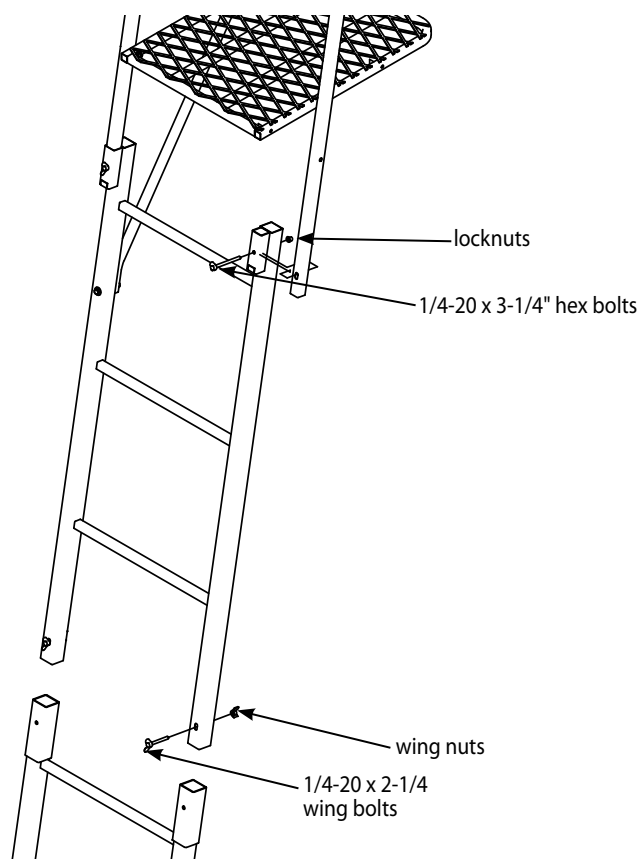

Figure 5

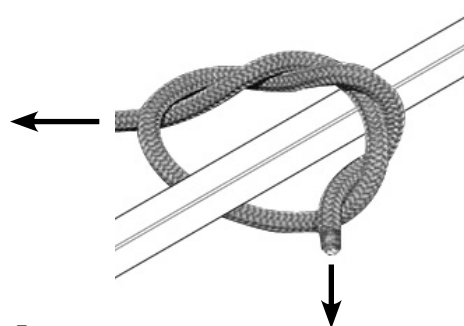
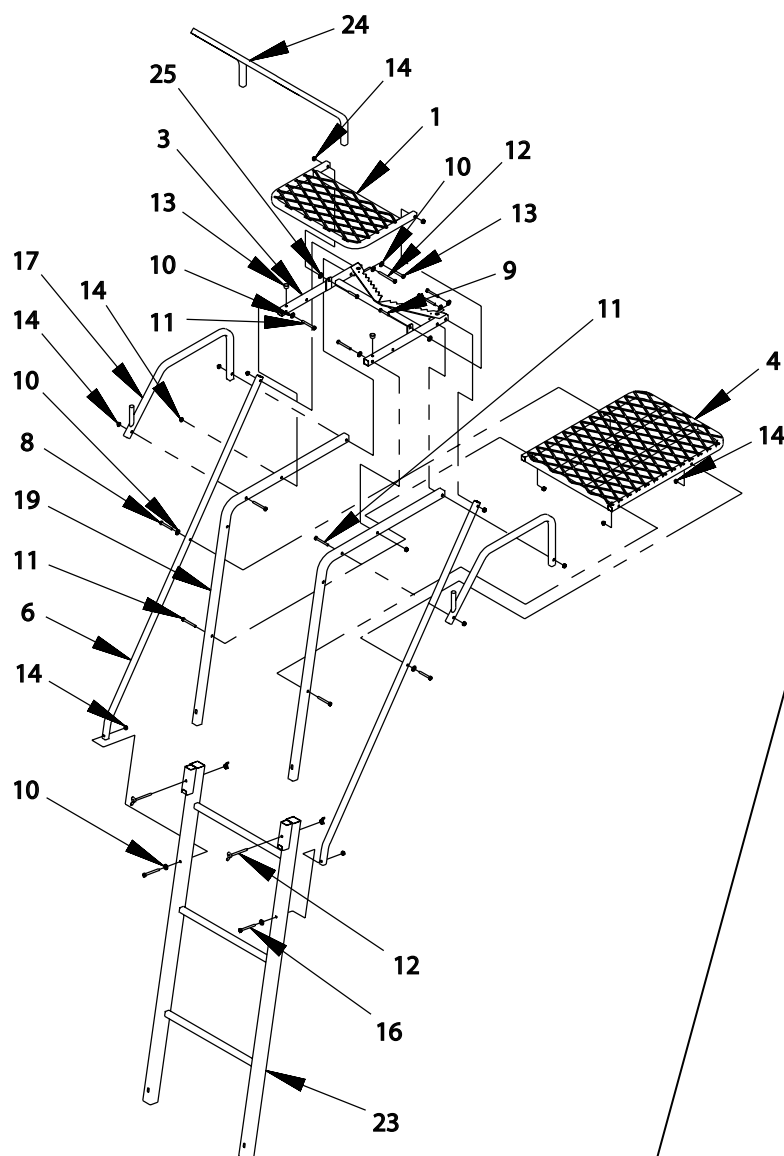

Figure 7

**NO EXTENSIONS AVAILABLE FOR THIS MODEL,
TESTED FOR 20' MAXIMUM HEIGHT!**

**LADDER PARTS -
UPPER SECTION**



**LADDER PARTS -
LOWER SECTION**

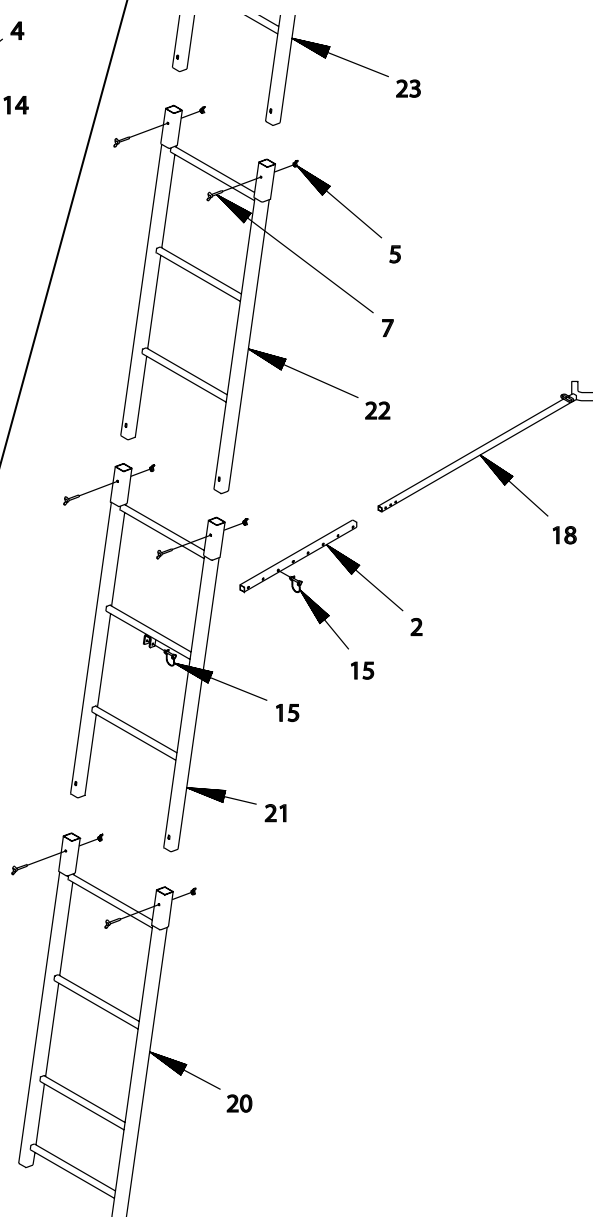

KEY #	PART #	DESCRIPTION	QTY.
1	1ML15	SEAT FRAME	1
2	1ML23	STABILIZER SUPPORT TUBE	1
3	1ML34	SEAT FRAME	1
4	1ML37	FOOT PLATFORM, LADDER	1
5	48042B	NUT, WING 1/4-20	6
6	48055	BRACE SUPPORT, 55"	2
7	48057B	SCREW, WING 1/4-20 X 2-1/4	6
8	48153B	BOLT, HHCS GR5 BLK 1/4-20 X 2	4
9	48240B	BOLT, HHCS GR5 BLK 1/4-20 X 1-1/2	2
10	48261B	WASHER, BLK 1/4	12
11	48271B	BOLT, HHCS GR5 BLK 1/4-20 X 2-1/4	6
12	48273B	BOLT, HHCS GR5 BLK 1/4-20 X 3-1/4	4
13	48679	RUBBER BUMPER STOP	2
14	48752B	NUT, FLANGED, NYLOCK 1/4-20	18
15	63281	SNAP PIN, 1/4 X 1-3/4	2
16	67540B	BOLT, HHCS GR5 BLK 1/4-20 X 2-3/4	2
17	AR12	ARMREST	2
18	L17	STABILIZER BAR	1
19	SL61	SIDE RAIL	2
20	SL71	LADDER, BOTTOM 53"	1
21	SL72	LADDER, W/VAM 53"	1
22	SL73	LADDER, 53"	1
23	SL74	LADDER, TOP 53"	1
24	SR10	SHOOTING RAIL	1
25	WN516	WASHER, BLK 5/16"	2

ITEMS BELOW NOT SHOWN

--	48819	SEAT, 1" W/ BACKREST	1
--	48737	CAMO SLEEVE, 18"	1
--	48736	CAMO SLEEVE, 9"	2
--	48415	RATCHET STRAP	2
--	48155	FULL BODY HARNESS (FAS)	1
--	48063	TIE-OFF ROPE, 22' (SOLD IN ROPE KIT ONLY)	2

FINISHED 20' LUMBERJACK EXTREME LADDER

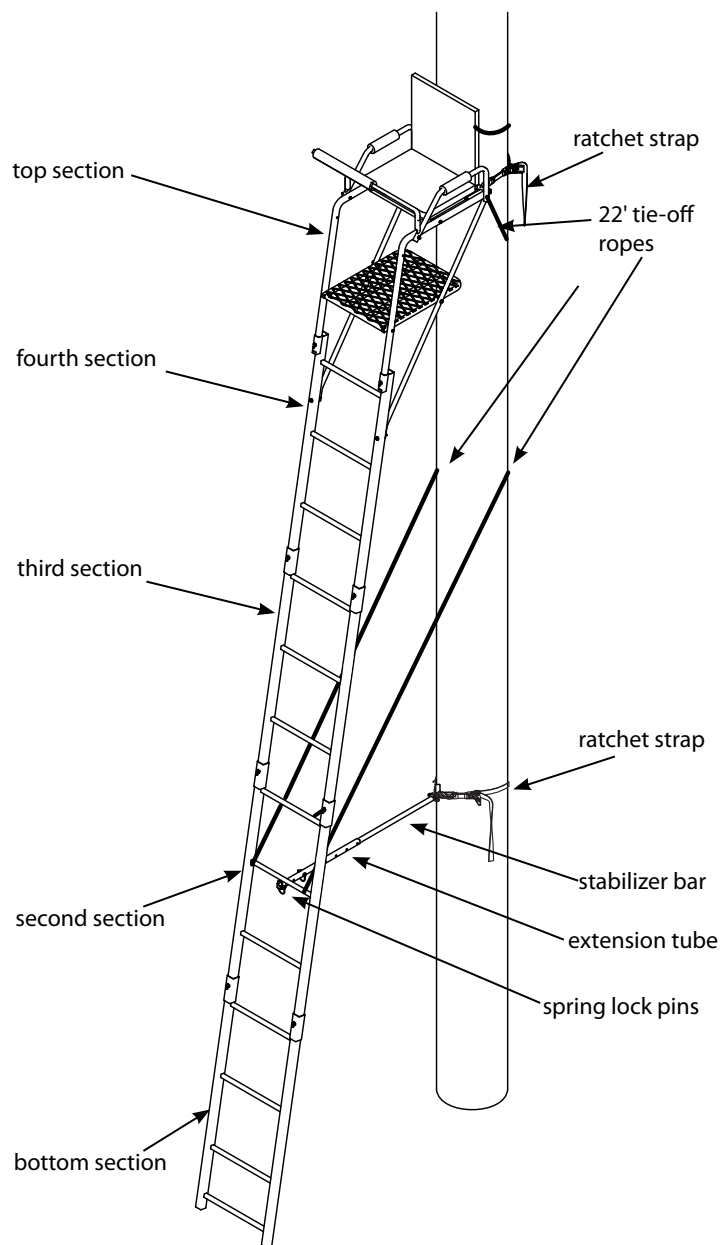

Maximum Height - 20'

Maximum Field Rating - 300 lbs.

Tree Diameter Range - 12" to 20"

ASSEMBLY INSTRUCTIONS (RE607)

Tools needed – two 7/16" wrenches

IMPORTANT ASSEMBLY TIP: Do not tighten any nut and bolt combinations completely until all parts are assembled together! Finger tighten plus one turn of a wrench only! This will temporarily hold the lock nut on the bolt while helping alignment of all parts! After all parts are assembled together, all nut & bolt combinations must be completely tightened.

1. Attach the foot platform (48045) to the inside of side rails (1ML24) using (2) provided 1/4-20 x 2-1/4" bolts and locknuts. **SEE FIGURE 1. DO NOT tighten all nut & bolt assemblies completely!**

NOTE: Mesh surface should be on top with squared ends of platform closest to side rails.

2. Attach the tree blade frame (1ML34) to the inside of side rails, and the (2) shooting rail mounts (112ML43) and (2) armrests (LFX5) to the outside of side rails using (4) provided 1/4-20 x 3-1/4" bolts, locknuts and steel washers. **SEE FIGURE 2A.**

3. Attach seat frame (1ML15) to the tabs on the tree blade frame using (2) provided 1/4-20 x 1-1/2" bolts, locknuts, nylon washers and (4) steel washers. **SEE FIGURE 2B.** Attach the (2) provided rubber bumper stops to top side of tree blade frame by pressing in to provided holes. **SEE FIGURE 2B.**

NOTE: Mesh surface of seat frame should be on top.

NOTE: Nylon washers should be placed between tabs and seat frame to eliminate noise.

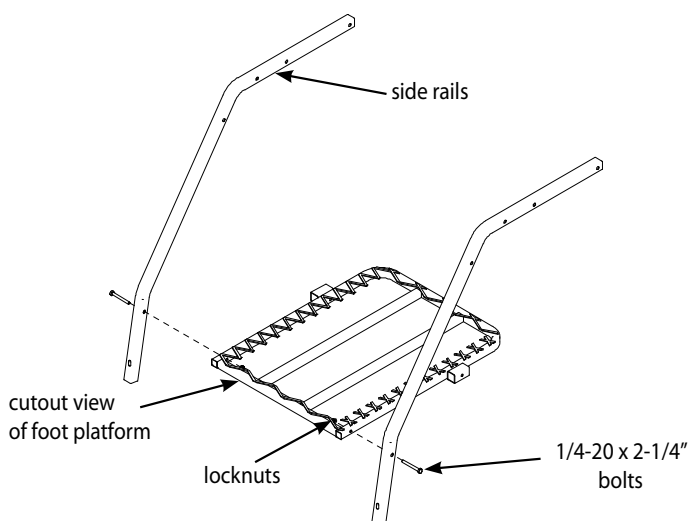

Figure 1

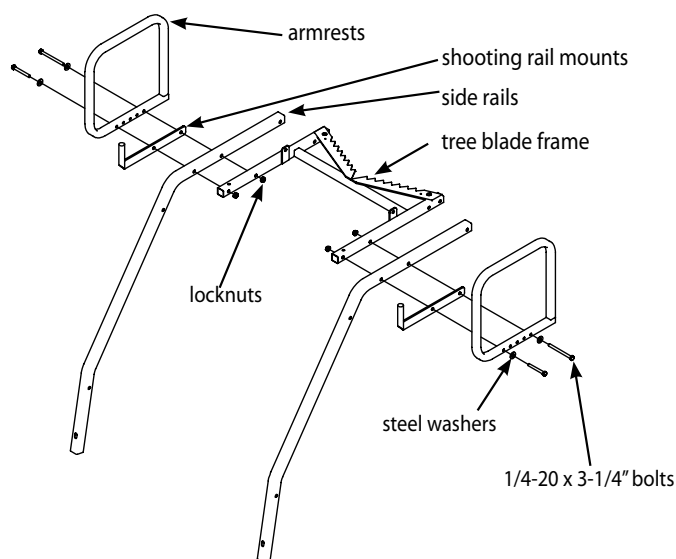

Figure 2A

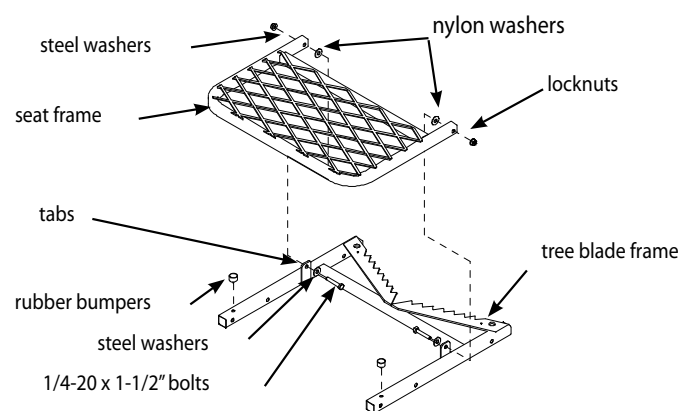

Figure 2B

4. Insert the assembled top platform section into the top ladder section with mounting holes (SL54). Attach the (2) support braces (48064) to the outside of side rails, foot platform and 4-step ladder section with mounting holes using (2) provided 1/4-20 x 3-1/4" bolts, (2) 1/4-20 x 3" bolts, (2) 1/4-20 x 2-1/4" bolts, (4) steel washers and (6) locknuts. **SEE FIGURE 3. You must now tighten all nut & bolt assemblies. Be sure not to over tighten or crush tubing when tightening!**
5. Attach the removable seat cushion (48819) to the top of seat frame. Wrap the Velcro seat straps or buckle straps around seat frame and secure together. Snap the side release buckles together for buckle style seats. Pull straps tight so seat is not loose.
6.
 - a. Attach the shooting rail (SR10) by setting rail down over studs on shooting rail mounts. **SEE FIGURE 3. Lubrication is recommended to prevent binding and noise.**
 - b. Attach the (2) provided 9" camo arm pad/shelves to the armrests and (1) 18" camo foam pad to the shooting rail by wrapping around metal tubing and attaching Velcro together. Shelves should lay out flat to the outside of armrests. Use these shelves for holding various hunting gear items so they are readily available to you during your hunt.
7. The remaining (3) ladder sections are assembled to the top ladder assembly on the ground in the following order: bottom section (SL51 ladder); second section (SL52 ladder); third section (SL51 ladder); fourth section (SL54 ladder); top section (assembled top platform section). **SEE FINISHED 22' TIMBERSHOT EXTREME LADDER.**

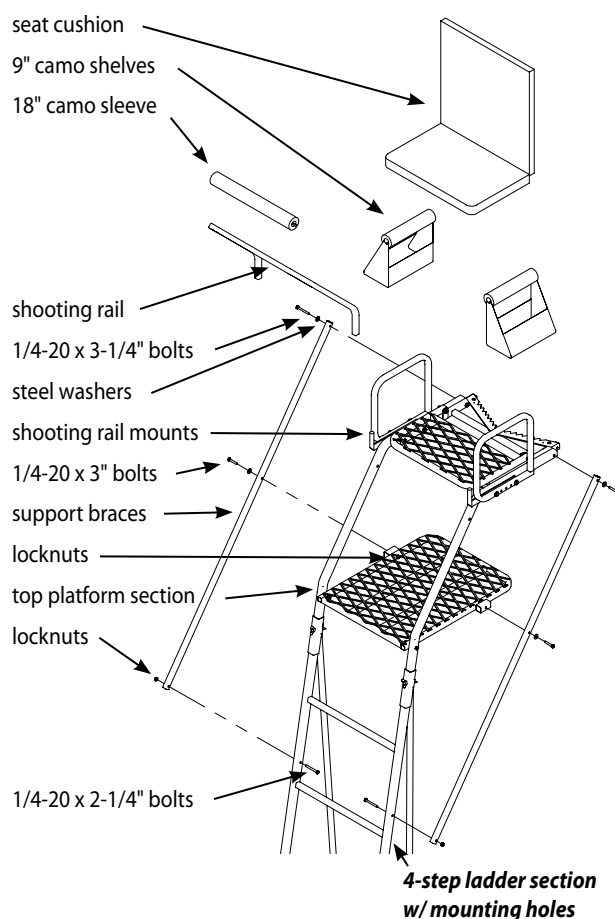

Figure 3

8. Attach the truss support (48023) to where the second and third ladder sections have been slid together, using (2) provided 1/4-20 x 1-3/4" wing bolts and wing nuts. **SEE FIGURE 4.**

9. a. Attach the counter lock support bar (48025) to the truss support mounting bracket using (1) provided 1-3/4" spring lock pin. **SEE FIGURE 4.**

b. Attach the opposite end of counter lock support bar and the stabilizer bar extension tube (1ML23) to the second ladder section mounting bracket using (1) provided 2-1/2" spring lock pin. **SEE FIGURE 4.**

NOTE: Pin may have a tight fit. This is normal due to the counter lock support bar acting as a locking bar. You may need to temporarily loosen the wing nuts/bolts on truss support to help with hole alignment. Retighten wing nuts/bolts when complete.

c. Slide the stabilizer bar (L17) into the extension tube and attach the two pieces together using (1) provided 1-3/4" spring lock pin. Spring lock pin must go through both the extension tube and the stabilizer bar at appropriate hole to achieve desired distance from tree. Adjustment in length may be needed when ladder is uprighted later in instructions. **SEE FIGURE 4.**

10. Insert the (4) truss male braces (48041) into the (4) truss female braces (48040). Have the flattened end of the braces oriented in opposite directions of each other and align the holes to secure the braces together using (4) provided 1/4-20 x 1-1/4" bolts and locknuts. **SEE FIGURE 5 ON FOLLOWING PAGE. Tighten securely, being careful not to over tighten or crush tubing!**

NOTE: You must be sure to have the flattened ends of braces oriented in opposite directions of each other so they will align properly (flush) to the mating parts later on in assembly.

11. a. Attach (2) assembled braces to where the fourth ladder section and assembled top platform section have been slid together using (2) provided 1/4-20 x 1-3/4" wing bolts and wing nuts. You must attach the flattened end of these braces so that it will cause them to angle away from the ladder, towards the rounded end of truss support. It is recommended to position the female end of these upper brace assemblies to the top of the ladder so water will drain freely during use. **SEE FIGURE 5 AND 6 ON FOLLOWING PAGE.**

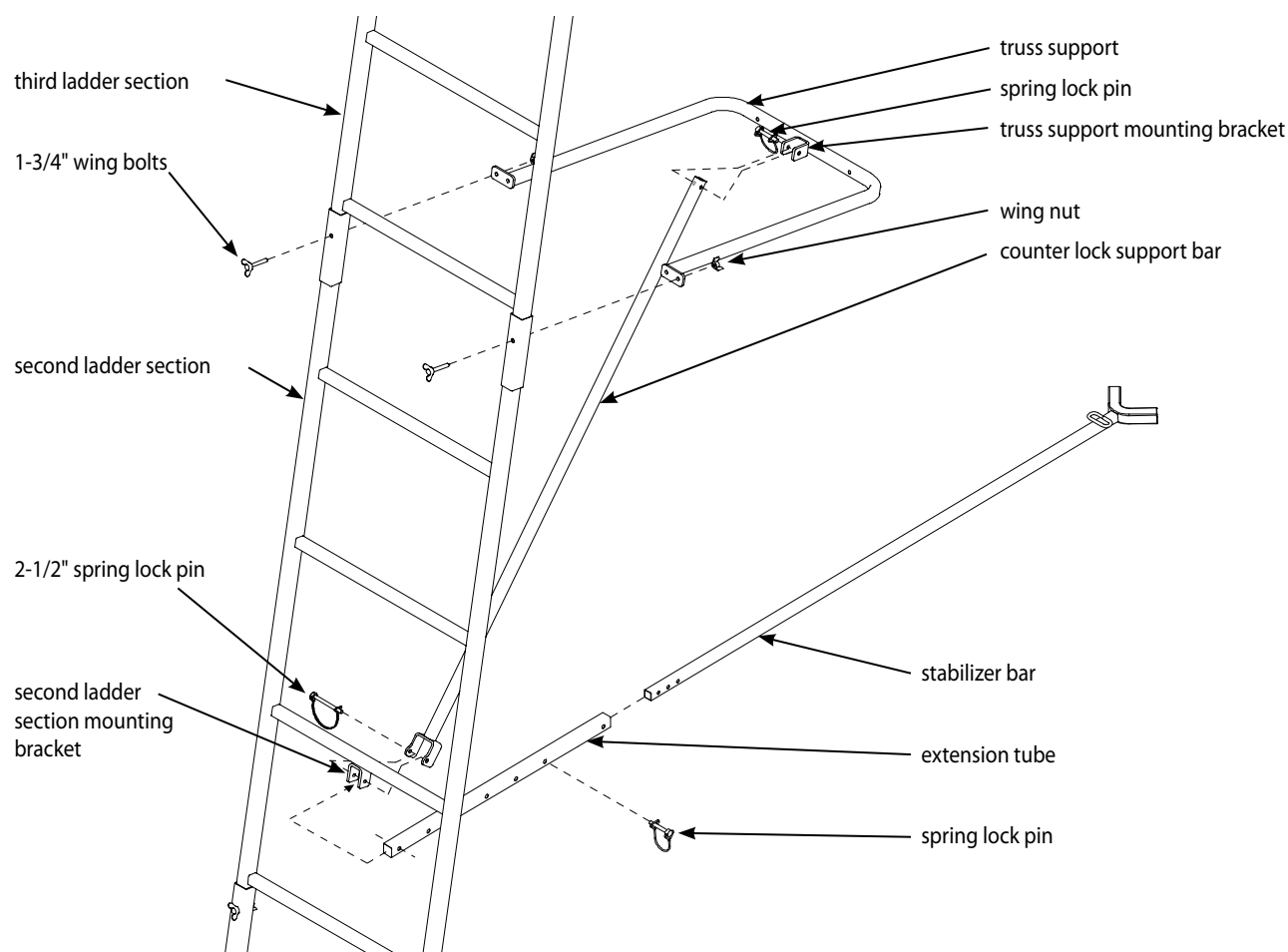

Figure 4

b. Attach the remaining (2) assembled braces and the opposite end of previously assembled braces to the truss support using (2) provided 1/4-20 x 1-3/4" wing bolts and wing nuts. You must attach the flattened end of braces so that it will cause the lower braces to angle towards the bottom end of ladder. It is recommended to position the female end of these lower brace assemblies to the truss support so water will drain freely during use. **SEE FIGURE 5.**

NOTE: Lifting on the bottom end of ladder will be needed to help align the holes in the flattened end of brace assemblies to the holes in the truss support as you are beginning to put the pre-built strength "arch" in the ladder assembly. This is normal.

c. Attach the opposite end of lower brace assemblies to the bottom ladder section using (2) provided 1/4-20 x 1-3/4" wing bolts and wing nuts. **SEE FIGURE 5.**

NOTE: Lifting on the bottom end of ladder will be needed to help align the holes in the flattened end of brace assemblies to the slots in the bottom ladder section as you are completing the pre-built strength "arch" in the ladder assembly. This is normal.

d. Secure the first and second ladder sections as well as the third and fourth ladder sections together using (4) provided 1/4-20 x 1-3/4" wing bolts and wing nuts. **SEE FIGURE 6.**

12. **Tighten all wing bolt/wing nut combinations securely by hand. Be sure not to over tighten or crush tubing. Double and triple check all hardware locations to make sure they are all securely fastened.**
13. Tie one end of each of the provided 22' ropes to the platform side rails, just in front of the tree blade. **Be sure your double knots are secure. SEE FIGURE 7.**

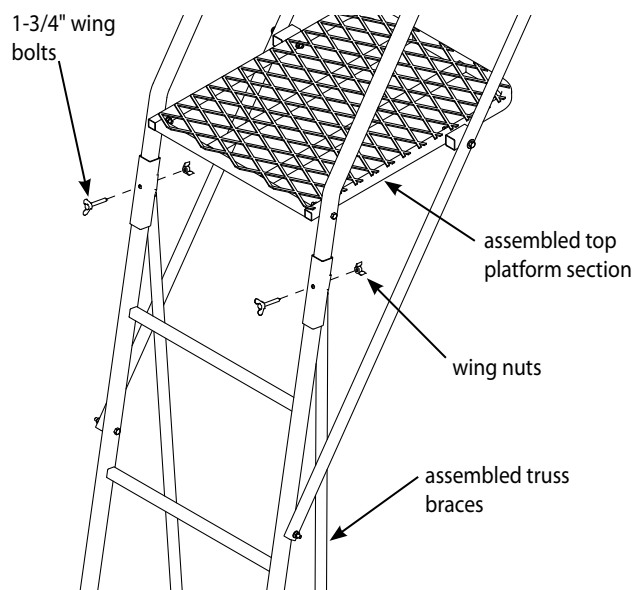

Figure 6

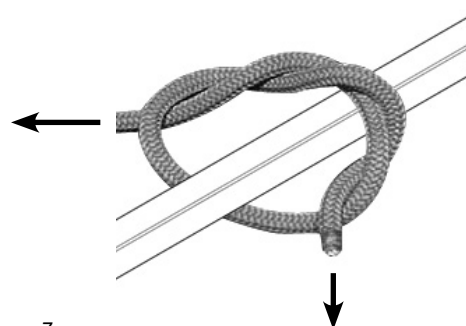

Figure 7

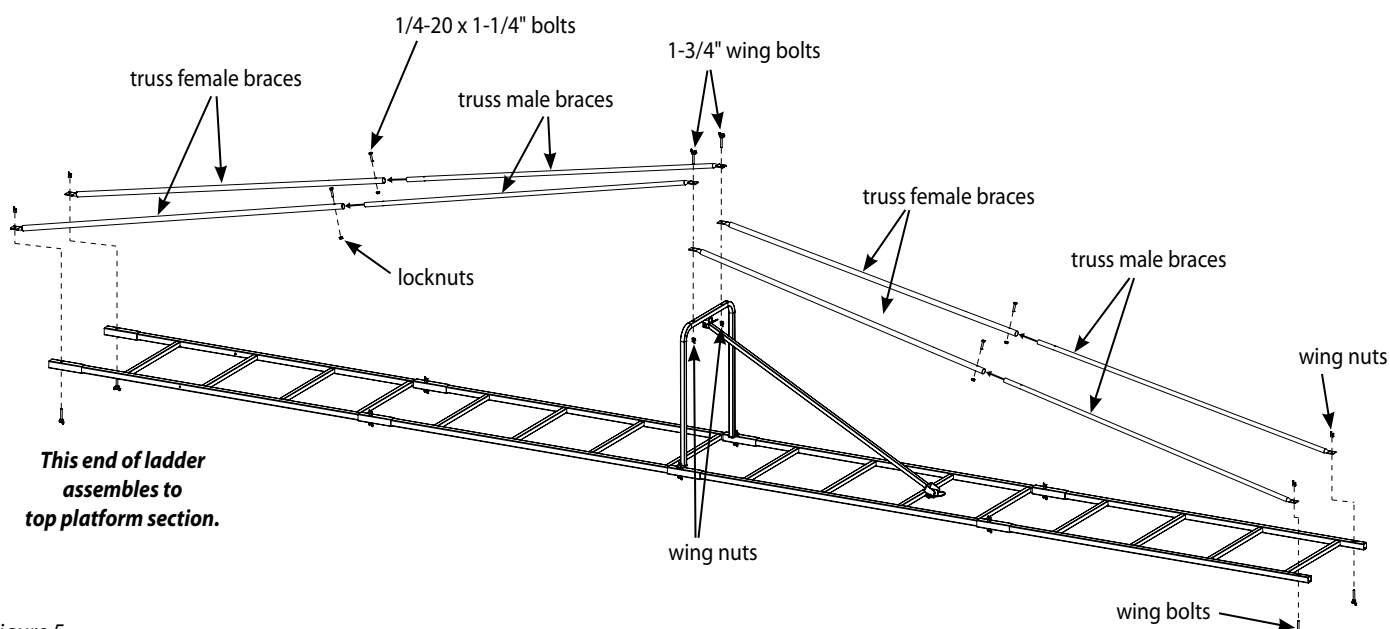
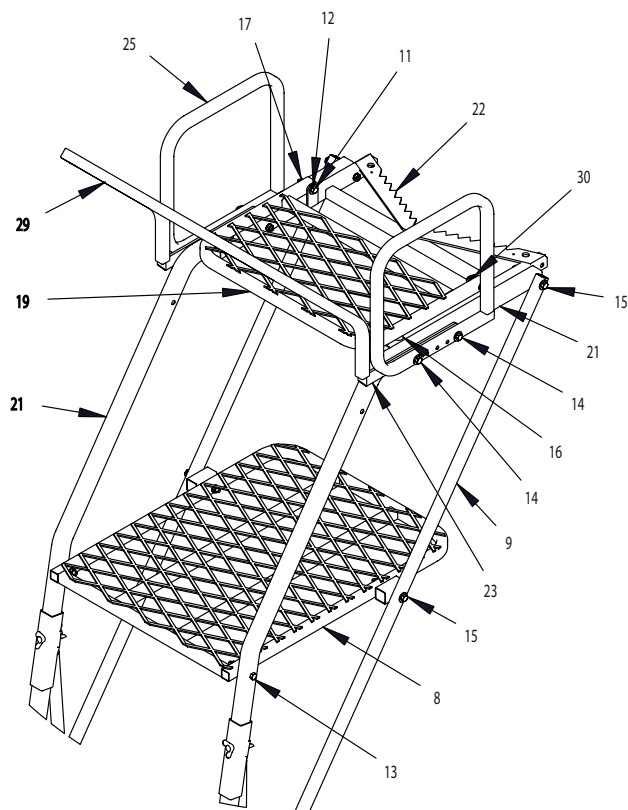
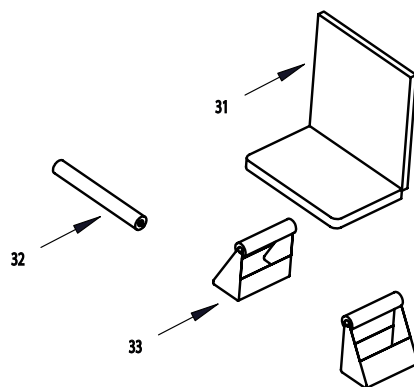
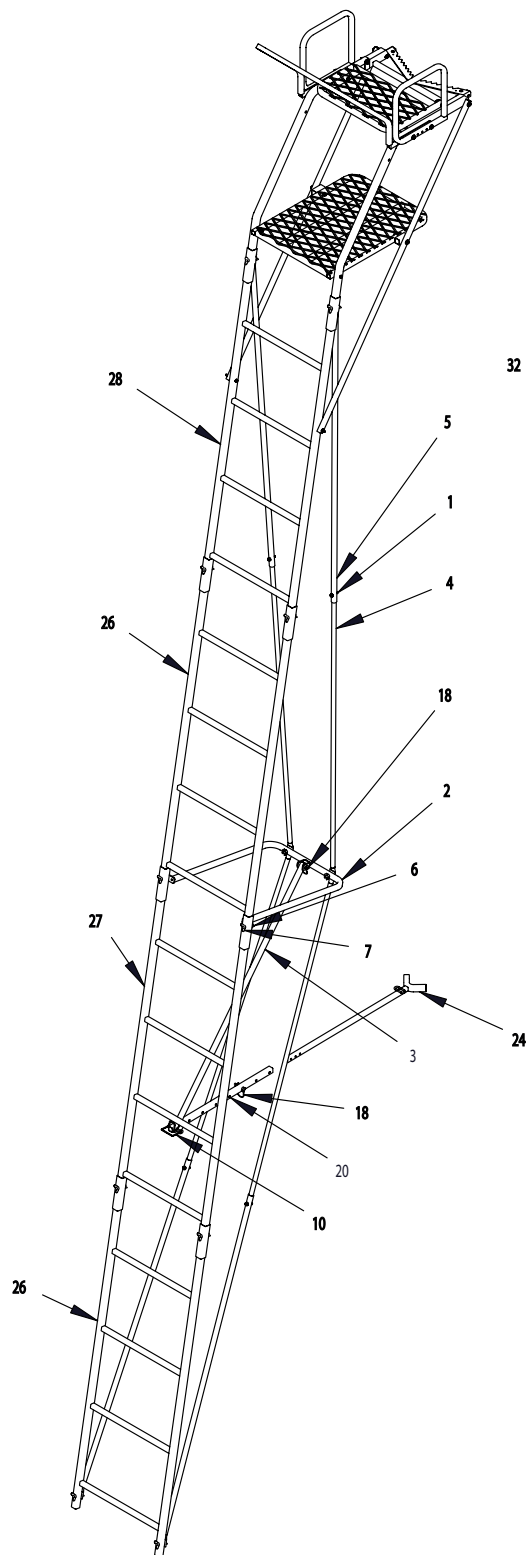

Figure 5

LADDER PARTS (RE607)

**NO EXTENSIONS AVAILABLE FOR THIS MODEL,
TESTED FOR 22' MAXIMUM HEIGHT!**



LADDER PARTS LIST (RE607)

KEY #	PART #	DESCRIPTION	QTY.
1	8909B	BOLT, HHCS GR5 BLK 1/4-20 X 1-1/4"	4
2	48023	TRUSS SUPPORT	1
3	48025	COUNTER LOCK SUPPORT BAR	1
4	48040	BRACE, FEMALE TRUSS	4
5	48041	BRACE, MALE TRUSS	4
6	48042B	WING NUT 1/4-20	12
7	48044B	WING BOLT 1/4-20 X 1-3/4"	12
8	48045	FOOT PLATFORM	1
9	48064	SUPPORT BRACE	2
10	48090	LOCK PIN 1/4 X 2-1/2"	1
11	48240B	BOLT, HHCS GR5 BLK 1/4-20 X 1-1/2"	2
12	48261B	WASHER, BLK 1/4"	12
13	48271B	BOLT, HHCS GR5 BLK 1/4-20 X 2-1/4"	4
14	48273B	BOLT, HHCS GR5 BLK 1/4-20 X 3-1/4"	6
15	48280B	BOLT, HHCS GR5 BLK 1/4-20 X 3"	2
16	48679	RUBBER BUMPER STOP	2
17	48752B	NUT, FLANGED NYLOCK 1/4-20	18
18	63281	SPRING LOCK PIN, ROUNDED RETAINER 1/4 X 1-3/4"	2
19	1ML15	SEAT PLATFORM FRAME	1
20	1ML23	SUPPORT TUBE, STABILIZER	1
21	1ML24	SIDE RAIL	2
22	1ML34	SEAT PLATFORM	1
23	112ML43	MOUNT, SHOOTING RAIL	2
24	L17	STABILIZER BAR, 39"	1
25	LFX5	ARMREST, BOLT-ON	2
26	SL51	4-STEP LADDER, POCKET/PIN STYLE	2
27	SL52	4-STEP LADDER W/VAM, POCKET/PIN STYLE	1
28	SL54	4-STEP LADDER W/MOUNTING HOLES, POCKET/PIN STYLE	1
29	SR10	SHOOTING RAIL	1
30	WN516	WASHER, NYLON BLK 5/16"	2
31	48819	SEAT, 1" W/ BACKREST	1
32	48737	CAMO SLEEVE, 18"	1
33	48021	CAMO SHELF, 9"	2
ITEMS BELOW NOT SHOWN			
--	48415	RATCHET STRAP	2
--	48155	FULL BODY HARNESS (FAS)	1
--	48063	TIE-OFF ROPE, 22' (SOLD IN ROPE KIT ONLY)	2

FINISHED 22' TIMBERSHOT EXTREME LADDER

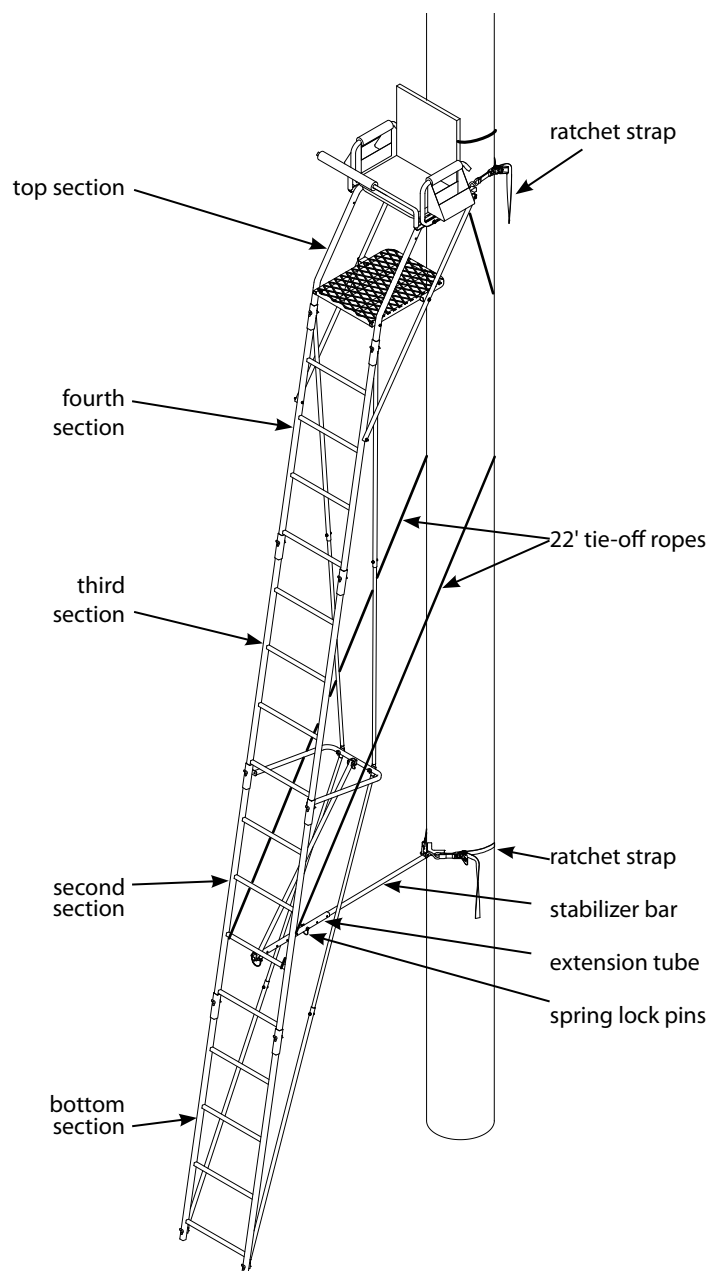

Maximum Height - 22'

Maximum Field Rating - 300 lbs.

Tree Diameter Range - 12" to 20"

ASSEMBLY INSTRUCTIONS (RE623)

Tools needed – two 7/16" wrenches, rubber mallet

IMPORTANT ASSEMBLY TIP: DO NOT TIGHTEN NUT & BOLT COMBINATIONS COMPLETELY UNTIL ALL PARTS ARE ASSEMBLED TOGETHER! FINGER TIGHTEN ONLY PLUS ONE TURN OF A WRENCH ONLY! THIS WILL TEMPORARILY HOLD THE LOCK NUT ON THE BOLT WHILE HELPING ALIGNMENT OF ALL PARTS! AFTER ALL PARTS ARE ASSEMBLED TOGETHER, ALL NUT & BOLT COMBINATIONS MUST BE COMPLETELY TIGHTENED!

1. Attach (1) ladder receiver J-pipe (112ML70) to the bottom of left foot platform (112ML66) and (1) ladder receiver J-pipe to the bottom of right platform (112ML69) using (4) provided 1/4-20 x 2-1/2" bolts, locknuts and steel washers. **SEE FIGURE 1. DO NOT tighten all nut and bolt assemblies completely!**

NOTE: Mesh surface should be on top.

2. Attach left and right platforms together using (2) provided 1/4-20 x 2-1/2" bolts, locknuts and steel washers. **SEE FIGURE 1.**
3. Attach (1) platform spanner tube (112ML77) to the bottom of assembled platforms (near front end of platforms) using (4) provided 1/4-20 x 2-1/2" bolts, locknuts and steel washers. **SEE FIGURE 2.**

NOTE: Pockets of platform spanner tubes should be orientated upward.

4. Attach (1) platform spanner tube (112ML77) and (2) support tubes (112ML75) to the bottom of assembled platforms (near back end of platforms) using (2) provided 1/4-20 x 3-1/4" bolts, (2) 1/4-20 x 2-1/2" bolts, (4) locknuts and (4) steel washers. **SEE FIGURE 2.**

NOTE: Pockets of platform spanner tubes should be orientated upward.

NOTE: Bent ends of support tubes must be attached to the platform spanner tubes.

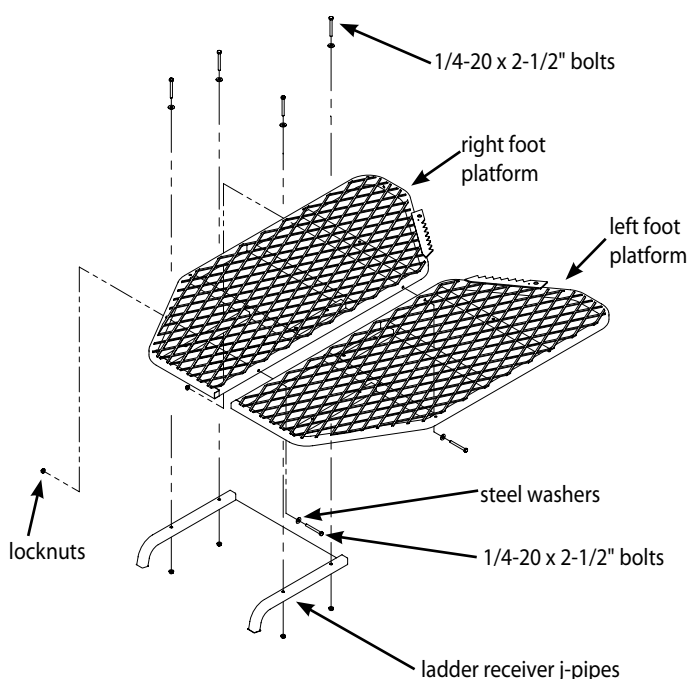

Figure 1

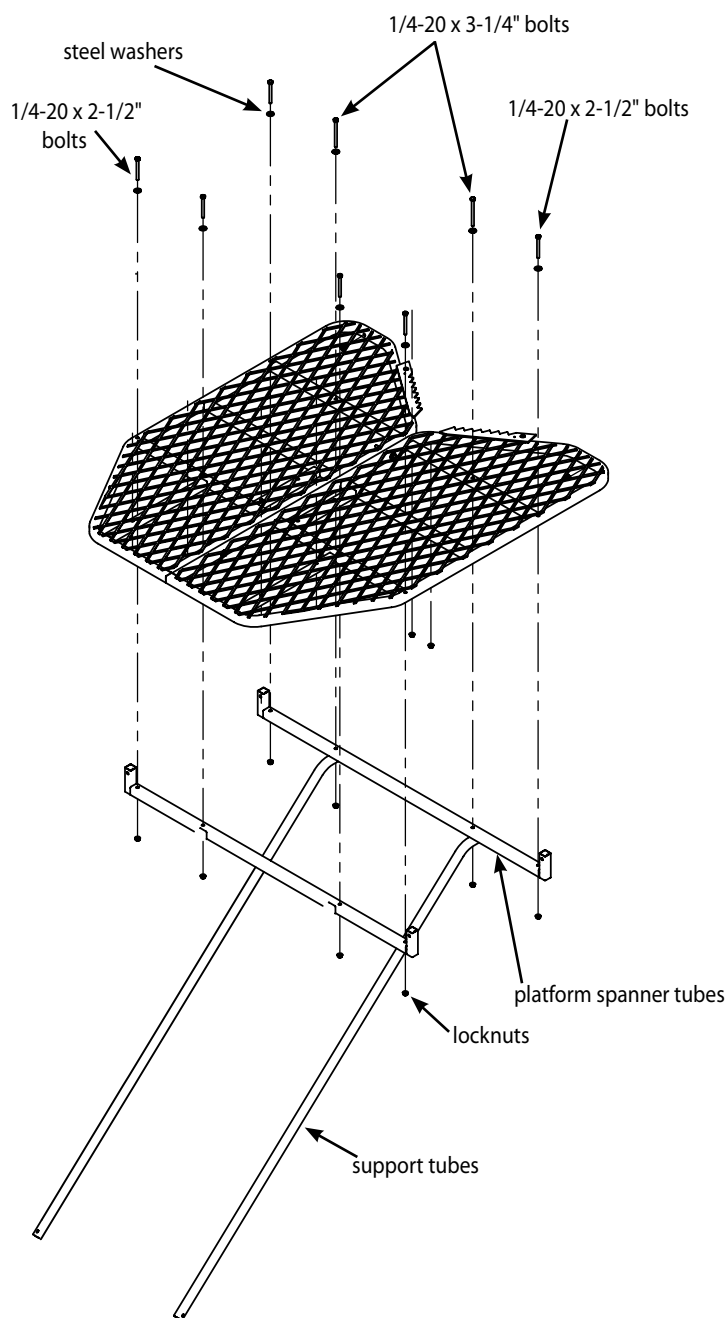

Figure 2

5. Insert the two ladder receiver J-pipes (already assembled onto the platform) into the pockets of the top ladder section with side holes (SL78). Attach the (2) support tubes (112ML75) to the outside of top ladder section using (2) provided 1/4-20 x 2-1/4" bolts and locknuts. Secure the top ladder section and assembled top platform section together using (2) provided spring lock pins. Handle of spring lock pin must be put to the outside of ladder side rails. **SEE FIGURE 3.**

6. Attach the tree blade weldment (112ML73) to the top side of assembled platforms (near welded on platform tree blades) using (2) provided 1/4-20 x 2-1/4" bolts, locknuts and steel washers. **SEE FIGURE 4.**

NOTE: Teeth of tree blade weldment should point to the rear of assembled platforms, in the same direction as platform tree blades.

7. Attach (2) tree blade support braces (112ML76) to the front side of tree blade weldment and back side of the assembled platforms using (3) 1/4-20 x 1-1/2" bolts and (3) locknuts. **SEE FIGURE 4. Pay special attention to the orientation of the support braces shown in Figure 4.**

8. Using the end with the greater distance from hole to end of tube, insert (4) shooting rail uprights (112ML72) into pockets of platform spanner tubes. Secure each upright in the pocket using (4) 1/4-20 x 1-1/4" bolts, locknuts and steel washers. **SEE FIGURE 5.**

9. Insert (2) curtain/shooting rail rims (112ML71) into each end of the rail spanner tube (TWR26) and secure using (2) provided 1/4-20 x 1-1/4" bolts, locknuts and steel washers. **SEE FIGURE 5. Pay special attention to the orientation of shooting rail rims in Figure 5.**

10. Attach the assembled shooting rail to the inside of shooting rail uprights using (4) provided 1/4-20 x 1-3/4" bolts & locknuts. **SEE FIGURE 5. You must now tighten all nut & bolt assemblies. Be sure not to over tighten or crush tubing when tightening!**

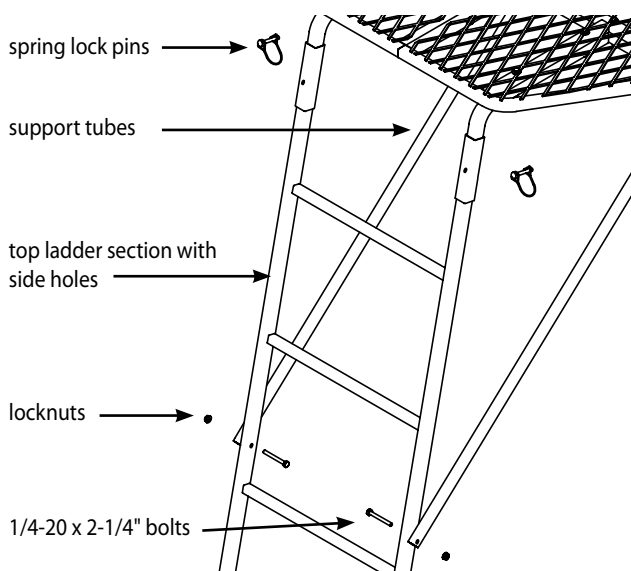

Figure 3

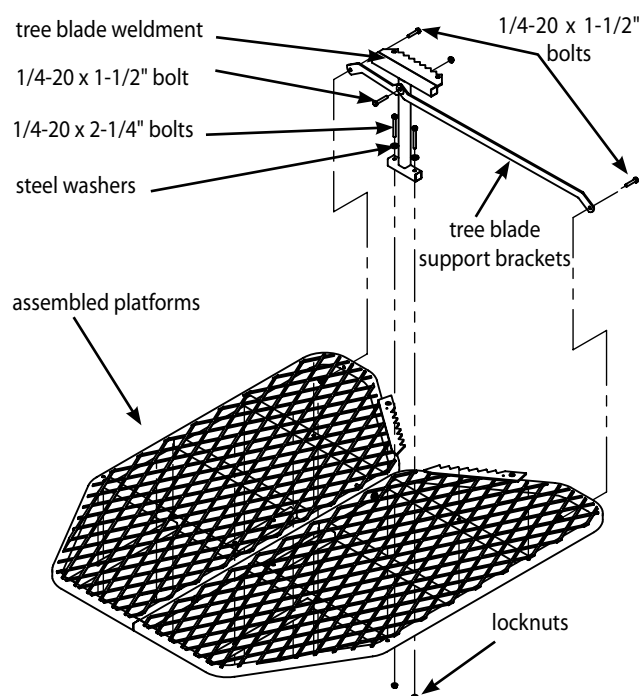

Figure 4

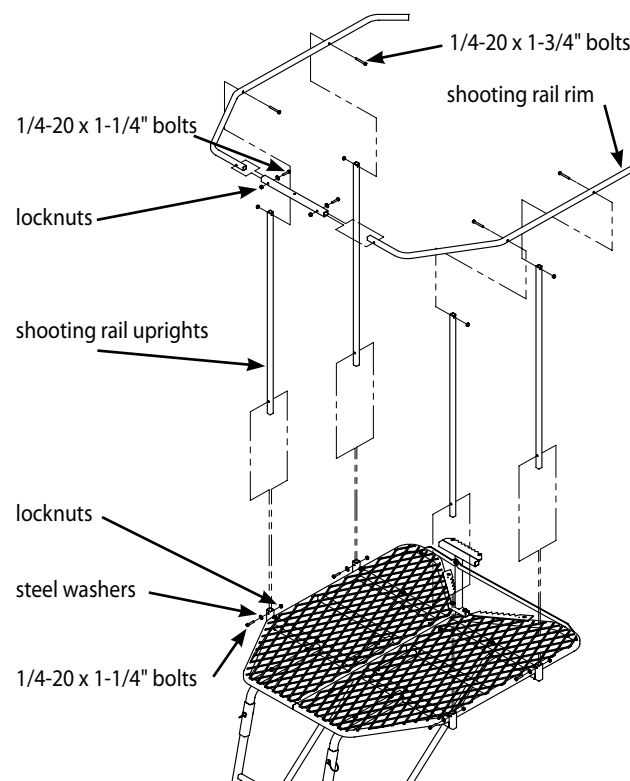

Figure 5

SWIVEL SEAT ASSEMBLY INSTRUCTIONS

NOTE: Swivel seat assembly must be assembled on the ground. Do not attach to platform until ladder is uprighted, attached to the tree per Set-Up and Use Instructions, and you are attached to the tree with the provided Full Body Harness.

11. Attach swivel (48662) to either end of seat post (TP11) using (4) provided 1/4-20 x 3/4" bolts and locknuts. **SEE FIGURE 6.**

NOTE: Make sure head of bolts are on swivel side and nut on bottom of seat post plate to prevent any obstruction when swivel is pivoted during use.

12. Attach seat frame (TP154) to swivel using (4) provided 1/4-20 x 1-1/4" bolts and locknuts. **SEE FIGURE 6.**

NOTE: Make sure head of bolts are on swivel side and nut on top of seat frame to prevent any obstruction when swivel is pivoted during use. Mesh surface should be on top.

13. Attach backrest rim (TP165) to tabs of seat frame using (2) provided 1/4-20 x 1-1/4" bolts and locknuts. **SEE FIGURE 6.**

14. Attach the (2) armrests (TP164) to the seat frame and backrest rim using (4) provided 1/4-20 x 2" bolts, locknuts and steel washers. **SEE FIGURE 6. You must now tighten all nut & bolt assemblies. Be sure not to over tighten or crush tubing when tightening!**

NOTE: The armrests are approximately 1" longer on one side. Bolt the longer side to the backrest rim and the shorter side to the seat frame.

15. a. Attach the removable seat cushion (48127) to the top of seat frame. Wrap the Velcro straps or buckle straps around seat frame and secure together. Snap the side release buckles together for buckle style seats. Pull straps tight so seat is not loose.

b. Attach the removable backrest cushion (48128) by sliding pocket portion over the metal backrest frame. Wrap the Velcro straps around backrest crossbar and secure together. Pull tight so backrest is not loose.

c. Using a rubber mallet, tap in (2) plastic pipe plugs (48869) into each end of the shooting rail.

d. Attach the (2) provided 9" camo sleeves (48736) to the armrests and the (1) 128" camo sleeve (48129) to the shooting rail by wrapping around metal tubing and attaching Velcro together.

e. Attach the camo curtain (48086) to the shooting rail/platform by wrapping top edge around padded shooting rail and attaching Velcro together. Zippered door should be aligned with the ladder. Pull the bottom edge with elastic down and secure Velcro straps around platform frame.

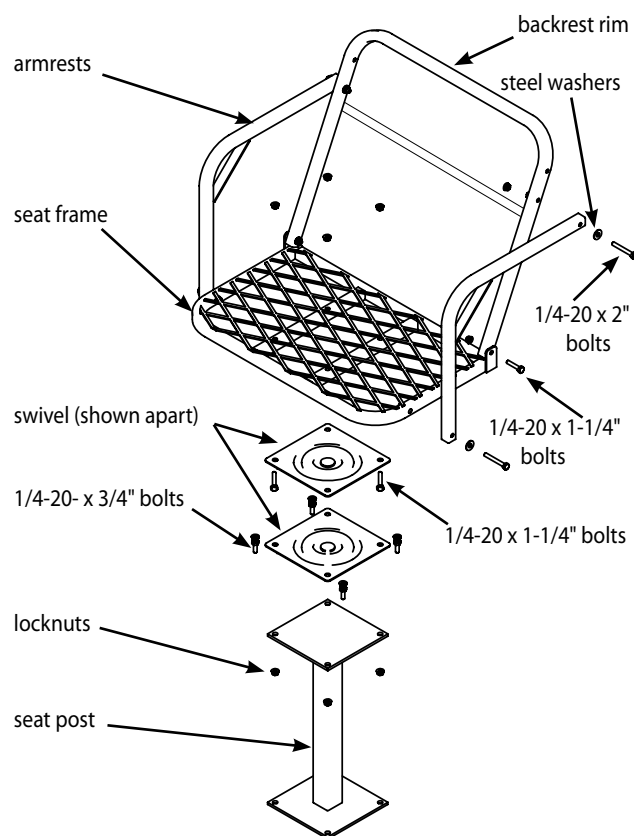

Figure 6

16. The remaining (2) ladder sections are assembled to the top ladder assembly on the ground in the following order: bottom section (SL51 ladder); second section (SL52 ladder); third section (SL78 ladder); top section (assembled top, platform section). **SEE FINISHED 17' SPIN SHOT LADDER.**
17. With all sections assembled together on ground, secure all sections together using (4) provided spring lock pins. Handle of spring lock pin must be put to the outside of ladder side rails. **SEE FIGURE 7.**
18. a. Attach the stabilizer bar extension tube (48053) to the second ladder section mounting bracket using (1) provided spring lock pin. **SEE FIGURE 7.**
b. Slide the stabilizer bar (48052) into the extension tube and attach the two pieces together using (1) provided spring lock pin. Spring lock pin must go through both the extension tube and stabilizer bar at appropriate hole to achieve desired distance from tree. Adjustment in length may be needed when ladder is uprighted later in instructions. **SEE FIGURE 7.**
19. Tie one end of each of the provided 15' ropes to the square tube platform rim, next to the bolted on tree blade support braces. Be sure your double knots are secure. **SEE FIGURE 8.**

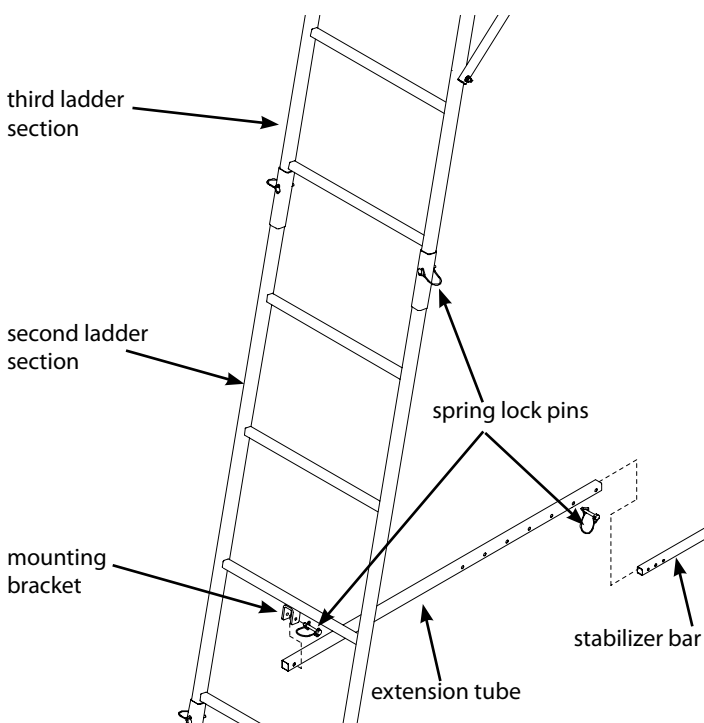

Figure 7

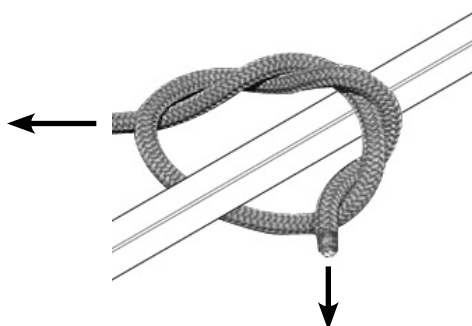
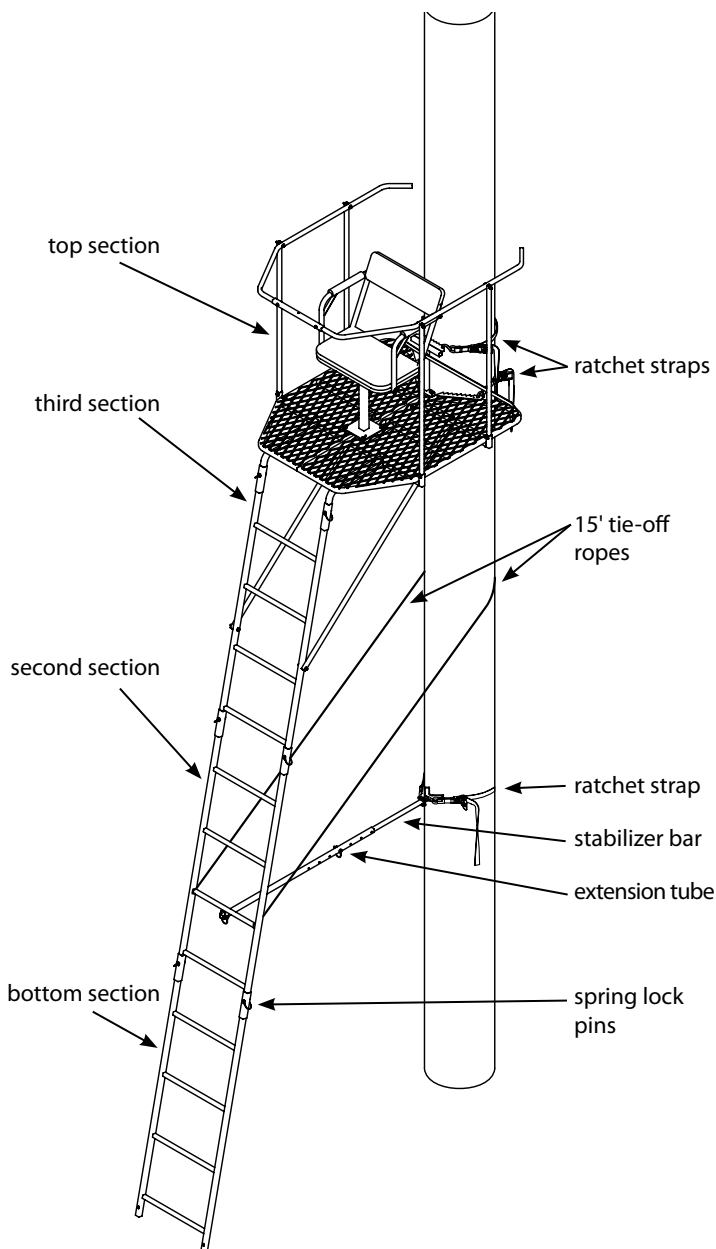
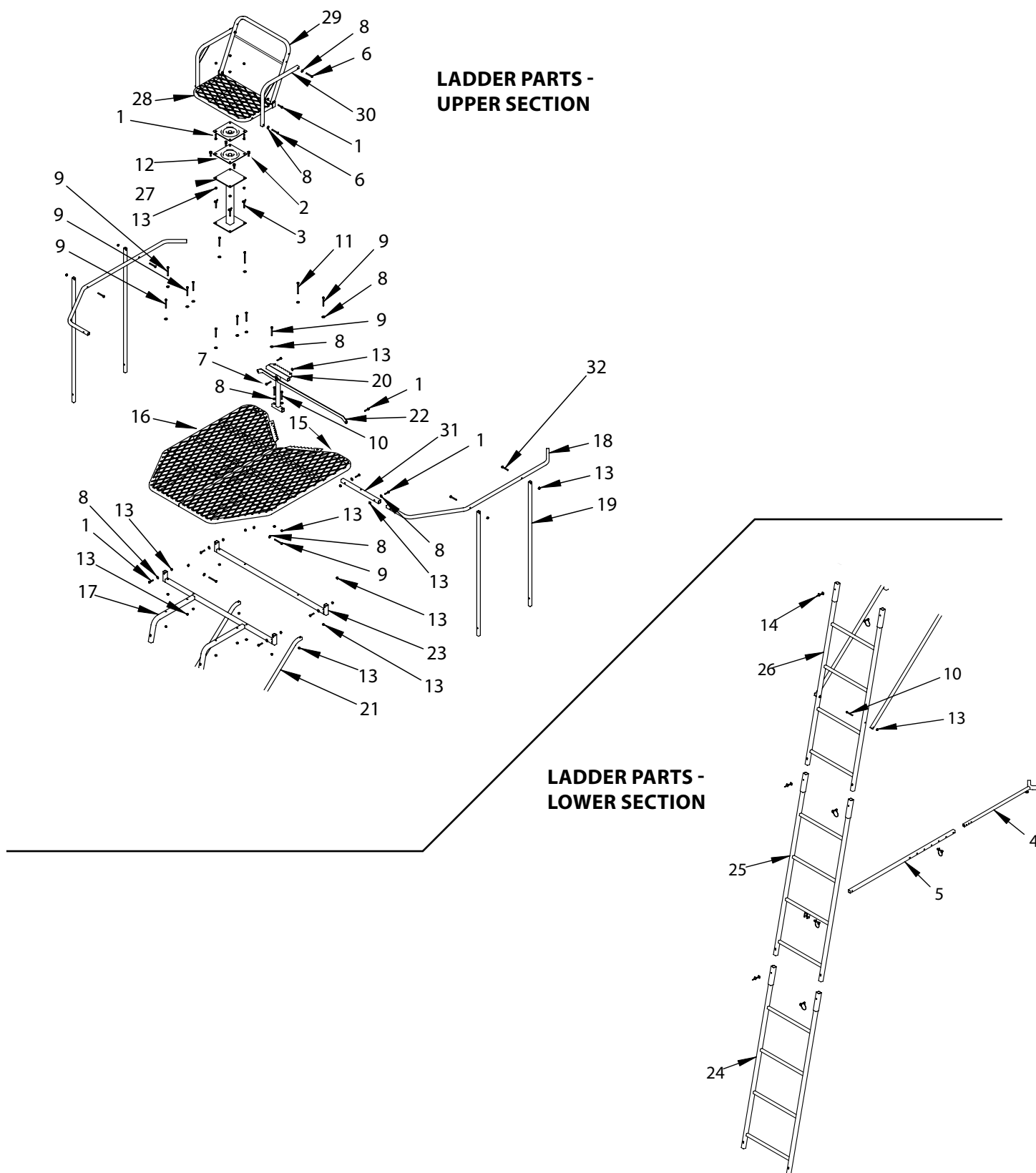

Figure 8

FINISHED 17' SPIN SHOT LADDER





LADDER PARTS LIST

KEY #	PART #	DESCRIPTION	QTY.
1	8909B	BOLT 1/4-20 X 1-1/4" HHCS GR5 BLK ZN	12
2	8930B	BOLT 1/4-20 X 3/4" HH GR5 BLK ZN	4
3	48044B	SCREW, WING 1/4-20 X 1-3/4"	4
4	48052	WELDMENT, STABILIZER BAR, 27"	1
5	48053	TUBE, STABILIZER, SUPPORT	1
6	48153B	BOLT 1/4-20 X 2" HHCS GR5 BLK ZN	4
7	48240B	BOLT 1/4-20 X 1-1/2" HHCS GR5 BLK ZN	3
8	48261B	WASHER FLAT 1/4" BLACK	26
9	48270B	BOLT 1/4-20 X 2-1/2" HHCS GR5 BLK ZN	12
10	48271B	BOLT 1/4-20 X 2-1/4" HHCS GR5 BLK ZN	4
11	48273B	BOLT 1/4-20 X 3-1/4" HHCS GR5 BLK ZN	2
12	48662	SWIVEL ONLY - LADDER POD SEAT	1
13	48752B	NUT, FLANGED, NYLOCK, 1/4-20"	45
14	63281	SNAP PIN, 1/4 X 1-3/4, ROUNDED RETAINER	8
15	112ML66	WELDMENT, PLATFORM, LEFT	1
16	112ML69	WELDMENT, PLATFORM, RIGHT	1
17	112ML70	RECEIVER, LADDER	2
18	112ML71	RAIL, CURTAIN	2
19	112ML72	RAIL, UPRIGHT, SHOOTING RAIL, 40"	4
20	112ML73	WELDMENT, TREE BLADE	1
21	112ML75	TUBE, SUPPORT 58-1/2"	2
22	112ML76	BRACE, SUPPORT, TREE BLADE	2
23	112ML77	WELDMENT, FTS, SPANNER, PLATFORM	2
24	SL51	WELDMENT, LADDER, 4-STEP, POCKET/PIN STYLE	1
25	SL52	WELDMENT, LADDER, 4-STEP, W/ VAM, POCKET/PIN STYLE	1
26	SL78	WELDMENT, LADDER, 4-STEP W/ HOLES, POCKET/PIN STYLE	1
27	TP11	WELDMENT - SEAT POST LADDER POD	1
28	TP154	WELDMENT, SEAT, POD, 20" X 12"	1
29	TP165	FTS, BACKREST, POD	1
30	TP164	WELDMENT, ARM REST, POD	2
31	TWR26	TUBE, RAIL SPANNER, TOWER	1
32	48250B	BOLT - 1/4-20 X 1-3/4"	4

**NO EXTENSIONS AVAILABLE
FOR THIS MODEL,
TESTED FOR 17' MAXIMUM HEIGHT!**

ITEMS NOT SHOWN:

PART #	DESCRIPTION	QTY.
48869	PIPE PLUG, 18MM	2
48127	PADDED SEAT	1
48128	PADDED BACKREST	1
48736	9" CAMO PAD	2
48129	128" CAMO PAD	1
48086	CAMO CURTAIN	1
48164	HARNESS FAS, 39" TETHER W/SRD	1
48415	RATCHET STRAP	3
48691	TIE-OFF ROPE KIT	1

Maximum Height - 17'

Maximum Field Rating - 300 lbs.

Tree Diameter Range - 12" to 20"

ASSEMBLY INSTRUCTIONS (RE624)

Tools needed – two 7/16" wrenches, rubber mallet

IMPORTANT ASSEMBLY TIP: DO NOT TIGHTEN NUT & BOLT COMBINATIONS COMPLETELY UNTIL ALL PARTS ARE ASSEMBLED TOGETHER! FINGER TIGHTEN ONLY PLUS ONE TURN OF A WRENCH ONLY! THIS WILL TEMPORARILY HOLD THE LOCK NUT ON THE BOLT WHILE HELPING ALIGNMENT OF ALL PARTS! AFTER ALL PARTS ARE ASSEMBLED TOGETHER, ALL NUT & BOLT COMBINATIONS MUST BE COMPLETELY TIGHTENED!

1. Attach the (2) platforms together using (2) provided 1/4-20 x 2" bolts, locknuts and steel washers. **SEE FIGURE 1. DO NOT tighten all nut and bolt assemblies completely!**
2. Attach the (2) platforms (410000) to the platform J-pipes (410003) using (8) provided 1/4-20 x 2-1/4" bolts, locknuts and steel washers. **SEE FIGURE 2.**

NOTE: Mesh surface of foot platforms should be on top.

3. Attach the tree blade weldment (2ML130) to the platform J-pipes using (2) provided 1/4-20 x 2-1/2" bolts, locknuts and steel washers. **SEE FIGURE 2.**
4. Attach the (2) seat upright weldments (410005) to the platform J-pipes using (4) provided 1/4-20 x 1-1/2" bolts and locknuts. **SEE FIGURE 3.**
5. Attach the seat upright loop (410023) by inserting each end into the seat upright weldments. Secure these parts together along with the (2) armrest straps (410103) using (2) provided 1/4-20 x 1-3/4" bolts, locknuts and (4) steel washers. **SEE FIGURE 3.** Bolts must go through two holes in armrest straps. Armrest straps must wrap around back side of seat upright weldments.

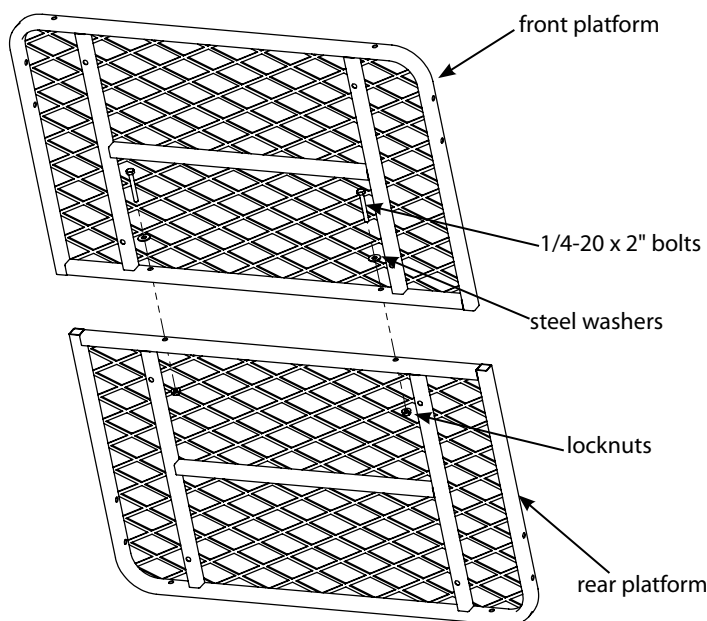

Figure 1

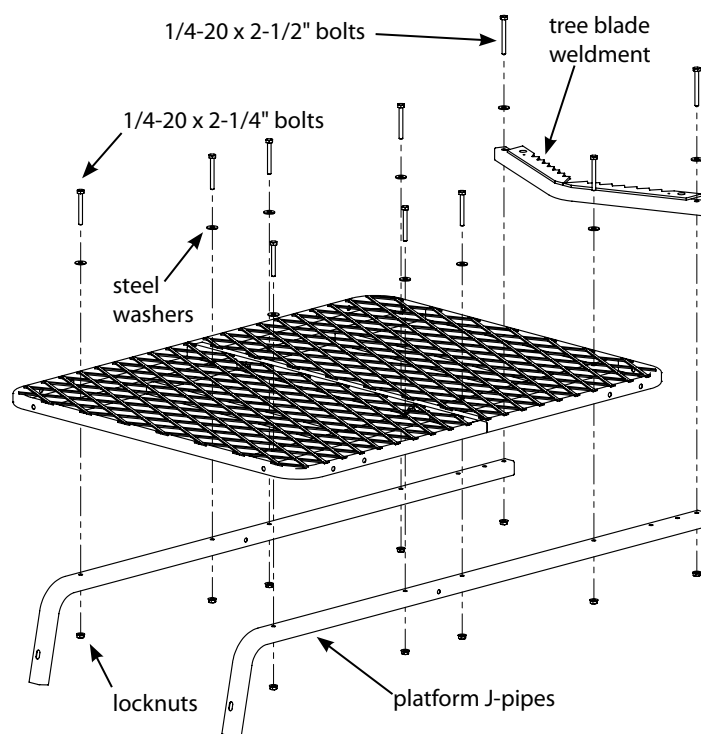

Figure 2

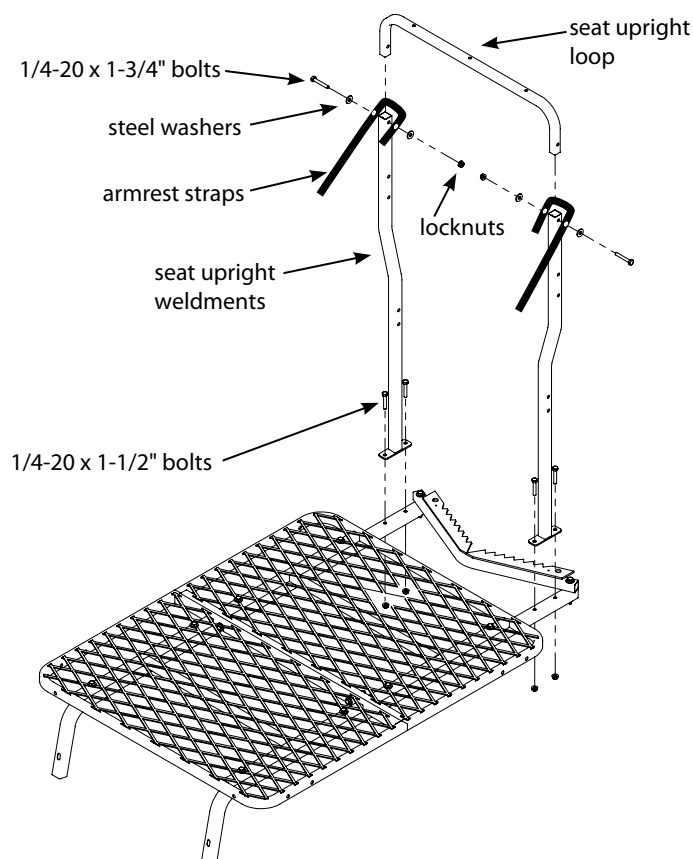

Figure 3

6. Attach the upper tree blade weldment (410004) and the (2) seat pivot brackets (410008) to the seat upright weldments using (4) provided 1/4-20 x 2-1/4" bolts and locknuts. **SEE FIGURE 4.**
7. Attach -preassembled mesh seat with fabric rail mounts (360020) and (2) seat cables (48218) to the outside of the welded seat frame (410071) using (2) provided 1/4-20 x 2" bolts, (2) 1/4-20 x 2-1/4" bolts, (4) locknuts and (4) steel washers. **SEE FIGURE 5 AND 6. MESH FABRIC IS NOT SHOWN TO ILLUSTRATE NECESSARY HARDWARE.**

NOTE: Fabric rail mounts will fit tightly around the welded seat frame intentionally to correctly tension the mesh seat; this is normal. The use of a rubber mallet may be needed to fully position the fabric rail mounts onto the welded seat frame.

8. Attach the assembled seat section to the previously assembled seat pivot brackets using (2) provided 1/4-20 x 2-1/4" bolts, locknuts, steel washers and nylon washers. **SEE FIGURE 6.** Nylon washers should be placed between fabric rail mounts and seat pivot brackets.
9. Attach the loose ends of the two seat cables to the seat upright weldments using (2) provided 1/4-20 x 1-1/2" bolts and locknuts. **SEE FIGURE 6.**

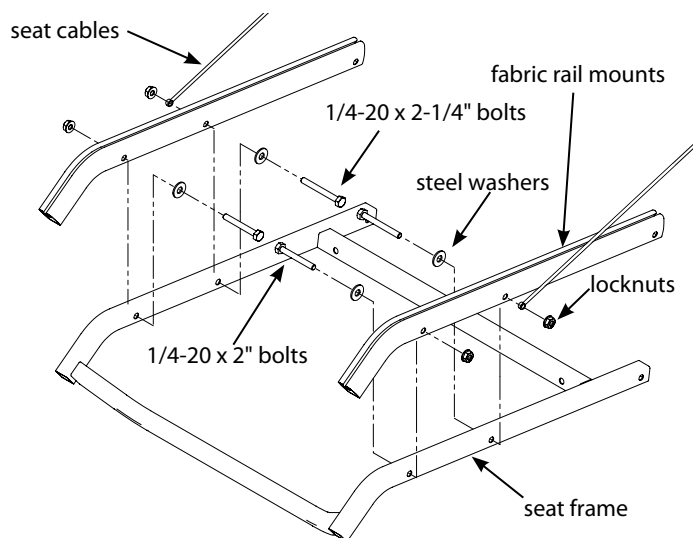

Figure 5

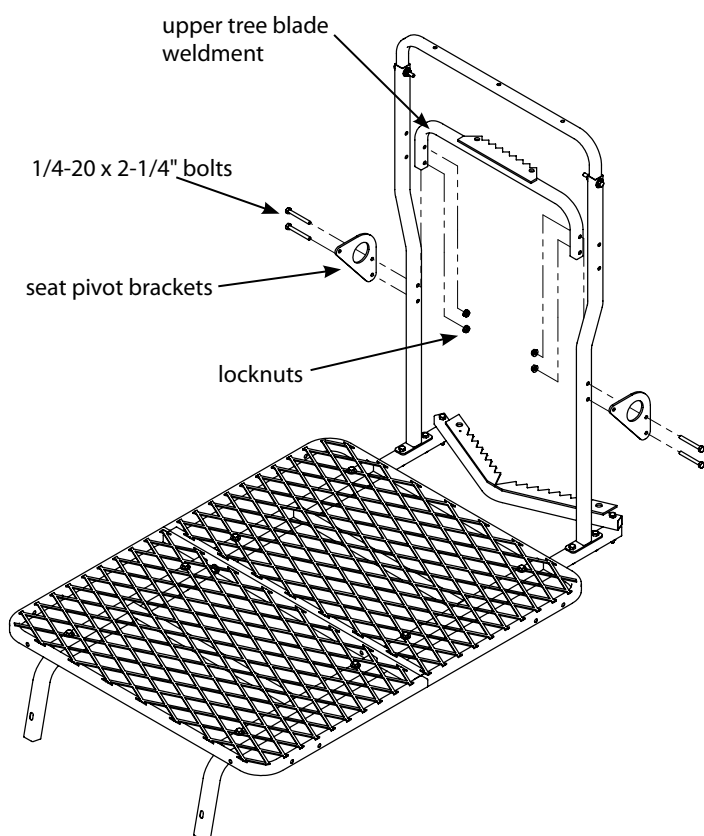

Figure 4

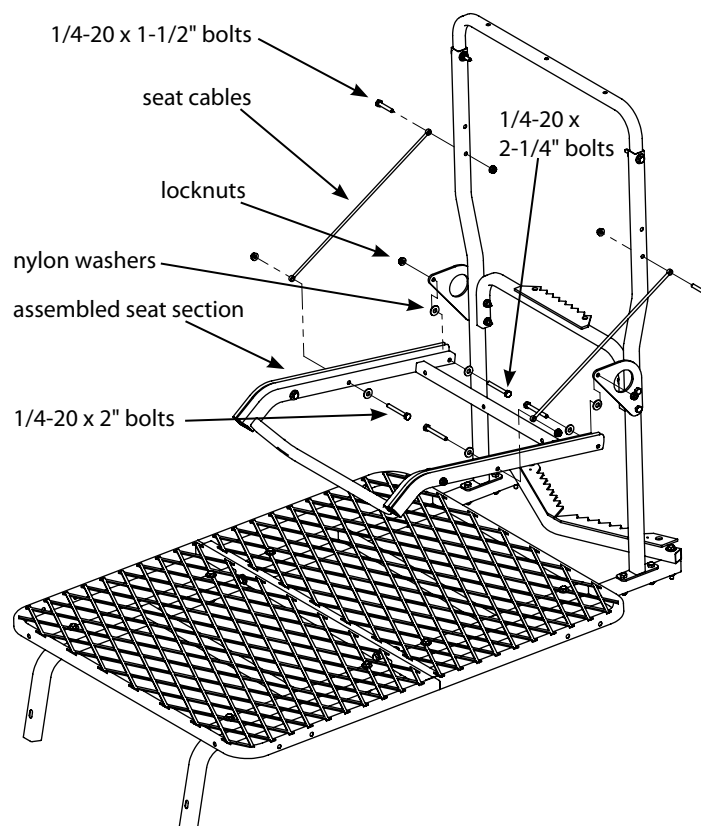

Figure 6

10. a. Using a rubber mallet, gently tap in (2) plastic pipe plugs (48869) into the short side of the armrest tubes.
 b. Attach the armrests (410009) to the seat upright weldments using (2) provided 1/4-20 x 2-1/4" bolts, locknuts, steel washers and nylon washers. **SEE FIGURE 7.** Nylon washers should be placed between armrests and seat upright weldments.
 c. Attach the loose end of the (2) armrest straps (410103) to the armrest using (2) provided (2) 1/4-20 x 1-1/2" bolts, locknuts and (4) steel washers. **SEE FIGURE 7.** Bolts must go through two holes on armrest straps. Armrest straps must wrap around bottom of armrests.
11. a. Insert the (2) curtain rail uprights (410019) into the curtain rail J-pipes and secure together using (2) provided 1/4-20 x 1-1/4" bolts, locknuts and steel washers. **SEE FIGURE 8.**
 b. Attach the (2) curtain rail uprights to the rear platform using (2) provided 1/4-20 x 2" bolts, locknuts and steel washers. **SEE FIGURE 8.**
12. a. Attach the bottom of the mesh backrest (360007) and the seat retainer bar (410010) to the rear of the welded seat frame using (3) provided 1/4-20 x 1-1/2" bolts, locknuts and steel washers. **SEE FIGURE 9a and 9b on following page.** The mesh backrest must wrap around the front, bottom, and back side of the seat frame tube; the plastic stiffening rod located in the sewn sleeve of mesh backrest **MUST** be positioned above the seat retainer bar to act as a stop and prevent the backrest from pulling out during use. All bolts **MUST** go through the seat retainer bars, both sets of holes provided in the mesh backrest and the seat frame tube. **Tighten these three bolts securely at this time. Do not crush tubing when tightening!**

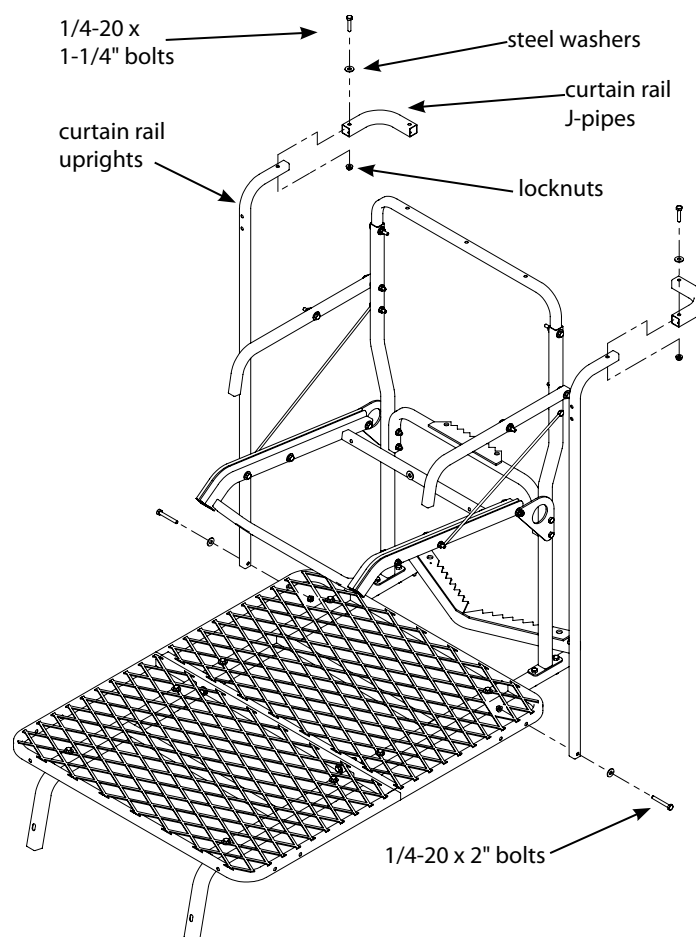

Figure 8

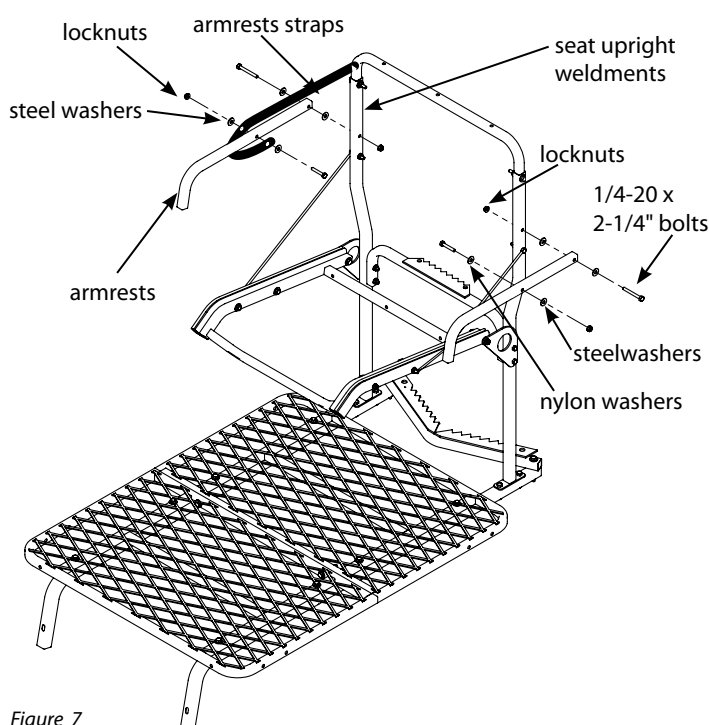

Figure 7

b. With the seat pivoted up in the flip-up position (to allow for slack), attach the top of mesh backrest and the backrest retainer bar (410079) to the seat upright loop using (3) provided 1/4-20 x 1-1/2" bolts and locknuts. **SEE FIGURE 9a and 9b.** The mesh backrest must wrap around the top side of the seat upright loop and the plastic stiffening rod located in the sewn sleeve of mesh backrest **MUST** be positioned behind the backrest retainer bar to act as a stop and prevent the backrest from pulling out during use. All bolts **MUST** go through the backrest retainer bar, holes provided in the mesh backrest and the seat upright loop. **Tighten these three bolts securely at this time. Do not crush tubing when tightening!**

13. Attach the (2) curtain rail J-pipes (410020) to the backrest retainer bar using (2) provided 1/4-20 x 1-1/2" bolts and locknuts. **SEE FIGURE 9a.**

14. Attach the (2) curtain rail side tubes (410018) to the curtain rail uprights using (4) provided 1/4-20 x 2" bolts, locknuts and steel washers. **SEE FIGURE 10.**

15.a. Insert each curtain rail side tube into the door mount weldment (410011) and secure together using (2) provided 1/4-20 x 1-1/4" bolts, locknuts and steel washers. **SEE FIGURE 10.**

b. Attach the bottoms of each door mount weldment to the front platform using (4) provided 1/4-20 x 2" bolts, locknuts and steel washers **SEE FIGURE 10.**

16. Attach (2) flat bars (1ML40) to the front platform and door mount weldments using (2) provided 1/4-20 x 1-1/4" bolts, (2) 1/4-20 x 1-1/2" bolts and (4) locknuts. **SEE FIGURE 10.**

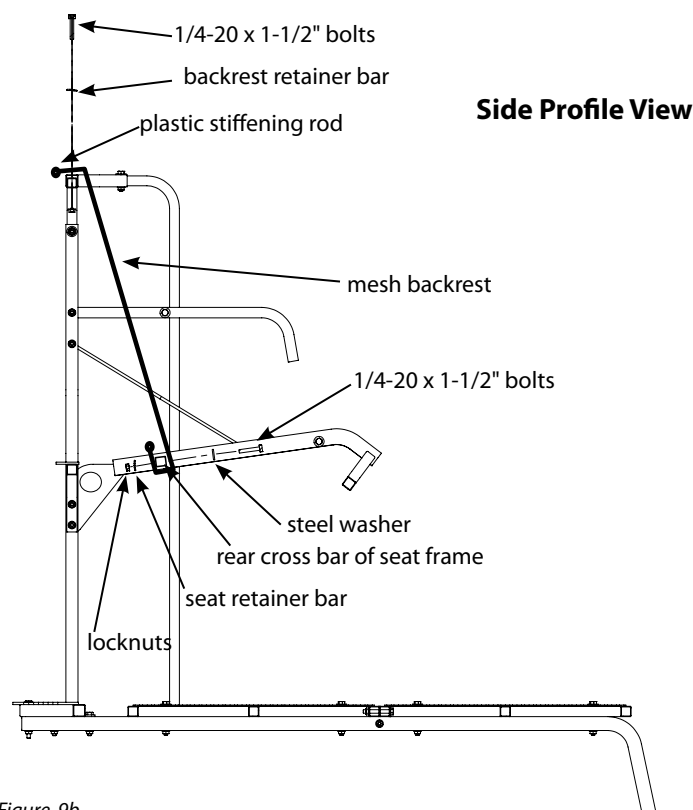

Figure 9b

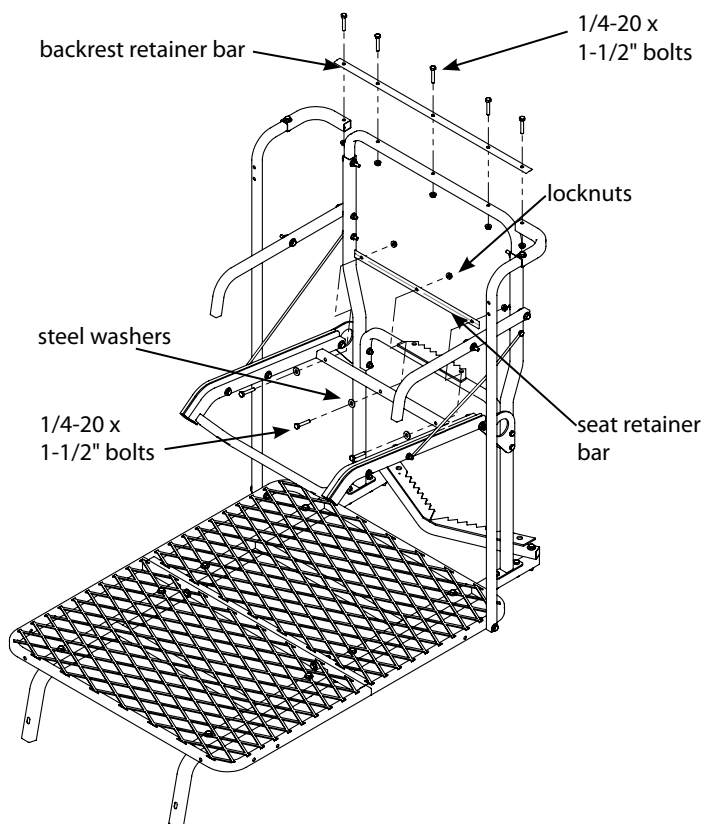

Figure 9a

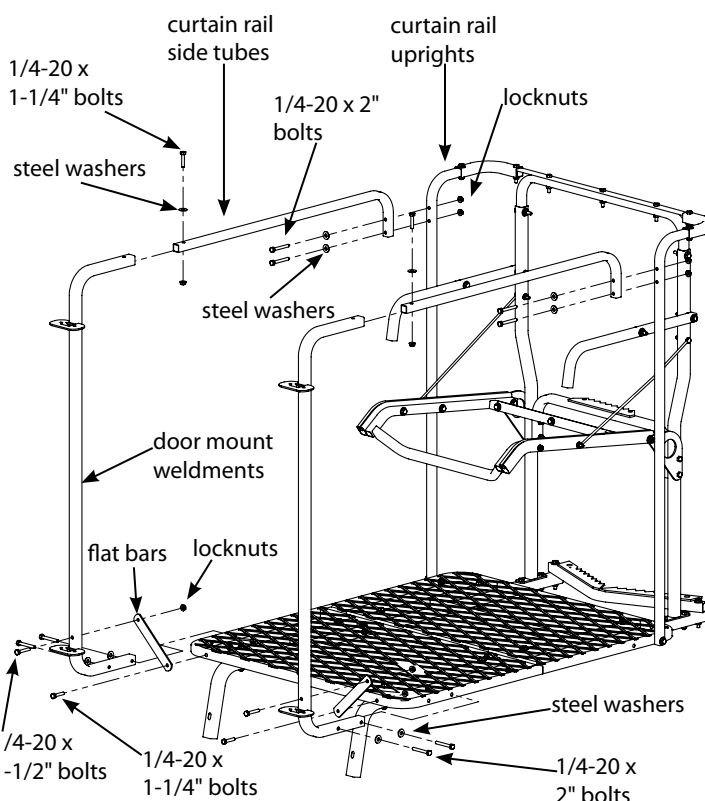

Figure 10

17. Attach (2) door weldments (410017) to the door mount weldments by inserting welded rod and square tube of door frame into the locking position on the upper door mount frame plates. Attach the lower portion of each door to the lower door mount plate using (2) provided 1/4-20 x 1-3/4" bolts and locknuts. **SEE FIGURE 11. Tighten nut only so that the bolt protrudes through nyloc nut so that it is flush.**

Test by lifting each door out of the lock position and making sure the pivoting rod at the top of each door does not come out of the upper door mount plates. Test the locking feature of each door by dropping each door into the upper door mount plates allowing the square tube portion of each door to securely lock.

NOTE: Make sure both doors are functioning properly at all times. Doors should pivot freely to and from the lock position. Nuts should be adjusted on bottom of doors to allow free travel, but not allow the door pin at top to pull out of upper door mount plates.

18. **You must now tighten all remaining nut & bolt assemblies. Be sure not to over tighten or crush tubing when tightening!**
19. Sections are assembled on the ground in the following order; bottom section (410025 3-step ladder); second section (410027 3-step ladder with stabilizer bar mount); third section (410028 3-step ladder w/ mounting holes); top section (assembled top platform section). **SEE FINISHED 15' OPENING DAY LADDER.**
20. With all sections assembled together on ground, secure all sections together using (6) provided spring lock pins. Handle of spring lock pin must be put to the outside of ladder side rails. **SEE FIGURE 12.**

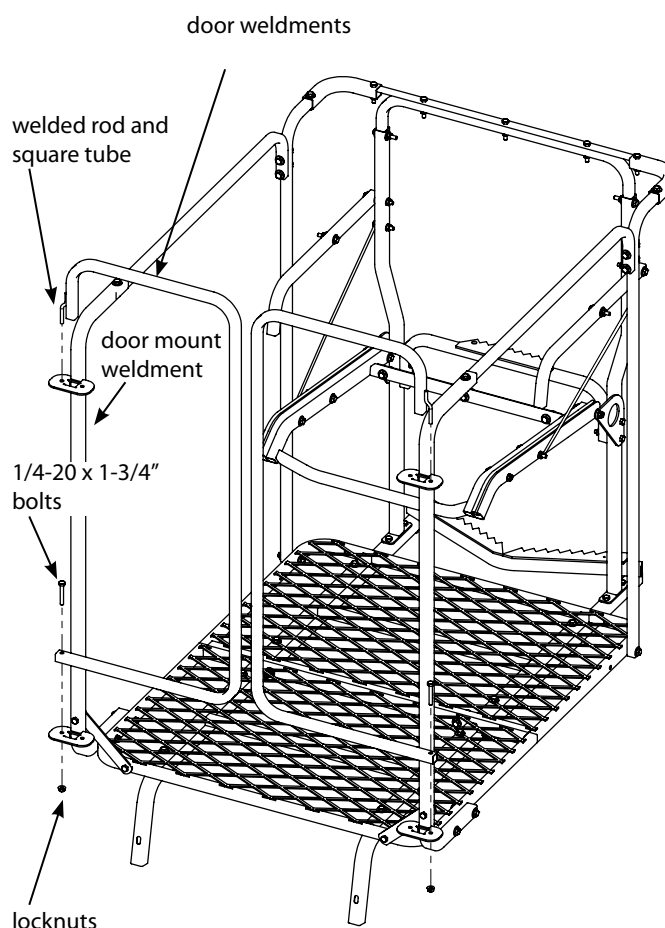

Figure 11

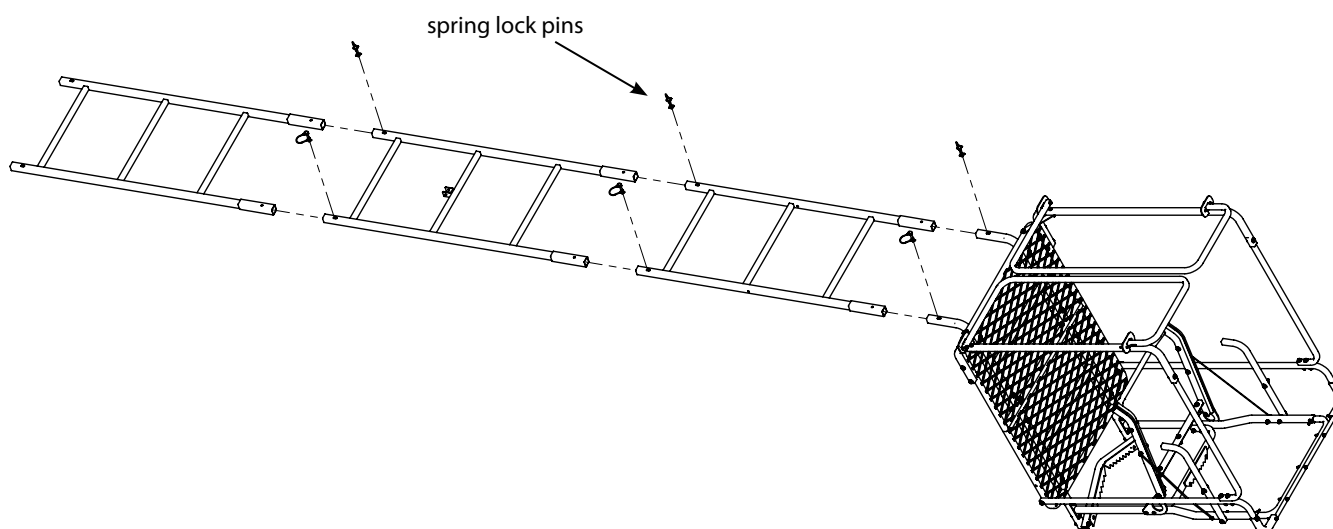

Figure 12

21. Attach the (2) support braces (410024) to the outside of platform J-pipes and outside of top ladder section w/ mounting holes using (4) provided 1/4-20 x 1-1/2" bolts and locknuts. **SEE FIGURE 13.** Tighten securely. **Be sure not to over tighten or crush tubing when tightening!**

22. a. Attach the stabilizer bar extension tube (1ML23) to the second ladder section mounting bracket using (1) provided spring lock pin. **SEE FIGURE 14.**

b. Slide the stabilizer bar (L17) into the extension tube and attach the two pieces together using (1) provided spring lock pin. Spring lock pin must go through both the extension tube and stabilizer bar at appropriate hole to achieve desired distance from tree. Adjustment in length may be needed when ladder is uprighted later in instructions. **SEE FIGURE 14.**

23. Tie one end of each of the provided 15' ropes to the platform J-pipes, just in front of the tree blade (2ML130). Be sure your double knots are secure. **SEE FIGURE 15.**

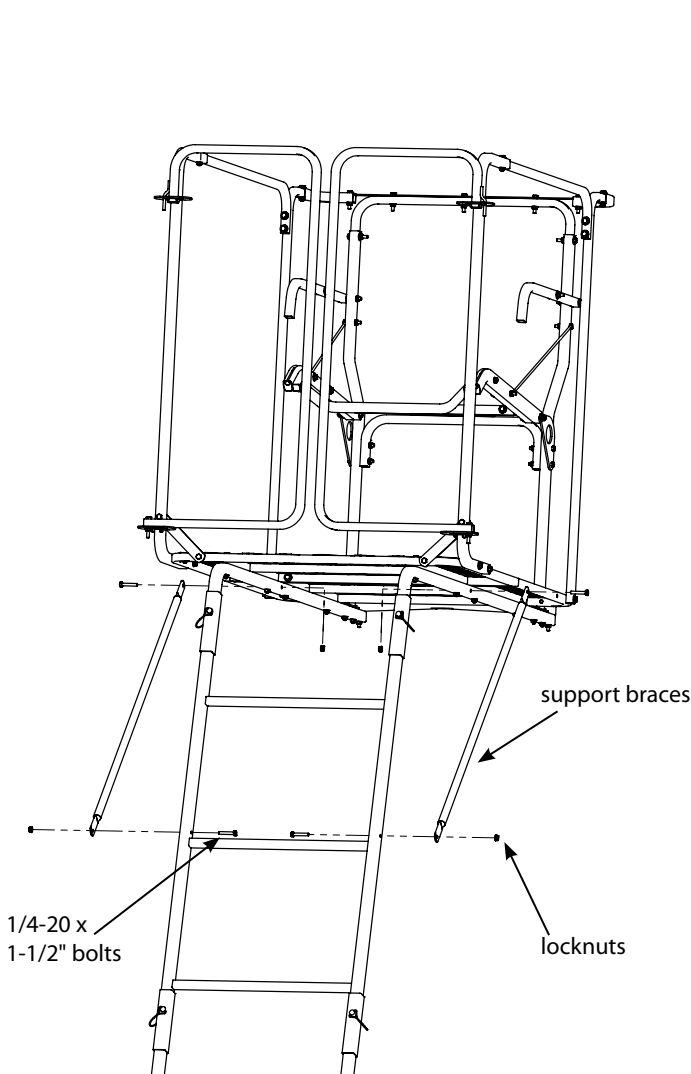

Figure 13

24. a. Attach the removable seat pad (360005) to top of mesh fabric on assembled seat frame. Wrap the Velcro straps or buckle straps around seat frame and secure together. Pull straps tight so seat is not loose.

b. Attach the (2) provided 9" camo sleeves (48736) to the armrest tubes by wrapping around metal tubing and attaching Velcro together.

c. Attach the provided 12" foam pads to the top of door frames and curtain rail side tubes at desired locations.

d. Attach both halves of the camo curtain to the assembled shooting rail/door assembly. Each half has a "pocket" type feature sewn on the inside, this portion is where the upper side of the door frames are inserted into. The elastic side of each curtain should be secured around the platform. Secure the remaining portions of each curtain half by attaching Velcro points to the shooting rail assembly and platform.

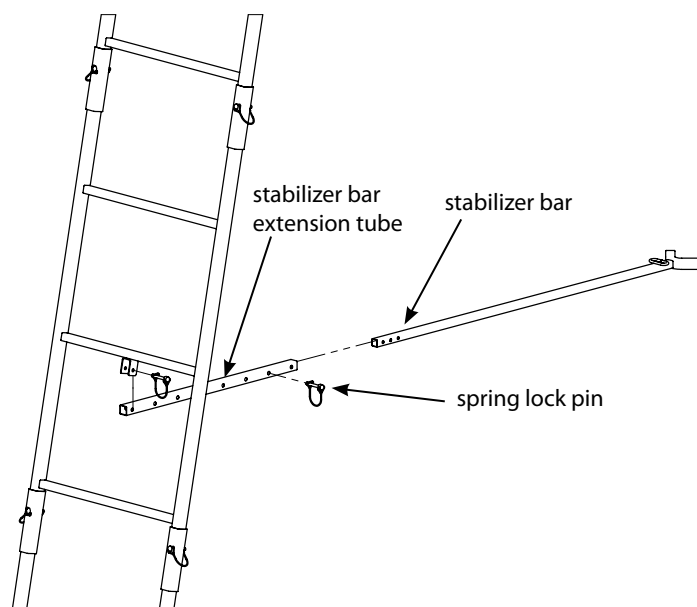

Figure 14

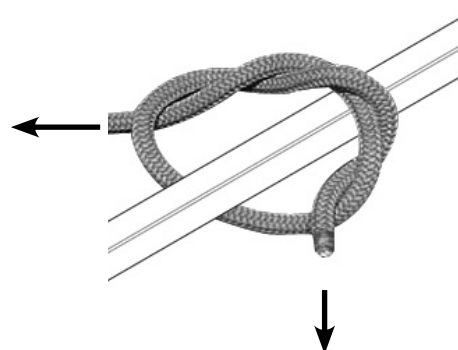
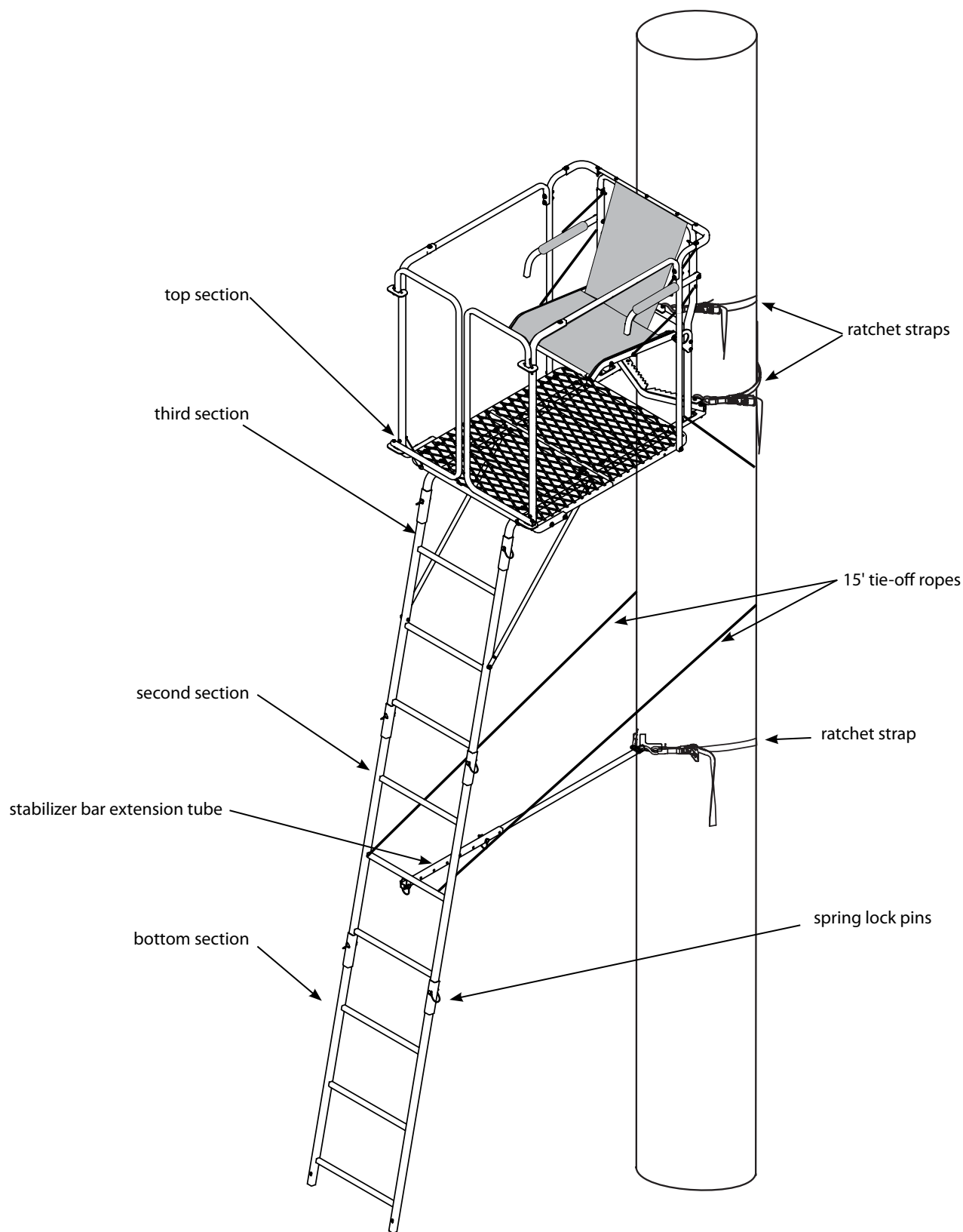
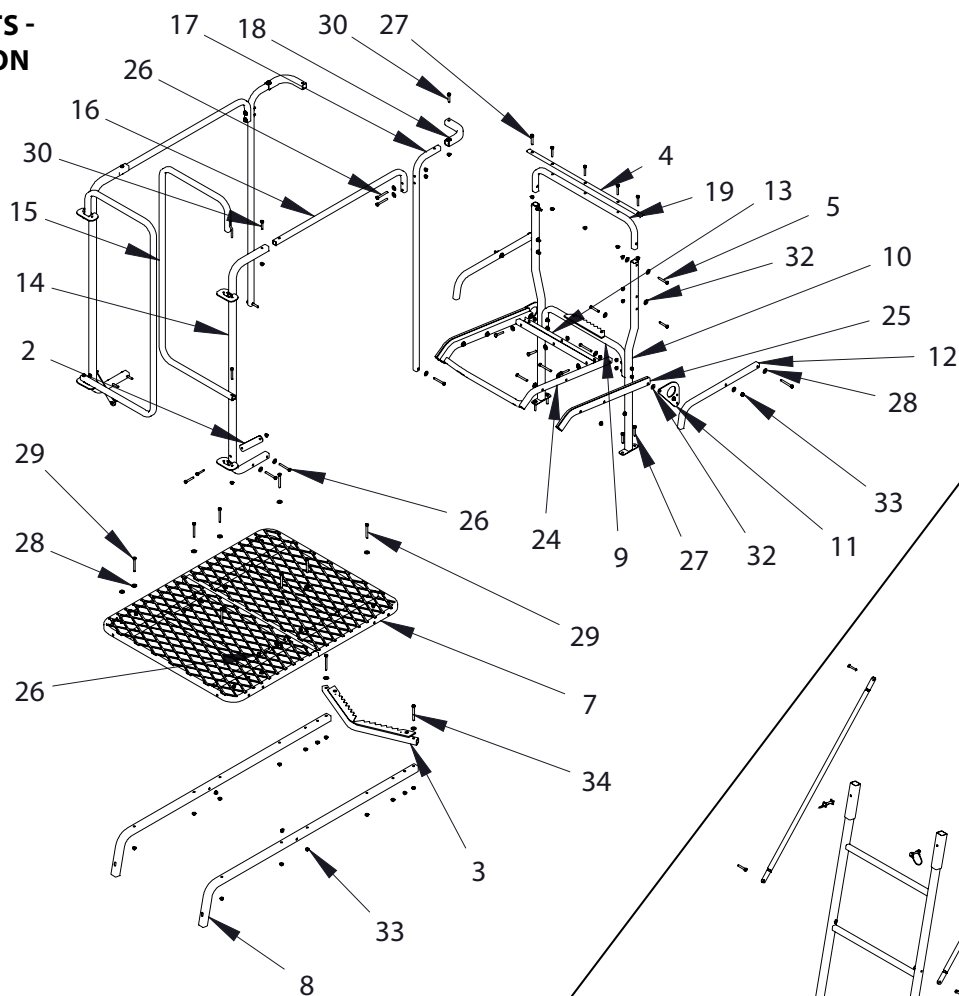

Figure 15

FINISHED 15' OPENING DAY LADDER



LADDER PARTS - UPPER SECTION



LADDER PARTS - LOWER SECTION

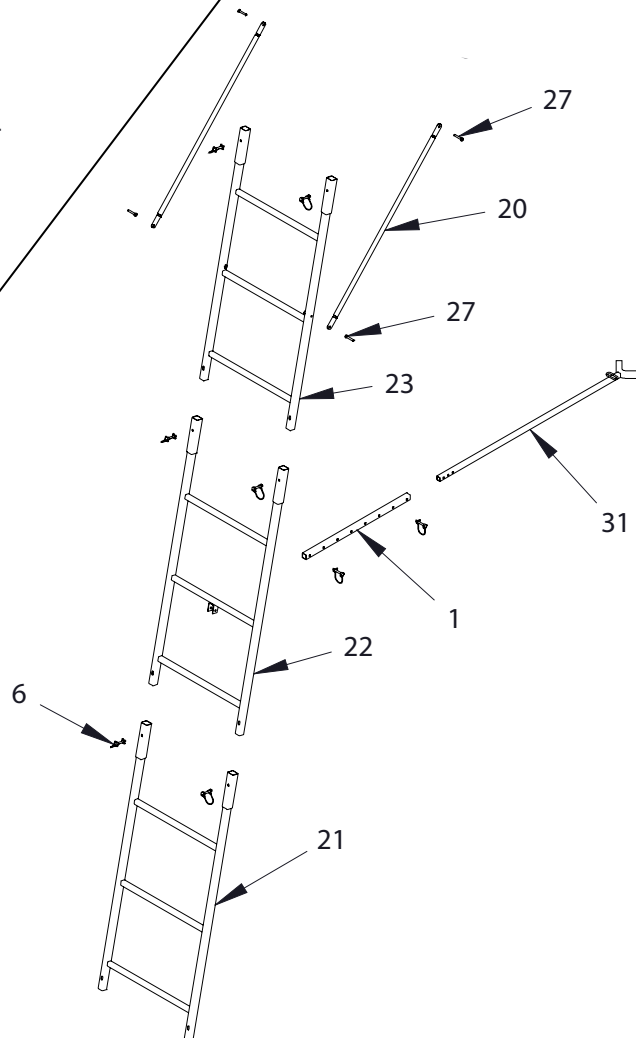

KEY #	PART #	DESCRIPTION	QTY.
1	1ML23	TUBE, STABILIZER, SUPPORT	1
2	1ML40	BRACE, SUPPORT FLAT	2
3	2ML130	WELDMENT, TREE BLADE	1
4	410079	STRIP FABRIC MOUNT	1
5	48250B	BOLT 1/4-20 X 1-3/4" HHCS GR5 BLK ZN	4
6	63281	SNAP PIN, 1/4 X 1-3/4", ROUNDED RETAINER	8
7	410000	WELDMENT PLATFORM 29" X 18.25"	2
8	410003	J PIPE LADDER	2
9	410004	WELDMENT TREE BLADE	1
10	410005	WELDMENT UPRIGHT SEAT	2
11	410008	BRACKET SEAT PIVOT	2
12	410009	ARMREST	2
13	410010	STRIP FABRIC MOUNT	1
14	410011	WELDMENT DOOR MOUNT	2
15	410017	LOOP DOOR	2
16	410018	TUBE SIDE CURTAIN RAIL	2
17	410019	UPRIGHT CURTAIN RAIL	2
18	410020	J PIPE CURTAIN RAIL	2
19	410023	LOOP SEAT UPRIGHT	1
20	410024	BRACE SUPPORT 35.69"	2
21	410025	WELDMENT LADDER 3 STEP 46"	1
22	410027	WELDMENT LADDER 3 STEP W/VAM 46"	1
23	410028	WELDMENT LADDER 3 STEP W/ HOLES 43.25"	1
24	410071	WELDMENT FTS SEAT FRAME	1
25	410077	RAIL FABRIC MOUNT FLIP SEAT	2
26	48153B	BOLT 1/4-20 X 2" HHCS GR5 BLK ZN	14
27	48240B	BOLT 1/4-20 X 1-1/2" HHCS GR5 BLK ZN	22
28	48261B	WASHER FLAT 1/4" BLACK	45
29	48271B	BOLT 1/4-20 X 2-1/4" HHCS GR5 BLK ZN	18
30	8909B	BOLT 1/4-20 X 1-1/4" HHCS GR5 BLK ZN	6
31	L17	WELDMENT, STABILIZER BAR	1
32	WN516	WASHER, 5/16", BLACK NYLON	4
33	48752B	NUT, FLANGED, NYLOCK, 1/4-20	66
34	48270B	BOLT 1/4-20 X 2-1/2 HHCS GR5 BLK ZN	2

**NO EXTENSIONS AVAILABLE
FOR THIS MODEL,
TESTED FOR 15' MAXIMUM HEIGHT!**

ITEMS NOT SHOWN:

PART #	DESCRIPTION	QTY.
360005	PADDED SEAT	1
48736	9" CAMO PAD	2
48155	HARNESS FAS, W/SRD	1
48415	RATCHET STRAP	3
48691	TIE-OFF ROPE KIT	1
410103	ARMREST STRAP	2
48218	CABLE, 15"	2
360002	PAD BUMPER 12"	6
360000L	CURTAIN SEWN LEFT	1
360000R	CURTAIN SEWN RIGHT	1
360020	ASSEMBLY SEAT OPENING DAY	1
360024	ASSEMBLY BACKREST OPENING DAY	1

Maximum Height - 15'

Maximum Field Rating - 300 lbs.

Tree Diameter Range - 12" to 20"

SETUP AND USE INSTRUCTIONS (FOR ALL LADDER STANDS IN THIS MANUAL)

1. With assembled product lying on the ground in assembled position, **position one person at bottom end of ladder lying on the ground.** This person has to prevent the ladder end from tilting up when platform end is lifted and prevent the ladder from skidding across ground.
2.
 - a. Position (2) people at the platform end of the ladder, lift the platform end, and continue uprighting by walking toward bottom end of ladder and moving hands along ladder legs. **Stand ladder up against chosen straight tree on dry, level ground.** Use caution when ladder comes over center against tree.
 - b. Step back and look at ladder top to see that it is level. Adjust as needed to achieve a level platform at top. For ladder stands with two tree blades (one at platform level and one at upper level) be sure that both tree blades are contacting tree. Adjust as needed so both tree blades are contacting tree.
 - c. Step down hard on bottom step to push ladder legs into the ground.
 - d. With ratchet strap now in hand, hook "S" hook with long strap to the stabilizer bar link welded on stabilizer bar. Feed the long strap through the center (slot) of ratcheting mechanism and back around through tightening lever. **SEE FIGURES 1 AND 2.** Secure the ladder tight so the stabilizer bar is at a right angle to the tree. Adjust stabilizer bar length as necessary so it contacts tree. Be absolutely sure the tree blade(s) at top and the stabilizer bar are all contacting tree.

NOTE: Be sure you feed the long strap correctly so there are no twists in the strap.

Wrap entire ratchet assembly around tree and hook other "S" hook through opposite side of stabilizer bar link. Pull tail of long strap until most of the slack is taken out. Be sure entire strap is even and at the same level all around tree. "Ratchet" tight to tree, this will securely attach stabilizer bar to tree. **SEE FIGURE 1.** Be absolutely sure the tree blade(s) at top and stabilizer bar are all contacting tree.

NOTE: To release ratchet, simply pull the release lever and open tightening lever wide open (flat).

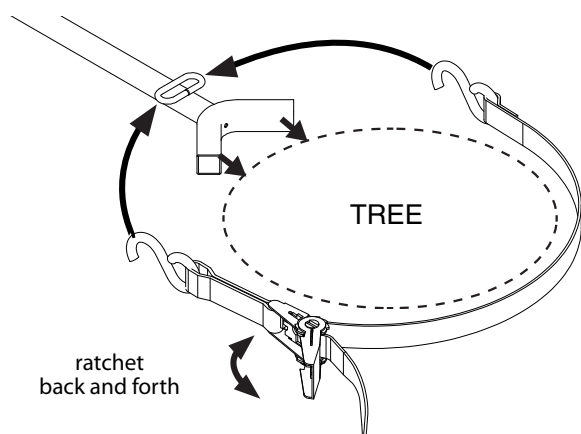

Figure 1

⚠ WARNING

DOUBLE CHECK ASSEMBLY STEPS TO BE CERTAIN YOU HAVE CORRECTLY ASSEMBLED THIS PRODUCT.

STUDY YOUR NEW STAND TO BECOME FAMILIAR WITH ALL OF ITS FEATURES AND DESIGN. AT GROUND LEVEL, FOLLOWING PROVIDED USE INSTRUCTIONS, PRACTICE ATTACHING STAND TO TREE AND REMOVING STAND FROM TREE. PRACTICE SITTING, STANDING, AND USING THIS PRODUCT BEFORE ATTACHING OVERHEAD. SAVE THESE INSTRUCTIONS FOR FUTURE REFERENCE. YOU MUST ALWAYS USE THE PROVIDED FULL BODY HARNESS (FALL ARREST SYSTEM) THAT MEETS TMA STANDARDS WHILE USING THIS PRODUCT.

ALWAYS USE THREE PEOPLE FOR SET-UP AND TAKE-DOWN. BE ABSOLUTELY SURE THE TREE BLADE(S) ON PLATFORM AND THE STABILIZER BAR ARE CONTACTING TREE BEFORE CLIMBING LADDER.

STABILIZER BAR MUST ALWAYS BE CORRECTLY AND SECURELY ATTACHED TO LADDER AND TREE BEFORE CLIMBING LADDER.

SOME MODELS INCLUDE A MULTI-PIECE STABILIZER BAR SYSTEM. BE SURE SPRING LOCK PIN GOES THROUGH BOTH THE EXTENSION TUBE AND THE STABILIZER BAR.

BE CERTAIN SPRING LOCK PINS ARE LATCHED SECURELY TO PREVENT ACCIDENTAL REMOVAL.

BE SURE YOUR DOUBLE KNOTS ARE ALL SECURE ON ALL ROPE CONNECTIONS.

NEVER ASCEND OR DESCEND LADDER WITHOUT TIE-OFF ROPES SECURELY HOLDING LADDER TO TREE AND STABILIZER BAR SECURELY ATTACHED.

BE CERTAIN TO ALWAYS LEAN FORWARD, TOWARD THE TREE WHEN ASCENDING OR DESCENDING LADDER. ATTACH YOUR HARNESS TETHER TO THE TREE BEFORE SECURING THE PLATFORM TO THE TREE AND STEPPING ONTO THE PLATFORM.

ALWAYS HAVE THREE POINTS OF CONTACT WHILE CLIMBING LADDER.

BRING RATCHET STRAP(S) UP WITH YOU IN A POCKET- DO NOT CARRY IN YOUR HANDS!

IF YOUR LADDER STAND MODEL HAS SWING-OPEN DOORS, ALWAYS MAKE SURE DOORS ARE SECURELY LATCHED SHUT WHEN IN USE. DO NOT LEAN AGAINST, LEAN OVER OR SIT ON DOORS. THEY ARE DESIGNED FOR ENTRANCE/EXIT DOORS ONLY. ALWAYS BE AWARE THE DOORS CAN UNLATCH AND PIVOT OPEN.

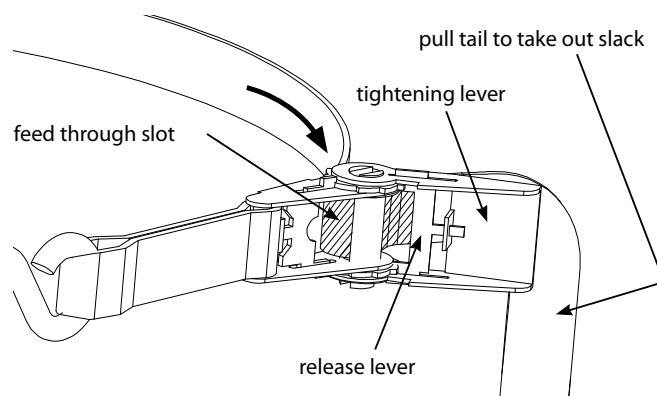

Figure 2

e. Wrap the previously attached tie-off ropes hanging down from platform, around the back side of tree in opposite directions of each other. Pull the ropes snug and tie them to the ladder at the stabilizer bar height location. This ground level ladder-to-tree attachment will prevent the ladder from pulling away from the tree while ascending to top for final ratchet strap attachment. The same holds true when ladder removal is necessary. **SEE FIGURE 4a and 4 b.**

NOTE: During installation and removal of ladder treestand, you must always and properly use the included Full Body Harness (Fall Arrest System). Refer to the Full Body Harness instructions included with this product for proper use.

3. **With two people securely holding the ladder,** use the three point contact climbing method to slowly climb the ladder and carefully keep a constant hand grip on the ladder at all times. Always lean forward, toward tree, to keep top section tree blade(s) against the tree. **Be certain ladder bottom is firmly seated on dry, level ground. Attach your harness tether to the tree before securing the platform to the tree and stepping onto platform. Refer to the Full Body Harness instructions included with this product.**

4. Standing on ladder step, lean toward tree with ratchet strap now in hand, hook "S" hook with long strap through hole provided on tree blade. Feed the long strap through the center (slot) of ratcheting mechanism and back around through tightening lever. **SEE FIGURES 5a/5b AND 6.**

NOTE: Be sure to feed the long strap correctly so there are no twists in the strap.

WARNING

DO NOT ALLOW EXCESSIVE STRAP BUILDUP IN RATCHET AS THIS WILL PREVENT THE RATCHET TEETH FROM ENGAGING CAUSING SLIPPAGE.

ALWAYS ATTACH RATCHET STRAPS SECURELY WHILE USING THIS PRODUCT!

NEVER STAND ON LADDER SEAT, IT IS DESIGNED FOR SITTING ONLY.

SEAT IS REMOVABLE. BE CERTAIN IT IS SECURELY ATTACHED WHEN IN USE.

BE SURE SHOOTING RAIL IS SEATED ALL THE WAY DOWN ON STUDS DURING USE.

NEVER LEAN AGAINST, LEAN OVER, OR SIT ON SHOOTING RAIL. IT IS DESIGNED AS A SHOOTING REST ONLY. ALWAYS BE AWARE THAT THE SHOOTING RAIL CAN SWING TO ONE SIDE OR THE OTHER ON SOME MODELS.

BE SURE SHOOTING RAIL IS SET OFF TO THE SIDE (ON ONE STUD) WHEN ASCENDING OR DESCENDING LADDER.

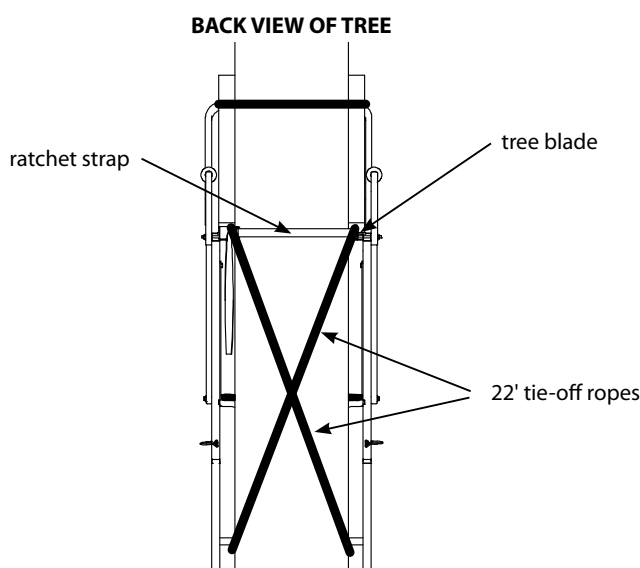

Figure 4a: Applies to RE607 and RE619

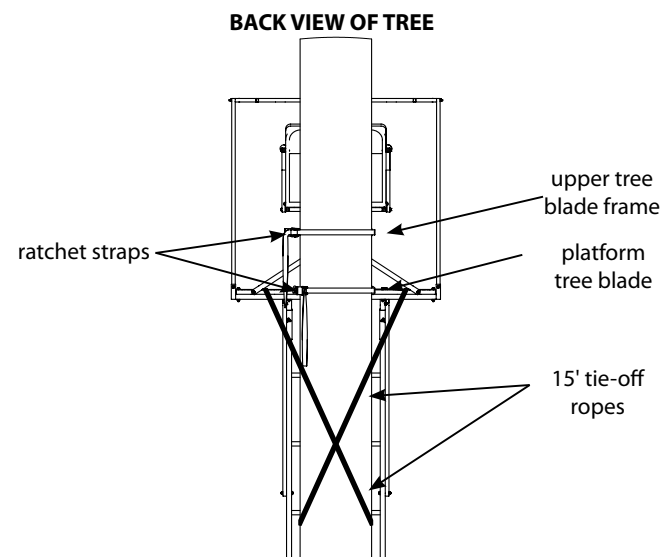

Figure 4b: Applies to RE623 and RE624

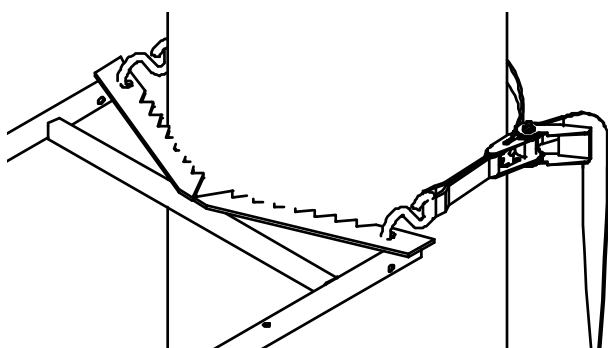

Figure 5a: Applies to RE607 and RE619

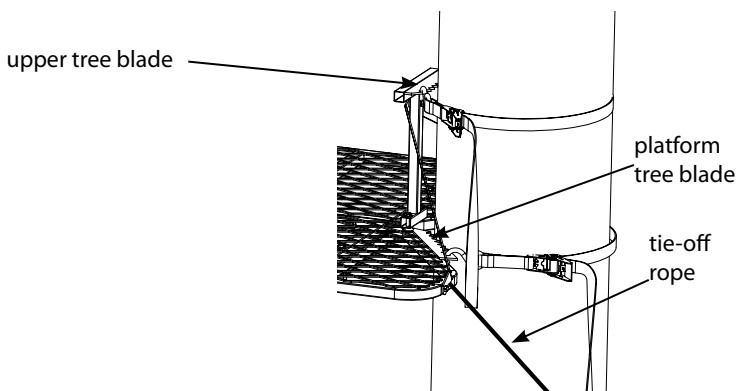

Figure 5b: Applies to RE623 and RE624

Wrap entire ratchet assembly around tree and hook other "S" hook through opposite tree blade hole. Pull tail of long strap until most of the slack is taken out. Be sure entire strap is even and at the same level all around tree. "Ratchet" tight to tree, this will securely attach ladder to tree and prevent movement. **SEE FIGURES 5a, 5b, AND 7.**

NOTE: To release ratchet, simply pull the release lever and open tightening lever wide open (flat).

5. **For RE623 and RE624 ONLY:** Repeat step 4 for second tree blade attachment by placing "S" hooks through holes provided on second tree blade. **SEE FIGURES 5b, 6, AND 7.**
6. If applicable, attach backrest portion of seat to tree by wrapping the long strap with buckle end around tree and snapping together with opposite end. Adjust as needed.
7. If applicable, once seated, shooting rail can now be seated down over studs. **SEE FINISHED LADDER ILLUSTRATIONS.**
8. **FOR RE607, RE619, and RE624:** Reverse setup and use instructions to take ladder down. This now completes the set-up instructions for RE607, RE619 and RE624. **FOR RE623, PLEASE CONTINUE AS INSTRUCTED ON THE FOLLOWING PAGE TO PROPERLY INSTALL YOUR SWIVEL SEAT.**

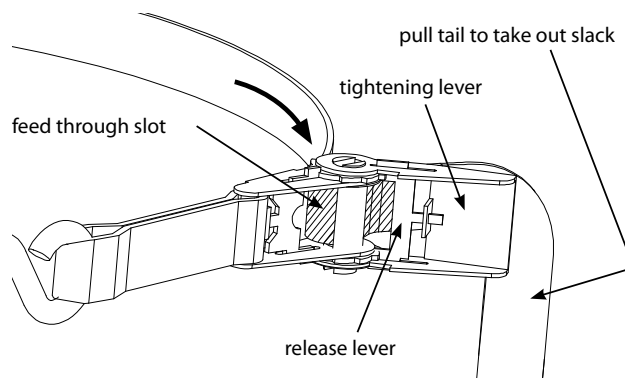

Figure 6

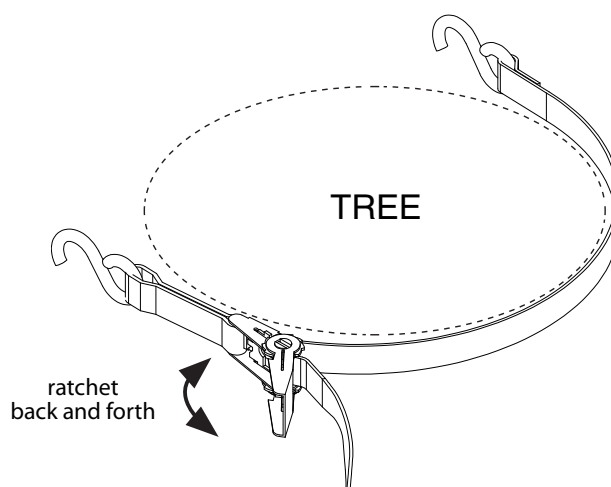

Figure 7

FOR RE623 ONLY: HOISTING YOUR SWIVEL SEAT

9. Using the three point contact climbing method, slowly descend the ladder and carefully keep a constant hand grip on the ladder at all times until you reach the ground.
10. Tie one end of your hoist rope (not included) to the seat assembly. Be sure your double knot is secure. Place (4) 1/4-20 x 1-3/4" wing bolts in your pocket.
11. With other end of hoist rope, use the three point contact climbing method to slowly climb the ladder and carefully keep a constant hand grip on the ladder at all times. **Once you reach the platform, immediately attach your harness tether to the tree. SEE FIGURE 8.**
12. Carefully raise the seat assembly to the platform using the hoist rope (**SEE FIGURE 8**) and place seat post on top of the platform and align the 4 holes in seat post plate to the 4 holes located in the center of the platform. Remove (4) wing bolts from your pocket and use them to secure the seat post/seat assembly to the platform. Wing bolts should be inserted from the top and threaded into the nut welds located on bottom side of platform. **TIGHTEN SECURELY BY HAND, SEE FIGURE 9.**
13. Reverse setup and use instructions to take ladder down.

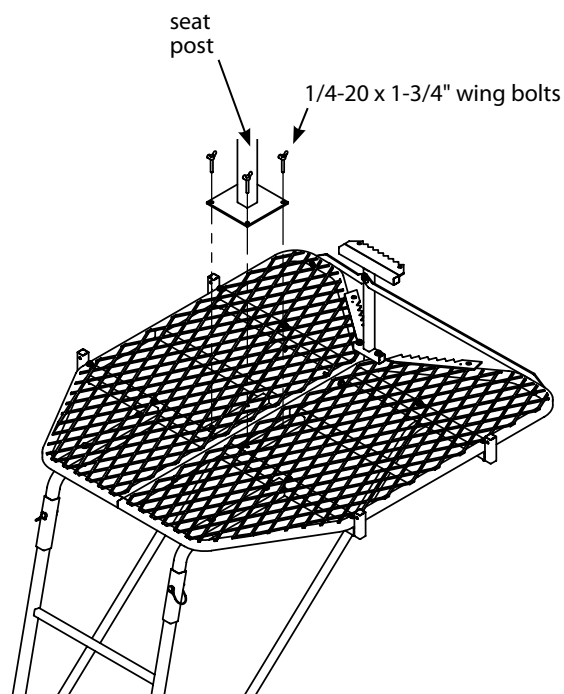

Figure 9

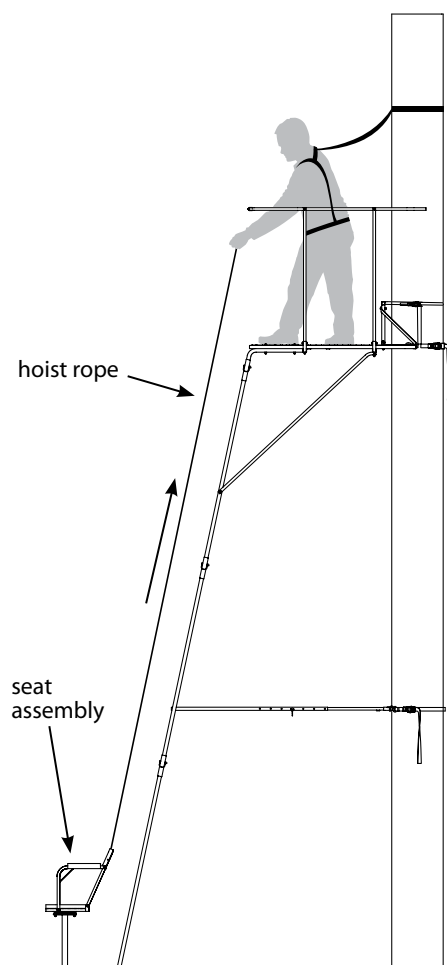
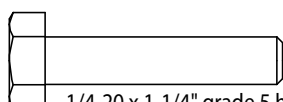

Figure 8

BOLT IDENTIFICATION CHART

Not all bolt sizes shown are included with all treestands. Bolts shown are for size reference only. Extra hardware may be included in the parts bag.



1/4-20 x 1-1/4" grade 5 hex head bolt

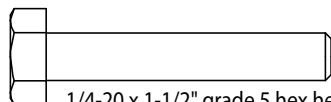

1/4-20 x 1-1/2" grade 5 hex head bolt

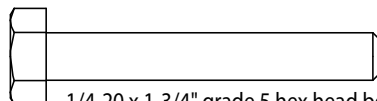

1/4-20 x 1-3/4" grade 5 hex head bolt

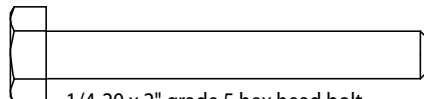

1/4-20 x 2" grade 5 hex head bolt

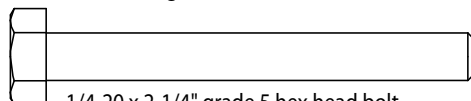

1/4-20 x 2-1/4" grade 5 hex head bolt

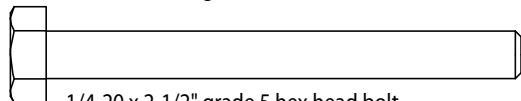

1/4-20 x 2-1/2" grade 5 hex head bolt

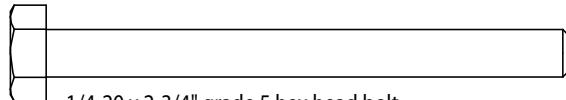

1/4-20 x 2-3/4" grade 5 hex head bolt

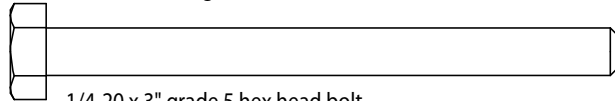

1/4-20 x 3" grade 5 hex head bolt

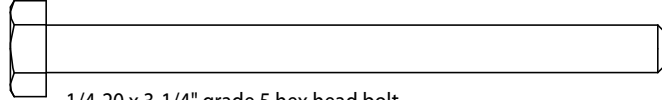

1/4-20 x 3-1/4" grade 5 hex head bolt

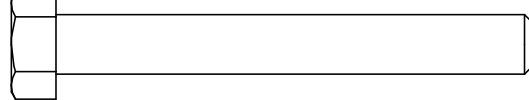

5/16-18 x 2-1/2" grade 5 hex head bolt

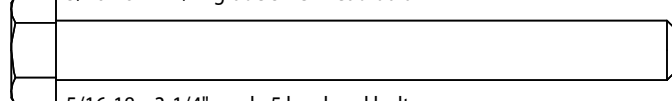

5/16-18 x 3-1/4" grade 5 hex head bolt

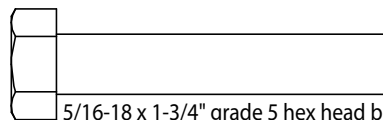

5/16-18 x 1-3/4" grade 5 hex head bolt

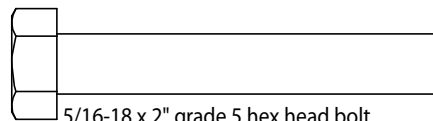

5/16-18 x 2" grade 5 hex head bolt

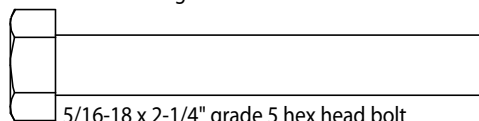

5/16-18 x 2-1/4" grade 5 hex head bolt



This image shows a single sheet of white paper with horizontal ruling lines. The lines are evenly spaced and run across the width of the page. There are no margins, text, or other markings on the paper.



Rivers Edge Treestands, Inc.
1690 Elm Street, PO Box 755
Cumberland, WI 54829
800-450-EDGE (3343) | Fax 715-822-2124
Email: info@huntriversedge.com

*All weights, specifications and features are approximate and are subject to change without notice. Due to continuous product improvements, product images may not be exact. Warning labels in some product images may have been removed for photography purposes only. Props shown in photos not included. Some assembly may be required.