

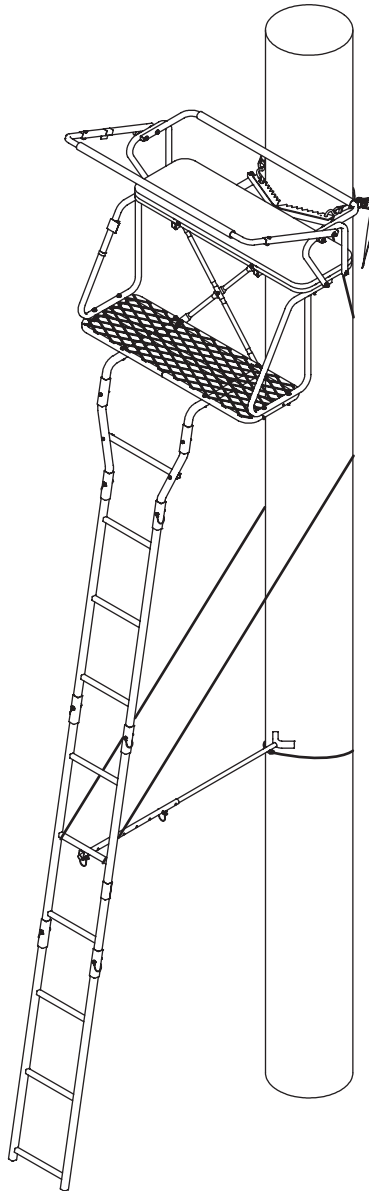

Operator's Manual

RE640 Standard 2-Man™

Maximum Height - 16' to shooting rail
Maximum Field Rating - 500 lb; no more than 300 lb per person
Tree Diameter Range - 12" to 20"



Certified to TMA
Standards by an
Independent
Testing Laboratory

**Wear Your
Harness!**



Get parts online at
www.HuntRiversEdge.com



P/N: 18870
REV1: 02/17/15
© 2015 RETI
All Rights Reserved.

INTRODUCTION

Rivers Edge® Treestands are engineered with you the hunter in mind. We appreciate your purchase of one of our world class treestands. Follow these few simple instructions and your stand will provide you many years of trouble-free pleasure. Instructions should be kept in a safe place and reviewed at least annually.

If for any reason you have a problem with your product, **DO NOT return to the retailer**, contact the Rivers Edge® customer service department at 800-450-EDGE (3343) for assistance.

CONTENTS

Introduction/Warranty	2
Warnings.....	3-4
Inspection and Maintenance	4
Assembly Instructions	5-7
Set Up and Use Instructions	8-9
Parts Explosion/Parts List	10-11
Hardware Identification Chart	11

WARRANTY

Rivers Edge Tree Stands, Inc. ("RETI") offers a one year warranty for all components of the treestand. These warranties apply to the original owner with a proof of purchase. These warranties begin on the date of purchase by the first retail consumer and continue for the period specified above. These warranties apply to products that are not modified, abused or used in a manner that deviates from the product's intended usage. Minor fading in color is normal and is not covered by warranty. Any corrosion of painted surfaces that occurs as a result of paint being removed or damaged is also not covered by warranty. RETI offers no other warranty expressed or implied. Products for which warranty work has been approved must be sent directly to RETI and performed by RETI.

To obtain warranty service and/or replacement instructions, you must obtain prior approval from Rivers Edge® Treestands before shipping your package to us by calling our customer service department at 800-450-EDGE (3343) or by writing to: Rivers Edge Tree Stands, Inc., P.O. Box 755, 1160 Eighth Avenue, Cumberland, WI 54829 for a return material authorization number (RMA#). All items must be shipped prepaid. RETI will, at no charge, repair or replace, in RETI's sole discretion, any product that satisfies the conditions stated above. RETI retains the right to change models, specifications and price without notice.

This equipment has been manufactured under strict quality and safety guidelines. As with any equipment of this type, full understanding of the instructions and its use is mandatory and imperative for the safety of its user. RETI is not responsible for any damages or injuries sustained due to improper use or modification of any of its products, or resulting from any use which deviates from the product's intended usage. RETI is not responsible for any injuries sustained due to failure to read and adhere to the instructions for use. Any misunderstanding or questions regarding the products of their use should be directed to RETI prior to any use. **All RETI treestands are sold with a full body harness ("Fall Arrest System") that meets standards set by the Treestand Manufacturer's Association ("TMA").** It is the owner's sole responsibility to inspect the product regularly for damage, improper installation, or conditions that could jeopardize the ultimate safety of the product. Failure to use or improper use of the provided Fall Arrest System may result in serious injury or death. **ALWAYS wear the provided Fall Arrest System while using this product. Owner is responsible to understand and follow product field weight rating and must never exceed maximum weight rating.** RETI is not responsible for any malfunction or injury resulting from normal wear and tear, damage caused by improper use, improper maintenance, negligence or accidents. This product, if used safely as intended, will provide trouble free service for the useful life of the product. We hope you will enjoy the quality of our products for years to come, and have a safe hunt.

For replacement parts, phone 800-450-EDGE (3343) or go online to www.HuntRiversEdge.com.

WARNINGS

WARNING

DO NOT USE THIS PRODUCT UNTIL YOU HAVE WATCHED THE INCLUDED TREESTAND SAFETY DVD, UNDERSTAND IT AND PRACTICED THE TECHNIQUES FOR SAFE HUNTING DISCUSSED IN THIS DVD.

YOU MUST ALWAYS USE THE PROVIDED FULL BODY HARNESS (FALL ARREST SYSTEM) THAT MEETS TMA STANDARDS WHILE USING THIS PRODUCT. SINGLE SAFETY BELTS AND CHEST HARNESSES ARE NO LONGER ALLOWED AND SHOULD NEVER BE USED.

IF YOU ARE NOT WEARING A FULL BODY HARNESS THAT IS PROTECTING YOU FROM A FALL, DO NOT LEAVE THE GROUND.

FAILURE TO USE OR IMPROPER USE OF THE PROVIDED FULL BODY HARNESS (FALL ARREST SYSTEM) THAT MEETS TMA STANDARDS MAY RESULT IN SERIOUS INJURY OR DEATH! READ, UNDERSTAND AND FOLLOW ALL INSTRUCTIONS. IF ANY INSTRUCTIONS ARE NOT UNDERSTOOD OR IF YOU HAVE A PARTS ISSUE CALL 800-450-EDGE (3343) BEFORE USING.

READ, UNDERSTAND AND FOLLOW ALL ASSEMBLY, INSPECTION, MAINTENANCE, FULL BODY HARNESS (FALL ARREST SYSTEM) & USE INSTRUCTIONS PROVIDED BEFORE EACH USE. FAILURE TO FOLLOW ALL WARNINGS AND INSTRUCTIONS COULD RESULT IN SERIOUS INJURY OR DEATH.

READ AND PERFORM ALL INSPECTION AND MAINTENANCE TASKS BEFORE EACH AND EVERY USE (REPLACE ANY QUESTIONABLE COMPONENTS IMMEDIATELY WITH RIVERS EDGE® ORIGINAL REPLACEMENT PARTS). DO NOT LEAVE YOUR STAND OUTDOORS - REMOVE AFTER EACH USE AND STORE INDOORS!

INSTRUCTIONS/DVD SHOULD BE KEPT IN A SAFE PLACE AND REVIEWED AT LEAST ANNUALLY. IT IS THE RESPONSIBILITY OF THE OWNER TO FURNISH THE COMPLETE INSTRUCTIONS TO ANY PERSON THAT WHO BORROWS OR PURCHASES THE TREESTAND.

DOUBLE CHECK ASSEMBLY STEPS TO BE CERTAIN YOU HAVE CORRECTLY ASSEMBLED THIS PRODUCT.

DO NOT CRUSH TUBING WHEN TIGHTENING BOLT ASSEMBLIES! IDENTIFY AND FAMILIARIZE YOURSELF WITH ALL PARTS BEFORE YOU START. A BOLT IDENTIFICATION CHART CAN BE FOUND IN THE BACK.

DO NOT EXCEED THE TOTAL FIELD RATING - 500 LB., NO MORE THAN 300 LB PER PERSON.

NEVER USE ANY PRODUCT THAT HAS NOT BEEN MAINTAINED OR INSPECTED PROPERLY - YOUR LIFE DEPENDS ON IT!

WHEN HUNTING FROM A TREESTAND, FALLS CAN OCCUR ANY TIME AFTER LEAVING THE GROUND CAUSING INJURY OR DEATH.

NEVER ATTACH TO A DEAD, ODD-SHAPED, LEANING, DISEASED, LOOSE-BARKED TREE OR UTILITY POLES.

WARNING

REPLACE ANY AND ALL TREESTAND STRAPS EVERY TWO YEARS OR WHEN ANY SIGNS OF DAMAGE OR WEAR EXIST BEFORE.

SOME MODELS INCLUDE A FOOTREST, WHICH IS DESIGNED AS A FOOTREST ONLY. NEVER STAND ON THE FOOTREST.

BE SURE TO RAISE AND LOWER YOUR WEAPON AND GEAR WITH A HAUL LINE. GUN BARREL END AND ARROW TIPS MUST BE POINTED DOWN- AWAY FROM YOU.

BE SURE SEAT PAD IS SECURELY AND CORRECTLY ATTACHED TO PREVENT ACCIDENTAL REMOVAL.

WARNING

ALL ASSEMBLY MUST BE DONE IN THIS ORDER AT GROUND LEVEL BEFORE UPRIGHTING.

NEVER EXCEED THE MAXIMUM STATED USE HEIGHT.

CHECK THE GROUND UNDER STAND TO MAKE SURE IT IS FIRM AND LEVEL. SLOPED GROUND OR UNEVEN SURFACE (ONE SIDE ON A ROCK) CAN CAUSE YOUR LADDER TO TILT OR SHIFT OFF THE TREE AS YOU CLIMB.

CHECK EVERY LADDER SECTION CONNECTION EVERY TIME YOU USE THE STAND BEFORE YOU LEAVE THE GROUND. IF LADDER SECTIONS ARE SEPARATING, DO NOT USE THE STAND.

LUBRICATION IS HIGHLY RECOMMENDED AT SLIDE TOGETHER POINTS OF EACH SECTION TO PREVENT BINDING. SECTIONS ARE STACKED TOGETHER BY SLIDING SECTIONS TOGETHER, INSIDE OF EACH OTHER. SECTIONS ARE THEN SECURED WITH SPRING LOCK PINS.

BE SURE ALL LADDER SECTIONS ARE SEATED COMPLETELY TOGETHER ON SWEDGED OR POCKETED ENDS OF PIPE.

STABILIZER BAR MUST ALWAYS BE CORRECTLY AND SECURELY ATTACHED TO LADDER AND TREE BEFORE CLIMBING LADDER.

SOME MODELS INCLUDE A MULTI-PIECE STABILIZER BAR SYSTEM. BE SURE SPRING LOCK PIN GOES THROUGH BOTH THE EXTENSION TUBE AND THE STABILIZER BAR.

BE CERTAIN SPRING LOCK PINS ARE LATCHED SECURELY TO PREVENT ACCIDENTAL REMOVAL.

BE SURE YOUR DOUBLE KNOTS ARE ALL SECURE ON ALL ROPE CONNECTIONS.

NEVER ASCEND OR DESCEND LADDER WITHOUT TIE-OFF ROPES SECURELY HOLDING LADDER TO TREE AND STABILIZER BAR SECURELY ATTACHED.

BE SURE ONLY ONE PERSON ASCENDS OR DESCENDS LADDER AT A TIME. BE CERTAIN FIRST PERSON IS SEATED SAFELY, AND ATTACHED TO TREE WITH PROVIDED FULL BODY HARNESS (FALL ARREST SYSTEM) THAT MEETS TMA STANDARDS CORRECTLY BEFORE SECOND PERSON ASCENDS OR DESCENDS LADDER.

NEVER HAVE TWO PEOPLE ON ONE SIDE OF THE PLATFORM. KEEP WEIGHT EVENLY DISTRIBUTED ON PLATFORM.

ALWAYS...

- Be physically fit, mentally alert, and well rested before using this product.
- Read, understand and follow all warnings and instructions before use and save for future reference.
- Use the provided Full Body Harness (Fall Arrest System) that meets TMA standards immediately upon reaching foot platform.
- Be fully aware of foot placement.
- Recommended for adult use only.
- Inspect ladder for missing parts, all hardware condition, and damage before every application, replace if necessary.
- Pull up a bow, backpack, firearm or other equipment only after being secure in the treestand and a fire arm must be pulled up with it unloaded, chamber open and muzzle down.
- Remove ladder after every use, store product indoors.
- Use only RETI original replacement parts.
- Lean forward, towards tree, when ascending and descending ladder.
- Place ladder on dry, level ground.
- Lubricate all slide together points to prevent binding, wear, rust & noise.
- Avoid all electrical power lines.
- Always inform someone of the hunting location, where the treestand will be located and the expected duration of the hunt.
- Carry a signal device such as a mobile phone, radio, whistle, signal flare or personal locator device (PLD) and it must be readily available at all times.
- Inspect the treestand and all safety devices each time before use and do not store a treestand outdoors when not in use.

NEVER...

- Sleep in a treestand
- Use on wet, soft, or unstable ground.
- Exceed the total field rating of 500 lb., no more than 300 lb. per person
- Attach to a dead, odd-shaped, leaning, diseased, loose barked trees or utility poles.
- Use on trees with a diameter smaller than 12 inches or no larger than 20 inches.
- Use a treestand during inclement weather such as rain, lightning, windstorms or icy conditions and end your hunt and return to the ground if inclement conditions arise.
- Alter the original design of your stand.
- Jump on or use in a careless manner.
- Lean out over edge of device.
- Use when intoxicated or using over-the-counter medication or prescription drugs.
- Use a damaged product, replace with new.
- Loan your stand to someone else.
- Use without stabilizer bar, spring lock pins & tie-off ropes securely attached.
- Stand on the seat, it is designed for sitting only.
- Use a treestand when feeling ill, nauseous or dizzy, or if you have a prior medical condition that could cause a problem i.e., heart condition, joints that lock-up, spinal fusion, etc. or if you are not well rested.
- Rely on a tree branch for support.
- Jump or bounce on a treestand to seat it to the tree

INSPECTION AND MAINTENANCE SCHEDULE

- Inspect all webbing, rope, cord, and strap assemblies for wear or damage.
- Inspect cables and cable ends for damage or kinking.
- Inspect all hardware and chain components for damage.
- Inspect for any structural damage to product. (Return to factory for repair or discard product if any damage is found.)
- Inspect all nut and bolt assemblies to be certain none are loose.
- Inspect for any missing parts.
- Lubricate all pivot and slide together points with powder graphite to prevent noise, wear, and rust.
- Inspect entire product for any rust, corrosion, cracks, freezing, excessive heat, or rotting damage that may effect the safety of your product. Discard any questionable product.
- Inspect entire product for any structural damage - pay close attention to all weld locations. (Return to factory for repair or discard product if any damage is found.)
- Using correct wrenches inspect all nut & bolt assembly locations and snug up any that may be loose. Be careful not to crush tubing when tightening!
- Inspect and check operation of all cables, cable ends, cord, rope, webbing, and strap or chain assemblies. Replace with factory new any item or assembly that shows signs of wear, damage, kinking, or functions incorrectly.
- Inspect seat. Replace any seat with factory new that shows signs of structural damage or wear.
- Inspect all hardware for wear or damage, also be sure you have no missing parts.
- Never modify your stand in any way by making repairs, replacing parts, or altering adding or attaching anything to it except if explicitly authorized in writing by the manufacturer.

ASSEMBLY INSTRUCTIONS

Tools needed – two 7/16" wrenches

IMPORTANT ASSEMBLY TIP: Do not tighten nut & bolt combinations completely until all parts are assembled together. Finger tighten only plus one turn of a wrench only. This will temporarily hold the lock nut on the bolt while helping alignment of all parts. Tighten hardware after all parts are assembled together or when instructed below.

1. Attach the J-pipes (8) to the bottom of one of the mesh platforms (9) using six 1/4-20 x 2-1/4" bolts (24), locknuts (26) and steel washers (27). This now makes this mesh platform the foot platform. **SEE FIGURE 1.**
2. Attach the side braces (10) to the top of the foot platform (9) using four 1/4-20 x 2-1/4" bolts (24), locknuts (26) and steel washers (27). **SEE FIGURE 1.**
3. Attach the other mesh platform (9) to the top of side braces (10) using four 1/4-20 x 2-1/4" bolts (24), locknuts (26) and steel washers (27). This now makes this mesh platform the seat platform. **SEE FIGURE 2.**
4. a. Attach the platform X-braces (11) to the foot and seat platforms (9) using four 1/4-20 x 1-1/2" bolts (22), locknuts (26) and two steel washers (27). **SEE FIGURE 3.**

NOTE: Each X-brace attaches to the inside of the seat frame, under the mesh. Make sure the angle cut ends of X-brace are attached to seat frame. **SEE FIGURE 3. Use two steel washers at this location.**

- b. Next, secure the center of each X-brace (11) together using one 1/4-20 x 1" bolt (20) and locknut (26). **SEE FIGURE 3.**
5. Attach the tree blade supports (12) to the bottom of the seat platform (9) using six 1/4-20 x 2-1/4" bolts (24), locknuts (26) and steel washers (27). **SEE FIGURE 4.**
 6. Attach the tree blade (13) to the top of tree blade supports (12) using two 1/4-20 x 2-1/4" bolts (24), locknuts (26) and steel washers (27). **SEE FIGURE 4.**
 7. Attach the armrests (14) to the seat platform (9) using four 1/4-20 x 2-1/4" bolts (24), locknuts (26) and steel washers (27). **SEE FIGURE 4.**

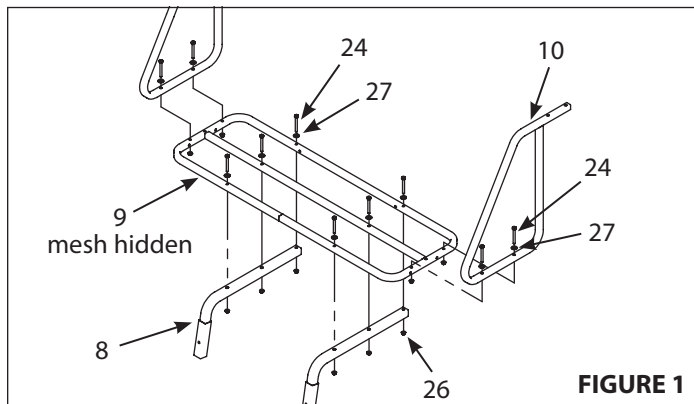

FIGURE 1

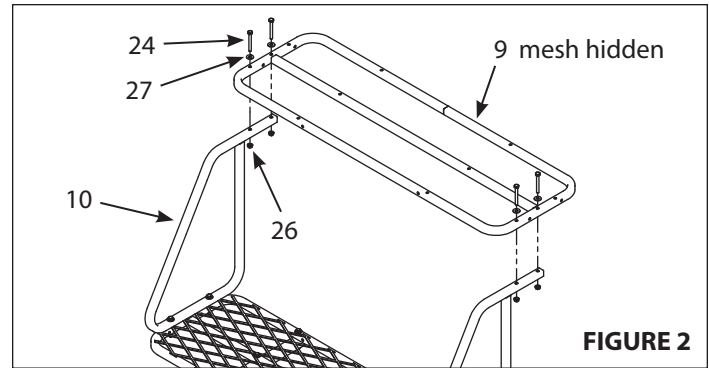

FIGURE 2

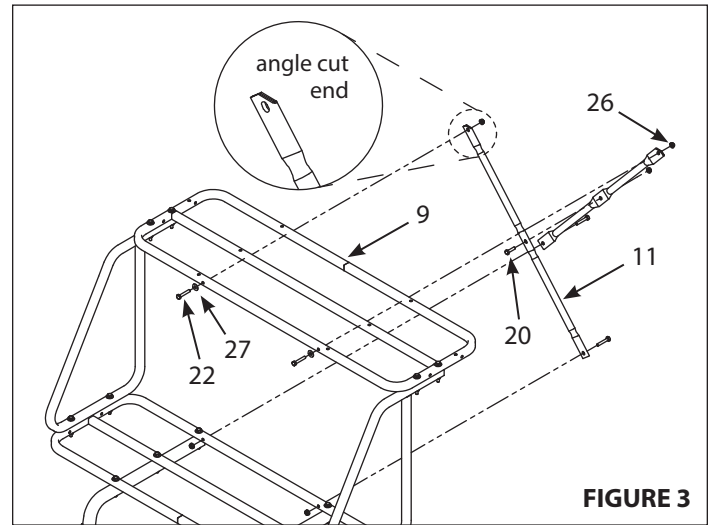

FIGURE 3

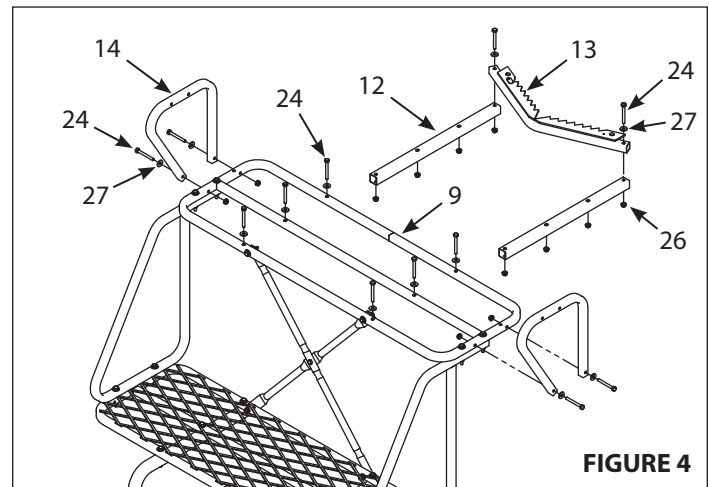
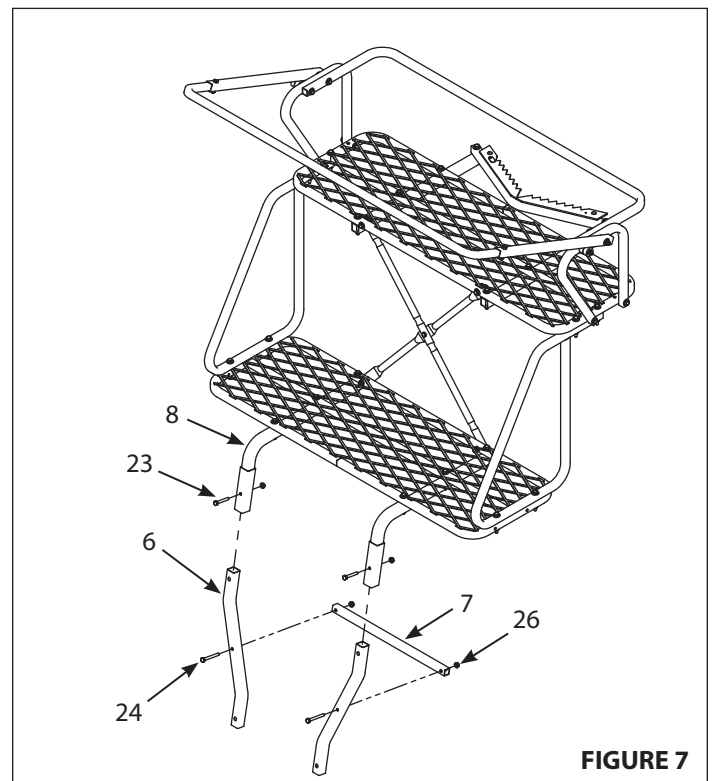
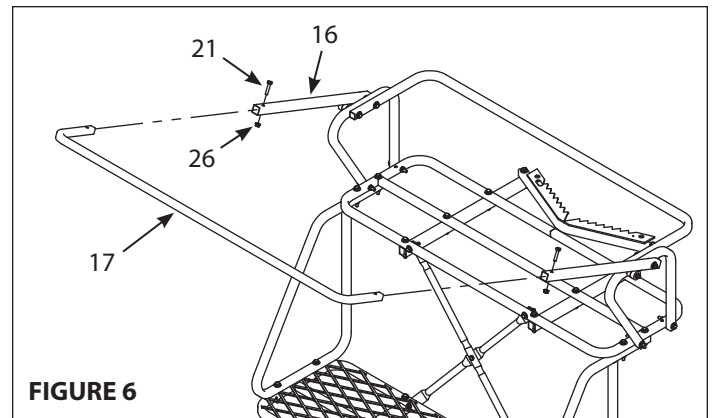
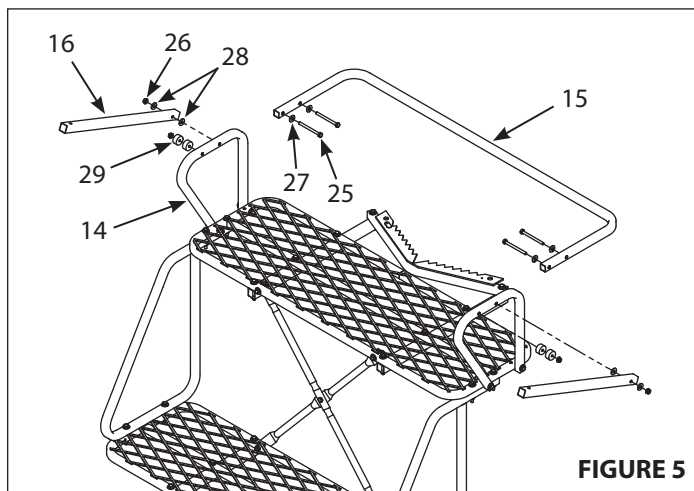

FIGURE 4

8. Attach the backrest rail (15) and both shooting rail extensions (16) to the armrests (14) using four 1/4-20 x 3" bolts (25), four locknuts (26), four steel washers (27), four plastic spacers (29) and four plastic washers (28). Shooting rail extensions should rest on top of the plastic spacers to act as the shooting rail rest. **SEE FIGURE 5.**

NOTE: Backrest rail (15) should go to the inside of armrests (14) and shooting rail extensions (16) should go to the outside. SEE FIGURE 5.

9. Insert the shooting rail (17) into the shooting rail extensions (16) and secure together using two 1/4-20 x 1-1/4" bolts (21) and locknuts (26). **SEE FIGURE 6.**
10. Insert the ladder offset extensions (6) into the J-pipes (8) and secure together using two 1/4-20 x 1-3/4" bolts (23) and locknuts (26). **SEE FIGURE 7.**
11. Attach offset extension step (7) to the offset extensions (6) using two 1/4-20 x 2-1/4" bolts (24) and locknuts (26). **SEE FIGURE 7.**
12. **You must now tighten all nut and bolt assemblies. Be sure not to over tighten or crush tubing when tightening.**
13. a. Attach the sewn seat pad (18) to the metal seat frame (9) by wrapping straps around metal frame and securely fastening all plastic buckles together. Pull straps tight so seat is not loose.
- b. Attach the sewn rail covers (19) to the shooting rail (17) and the backrest rail (15) by wrapping around tubing and attaching Velcro together.



14. Sections are assembled on the ground in the following order; bottom section (item #1, 3-step ladder); second section (item #2, 3-step ladder w/stabilizer bar mount); third section (item #3, 3-step ladder); top section (assembled top platform section). **SEE FINISHED 2-MAN LADDER LINEART.**

15. With all sections assembled together on ground, secure all sections together using six provided spring lock pins (30). **SEE FIGURE 8.**

16.a. Attach the stabilizer bar extension tube (4) to the second ladder section (2) mounting bracket using one spring lock pin (30). **SEE FIGURE 9.**

b. Slide the stabilizer bar (5) into the extension tube (4) and attach the two pieces together using one spring lock pin (30). Spring lock pin must go through both the extension tube and stabilizer bar at appropriate hole to achieve desired distance from tree. Adjustment in length may be needed when ladder is uprighted later in instructions. **SEE FIGURE 9.**

17.a. Tie one end of the 9' rope to the link welded onto the stabilizer bar. Be sure your double knots are secure. **SEE FIGURE 10.**

b. Tie one end of each of the 15' ropes to the square tube of tree blade supports (12), just in front of the tree blade (13). Be sure your double knots are secure. **SEE FIGURE 10.**

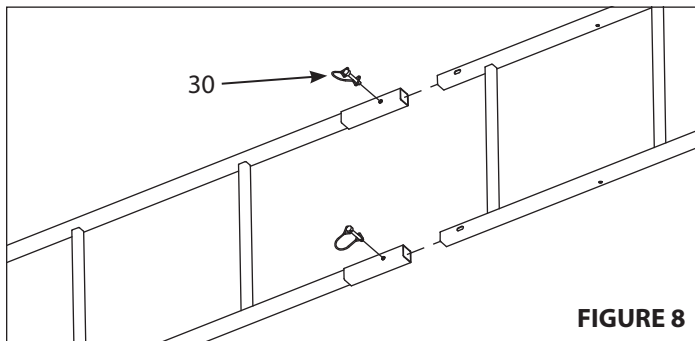

FIGURE 8

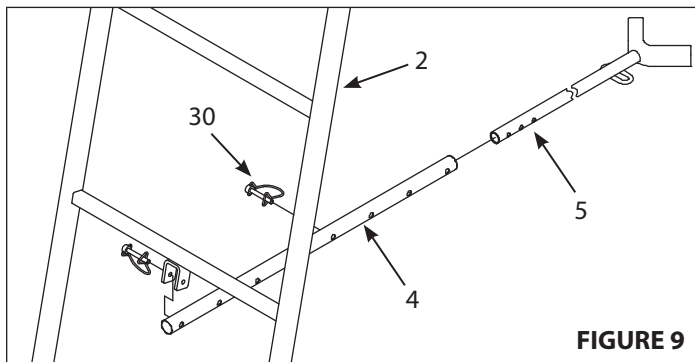

FIGURE 9

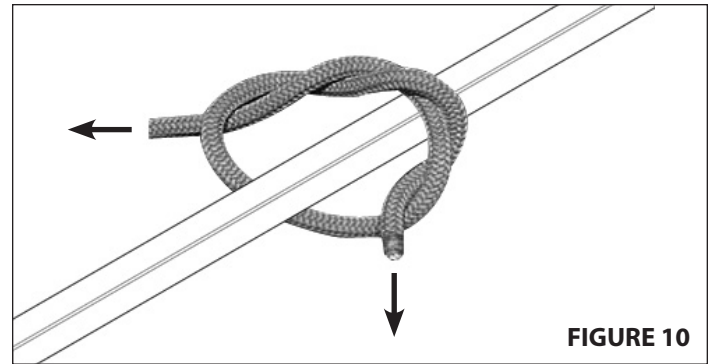
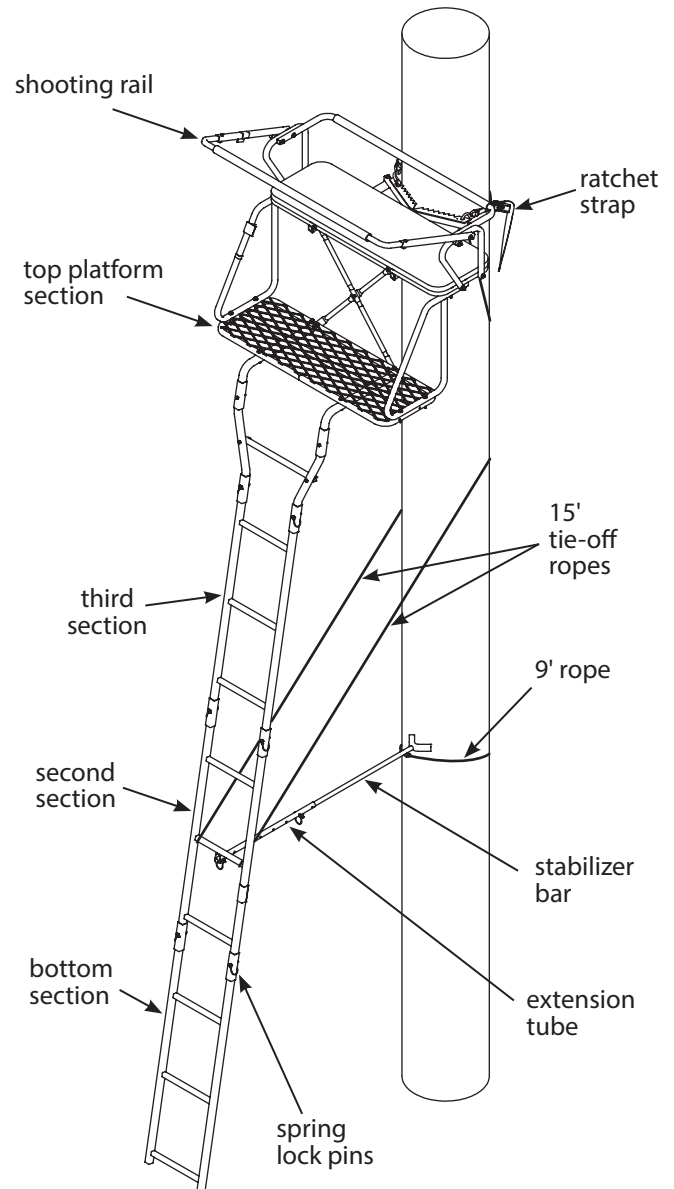

FIGURE 10

FINISHED STANDARD 2-MAN



SET-UP AND USE INSTRUCTIONS

During installation and removal of ladder treestands, you must always and properly use the included Full Body Harness (Fall Arrest System). Refer to the Full Body Harness instructions included with this product for proper use.

1. With assembled product lying on the ground in assembled position, **position one person at bottom end of ladder lying on the ground.** This person has to prevent the ladder end from tilting up when platform end is lifted and prevent the ladder from skidding across ground.
2.
 - a. Position (2) people at the platform end of the ladder, lift the platform end and continue uprighting by walking toward bottom end of ladder and moving hands along ladder legs. **Stand ladder up against chosen straight tree on dry, level ground.** Use caution when ladder comes over center against the tree.
 - b. Step back and look at the ladder top to see that platform tree blade is contacting the tree. Adjust as needed so the tree blade is contacting tree and the platform appears level.
 - c. Step down hard on bottom step to push ladder legs into the ground.
 - d. Wrap the 9' rope attached to stabilizer bar around tree and tie the free end to the link welded on stabilizer bar at the stabilizer bar height location. Secure the ladder tight so the stabilizer bar is at a right angle to the tree. Adjust stabilizer bar length as necessary so it contacts tree. Be absolutely sure the tree blade on the platform and the stabilizer bar are both contacting the tree.
 - e. Wrap the previously attached 15' tie-off ropes hanging down from platform, around the back side of tree in opposite directions of each other. Pull the ropes snug and tie them to the ladder at the stabilizer bar height location. This ground level ladder-to-tree attachment will prevent the ladder from pulling away from the tree while ascending to top for final ratchet strap attachment. The same holds true when ladder removal is necessary. **SEE FIGURE 11.**
3. **With two people securely holding the ladder,** use the three point contact climbing method to slowly climb the ladder and carefully keep a constant hand grip on the ladder at all times. Always lean forward, toward the tree, to keep the platform tree blade against the tree. **Be certain ladder bottom is firmly seated on dry, level ground. Attach your harness tether to the tree before securing the platform to the tree and stepping onto platform. Refer to the Full Body Harness instructions included with this product.**

WARNING

NEVER ASCEND OR DESCEND LADDER WITHOUT TIE-OFF ROPES SECURELY HOLDING LADDER TO TREE AND STABILIZER BAR SECURELY ATTACHED. FAILURE TO CORRECTLY PERFORM THESE STEPS CAN CAUSE THE LADDER TO COLLAPSE/BUCKLE-OVER BACKWARDS DURING THE INITIAL ASCENT TO ATTACH RATCHET STRAP RESULTING IN SERIOUS INJURY OR DEATH.

WARNING

DOUBLE CHECK ASSEMBLY STEPS TO BE CERTAIN YOU HAVE CORRECTLY ASSEMBLED THIS PRODUCT.

STUDY YOUR NEW STAND TO BECOME FAMILIAR WITH ALL OF ITS FEATURES AND DESIGN. AT GROUND LEVEL, FOLLOWING PROVIDED USE INSTRUCTIONS, PRACTICE ATTACHING STAND TO TREE AND REMOVING STAND FROM TREE. PRACTICE SITTING, STANDING, AND USING THIS PRODUCT BEFORE ATTACHING OVERHEAD. SAVE THESE INSTRUCTIONS FOR FUTURE REFERENCE. YOU MUST ALWAYS USE THE PROVIDED FULL BODY HARNESS (FALL ARREST SYSTEM) THAT MEETS TMA STANDARDS WHILE USING THIS PRODUCT.

ALWAYS USE THREE PEOPLE FOR SET-UP AND TAKE-DOWN. BE ABSOLUTELY SURE THE TREE BLADE(S) ON PLATFORM AND THE STABILIZER BAR ARE BOTH CONTACTING TREE BEFORE CLIMBING LADDER.

STABILIZER BAR MUST ALWAYS BE CORRECTLY AND SECURELY ATTACHED TO LADDER AND TREE BEFORE CLIMBING LADDER.

SOME MODELS INCLUDE A MULTI-PIECE STABILIZER BAR SYSTEM. BE SURE SPRING LOCK PIN GOES THROUGH BOTH THE EXTENSION TUBE AND THE STABILIZER BAR.

BE CERTAIN SPRING LOCK PINS ARE LATCHED SECURELY TO PREVENT ACCIDENTAL REMOVAL.

BE SURE YOUR DOUBLE KNOTS ARE ALL SECURE ON ALL ROPE CONNECTIONS.

NEVER ASCEND OR DESCEND LADDER WITHOUT TIE-OFF ROPES SECURELY HOLDING LADDER TO TREE AND STABILIZER BAR SECURELY ATTACHED. FAILURE TO CORRECTLY PERFORM THESE STEPS CAN CAUSE THE LADDER TO COLLAPSE/BUCKLE-OVER BACKWARDS DURING THE INITIAL ASCENT TO ATTACH RATCHET STRAP RESULTING IN SERIOUS INJURY OR DEATH.

BACK VIEW OF TREE

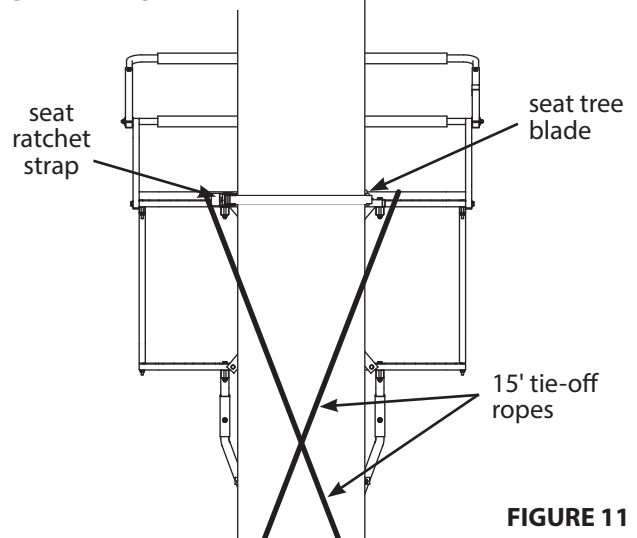

FIGURE 11

4. Standing on ladder step, lean toward tree with ratchet strap now in hand, Hook "S" hook with long strap through hole provided on seat tree blade. Feed the long strap through the center (slot) of ratcheting mechanism and back around through tightening lever. **SEE FIGURES 12 AND 14.**

NOTE: Be sure you feed the long strap correctly so there are no twists in the strap.

Wrap entire ratchet assembly around tree and hook other "S" hook through opposite tree blade hole. Pull tail of long strap until most of the slack is taken out. Be sure entire strap is even and at the same level all around tree. "Ratchet" tight to tree, this will securely attach ladder to tree and prevent movement. **SEE FIGURES 12 AND 13.**

NOTE: To release ratchet, simply pull the release lever and open tightening lever wide open (flat).

5. Reverse setup and use instructions to take ladder down.

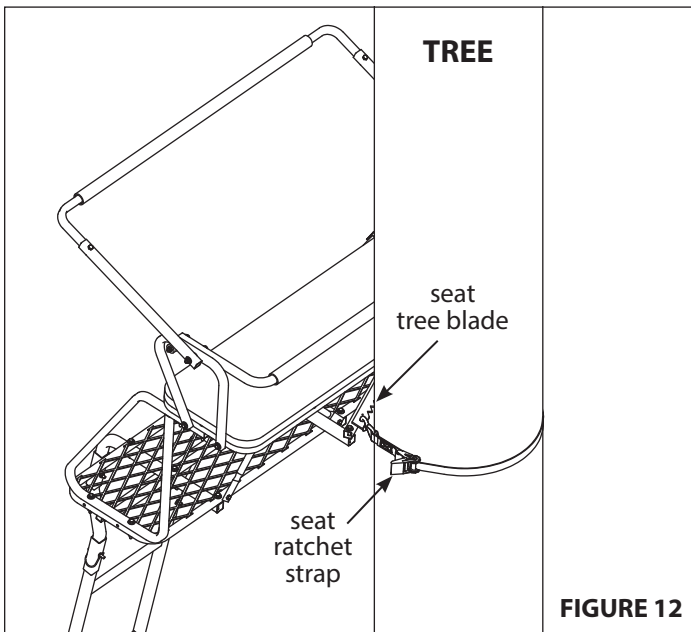

FIGURE 12

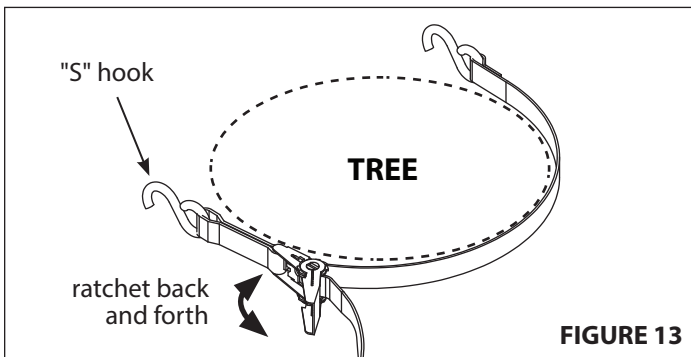

FIGURE 13

! WARNING

BE SURE ONLY ONE PERSON ASCENDS OR DESCENDS LADDER AT A TIME. BE CERTAIN FIRST PERSON IS SEATED SAFELY, AND ATTACHED TO TREE WITH PROVIDED FULL BODY HARNESS (FALL ARREST SYSTEM) THAT MEETS TMA STANDARDS CORRECTLY BEFORE SECOND PERSON ASCENDS OR DESCENDS LADDER.

NEVER HAVE TWO PEOPLE ON ONE SIDE OF THE PLATFORM. KEEP WEIGHT EVENLY DISTRIBUTED ON PLATFORM.

BE CERTAIN TO ALWAYS LEAN FORWARD, TOWARD THE TREE WHEN ASCENDING OR DESCENDING LADDER. ATTACH YOUR HARNESS TETHER TO THE TREE BEFORE SECURING THE PLATFORM TO THE TREE AND STEPPING ONTO THE PLATFORM.

ALWAYS HAVE THREE POINTS OF CONTACT WHILE CLIMBING LADDER.

BRING RATCHET STRAP(S) UP WITH YOU IN A POCKET- DO NOT CARRY IN YOUR HANDS!

DO NOT ALLOW EXCESSIVE STRAP BUILDUP IN RATCHET AS THIS WILL PREVENT THE RATCHET TEETH FROM ENGAGING CAUSING SLIPPAGE.

ALWAYS ATTACH RATCHET STRAPS SECURELY WHILE USING THIS PRODUCT!

NEVER STAND ON LADDER SEAT, IT IS DESIGNED FOR SITTING ONLY.

SEAT IS REMOVABLE. BE CERTAIN IT IS SECURELY ATTACHED WHEN IN USE.

NEVER LEAN AGAINST, LEAN OVER, OR SIT ON SHOOTING RAIL. IT IS DESIGNED AS A SHOOTING REST ONLY. ALWAYS BE AWARE THAT THE SHOOTING RAIL CAN PIVOT UP AND DOWN.

BE SURE SHOOTING RAIL IS FLIPPED BACK WHEN ASCENDING OR DESCENDING LADDER.

ALWAYS BE AWARE OF THE OTHER PERSON'S POSITION. USE EXTREME CAUTION WHEN WEAPONS ARE USED TO PREVENT PERSONAL INJURY.

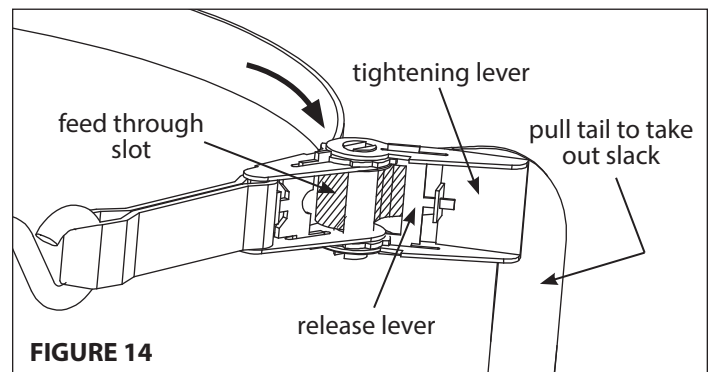
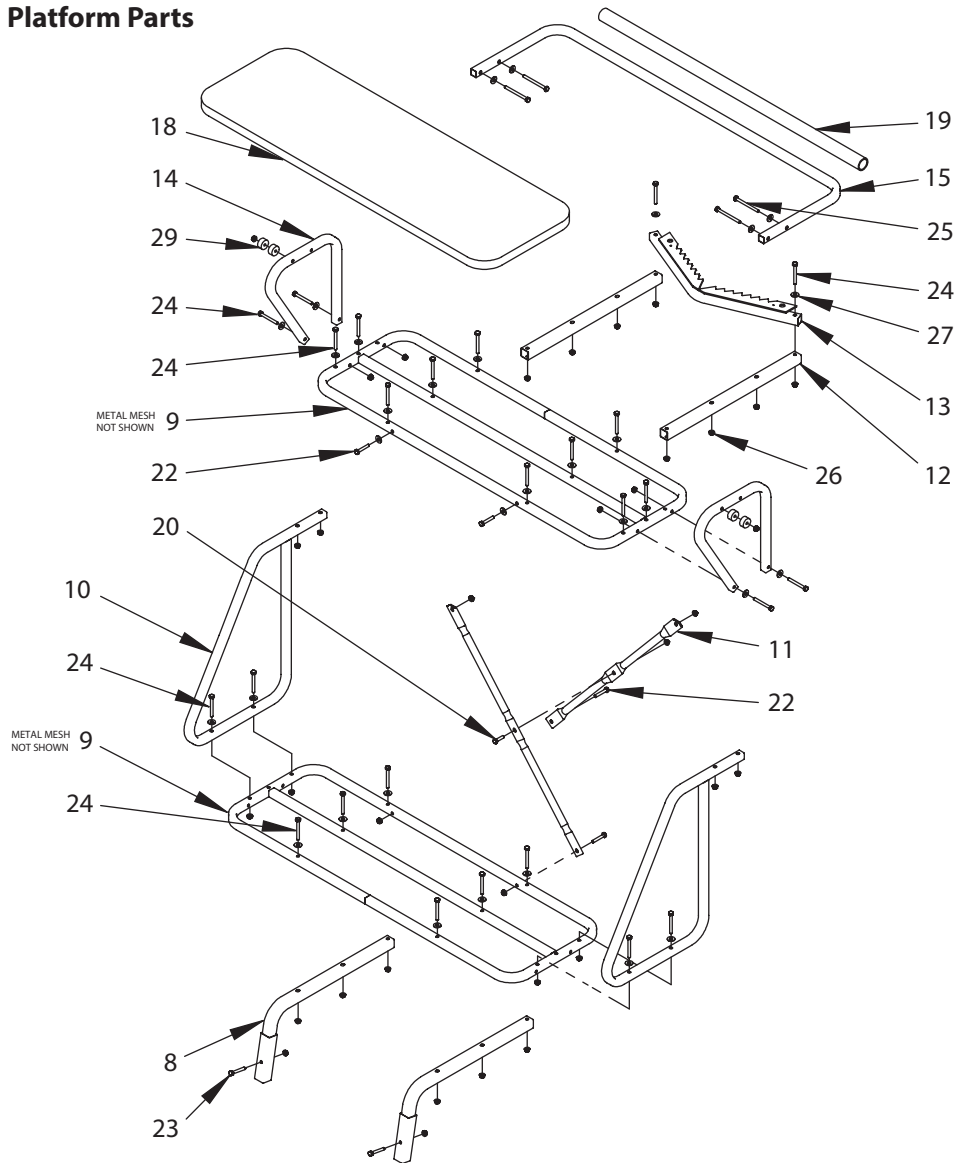

FIGURE 14

PARTS EXPLOSION

Platform Parts



Ladder Parts

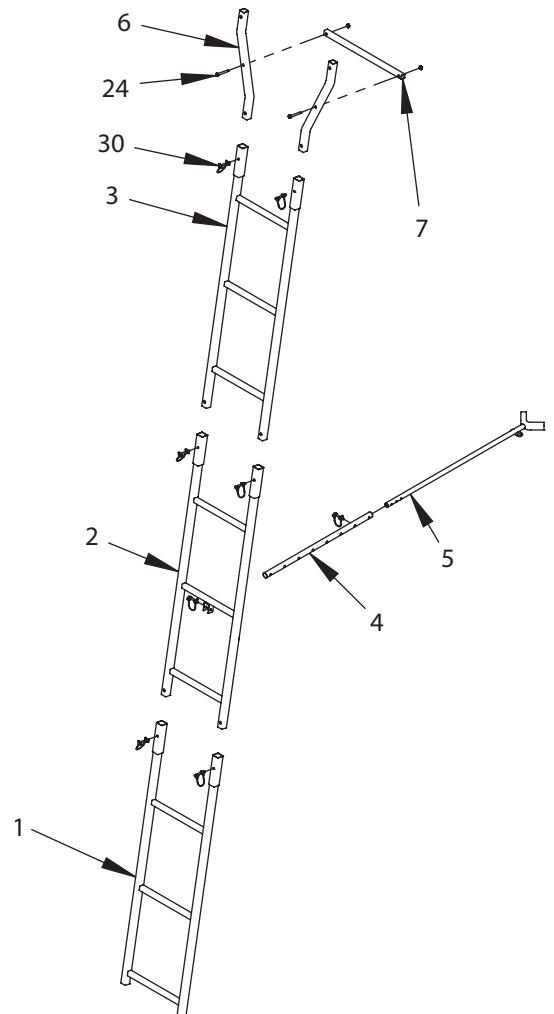

Shooting Rail Parts

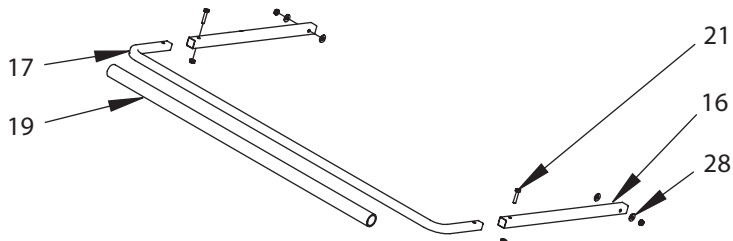

PARTS LIST

KEY #	PART #	DESCRIPTION	QTY.
1	18833	WELDMENT LADDER SECTION BOTTOM	1
2	18831	WELDMENT LADDER SECTION MIDDLE W/VAM	1
3	18829	WELDMENT LADDER SECTION TOP	1
4	18835	FTS EXTENSION STABILIZER BAR ROUND 16.5	1
5	410073	WELDMENT STABILIZER BAR 29.25"	1
6	19756	FTS LADDER OFFSET EXTENSION	2
7	19757	FTS OFFSET EXTENSION STEP	1
8	19754	WELDMENT J PIPE LADDER	2
9	19751	WELDMENT PLATFORM	2
10	19758	FTS PLATFORM SIDE BRACE	2
11	19759	FTS PLATFORM X BRACE	2
12	18873	FTS TREE BLADE SUPPORT	2
13	18871	WELDMENT TREE BLADE	1
14	19760	FTS ARMREST	2
15	19761	FTS BACK REST	1
16	19762	FTS SHOOTING RAIL EXTENSION	2
17	19763	FTS SHOOTING RAIL	1
18	19855	SEAT CUSHION	1
19	19854	SHOOTING RAIL BACKREST COVER	2
20	63282	BOLT 1/4-20 X 1 INCH	1
21	8909B	BOLT 1/4-20 X 1-1/4 INCH	2
22	48240B	BOLT 1/4-20 X 1-1/2 INCH	4
23	48250B	BOLT 1/4-20 X 1-3/4 INCH	2
24	48271B	BOLT 1/4-20 X 2-1/4 INCH	28
25	48280B	BOLT 1/4-20 X 3 INCH	4
26	48752B	NUT 1/4-20	41
27	48261B	WASHER 1/4 INCH FLAT	32
28	WN516	WASHER PLASTIC 1/4 INCH	4
29	10347	SPACER PLASTIC 1/4 INCH X 1 INCH	4
30	19847	LOCKPIN 6 MM X 50.8 MM ROUND	8

Maximum Height - 16' to shooting rail

Maximum Field Rating - 500 lb; no more than 300 lb per person

Tree Diameter Range - 12" to 20"

ITEMS NOT SHOWN:

PART #	DESCRIPTION	QTY.
48415	RATCHET STRAP	1
10531	FULL BODY HARNESS (FAS)	2
48691	TIE-OFF ROPE KIT (INCLUDES TWO 15' ROPES AND ONE 9' ROPE)	1
48800	DVD TREESTAND SAFETY	1

**NO EXTENSIONS AVAILABLE FOR THIS MODEL.
NEVER MODIFY OR EXCEED ORIGINAL STATED USE HEIGHT!**

HARDWARE IDENTIFICATION CHART

Hardware shown are for size reference only. Extra hardware may be included in the parts bag.

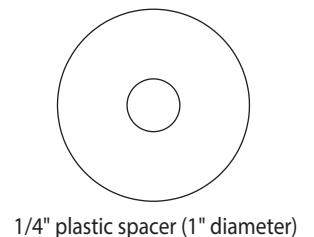
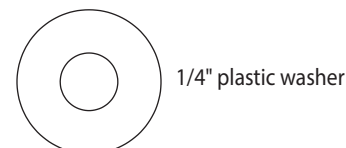
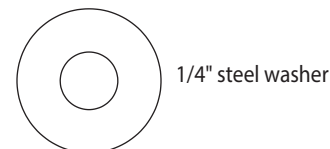
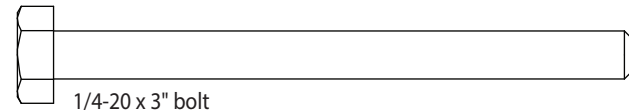
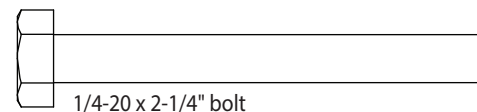
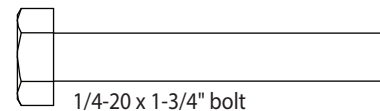
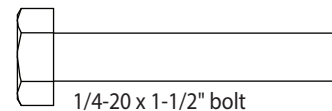
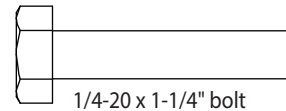
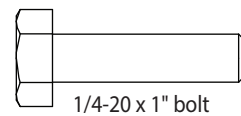



Rivers Edge® Treestands, Inc.
1160 Eighth Avenue, PO Box 755
Cumberland, WI 54829
800-450-EDGE (3343) | Fax 715-822-2124
Email: info@huntriversedge.com