

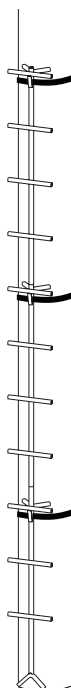

CLIMBING AID INSTRUCTIONS

Rapid Stick™ Models

**15' RAPID STICK
Model RE709**



**20' RAPID STICK
Model RE708**

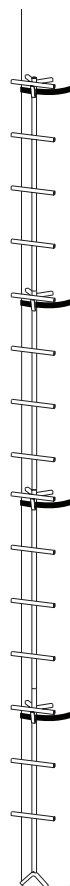

**5' EXTENSION
Model RE710**



Certified to
TMA Standards
by Independent
Test Lab



HuntRiversEdge.com

OMRE70809
Rev. 11/24/08
© 2009 Rivers Edge Treestands, Inc.
All Rights Reserved.

20' Rapid Stick (RE708) 15' Rapid Stick (RE709) 5' Extension (RE710)

Rivers Edge Treestands are engineered with you the hunter in mind. We appreciate your purchase of one of our world class climbing aids. Follow these few simple instructions and your climbing aid will provide you many years of trouble-free pleasure. Instructions should be kept in a safe place and reviewed at least annually.

If for any reason you have a problem with your product, **DO NOT return to the retailer**, contact the Rivers Edge customer service department at 800-450-EDGE (3343) for assistance.

ASSEMBLY INSTRUCTIONS

Tools needed – two 7/16" wrenches

IMPORTANT ASSEMBLY TIP: *Do not tighten any nut and bolt combinations completely until all parts are assembled together! Finger tighten plus one turn of a wrench only! This will temporarily hold the lock nut on the bolt while helping alignment of all parts! After all parts are assembled together, all nut & bolt combinations must be completely tightened.*

1. Attach one tree hugger (SS12) to each stick section using (1) provided 1/4-20 x 3-1/4" bolt, 5/16" washer, 1/4" washer and locknut on each section. **SEE FIGURE 1.** Tighten all nut & bolt assemblies. Be sure not to over tighten or crush tubing when tightening!

NOTE: Head of bolt should be on front side of step and washers and locknut should be on back side of tree hugger.

2. Attach the provided anti-slip tape (48104) to the top side of each step. The step must be clean and at room temperature to assure proper adhesion.
3. Thread the snap hook through the pocket on the vertical post of each section. **SEE FIGURE 2.** Temporarily and loosely tie the strap (48748) to the Rapid Stick section to prevent it from falling off during transport and uprighting.

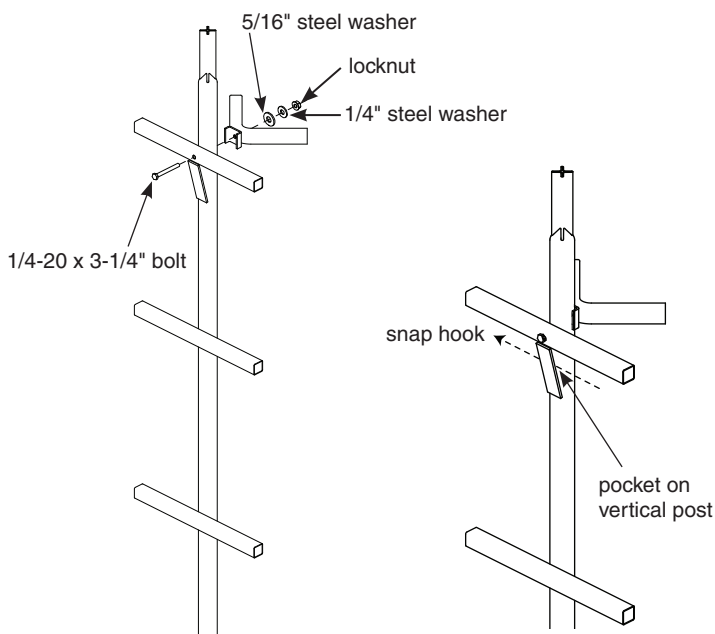

FIGURE 1

FIGURE 2

WARNING

YOU MUST PURCHASE AND ALWAYS USE A FULL BODY HARNESS (FALL ARREST SYSTEM) WITH A CLIMBING BELT THAT MEETS TMA STANDARDS WHILE USING THIS PRODUCT. SINGLE SAFETY BELTS AND CHEST HARNESSES ARE NO LONGER ALLOWED AND SHOULD NEVER BE USED. IF YOU ARE NOT WEARING A FULL BODY HARNESS PROPERLY ATTACHED TO THE TREE THAT IS PROTECTING YOU FROM A FALL, DO NOT LEAVE THE GROUND.

READ, UNDERSTAND AND FOLLOW ALL ASSEMBLY, INSPECTION, MAINTENANCE & USE INSTRUCTIONS PROVIDED BEFORE EACH USE. FAILURE TO FOLLOW ALL WARNINGS AND INSTRUCTIONS COULD RESULT IN SERIOUS INJURY OR DEATH.

ALL ASSEMBLY MUST BE DONE IN THIS ORDER AT GROUND LEVEL BEFORE USE.

DO NOT CRUSH TUBING WHEN TIGHTENING BOLT ASSEMBLIES! IDENTIFY AND FAMILIARIZE YOURSELF WITH ALL PARTS BEFORE YOU START. A BOLT IDENTIFICATION CHART CAN BE FOUND IN THE BACK.

LUBRICATION IS HIGHLY RECOMMENDED AT SLIDE TOGETHER POINTS OF EACH SECTION TO PREVENT BINDING. SECTIONS ARE STACKED TOGETHER BY SLIDING SECTIONS TOGETHER, INSIDE OF EACH OTHER.

BE SURE SECTIONS ARE SEATED COMPLETELY TOGETHER ON SWEDGED ENDS OF PIPE.

DOUBLE CHECK ASSEMBLY STEPS TO BE CERTAIN YOU HAVE CORRECTLY ASSEMBLED THIS PRODUCT.

MAINTENANCE TASKS TO BE DONE BEFORE EACH & EVERY USE. REPLACE ANY QUESTIONABLE COMPONENTS IMMEDIATELY WITH FACTORY ORIGINAL PARTS ONLY!

STUDY YOUR NEW STICK TO BECOME FAMILIAR WITH ALL OF ITS FEATURES AND UNIQUE DESIGN. PRACTICE SETTING UP AT GROUND LEVEL BEFORE MOUNTING IT OVERHEAD. SAVE THESE INSTRUCTIONS FOR FUTURE REFERENCE. PROPERLY USE A FULL BODY HARNESS (FALL ARREST SYSTEM) WITH A CLIMBING BELT THAT MEETS TMA STANDARDS AT ALL TIMES, INCLUDING ASCENDING TO AND DESCENDING FROM A TREESTAND.

20' Rapid Stick (RE708) 15' Rapid Stick (RE709) 5' Extension (RE710)

- Sections are assembled on the ground in the following order: bottom section (SS9), middle section (SS10), top section (SS11). **SEE FINISHED 15' RAPID STICK.** Sections are stacked together by sliding sections together, inside of each other.

NOTE: On 20' model, a second middle section (SS10) is inserted between bottom and top sections. SEE FINISHED 20' RAPID STICK.

NOTE: If you purchased the optional 5' Extension (RE710), it is to be inserted (positioned) between top & bottom sections. Extensions are the same design as the middle sections that come with a complete 15' Rapid Stick or 20' Rapid Stick.

INSPECTION INSTRUCTIONS

- Inspect strap assemblies for wear or damage.
- Inspect entire product for any structural damage, rust, or freezing - pay special attention to all weld locations.

SETUP AND USE INSTRUCTIONS

- Stand the stick up against the **selected straight tree on dry, level ground.** Take the buckle end of the bottom section strap, wrap it around the tree, and attach it to the snap hook end of the strap. **SEE FIGURE 3.** Pull the strap so that the section is snugly secured to the tree.

NOTE: Be sure you feed the strap correctly so there are no twists in the strap.

- Climb up your Rapid Stick only far enough to reach the middle section strap and attach it to the tree, refer to step 1.
- Repeat strap attachment for each section until all sections are securely attached.
- Reverse setup and use instructions to take down stick.

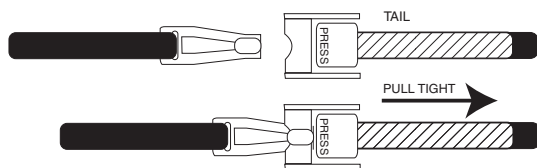

FIGURE 3

WARNING

YOU MUST PURCHASE AND ALWAYS USE A FULL BODY HARNESS (FALL ARREST SYSTEM) WITH A CLIMBING BELT THAT MEETS TMA STANDARDS WHILE USING THIS PRODUCT. SINGLE SAFETY BELTS AND CHEST HARNESSES ARE NO LONGER ALLOWED AND SHOULD NEVER BE USED. IF YOU ARE NOT WEARING A FULL BODY HARNESS PROPERLY ATTACHED TO THE TREE THAT IS PROTECTING YOU FROM A FALL, DO NOT LEAVE THE GROUND.

A FULL BODY HARNESS WITH LINEMAN'S/CLIMBING BELT MUST BE WORN AT ALL TIMES WHILE INSTALLING OR REMOVING ANY HANG-ON CLIMBING AIDS.

READ, UNDERSTAND AND FOLLOW ALL ASSEMBLY, INSPECTION, MAINTENANCE & USE INSTRUCTIONS PROVIDED BEFORE EACH USE. FAILURE TO FOLLOW ALL WARNINGS AND INSTRUCTIONS COULD RESULT IN SERIOUS INJURY OR DEATH.

NEVER USE ANY PRODUCT THAT HAS NOT BEEN MAINTAINED OR INSPECTED PROPERLY - YOUR LIFE DEPENDS ON IT!

DO NOT UNDER ANY CIRCUMSTANCES EXCEED THE MAXIMUM USAGE HEIGHT OF 20'. 5' EXTENSIONS CAN ONLY BE USED WITH THE 15' RAPID STICK.

NEVER ATTACH TO A DEAD, ODD-SHAPED, LEANING, DISEASED, LOOSE-BARKED TREE OR UTILITY POLES.

HANG-ON CLIMBING AIDS MUST BE PLACED ON THE TREE AT A HEIGHT ABOVE THE PLATFORM WHERE THE USER CAN MAINTAIN A HANDHOLD ON THE UNIT AND STEP DOWNWARDS ONTO THE TREESTAND. NEVER STEP UP FROM A CLIMBING DEVICE TO GET INTO YOUR STAND.

WHEN USING A CLIMBING/LINEMAN'S BELT TO ASCEND THE TREE, THE FULL BODY HARNESS SHOULD BE ATTACHED TO THE TREE BEFORE STEPPING DOWN ONTO THE TREESTAND.

SECTIONAL LADDERS AND STEPS SHOULD BE SPACED ON THE TREE TO INSURE EACH STEP IS NO MORE THAN 18 INCHES APART.

CHECK EVERY STICK LADDER SECTION CONNECTION EVERY TIME YOU USE THE STICK LADDER BEFORE YOU LEAVE THE GROUND. IF STICK LADDER SECTIONS ARE SEPARATING, DO NOT USE THE STICK LADDER.

ALWAYS ATTACH SO THE SPRING LOADED CAM LEVER OF THE STRAPS FACES AWAY FROM THE TREE. NEVER TOUCH THE CAM LEVER WHILE PUTTING WEIGHT ON THE STICK AND/OR CLIMBING THE STICK AS THIS COULD POTENTIALLY RELEASE THE STRAP AND REMOVE THAT SECTION OF RAPID STICK FROM THE TREE.

NEVER HOLD ONTO ANY SECTION OR PULL ON ANY SECTION THAT IS NOT SECURELY ATTACHED TO TREE WITH THE SUPPLIED STRAP AND BUCKLE.

BE SURE TO RAISE AND LOWER YOUR WEAPON AND GEAR WITH A HAUL LINE. GUN BARREL END AND ARROW TIPS MUST BE POINTED DOWN- AWAY FROM YOU.

WHEN HUNTING FROM A TREESTAND, FALLS CAN OCCUR ANY TIME AFTER LEAVING THE GROUND CAUSING INJURY OR DEATH.

NEVER JUMP OR BOUNCE ON A STICK LADDER TO SEAT IT TO THE TREE.

20' Rapid Stick (RE708) 15' Rapid Stick (RE709) 5' Extension (RE710)

ALWAYS...

- Be physically fit, mentally alert, and well rested before using this product.
- Read, understand and follow all warnings and instructions before use, save for future reference.
- Use a Full Body Harness (Fall Arrest System) with a climbing belt that meets TMA standards at all times including ascending to and descending from a treestand.
- Be fully aware of foot placement.
- Recommended for adult use only.
- Inspect for missing parts, all hardware condition, and damage before every application, replace if necessary.
- Remove after every use, store product indoors.
- Use only Rivers Edge original replacement parts.
- Lean forward, toward tree, when ascending or descending climbing aid.
- Place climbing aid on dry, level ground.
- Lubricate all slide together points with powder graphite to prevent binding, wear, rust & noise.
- Avoid all electrical power lines.
- Inform someone of the hunting location, where the treestand will be located and the expected duration of the hunt.
- Carry a signal device such as a mobile phone, radio, whistle, signal flare or personal locator device (PLD) and it must be readily available at all times.
- Inspect the climbing aid/treestand and all safety devices each time before use and do not store outdoors when not in use.

NEVER...

- Exceed maximum usage height of 20'.
- Sleep in a treestand.
- Use on wet, soft, or unstable ground.
- Exceed the total field rating of 300 lbs.
- Attach to a dead, odd-shaped, leaning, diseased, loose-barked tree or utility pole.
- Use on trees with a diameter smaller than 8 inches or larger than 20 inches.
- Use a climbing aid/treestand during inclement weather such as rain, lightning, windstorms or icy conditions and end your hunt and return to the ground if inclement conditions arise.
- Carry gun or bow when ascending or descending.
- Alter the original design of your climbing aid.
- Jump on or use in a careless manner.
- Lean out over edge of device.
- Use when intoxicated or using over-the-counter medication or prescription drugs.
- Use a climbing aid/treestand when feeling ill, nauseous or dizzy, or if you have a prior medical condition that could cause a problem (i.e. heart condition, joints that lock up, spinal fusions, etc.) or if you are not well rested.
- Rely on a tree branch for support.
- Use a damaged product, replace with new.
- Loan your climbing aid to someone else.

WARNING

BE SURE TO RAISE AND LOWER YOUR WEAPON OR GEAR WITH A HAUL LINE. GUN BARREL END OR ARROW TIPS MUST BE POINTED DOWN - AWAY FROM YOU.

INSTRUCTIONS SHOULD BE KEPT IN A SAFE PLACE AND REVIEWED AT LEAST ANNUALLY.

READ AND PERFORM ALL MAINTENANCE TASKS AS DESCRIBED IN INSPECTION AND MAINTENANCE.

READ, UNDERSTAND AND FOLLOW ALL ASSEMBLY, INSPECTION, MAINTENANCE & USE INSTRUCTIONS PROVIDED BEFORE EACH USE. FAILURE TO FOLLOW ALL WARNINGS AND INSTRUCTIONS COULD RESULT IN SERIOUS INJURY OR DEATH.

FAILURE TO USE OR IMPROPER USE OF A FULL BODY HARNESS (FALL ARREST SYSTEM) WITH A CLIMBING BELT THAT MEETS TMA STANDARDS MAY RESULT IN SERIOUS INJURY OR DEATH!

READ AND UNDERSTAND ALL INSTRUCTIONS. IF ANY INSTRUCTIONS ARE NOT UNDERSTOOD OR IF YOU HAVE A PARTS ISSUE CALL 800-450-EDGE (3343) BEFORE USING.

20' Rapid Stick
Model RE708

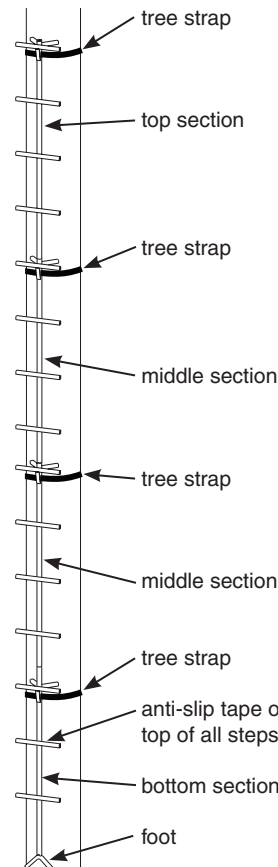

15' Rapid Stick
Model RE709

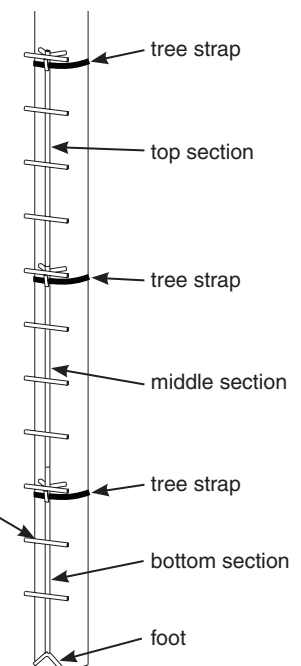

INSPECTION AND MAINTENANCE SCHEDULE

FOR ALL RIVERS EDGE PRODUCTS

- Inspect all webbing, rope, cord, and strap assemblies for wear or damage.
- Inspect cables and cable ends for damage or kinking.
- Inspect all hardware and chain components for damage.
- Inspect for any structural damage to product. (Return to factory for repair or discard product if any damage is found.)
- Inspect all nut and bolt assemblies to be certain none are loose.
- Inspect for any missing parts.
- Lubricate all pivot and slide together points with powder graphite to prevent noise, wear, and rust.
- Inspect entire product for any rust, corrosion, cracks, freezing, excessive heat, or rotting damage that may effect the safety of your product. Discard any questionable product.
- Inspect entire product for any structural damage - pay close attention to all weld locations. (Return to factory for repair or discard product if any damage is found.)
- Using correct wrenches inspect all nut & bolt assembly locations and snug up any that may be loose. Be careful not to crush tubing when tightening!
- Inspect and check operation of all cables, cable ends, cord, rope, webbing, and strap or chain assemblies. Replace with factory new any item or assembly that shows signs of wear, damage, kinking, or functions incorrectly.
- Inspect seat. Replace any seat with factory new that shows signs of structural damage or wear.
- Inspect all hardware for wear or damage, also be sure you have no missing parts.
- Never modify your stand in any way by making repairs, replacing parts, or altering adding or attaching anything to it except if explicitly authorized in writing by the manufacturer.

WARNING

READ BEFORE USING...SAVE THESE INSTRUCTIONS.

PERFORM THESE TASKS BEFORE EACH AND EVERY USE. (REPLACE ANY QUESTIONABLE COMPONENTS IMMEDIATELY WITH RIVERS EDGE ORIGINAL REPLACEMENT PARTS.) DO NOT LEAVE YOUR STAND OUTDOORS - REMOVE AFTER EACH USE AND STORE INDOORS!

REPLACE ANY AND ALL TREESTAND STRAPS EVERY TWO YEARS OR WHEN ANY SIGNS OF DAMAGE OR WEAR EXIST BEFORE.

NEVER USE ANY PRODUCT THAT HAS NOT BEEN MAINTAINED OR INSPECTED PROPERLY- YOUR LIFE DEPENDS ON IT!

WARRANTY

Rivers Edge Treestands, Inc., offers a lifetime warranty to be free from defects in materials and workmanship. This warranty applies to the original owner with a proof of purchase. All items attached to our stands (seat, strap, rope, wood, etc.) that are degradable are warranted for a period of one year. There is no warranty on paint. This warranty applies to products that are not modified, abused or misused in a manner that deviates from the products intended usage. Rivers Edge Treestands offers no other warranty expressed or implied nor is to be held liable for any damage that may result from any defect in a treestand manufactured by them. Warranty work must be sent directly to Rivers Edge Treestands and performed by them. **To obtain warranty service and/or replacement instructions, you must have prior approval from Rivers Edge Treestands before shipping your package to us by calling our customer service department at 800-450-EDGE (3343) or by writing to: Rivers Edge Treestands, Inc., P.O. Box 755, 1690 Elm Street, Cumberland, WI 54829 for a return material authorization number (RMA#).** All items must be shipped prepaid. Rivers Edge Treestands will at no charge, repair or replace, at their discretion, any defective stand which falls under the conditions stated above. Rivers Edge Treestands retains the right to change models, specifications and price without notice.

This equipment has been manufactured under strict quality guidelines. As with any equipment of this type, full understanding of the instructions and its use is mandatory for the safety of its user. Rivers Edge Treestands, Inc., is not responsible for any damages or injuries sustained due to improper use or modification of any of its products, or due to any use which deviates from the products intended usage. The manufacturer also is not responsible for any injuries sustained due to failure to adhere to the instructions for use. Any misunderstanding of its operation should be directed to manufacturer prior to its use.

Owner is responsible to check product field rating and must never exceed maximum weight rating stated. Rivers Edge Treestands, Inc., is not responsible for any malfunction due to normal wear and tear and/or damage caused by improper use, improper maintenance or accidents. This product if used safely as intended, will give you years of trouble free service. We hope you will enjoy the quality of our products for years to come, and have a safe hunt.

For replacement parts, phone 800-450-EDGE (3343) or go online to www.HuntRiversEdge.com.

20' Rapid Stick (RE708) 15' Rapid Stick (RE709) 5' Extension (RE710)

15' AND 20' RAPID STICK PARTS

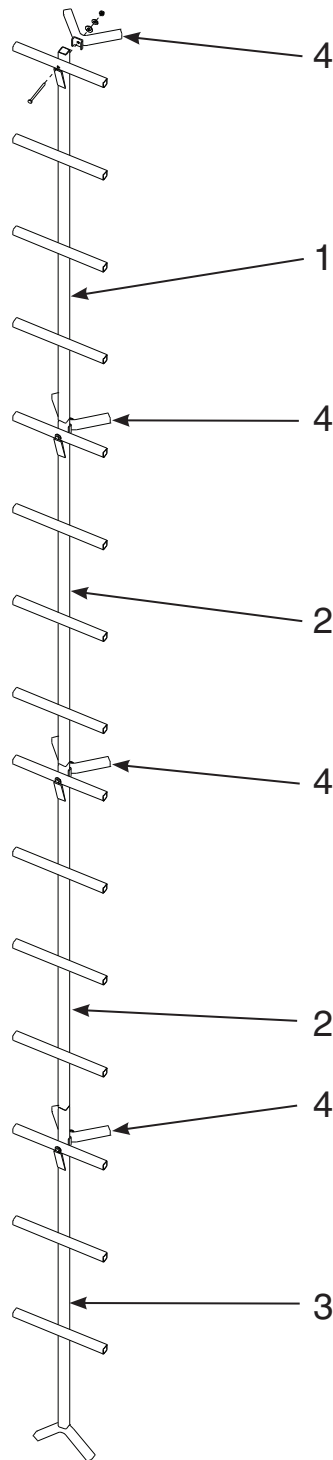
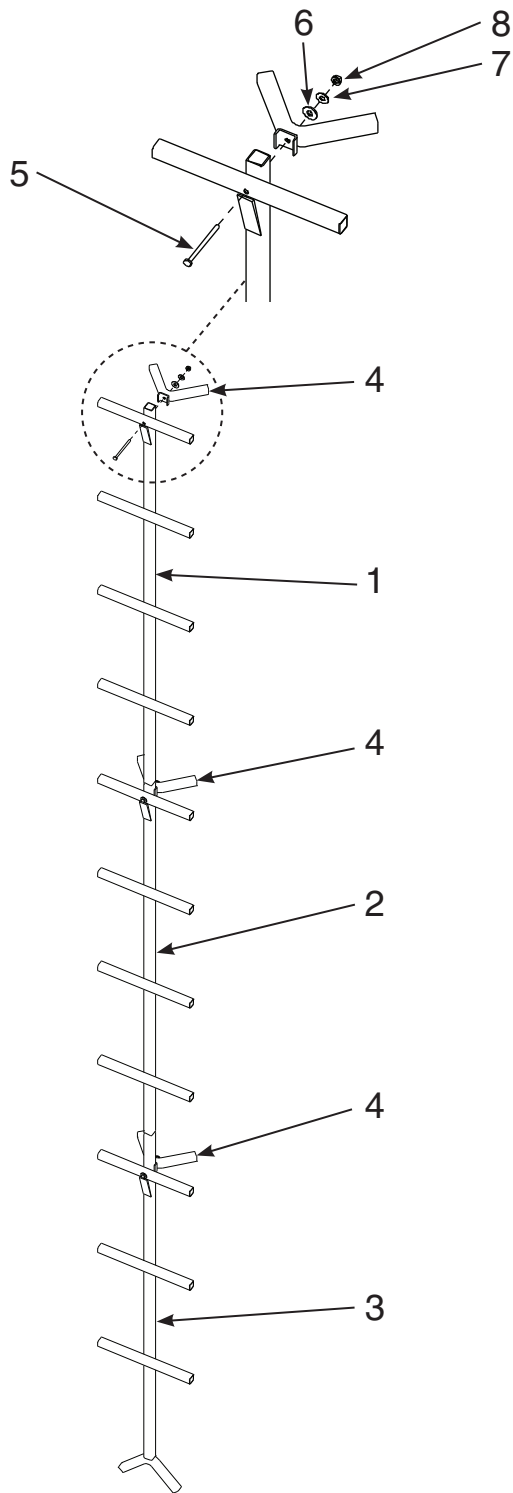

20' Rapid Stick (RE708) 15' Rapid Stick (RE709) 5' Extension (RE710)

5' EXTENSION (RE710) AVAILABLE FOR THIS MODEL,
TESTED FOR 20' MAXIMUM HEIGHT!

15' RAPID STICK PARTS

KEY #	PART #	DESCRIPTION	QTY.
1	SS11	TOP STICK SECTION	1
2	SS10	MIDDLE STICK SECTION	1
3	SS9	BOTTOM STICK SECTION	1
4	SS12	TREE HUGGER	3
5	48273B	BOLT 1/4-20 X 3-1/4" HH BLK ZN	3
6	48261B	WASHER 1/4" FLAT BLK ZN	3
7	WF516B	WASHER 5/16" FLAT BLK ZN	3
8	48752B	NUT 1/4-20 FLANGE TOP LOCK BLK ZN	3
--	48748	STRAP WITH CAM & SNAP HOOK	3
--	48104	ANTI-SLIP TAPE 1/2" X 12"	11

NO EXTENSIONS AVAILABLE FOR THIS MODEL,
TESTED FOR 20' MAXIMUM HEIGHT!

20' RAPID STICK PARTS

KEY #	PART #	DESCRIPTION	QTY.
1	SS11	TOP STICK SECTION	1
2	SS10	MIDDLE STICK SECTION	2
3	SS9	BOTTOM STICK SECTION	1
4	SS12	TREE HUGGER	4
5	48273B	BOLT 1/4-20 X 3-1/4" HH BLK ZN	4
6	48261B	WASHER 1/4" FLAT BLK ZN	4
7	WF516B	WASHER 5/16" FLAT BLK ZN	4
8	48752B	NUT 1/4-20 FLANGE TOP LOCK BLK ZN	4
--	48748	STRAP WITH CAM & SNAP HOOK	4
--	48104	ANTI-SLIP TAPE 1/2" X 12"	15

BOLT IDENTIFICATION CHART

Not all bolt sizes shown are included with all treestands. Bolts shown are for size reference only. Extra hardware may be included in the parts bag.

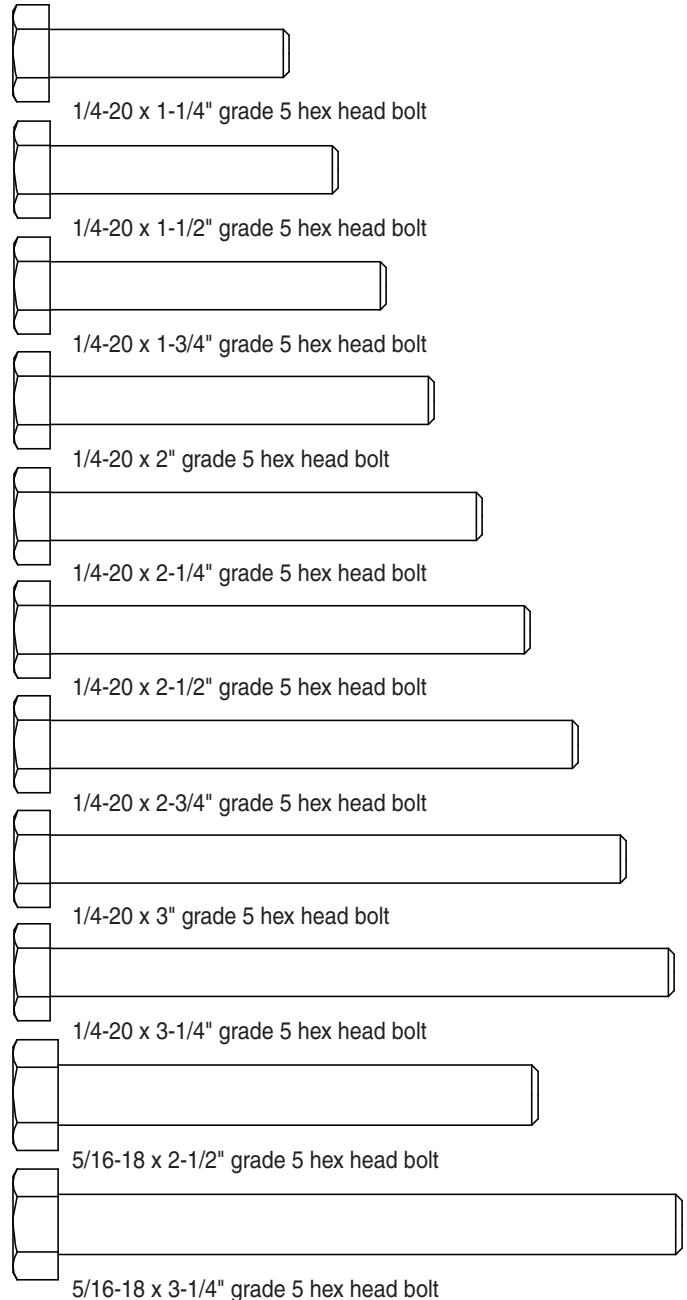

ACCESSORY CHART & REPLACEMENT PARTS

ITEM #	DESCRIPTION	MSRP*
RE750	Universal Treestand Canopy Protect yourself from the elements. Has a strong ratchet for attaching to trees along with a sturdy steel construction. Exclusive Rivers Edge Fall Camouflage. Universal design, will work on all treestands.	\$59.99
48748	Strap w/Cam & Snap Hook	\$6.99
48104	Anti-slip Tape	.60

* Prices shown do not include shipping & handling charges.

All prices are subject to change without notice. When ordering from manufacturer, there is a \$10.00 minimum order.

For replacement parts, phone 1-800-450-EDGE (3343) or
go online to www.HuntRiversEdge.com.



Rivers Edge Treestands, Inc.
1690 Elm Street; P.O. Box 755
Cumberland, Wisconsin 54829
800-450-EDGE (3343) · Fax (715) 822-2124
E-mail: info@huntriversedge.com



HuntRiversEdge.com

* All weights, specifications and features are approximate and are subject to change without notice. Due to continuous product improvements, product images may not be exact.