

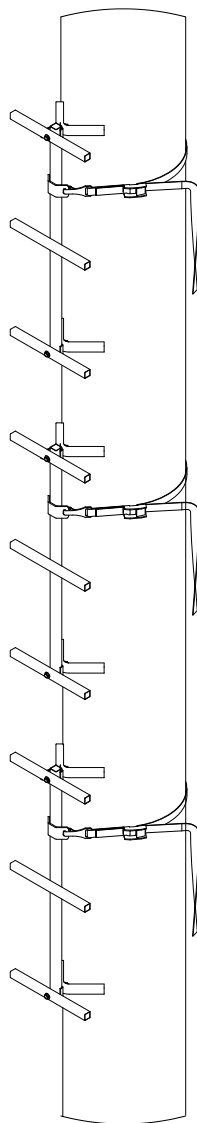

Operator's Manual

Fast Stick™ Climbing Aids



INCLUDES MODEL #'s:

- ☐ RE711, Fast Stick™ (3 pack)
- ☐ RE715, Fast Stick™ (single)

Rivers Edge Treestands are engineered with you the hunter in mind. We appreciate your purchase of one of our climbing sticks. Follow these few simple instructions and your climbing aid will provide you many years of trouble-free pleasure. Instructions should be kept in a safe place and reviewed at least annually.

If for any reason you have a problem with your product, **DO NOT return to the retailer**, contact the Rivers Edge customer service department at 800-450-3343 for assistance.

CONTENTS

Introduction/Warranty	2
Warnings.....	3
Assembly Instructions	4
Set-Up and Use Instructions.....	4
Inspection and Maintenance	5
Parts Explosion/Parts List	6
Bolt Guide	7

WARRANTY

Rivers Edge Treestands, Inc., offers a lifetime warranty to be free from defects in materials and workmanship. This warranty applies to the original owner with a proof of purchase. All items attached to our stands (seat, strap, rope, wood, etc.) that are degradable are warranted for a period of one year. There is no warranty on paint. This warranty applies to products that are not modified, abused or misused in a manner that deviates from the products intended usage. Rivers Edge Treestands offers no other warranty expressed or implied nor is to be held liable for any damage that may result from any defect in a treestand manufactured by them. Warranty work must be sent directly to Rivers Edge Treestands and performed by them. **To obtain warranty service and/or replacement instructions, you must have prior approval from Rivers Edge Treestands before shipping your package to us by calling our customer service department at 800-450-EDGE (3343) or by writing to: Rivers Edge Treestands, Inc., P.O. Box 755, 1690 Elm Street, Cumberland, WI 54829 for a return material authorization number (RMA#).** All items must be shipped prepaid. Rivers Edge Treestands will at no charge, repair or replace, at their discretion, any defective stand which falls under the conditions stated above. Rivers Edge Treestands retains the right to change models, specifications and price without notice.

This equipment has been manufactured under strict quality guidelines. As with any equipment of this type, full understanding of the instructions and its use is mandatory for the safety of its user. Rivers Edge Treestands, Inc., is not responsible for any damages or injuries sustained due to improper use or modification of any of its products, or due to any use which deviates from the products intended usage. The manufacturer also is not responsible for any injuries sustained due to failure to adhere to the instructions for use. Any misunderstanding of its operation should be directed to manufacturer prior to its use.

Owner is responsible to check product field rating and must never exceed maximum weight rating stated. Rivers Edge Treestands, Inc., is not responsible for any malfunction due to normal wear and tear and/or damage caused by improper use, improper maintenance or accidents. This product if used safely as intended, will give you years of trouble free service. We hope you will enjoy the quality of our products for years to come, and have a safe hunt.

For replacement parts, phone 800-450-EDGE (3343) or go online to www.HuntRiversEdge.com.

WARNING

YOU MUST PURCHASE AND ALWAYS USE A FULL BODY HARNESS (FALL ARREST SYSTEM) WITH A CLIMBING BELT THAT MEETS TMA STANDARDS WHILE USING THIS PRODUCT. SINGLE SAFETY BELTS AND CHEST HARNESSES ARE NO LONGER ALLOWED AND SHOULD NEVER BE USED.

IF YOU ARE NOT WEARING A FULL BODY HARNESS WITH A CLIMBING BELT THAT IS PROPERLY ATTACHED TO THE TREE THAT IS PROTECTING YOU FROM A FALL, DO NOT LEAVE THE GROUND.

FAILURE TO USE OR IMPROPER USE OF A FULL BODY HARNESS (FALL ARREST SYSTEM) WITH A CLIMBING BELT THAT MEETS TMA STANDARDS MAY RESULT IN SERIOUS INJURY OR DEATH! READ, UNDERSTAND AND FOLLOW ALL INSTRUCTIONS. IF ANY INSTRUCTIONS ARE NOT UNDERSTOOD OR IF YOU HAVE A PARTS ISSUE CALL 800-450-EDGE (3343) BEFORE USING.

READ, UNDERSTAND AND FOLLOW ALL ASSEMBLY, INSPECTION, MAINTENANCE, & USE INSTRUCTIONS PROVIDED BEFORE EACH USE. FAILURE TO FOLLOW ALL WARNINGS AND INSTRUCTIONS COULD RESULT IN SERIOUS INJURY OR DEATH.

READ AND PERFORM ALL INSPECTION AND MAINTENANCE TASKS BEFORE EACH AND EVERY USE. REPLACE ANY QUESTIONABLE COMPONENTS IMMEDIATELY WITH RIVERS EDGE ORIGINAL REPLACEMENT PARTS. DO NOT LEAVE YOUR STAND OUTDOORS – REMOVE AFTER EACH USE AND STORE INDOORS!

INSTRUCTIONS SHOULD BE KEPT IN A SAFE PLACE AND REVIEWED AT LEAST ANNUALLY.

DOUBLE CHECK ASSEMBLY STEPS TO BE CERTAIN YOU HAVE CORRECTLY ASSEMBLED THIS PRODUCT.

DO NOT CRUSH TUBING WHEN TIGHTENING BOLT ASSEMBLIES! IDENTIFY AND FAMILIARIZE YOURSELF WITH ALL PARTS BEFORE YOU START.

DO NOT EXCEED THE TOTAL FIELD RATING- 275 LBS.

NEVER USE ANY PRODUCT THAT HAS NOT BEEN MAINTAINED OR INSPECTED PROPERLY – YOUR LIFE DEPENDS ON IT!

WHEN HUNTING FROM A TREESTAND, FALLS CAN OCCUR ANY TIME AFTER LEAVING THE GROUND CAUSING INJURY OR DEATH.

NEVER ATTACH TO A DEAD, ODD-SHAPED, LEANING, DISEASED, LOOSE-BARKED TREE OR UTILITY POLES.

REPLACE ANY AND ALL TREESTAND STRAPS EVERY TWO YEARS OR WHEN ANY SIGNS OF DAMAGE OR WEAR EXIST BEFORE.

BE SURE TO RAISE AND LOWER YOUR WEAPON OR GEAR WITH A HAUL LINE. GUN BARREL END OR ARROW TIPS MUST BE POINTED DOWN - AWAY FROM YOU.

WARNING

ALL ASSEMBLY MUST BE DONE IN THIS ORDER AT GROUND LEVEL BEFORE SETUP AND USE.

STUDY YOUR NEW CLIMBING AID TO BECOME FAMILIAR WITH ALL OF ITS FEATURES AND DESIGN. AT GROUND LEVEL, FOLLOWING PROVIDED USE INSTRUCTIONS, PRACTICE ATTACHING CLIMBING AID TO TREE AND REMOVING FROM TREE BEFORE ATTACHING OVERHEAD. SAVE THESE INSTRUCTIONS FOR FUTURE REFERENCE. PROPERLY USE A FULL BODY HARNESS (FALL ARREST SYSTEM) WITH A CLIMBING BELT THAT MEETS TMA STANDARDS AT ALL TIMES INCLUDING ASCENDING TO AND DESCENDING FROM A TREESTAND.

SECTIONAL LADDERS AND STEPS SHOULD BE SPACED ON THE TREE TO INSURE EACH STEP IS NO MORE THAN 18-INCHES APART.

CHECK EVERY STICK LADDER SECTION CONNECTION EVERY TIME YOU USE THE STICK LADDER BEFORE YOU LEAVE THE GROUND. IF STICK LADDER SECTIONS ARE SEPARATING, DO NOT USE THE STICK LADDER.

BE CERTAIN TO ALWAYS LEAN FORWARD, TOWARD THE TREE WHEN ASCENDING OR DESCENDING CLIMBING AID.

ALWAYS HAVE THREE POINTS OF CONTACT WHILE CLIMBING STICK.

NEVER HOLD ONTO ANY SECTION OR PULL ON ANY SECTION THAT IS NOT SECURELY ATTACHED TO THE TREE WITH THE PROVIDED STRAP AND BUCKLE.

ALWAYS ATTACH THE CAM STRAP ASSEMBLY SO THE SPRING LOADED CAM LEVER OF THE STRAP IS FACING AWAY FROM THE TREE. NEVER TOUCH THE CAM LEVER WHILE PUTTING WEIGHT ON THE STICK AND/OR CLIMBING THE STICK AS THIS COULD POTENTIALLY RELEASE THE STRAP AND REMOVE THAT SECTION FROM THE TREE.

A FULL BODY HARNESS WITH LINEMAN'S/CLIMBING BELT MUST BE WORN AT ALL TIMES WHILE INSTALLING OR REMOVING ANY HANG-ON CLIMBING AIDS.

HANG-ON CLIMBING AIDS MUST BE PLACED ON THE TREE AT A HEIGHT ABOVE THE PLATFORM WHERE THE USER CAN MAINTAIN A HANDHOLD OF THE UNIT AND STEP DOWNWARDS ONTO THE TREESTAND. NEVER STEP UP FROM A CLIMBING DEVICE TO GET INTO YOUR STAND.

WHEN USING A CLIMBING/LINEMAN'S BELT TO ASCEND THE TREE, THE FULL BODY HARNESS TETHER SHOULD BE ATTACHED TO THE TREE BEFORE STEPPING DOWN ONTO THE TREESTAND.

NEVER JUMP OR BOUNCE ON A CLIMBING AID TO SEAT IT TO THE TREE.

ASSEMBLY INSTRUCTIONS

Tools needed – two 7/16" wrenches

IMPORTANT ASSEMBLY TIP: DO NOT TIGHTEN NUT & BOLT COMBINATIONS COMPLETELY UNTIL ALL PARTS ARE ASSEMBLED TOGETHER! FINGER TIGHTEN ONLY PLUS ONE TURN OF A WRENCH ONLY! THIS WILL TEMPORARILY HOLD THE LOCKNUT ON THE BOLT WHILE HELPING ALIGNMENT OF ALL PARTS! AFTER ALL PARTS ARE ASSEMBLED TOGETHER, ALL NUT & BOLT COMBINATIONS MUST BE COMPLETELY TIGHTENED!

1. Attach (2) tree huggers (SS12) to each Fast Stick weldment (48161) using (2) provided 1/4-20 x 3" bolts, (2) locknuts and (2) 1/4" washers. **SEE FIGURE 1. TIGHTEN ALL NUT AND BOLT ASSEMBLIES COMPLETELY! REPEAT FOR EACH ADDITIONAL FAST STICK SECTION.**

NOTE: Head of bolts should be on the front side of step and locknuts should be on back side of tree hugger.

2. Attach the provided anti-slip tape (48104) to the top side of each step. The step must be clean and at room temperature to assure proper adhesion.
3. a. Using (1) of the provided cam strap assemblies (48302), insert the loop end of the short strap through slot of strap attachment bracket located on to the vertical post of Fast Stick weldment. You may choose either slot, depending on left or right hand preference. **SEE FIGURE 2A.**
b. Take the entire cam strap assembly and feed it through the loop and pull tight forming a cinch knot. This permanently attaches the strap to the Fast Stick section. **SEE FIGURES 2B and 2C.**
c. Repeat steps 3a and 3b to attach remaining strap assemblies to remaining Fast Stick sections.

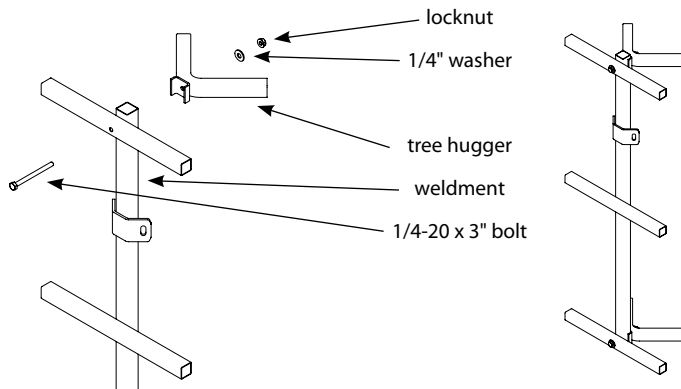

Figure 1



Figure 2a

SET-UP AND USE INSTRUCTIONS

1. Standing on ground, with (1) Fast Stick section against tree, take the snap hook end of strap and wrap it around the tree. Connect hook to opposite slot of attachment bracket by snapping into slot. Pull the tail of cam strap tight so that the section is snugly secured to the tree. **SEE FIGURE 3.** Be certain all (4) contact points of tree huggers, (2) on each hugger, are contacting tree.

NOTE: Be sure you wrap the strap correctly so there are no twists in the strap and cam lever of buckle is facing away from the tree.

2. Take the section and pull down on it so it feels stable and is settled into using position before stepping on it. Check again to be certain all (4) contact points of tree huggers are contacting tree. Redo as necessary to accomplish this.
3. While properly wearing/using a Full Body Harness with a lineman's/climbing belt, climb the Fast Stick section only far enough to attach the second section to the tree. Repeat steps 1 & 2 for proper attachment of all remaining Fast Stick sections.
4. Reverse setup and use instructions to remove Fast Stick sections from the tree.

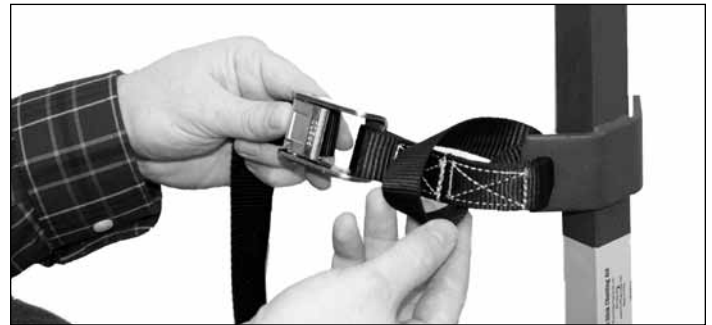

Figure 2b



Figure 2c

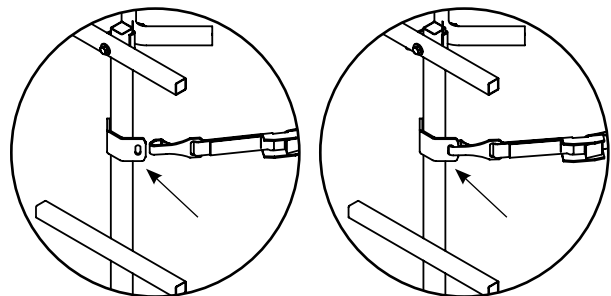

Figure 3

ALWAYS...

- Be physically fit, mentally alert, and well rested before using this product.
- Read, understand and follow all warnings and instructions before use, save for future reference.
- Use a Full Body Harness (Fall Arrest System) with a climbing belt that meets TMA standards at all times including ascending to and descending from a treestand.
- Be fully aware of foot placement.
- Recommended for adult use only.
- Inspect for missing parts, all hardware condition, and damage before every application, replace if necessary.
- Remove after every use, store product indoors.
- Use only Rivers Edge original replacement parts.
- Lean forward, toward tree, when ascending or descending climbing aid.
- Lubricate all slide together points with powder graphite to prevent binding, wear, rust & noise.
- Avoid all electrical power lines.
- Inform someone of the hunting location, where the treestand will be located and the expected duration of the hunt.
- Carry a signal device such as a mobile phone, radio, whistle, signal flare or personal locator device (PLD) and it must be readily available at all times.
- Inspect the climbing aid/treestand and all safety devices each time before use and do not store outdoors when not in use.

NEVER...

- Sleep in a treestand.
- Exceed the total field rating of 275 lb.
- Attach to a dead, odd-shaped, leaning, diseased, loose-barked tree or utility pole.
- Use on trees with a diameter smaller than 8 inches or larger than 20 inches.
- Use a climbing aid/treestand during inclement weather such as rain, lightning, windstorms or icy conditions and end your hunt and return to the ground if inclement conditions arise.
- Carry gun or bow when ascending or descending.
- Alter the original design of your climbing aid.
- Jump on or use in a careless manner.
- Lean out over edge of device.
- Use when intoxicated or using over-the-counter medication or prescription drugs.
- Use a climbing aid/treestand when feeling ill, nauseous or dizzy, or if you have a prior medical condition that could cause a problem (i.e. heart condition, joints that lock up, spinal fusions, etc.) or if you are not well rested.
- Rely on a tree branch for support.
- Use a damaged product, replace with new.
- Loan your climbing aid to someone else.

INSPECTION AND MAINTENANCE SCHEDULE**FOR ALL RIVERS EDGE PRODUCTS**

- Inspect all webbing, rope, cord, and strap assemblies for wear or damage.
- Inspect cables and cable ends for damage or kinking.
- Inspect all hardware and chain components for damage.
- Inspect for any structural damage to product. (Return to factory for repair or discard product if any damage is found.)
- Inspect all nut and bolt assemblies to be certain none are loose.
- Inspect for any missing parts.
- Lubricate all pivot and slide together points with powder graphite to prevent noise, wear, and rust.
- Inspect entire product for any rust, corrosion, cracks, freezing, excessive heat, or rotting damage that may effect the safety of your product. Discard any questionable product.
- Inspect entire product for any structural damage - pay close attention to all weld locations. (Return to factory for repair or discard product if any damage is found.)
- Using correct wrenches inspect all nut & bolt assembly locations and snug up any that may be loose. Be careful not to crush tubing when tightening!
- Inspect and check operation of all cables, cable ends, cord, rope, webbing, and strap or chain assemblies. Replace with factory new any item or assembly that shows signs of wear, damage, kinking, or functions incorrectly.
- Inspect seat. Replace any seat with factory new that shows signs of structural damage or wear.
- Inspect all hardware for wear or damage, also be sure you have no missing parts.
- Never modify your stand in any way by making repairs, replacing parts, or altering adding or attaching anything to it except if explicitly authorized in writing by the manufacturer.

FAST STICK PARTS

Maximum Field Rating - 275 lbs.

Tree Diameter Range - 8" to 20"

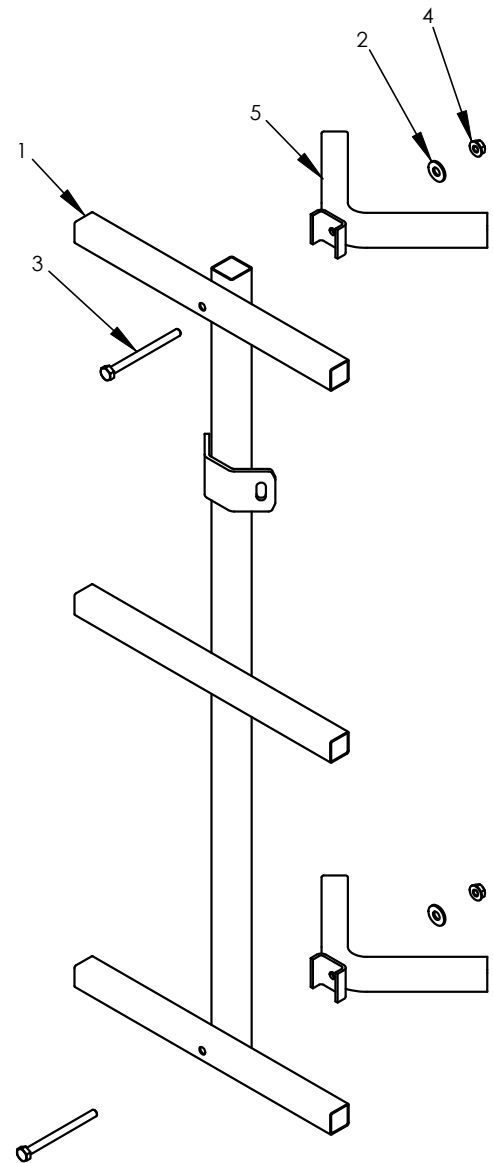
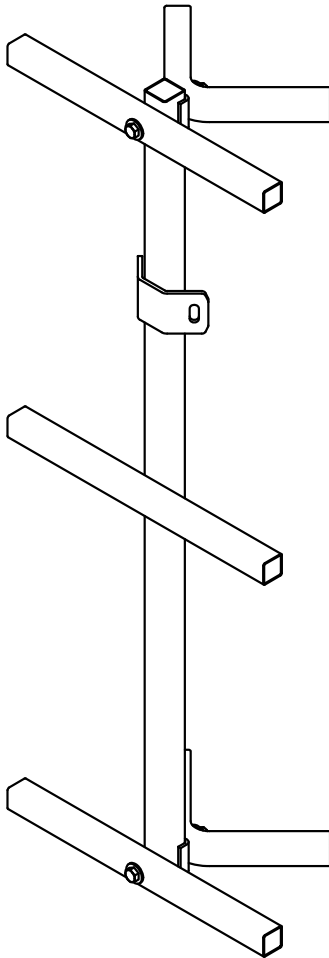

FAST STICK PARTS-RE711

KEY #	PART #	DESCRIPTION	QTY.
1	48161	WELDMENT, STEEL FAST STICK	3
2	48261B	WASHER 1/4 BLK ZNC	6
3	48280B	BOLT 1/4-20 X 3" HHCS BLK ZNC	6
4	48752B	NUT, FLANGED, NYLOCK, 1/4-20	6
5	SS12	WELDMENT, TREE HUGGER, BOLT-ON RAPID STICK	6
--	48302	CAM STRAP ASSEMBLY, FAST STICK	3
--	48104	ANTI-SLIP TAPE	9

FAST STICK PARTS-RE715

KEY #	PART #	DESCRIPTION	QTY.
1	48161	WELDMENT, STEEL FAST STICK	1
2	48261B	WASHER 1/4 BLK ZNC	2
3	48280B	BOLT 1/4-20 X 3" HHCS BLK ZNC	2
4	48752B	NUT, FLANGED, NYLOCK, 1/4-20	2
5	SS12	WELDMENT, TREE HUGGER, BOLT-ON RAPID STICK	2
--	48302	CAM STRAP ASSEMBLY, FAST STICK	1
--	48104	ANTI-SLIP TAPE	3

BOLT IDENTIFICATION CHART

Not all bolt sizes shown are included with all treestands. Bolts shown are for size reference only. Extra hardware may be included in the parts bag.

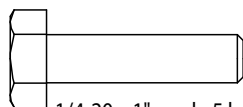

1/4-20 x 1" grade 5 hex head bolt

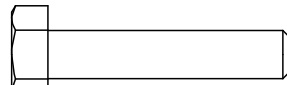

1/4-20 x 1-1/4" grade 5 hex head bolt

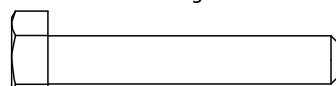

1/4-20 x 1-1/2" grade 5 hex head bolt

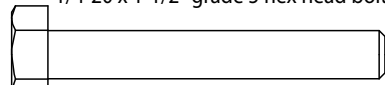

1/4-20 x 1-3/4" grade 5 hex head bolt



1/4-20 x 2" grade 5 hex head bolt

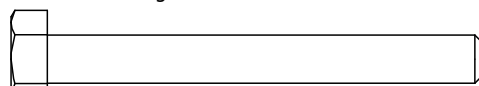

1/4-20 x 2-1/4" grade 5 hex head bolt

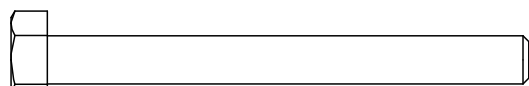

1/4-20 x 2-1/2" grade 5 hex head bolt

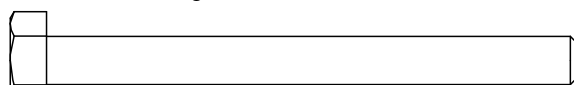

1/4-20 x 2-3/4" grade 5 hex head bolt

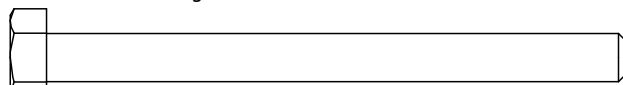

1/4-20 x 3" grade 5 hex head bolt



1/4-20 x 3-1/4" grade 5 hex head bolt

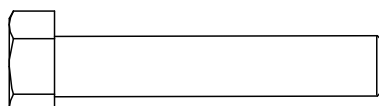

5/16-18 x 1-3/4" grade 5 hex head bolt

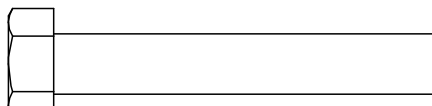

5/16-18 x 2" grade 5 hex head bolt

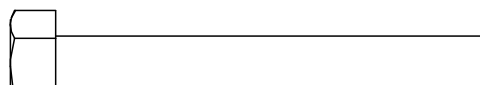

5/16-18 x 2-1/4" grade 5 hex head bolt

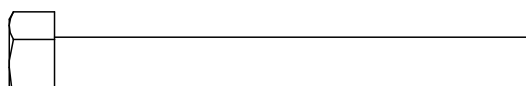

5/16-18 x 2-1/2" grade 5 hex head bolt

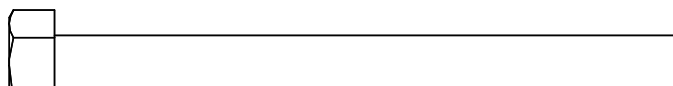

5/16-18 x 3-1/4" grade 5 hex head bolt



Rivers Edge Treestands, Inc.
1690 Elm Street, PO Box 755
Cumberland, WI 54829
800-450-EDGE (3343) | Fax 715-822-2124
Email: info@huntriversedge.com

*All weights, specifications and features are approximate and are subject to change without notice. Due to continuous product improvements, product images may not be exact. Warning labels in some product images may have been removed for photography purposes only. Props shown in photos not included. Some assembly may be required.