



2" ATV Trailer Ball Hitch Kit (TX112)

You have just purchased the YUTRAX 2" Trailer Ball Hitch Kit TX112. Just follow these simple directions for use and your ball hitch will give you many years of trouble-free pleasure. Save these instructions for future reference.

If for any reason you have a problem with your product, DO NOT return to the retailer, contact the YUTRAX customer service department at 800-345-6007 M-F from 8 a.m. to 5 p.m. for assistance.

ASSEMBLY INSTRUCTIONS:

Tools needed - (2) 13mm wrenches, (2) 16mm wrenches

1. Slide the spacer plates (16845) in between the tongue and coupler on each side. When properly installed, the spacer plates should be flush with the coupler and bottom side of the tongue. Attach the coupler (TK133) to the tongue tube (16841) using the (2) M10 x 80 bolts provided, M10 washers on each side, and (2) M10 nyloc nuts. **SEE FIGURE 1**
2. Tighten bolts to squeeze the coupler together to keep it from moving. **SEE FIGURE 2**
3. Remove the M8 x 60 bolt from the coupling tube on the trailer and pull the original tongue out of the trailer. Slide the new ball hitch tongue into the coupler, install the M8 x 60 bolt and tighten. **SEE FIGURE 3**

WARNING

READ AND UNDERSTAND ALL ASSEMBLY, INSPECTION, & USE INSTRUCTIONS PROVIDED BEFORE EACH USE. IF ANY INSTRUCTIONS ARE NOT UNDERSTOOD OR IF YOU HAVE A PARTS ISSUE CALL 800-345-6007 BEFORE USING. FAILURE TO FOLLOW INSTRUCTIONS COULD RESULT IN SERIOUS INJURY OR DEATH.

DOUBLE CHECK ASSEMBLY STEPS TO BE CERTAIN YOU HAVE CORRECTLY ASSEMBLED THIS PRODUCT.

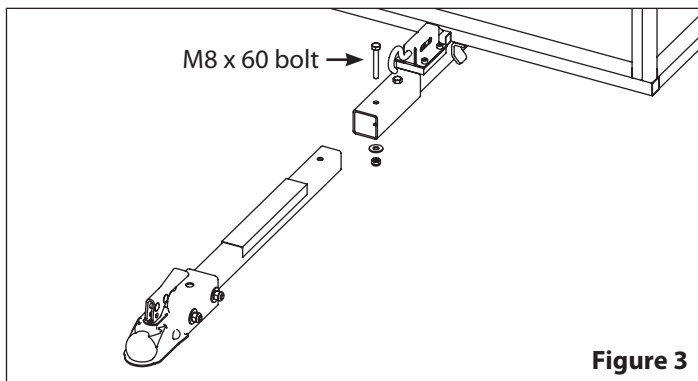
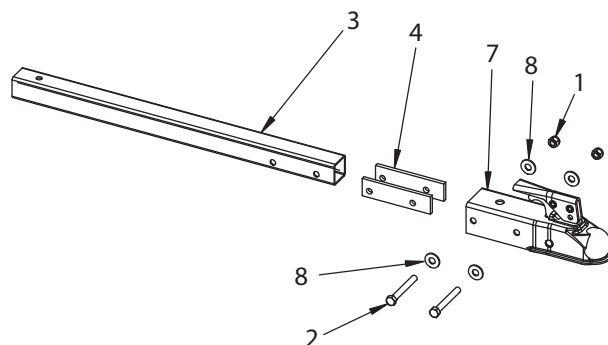
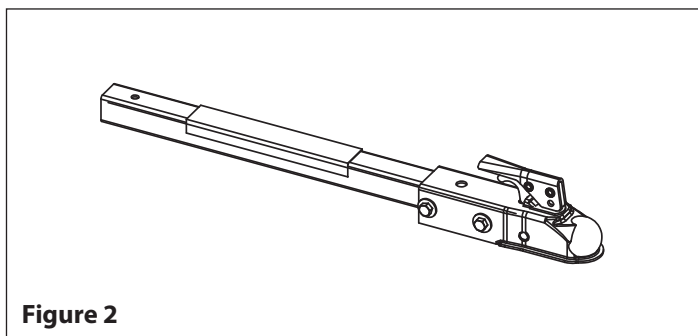
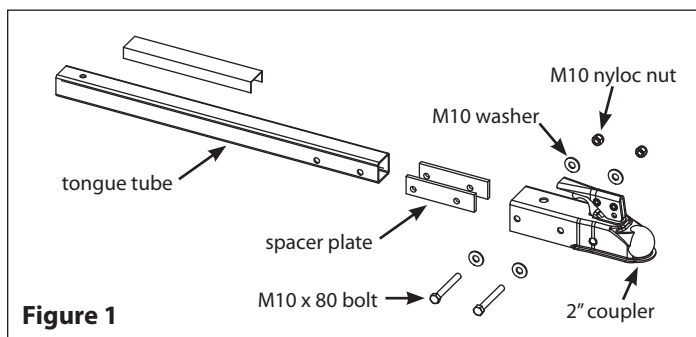

KEY #	PART #	DESCRIPTION	QTY.
1	W1265V0903	NUT M10 HNYLK GR8.8 ZN	2
2	24144	BOLT M10 X 1.5 X 80 HH GR8.8 ZN	2
3	16841	TONGUE TUBE BALL HITCH	1
4	16845	SPACER HITCH PLATE	2
5	16861M	INSERTION BAG TX112 METRIC	1
6	OMTX112	OWNERS MANUAL TX112 HITCH KIT	1
7	TK133	HITCH, 2 INCH BALL ADAPTER WITH ADDED HOLE	1
8	19905	WASHER 10MM X 20MM X 2MM GR 8.8 ZN	4

