

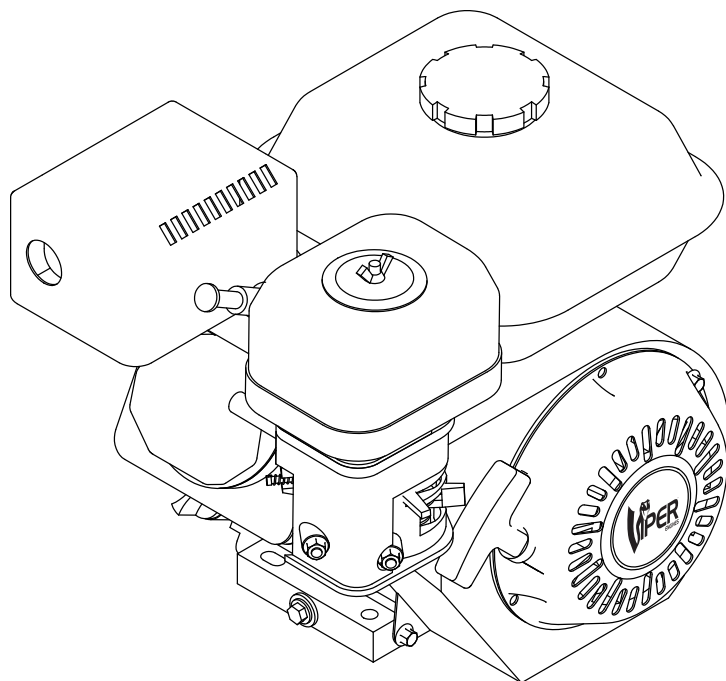

# ***OPERATING & MAINTENANCE INSTRUCTIONS***

## ***6.5 hp 4-STROKE ENGINE***



OM6036507  
Rev. 11/29/06  
© 2007 Ardisam, Inc.  
All Rights Reserved. Printed in USA.



## INTRODUCTION

### **Thank You . . .**

*for purchasing a Viper engine from Ardisam, Inc. We have worked to ensure that our product meets high standards for usability and durability. With proper care, your engine will provide many years of excellent service. Please take the time to read this manual carefully to learn how to correctly operate and maintain your Viper engine. Due to continuous efforts to perfect our products, certain procedures and specifications are subjected to change without notice. Congratulations on your investment in quality.*

## CONTENTS

Introduction .....	2
General Safety Precautions .....	3-4
Engine Components.....	5
Pre-Operation Procedures .....	6-7
Engine Operation .....	8-9
Maintenance.....	10
Engine Maintenance .....	11-13
Battery (Electric Models Only) .....	13-14
Transporting and Storage.....	14
Service and Troubleshooting.....	15-16
Parts Explosion/Parts List .....	17-18
Registration/Warranty.....	19

## FEDERAL EMISSION INFORMATION

Ardisam, Inc. warrants to the retail purchaser, that this small, off-road engine was designed, built and equipped to conform at the time of initial sale to all applicable regulations of the U.S. Environmental Protection Agency (EPA).



## GENERAL SAFETY PRECAUTIONS

Please read this section carefully. Operate the engine according to the safety instructions and recommendations outlined here and inserted throughout the text. Anyone who uses this engine must read the instructions and be familiar with the controls.

### Owner's Responsibility:

It is the owner's responsibility to accurately assemble the engine for safe and effective use.

- Read and follow all safety instructions.
- Carefully follow all assembly instructions.
- Maintain the engine according to directions and schedule included in this operator's manual.
- Ensure that anyone who uses this engine is familiar with all controls and safety precautions.

### SIGNAL WORDS



A signal word alerts you to potential hazards that could harm you or others. Each signal word is preceded by the safety alert symbol followed by the word **DANGER**, **WARNING**, **CAUTION** or **IMPORTANT**.

Each signal word will make you aware of what the hazard is, what can happen, and what you can do to prevent or decrease injury occurrence.

### **DANGER**

**DANGER INDICATES YOU WILL BE KILLED OR SERIOUSLY INJURED IF THE SAFETY INSTRUCTIONS THAT FOLLOW THIS SIGNAL WORD ARE NOT OBEYED.**

### **WARNING**

**WARNING INDICATES YOU CAN BE KILLED OR SERIOUSLY INJURED IF THE SAFETY INSTRUCTIONS THAT FOLLOW THIS SIGNAL WORD ARE NOT OBEYED.**

### **CAUTION**

**CAUTION INDICATES YOU CAN OR YOUR EQUIPMENT CAN BE HURT IF THE SAFETY INSTRUCTIONS THAT FOLLOW THIS SIGNAL WORD ARE NOT OBEYED.**

### **IMPORTANT**

**INDICATES HELPFUL INFORMATION FOR PROPER ASSEMBLY, OPERATION, OR MAINTENANCE OF YOUR ENGINE.**

**PRECAUTIONS****WARNING:  
FUEL FILLING PRECAUTIONS**

- FUEL AND FUEL VAPORS ARE HIGHLY FLAMMABLE.
- NEVER FILL GAS TANK INDOORS OR IN A POORLY VENTILATED AREA.
- TURN ENGINE OFF AND LET COOL BEFORE REMOVING GAS CAP.
- DO NOT OVERFILL GAS TANK. IF FUEL SPILLAGE OCCURS, WIPE AWAY CAREFULLY AND ALLOW FUEL TO DRY BEFORE STARTING ENGINE.
- PREVENT FIRE AND EXPLOSION CAUSED BY STATIC ELECTRIC DISCHARGE. USE ONLY NON-METAL, PORTABLE FUEL CONTAINERS APPROVED BY THE UNDERWRITER'S LABORATORY(U.L.) OR THE AMERICAN SOCIETY FOR TESTING & MATERIALS (ASTM).
- NEVER POUR FUEL OUT OF ENGINE GAS TANK.
- NEVER ALLOW CHILDREN TO FILL THE GAS TANK. ADULTS ONLY.
- NEVER ALLOW YOURSELF, OR ANYONE UNDER THE INFLUENCE OF DRUGS OR ALCOHOL, TO FILL GAS TANK.
- GAS CAP MUST BE PROPERLY SECURED BEFORE AND DURING OPERATION.
- REFRAIN FROM SMOKING AND STAY AWAY FROM OPEN FLAMES AND SPARKS WHEN REFUELING.

**WARNING:  
FIRE & BURN PROTECTION**

- KEEP ALL SPARKS, SMOKING MATERIALS, AND OPEN FLAMES AWAY FROM ENGINE.
- DO NOT USE ENGINE AROUND DRY BRUSH, CLOTH RAGS, OR OTHER FLAMMABLE MATERIALS.
- BE CAREFUL OF HOT PARTS. THE MUFFLER GUARD AND OTHER PARTS BECOME EXTREMELY HOT DURING AND IMMEDIATELY AFTER USE. HOT PARTS CAN CAUSE SEVERE BURNS.
- ALWAYS KEEP MATERIALS AND DEBRIS CLEAR OF MUFFLER GUARD AND OTHER HOT ENGINE PARTS.
- NEVER OPERATE THE ENGINE WITHOUT THE MUFFLER GUARD IN PLACE.

**WARNING:  
OTHER SAFETY PRECAUTIONS**

- STAY AWAY FROM ROTATING PARTS. PLACE PROTECTIVE COVERS OVER ROTATING PARTS.
- DO NOT CARRY OR REMOVE ENGINE WHILE IN OPERATION.
- OPERATE THE ENGINE ONLY ON LEVEL AND STABLE SURFACES.

**WARNING:  
EXHAUST PRECAUTIONS**

- DO NOT INHALE EXHAUST FUMES. THEY GIVE OFF CARBON MONOXIDE, AN ODORLESS, COLORLESS, DEADLY GAS.
- USE EXTREME CARE WHEN RUNNING ENGINE NEAR PEOPLE OR ANIMALS. ALWAYS POINT EXHAUST AND MUFFLER IN A SAFE DIRECTION.
- NEVER RUN ENGINE IN AN ENCLOSED OR PARTIALLY ENCLOSED AREA. EXAMPLES INCLUDE: BUILDINGS THAT ARE ENCLOSED ON ONE OR MORE SIDES, CAR PORTS OR BASEMENTS.
- ALWAYS MAKE SURE EXHAUST PIPE IS FREE OF FOREIGN OBJECTS.

**WARNING:  
ENGINE REPAIR PRECAUTIONS**

- BEFORE WORKING ON ENGINE, ENGINE SHOULD BE OFF AND COOL.
- ALWAYS DISCONNECT THE SPARK PLUG WIRE FROM THE SPARK PLUG.
- SECURE DISCONNECTED SPARK PLUG WIRE AWAY FROM SPARK PLUG AND ANY METAL OBJECTS TO AVOID ARCING (HAZARDOUS UNINTENTIONAL CONNECTION).
- CHECK ALL PARTS THAT WERE REPAIRED OR REMOVED TO ENSURE SECURE AND PROPER FIT.
- USE ONLY ORIGINAL VIPER EQUIPMENT AND PARTS.

## ENGINE COMPONENTS

### MODEL 60365 6.5 HP HORIZONTAL SHAFT

This is a 4-stroke air cooled engine. The 6.5 hp engine utilizes a horizontal shaft and an oil slinger with dipstick.

#### **⚠ WARNING**

**DO NOT REFUEL WHILE SMOKING, NEAR OPEN FLAME, OR OTHER POTENTIAL HAZARDS.**

**FUEL IS HIGHLY FLAMMABLE AND MUST BE HANDLED WITH CARE. NEVER FILL THE TANK WHEN THE ENGINE IS HOT OR RUNNING. ALWAYS MOVE OUTDOORS TO FILL THE TANK.**

#### **IMPORTANT**

**ENGINE IS SHIPPED FROM FACTORY WITHOUT OIL. YOU MUST ADD ENGINE OIL BEFORE STARTING ENGINE. IF ENGINE IS STARTED WITHOUT OIL, ENGINE MAY BE DAMAGED BEYOND REPAIR AND WILL NOT BE COVERED BY WARRANTY.**

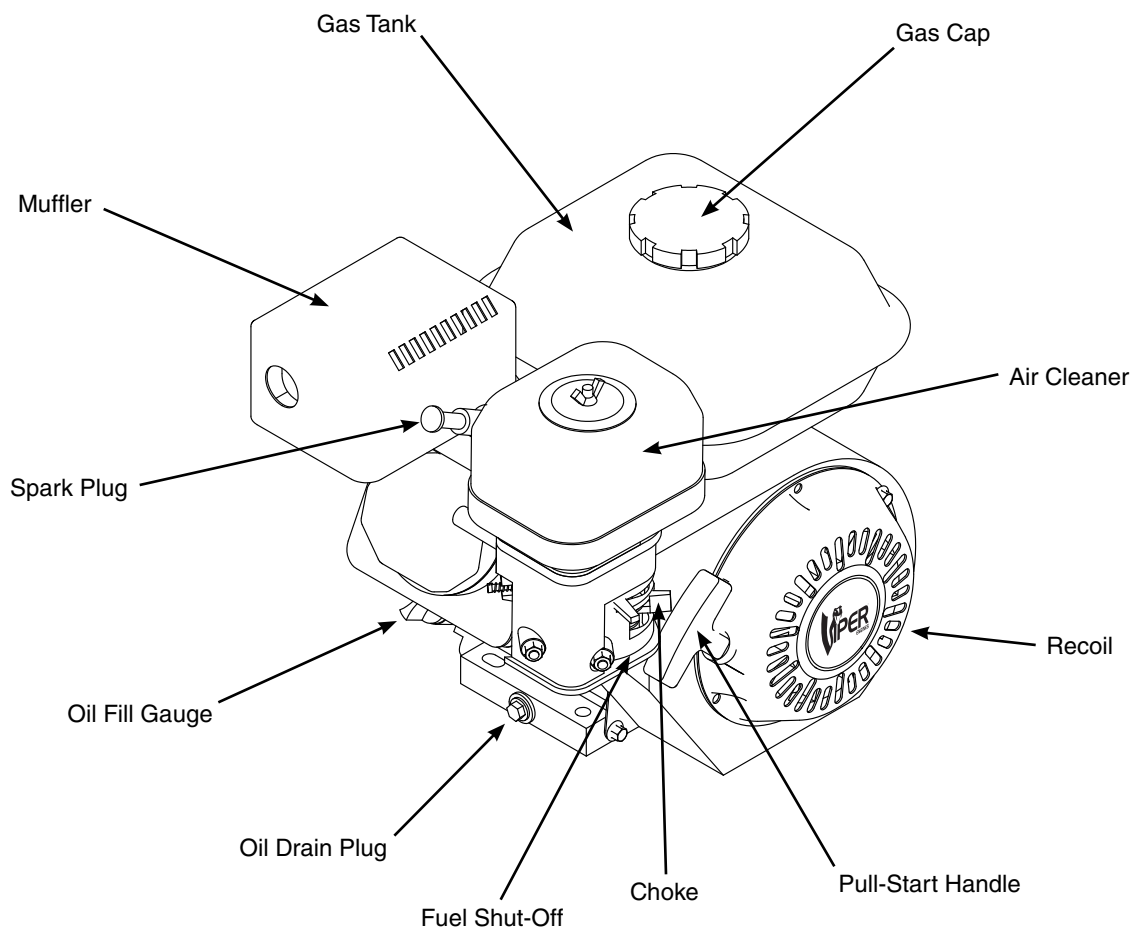

## PRE-OPERATION PROCEDURES

### PRE-OPERATION INSPECTION

1. Examine underneath and around engine for signs of oil or fuel leaks.
2. Inspect fuel hoses and joints for tightness and fuel seepage.
3. Look for signs of engine damage.
4. Check that all guards and shields are in place, and all screws, nuts and bolts are tightened.
5. Eliminate excessive debris around muffler and recoil starter.
6. Inspect the air filter component for air restrictions that may reduce engine performance.

### CAUTION

FOR THE SAFETY OF THE USER, AND TO MAXIMIZE THE LIFE OF THE ENGINE, IT IS CRUCIAL TO TAKE TIME TO CHECK THE CONDITION OF THE ENGINE. PROBLEMS MUST BE CORRECTED BEFORE OPERATING.

AVOID INJURY! ENGINE OIL IS HAZARDOUS TO YOUR HEALTH. DISPOSE OF OIL APPROPRIATELY. USE A SAFE DISPOSAL/RECYCLING CENTER.

### WARNING

DO NOT ATTEMPT TO START ENGINE IN THE FOLLOWING WAYS:

- DO NOT USE STARTING FLUID.
- DO NOT SPRAY FLAMMABLE LIQUIDS OR VAPORS INTO AIR CLEANER, CARBURETOR OR SPARK PLUG CHAMBER.
- DO NOT REMOVE SPARK PLUG AND PULL ON STARTER ROPE. FLAMMABLE FUEL CAN SPRAY OUT AND IGNITE FROM A SPARK FROM SPARK PLUG.

DO NOT REFUEL WHILE SMOKING, NEAR OPEN FLAME, OR OTHER POTENTIAL HAZARDS.

FUEL IS HIGHLY FLAMMABLE AND MUST BE HANDLED WITH CARE. NEVER FILL THE TANK WHEN THE ENGINE IS HOT OR RUNNING. ALWAYS MOVE OUTDOORS TO FILL TANK.

### IMPORTANT

ENGINE IS SHIPPED FROM FACTORY WITHOUT OIL. YOU MUST ADD ENGINE OIL BEFORE STARTING ENGINE.

### CHECKING & ADDING OIL

Be sure the engine is located on a level surface before checking or refilling oil.

1. Clean around oil fill area. **SEE FIGURE 1.**
2. Slide out dipstick and wipe clean with cloth. **SEE FIGURE 2.**
3. Reinsert and tighten dipstick.
4. Slide out dipstick and check oil.
5. If oil level is below the top thread of the oil fill hole, refill to upper level. **SEE FIGURE 3(a) & 3(b).**
6. Change oil if contaminated. (See Chapter 5 Under "LUBRICATION".)

Viper engine oil may be put in through the oil dipstick hole or through the oil fill plug opening. If an oil plug is present, loosen screw and fill oil until oil level is even with top thread in plug hole.

### CHECKING & FILLING GAS TANK

Be sure the engine is located on a level surface before checking or refilling oil. Use unleaded regular, unleaded premium, or reformulated automotive fuels only. Fuel may contain up to 10% ethanol, 10% gasohol, 15% MTBE, and 15% ETBE. **DO NOT use Methanol or leaded fuels. DO NOT mix oil with fuel.**

1. Make sure engine is cool and not operating while filling.
2. Remove gas cap with inlet facing upward; fill to upper level.

**Note: Do not overfill. Fill to roughly 1 ½ inches below the neck to allow for fuel expansion.**

3. Replace cap and remove any spilled fuel before operating.

### ⚠ WARNING

**FUEL IS HIGHLY FLAMMABLE AND MUST BE HANDLED WITH CARE. NEVER FILL THE TANK WHEN THE ENGINE IS HOT OR RUNNING. ALWAYS MOVE OUTDOORS TO FILL THE TANK.**

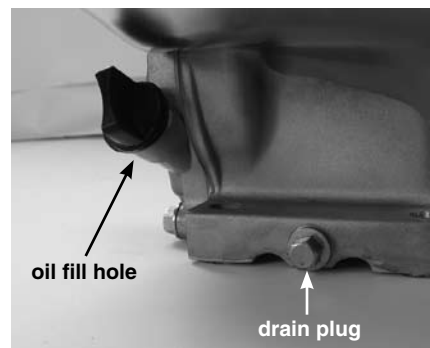

FIGURE 1

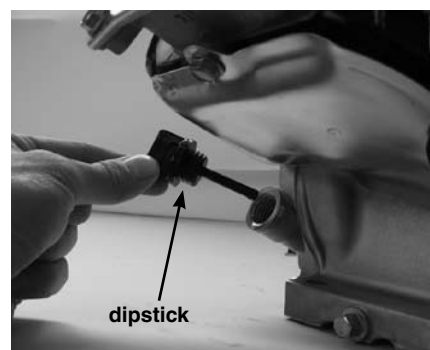

FIGURE 2

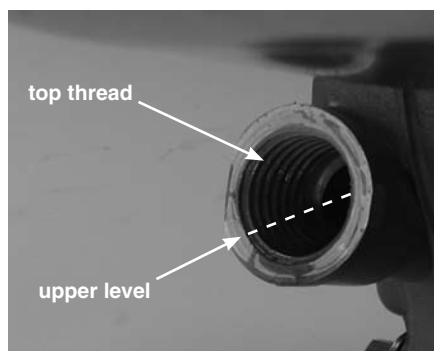

FIGURE 3(a)



FIGURE 3(b)

## ENGINE OPERATION

**REVIEW SECTION “PRE-OPERATION INSPECTION” BEFORE STARTING ENGINE.**

### STARTING & STOPPING ENGINE

#### MANUAL START ENGINE

1. Move engine to a well ventilated area, always outdoors, to prevent carbon monoxide poisoning.
2. Move to an area away from flames or sparks, to avoid ignition of vapors if present.
3. Remove all debris from air cleaner holes and gas cap to ensure proper air flow.
4. **Choke:**
  - “**Full choke**” position is established by moving the choke lever as far left to the **CHOKE** position as possible. **SEE FIGURE 5.**
  - “**Half choke**” position is established when the choke lever is maneuvered half-way between **CHOKE** and **RUN** positions. **SEE FIGURE 6.**

**First Start & Cold Start:** Move choke lever to “full choke.” **SEE FIGURE 5.**

**Warm Start:** “No choke” or “half choke” is needed. **SEE FIGURE 7.**

### ⚠ WARNING

**CARBON MONOXIDE GAS IS TOXIC. INHALATION CAN CAUSE UNCONSCIOUSNESS AND DEATH.**

**NEVER LEAVE ENGINE RUNNING WHILE UNATTENDED.**

**DO NOT ATTEMPT TO START ENGINE IN THE FOLLOWING WAYS:**

- **DO NOT USE STARTING FLUID.**
- **DO NOT SPRAY FLAMMABLE LIQUIDS OR VAPORS INTO AIR CLEANER, CARBURETOR OR SPARK PLUG CHAMBER.**
- **DO NOT REMOVE SPARK PLUG AND PULL ON STARTER ROPE. FLAMMABLE FUEL CAN SPRAY OUT AND IGNITE FROM A SPARK FROM SPARK PLUG.**

### ⚠ CAUTION

**DO NOT STOP ENGINE BY MOVING CHOKE CONTROL TO CHOKE. BACKFIRE, ENGINE DAMAGE, OR FIRE MAY OCCUR.**



**FIGURE 5**

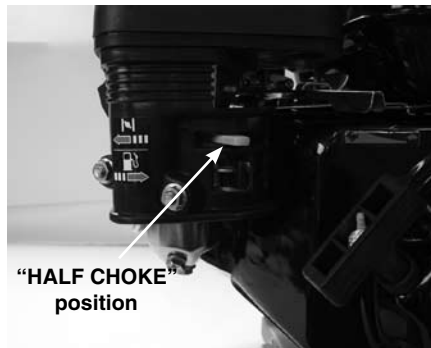

**FIGURE 6**

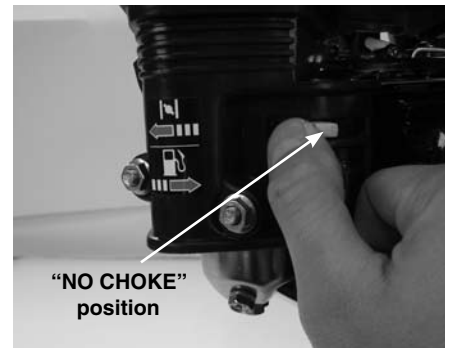

**FIGURE 7**



## OPERATING AND MAINTENANCE INSTRUCTIONS

### 6.5 hp 4-Stroke Engine



5. Grasp starter handle and pull out slowly, until resistance is felt. Without letting it retract, pull rope with a rapid full arm stroke. Let it return to its original position very slowly. Repeat this step each time the starter rope is pulled. **SEE FIGURE 8.**
6. Pull recoil until engine fires or runs.
7. After engine begins operating, move choke lever to **"half choke."** **SEE FIGURE 6.**
8. Run engine for 30 to 45 seconds at **"half choke"** position until engine warms up.
9. Move choke lever to **"no choke"** position and move throttle to desired speed. **SEE FIGURE 7.**

#### **ELECTRIC START ENGINE**

1. Repeat steps 1-4 under **"MANUAL START ENGINE"** heading on previous page.
2. Insert key and turn to start. **SEE FIGURE 9.**
3. After engine starts running, move choke lever to **"half choke."** **SEE FIGURE 6.**
4. Run engine for 30 to 45 seconds at **"half choke"** position until engine warms up.
5. Move choke lever to **"no choke"** position and move throttle to desired speed. **SEE FIGURE 7.**
6. To stop, turn key to **OFF** position. **SEE FIGURE 10.**

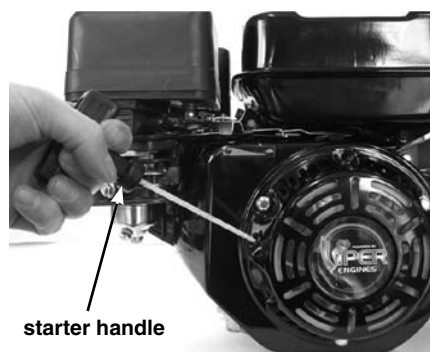

**FIGURE 8**

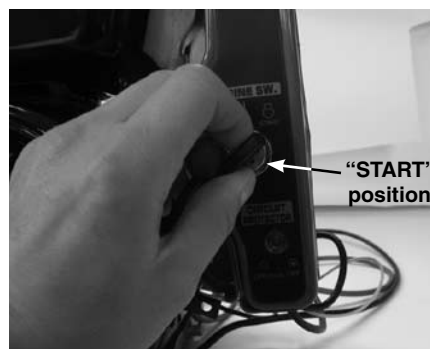

**FIGURE 9**

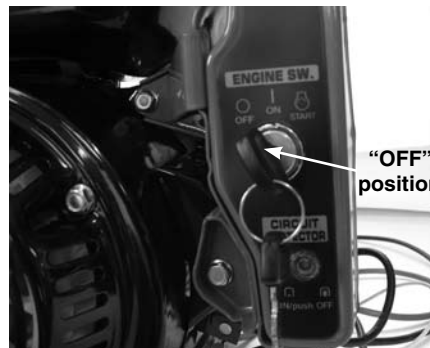

**FIGURE 10**

## MAINTENANCE

Please read the maintenance schedule, and observe these recommended care operating intervals to extend the life of your engine.

### **⚠ CAUTION**

**TO PREVENT ACCIDENTAL STARTING:**

**AVOID INJURY! ENGINE MUST BE TURNED OFF AND COOL AND SPARK PLUG WIRE MUST BE REMOVED FROM SPARK PLUG BEFORE CHECKING AND ADJUSTING ENGINE OR EQUIPMENT.**

**AVOID INJURY! TEMPERATURE OF MUFFLER AND NEARBY AREAS MAY EXCEED 150° F (65° C). AVOID THESE AREAS.**

**AVOID INJURY! CHECK ENGINE OFTEN FOR LOOSE NUTS AND BOLTS. KEEP THESE ITEMS TIGHTENED.**

## MAINTENANCE SCHEDULE

MAINTENANCE ITEM		Every 8 hours (daily)	Every 50 hours or seasonally	Every 100 hours or seasonally	Yearly
Clean Engine and Check Bolts & Nuts		X			
Engine Oil (See Lubrication section)	Check	X			
	Change *	(initial 5 hours)	X		
Oil in Gear Reduction (if equipped)	Change		X		
Air Filter (See Air Filter section)	Check	X		X	
	Clean **		(20 hours)		
	Replace				X
Spark Plug (Gap .030") (See Spark Plug section)	Check-Adjust		X		
	Replace				X
Fuel Filter (See Fuel Filter section)	Clean ***		X		
	Replace				
Gas Tank	Replace			X	
	Clean ***			X	
Valve Clearance - Intake: 0.15 mm (0.006") Exhaust: 0.20 mm (0.008")	Check-Adjust				X

\* Perform initial oil change after first 5 hours of operation, then every 50 hours or every season

\*\* Service more frequently under dusty conditions

\*\*\* These items should only be performed by a mechanically proficient person or by the servicing dealer

## ENGINE MAINTENANCE

### LUBRICATION

Choose engine oil that meets or surpasses the latest API service classification. For temperatures higher than 32° F, use SAE 30 or SAE 10W-30 motor oil. Use SAE 5W-30 or SAE 10W if temperatures are below 32° F.

**NOTE: Do not use SAE 10W-40 motor oil.**

### OIL MAINTENANCE

After the first five hours of operating a new Viper engine the oil should be replaced, and every 50 hours of operating time thereafter. The oil should be changed every 25 hours if used under severe conditions, such as in high temperatures or under heavy loads, otherwise changed weekly. Check oil periodically; do not overfill!

### CHANGING OIL

Be sure the engine is not operating and is located on a level surface before checking or refilling oil. Engine should be warm for easy removal of oil.

1. Detach spark plug wire and move away from spark plug. If engine uses a battery; disconnect at negative terminal. **SEE FIGURE 11.**
2. Disconnect oil drain plug and empty oil into suitable oil container. Dispose of oil properly. **SEE FIGURE 1.**
3. Reconnect drain plug. Remove dipstick (if applicable) or oil fill cap. **SEE FIGURE 2.**
4. Fill with appropriate oil to “FULL” or top line of dipstick; otherwise to top thread of oil fill hole. **SEE FIGURE 3(a) & 3(b).**
5. Reinsert dipstick or oil fill cap and tighten.

### AIR FILTER

- Never run engine without air filter properly installed. Added wear and engine failure may occur if air filter is not installed on engine. **SEE FIGURE 12.**
- Service air filter every 3 months or after 20 hours of operation. Clean filter daily in extremely dusty conditions.

### REMOVING/INSTALLING AIR FILTER

1. Loosen wing nut and remove air cleaner cover by rotating to the left towards spark plug. **SEE FIGURE 12.**

**NOTE: Remove with care to prevent damage to choke lever.**

### ⚠ CAUTION

#### TO PREVENT ACCIDENTAL STARTING

**AVOID INJURY! ENGINE MUST BE TURNED OFF AND COOL AND SPARK PLUG WIRE MUST BE REMOVED FROM SPARK PLUG BEFORE CHECKING AND ADJUSTING ENGINE OR EQUIPMENT.**

#### OIL IS HAZARDOUS WASTE

**AVOID INJURY! ENGINE OIL IS HAZARDOUS TO YOUR HEALTH. DISPOSE OF OIL APPROPRIATELY. USE A SAFE DISPOSAL/RECYCLING CENTER.**

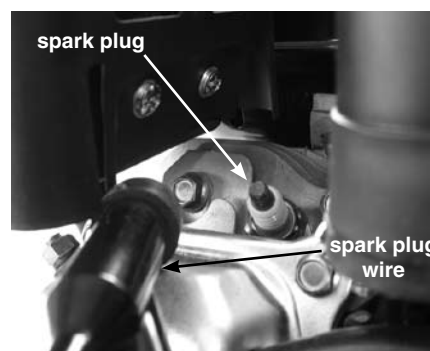

FIGURE 11



FIGURE 12)

2. Remove foam pre-cleaner, followed by the air filter. **SEE FIGURE 13(a) & 13(b).**
3. Replace foam pre-cleaner and reinstall new or clean air filter inside cover.
4. Place cover's tabs into slots in bottom of base.
5. Replace cover and tighten wing nut. **SEE FIGURE 14.**

### WASHING AIR FILTER

1. Wash in warm water with mild soap until dirt and debris are removed. Press filter when washing, do not twist.
2. Rinse in warm water until soap and dirt are removed.
3. Dry filter by wrapping in a clean cloth and pressing filter until it is dry.
4. Attach the filter and air cleaner cover to the engine.

### **SPARK PLUG**

The recommended spark plug is a Torch F7RTC which cross references to an AC Delco R42CXLS, Champion RN7YC or Denso W22EPR-U.

### CHECKING AND CHANGING SPARK PLUG

1. Check spark plug every 50 operating hours.
  2. Disconnect the spark plug cap, and clean any debris form around the spark plug area.
  3. Remove spark plug and replace if any of the following occur; pitted electrodes, burned electrodes, cracked porcelain, or deposits around electrodes.
  4. After analysis, seat spark plug and tighten with spark plug wrench to compress the sealing washer. **SEE FIGURE 11.**
- Reinstall original spark plug, tighten additional 1/2 turn.
  - Installing new spark plug, adjust spark plug gap to .030" and tighten additional 1/8 – 1/4 turn .

**NOTE: Loose spark plug may overheat and damage engine. Over tightened spark plug may damage threads in the cylinder head.**

### SPARK PLUG MAINTENANCE

Spark plug should be removed, cleaned and gap adjusted after approximately fifty hours of operating time.

**NOTE: A sand blaster should not be used to clean spark plugs. Microscopic particles remaining in the plug may score the engine cylinder during operation. Use solvent and a wire brush to clean the plug and compressed air to blow out completely.**

### **CARBURETOR**

- Never tamper with factory setting of the carburetor.
- Contact your service provider or Ardisam, Inc. if adjustment is needed.

### **⚠ WARNING**

**FUEL IS HIGHLY FLAMMABLE AND MUST BE HANDLED WITH CARE. NEVER FILL THE TANK WHEN THE ENGINE IS HOT OR RUNNING. ALWAYS MOVE OUTDOORS TO FILL GAS TANK.**

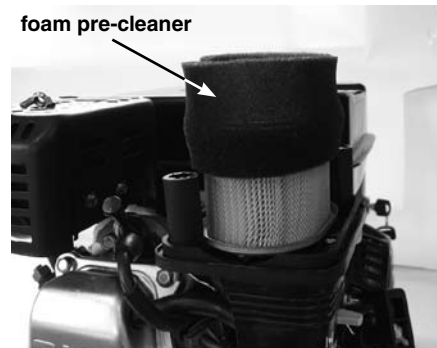

**FIGURE 13(a)**



**FIGURE 13(b)**

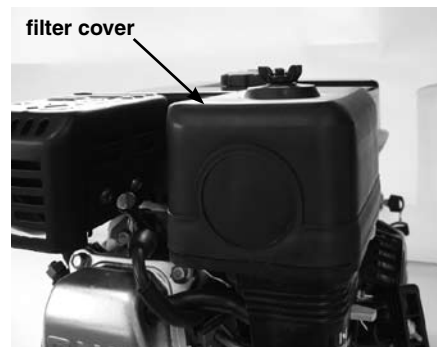

**FIGURE 14**

### FUEL FILTER

#### CLEANING OR REPLACING FUEL FILTER

1. Drain fuel from tank before attempting to clean/replace fuel filter.
2. Disconnect the hose clamp and remove fuel filter from fuel pipe.  
**SEE FIGURE 15(a) & 15(b).**
3. Filter may be washed with kerosene.
4. Reassemble; if filter is overly dirty replace with new.

### BATTERY (ELECTRIC MODELS ONLY)

Viper engines use a 12 V 7.0 AH/20HR battery. Never connect the battery in reverse polarity avoiding a short circuit to the battery charging system. Always connect the positive (+) battery cable to the battery terminal before hooking up the negative (-) battery cable.

#### CONNECTION

1. Connect positive (+) battery cable to the starter solenoid terminal.
2. Connect negative (-) battery cable to an engine mounting bolt, frame bolt, or other proficient ground connection.
3. Connect positive (+) battery cable to the positive (+) battery terminal.
4. Connect negative (-) battery cable to the negative (-) battery terminal.
5. Coat both terminals and cable ends with grease.

#### FUSE REPLACEMENT

Viper's electric starter relay circuit and battery charging circuit are protected by a 5-ampere fuse. The electric starter is inoperable if the fuse burns out. The engine may be started manually without a fuse, but the battery will not charge while operating until the fuse is replaced.

1. Remove ignition circuit cover and locate fuse housing. **SEE FIGURE 16(a) & 16(b).**

### **⚠ WARNING**

#### BATTERY MAY EXPLODE

- **BATTERY MAY EXPLODE IF PROPER PROCEDURE IS NOT FOLLOWED, CAUSING SERIOUS HARM TO PEOPLE NEARBY.**
- **KEEP AWAY FROM ALL SPARKS, OPEN FLAMES, AND SMOKING MATERIALS**

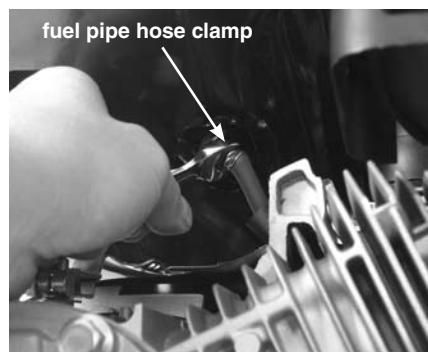

FIGURE 15(a)

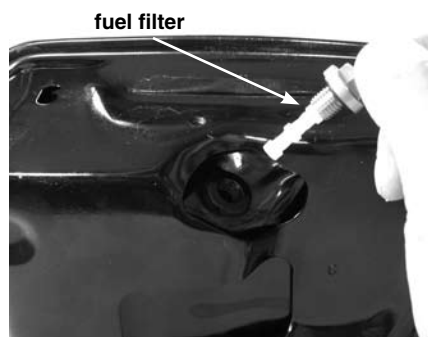

FIGURE 15(b)

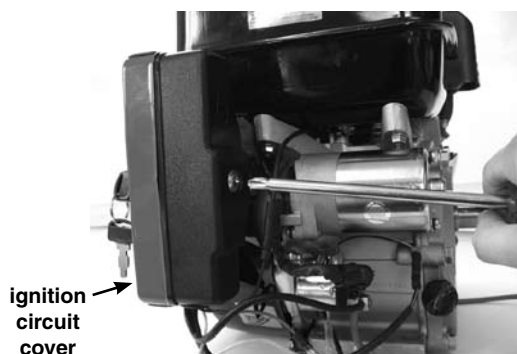

FIGURE 16(a)

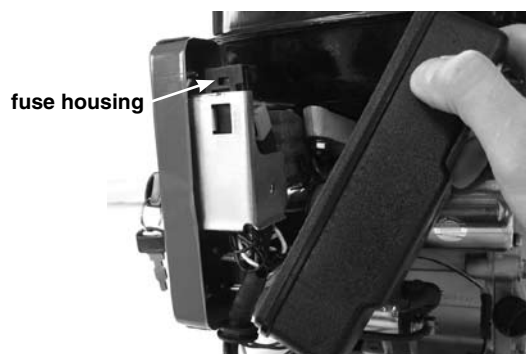

FIGURE 16(b)



2. Open the fuse cover and examine the fuse. If fuse is burnt out, **SEE FIGURE 17.**
3. Pull out and dispose burnt-out fuse. Install a new 5-ampere fuse. **SEE FIGURE 18.**
4. Replace ignition circuit cover. **SEE FIGURE 19(a) & 19(b).**

**NOTE:** Repeated fuse failure suggests a short circuit or an overload in the electrical system. Service engine at nearest Viper dealer.

## TRANSPORTING AND STORAGE

### TRANSPORTING ENGINE

1. Never transport engine inside an enclosed space or vehicle. Fuel or fuel vapors may ignite causing serious injury or death.
2. If fuel is present in the gas tank remove fuel or transport with an open vehicle in an upright position.
3. If an enclosed vehicle must be used, remove gas into an approved red fuel container. **DO NOT siphon by mouth.**
4. Run engine to use up the fuel in the carburetor and gas tank. Always run engine in a well ventilated area.
5. Wipe away any spilled fuel from engine. Allow to dry.

### STEPS FOR LONG TERM STORAGE

1. Add fuel stabilizer according to manufacturer's instructions.
2. Run engine for 10-15 minutes to ensure that the stabilizer reaches the carburetor.
3. Remove the remainder of the fuel from the gas tank into an approved fuel container.
4. Store engine in its upright position.
5. Remove all debris from engine.

### ⚠ WARNING

**FAILURE TO FOLLOW MAINTENANCE INFORMATION CAN CAUSE DEATH OR SERIOUS INJURY.**

**DO NOT REMOVE FUEL WHILE SMOKING, NEAR OPEN FLAME, OR OTHER POTENTIAL HAZARDS.**

**AVOID INJURY! NEVER STORE ENGINE WITH FUEL IN THE TANK INSIDE A BUILDING. POTENTIAL SPARKS MAY BE PRESENT CAUSING IGNITION OF FUEL AND FUEL VAPORS.**

### ⚠ CAUTION

**AVOID INJURY! TO AVOID INJURY OR DEATH, NEVER SIPHON FUEL BY MOUTH.**

**AVOID INJURY! CHECK ENGINE OFTEN FOR LOOSE NUTS AND BOLTS. KEEP THESE ITEMS TIGHTENED.**

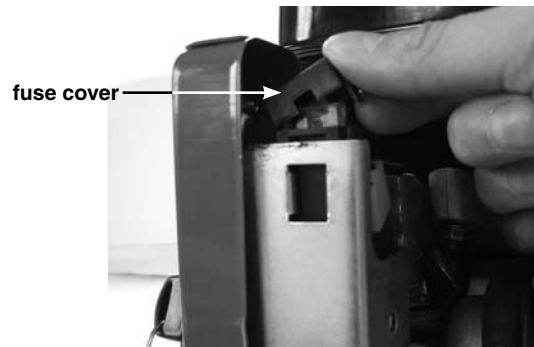

FIGURE 17

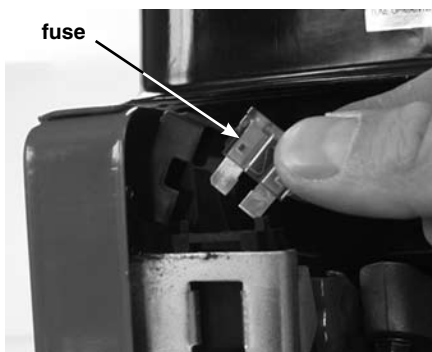

FIGURE 18



FIGURE 19(a)



FIGURE 19(b)

## **SERVICE AND TROUBLESHOOTING**

### **SERVICE INFORMATION**

At Ardisam, we build quality and durability into the design of our products. Nevertheless, no amount of careful design by us, or thorough maintenance by you, can guarantee a repair-free life for your engine. Most repairs will be minor and easily fixed by following the suggestions in the troubleshooting guide of this section.

This section will help you pinpoint the causes of common problems and identify remedies.

For more complicated repairs you may want to rely on your retailer, an authorized mechanic or Ardisam, Inc. (contact your retailer for a list of authorized mechanics in your area). A parts catalog is included in this section. We will always be glad to answer any questions you encounter or find suitable assistance to meet your needs. To order parts or inquire about our warranty call, write or browse our website at the address found below under the section "ordering repair parts."

### **ORDERING REPAIR PARTS**

Parts can be obtained from the store where your engine was purchased or direct from the factory. To order from the factory, call or write to:

**Ardisam, Inc.**  
**1690 Elm Street, Cumberland, WI 54829**  
**Phone (715) 822-2415 Fax (715) 822-4180**  
**1-800-345-6007**  
**Email: [info@ardisam.com](mailto:info@ardisam.com)**  
**[www.ardisam.com](http://www.ardisam.com)**

Please include the following information with your order:

1. Part numbers
2. Part description
3. Quantity
4. Model number and serial number

### **⚠ CAUTION**

**PRACTICE SAFETY AT ALL TIMES. ENGINE MUST BE TURNED OFF AND ALLOWED TO COOL AND SPARK PLUG WIRE MUST BE DISCONNECTED BEFORE ATTEMPTING ANY MAINTENANCE OR REPAIR.**

**TROUBLESHOOTING**

PROBLEM	POSSIBLE CAUSE	REMEDY/ACTION
Engine will not start     Electric Start	1. Power switch off	1. Flip switch to <b>ON</b> position
	2. Spark plug wire disconnected	2. Connect spark plug wire to spark plug
	3. Out of fuel	3. Refuel
	4. Spark plug wet, faulty or improperly gapped	4. Clean, replace or gap sparkplug
	5. Battery discharged	5. Recharge battery
	6. Fuse burnt out	6. Replace fuse
Engine runs rough, floods during operation	1. Dirty air filter	1. Clean or replace air filter
	2. Choke partially engaged	2. Turn off choke
	3. Carburetor out of adjustment	3. Call factory
Engine is hard to start	1. Stale fuel	1. Drain old fuel and replace with fresh. Use gas stabilizer at end of season
	2. Spark plug wire loose	2. Make sure spark wire is securely attached to spark plug
	3. Dirty carburetor	3. Clean carburetor, use gas stabilizer, new gas can
Engine misses or lacks power	1. Clogged gas tank	1. Remove and clean
	2. Clogged air filter	2. Clean or replace
	3. Improper carburetor adjustment	3. Call factory
	4. Spark plug dirty, improper gap, or wrong type	4. Replace spark plug and adjust gap to .030"
Engine runs, then quits	1. Gas cap not venting	1. Open self venting gas cap

Contact service provider if above remedies fail.



# OPERATING AND MAINTENANCE INSTRUCTIONS

6.5 hp 4-Stroke Engine

## 6.5 HP VIPER ENGINE PARTS EXPLOSION

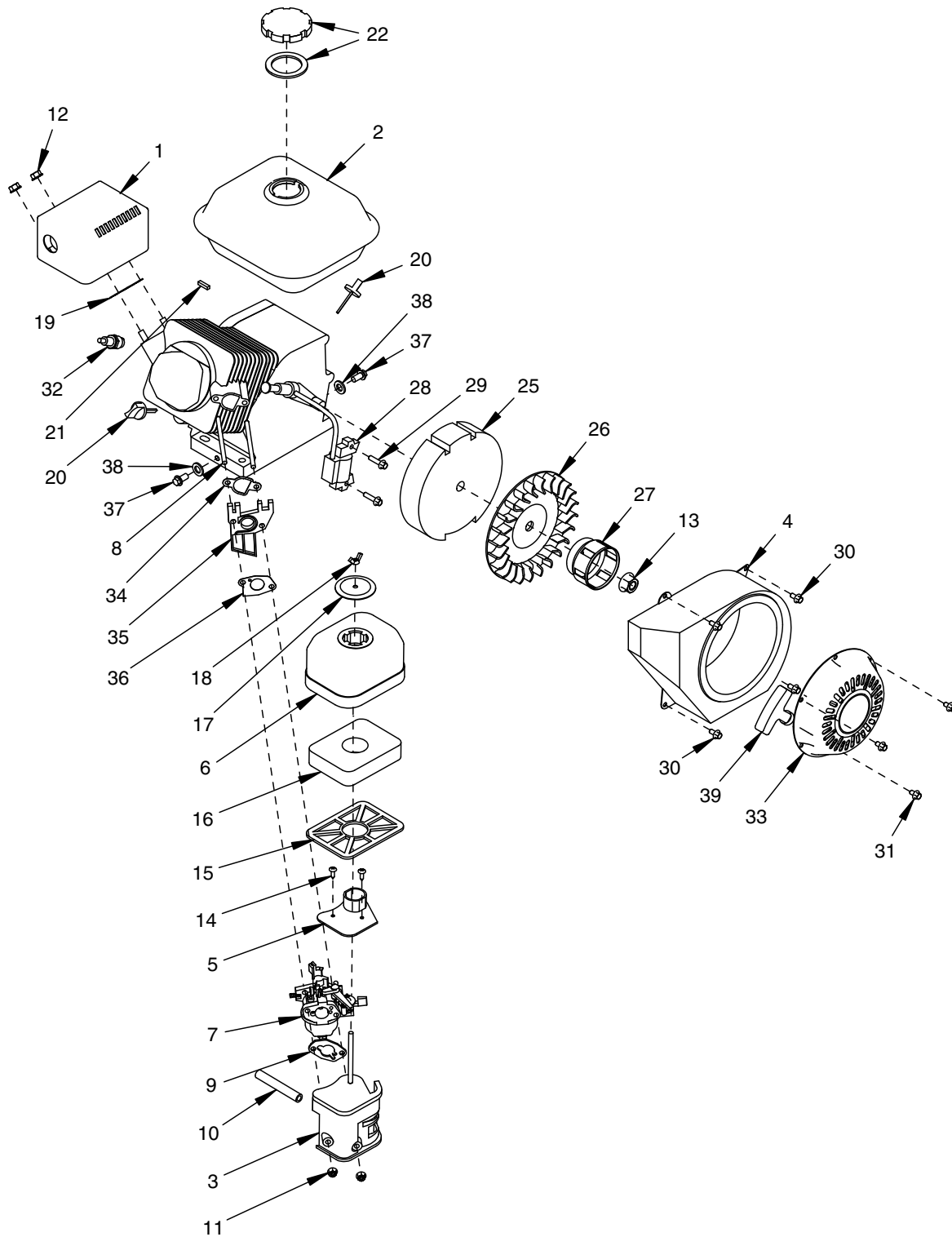



## OPERATING AND MAINTENANCE INSTRUCTIONS

6.5 hp 4-Stroke Engine

### 6.5 HP VIPER ENGINE PARTS LIST

KEY NO.	PART NO.	DESCRIPTION	QTY.
1	64686	MUFFLER KIT	1
2	64304	GAS TANK	1
3	64283	HOUSING, AIR CLEANER	1
4	64237	FAN HOOD ASSEMBLY	1
5	64285	BASE, AIR FILTER	1
6	64279	COVER, AIR CLEANER	1
7	64308	CARBURETOR ASSEMBLY	1
8	64207	STUD BOLT, M6 X 113	2
9	64309	GASKET, AIR CLEANER	1
10	64204	AIR DUCT	1
11	64732	NUT, FLANGED M6	2
12	64291	NUT, FLANGED M8	2
13	64274	NUT, FLANGED M14	1
14	64733	SCREW, FLAT HEAD	2
15	64286	HOLDER, AIR FILTER	1
16	64280	AIR FILTER ELEMENT	1
17	64281	WASHER	1
18	64278	WING NUT	1
19	64294	GASKET, EXHAUST	1
20	64182	DIPSTICK ASSEMBLY	2
21	4352	KEY	1
22	6327	GAS CAP W/ PACKING RING	1

KEY NO.	PART NO.	DESCRIPTION	QTY.
25	64277	FLYWHEEL	1
26	64276	FAN, FLYWHEEL	1
27	64275	STARTING FLANGE	1
28	64273	IGNITION COIL ASSEMBLY	1
29	64269	BOLT, M6 X 25 FLANGED	2
30	6272	BOLT, M6 X 18 FLANGED	4
31	6263	BOLT, M6 X 12 FLANGED	3
32	64212	SPARK PLUG	1
33	64250	RECOIL STARTER ASSEMBLY (INCLUDES PULL-START HANDLE)	1
34	64305	GASKET, INLET	1
35	64306	CONNECTING BLOCK	1
36	64307	GASKET, CARBURETOR	1
37	6204	OIL DRAIN PLUG	2
38	64157	WASHER	2
39	64249	PULL-START HANDLE	1

## OPERATING AND MAINTENANCE INSTRUCTIONS

6.5 hp 4-Stroke Engine



### REGISTRATION

Record your model number and serial number in the space provided for easy reference. Fill out and mail the registration card located in your parts packet. Warranty is valid only if your completed registration card is received by Ardisam, Inc., at time of purchase.

Model Number \_\_\_\_\_

Serial Number \_\_\_\_\_

Date of Purchase \_\_\_\_\_

Place of Purchase \_\_\_\_\_

**Ardisam, Inc.**  
**1690 Elm Street**  
**Cumberland, Wisconsin 54829**  
**800-345-6007 • Fax (715) 822-2223**  
**Email: [info@ardisam.com](mailto:info@ardisam.com)**

### WARRANTY

Ardisam, Inc., Manufacturing Company warrants this Viper engine under a **two year** limited warranty to be free from defects in materials and workmanship for the service life of the product not to exceed twenty four consecutive months from the date of purchase for consumer applications and **one year** for all commercial applications. As an Ardisam Viper small engine owner, you are accountable for executing proper maintenance listed in your Operating and Maintenance Instructions. This warranty applies to the original owner with a proof of purchase and is not transferable. This warranty applies only to products which have not been subjected to negligent use, misuse, alteration, accident, unauthorized parts, failure to use proper fuel and oil, or if repairs have been performed at non-authorized service centers. This warranty supersedes all other warranties either expressed or implied and all other obligations or liabilities on our part. Ardisam, does not assume, and does not authorize any other person to assume for us, any liability in connection with the sale of our products. Warranty work must be sent directly to Ardisam, Inc. or one of our authorized service centers and performed by them. To obtain warranty service and replacement instructions, contact our customer service department at 800-345-6007 or by writing to: Ardisam, Inc., 1690 Elm Street, Cumberland, WI 54829. All items must be shipped prepaid. Ardisam will at no charge, repair or replace, at their discretion, any defective part which falls under the conditions stated above. Ardisam retains the right to change models, specifications and price without notice.



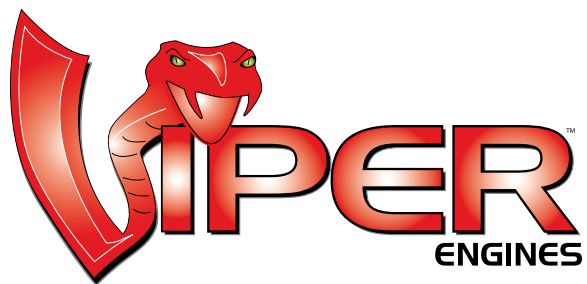

VIPER Engines, Manufactured by Ardisam, Inc.  
1690 Elm Street  
Cumberland, Wisconsin 54829  
800-345-6007 · Fax (715) 822-2223  
Email: [info@ardisam.com](mailto:info@ardisam.com)

