

Universal Mount ATV/UTV Wheel Chock (TX211)

YUTRAX™ offers a full line of Engineered Outdoor Gear. We appreciate your purchase of one of our world class ATV/UTV Wheel Chocks. Follow these few simple instructions and your product will be sure to give you many years of trouble free pleasure. Instructions should be kept in a safe place and reviewed at least annually.

If for any reason you have a problem with your product, **DO NOT return to the retailer**, contact the YUTRAX customer service department at 800-345-6007 for assistance.

ASSEMBLY INSTRUCTIONS:

Tools needed -- two 7/16" wrenches and two 1/2" wrenches.

NOTE: This ATV/UTV Wheel Chock was universally designed to work on most brands of ATV/UTV's.

1. Insert (2) lower wheel chock tubes (68100) into the upper wheel chock tube (68099) by inserting swaged end of lower tubes into the upper tube. Be sure both lower tubes are inserted the same direction. **SEE PARTS EXPLOSION.**
2. With both lower tubes inserted into the upper tube, secure them together using (2) provided 1/4-20 x 1-1/2" bolts and locknuts. **SEE PARTS EXPLOSION.** Make sure the head of the bolts are on the inside of wheel chock so threaded end of the bolts will not interfere with wheel of vehicle when in use. **Tighten securely.**
3. Attach (2) channel mounts (68098) to each lower tube using (2) provided spring lock pins. Make sure channels are oriented **as per the PARTS EXPLOSION.** Spring lock pins should be orientated so heads are to the inside of wheel chock, and latch ends are to the outside of wheel chock. **SEE PARTS EXPLOSION.** Place the assembled wheel chock with channels attached onto the bed of hauling vehicle (trailer). With the wheel chock in the desired location, mark the 4 locations to drill holes for permanent attachment of the channels. Remove wheel chock after hole locations are marked.
4. Using a 21/64" drill bit, drill the four marked locations in bed of hauling vehicle (trailer). Use caution and be sure you are not going to drill through any critical structure point of hauling vehicle (trailer).
5. Attach the channel mounts to the bed of hauling vehicle (trailer) using (4) provided 5/16-18 x 1-1/4" or 5/16-18 x 1-3/4" or 5/16-18 x 2-1/4" bolts, locknuts and fender washers. **SEE PARTS EXPLOSION. Tighten Securely.**
NOTE: Bolt length is dependant upon thickness of your trailer bed.
6. Wheel chock can now be attached and detached easily by using the spring lock pins. Be sure spring lock pins are latched to prevent accidental removal. Channel mounts are designed to be permanently attached to bed of hauling vehicle (trailer).

! WARNING

READ, UNDERSTAND AND FOLLOW ALL ASSEMBLY, INSPECTION, MAINTENANCE & USE INSTRUCTIONS PROVIDED BEFORE EACH USE. FAILURE TO FOLLOW ALL WARNINGS AND INSTRUCTIONS COULD RESULT IN SERIOUS INJURY OR DEATH.

IF ANY INSTRUCTIONS ARE NOT UNDERSTOOD OR IF YOU HAVE A PARTS ISSUE CALL 800-345-6007 BEFORE USING.

BE SURE LOWER TUBES ARE SEATED COMPLETELY TOGETHER WITH UPPER TUBES. SECTIONS ARE THEN SECURED WITH BOLTS AND NUTS.

BE SURE SPRING LOCK PINS ARE LATCHED SECURELY TO PREVENT ACCIDENTAL REMOVAL.

USE CAUTION WHEN DRIVING INTO WHEEL CHOCK TO PREVENT UNNECESSARY DAMAGE.

VEHICLE SHOULD ALWAYS BE TIED FORWARD TO APPLY PRESSURE ON WHEEL CHOCK.

BE SURE TO PERIODICALLY CHECK ALL NUT AND BOLTS FOR TIGHTNESS. OVER TIME, NUTS AND BOLTS MAY BECOME LOOSE FROM VIBRATION.

INSPECT BEFORE EACH AND EVERY USE TO BE SURE THERE IS NO PRODUCT DAMAGE OR LOOSE/MISSING HARDWARE.

NEVER USE A DAMAGED WHEEL CHOCK- REPLACE WITH NEW.

NEVER USE UNDER THE INFLUENCE OF ALCOHOL OR DRUGS.

NEVER USE CARELESSLY- THINK SAFETY!

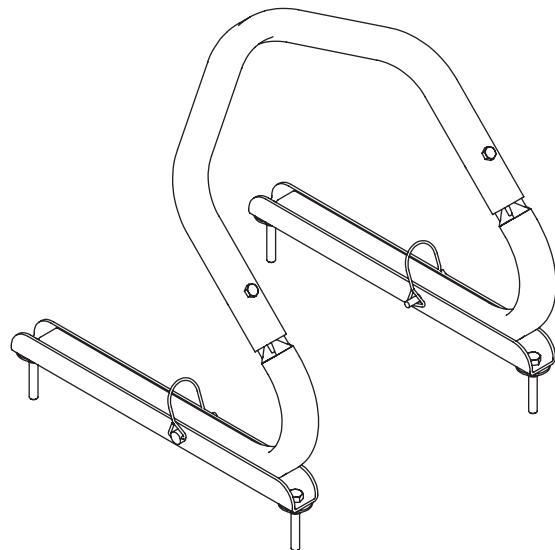
TX211 - ASSEMBLED WHEEL CHOCK

P/N: 18356
ECN: 10559
REV2: 08/05/14
© 2014 Ardisam, Inc.
All Rights Reserved.



TX211 - PARTS EXPLOSION

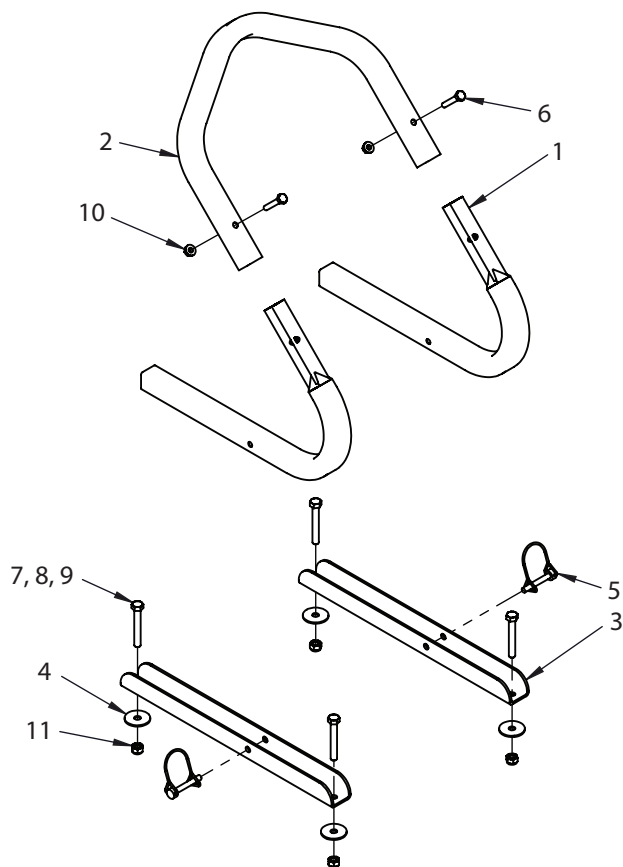

KEY #	PART #	DESCRIPTION	QTY.
1	68100	TUBE, WHEEL CHOCK LOWER	2
2	68099	TUBE, WHEEL CHOCK UPPER	1
3	68098	CHANNEL MOUNT WHEEL CHOCK	2
4	1960044	WASHER, FLAT .33 ID X 1.25 OD X .07 THK	4
5	63281	LOCKPIN 1/4 X 1-3/4 ROUND HANDLE BLK	2
6	48240B	BOLT, HHCS 1/4-20 X 1-1/2 GR5 BLK	2
7	1401B	BOLT, HHCS 5/16-18 X 1-1/4 GR5 BLK	4
8	8655B	BOLT, HHCS 5/16-18 X 1-3/4 GR5 BLK	4
9	48300B	BOLT, HHCS 5/16-18 X 2-1/4 GR5 BLK	4
10	48752B	NUT, 1/4-20 HFNYLK BLK ZN	2
11	60G5NYB	NUT, 5/16-18 HNYLK BLK ZN	4

WARRANTY

YUTRAX, a division of Ardisam Incorporated, offers a one year limited warranty to be free from defects in materials and workmanship for the service life of the product, not to exceed twelve consecutive months from the date of purchase. This warranty applies to the original owner with a proof of purchase and is not transferable. This warranty applies only to products which have not been subjected to negligent use, misuse, alteration, accident or if repairs have been made by anyone outside our factory. This warranty supersedes all other warranties either expressed or implied and all other obligations or liabilities on our part. Ardisam, Inc., does not assume, and does not authorize any other person to assume for us, any liability in connection with the sale of our products. Warranty work must be sent directly to Ardisam, Inc. or one of our authorized service centers and performed by them. **To obtain warranty service and/or replacement instructions, you must have prior approval from Ardisam, Inc. before shipping your package to us by calling our customer service department at 800-345-6007 or by writing to: Ardisam, Inc., P.O. Box 666, 1690 Elm Street, Cumberland, WI 54829 for a return material authorization number (RMA#).** All items must be shipped prepaid. Ardisam, Inc. will at no charge, repair or replace, at their discretion, any defective part which falls under the conditions stated above. Ardisam retains the right to change models, specifications and price without notice.

For replacement parts, phone 800-345-6007
or go online to www.yutrax.com.



YUTRAX™, Division of Ardisam, Inc.
1160 8th Avenue, PO Box 666
Cumberland, WI 54829
800-345-6007 | Fax 715-822-2223
E-mail: info@yutrax.com