

Eskimo®

HIGH PERFORMANCE ICE FISHING GEAR

GetEskimo.com

ASSEMBLY INSTRUCTIONS & PARTS

Eskape 350 Ice Shelter



MODEL 69163



GetEskimo.com



OM69163

Rev. 6/3/08

© 2008 Ardisam, Inc.
All Rights Reserved.

Eskape™ 350 Hardwater Series (69163)

Eskimo ice shelters are engineered with you, the high performance ice angler in mind. We appreciate your purchase of one of our high performance portable ice shelters. Follow these simple instructions and your ice shelter will provide you many years of trouble-free pleasure. Save these instructions for future reference.

If for any reason you have a problem with your product, **DO NOT return to the retailer**, contact the Eskimo customer service department by phone at **800-345-6007** or by e-mail at **info@ardisam.com** for assistance.

CONTENTS

Introduction & Registration	2
Important Safety Precautions	3
Assembly, Set-up & Take-down Instructions	4-9
Standard Accessories.....	10
Long Term Storage	10
Parts	11-13
FAQ's (Frequently Asked Questions).....	14
Warranty	15
Optional Accessories.....	16

REGISTRATION

Record the model number and serial number (if applicable) in the space provided for easy reference. Fill out and mail the registration card located in the parts packet. Warranty is valid only if the completed registration card is received by Ardisam, Inc. within 30 days of purchase.

OWNERSHIP RECORDS		
Place of Purchase:		
Place of Purchase Address:		
City:	State/Province:	Zip Code/Postal Code:
Model Number:		Serial Number:
Date of Purchase:		
Notes:		

Escape™ 350 Hardwater Series (69163)

IMPORTANT SAFETY PRECAUTIONS

This tent is made with flame resistant fabric which meets CPAI-84 specifications. It is not fire proof. The fabric will burn if left in continuous contact with any flame source.

The application of any foreign substance to the tent fabric may render the flame resistant properties ineffective.

Heat sources burn oxygen and emit carbon monoxide. Use caution with heaters and vent properly.



This symbol points out important safety instructions which if not followed could endanger your personal safety. Read and follow all instructions in this manual.

- Do not use candles, matches or open flames of any kind in or near this shelter.
- Do not cook inside this shelter.
- Exercise extreme caution when using fuel-powered lanterns or heaters inside this shelter.
- Do not refuel lamps, heaters or stoves inside this shelter.
- Extinguish or turn off all lanterns before leaving this shelter.
- Do not smoke in this shelter.
- Do not store flammable liquids inside this shelter.

! WARNING

READ, UNDERSTAND AND FOLLOW ALL ASSEMBLY, SAFETY, SET-UP & USE INSTRUCTIONS PROVIDED BEFORE EACH USE. FAILURE TO FOLLOW ALL WARNINGS AND INSTRUCTIONS COULD RESULT IN SERIOUS INJURY OR DEATH.

KEEP ALL FLAME AND HEAT SOURCES AWAY FROM THIS TENT FABRIC.

DUE TO TRAFFIC ON LAKES, ICE FISHING CAN BE HAZARDOUS AT NIGHT. IF YOU CHOOSE TO FISH AT NIGHT OR IN CONDITIONS WITH POOR VISIBILITY, BE SURE TO TAKE PRECAUTIONS.

NEVER LEAVE THE ICE SHELTER UNATTENDED.

SECURELY ANCHOR THE ICE SHELTER TO THE ICE IN HIGH WIND CONDITIONS.

LUBRICATE THE SLIDE POLES WITH WD-40® OR A SILICON SPRAY AT LEAST SEASONALLY. DO NOT USE OIL OR GREASE AS A LUBRICANT.

Eskape™ 350 Hardwater Series (69163)

ASSEMBLY INSTRUCTIONS

Tools Needed: (2) 7/16" wrenches, (1) 3/8" wrench, (1) Phillips screwdriver and a rubber mallet.

ASSEMBLY NOTE: This ice shelter should be assembled in a garage or basement setting due to the time and length of assembly. Identify and familiarize yourself with all parts and hardware before assembly. Allow 1-3 hours for assembly.

ASSEMBLY NOTE: The use of a cordless drill with socket will make assembly of your ice shelter much quicker. Be sure to set the drill speed low so you do not over tighten any nut and bolt combinations.

ASSEMBLY NOTE: If a High-Speed Tracking Kit will be purchased for use on this ice shelter, it should be mounted to the sled before assembly of the ice shelter for convenience.

IMPORTANT ASSEMBLY TIP: DO NOT FULLY TIGHTEN ANY NUT AND BOLT COMBINATIONS UNTIL ALL BOLT-ON PARTS ARE ASSEMBLED TOGETHER! FINGER TIGHTEN ONLY! THIS WILL HELP HOLE ALIGNMENT OF ALL PARTS.

1. Attach the left hinge riser (68052) to the left front upper lip of sled using (3) provided 1/4-20 x 7/8" hex head bolts, nyloc nuts and washers. **SEE FIGURE 1.**

2. Attach the left hinge assembly (68140) to the top of left hinge riser using (2) provided 1/4-20 x 3/4" hex head bolts and nyloc nuts. **SEE FIGURE 1.**

NOTE: Be sure hinge assembly is orientated as shown in FIGURE 1, with high sides of hinges placed to the front of sled and bottom "J" hinge pole to the inside.

3. Attach the right hinge riser (68053) to the right front upper lip of sled using (3) provided 1/4-20 x 7/8" hex head bolts, nyloc nuts and washers. **SEE FIGURE 1.**

4. Attach the right hinge assembly (68139) to the top of right hinge riser using (2) provided 1/4-20 x 3/4" hex head bolts and nyloc nuts. **SEE FIGURE 1.**

NOTE: Be sure hinge assembly is orientated as shown in FIGURE 1, with high sides of hinges placed to the front of sled and bottom "J" hinge pole to the inside.

5. Attach (2) seat kit mount brackets (68304) to each hinge riser using (4) provided 1/4-20 x 3/4" hex head bolts and nyloc nuts. **SEE FIGURE 2.**
6. Slide the (2) pre-assembled rod holder assemblies (68449) into the T-slot of either bench seat rail. Doing so makes this bench seat rail the front rail and will be positioned beneath your legs during use.
7. Attach (2) bench seat rails (68351) to the top side of seat kit mount brackets using (4) provided 1/4-20 x 2-1/2" bolts, nyloc nuts and (4) washers. **SEE FIGURE 3A.** Make sure the rail with the rod holder assemblies is in front, so it will be positioned beneath your legs during use.

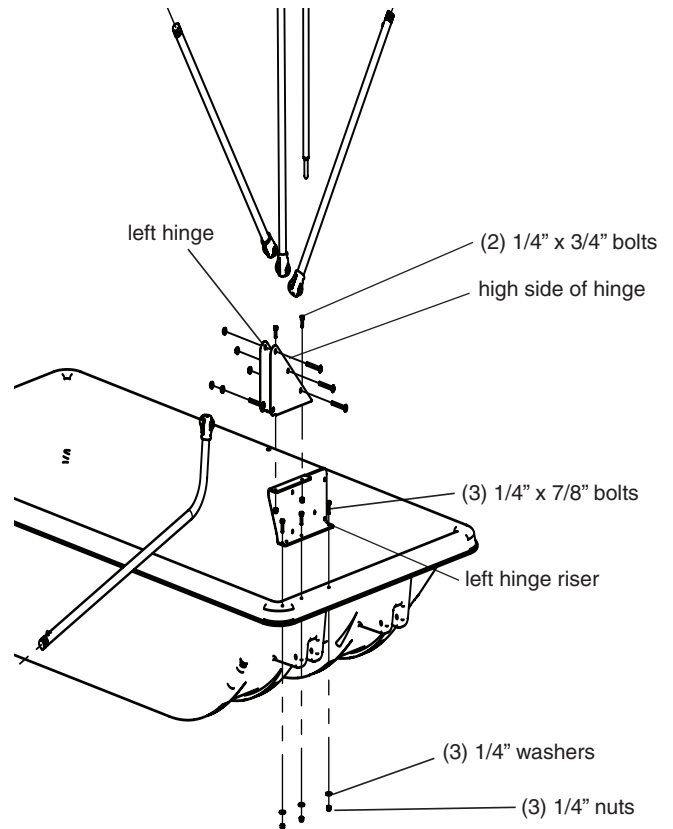

FIGURE 1 (left side shown)

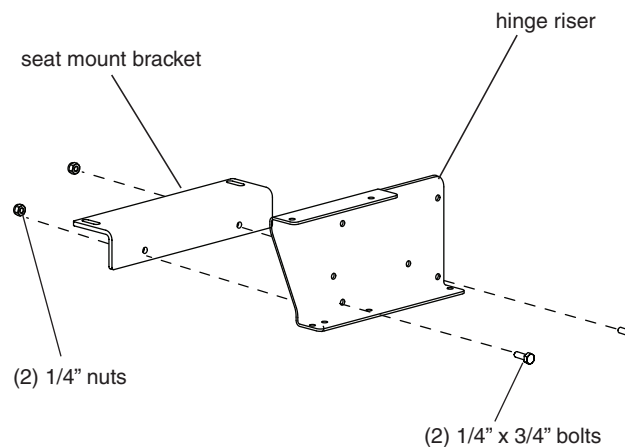

FIGURE 2 (left side shown)

Escape™ 350 Hardwater Series (69163)

8. Attach (2) storage tray end caps (68156) to each end of the storage tray (68158) using (8) provided 10-24 x 5/8" bolts, nyloc nuts and (16) 3/16" washers. **SEE FIGURE 3B.**
9. Attach the seat brace (68026), the left backrest bracket (68310), the right backrest bracket (68323) and the plastic storage tray to the center set of holes on bench seat rails using (2) provided 1/4-20 x 3-1/2" Phillips truss head bolts, (2) 1/4-20 x 4-1/2" Phillips truss head bolts, (4) nyloc nuts and (4) washers. **SEE FIGURE 3A.** The long bolts should be used in the rear holes since the added length is needed to go through the seat brace.

NOTE: The seat brace has two positions you can use to attach it to the backrest brackets and storage tray. Pick the position that best fits and allows for the bottom of seat brace to be positioned against the sled bottom firmly or in the channel.

In order for the top of the seat brace to fit firmly against the lip of storage tray, you may carefully cut two notches in the lip of storage tray for the welded on stubs of seat brace to clear the curled edge. Or, another option is to simply tighten down the nuts and bolts and allow for the curled edge to naturally flatten out and become sandwiched between the backrest brackets and top of seat brace. Either option will work depending on your preference.

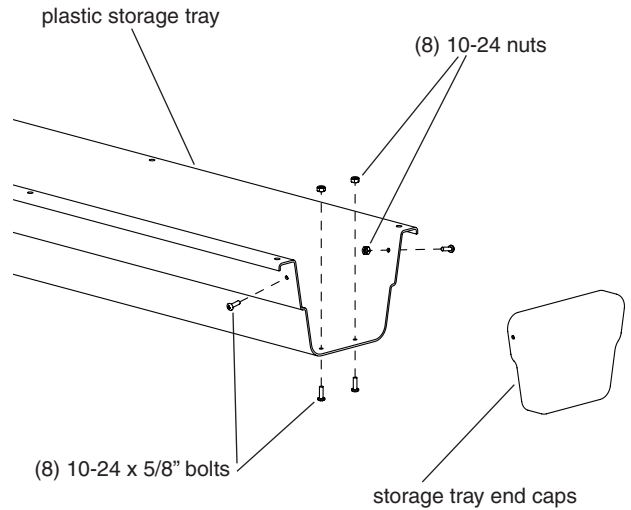

FIGURE 3B (left side shown)

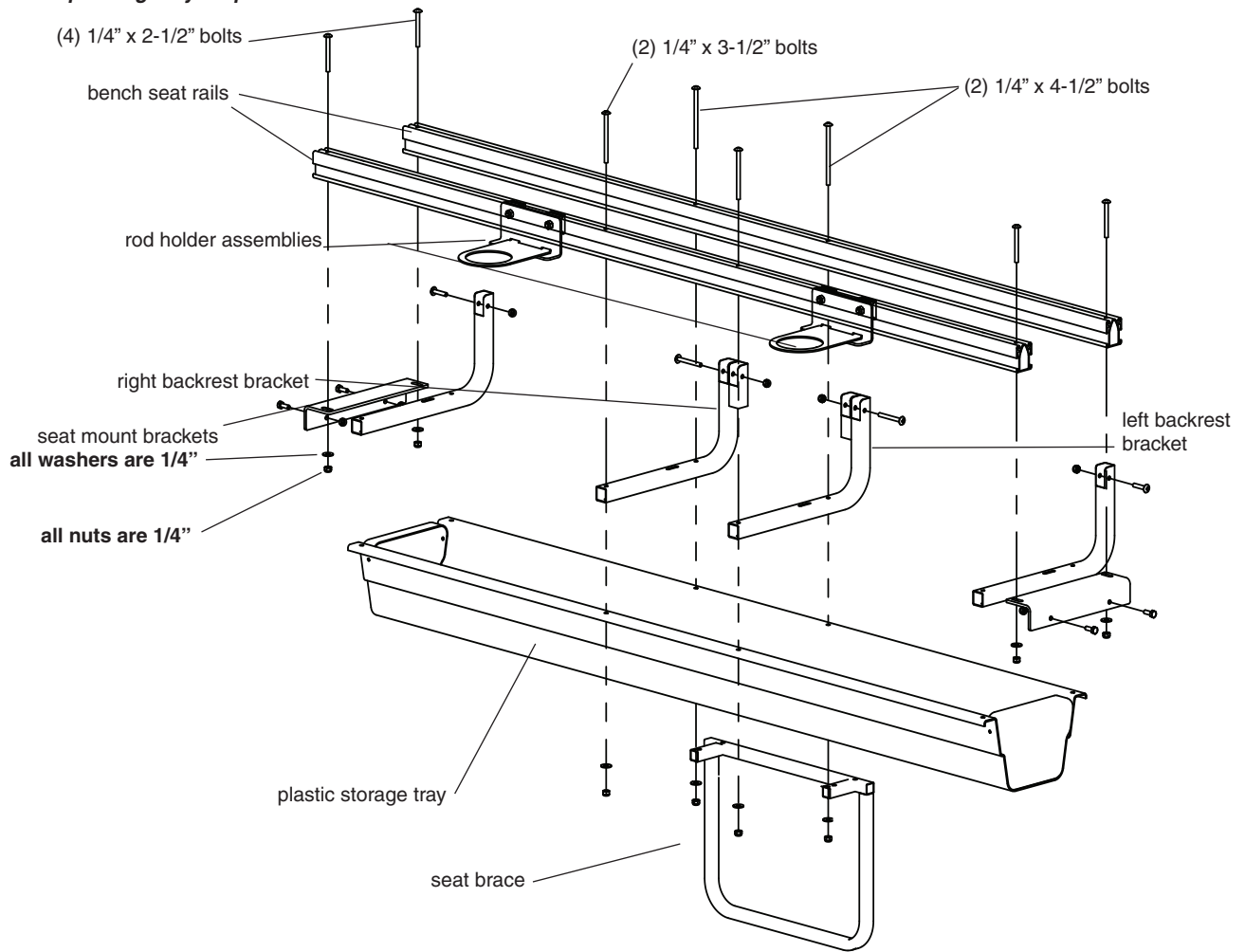

FIGURE 3A

Eskape™ 350 Hardwater Series (69163)

10. Attach the (2) 25" outer seat bottom frames (68322) and the plastic storage tray to the bench seat rails using (4) provided 1/4-20 x 3-1/2" Phillips head bolts, nyloc nuts and washers. **SEE FIGURE 4.**
11. Attach the (2) 25" padded seat assemblies (68006) and the (1) 12" padded seat assembly (68004) to the curled lip of front bench seat rail by hooking the curled end of seat bracket into the curled end of bench seat rail. **SEE FIGURE 3.** Seats should be positioned so they will flip upwards to the front so you can access gear underneath the seats, in the storage tray.

NOTE: Do not force the seat bracket into the bench seat rail. Loosening the seat bracket and adjusting the position of it from front to back will allow for the adjustment needed to hook the seat into the seat rail and then retighten the seat bracket on seat afterwards. You may even need to remove the seat brackets from the seat and hook them into the seat rail individually, then reattach the seat to the seat brackets.

Once your shelter is completely assembled, you may want to adjust the seat bracket position on the seat using the slots for desired positioning. Doing this will allow you to adjust how much travel the seats will have when flipping up.

12. Attach the (2) 25" metal backrest frames (68348) and the (1) 12" metal backrest frame to the backrest brackets using (2) provided 1/4-20 x 1-1/4" Phillips head bolts, (2) 1/4-20 x 2-1/4" Phillips head bolts and (4) nyloc nuts. **SEE FIGURE 4.**
13. **You may now tighten all nut & bolt assemblies. Be sure not to over tighten or crush tubing when tightening!**
14. Attach (2) removable 25" backrest cushions (68009) and (1) removable 12" backrest cushion (68008) to the backrest frames and secure with Velcro.

WARNING

BE SURE SEAT PAD & BUCKLES ARE SECURELY AND CORRECTLY ATTACHED TO PREVENT ACCIDENTAL REMOVAL!

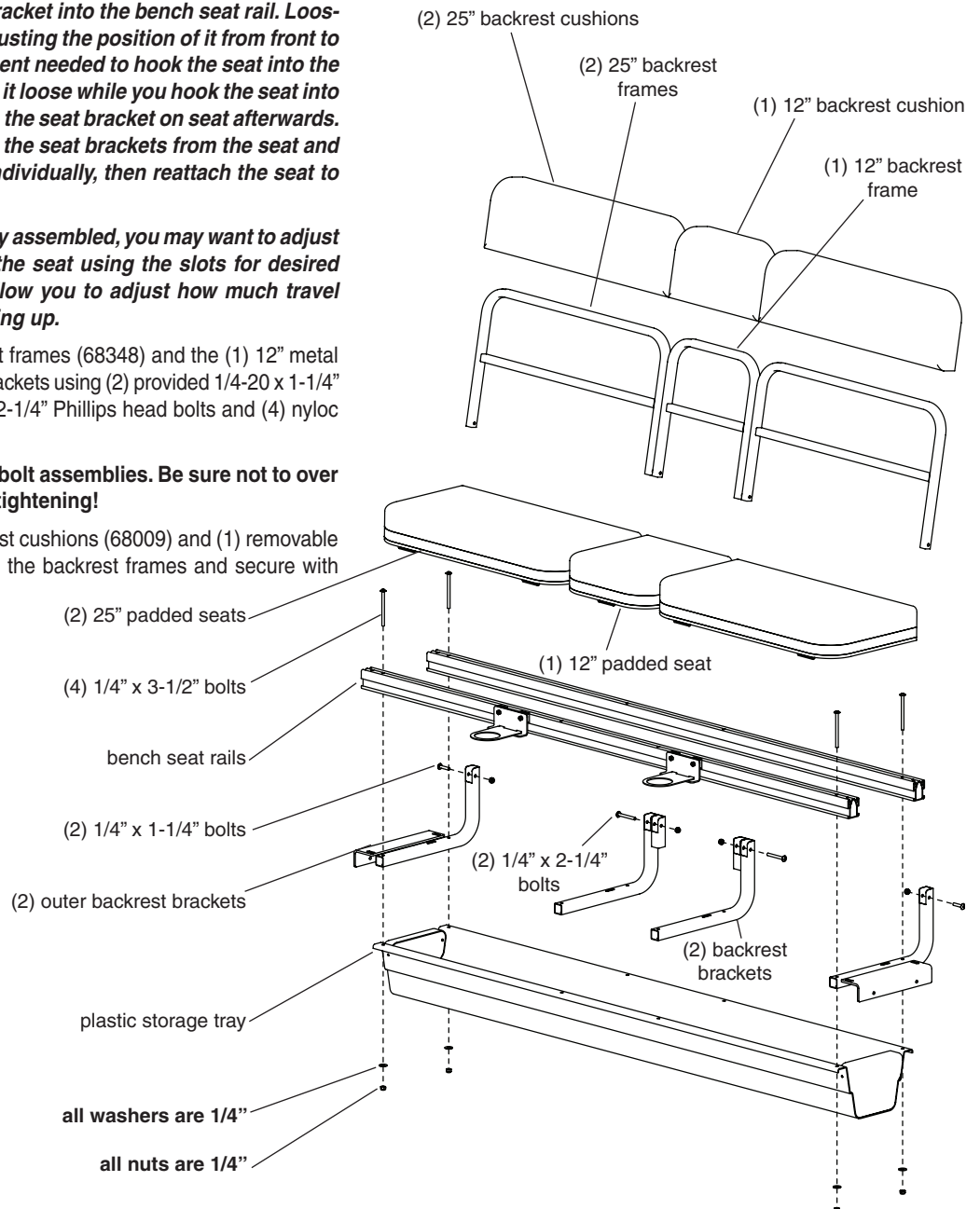

FIGURE 4

Eskape™ 350 Hardwater Series (69163)

15. Insert (3) hinge upright poles from each hinge and into the (3) top cross brace poles (68133 which measure approximately 75.95" x 27.96"). Making sure the lever side of large, red QRS pole clip is inline with the push button of hinge poles, push the snap buttons inward to allow cross brace pole to go over hinge poles and slide them to their shortest height (transport mode). **SEE FIGURE 5.**

NOTE: The (3) top cross brace poles are taller and wider than the bottom cross brace pole.

NOTE: If cross brace poles are not assembled correctly, added tension will be applied to the fabric skin.

16. Unfold skin and locate the Eskimo Eskape 350 logo near the zippered door, which is the front of the shelter. With front of shelter skin laying face down on the ground in front of the shelter, locate the (3) fabric sleeves sewn to the bottom seam on front side of shelter. Slide bottom cross brace pole (68132 which measure approximately 71.71" x 30.89") through the (3) fabric sleeves. Insert (1) hinge "J" pole from each hinge into the bottom cross brace pole. Making sure the lever side of large, red QRS pole clip is inline with the snap button of hinge poles, push the snap buttons inward to allow cross brace pole to go over "J" poles. Snap into place for the "in-use position." **SEE FIGURE 6.**

NOTE: Snap button should align with lever side of large, red QRS pole clip in cross brace pole. If not, you have feed the cross brace pole through fabric sleeves incorrectly and the cross brace will need to be flipped over.

17. Drape the rest of the shelter skin over the shelter sled, seats and poles and position as best you can.

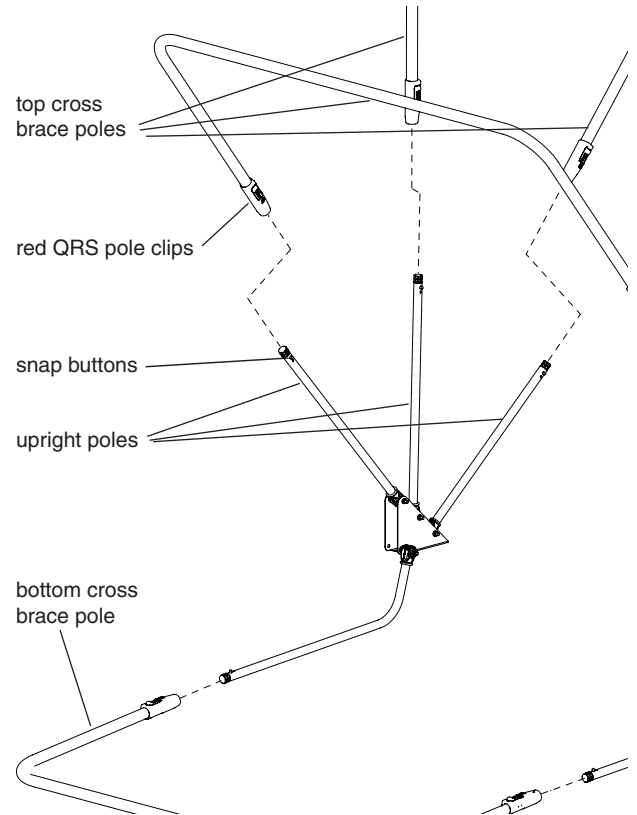

FIGURE 5 (right side shown)

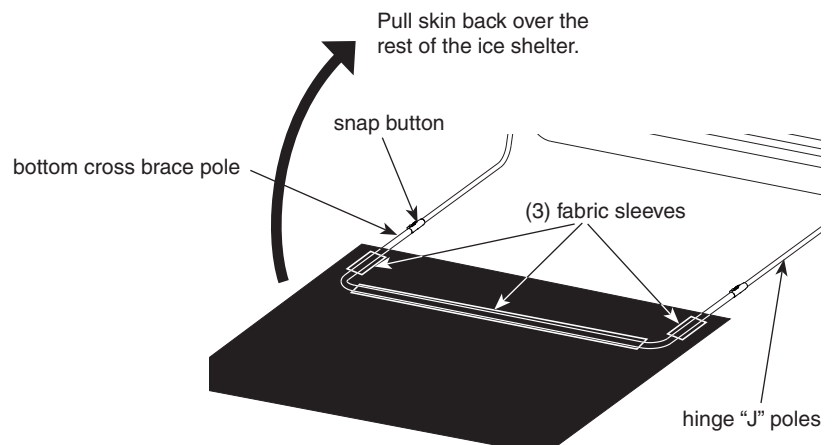

FIGURE 6

Escape™ 350 Hardwater Series (69163)

18. Assemble the two sets of door spreader poles (68046 & 68048) by sliding male half into the female half and snapping in place with snap button. **SEE FIGURES 7.**
19. Unzip door and move to the inside of shelter and extend the (3) top cross brace poles and snap into place. Place back spreader pole with stud, both roof spreader poles and both door spreader poles into position by snapping C-clip over cross brace poles. For back spreader pole, simply place end with stud into pre-drilled hole in back lip of sled. Attach all Velcro loops to cross brace poles. **SEE FIGURES 7 & 8.**
20. Move to outside of shelter. Find the center of the edge trim and line it up with the center of sled lip on back side of shelter. Pull down on the skin evenly over the sled lip until it is snug.

NOTE: When pulling skin tight, DO NOT lift the bottom cross brace pole off the ground. Bottom cross brace pole should always contact the ground. Make sure you have all spreader poles in place before applying edge trim to assure proper tension to the fabric skin.

Temporarily press the edge trim over the skin and sled lip. Using a rubber mallet may be helpful to press over the sled lip.

21. Secure edge trim in place using #6 3/8" sheet metal screws.

NOTE: Screws should be spaced apart evenly. This step does mean you will put very small holes in your skin to keep the edge trim and skin securely attached to sled lip. This will in no way affect the performance of your shelter.

22. Push ends of 8' tow rope through hitch tab or holes provided at the front of sled and knot each end to secure. This tow rope is designed for manual pulling by hand only. Do not tow behind a motorized vehicle with rope. For high speed towing, you should purchase the Eskimo Tow Hitch accessory.

IMPORTANT NOTE: If purchasing a tow hitch for your Eskimo ice shelter, it is highly recommended that you also purchase a high speed tracking kit to help extend the life of your sled and prevent unnecessary damage. Failure to do so may result in voiding of your warranty.

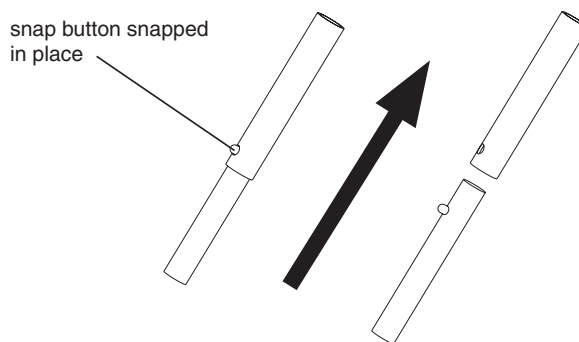

FIGURE 7

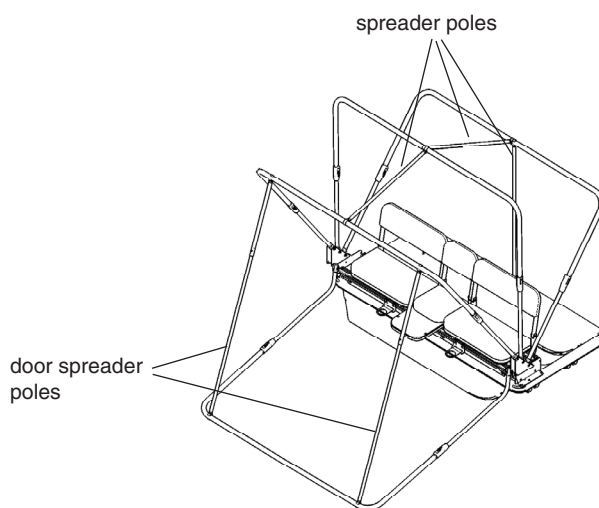

FIGURE 8

SET-UP & USE INSTRUCTIONS

SET-UP: From the outside or inside of shelter, depending on your preference, start with the bottom cross brace pole and pull out all cross brace poles and snap into place. As you pull out each cross brace pole and snap into place, flip all cross braces over to the in use position. Secure all spreader poles in between all cross brace poles by snapping C-clips over cross brace poles.

By removing the back spreader pole and the top back spreader pole, you can flip the shelter half way back and use it as a wind break on nice day.

TAKE-DOWN: Close all window covers, vent covers and zip door shut. Remove all spreader poles and place in bottom of sled. Remove any gear from the storage pockets. Starting with the rear cross brace pole, press the QRS pole clips in and retract all cross brace poles to their shortest length. Work from the rear cross brace to the front cross brace that lies on the ground/ice. Flip all poles back into the transport position. Use extreme caution when flipping poles for transport position and make sure no part of the skin gets pinched, caught or stuck between any poles or in any pinch points. Fold excess skin inside sled when complete.

NOTE: *Use extreme caution so you don't rip or tear any portion of the skin, especially around the hinges or any pinch point areas.*

STANDARD ACCESSORIES

REMOVABLE GEAR TABLE

This gear table is designed to lock into the curled lip of the rear aluminum bench seat rail. It works just like the flip up seats, as you can flip the table up and access gear underneath. Most anglers will remove the center seat and put the table in so it is accessible to two anglers at once, however, the table can certainly be positioned anywhere along the bench seat rail, even to one end against the side of the shelter if desired. Simply remove one of the seats from the aluminum bench seat rail and replace it with the table. The table should always be removed during transport so it does not get damaged and so a travel cover accessory can snugly fit over the shelter for transport.

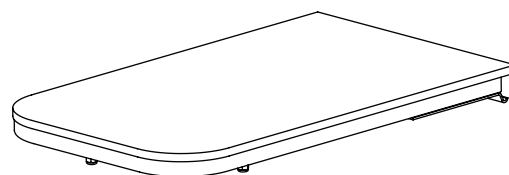

gear table

REMOVABLE ROD HOLDER

Depending on which model you have, your shelter has come standard with at least one rod holder assembly. This is designed to fit in the T-slot portion of the front aluminum bench seat rail. With the built-in plastic slides, the rod holder can easily be positioned anywhere along the bench seat rail. The round hole design allows you to set your rod and any position desired. By turning your rod in the hole and by sliding the assembly in the seat rail, you will be able to find your most desired position. Rod holder(s) should always be removed during transport so they do not get damaged and so a travel cover accessory can snugly fit over the shelter for transport. Simply unhook the plate from the mount. The mount can stay in the bench seat rail.



rod holder

STORAGE TRAY

The exclusive built-in storage tray runs the entire length of the bench seat so you have ample storage of rods, bait, beverages, the removable rod holders and more. Its left open for you to customize to your liking. If you want to add foam blocks, or partitions, it can easily be done yourself so you can customize it just the way you want. The durable design will protect your small gear from the large gear you may be storing in the ice shelter sled like buckets or ice augers.

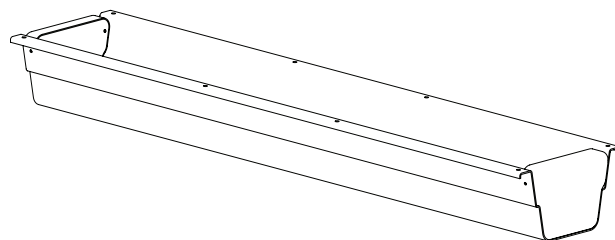

storage tray

LONG TERM STORAGE

- Always make sure your ice shelter is completely dry before storing for long periods of time. Storing your ice shelter when damp or wet may cause mold and mildew damage.
- Remove skin, padded seats and padded backrests from ice shelter sled and poles. Clean all salt, moisture and debris from your shelter skin.
- Store skin, padded seats and padded backrests in a cool, dry place away from rodents.
- Clean all salt, moisture and debris from the sled and poles of your shelter. Wipe down poles with WD-40 or similar types of silicon to deter from corrosion.

NOTE: Before attaching skin for use, re-wipe the poles to remove excess WD-40 or silicon substance to deter from damage to your skin.

- Store poles and sled in a cool, dry place.

ESKAPE 350 PARTS

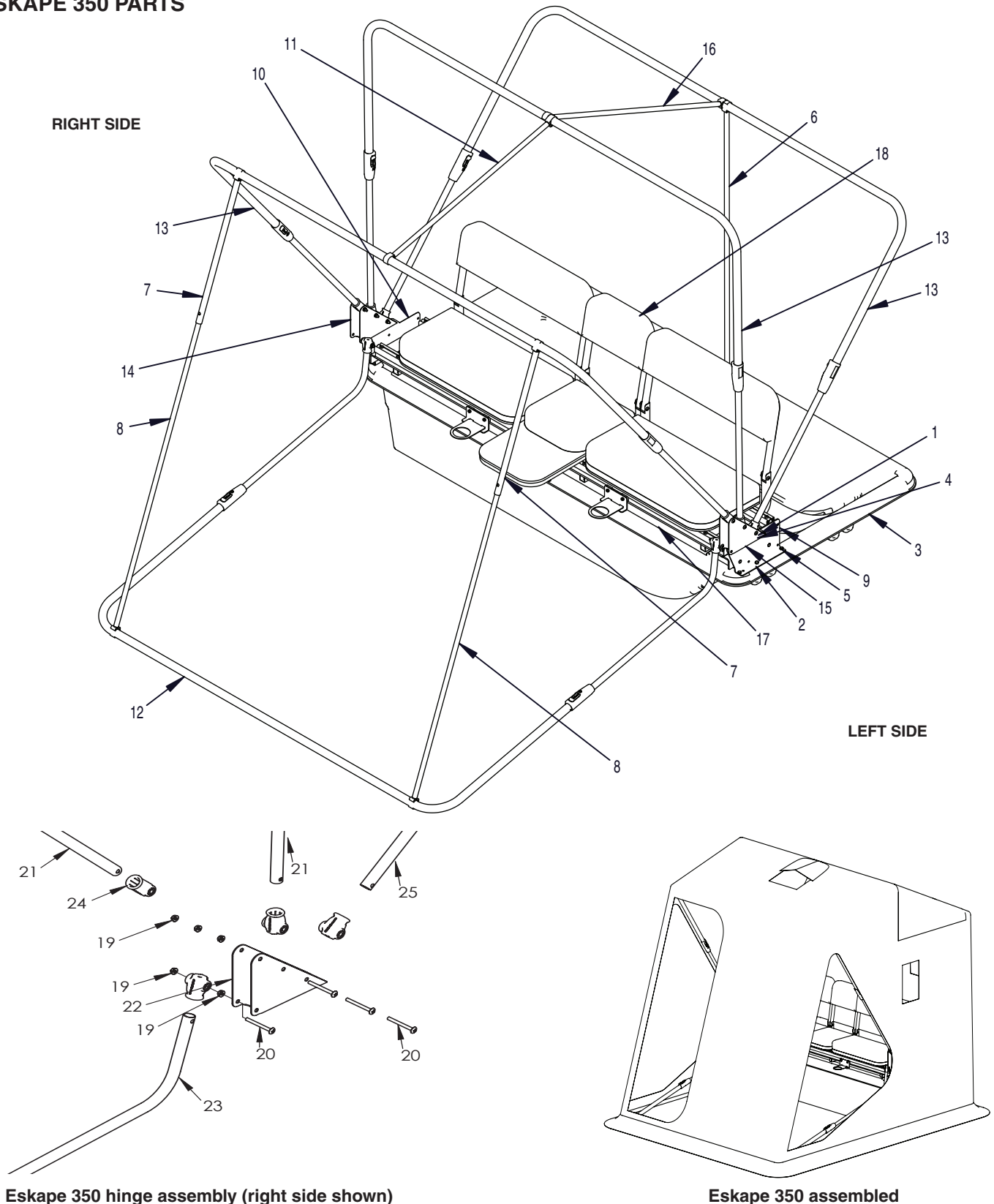

Eskape 350 hinge assembly (right side shown)

Eskape 350 assembled

Escape™ 350 Hardwater Series (69163)

PARTS LISTS

REF. NO.	DESCRIPTION	PART NO.	QTY.
1	BOLT, 1/4-20 X 3/4" HH GR5	8930	4
2	WASHER, 1/4"	48261B	6
3	SLED	67163	1
4	NUT, 1/4-20 HNYLK	67538	10
5	BOLT, 1/4-20 X 7/8 HHCS GR5	67541	6
6	POLE ASSEMBLY, SPREADER 46.60" (INCLUDES ONE .706" LARGE CLIP AND ONE .706" STUD)	68041	1
7	POLE ASSEMBLY, SPREADER FEMALE 22.16" (INCLUDES ONE .875" LARGE CLIP)	68046	2
8	POLE ASSEMBLY, SPREADER MALE 50.59" (INCLUDES ONE .706" LARGE CLIPS)	68048	2
9	RISER, LEFT HINGE	68052	1
10	RISER, RIGHT HINGE	68053	1
11	POLE ASSEMBLY, SPREADER 34" (INCLUDES TWO .706" LARGE CLIPS)	68087	1
12	POLE ASSEMBLY, BOTTOM CROSS BRACE	68132	1
13	POLE ASSEMBLY, TOP CROSS BRACE	68133	3
14	HINGE ASSEMBLY, RIGHT	68139	1
15	HINGE ASSEMBLY, LEFT	68140	1
16	POLE ASSEMBLY, SPREADER 38.75" (INCLUDES TWO .706" LARGE CLIPS)	68151	1
17	BOX, ROD HOLDER	68160	1
18	SEAT KIT	69293	1
19	NUT, 1/4-20 TOP LOCK FLANGED BLK	48752B	10
20	BOLT 1/4-20 X 2-1/2" PHILLIPS TRUSS HD	67430	8
21	POLE ASSEMBLY, UPRIGHT 28.75"	68029	4
22	HINGE, DOUBLE SIDED HOLE	68050	2
23	POLE ASSEMBLY, J-POLE 32.5"	68057	2
24	CAP, POCKET POLE HINGE	68060	8
25	POLE ASSEMBLY, REAR UPRIGHT 27.25"	68069	2
ITEMS BELOW NOT SHOWN			
-	CAP END, ROD HOLDER BOX	68156	2
-	SCREW, 10-32 X 1/4" PAN HD	68136	8
-	CLIP, LARGE .875"	68064	2
-	CLIP, LARGE .706"	68063	7
-	STUD, .706"	68309	1
-	TOW ROPE	67589	1
-	SCREW, #6 X 3/8" PHILLIPS TRUSS HD	69629	13
-	SHELTER SKIN, RED	68021	1
-	EDGE TRIM, 5/16" CUT TO 114"	69529	1
-	WINDOW REPLACEMENT, 8" X 12"	69531	2
-	WINDOW REPLACEMENT, 13.5" X 13.5"	69534	5
REPAIR PARTS			
-	PATCH KIT, RED	69742	-

ESKAPE 350 SEAT PARTS

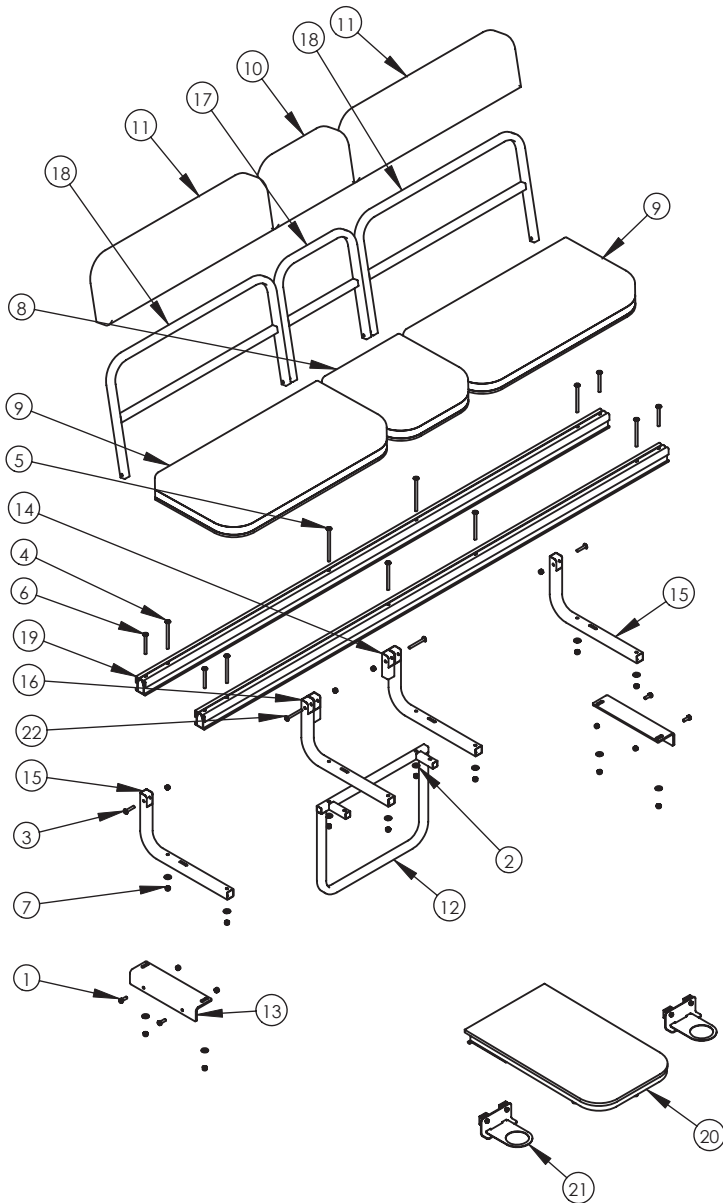

REF. NO.	DESCRIPTION	PART NO.	QTY.
1	BOLT 1/4-20 X 3/4" HH GR5	8930	4
2	WASHER 1/4"	48261	12
3	BOLT, 1/4-20 X 1-1/4" PTH GR2	67400	2
4	BOLT 1/4-20 X 3-1/2" PTH GR5	67402	6
5	BOLT 1/4-20 X 4-1/4" PTH GR5	67403	2
6	BOLT 1/4-20 X 2-1/2" PTH GR5	67430	4
7	NUT 1/4-20 HEX NYLOC	67538	20
8	SEAT ASSEMBLY, 12" RED	68004	1
9	SEAT ASSEMBLY, 25" RED	68006	2
10	BACKREST PAD, 12" RED	68008	1
11	BACKREST PAD, 25" RED	68009	2
12	SEAT BRACE WELDMENT	68026	1
13	BRACKET, SEAT MOUNT	68304	2
14	BRACKET, BACKREST LEFT	68310	1
15	FRAME, SEAT BOTTOM	68322	2
16	BRACKET, BACKREST RIGHT	68323	1
17	BACKREST WELDMENT, 12"	68345	1
18	BACKREST WELDMENT, 25"	68348	2
19	RAIL, BENCH SEAT	68351	2
20	TABLE	68447	1
21	ROD HOLDER ASSEMBLY	68449	2
22	BOLT 1/4-20 X 2-1/4" PTH GR5	69279	2

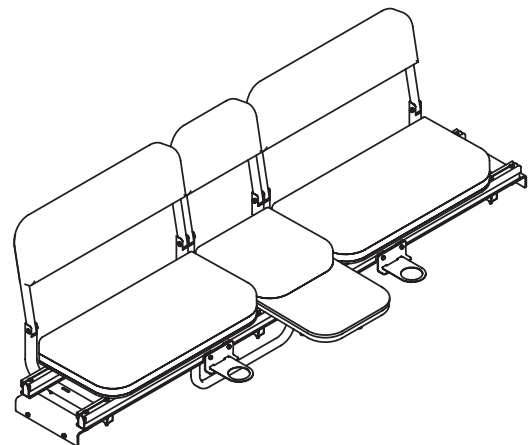

Frequently Asked Questions

- **How can I keep mice and other rodents from damaging my ice shelter?**

During the off season, you should always remove your ice shelter skin, padded seats and padded backrests from the sled and poles and make sure it is dry. Fold it up and store in a large plastic container with lid and store in a cool, dry place. The use of moth balls or dryer sheets may be helpful also.

- **My poles are noisy and don't run as smooth as they did originally. Is there a fix?**

Applying WD-40 or a similar type of silicon spray works well for lubricating the poles for easier operation and also deters from corrosion. You should do this maintenance at least seasonal, especially before storing for long term periods. Wipe off excess lubricant so it does not damage your ice shelter skin. Using a rod with a cloth attached to the end of it, apply the WD-40 or silicon lubricant to the rag and wipe the inside of the large poles so they have a lubricated surface for the hinge poles to slide on.

- **My zipper functions roughly or freezes up from snow/ice. How can I fix this?**

You can try a silicon spray to help lubricate it, or purchase an actual Zipper Lube brand lubricant found in many sporting goods stores, in the camping section. Either way, use with caution and wipe off excess lubricant so it does not damage your ice shelter skin.

- **For attaching the edge trim to my skin and sled, do I actually drill holes through the skin?**

Yes, this is the best way to make a seal between the skin and sled. It also keeps the edge trim securely in place and will not fall off during transport. If you remove the skin from the poles and sled during the off season, the skin will go back on the same way and you should be able to use the same holes for the screws as you did the previous season.

- **The edge trim is hard to put on the sled lip, is there a secret?**

You should apply the edge trim to the sled lip at room temperature which makes it more pliable. The use of a rubber mallet will help too.

- **Why are my windows turning cloudy when they get wet?**

Sometimes if your windows get extremely wet, the moisture can penetrate the windows which gives them a cloudy appearance. This can easily be remedied by removing the windows and bringing them into a warm environment (indoors) and letting the moisture retreat from the window which will clear them back up to the original appearance.

- **I have a tear in my skin, how do I repair it?**

You can call or e-mail us to purchase a patch kit which consists of a 12" x 12" piece of skin material and an adhesive to apply the patch to the tear area. This should be done at room temperature to assure proper adhesion. Allow at least 24 hours for the adhesive to set and assure proper adhesion.

- **My shelter lets some water come through it, how can I remedy that?**

You may purchase a seam sealer or silicon spray to help seal the seams to help repel water, such as Camp Dry which can be found in many sporting goods stores, in the camping section. Eskimo ice shelters are not water proof.

- **I can see small pin holes in my shelter skin, why?**

The coating on the inside of shelter skin is done to help darken the interior. The pin holes are either the coating wearing off the fabric from normal exposure to the elements or from normal wear and tear. This will not affect the performance of the ice shelter in any way and is normal.

- **I can see cracks on the inside of my shelter skin, why?**

This is also normal due to exposure to the elements and normal wear and tear. When you fold your shelter for transport, lines and creases develop in the fabric. This will not affect the performance of the ice shelter in any way.

- **Will my ice shelter leak from the small pin holes in skin?**

Many variables can come into play. It depends on the outside air temperature, the air temperature inside the shelter, how much heat you are using inside shelter, etc. Some leaking could occur due to condensation, but that is normal. This can be controlled better by using the numerous air vents, windows and doors that are on your shelter.

- **Do I have to have a tracking kit to tow my ice shelter?**

For high speed towing behind a snowmobile or ATV, we highly recommend you purchase a high speed tracking kit so you do not cause unnecessary or premature damage to your ice shelter sled. If you are only going to pull your ice shelter by hand, a high speed tracking kit is not necessary, but does make it easier to pull.

- **Can I wash my ice shelter skin?**

You can use a mild bleach and water solution to get rid of mold or mildew. If you just want to wash your skin, you can use a mild soap and water mixture. Do not machine wash your skin.

WARRANTY**ONE YEAR LIMITED WARRANTY**

Ardisam, Inc., a manufacturing company, warrants this Eskimo Ice Shelter to be free from defects in the material or workmanship for a period of one year from the date of purchase. During the one year warranty of this product, Ardisam will furnish 100% parts and labor to correct any defect caused by faulty material or workmanship. **The warranty does not cover cracked windows, tent tears, or bent poles due to high wind conditions or unattended use.** Warranty work must be sent directly to Ardisam, Inc. or to an authorized service center. **To obtain warranty service and/or replacement instructions, you must have prior approval before shipping package by calling our customer service department at 1-800-345-6007 for a return material authorization number (RMA#).** All items must be shipped prepaid. Ardisam, Inc. will at no charge, repair or replace, at their discretion, any defective part which falls under the conditions stated above. Ardisam retains the right to change models, specifications and price without notice. This product if used as intended, will give you years of trouble free service. We hope you will enjoy the quality of our products for years to come. **For replacement parts, phone 1-800-345-6007 or go online to GetEskimo.com.**

This warranty applies to the original owner with a proof of purchase and is not transferable. It supersedes all other warranties either expressed or implied and all other obligations to liabilities on our part. Ardisam, Inc. does not assume, and does not authorize any other person to assume for us, any liability in connection with the sale of our products. The warranty applies only to products which have not been subjected to negligent use, misuse, alteration, accident or repairs made by anyone not certified by Ardisam, Inc. This guarantee is void unless the warranty card is properly filled out and received by Ardisam, Inc., within 30 days of purchase.



Eskimo, A Division of Ardisam, Inc.
1360 First Avenue; P.O. Box 666
Cumberland, Wisconsin 54829
1-800-345-6007 · Fax (715) 822-4180
E-mail: info@ardisam.com

ACCESSORY CHART

ITEM #	DESCRIPTION	MSRP*
69117	High Speed Tracking Kit, Eskape 350	\$69.99
69173	Travel Cover, Eskape 350	\$64.99
69104	Tow Hitch, Eskape 350	\$46.99

* Prices shown do not include shipping & handling charges.

All prices are subject to change without notice. When ordering from manufacturer, there is a \$10.00 minimum order.

For replacement parts, phone 1-800-345-6007 or
go online to www.GetEskimo.com

Visit www.ardisam.com and discover more innovations
that will benefit you throughout the year.



Eskimo, Division of Ardisam, Inc.
1360 First Avenue; P.O. Box 666
Cumberland, Wisconsin 54829
1-800-345-6007 · Fax (715) 822-4180
E-mail: info@ardisam.com

