



Operator's Manual

WORK WAGON™

16 cu. ft. Poly Dump Cart

MODEL WW16P

Maximum Cu. Ft. Capacity
16 ft.³

Maximum Weight Capacity
1800 lb.

Maximum Dump Capacity
600 lb.

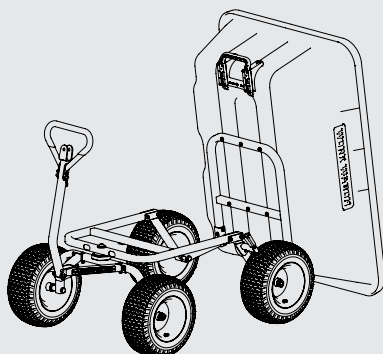
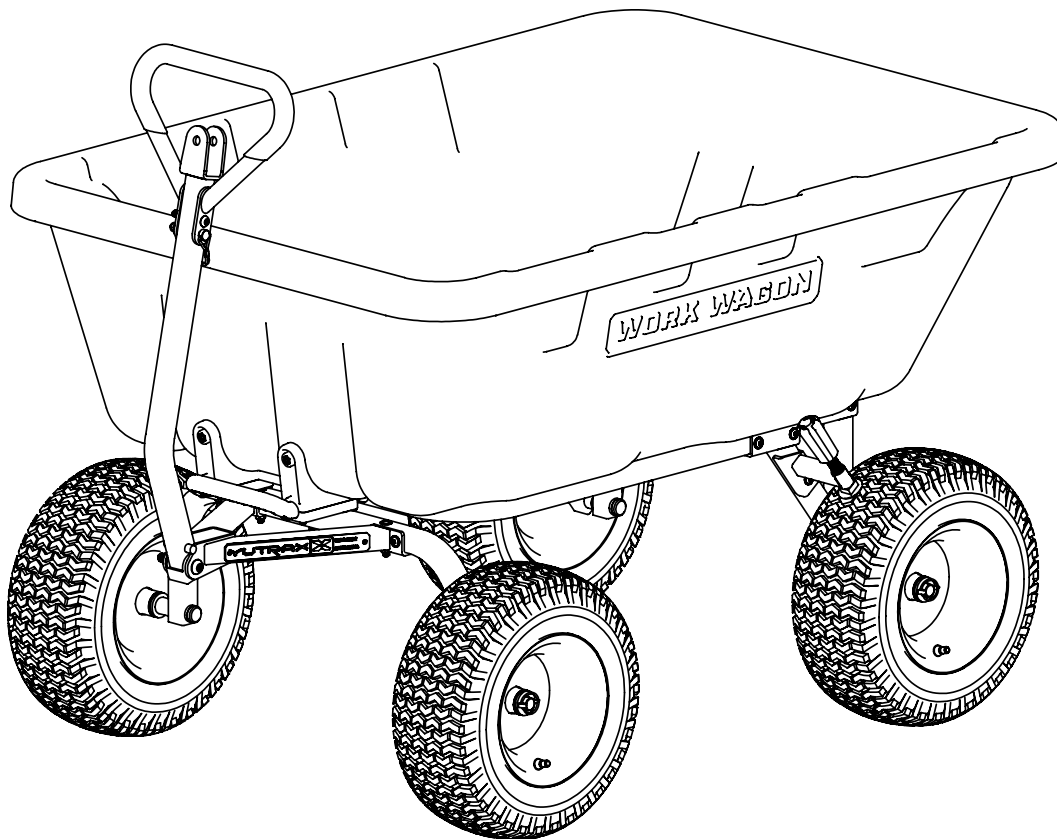

DUMP CONFIGURATION

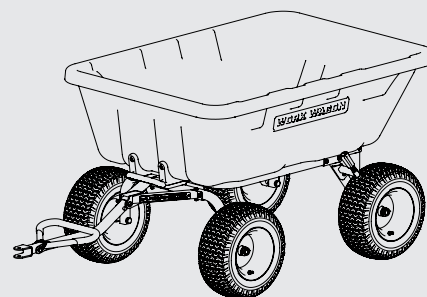

TOW CONFIGURATION

STOP

READ AND UNDERSTAND THE FOLLOWING WARNINGS BEFORE ASSEMBLY

MODEL WW16P

MAXIMUM WEIGHT CAPACITY - 1800 LB.

MAXIMUM DUMP CAPACITY - 600 LB.

WARNING

▲ READ, UNDERSTAND AND FOLLOW ALL ASSEMBLY, INSPECTION, MAINTENANCE & USE INSTRUCTIONS PROVIDED BEFORE EACH USE. FAILURE TO FOLLOW ALL WARNINGS AND INSTRUCTIONS COULD RESULT IN SERIOUS INJURY OR DEATH.

BE SURE TO FOLLOW ALL INSTRUCTIONS PROVIDED. IF ANY INSTRUCTIONS ARE NOT UNDERSTOOD OF IF YOU HAVE PART ISSUES CALL 800-345-6007 BEFORE USING.

DOUBLE CHECK ASSEMBLY STEPS TO BE CERTAIN YOU HAVE CORRECTLY ASSEMBLED THIS PRODUCT.

WARNING

- ▲ This product carries strict weight restrictions. **Do Not** use this product if you exceed the total weight limit.
- ▲ Stopping distance increases with speed and weight of towed load. Travel slowly and allow extra time and distance to stop.
- ▲ Total towed weight must not exceed limits specified in towing vehicle operator's manual.

WARNING

- ▲ **Always** use as an ATV trailer/cart only.
- ▲ **Never** tow behind vehicle on a highway. For off-road use only!
- ▲ **Always** follow the manufacturer's recommendations for weight limits for towed equipment and towing on slopes. Excessive towed load can cause loss of traction and loss control on slopes. Reduce towed weight when operating on slopes.
- ▲ **Never** shift to neutral and coast downhill.
- ▲ **Never** drive in excess of 10 MPH while using this product.
- ▲ **Always** use only approved hitches. Tow only with a machine that has a hitch designed for towing. Do not attach towed equipment except at the approved hitch point.
- ▲ **Never** turn sharply. Use additional caution when turning or operating under adverse surface conditions. Use care when reversing.
- ▲ **Always** inspect before each & every use to be sure there is no product damage or loose/missing bolts or hardware. Over time, nuts and bolts may become loose from vibration.
- ▲ **Be sure** to always have the correct amount of air pressure in tires. This will help deter from unnecessary wear and/or damage. Operating tire pressure should be set to 10 PSI.
- ▲ **Always** be sure lock pins are latched to prevent accidental removal.
- ▲ **Never** use a damaged ATV trailer/cart.
- ▲ **Always** keep bystanders away when you operate a towed attachment.
- ▲ **Always** before you back machine and attachment, look carefully behind attachment for bystanders.
- ▲ **Never** allow people or animals to ride in the ATV trailer/cart! It is not designed for that matter.
- ▲ **Never** use when intoxicated or using over-the-counter medication or prescription drugs.
- ▲ **Never** use carelessly – Think Safety!
- ▲ **Always** engage parking brake on hilly terrain or while dumping loads to avoid cart from rolling away or causing unnecessary injury to you, bystanders, etc. Be sure to disengage parking brake before moving trailer/cart.

TOOLS FOR ASSEMBLY (NOT INCLUDED)

HEX KEYS	WRENCHES	OTHER
SAE 3/16 HEX KEY	SAE 1/2 WRENCH	RUBBER MALLET <i>(Optional)</i>
SAE 7/32 HEX KEY	SAE 9/16 WRENCH	
SAE 5/16 HEX KEY	SAE 3/4 WRENCH	
SAE 7/16 HEX KEY	SAE 1-1/16 WRENCH	
	AN ADJUSTABLE WRENCH CAN REPLACE ANY OF THE FOUR WRENCHES LISTED ABOVE	

PARTS LIST

ITEM #	PART #	DESCRIPTION	QTY.
1	43466	BED	1
2	43472	TONGUE BRACKET	1
3	43476	FRAME - FRONT	1
4	43479	FRAME - TOP	1
5	43482	FRAME - REAR OUTER LH	1
6	43484	FRAME - REAR OUTER RH	1
7	43486	BED FRAME	1
8	43488	FRAME - REAR INNER	2
9	43491	TONGUE	1
10	43496	PULL HANDLE	1
11	43520	SPINDLE 161.5MM	2
12	43521	SPINDLE 214MM	2
13	43524	BOLT 3/8 X 2-1/2 IN	1
14	43525	BOLT 1/2 X 3 IN	1
15	43528	NUT 5/16 IN	21
16	43530	NUT 3/8 IN	1
17	43531	NUT 1/2 IN	1
18	43541	WASHER 1-1/2 IN	8
19	43542	LINCH PIN 3/16 X 1-1/4 IN	4
20	43543	CLEVIS PIN 1/2 X 2-1/2 IN	1
21	43548	TONGUE END CAP	1
22	43553	DUMP RELEASE	1
23	43582	PARKING BRAKE	1
24	43627	TIRE	4
25	45495	HEXAGON SPACER	1
26	45674	BOLT 5/16 X 2 IN	21
27	45675	BOLT 5/16 X 1 IN	3
28	45680	BOLT 3/4 X 4-3/4 IN	1
29	45830	NUT 3/4 IN	1

STEP 1

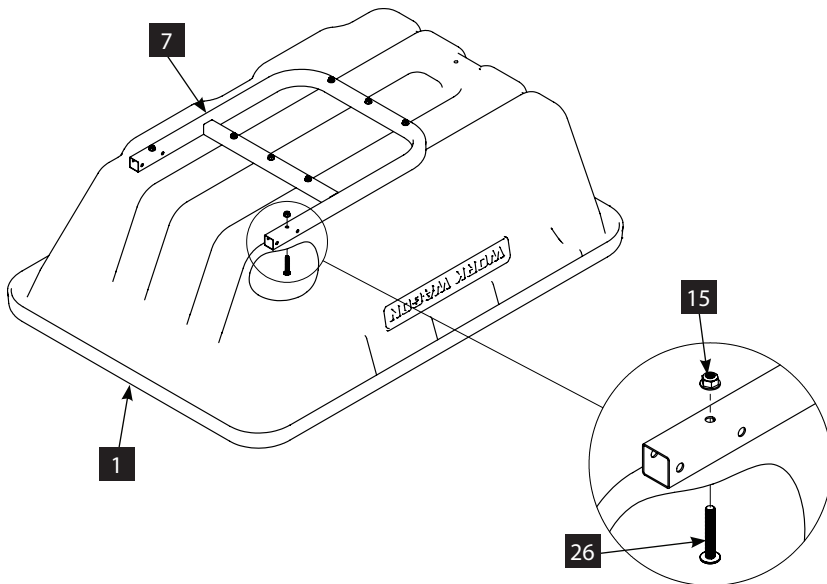

1. Attach (7) to (1) with eight (26) and eight (15).

*bed hidden
for clarity*

STEP 2

2. Attach two (8) to (7) with four (26) and four (15).

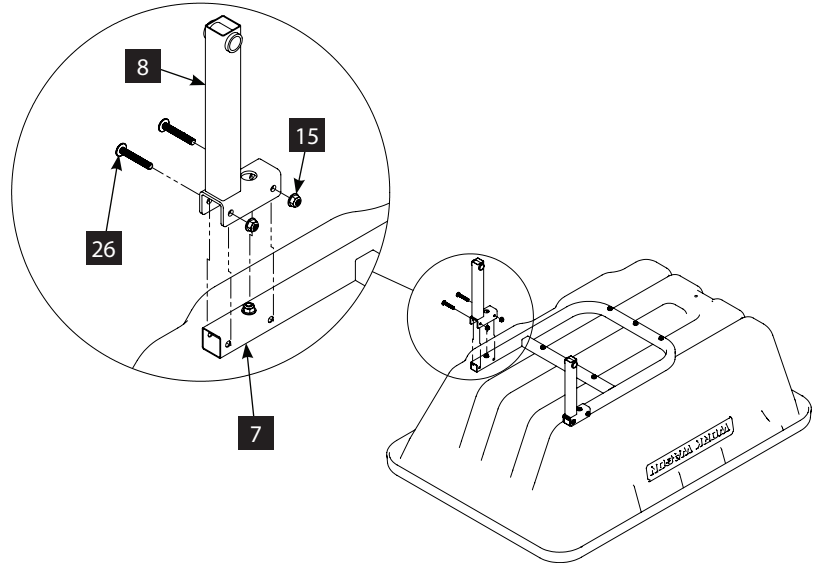

STEP 3

3. Attach (6) to (4) with two (26) and two (15). Attach (5) to (4) with two (26) and two (15).

NOTE: The longest round tubing portion of (6) and (5) should be to the outside of the assembly.

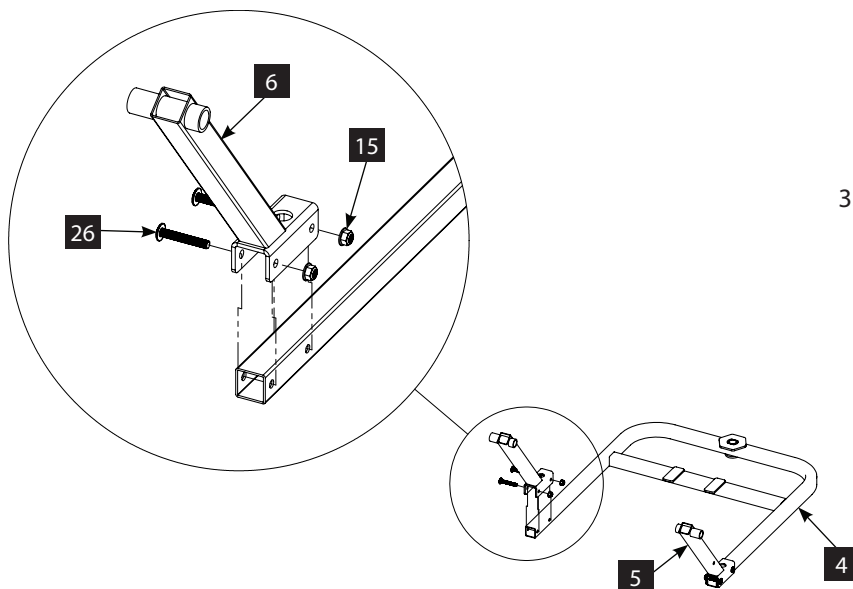

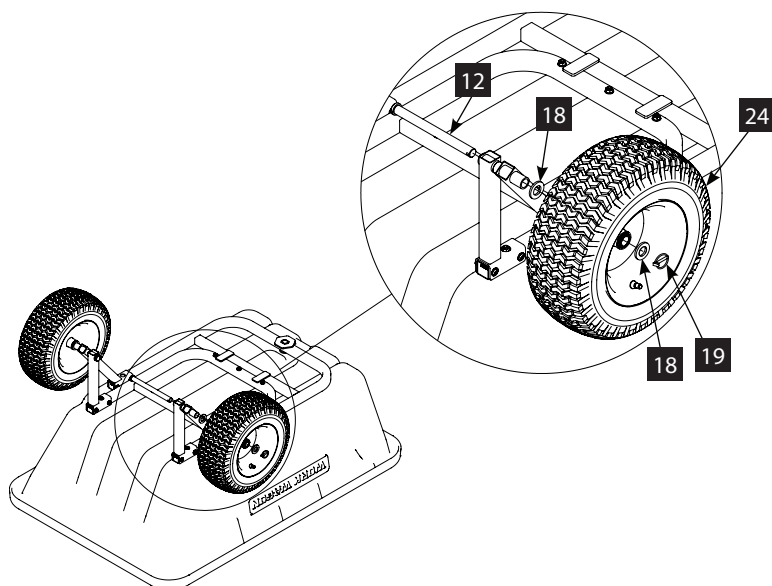

4. Place the assembly of **STEP 3** onto the assembly of **STEP 2**. Slide one (12) through the round tubing of both frame sections, one (18), one (24), and another (18). Retain everything in place by installing one (19) into the hole at the end of (12). Repeat on the opposite side.

*If one spindle goes in easy and the other is giving resistance, back out the first spindle and install both spindles simultaneously by tapping each one in a little at a time with a hammer or mallet.

STEP 4

STEP 5

5. Attach (2) to (3) with four (26) and four (15).

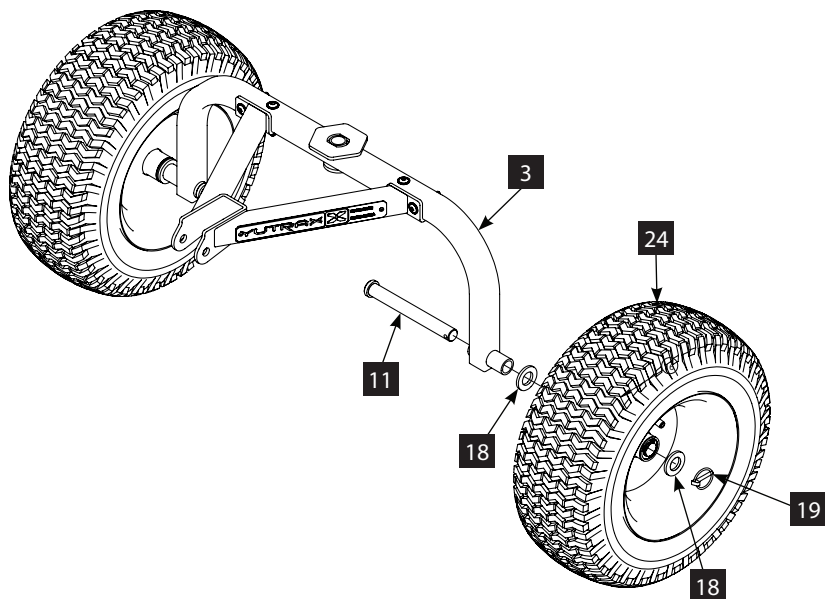
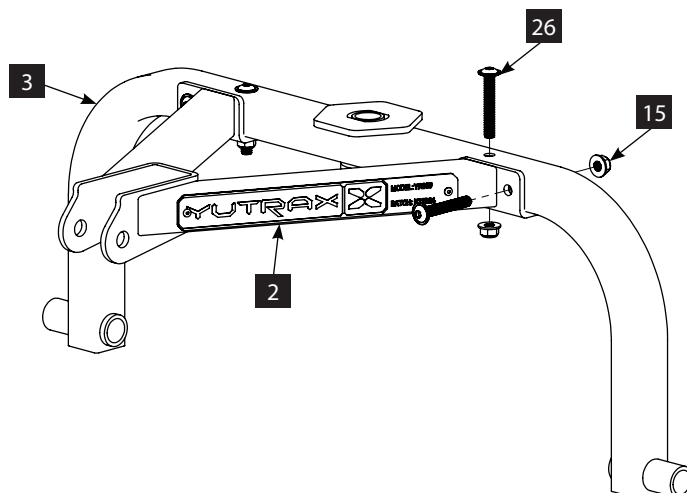

6. Slide one (11) through the round tubing of (3), one (18), one (24), and another (18). Retain everything in place by installing one (19) into the hole at the end of (11). Repeat on the opposite side.

STEP 6

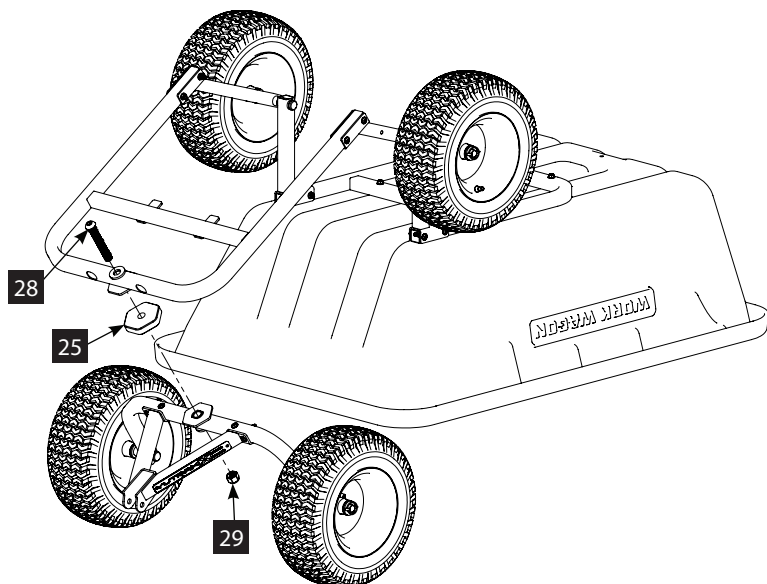

7. Feed (28) through the top of **STEP 4** Assembly, through (25), through **STEP 6** Assembly, and then fix it to (29).

NOTE: Tighten bolt and nut until any excessive play is eliminated but the two assemblies can pivot freely.

8. Install (21) onto the end of (9). Align the holes of (21), (9), and (2). Fasten the assembly together with (14) and (17). Assemble (10) at the middle hole of (9) with (13) and (16). (10) can be rotated into either the hand pulling or towing configuration and then locked into place with (20).

NOTE: Tighten both bolts and nuts until any excessive play is eliminated but the two assemblies can pivot freely.

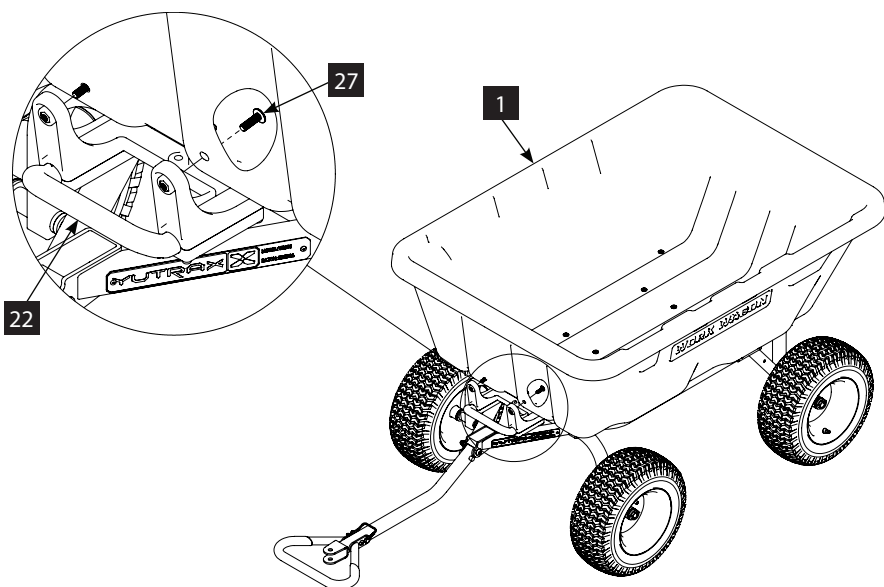
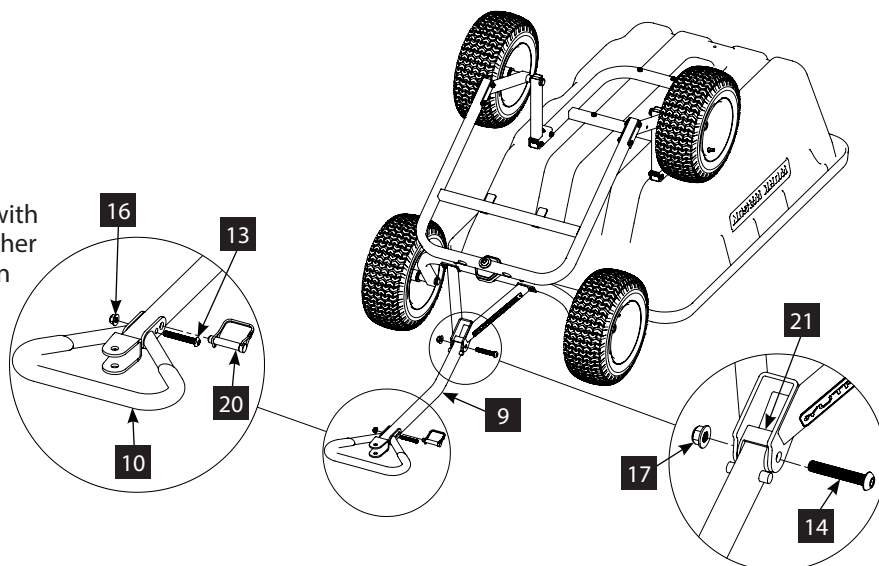

9. Flip (1) 180-degrees onto the frame. Assemble (22) onto (1) with three (27).

10. Attach (5) to the rear of the frame and between the tire and bed with one (26) and one (15). (23) is a parking brake that is disengaged by rotating the knob counterclockwise and engaged by rotating clockwise into the tire.

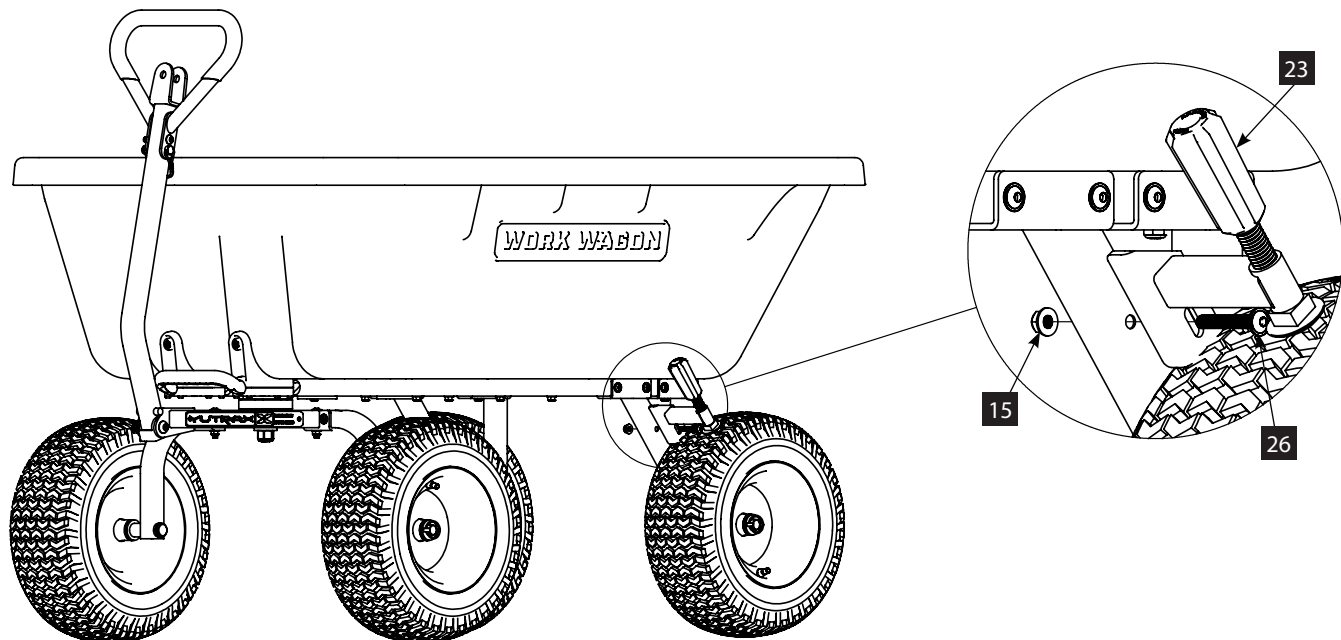

STEP 10

WARRANTY

YUTRAX®, a division of Ardisam Incorporated, offers a one year limited warranty to be free from defects in materials and workmanship for the service life of the product, not to exceed twelve consecutive months from the date of purchase. This warranty applies to the original owner with a proof of purchase and is not transferable. This warranty applies only to products which have not been subjected to negligent use, misuse, alteration, accident or if repairs have been made by anyone outside our factory. This warranty supersedes all other warranties either expressed or implied and all other obligations or liabilities on our part. Ardisam, Inc., does not assume, and does not authorize any other person to assume for us, any liability in connection with the sale of our products. Warranty work must be sent directly to Ardisam, Inc. or one of our authorized service centers and performed by them.

To obtain warranty service and/or replacement instructions, you must have prior approval from Ardisam, Inc. before shipping your package to us by calling our customer service department at 800-345-6007 M-F or by writing to: Ardisam, Inc., 1730 Industrial Avenue, Cumberland, WI 54829 for a return material authorization number (RMA#). All items must be shipped prepaid. Ardisam, Inc. will at no charge, repair or replace, at their discretion, any defective part which falls under the conditions stated above. Ardisam retains the right to change models, specifications and price without notice.



YUTRAX®, A Division of Ardisam, Inc.
1730 Industrial Avenue,
Cumberland, WI 54829

Phone: 800-345-6007
www.yutrax.com

All weights, specifications and features are approximate and are subject to change without notice. Due to continuous product improvement, product images may not be exact. Warning labels in some product images may have been removed for photography or demonstration purposes only. Props shown in photos not included. Some assembly may be required. Refer to product manual/instructions for safe setup and use.