



Instruction Sheet
Stand & Tray
for 5-Ton Log Splitter

Model #: 32230
Control #'s: 32234 *

Fiche d'instructions
Piètement et plateau
pour fendeuse de bûches 5 tonnes

Modèle n° : 32230
N° de contrôle : 32234 *

Hoja de instrucciones
Soporte y bandeja
para partidor de leña de 5 toneladas

N.º de modelo: 32230
N.º de control: 32234 *

ENGLISH

FRANÇAIS

ESPAÑOL

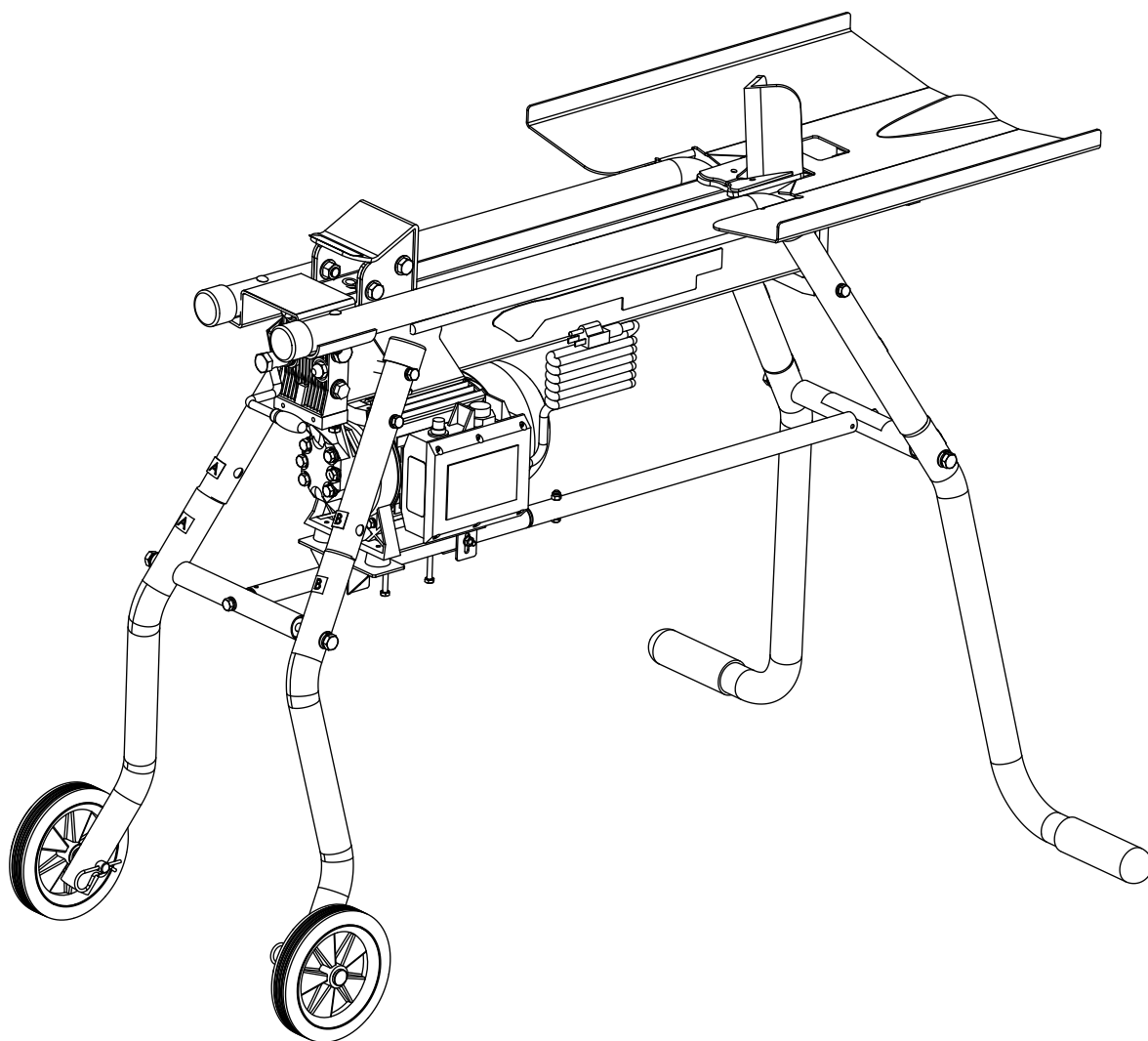

Get parts or technical assistance online at
www.getearthquake.com or call (800) 345-6007
Pièces détachées et assistance technique en ligne à
www.getearthquake.com ou composer le (800) 345-6007
Obtenga piezas o asistencia técnica en línea en
www.getearthquake.com o llame al (800) 345-6007

© 2023 Ardisam
All Rights Reserved
Tous droits réservés
Todos los derechos reservados

P/N: 34098-REV4:
08/02/2023
Réf. : 34098-REV4:
08/02/2023
N.º/P: 34098-MOD4:
08/02/2023
ECN: 14179

- * The first six digits of the product's serial number are the control number.
- * Les six premiers chiffres du numéro de série du produit correspondent au numéro de contrôle.
- * Los primeros seis dígitos del número de serie del producto son el número de control.

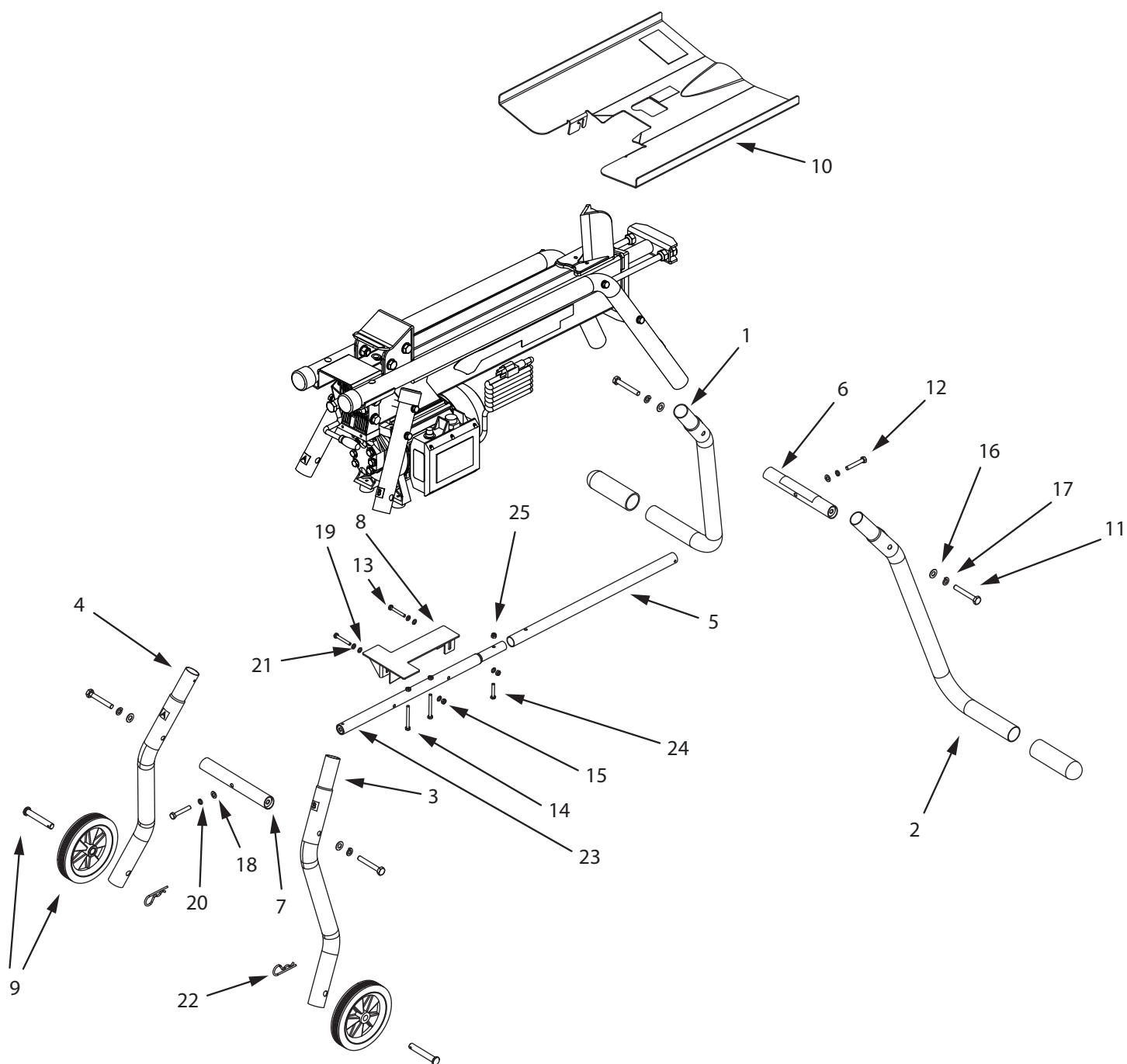

ITEM NO.	PART NO.	DESCRIPTION	QTY
1	34196	W500 STAND REAR LEFT LEG WITH DECAL	1
2	34197	W500 STAND REAR RIGHT LEG WITH DECAL	1
3	34199	W500 STAND FRONT RIGHT LEG WITH DECAL	1
4	34198	W500 STAND FRONT LEFT LEG WITH DECAL	1
5	33777	WELDMENT TUBE 25.1.5X513.2 MM W/ SPACER	1
6	33734	WELDMENT W500 STAND LEG CONNECTION ROD	1
7	33734	WELDMENT W500 STAND LEG CONNECTION ROD	1
8	33735	WELDMENT MOTOR SUPPORT W500 STAND	1
9	33669	WHEEL AXLE ASSY W500	1
10	34203	W500 LOG TRAY WITH DECAL	1
11	W1265V0902	BOLT M10X1.5X70 MM HHCS GR8.8 ZN P-T	4
12	21718	BOLT M8X1.25X50 MM HHCS GR8.8 ZN F-T	2
13	33742	BOLT M6X1.0X45 MM HHCS GR8.8 ZN F-T	2
14	331059	BOLT M6X1.0X60 MM HH GR8.8 ZN F-T	2
15	31948	NUT M6X1X4.2 MM H GR8.8 ZN	2
16	W1200126	WASHER M10X21.25X1.33 MM GR8.8 ZN	4
17	W1200119	WASHER M10X18.1X2 MM SPRLK ZN	4
18	20143	WASHER M8X16X1.5 MM GR8.8 ZN	2
19	W1200117	WASHER M6X12X1.00 MM GR8.8 ZN	4
20	32569	WASHER M8X1.25X2.1 MM SPRLK GR8.8 ZN	2
21	W1200116	WASHER M6X11.8X1.5 MM SPRLK GR8.8 ZN	2
22	46134	HAIRPIN 0.148 DIA X 0.75 SHAFT OD	2
23	34778	WELDMENT TUBE 25.1.5X513.2 MM SWEDGE END W/ SPACER	1
24	18104	BOLT M6X1.0X35 MM HHCS GR8.8 ZN F-T	1
25	W1265V0913	NUT M6X1.0X8 MM HNYLK CL8 ZN	1

Installation of Stand:

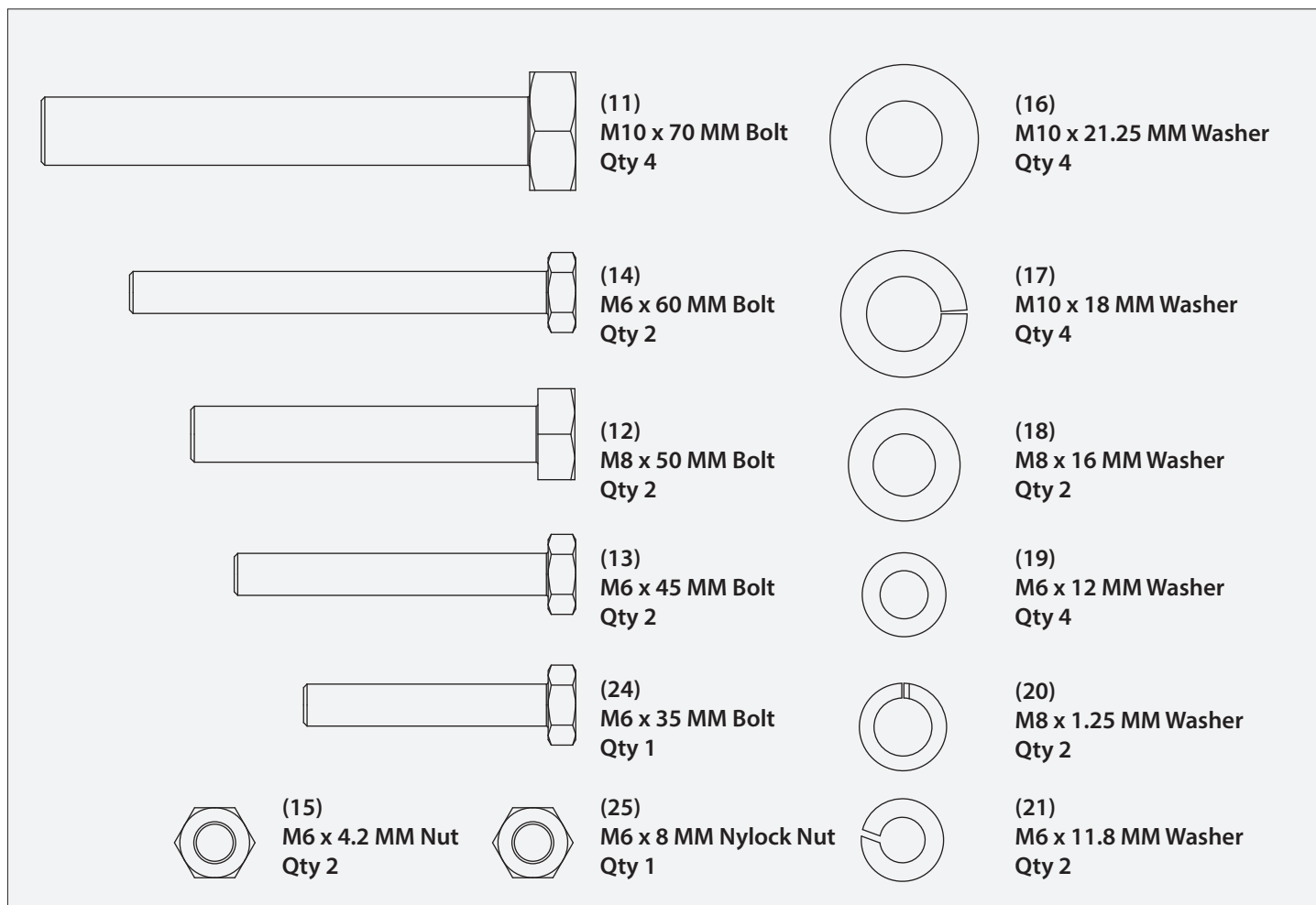

Open the hardware bag and identify all the hardware as shown above.

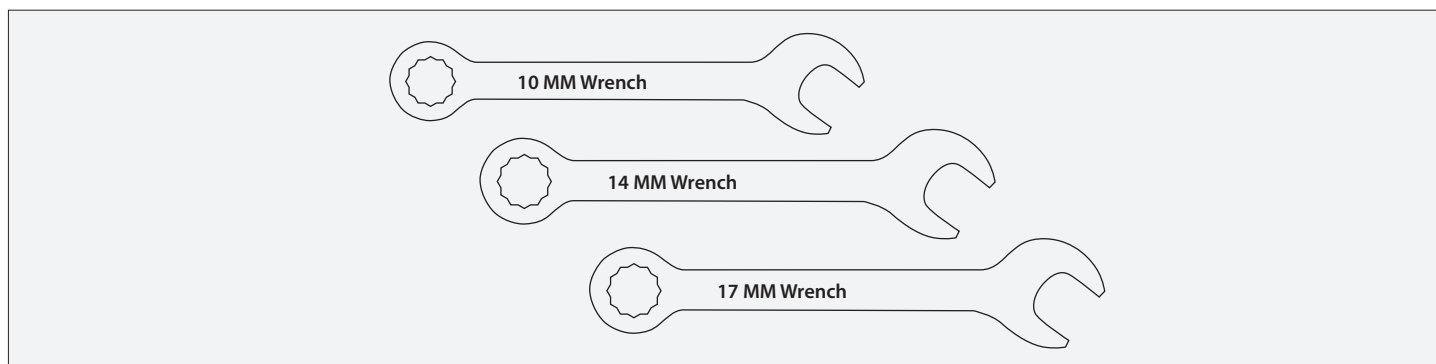

Wrench sizes needed: 10mm, 14mm, 17mm

- 1** Lift the log splitter from the wedge end and insert the rear legs **(1 & 2)** making sure the letters on the decals match and the decals align as in **figures 2 and 3**.

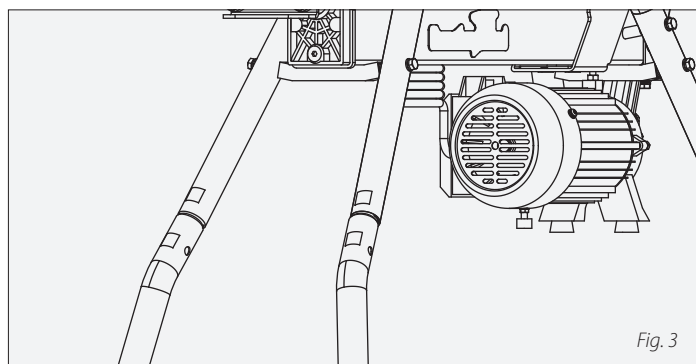
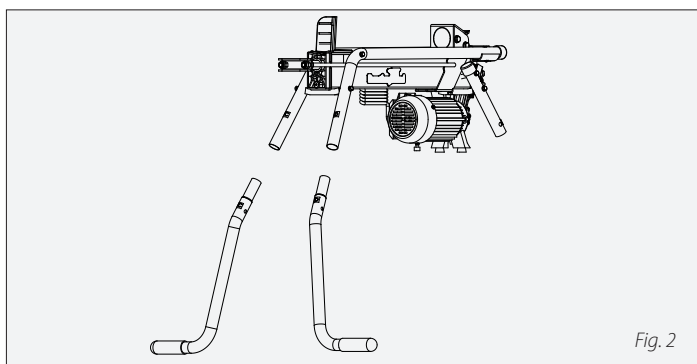

- 2** Using two of the M10 bolts **(11)**, M10 flat washer **(16)** and M10 spring lock washer **(17)**, install the cross beam **(6)** between the rear legs **(1 & 2)**. The hardware should be loose installed. Cross beam **(6)** is identified by the decal referencing a lifting location for the log splitter for transport.

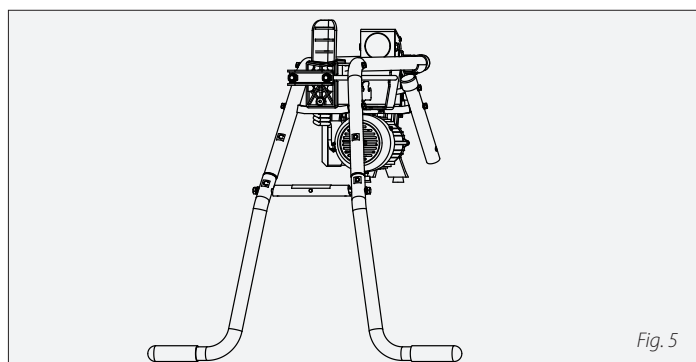
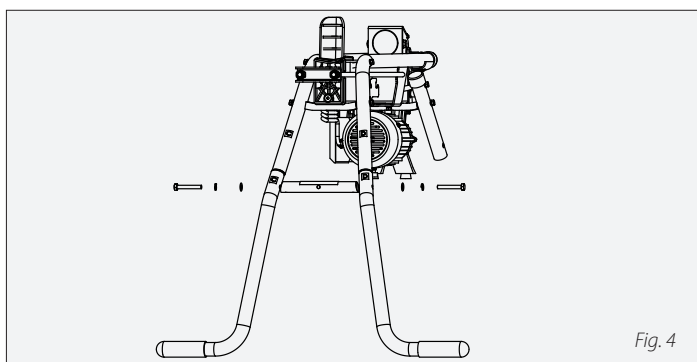

- 3** Lift the pump end and insert the front legs **(3 & 4)** making sure the decals are aligned.

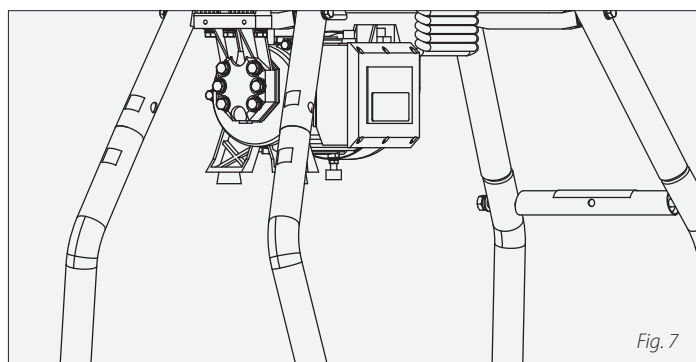
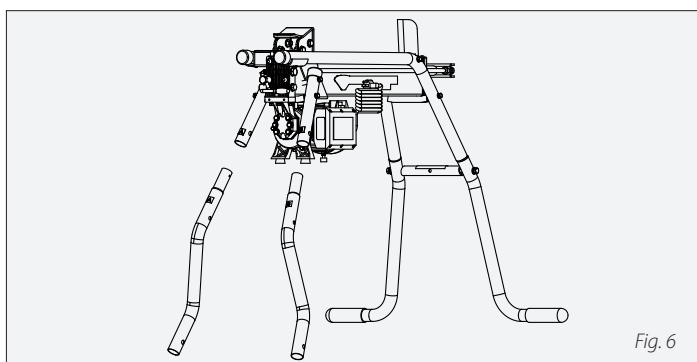

4

Using two of the M10 bolts (11), M10 flat washers (16) and M10 spring lock washer (17), install the cross beam (7) between the front legs (3 & 4). The hardware should be loose installed.

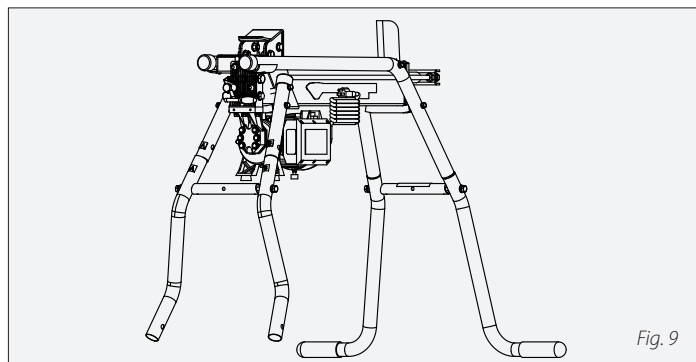
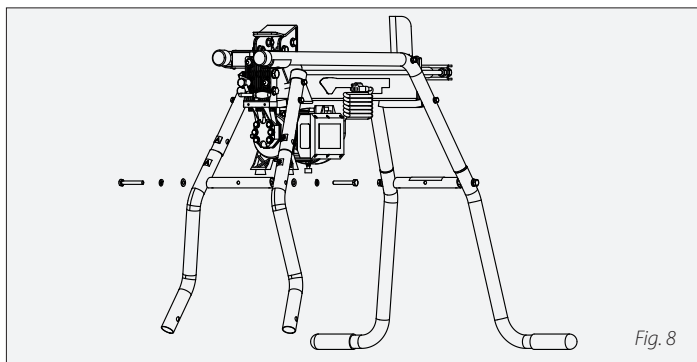

5

After installing legs look at the unit from a side view. It should look similar to **figure 10**.

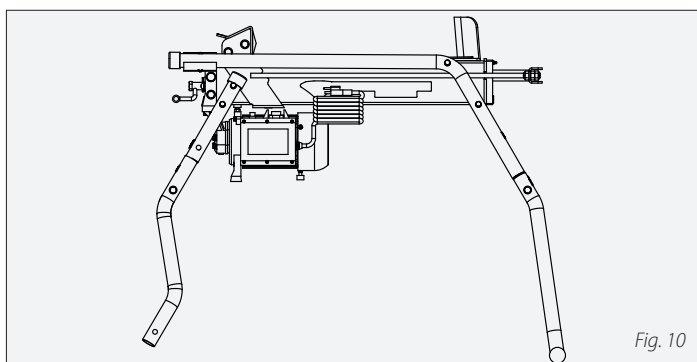

6

Using M6 bolts (14, 24) and M6 nut (25), fasten to central rods (5 & 23) as shown in **figure 11**. At this stage the bolts should not be protruding out of the weld nuts, as shown in **figure 12**.

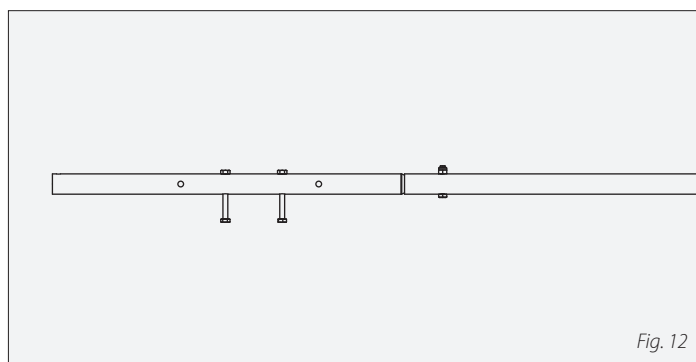
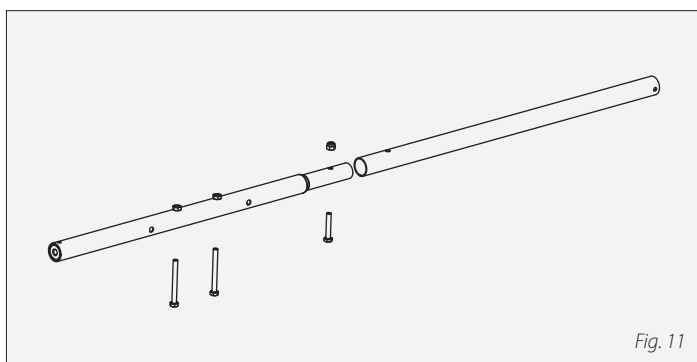

7

Attach the motor support (8) to the central rod (5) using M6 bolt (13), M6 flat washer (19), M6 spring lock washer (21), and M6 nut (15), as shown in **figures 13** and **14**. The hardware must be fastened such that the height of the motor support can be adjusted at a later stage.

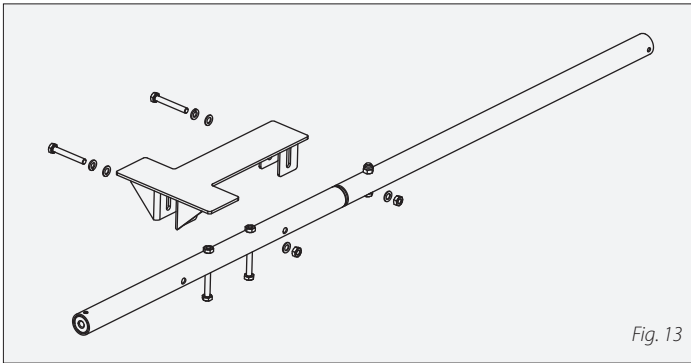

Fig. 13

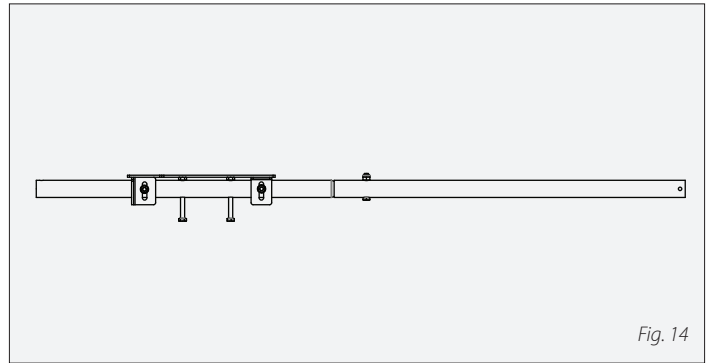

Fig. 14

8

Install the central rod (5 & 23) to the cross beams (6 & 7) using the M8 bolts (12), M8 flat washer (18) and M8 spring lock washer (20).

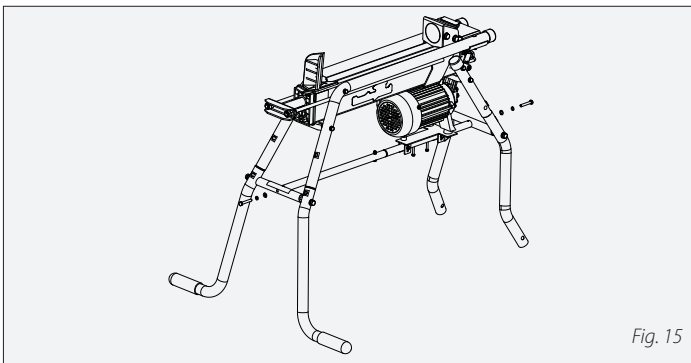

Fig. 15

9

After attaching the central rod to the legs, all hardware shall be tightened using appropriate size wrenches. See **figure 16**. The height of the motor support bracket (8) must now be adjusted, such that the motor rests on the upper motor support. See **figure 17**.

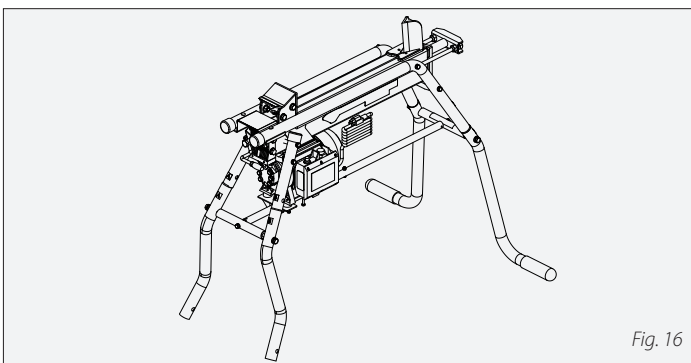

Fig. 16

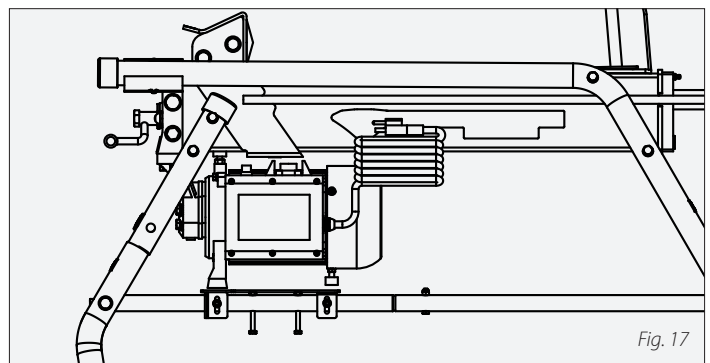
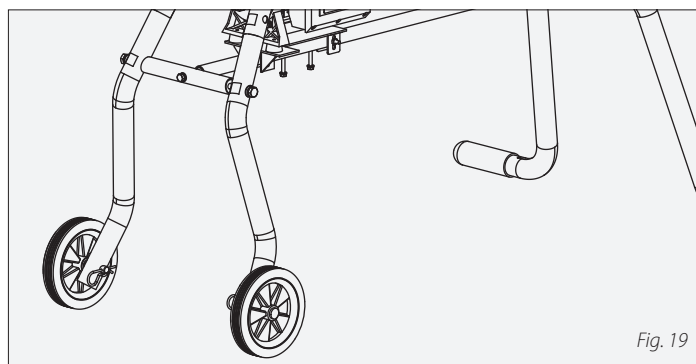
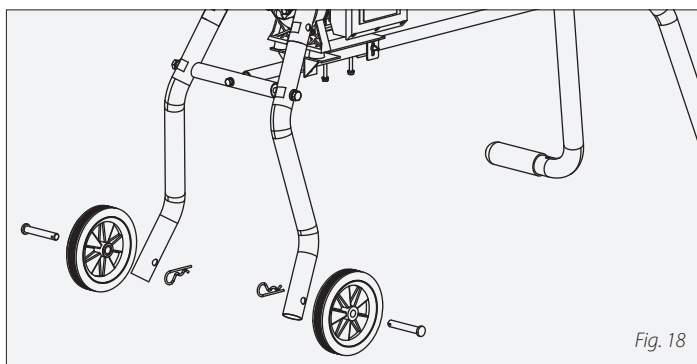

Fig. 17

10

Install the wheels using the pre-assembled wheel and axle **(9)** and hairpin **(22)**. Refer to **figures 18** and **19**.



Log Tray Assembly Instructions:

1

Using a 14mm wrench, loosen the bolts shown in **figure 1**.

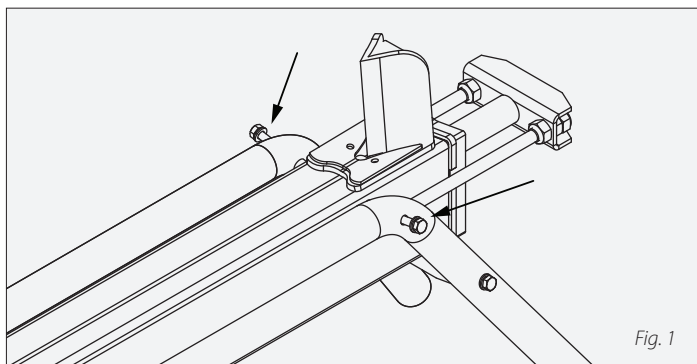

2

There should be about a 1/2" space between the head of the bolt and the leg. Refer to **figure 2**.

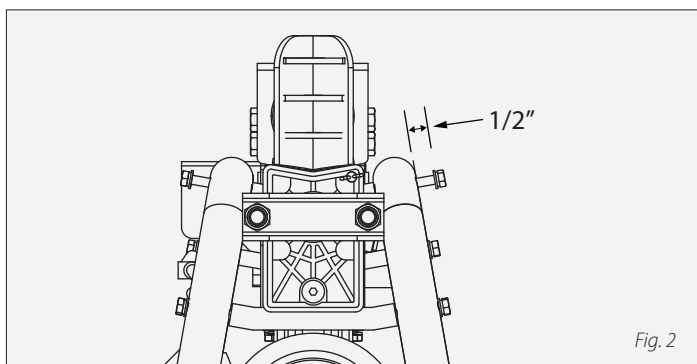

3

Drop down the tray as shown in **figure 3** such that the bolt slides through the slot on the bent tabs of the tray. Refer to **figures 3** and **4**.

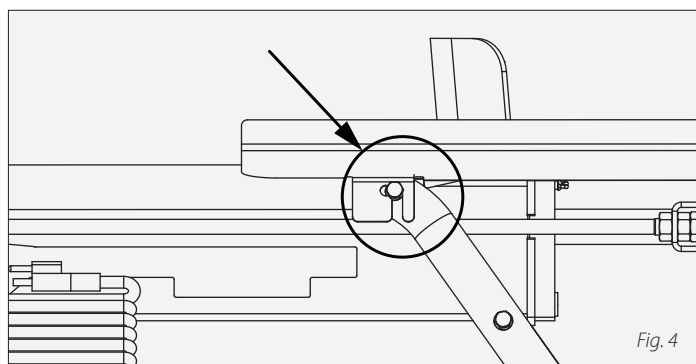
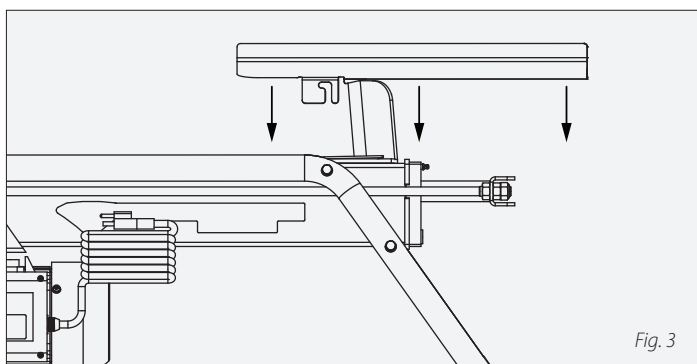

4

Pull back the tray away from the push block so that the bolts bottom out in the end of the slot. Tighten the bolt using the 14mm wrench.

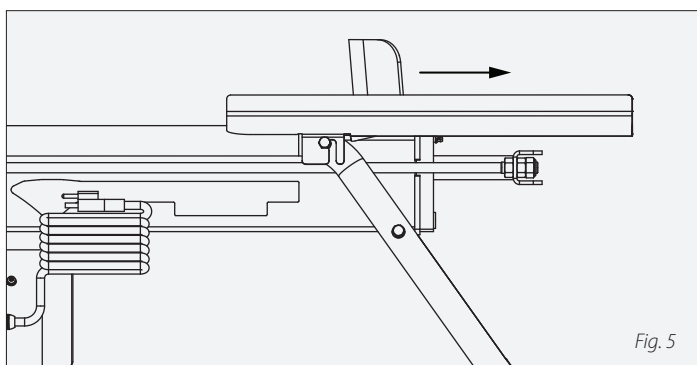



NOTES:

20 horizontal lines for notes.

[illegible]

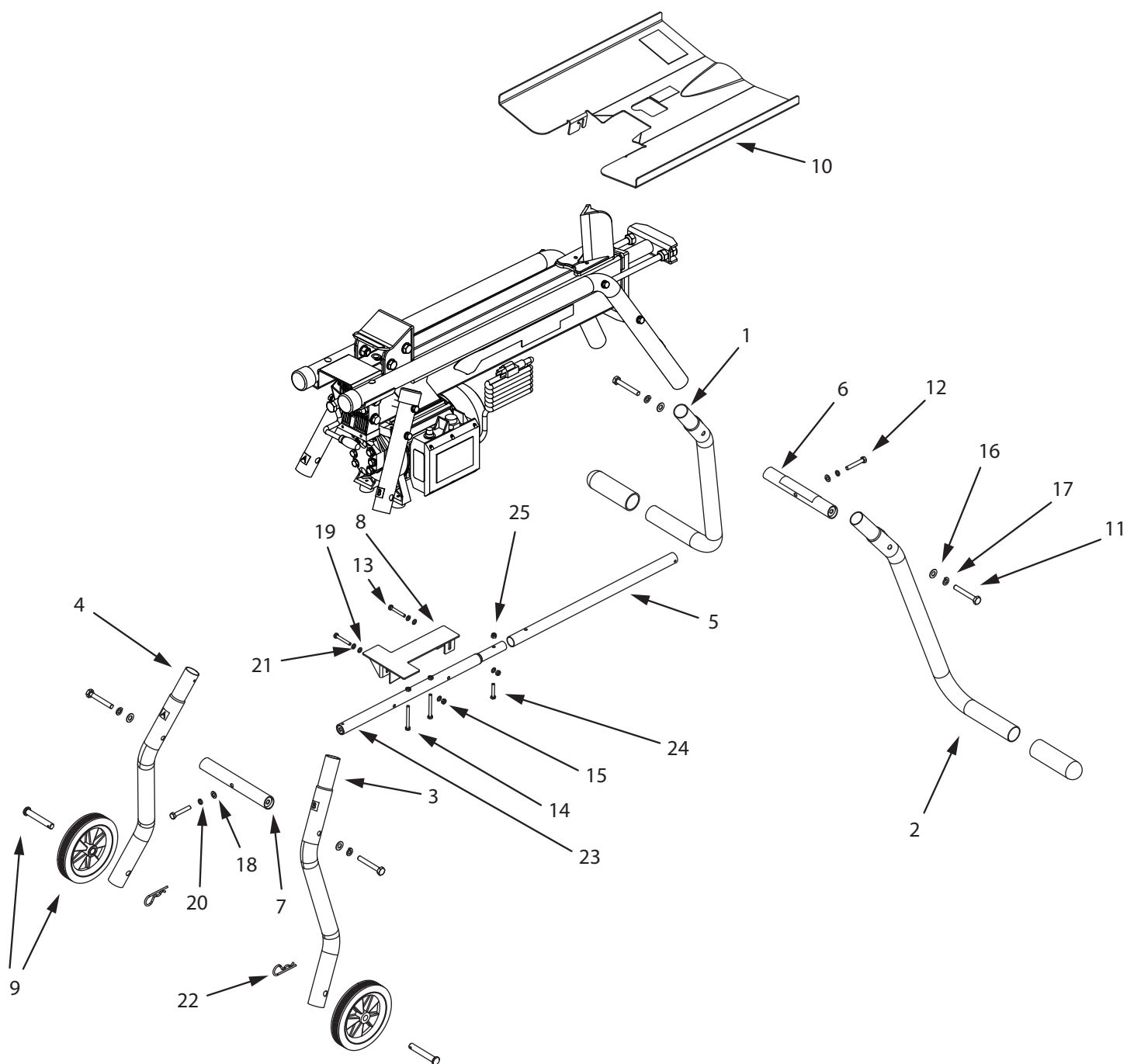

REPÈRE	N° RÉF.	DESCRIPTION	QTÉ
1	34196	PIED ARRIÈRE GAUCHE DU PIÈTEMENT W500 AVEC AUTOCOLLANT	1
2	34197	PIED ARRIÈRE DROIT DU PIÈTEMENT W500 AVEC AUTOCOLLANT	1
3	34199	PIED AVANT DROIT DU PIÈTEMENT W500 AVEC AUTOCOLLANT	1
4	34198	PIED AVANT GAUCHE DU PIÈTEMENT W500 AVEC AUTOCOLLANT	1
5	34777	WELDMENT TUBE 25.1.5X513.2 MM W/ SPACER	1
6	33734	BARRE DE RACCORDEMENT DE PIEDS DU PIÈTEMENT W500	1
7	33734	BARRE DE RACCORDEMENT DE PIEDS DU PIÈTEMENT W500	1
8	33735	SUPPORT MOTEUR MÉCANOSOUDE DU PIÈTEMENT W500	1
9	33669	ENSEMBLE ROUE ET AXE W500	1
10	34203	PLATEAU À BÛCHE DU W500 AVEC AUTOCOLLANT	1
11	W1265V0902	VIS M10X1,5X70 MM HHCS GR8.8 ZN P-T	4
12	21718	VIS M8X1,25X50 MM HHCS GR8.8 ZN F-T	2
13	33742	VIS M6X1,0X45 MM HHCS GR8.8 ZN F-T	2
14	331059	VIS M6X1,0X60 MM HH GR8.8 ZN F-T	2
15	31948	ÉCROU M6X1X4,2 MM H GR8.8 ZN	2
16	W1200126	RONDELLE M10X21,25X1,33 MM GR8.8 ZN	4
17	W1200119	RONDELLE M10X18,1X2 MM SPRLK ZN	4
18	20143	RONDELLE M8X16X1,5 MM GR8.8 ZN	2
19	W1200117	RONDELLE M6X12X1,00 MM GR8.8 ZN	4
20	32569	RONDELLE M8X1,25X2,1 MM SPRLK GR8.8 ZN	2
21	W1200116	RONDELLE M6X11,8X1,5 MM SPRLK GR8.8 ZN	2
22	46134	GOUPILLE EN ÉPINGLE 0,148 DIA. X 0,75 D.E. ARBRE	2
23	34778	WELDMENT TUBE 25.1.5X513.2 MM SWEDGE END W/ SPACER	1
24	18104	BOLT M6X1.0X35 MM HHCS GR8.8 ZN F-T	1
25	W1265V0913	NUT M6X1.0X8 MM HNYLK CL8 ZN	1

Montage du piètement :

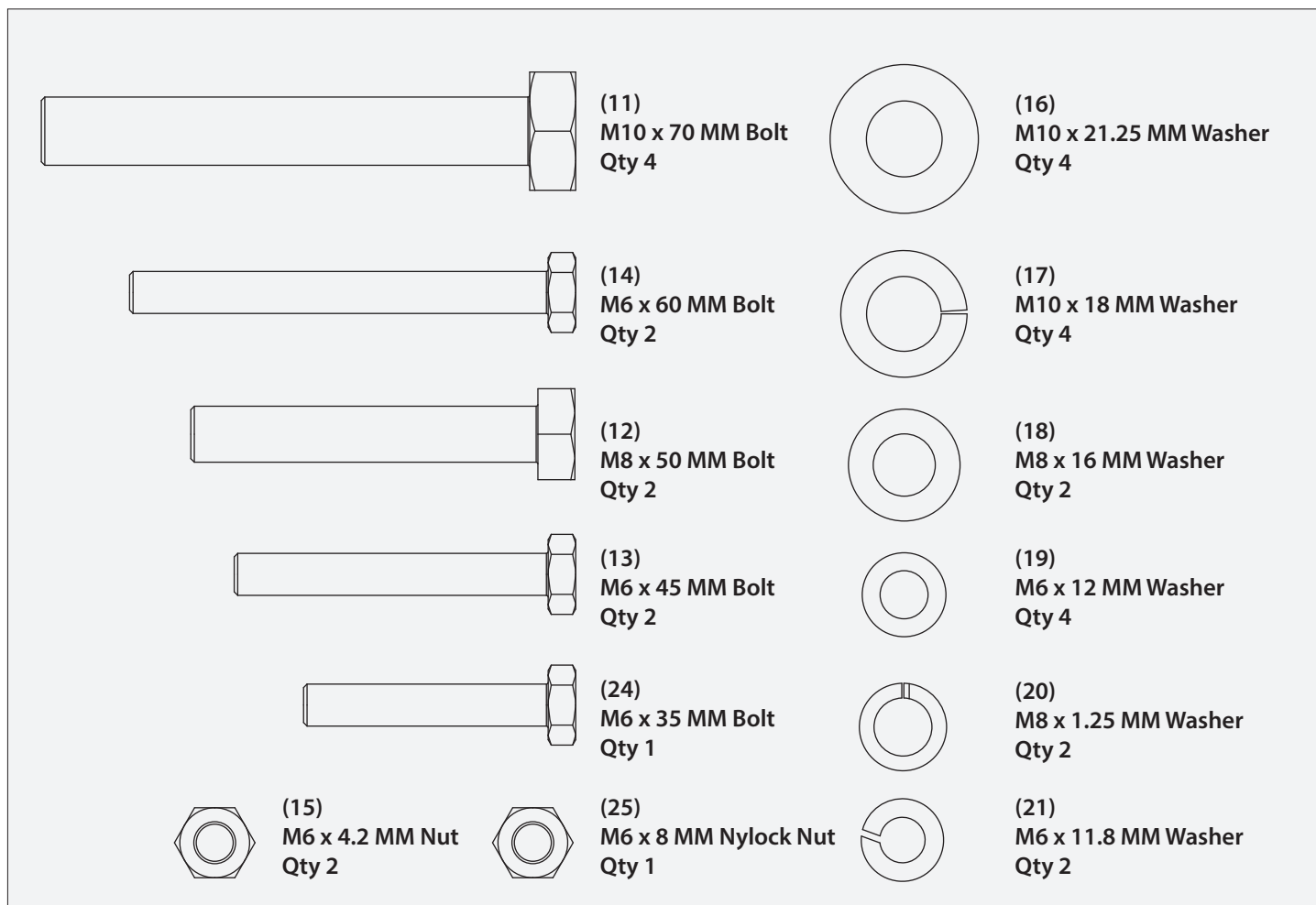

Ouvrir le sachet de visserie et identifier toute la visserie illustrée ci-dessus.

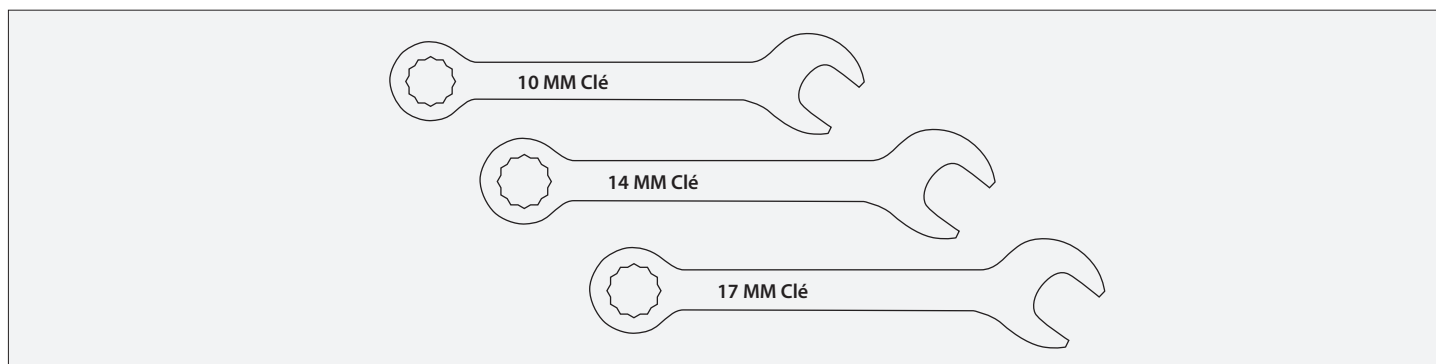

Tailles de clés nécessaires : 10 mm, 14 mm, 17 mm

1

Soulever la fendeuse de bûches par le côté coin et enfiler les pieds arrière (**1 et 2**) en s'assurant que les lettres sur autocollants se correspondent et que les autocollants soient alignés, comme aux **figures 2 et 3**.

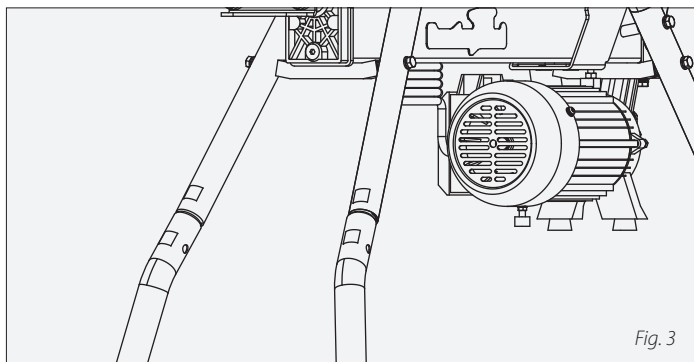
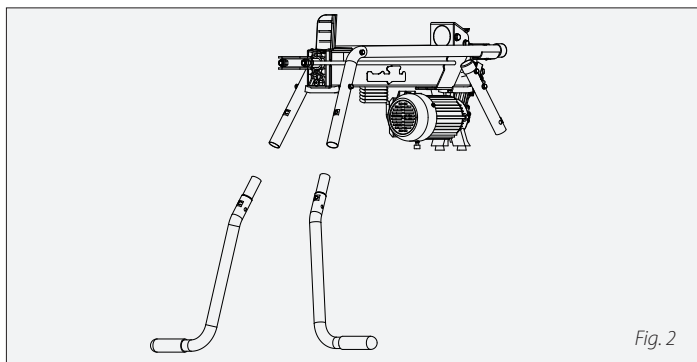

2

Avec deux des vis M10 (**11**), rondelles plates M10 (**16**) et rondelle-frein élastique M10 (**17**), monter la barre transversale (**6**) entre les pieds arrière (**1 et 2**). Poser la visserie sans la serrer. La barre transversale (**6**) est identifiée par l'autocollant indiquant un point de levage de la fendeuse de bûches pour le transport.

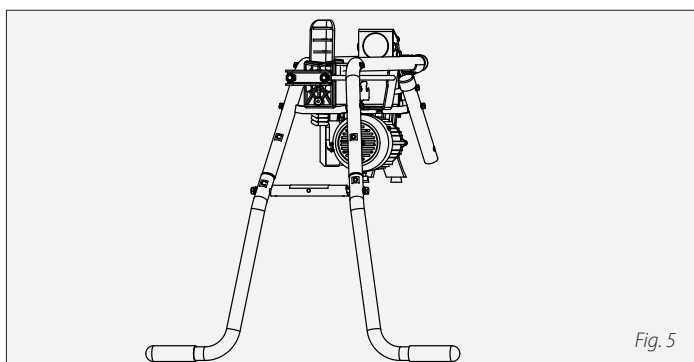
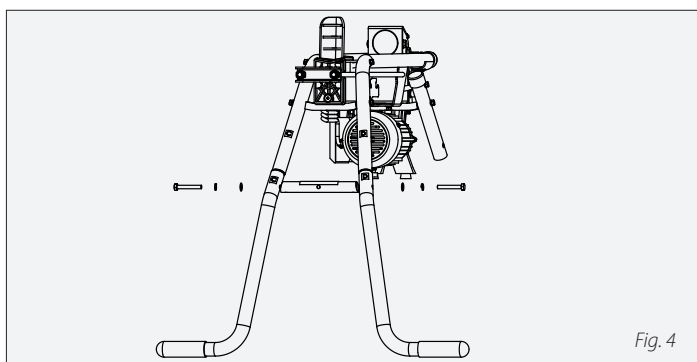

3

Soulever le côté pompe et enfiler les pieds avant (**3 et 4**) en veillant à aligner les autocollants.

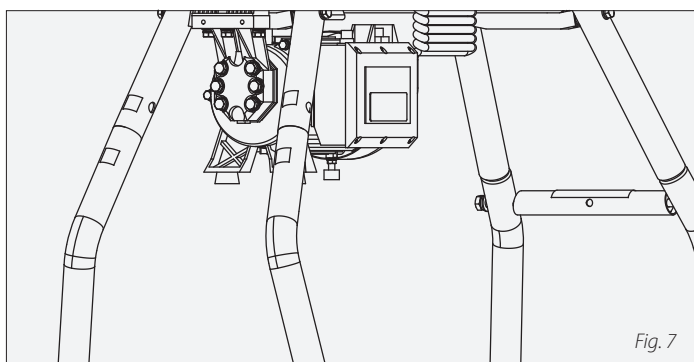
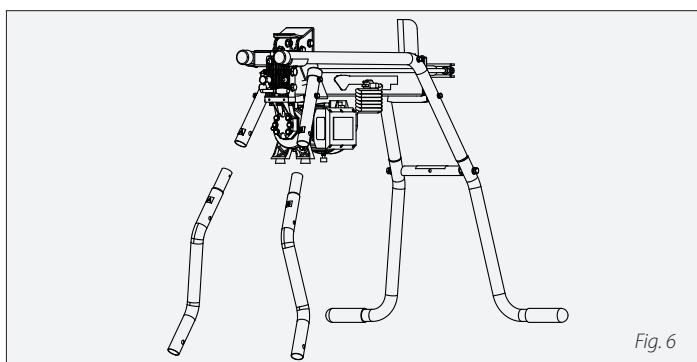

4

Avec deux des vis M10 **(11)**, rondelles plates M10 **(16)** et rondelle-frein élastique M10 **(17)**, monter la barre transversale **(7)** entre les pieds avant **(3 et 4)**. Poser la visserie sans la serrer.

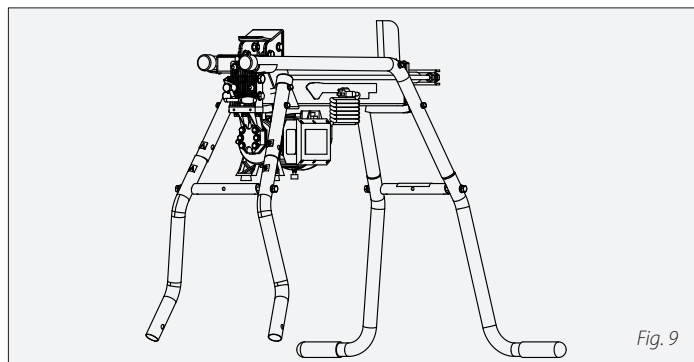
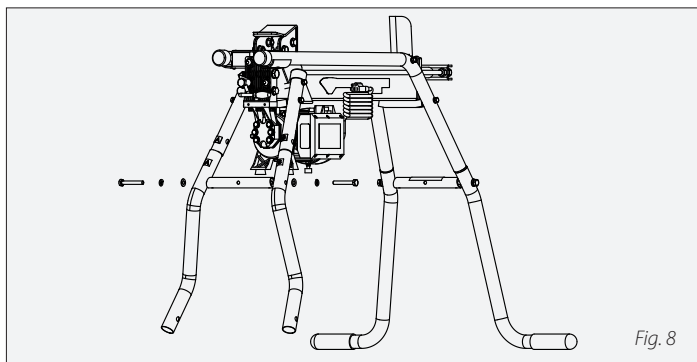

5

Après avoir monté les pieds, observer la machine par le côté. Son apparence doit être semblable à la **figure 10**.

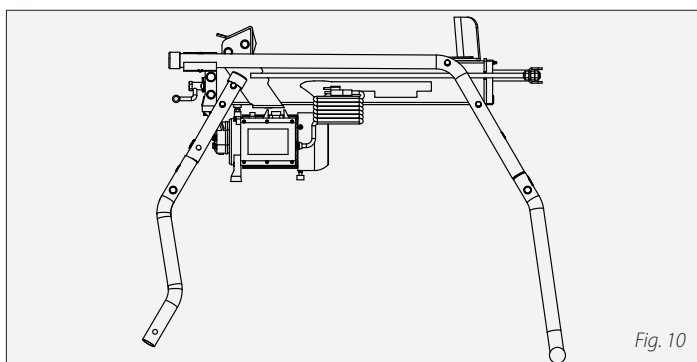

6

Attacher les vis M6 **(14, 24)** et écrou M6 **(25)** à la barre centrale **(5 & 23)** comme illustré à la **figure 11**. À ce stade, les vis ne doivent pas dépasser des écrous, comme illustré à la **figure 12**.

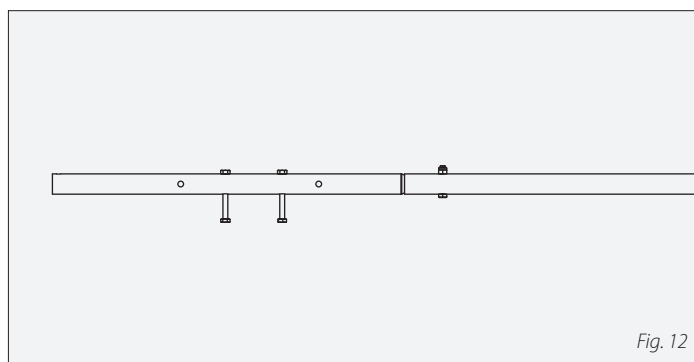
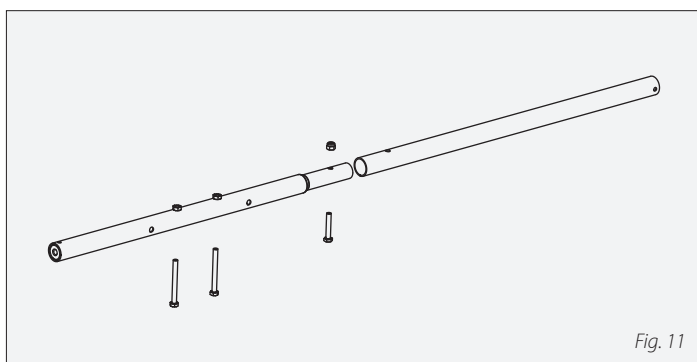

7

Attacher le support de moteur (8) à la barre centrale (5) avec les vis M6 (13), rondelles plates M6 (19), rondelles-freins élastiques M6 (21) et écrous M6 (15), comme illustré aux **figures 13** et **14**. La visserie doit être posée de telle manière que la hauteur du support de moteur puisse être ajustée ultérieurement.

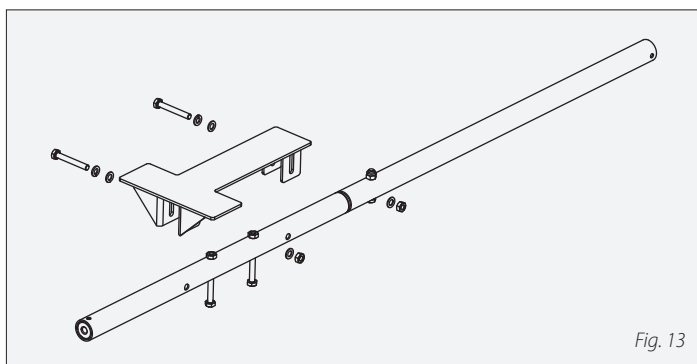

Fig. 13

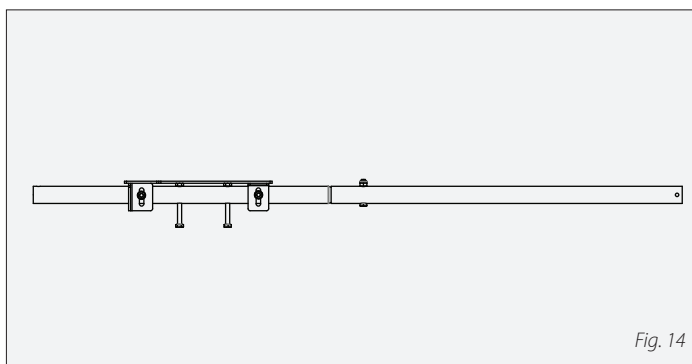

Fig. 14

8

Attacher la barre centrale (5 & 23) aux barres transversale (6 et 7) avec les vis M8 (12), rondelles plates M8 (18) et rondelles-freins élastiques M8 (20).

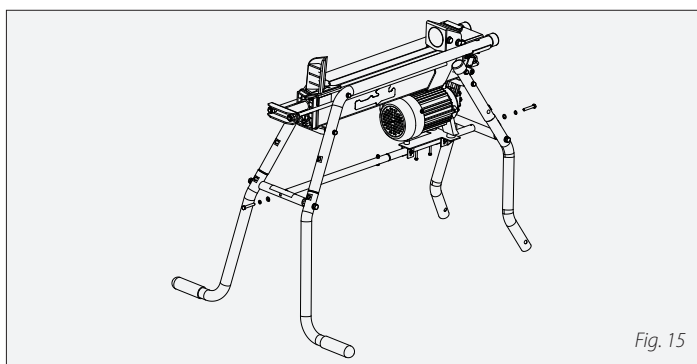

Fig. 15

9

Après avoir attaché la barre centrale aux pieds, serrer toute la visserie à l'aide de clés de taille correspondante. Voir **figure 16**. La hauteur de l'étrier de support du moteur (8) doit à présent être ajustée de telle manière que le moteur repose sur le dessus du support de moteur. Voir **figure 17**.

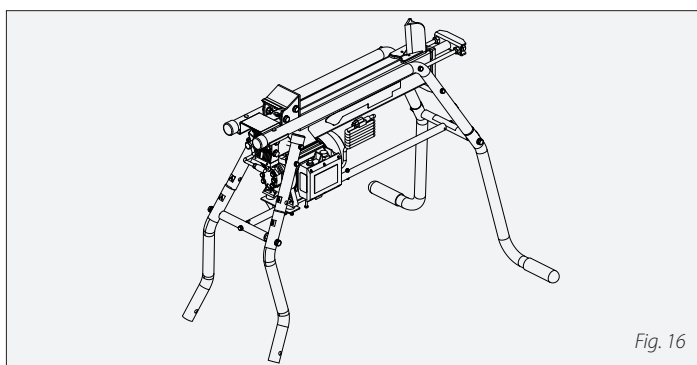

Fig. 16

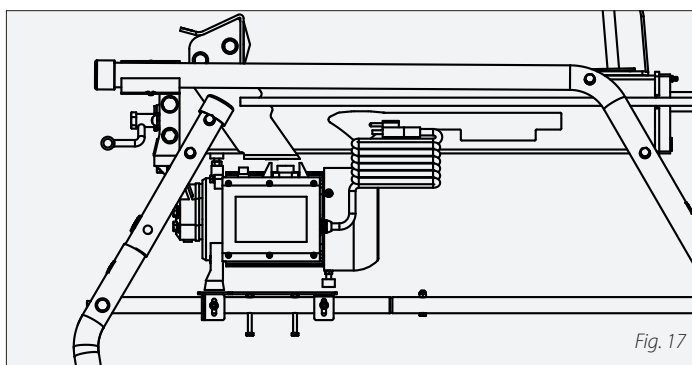
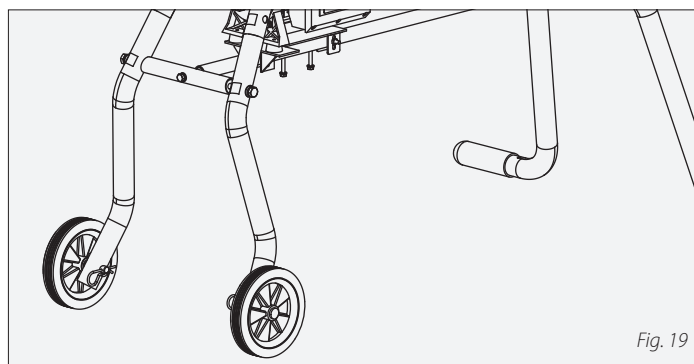
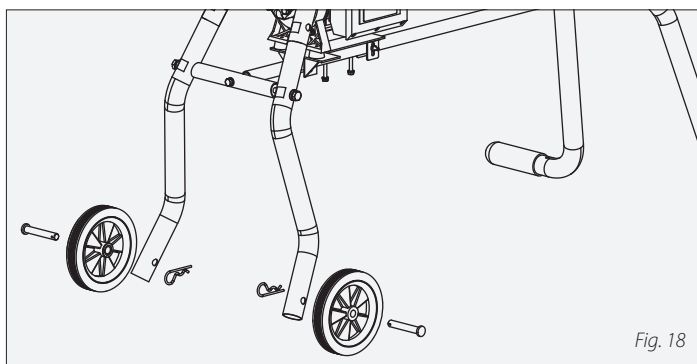

Fig. 17

10

Monter les ensembles roue et axe préassemblés **(9)** et épingle à cheveux **(22)**. Voir les **figures 18** et **19**.



Instructions d'assemblage du plateau à bûches :

1

Avec une clé de 14 mm, desserrer les vis illustrées à la **figure 1**.

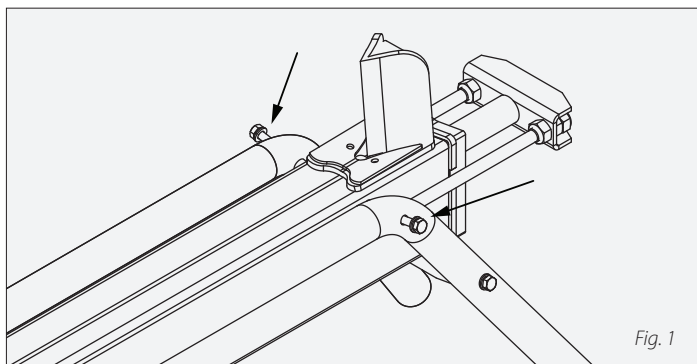

2

Il doit y avoir un espacement d'environ 13 mm (1/2 po) entre la tête de la vis et le pied. Voir la **figure 2**.

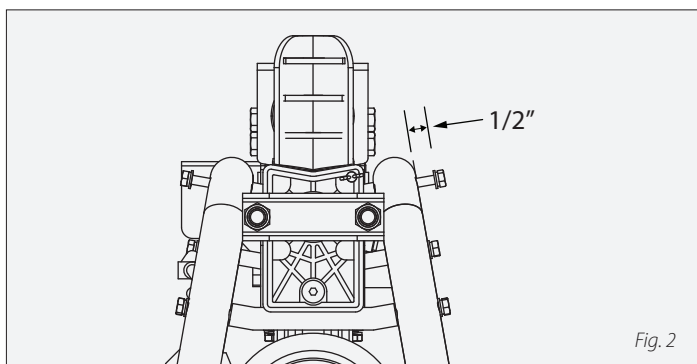

3

Abaisser le plateau comme illustré à la **figure 3** de manière à engager la vis dans l'encoche des pattes pliées du plateau. Voir les **figures 3 et 4**.

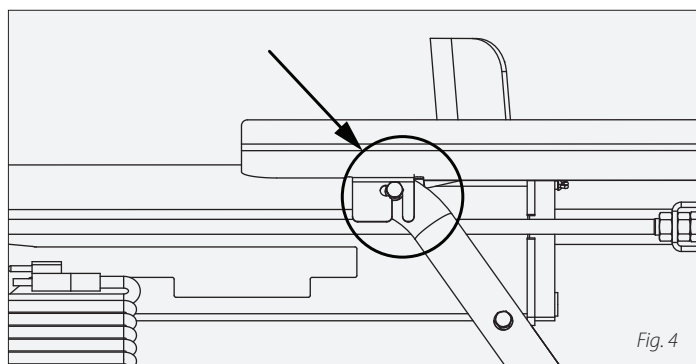
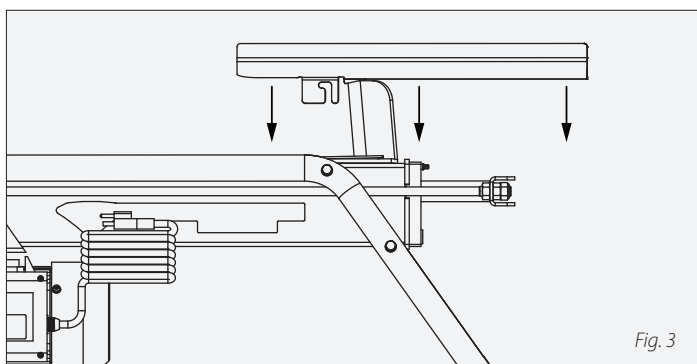

4

Tirer le plateau vers l'arrière de manière à amener le vis jusqu'au fond de leur encoche. Serrer les vis à l'aide de la clé de 14 mm.

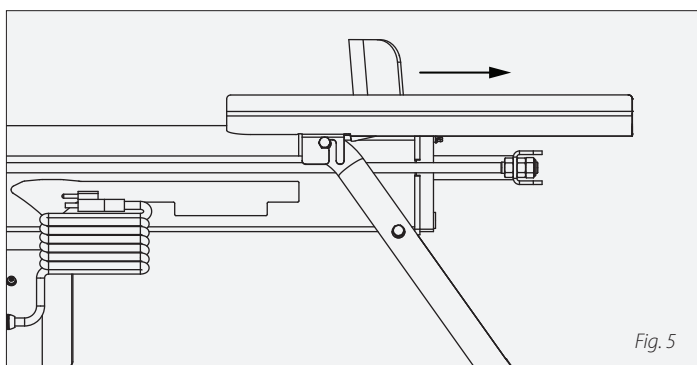

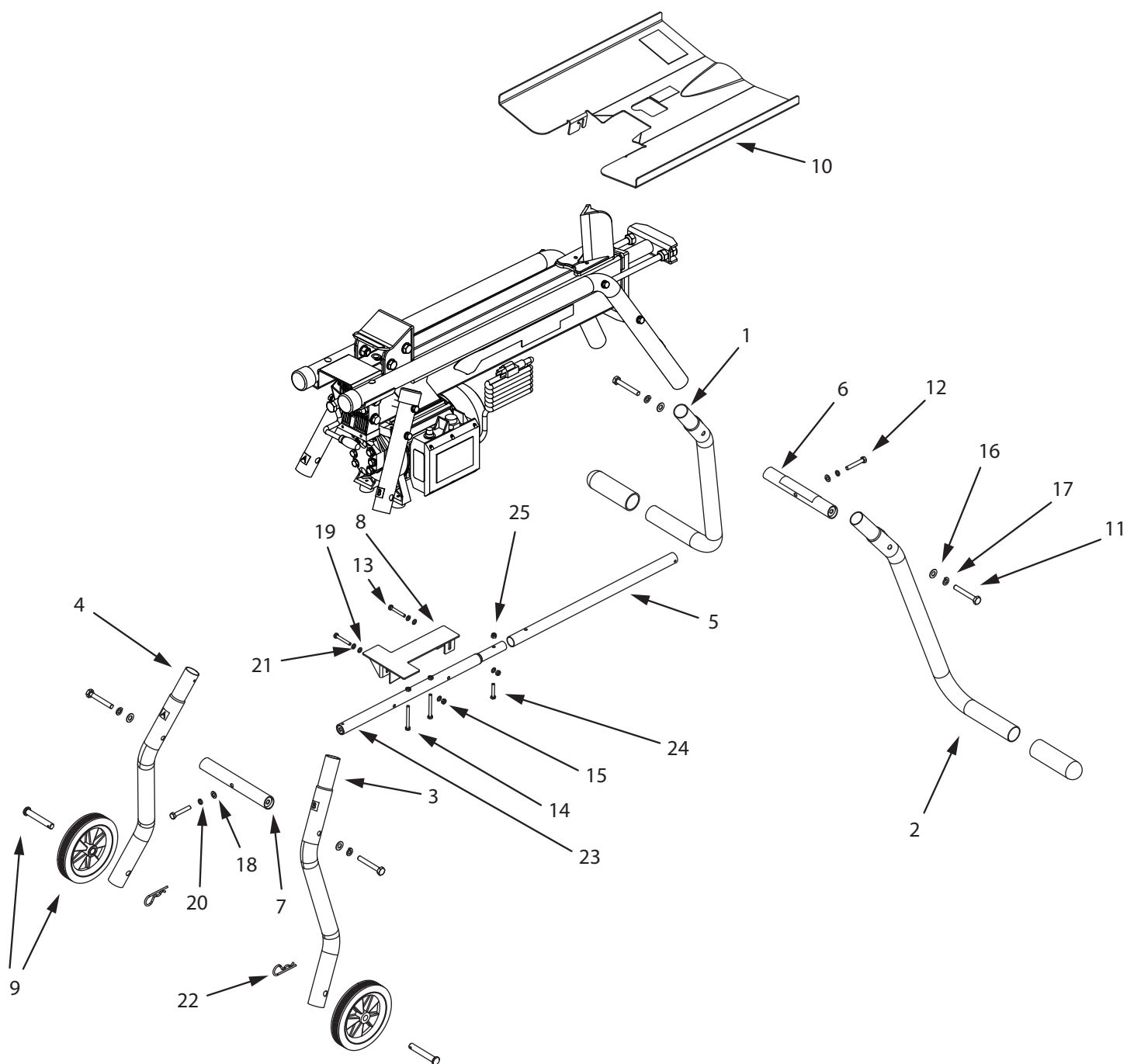

N.º DE ELEMENTO	N.º DE PIEZA	DESCRIPCIÓN	CANT.
1	34196	PATA TRASERA IZQUIERDA DEL SOPORTE W500 CON CALCOMANÍA	1
2	34197	PATA TRASERA DERECHA DEL SOPORTE W500 CON CALCOMANÍA	1
3	34199	PATA DELANTERA DERECHA DEL SOPORTE W500 CON CALCOMANÍA	1
4	34198	PATA DELANTERA IZQUIERDA DEL SOPORTE W500 CON CALCOMANÍA	1
5	34777	WELDMENT TUBE 25.1.5X513.2 MM W/ SPACER	1
6	33734	CONJUNTO SOLDADO DE VARILLA DE CONEXIÓN DE PATAS DEL SOPORTE W500	1
7	33734	CONJUNTO SOLDADO DE VARILLA DE CONEXIÓN DE PATAS DEL SOPORTE W500	1
8	33735	CONJUNTO SOLDADO DE SOPORTE DEL MOTOR DEL SOPORTE W500	1
9	33669	CONJUNTO DE EJE DE RUEDA W500	1
10	34203	BANDEJA DE LEÑOS W500 CON CALCOMANÍA	1
11	W1265V0902	PERNO M10X1.5X70 MM HHCS GR8.8 ZINC, ROSCA PARA TUBOS	4
12	21718	PERNO M8X1.25X50 MM HHCS GR8.8 ZINC, ROSCA FINA	2
13	33742	PERNO M6X1.0X45 MM HHCS GR8.8 ZINC, ROSCA FINA	2
14	331059	PERNO M6X1.0X60 MM HHCS GR8.8 ZINC, ROSCA FINA	2
15	31948	TUERCA M6X1X4.2 MM GR8.8 ZINC	2
16	W1200126	ARANDELA M10X21.25X1.33 MM GR8.8 ZINC	4
17	W1200119	ARANDELA M10X18.1X2 MM SPRLK ZINC	4
18	20143	ARANDELA M8X16X1.5 MM GR8.8 ZINC	2
19	W1200117	ARANDELA M6X12X1.00 MM GR8.8 ZINC	4
20	32569	ARANDELA M8X1.25X2.1 MM SPRLK GR8.8 ZINC	2
21	W1200116	ARANDELA M6X11.8X1.5 MM SPRLK GR8.8 ZINC	2
22	46134	PASADOR DE HORQUILLA 0.148 DIÁM. X 0.75 DIÁM. EXT. EJE	2
23	34778	WELDMENT TUBE 25.1.5X513.2 MM SWEDGE END W/ SPACER	1
24	18104	BOLT M6X1.0X35 MM HHCS GR8.8 ZN F-T	1
25	W1265V0913	NUT M6X1.0X8 MM HNYLK CL8 ZN	1

Instalación del soporte:

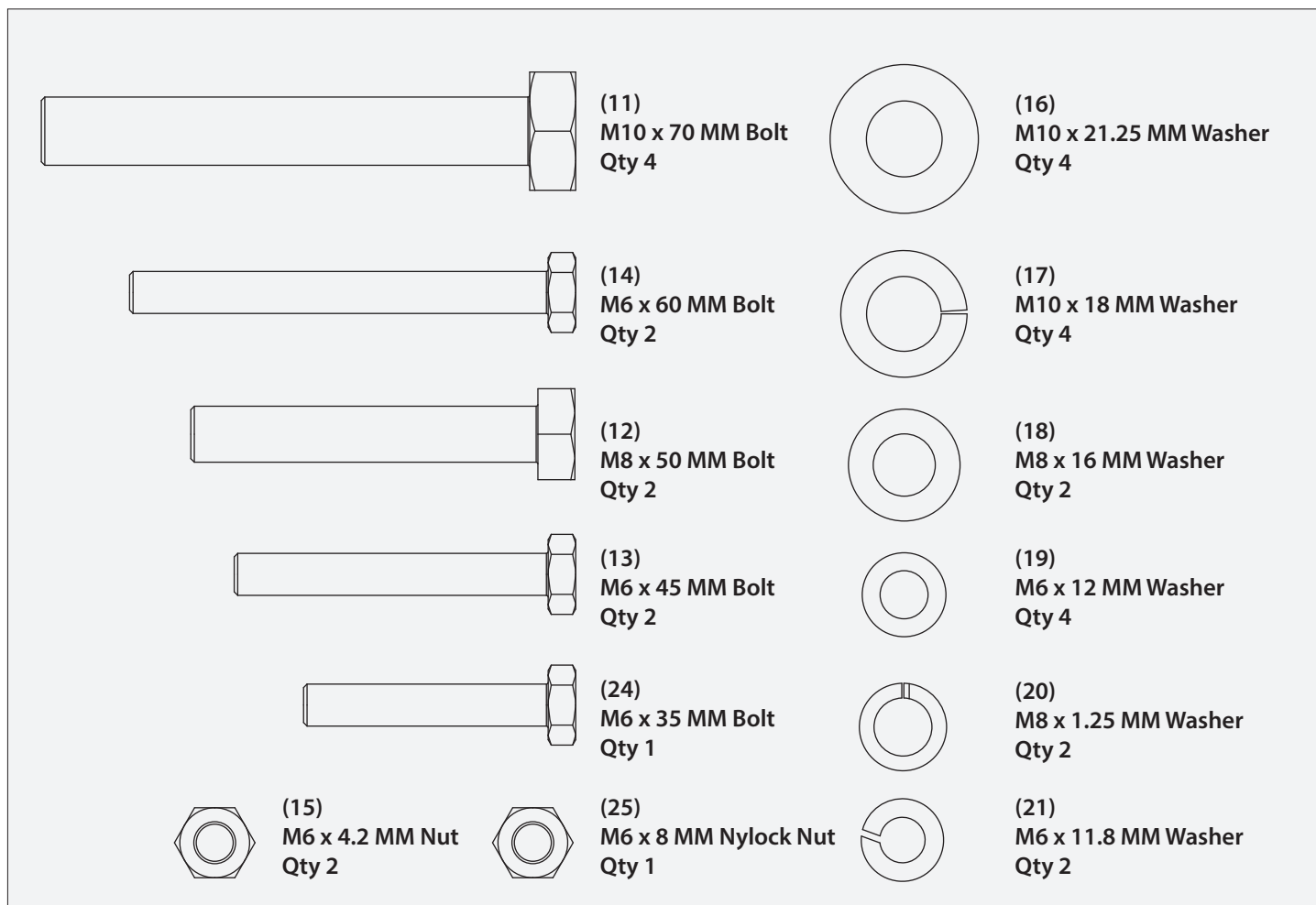

Abra la bolsa de piezas metálicas e identifique todas las que se muestran arriba.

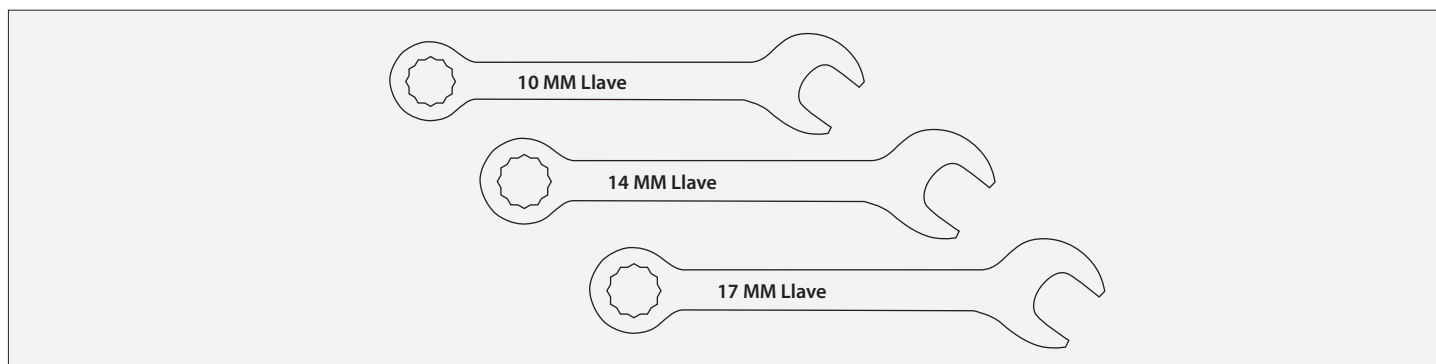

Tamaños de llave necesarios: 10 mm, 14 mm, 17 mm

1

Levante el partidor de leña desde la cuña e inserte las patas traseras **(1 y 2)**; asegúrese de que las letras de las calcomanías coincidan y que las calcomanías se alineen como en las **figuras 2 y 3**.

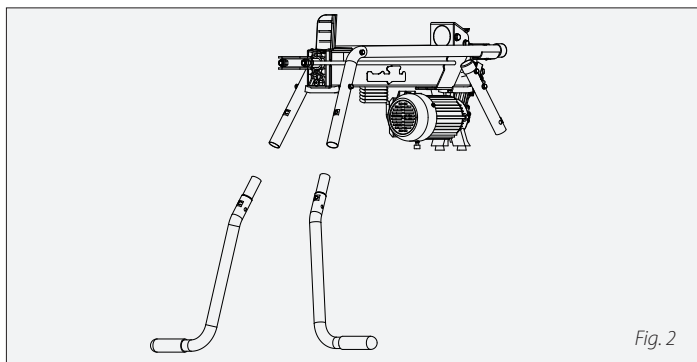

Fig. 2

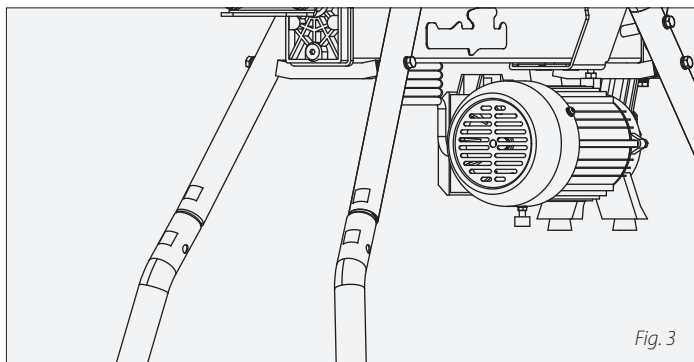

Fig. 3

2

Con dos de los pernos M10 **(11)**, la arandela plana M10 **(16)** y la arandela elástica de bloqueo M10 **(17)**, instale la viga transversal **(6)** entre las patas traseras **(1 y 2)**. Las piezas metálicas se deben instalar sueltas. La viga transversal **(6)** se identifica con la calcomanía que hace referencia a una ubicación de elevación para el transporte del partidor de leña.

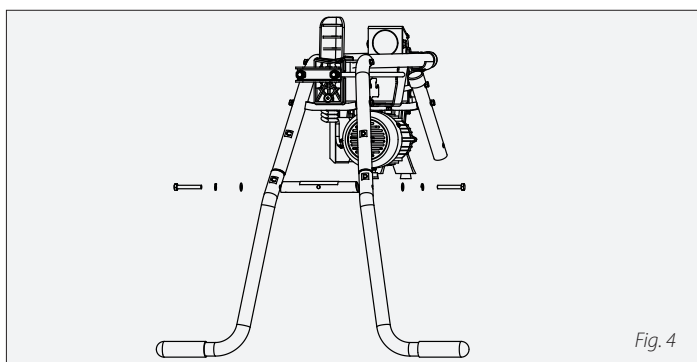

Fig. 4

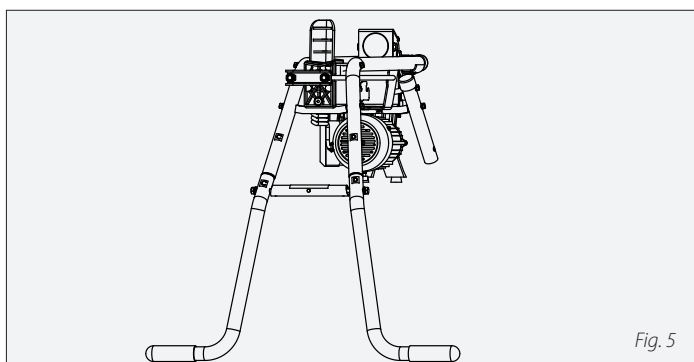

Fig. 5

3

Levante el extremo de la bomba e inserte las patas delanteras **(3 y 4)** y asegúrese de que las calcomanías estén alineadas.

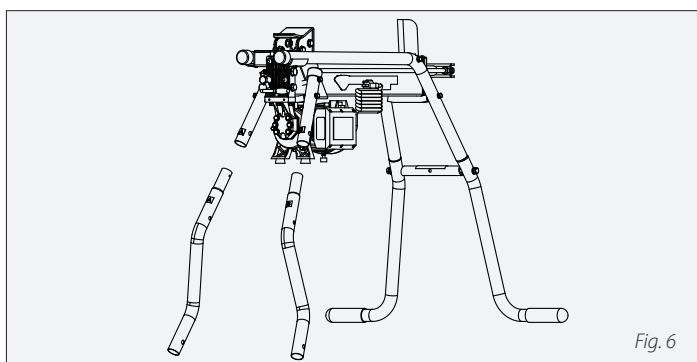

Fig. 6

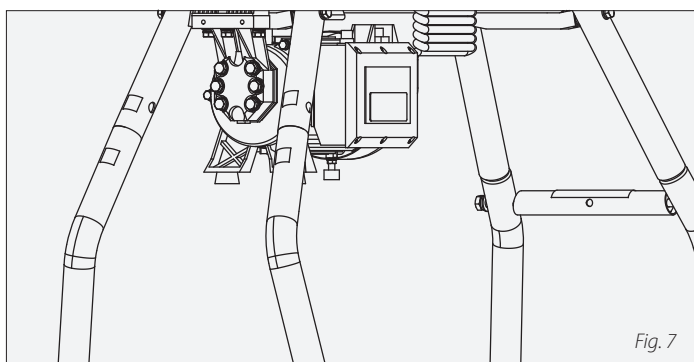
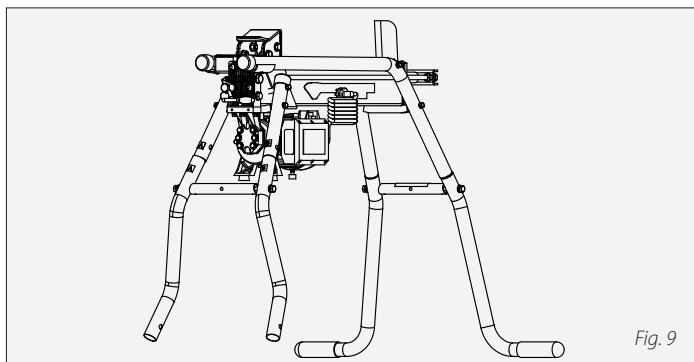
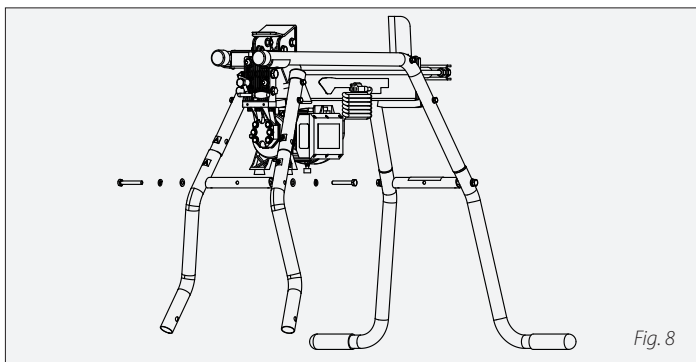

Fig. 7

4

Con dos de los pernos M10 **(11)**, arandelas planas M10 **(16)** y la arandela elástica de bloqueo M10 **(17)**, instale la viga transversal **(7)** entre las patas delanteras **(3 y 4)**. Las piezas metálicas se deben instalar sueltas.



5

Después de instalar las patas, observe la unidad desde un lado. Debería verse similar a la **figura 10**.

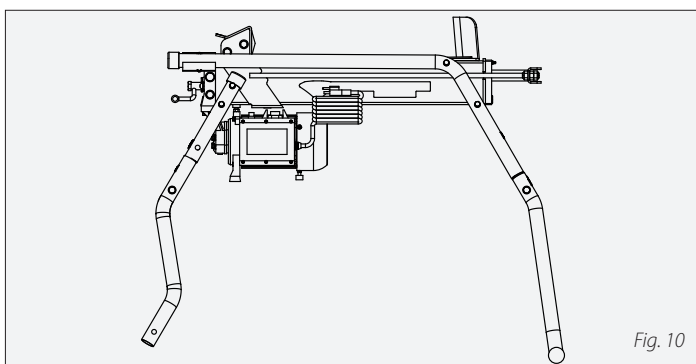

6

Con los pernos M6 **(14, 24)** y tuerca M6 **(25)**, fije a la varilla central **(5 & 23)** como se muestra en la **figura 11**. En esta etapa, los pernos no deben sobresalir de la tuerca, como se muestra en la **figura 12**.

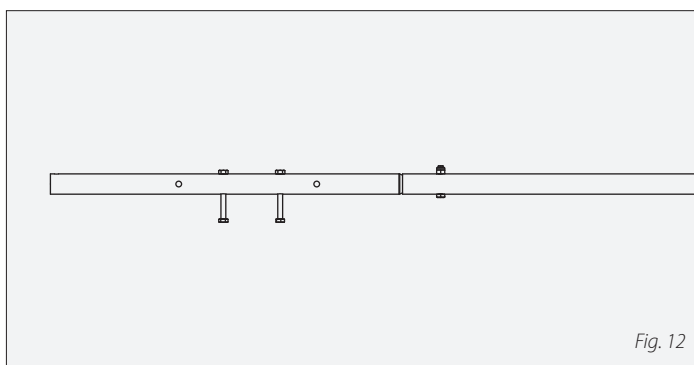
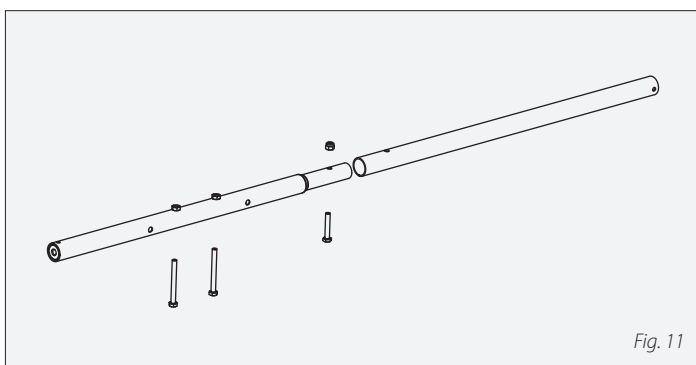

7

Instale el soporte del motor (8) en la varilla central (5) con el perno M6 (13), la arandela plana M6 (19), la arandela elástica de bloqueo M6 (21) y la tuerca M6 (15), como se muestra en las **figuras 13 y 14**. Las piezas metálicas se deben fijar de manera que la altura del soporte del motor se pueda ajustar en una etapa posterior.

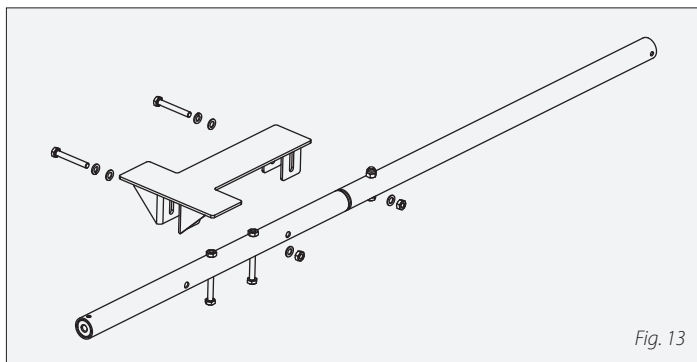

Fig. 13

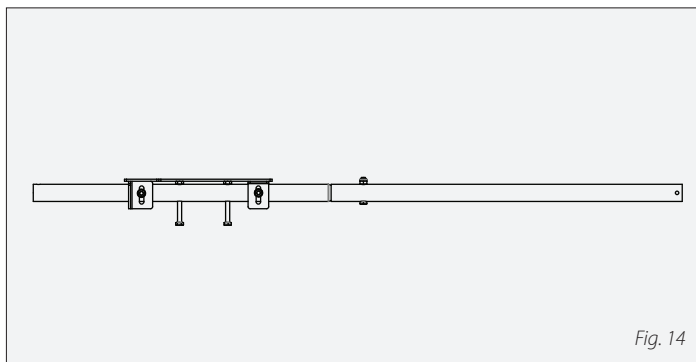

Fig. 14

8

Instale la varilla central (5 & 23) en las vigas transversales (6 y 7) con los pernos M8 (12), la arandela plana M8 (18) y la arandela elástica de bloqueo M8 (20).

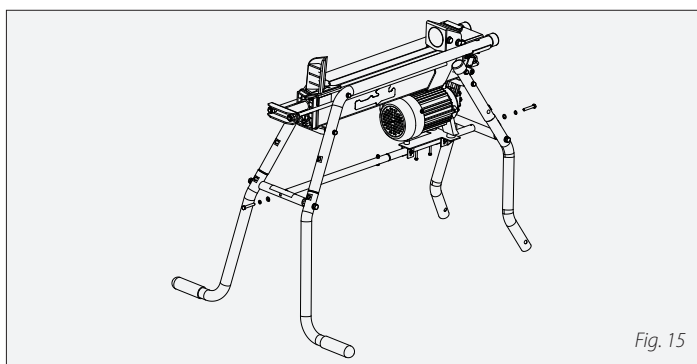

Fig. 15

9

Después de conectar la varilla central con las patas, se deben apretar todas las piezas metálicas con las llaves del tamaño correcto. Consulte la **figura 16**. Ahora se puede ajustar la altura del soporte del motor (8), de manera que el motor se apoye en el soporte superior del motor. Consulte la **figura 17**.

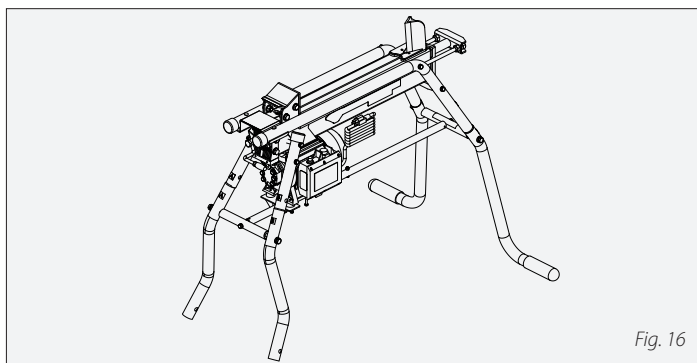

Fig. 16

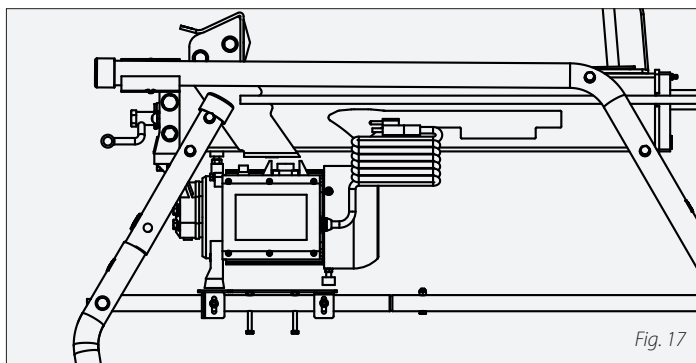
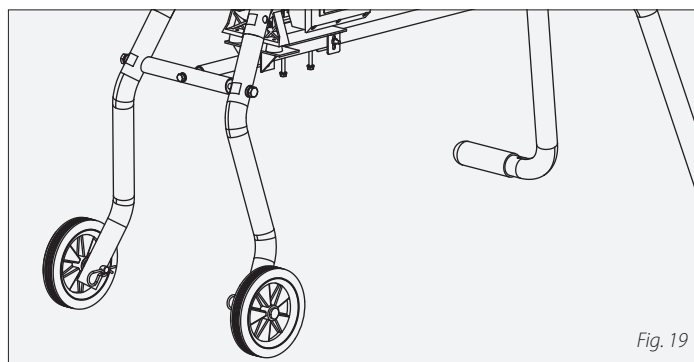
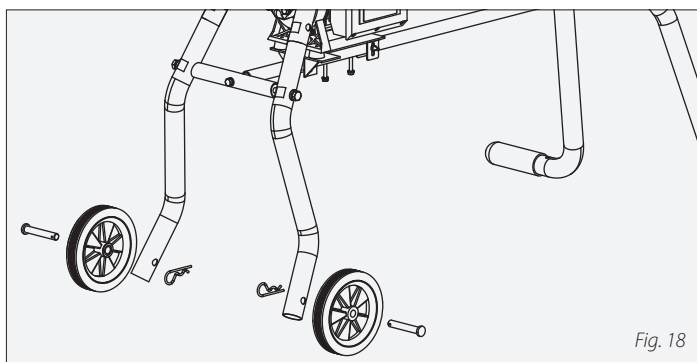

Fig. 17

10

Instale las ruedas con la rueda y eje montados previamente **(9)** y pasador de chaveta **(22)**. Consulte las **figuras 18 y 19**.



Instrucciones de montaje de la bandeja de leños:

1

Con una llave de 14 mm, suelte los pernos que se muestran en la **figura 1**.

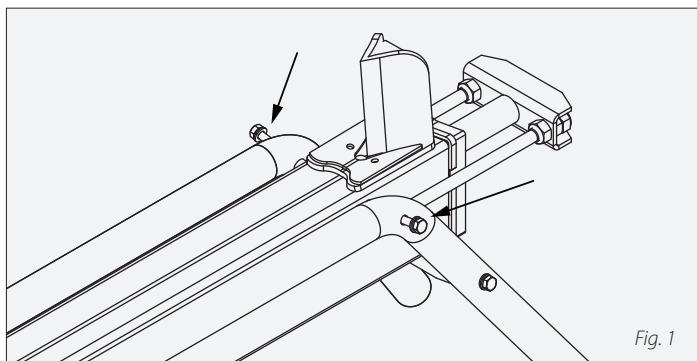

2

Debe haber un espacio de aproximadamente 1/2" entre la cabeza del perno y la pata. Consulte la **figura 2**.

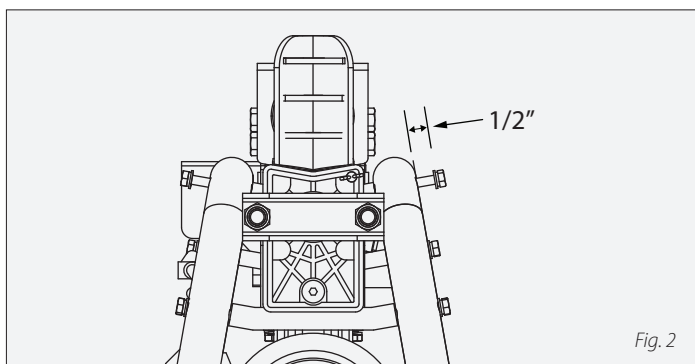

3

Deje caer la bandeja como se muestra en la **figura 3**, de modo que el perno se deslice a través de la ranura en las lengüetas dobladas de la bandeja. Consulte las **figuras 3 y 4**.

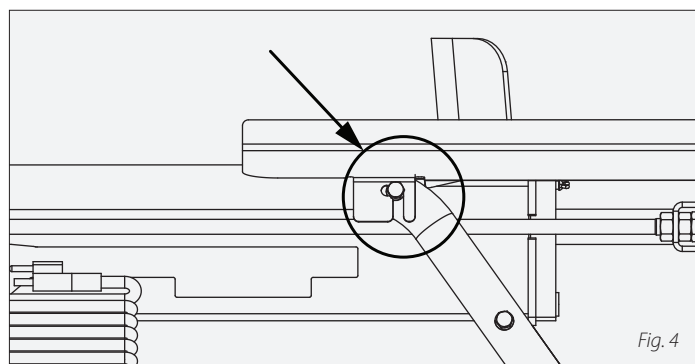
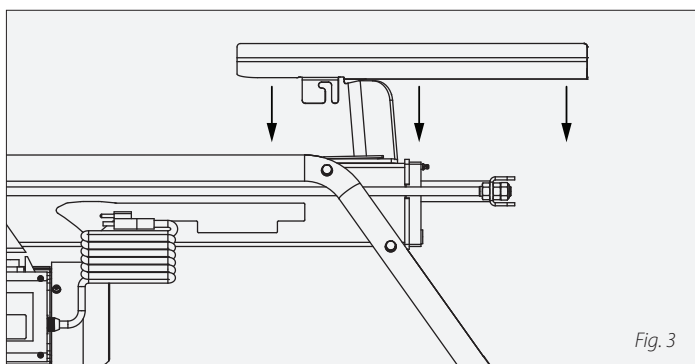

4

Mueva la bandeja en dirección contraria al bloque de empuje, de modo que los pernos sobresalgan en el extremo de la ranura. Apriete el perno con la llave de 14 mm.

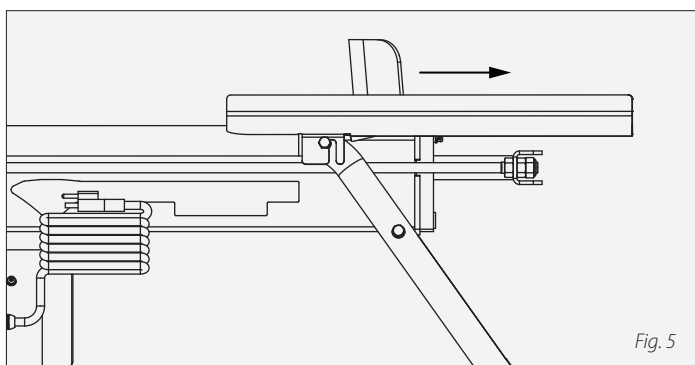

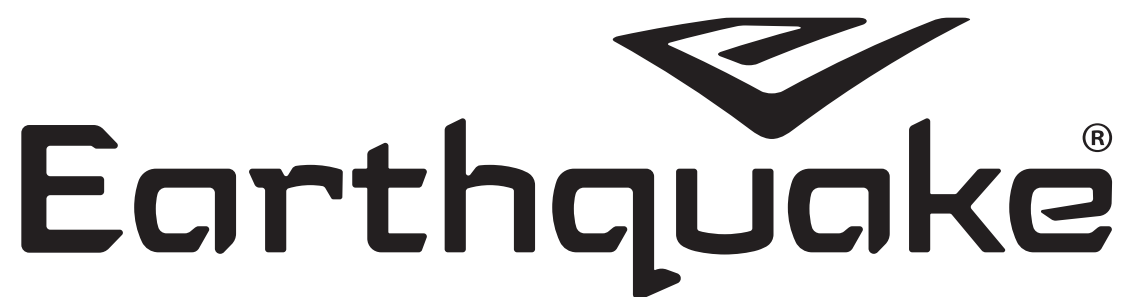

ARDISAM, INC.
1730 Industrial Avenue
PO Box 666
Cumberland, WI 54829

Phone: (800) 345-6007
Téléphone : (800) 345-6007
Teléfono: (800) 345-6007
Fax: (715) 822-2124
Télécopieur : (715) 822-2124
Fax: (715) 822-2124
www.getearthquake.com